

THE RESERVE LIST OF PLANTS CONSIDERED FOR
DECLARATION AS RARE FLORA

consists of:

A. TAXA PRESUMED EXTINCT

Not collected or reliably observed over the past 50 years, or whose total known wild population has been destroyed more recently

e.g. Sowerbaea multicaulis
Eriostemon falcatus

102 species

B. TAXA FOR HIGH PRIORITY MONITORING

Adequately surveyed, usually represented on reserves, not endangered or in need of special protection but could be if present circumstances change

e.g. Caladenia gemmata var. ixioides
Eucalyptus caesia

59 species

C. HIGH PRIORITY SPECIES CONSIDERED FOR DECLARATION BUT IN
NEED OF URGENT FURTHER SURVEY

Priority One Species

Only known from one or a few localities on land under
threat, e.g. road verges, urban areas, active mineral
leases

e.g. Eucalyptus "dolorosa"
Grevillea aff. hookeriana

161 species

Priority Two Species

Known from one or a few localities on land not under
immediate threat

e.g. Pimelea graniticola
Verreauxia verreauxii

163 species

Priority Three Species

Known from several localities, some of which are on
lands not under immediate threat

e.g. Wurmbea murchisoniana
Diuris sp. (granite, white)

112 species

DEPARTMENT OF CONSERVATION AND LAND MANAGEMENT

PROPOSED ADDITION OR DELETION TO THE
SCHEDULE OF DECLARED RARE FLORA

See CALM Policy Statement No. 9 for criteria,
definitions etc.

TAXON: Billardiera mollis

ADDITION:

Rare?

Endangered?

Special protection?

DELETION

Now adequately reserved?

More common than thought?

Hybrid?

Extinct?

RECOMMENDED BY: D.J. Coates

DATE: 5/2/88

TAXONOMY:

Described by E.M. Bennett (1983) in Nuytsia 4 (3) 275-277.

It most closely resembles B. villosa but has white anthers, flat leaf margins, a more open habit and a pubescent capsule.

RECENT SURVEY DATA:

Surveyed over a 3 month period from Nov 1981 to Jan 1983 and more recently over 3 days in Nov 1987 in the Ravensthorpe ranges and adjacent areas.

MANAGEMENT IMPLICATIONS:

This species occurs on vacant Crown land which could be released for farming, in areas claimed for mining and in one area where mining is occurring. It does not occur on any conservation reserve and will need to be closely monitored in case of habitat disturbance.

Advice to D.O.M.?

SUMMARY ASSESSMENT:

Billardiera mollis is a low spreading shrub with deep blue flowers occurring in the Ravensthorpe Ranges and adjacent areas extending over a range of 22 kms. Eight populations are known with none occurring on conservation reserves. Six populations, three of which are very small are found on vacant Crown land with one of these in an area claimed for mining. The remaining two populations occur on 'common' reserves, one where mining is already taking place and the other nearby in an area claimed for mining. A total of less than 1000 plants have been recorded in the wild. The species is vulnerable to potential land disturbance from either mining or farming.

KNOWN POPULATION AND RANGE:

Date of most recent survey	CALM Region	Population	Land Status	Area/No. of plants	Condition
-------------------------------------	----------------	------------	-------------	-----------------------	-----------

A: CONSERVATION RESERVES

B: OTHER LANDS

Oct 87	S.C.	Rabbit proof fence east Carlingup	VCL	±100	good
Oct 87	S.C.	"	VCL	±150	good
Nov-Jan 81/82	S.C.	East of Rabbit proof fence, east of Carlingup	VCL	3	-
"	S.C.	"	VCL	20	-
"	S.C.	"	VCL	14	-
"	S.C.	Mt Desmond	mining) +16119	'common'	±50
"	S.C.	'near Kundip'	claims) VCL		±150
"	S.C.	Kundip	(mining) +16091	'common'	7

RARE FLORA FIELD REPORT FORM



File No.: _____

Gaz [/] Proposed Gaz [] Not Gaz []

Population No.: 7

TO: S/C FLORA, COMO

FROM: J.L. ROBSON

TITLE: FORESTER (OPS) NORTHERN REGION

TAXON: *Daviesia microphylla*

SURVEY DATE: 15/7/88

REGION: NORTH

DISTRICT: MUNDARING

SHIRE OF: BEVERLEY

MAP REF: No/TYP: GUNAPIN: 1:50,000, BJ.93.8.6.

LAND STATUS: Nature Res. Nat. Park State Forest Water Res. Rly Res.
 Shire Res. Private Rd. Verge-MRD Rd. Verge Shire
 Gravel Res. MRD Gravel Res. Shire VCL Other (state) _____

LOCALITY: Dobaderry Nature Reserve No. 34442 - 1.5km north along Dobaderry Road from N/E jct' of Location 28713 and approx. west along internal fireline for 1.55km to a point 300m S/W of Dobaderry Swamp.

LATITUDE: 32°12'15" LONGITUDE 116°36'05 ALTITUDE -

HABITAT: light brown sand with odd lateritic rock evident.

SOIL TYPE: Laterite Ridge Pebble Gravel Limestone Granitic
 Loam Peat Sand-White Grey Yellow
 Clay It brown

CONDITION: Perm wet Moist Saline Dry Other (state) _____
Under normal summer conditions

LANDFORM: Cliff Hilltop ^{plateau} Ridge Breakaway Slope
 Lake Edge Drainage line River bank Gully Valley
 Lowplain Flat Sand Dune Firebreak Other (State) _____

Lateritic ridge with small sandy hilltop plateau

ASPECT: Bordered by slight slope on N/W, N & E aspect

VEGETATION CLASSIFICATION: Open, Wandoo/Marri stand

ASSOCIATED SPECIES: Understorey of scattered *Dryandra sessilis* associated with a light to moderate ground storey of varying heath shrub species 0.3-0.5m height.

NO. OF PLANTS: Mature: 7 Seedlings: - Area Occupied (m²): 1,000
 (Estimated) Plant regrowth in burnt area is very vigorous and

CONDITION: Healthy Dying Other (state) healthy - in unburnt area rather straggly growth

REPRODUCTIVE STATE: In bud Flower Fruit Immature Dehisced

RELEVANT OBSERVATIONS: e.g. Recently burnt Dieback Undisturbed
 (please describe) Approximately Autumn 1987

POLLINATORS: Native Bees Honey Bees Mammals Birds Others (state if observed) _____

ATTACHED: Map Illustration Photo Voucher Specimen Mudmap

ACTION REQUIRED: Taken (state) Mundaring to ensure its long term protection -
 NOTE: 6 plants are on the north side of the fireline and 1 plant on the south side.

COPY: Regional Office: District Office Other (state) 1 copy to Woodvale - for attention
Dr S. Hopper and Ms A. Kelly - ref: Confirmation of this species' ability to withstand fire.

Signed: J.L. Robson

Date: 18/7/88

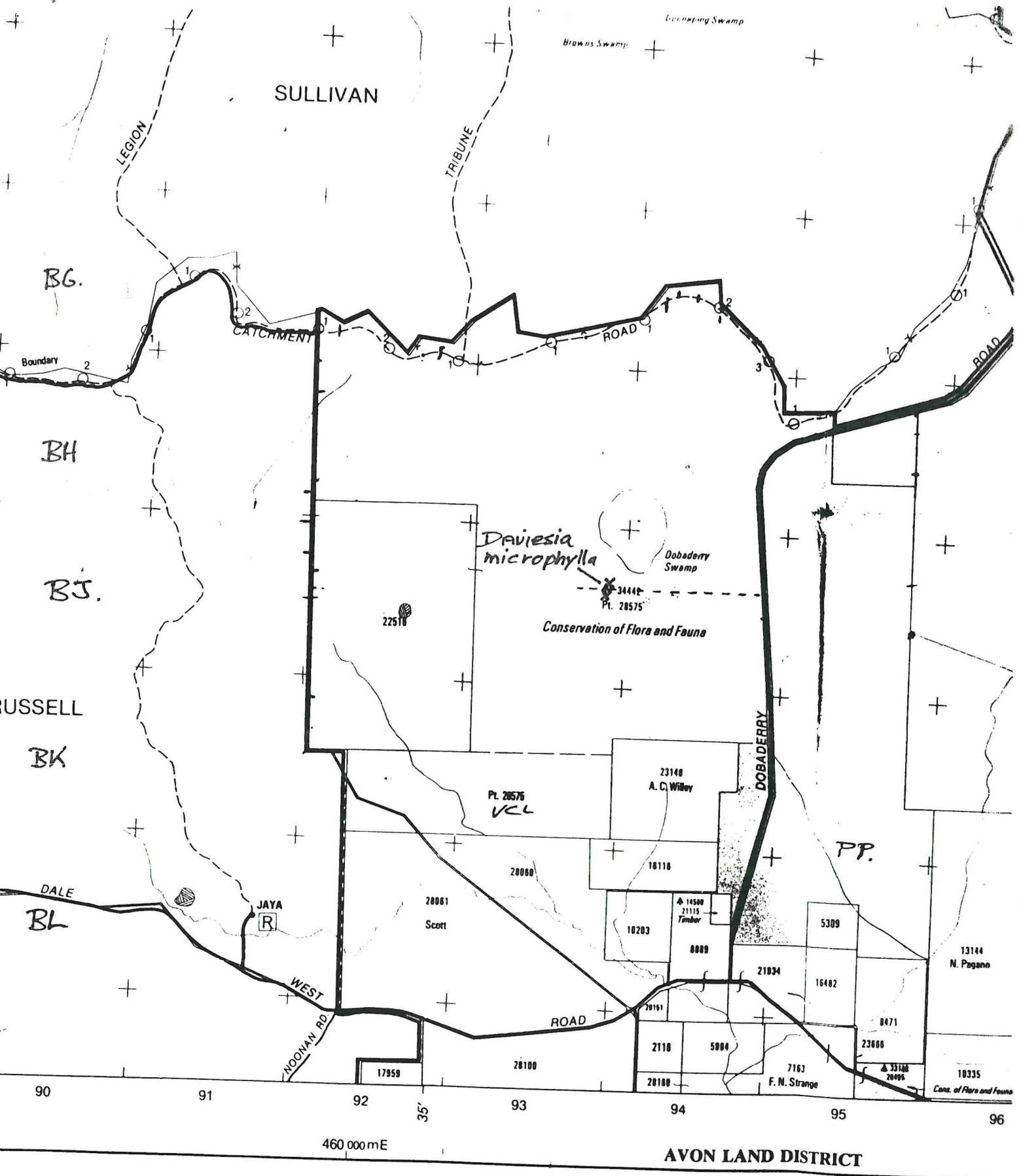

- Department
- hill
- ut Tower
- y Reference Tree Theodolite
- y Reference Tree Compass
- ment Water Supply Developed
- ment Water Supply
- ng Ramp

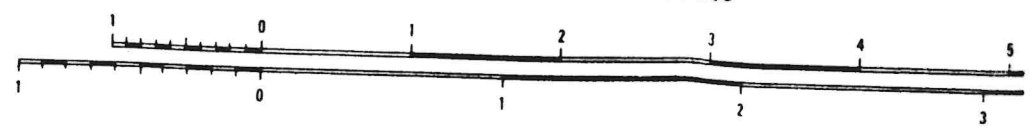

Prepared under the direction of the Conservator of Forests, Perth, W.A.
 Not to be reproduced without permission Crown Copyright Reserved

SIGHT RECORD SHEET

(Write zero as 'Ø'; letter 'i' as 'I'; letter 'z' as 'Z')



LOCALITY

Observer Code

Date of observation

Yr Mn Dy

Nearest named place

Air distance from nearest named place

Direction from nearest place

R C O 2 3 L R

8 8 Ø 7 1 5

C o F F i n R o c k

1 4 . 8

S

Further details of location

L O 1 . 5 5 k m W o f D o b a d e r r y R d a t 1 . 5 k m N o f L o c 2 8 7 1 3

Map used

Latitude

Longitude

Resolution: Codes

Vegetation restricted to road verge

Shire Code

Reserve number

Reserve class

G D

F O

3 2 1 2 1 5

1 1 6 3 6 Ø 5

3

1=1" 2=10"
3=30" 4=1'
5=10' 6=30'
7=1°

N

Y=Yes
N=No

Ø Ø 8

3 4 4 4 2

C

Shire name

Beverley

Reserve name

Dobaderry Swamp

HABITAT

Landform Codes: 1=Hilltop 2=Steep hill slope (>20°) 3=Gradual hill slope(5-20°) 4=Valley bottom or swale 5=Rock outcrop
6=Flat 7=Winter wet swamp 8=Lake edge 9=Riverbank or dry bed Ø=Other

Landform Aspect

L F

1

N

Major Colour

Soil Type: 1=Sand 2=Loam 3=Clay 4=Gravel 5=Stone Ø=Other
Soil Colour: B=Brown G=Grey K=Black R=Red W=White Y=Yellow Ø=Other

Surface Soil

Major

Minor

S L

1

4

B

Vegetation structure

highest stratum

lowest stratum

V S

4 M R

4 S R

2 S B

(Open woodland)

(Open Dryandra scrub)

(Heath)

Dominant species names

D S

E 9 J W 8 H

E 9 J C 4 C

D B N S E 4

Other habitat notes

H N 300 m SW of Dobaderry Swamp.

SPECIES PRESENT

Species name/code

Population size: Codes

In flower

Remarks

1=1-10 2=10-50

Y=Yes

12 13 14 15 16 17 18 19 20 21 22 23 24 25 26 27 28 29 30 31 32 33 34 35 36 37 38 39 40 41 42

3=50-100

N=No

4=100-500

Plants resprouting after Fire
in Autumn 1987

5=500-1000

11

43 44 45 46 47 48 49 50 51 52 53 54 55 56 57 58 59 60 61 62 63 64 65 66 67 68 69 70 71 72 73

6>1000

∅=unknown

0 5 D 1 S M H ∅

1

0 B

0 B

0 B

0 B

0 B

0 B

0 B

0 B

0 B

0 B

0 B

Grid for row 1

Grid for row 2

Grid for row 3

Grid for row 4

Grid for row 5

Grid for row 6

Grid for row 7

Grid for row 8

Grid for row 9

Grid for row 10

Grid for row 11