

**INSTITUTE OF FORESTERS
OF AUSTRALIA**



1987 Biennial Conference

Forest Management in Australia.

27TH SEPTEMBER - 2ND OCTOBER 1987

PERTH

WESTERN AUSTRALIA

PROGRAMME AND INFORMATION

SPONSORS

The Conference Organizing Committee acknowledge the following major sponsors.

ALCOA OF AUSTRALIA LTD
BUNNINGS FOREST PRODUCT PTY LTD
W.A. CHIP AND PULP CO. PTY LTD
WESTRALIAN FOREST INDUSTRIES LTD

Other Sponsors include:

ALSTERGREN PTY LTD
AUSTRALIAN AIRLINES
AUSTRALIAN FOREST DEVELOPMENT INSTITUTE
A.P.M. FORESTS
ADELAIDE TIMBER COMPANY PTY LTD
WORSLEY TIMBER PTY LTD
S M COLLINS (VIC) PTY LTD
BRUCE BEGGS
C.S.R. TIMBER PRODUCTS
GANDY TIMBERS
HARRIS DAISHOWA (AUST) PTY LTD
McARTHUR AND ASSOCIATES
R L NEWMAN AND PARTNERS PTY LTD
SPRENGEL AND ASSOCIATES
VICTORIAN SAWMILLERS ASSOCIATION
WHITTAKERS LTD
A.P.P.M. FOREST PRODUCTS
FOREST PRODUCTS ASSOCIATION

The Committee also acknowledge the considerable support given by the Department of Conservation and Land Management, Western Australia.

COUNCIL OF THE INSTITUTE OF FORESTERS OF AUSTRALIA (1985-1987)

President : Dr G J Bacon, Department of Forestry,
Brisbane, Queensland.

Members : Mrs H R Crompton, Canberra, ACT.
: Dr J.H Drielsma, Forestry Commission of NSW,
Sydney, NSW.
: Mr P C Johnston, Woods and Forests
Department, Adelaide, SA.
: Mr D J Keene, Dept of Conservation and Land
Management, Perth, WA.
: Mr P G Sheehan, Dept of Conservation,
Forests and Lands, Melbourne, VIC.
: Mr J E N Smith, APPM Forest Products,
Launceston, TAS.

Secretary : Mr K S Jennings, Dept of Forestry,
Brisbane, Queensland.

Business Manager : Mr B Cumberland, Canberra, ACT.

HOST DIVISION, WESTERN AUSTRALIA

Chairman : Dr F H McKinnell

Secretary : Mr P Jones

Committee : Mr R Sneeuwjagt
: Mr E Sprengle
: Mr K Vear

Conference : Dr J Fox (Chair) ; Mr A Hart
Committee : Mr R Sneeuwjagt (Sec) ; Mr D Haswell
: Mr G McArthur ; Mr P Jones
: Mr W Schmidt ; Dr E Hopkins
: Mr D Griffith ; Mr Batini
: Dr F McKinnell

Conference : Golden West Travel
Secretariate

ORGANISATION

All technical and administrative functions of the Conference will be held at the Hilton International Hotel - The Parmelia. These include registration, technical sessions, institute meetings, poster paper exhibits, craft exhibits and shop, tours information desk, morning and afternoon teas and luncheons.

Refer to the plan of the Parmelia functional rooms on the next page.

Drew Griffiths is the Conference Floor Manager, and is available for queries on organisation. Conference committee members and staff of Golden West Travel Convention Organizers at the Registration desk will be available to assist on any queries.

Registration desk phone number 322 3622 (Ext. 2455).

For urgent after hours messages contact Rick Sneeuwjagt on 3679831.

Public phones are available in the Hotel lobby.

Name tags should be worn at all official functions. Apart from identifying you, they are your official passport to Conference functions.

Colour code for name tags:

| | |
|-------|---|
| Blue | Conference Committee and Ladies Committee |
| White | Host Division |
| Gold | Authors and Speakers on Papers |
| Green | All other full Registrants |
| Pink | Partial Registrants, and Students |
| Red | Special Guests and Sponsors |

Delegates are requested to be punctual at all times. All functions and excursions will start at the stated times.

A "SPEAKERS BREAKFAST" is to be provided in the Parmelia Room at 7.30 am on Tuesday, Thursday and Friday to brief speakers on the presentations and audio-visual arrangements.

DELEGATE ENTITLEMENTS

The Conference Full delegate registration fee includes the following:

| | |
|-----------|--|
| Sunday | Picnic lunch and drinks, Welcome cocktails |
| Monday | :Morning tea and afternoon tea, lunch and ICEBREAKER dinner and drinks. |
| Tuesday | :Morning and afternoon tea, lunch, hospitality dinner. |
| Wednesday | :Field tour, lunch and drinks. |
| Thursday | :Morning and afternoon tea, lunch, Banquet dinner, drinks and entertainment. |
| Friday | :Morning tea, farewell lunch. |

The Social delegate entitlements includes the Sunday picnic and Welcome cocktails, ICEBREAKER, hospitality dinner, Field Tour and lunch, Banquet dinner, farewell lunch.

The Student entitlements includes the Sunday picnic, all morning and afternoon teas, Wednesday field tour and lunch, and Friday luncheon.

The Child entitlements include the Sunday picnic, Wednesday field tour and lunch.

INFORMATION

LOCALITY MAPS

- * Maps of the Perth City area and Kings Park are shown on the back of this Programme.

BUSES

- * A timetable for bus and ferry services are available from the Registration desk.

TAXIS

- * Swan (3220111)
- * Black & White (3288288)
- * Green & Gold (3283311)

CARPARKING

- * Parking at the Parmelia Hotel is available through Wilson's Parking at the rear of the hotel at a rate of \$7.00 per day. City of Perth parking is available at foot of Mill Street by ticket validation (\$2.50 per day).

CHILDMINDING

- * Babysitting available within the Parmelia at \$4.00 per hour (increases after 11.30p.m.). Contact Registration desk for other options.

PHOTOCOPING

- * Contact Registration desk for this service.

RESTAURANTS, SIGHTSEEING, ENTERTAINMENT

- * The Tours desk has information of all relevant details on all forms of entertainment and tours for the Conference and post-conference periods.

CONFERENCE FEATURES

- * Posters, Papers, Books are displayed and for sale in the Waterford Room. Woodcraft Exhibition by W.A. artists is on display in the Waterford Room.

CONFERENCE SHOP

- * Display and sale of IFA Conference Tie, Jumpers, T-Shirts and Books is held in the Waterford Room.
- * A specially labelled after-dinner wine - "Frontignac Liqueur" housed in a beautiful Jarrah presentation box will be on sale to delegates for \$35.00 each.

PROGRAMME

SUNDAY, 27TH SEPTEMBER

12.00pm to 4.00pm

WELCOME PICNIC - Kings Park. Off Saw Avenue near Subiaco to Park (see map at back of Programme).

Barbeque packs and drinks to be supplied.

2.30pm to 3.00pm

Dance to the Bushband "Fiddler's Green"

During this weekend (25-29th September, 1987) the annual Native Plant Display and Wildflower Exhibition will be on show at the Kings Park Exhibition ground off Fraser Avenue near the main entrance. (See map)

4.00pm to 7.00pm

Early Bird Registration 1st Floor, Hilton Hotel

6.00pm to 7.15pm

COCKTAIL RECEPTION
Swan Room, Hilton Hotel

For those wishing to "kick on", there is always the BURSWOOD ISLAND CASINO.

PROGRAMME (continued)

MONDAY, 28TH SEPTEMBER

- 8.30am to 5.00pm REGISTRATION
1st Floor (Foyer) - the Hilton.
- 9.15am to 9.45am MORNING TEA BREAK, Parmelia Room.
- 9.50am to 10.50am CONFERENCE OPENING - Swan Room, Hilton.
Delegates requested to be seated by 9.45am.
Call to Order, Welcome to W.A.
Dr F McKinnell
Chairman, W.A. Division
Opening Address - His Excellency
The Governor of Western Australia
Professor Gordon Reid.
- Presidential Address -
Dr G Bacon- President, I.F.A.
- 11.00am to 12.30pm PANEL DISCUSSION, Swan Room.
Multiple Use in the Jarrah Forest.
- Chairman: J Bradshaw
Dept of Conservation and Land
Management (WA)
- Panel: R Adams, J Havel, R Sneeuwajagt, K Low
- 12.30pm to 1.30pm LUNCHEON - Parmelia Room.
- 1.30pm to 3.00pm PANEL DISCUSSION
Multiple Use in the Karri Forest
Chairman: R Underwood
Dept of Conservation and Land
Management (WA).
- Panel: A Walker, A Lush, C Schuster, A Sands.
- 3.00pm to 3.25pm AFTERNOON TEA BREAK, Parmelia Room.

PROGRAMME (continued)

MONDAY, 28TH SEPTEMBER (continued)

TECHNICAL SESSIONS - INVITED PAPERS

THEME: MULTIPLE USE WITH EMPHASIS ON TIMBER PRODUCTION

Chairman: Ellis Nicholson (NSW)

- 3.30pm to 4.00pm "The Mountain Ash Forests of Victoria:
Ecology, Silviculture and Management
for Wood Production.,
R O Squire, R G Campbell, K J Wareing
and G R Featherstone.
- 4.00pm to 4.30pm "Management and Planning of Tasmania's Native
Forests and Sawlogs and Pulpwood Production".
L van Saane and R Gordon

SOCIAL EXCURSIONS (NOT INCLUDED IN REGISTRATION FEE)

- 9.00am 1. Half Day walk through Perth City, Museum
and Art Gallery. Morning Tea at Miss Maud's \$5.00
- 1.00pm 2. Half Day Orientation Coach tour of Perth
and Fremantle. Afternoon Tea included \$18.50 Adults
and \$16.50 child

EVENING

- 6.00pm to 10.30pm ICEBREAKER CRUISE - Barrack Street
Jetty. (Included in Conference Fee)
- River Cruise to Fremantle Harbour - Wine
and dine and dance on the wonderful Swan River.
- Official Launch of "LEAVES FROM THE FOREST"
Book of Foresters tales. Introduced by
Prof. Ian Ferguson.
- Non-delegates (\$30 adult, \$15 child).

PROGRAMME (continued)

TUESDAY, 29TH SEPTEMBER

7.00am to 8.30am IFA Council Meeting (Breakfast supplied)
and Biennial General meeting. Terrace Restaurant
- first floor.

TECHNICAL SESSIONS - Invited Papers

Theme: Multiple Use with Emphasis on Timber Production.

Chairman: Pat McNamara (WA)

9.00am to 9.30am "Management of Native Hardwood Forests in State
Forests of the North Coast of N.S.W."
R A Curtin, R M Squire and C M Mackowski.

9.30am to 10.00am "The Dry Sclerophyll Silvertop Ash - Stringybark
Forests of South-Eastern N.S.W."
R G Bridges and G R Dobbyns.

10.00am to 10.30am "Management of High Altitude Eucalypt Forests in
Tasmania".
R Ellis and E Lockett

10.30am to 11.00am MORNING TEA BREAK

11.00am to 11.30am "Dry Sclerophyll Forests in Victoria (1):
Low Elevation Mixed Forests".
J Kellas and R Hateley

11.30am to 12.00pm "Dry Sclerophyll Forests in Victoria (2):
Inland Box - Ironbark Forests".
J Kellas

12.00pm to 12.30pm "Southern Tablelands Eucalypts".
D Hamilton and N B Cowley

12.30pm to 1.30pm LUNCHEON, Parmelia Room

Chairman: Barrie Dexter (Victoria)

1.30pm to 2.00pm "Management of Cypress Pine Forests in
Queensland".
T N Johnston (Queensland Forestry Department).

PROGRAMME (continued)

TUESDAY, 29TH SEPTEMBER (continued)

TECHNICAL SESSION (continued)

2.00pm to 2.30pm "Management of Radiata Pine in Australia".
N.B. Lewis (South Australia)

2.30pm to 3.00pm "Management of Tropical and Sub-tropical Pines in
Queensland".
P J Francis and G M Shea.

3.00pm to 3.30pm AFTERNOON TEA BREAK

3.30pm to 4.00pm "Hoop Pine Forests Management".
J A Dale and G T Johnson.

SOCIAL EXCURSIONS (not included in Registration Fee)

9.45am onto 5.00pm Full Day Swan Valley Vineyard Tour.
Lunch and Wine tasting included
\$35.00 inclusive.

8.45am to 5.00pm Full Day - Atlantis Sea World and Yanchep National
Park.
Lunch excluded
(\$20 Ad., \$8 Child).

The Royal Show - fun of the fair for the kids. Take
the train to Claremont Show Grounds
(\$7 Adults, \$4 Child).

EVENING: HOME HOSPITALITY WITH W.A. FORESTERS' FAMILIES

Delegates who have requested home hospitality will
be listed at the Registration Desk, together with their
hosts. See the House Manager for further details if
you have not heard from your host by Monday night.

PROGRAMME (continued)

WEDNESDAY, 30TH SEPTEMBER

8.00am to 5.30pm FULL DAY TECHNICAL EXCURSIONS
(Included in Conference Fee)

Buses will depart promptly from outside the Hilton
Hotel at staggered intervals from 8.00am to 8.20am.

TOURS

1..JARRAH SILVICULTURE TOUR - Dwellingup District.
Looks at opportunities for optimizing wood and water
production through manipulation of forest stands.

2.BAUXITE MINING AND REHABILITATION TOUR -
Jarrahdale District.
impact and management of bauxite mining on the
northern jarrah forest. Inspects ALCOA's mining and
rehabilitation operations.

3.RECREATION DESIGN AND INTERPRETATION -
Lane Poole Reserve.
Methods of managing high-use recreation areas in
the northern jarrah forest.

4.WOOD PROCESSING TOUR - Perth.
Inspection of major wood processing facilities,
including the Bunnings Welshpool complex, and
WESFI's Plywood Factory.

SOCIAL EXCURSION

10.00a.m.-2.00p.m. Perth Zoo, for Adults and Kids. Go by ferry from
Barrack Street Jetty and a short walk. Plenty of
school holiday activity programmes.

EVENING

FREE - Check with Tours Desk for entertainment
ideas.

PROGRAMME (continued)

THURSDAY, 1ST OCTOBER

TECHNICAL SESSIONS - Invited Papers

THEME: AUSTRALIA'S RAINFORESTS.

Chairman: Bob Newman (Tasmania)

9.00am to 9.30am "Management of Tropical Rainforests in North
Queensland".
T E Just (Queensland Forestry Commission).

9.30am to 10.00am "Rainforests of New South Wales"
G N Baur (Forestry Commission of N.S.W.).

10.00am to 10.30am "Management of Tasmania's Cool Temperature
Rainforests".
J E Hickey and K C Felton

10.30am to 11.00am MORNING TEA BREAK

THEME: FORESTS COMBINING PRODUCTION AND PROTECTION.

11.00am to 11.30 "Riverine Forests of the Central Murray Valley".
M Parsons, L J Bren and B D Dexter.

11.30am to 12.00pm "Management of Inland Arid and Semi-arid
Woodland of Western Australia
I Kealley (C.A.L.M. W.A.)

THEME: MULTIPLE USE WITH EMPHASIS ON CONSERVATION

12.00pm to 12.30pm "The Perup Forest, Western Australia".
Dr P Christensen (CALM, W.A.).

12.30pm to 1.30pm LUNCHEON, Parmelia Room

PROGRAMME (continued)

THURSDAY, 1ST OCTOBER (continued)

TECHNICAL SESSION - Invited Papers

Chairman: Jim Williamson (W.A.)

- 1.30pm to 2.00pm "Management of Tropical Open Forest in
Kakadu National Park, Northern Territory"
C D Haynes (CALM, W.A.).

THEME: MULTIPLE USE WITH EMPHASIS ON RECREATION

- 2.00pm to 2.30pm "Recreation Management and Multi-resource Planning
for the Mt Cole Forest, Victoria".
M Leonard and D Holmes (C.F.L., Victoria).

- 2.30pm to 3.00pm "The Lane-Poole Reserve, Western Australia".
K Vear (CALM, W.A.).

- 3.00pm to 3.30pm AFTERNOON TEA BREAK

- 3.30pm to 4.00pm "Management of Stromlo Forest, Australian
Capital Territory".
A Sebire (Department of Territories, Canberra).

THEME: SPECIAL FOREST USE

- 4.00pm to 4.30pm "Managing the Ash-type Forests for Water Production
in Victoria".

P J O'Shaughnessy and M D A Jayasuriya.

- 4.30pm to 5.00pm "Management of Forests Combining Pines and
Grazing in Australia".
R Moore (CALM, W.A.).

PROGRAMME (continued)

THURSDAY, 1ST OCTOBER (continued)

SOCIAL EXCURSIONS

- 8.45am to 5.00pm .Full Day Trip to ROTTNEST ISLAND.
Ferry leaves from Barrack Street Jetty at 8.45am sharp.
(\$22 Adult, \$11 Child). Does not include lunch.

- 9.30am .Full or Half Day ADVENTURE WORLD.
A kids (and some parents!) paradise.
Entry Fee \$11.00 Adult, \$9.00 Child). Lunch excluded.

Take the M.T.T. bus (fare \$1.40 adult, child \$0.70).

EVENING

7.00pm

CONFERENCE BANQUET, Parmelia Room, the Hilton.

The gala event of the week. Be early for the pre-dinner
fellowship. Includes Helen Matthews, Perth's finest
jazz singer and her band. Music and dancing to
midnight.

Dress - Lounge Suit

1987 "Max Jacobs Oration" delivered by John Groome
(N.Z. Forestry Consultant).

Oration theme : "Professional Foresters
or Public Servants?".

PROGRAMME (continued)

FRIDAY, 2ND OCTOBER

TECHNICAL WORKSHOPS

9.00am to 10.30am

WORKSHOP 1: Intensive Management of Native Forests.
Chairman: Dr Ross Florence (ANU, Canberra).

WORKSHOP 2: Fire Protection of Regrowth Forest and Pine Plantations
Chairman: Mr John Smart (CALM)

WORKSHOP 3: Impact of National Estate Legislation.
Chairman: Mr Dick Curtin (Forestry Commission, NSW).

10.30am to 11.00am MORNING TEA BREAK

11.00am to 12.30pm

WORKSHOP 4: Geographic Information System in Forestry.
CHAIRMAN: DR ERIC HOPKINS (CALM, W.A.)

WORKSHOP 5: Controlling Forest Harvesting Practices
Chairman: Mr Evan Rolley (Tasmanian Forestry Commission).

WORKSHOP 6: Whither Forestry Education?
Chairman: Dr Ian Ferguson (University of Melbourne)

12.30pm to 2.00pm FAREWELL LUNCHEON (Parmelia Room).

OFFICIAL LAUNCH OF I. F. A. NATIONAL
FOREST POLICY.

2.00pm to 4.30pm IFA Institute Business Meeting, and
Biennial General Meeting (Swan Room)

CONFERENCE CLOSES TO MEET AGAIN IN 1989

POSTER PAPERS

A presentation of poster papers will be on display in the foyer of the Parmelia throughout the Conference.

The following list is not complete:

.Harvesting Karri Regrowth.
J D Clarke (CALM, WA)
CSIRO Division of Forest Research.

.Forest Mapping Display by The Institute of Cartographers.
."Growth of Jarrah on Dieback Sites".
E M Davison (CALM, W.A.)

.Development of Prescribed Burning in Regenerated Karri Forest".
W L McCaw (CALM, W.A.)

.Western Australian Timber Inventory moves towards air photo
sampling".
P H Biggs (CALM, W.A.)

.Ecological Survey of the Walpole-Nornalup National Park.
1: Patterns 2: Process"
G Wardell-Johnson (CALM, W.A.)

.Control of Forest Harvesting Practices"
E. Rolley (Tasmanian Forests Commission)

.Aut-ecological Studies of Eucalypt Patens.
B Owens and J Elliot

.The Mulga Woodland.
Dr J Fox and N Casson (Curtin University)

.A Hazard Rating System for Phytophthora Cinnamomi in
Northern Jarrah (Eucalypt Marginata) Forests.
B L Shearer, R Beuhrig, A Byrne, M Dillon and D Ward (CALM)

.Eucalypt Plantation Silviculture.
B Jenkins (WACAP)

LOCATION GUIDE

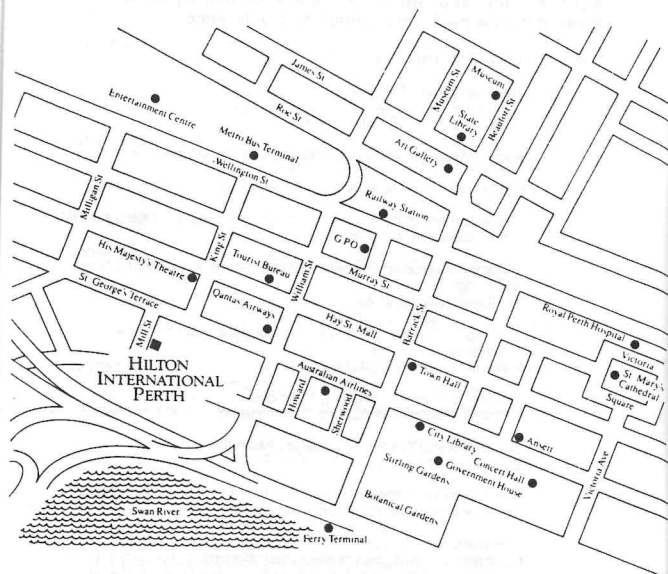

Hilton International

PERTH

THE PARMELIA
Mill Street, Perth WA 6000, Australia

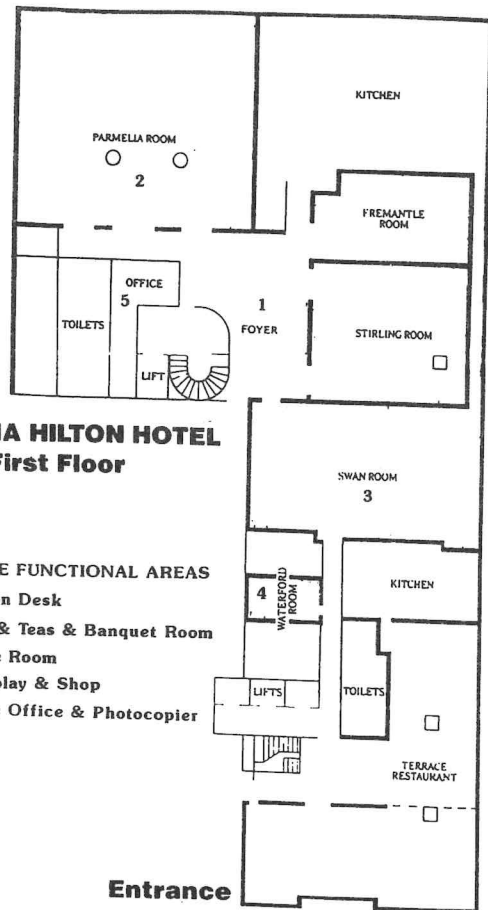

PARMELIA HILTON HOTEL First Floor

CONFERENCE FUNCTIONAL AREAS

1. Registration Desk
2. Luncheon & Teas & Banquet Room
3. Conference Room
4. Crafts Display & Shop
5. Conference Office & Photocopier

MILL STREET