

# RESERVE ACTION SHEET: STATE FOREST

**STATE FOREST No. 2**

**LOCAL GOVERNMENT:** Shire of Donnybrook-Balingup

**NAME:** Ludlow State Forest

**PURPOSE:** State Forest

**VESTING:** Conservation and Parks Commission

**ACTION**

Excision of Lot 4411 on Deposited Plan 213198 from State Forest No. 2.

**Total Area:** 877.59 to 875.41 hectares

**REASON FOR ACTION:**

Main Roads Western Australia requested the excision of 2.1712 hectares from State Forest No. 2 to rationalise the tenure of Bussell Highway. The Bussell Highway was constructed in 1995 and in 2005 Main Roads sought the excision of the constructed highway from State forest. In 2010 the Governor and Parliament approved the excision of portions of Bussell Highway from State Forest No. 2 and 12. Unfortunately Lot 4411 was not identified in 2005 and was not part of the package considered by Parliament in 2010.

An order was published in the Government Gazette on 10 February 2017 finalising the excision of Lot 4411 from State Forest No. 2. Main Roads will now undertake actions to formally dedicate Bussell Highway.

**Date of amendment:** 15/09/17

**Maps:** pp. 185, 194

**Customer advice:** N/A

**Proposal Summary:** see pp. 187

**IUCN classification:** N/A

**Recommended IUCN classification:**

**Native Title:**

1	<b>LAND UNIT LEADER</b>	To note	<i>bl</i> 15/11/2017
2	<b>LAND UNIT</b>	Send scan of RAS, Government Gazette order and maps to: <ul style="list-style-type: none"> <li>• Lisa Wright (Kensington) DIGITAL COPY</li> <li>• District Manager DIGITAL COPY</li> <li>• Regional Manager DIGITAL COPY</li> <li>• Geoffrey Banks GIS Branch DIGITAL COPY</li> </ul> Attach Landgate RED to file Strikethrough from District Proposals spreadsheets Create Conservation and Parks Commission summary	<i>[Signature]</i> 16/11/17 <i>[Signature]</i> 16/11/17 <i>[Signature]</i> 16/11/17 <i>[Signature]</i> 16/11/17 N/A <i>[Signature]</i> 16/11/17 <i>[Signature]</i> 16/11/17
3	<b>DIRECTOR, FOREST AND ECOSYSTEM MANAGEMENT</b>	To note	
4	<b>C.I.S.</b>	Please rename file/create new file Keyword: Activity: Subject: Free text:	

## — PART 2 —

---



---

### CONSERVATION

---



---

CO401

#### CONSERVATION AND LAND MANAGEMENT ACT 1984

#### CONSERVATION AND LAND MANAGEMENT (EXCISION FROM STATE FOREST) ORDER (NO. 4) 2017

Made by the Minister for Environment under section 9(3)(b) of the *Conservation and Land Management Act 1984*.

#### 1. Citation

This order may be cited as the *Conservation and Land Management (Excision from State Forest) Order (No. 4) 2017*.

#### 2. Commencement

This order comes into operation as follows—

- (a) clauses 1 and 2—on the day on which this order is published in the *Gazette*;
- (b) the rest of the order—on the day after that day.

#### 3. Portions of State Forest No. 2 excised

The area described in Schedule 1 is ordered to be excised from State Forest No. 2.

##### Schedule 1—Land no longer part of State Forest No. 2

All that portion of land situated about 8 kilometres east of Busselton and comprising of Lot 4411 on Deposited Plan 213198.

Area: 2.1712 hectares

On Landgate plan: Busselton (1930-I-NE).

#### 4. Purpose of excision

The area described in Schedule 1 is for the purpose of rationalising the tenure of Bussell Highway.

Hon STEPHEN DAWSON MLC, Minister for Environment.

---



---

### FIRE AND EMERGENCY SERVICES

---



---

FE401

#### FIRE AND EMERGENCY SERVICES SUPERANNUATION ACT 1985

##### APPOINTMENTS

The following have been appointed/elected to the Fire and Emergency Services Superannuation Board—

Member

Mr K. W. Jolly (Elected) 19 August 2017-18 August 2020

Alternate Member

Mrs T. E. Longman (Re-elected) 19 August 2017-18 August 2018

Mr P. R. Markovic (Elected) 19 August 2017-18 August 2018

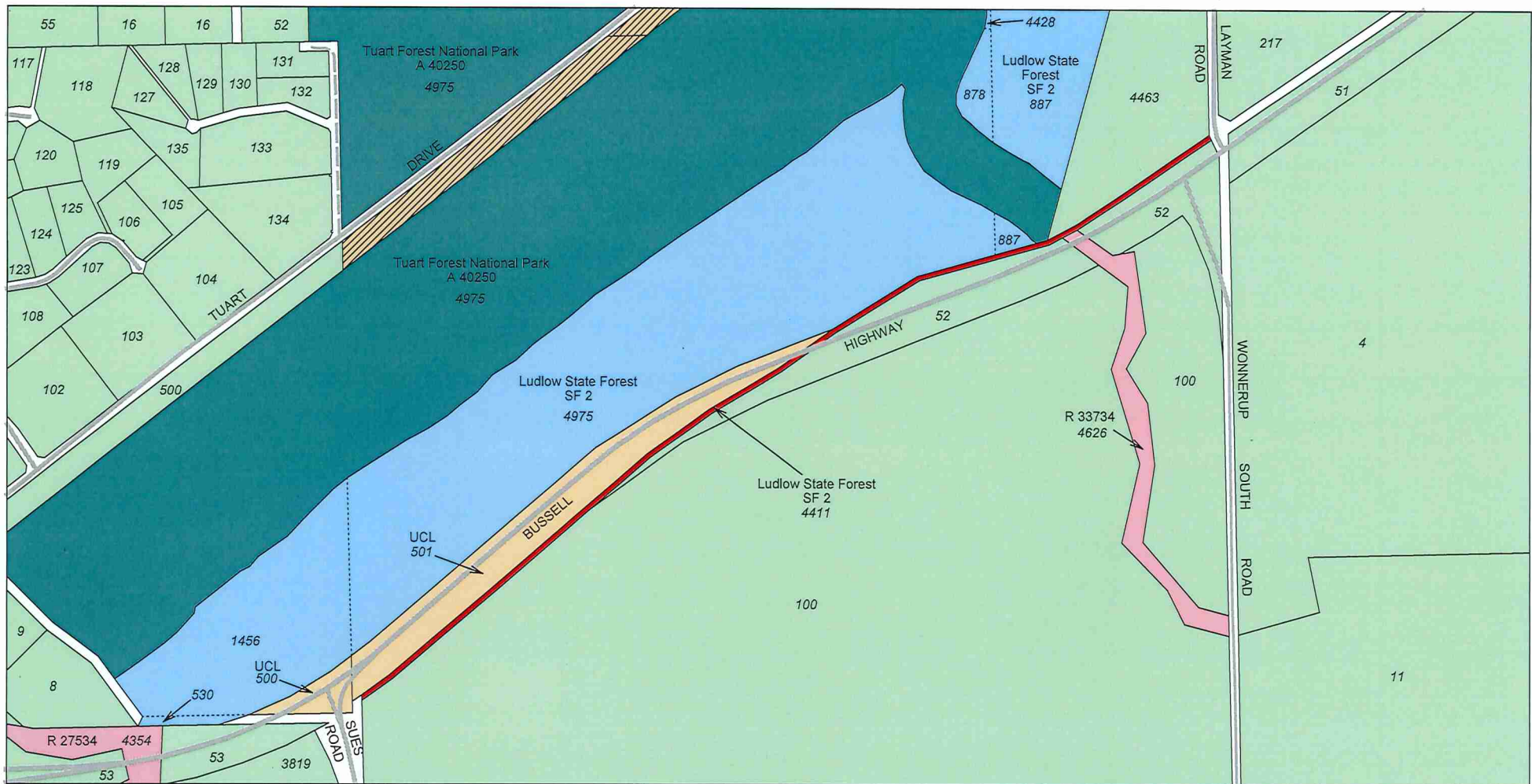

PROPOSED EXCISION FROM STATE FOREST No. 2

LEGEND

- |   |   |                           |   |
|---|---|---------------------------|---|
| 1. Area to be excised from State Forest No. 2       |  | 5. Unallocated Crown land |  |
| 2. National park adjoining area subject of excision |  | 6. Freehold land          |  |
| 3. State forest adjoining area subject of excision  |  | 7. Other public lands     |  |
| 4. Crown reserve                                    |  | 8. Public roads           |  |

SCALE 1 : 12 000

On Landgate plan: BUSSELTON (1930-I-NE)  
 On Department of Parks and Wildlife plan: 1930 - 1 & 4

