

**RESERVE GAZETTAL ACTION SHEET
FOR REGIONS AND DISTRICTS**

LANDS CLERK: Attach a copy of a map and forward to the following:

1. REGIONAL MANAGER:
CENTRAL FOREST, MIDWEST, GOLDFIELDS, KIMBERLEY, SWAN REGION,
PILBARA, SOUTH COAST, SOUTHERN FOREST, WHEATBELT
2. DISTRICT MANAGER: MUNPARING
3. DISTRICT WILDLIFE OFFICER: _____
4. CLERK WOODVALE
5. O.I.C. INVENTORY BUNBURY/KELMSCOTT/MANJIMUP

REASON FOR GAZETTAL:

Cancellation of Reserve as per
System 6 Recommendation C.28.

RESERVE NUMBER: 4623

CALM FILE NUMBER: 011229F3102.

NAME OF RESERVE: _____

PURPOSE: "Conservation of Flora and Fauna"

CLASS: 'c'

AREA: 460 ha

VESTING: N.P.N.C. A

DATE OF CURRENT GAZETTAL: 15.6.93

MAP REFERENCE: Baker Hill, Chidlow 1:25,000

SHIRE: _____

LANDS CLERK
09 367 0221
3390221

19 July 1993.
DATE

Copy filed 15/6/93 PVH.



DOLA

Department of LAND ADMINISTRATION

011229F3102

51
B.C

Your Ref: 011229F3102, 018732F3102, 018740F3102, 018755F3102
Our Ref: 3504/988, 3592/68, 3120/957, 544.72 KBE
Telephone: 323 1279
Enquiries: KEVIN EMROSE

COPIES ON OTHER
FILE NUMBERS.

Executive Director
DEPARTMENT OF CONSERVATION
AND LAND MANAGEMENT

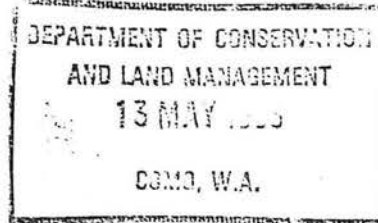

RESERVES NOS. 4623, 34772, 30681 AND 35291

I refer to your memorandum of 15 April, 1993 concerning the cancellation and consolidation of adjoining nature reserves and advise:-

- (i) Reserves 4623 and 14275; Executive Council action will be undertaken and you will be advised in the usual manner.
- (ii) & (iv) Reserves 34772, 29977, 35291 and 33254; Due to Class 'A' classification suitable Reserves Bill clauses will require preparation. Accordingly you will be advised periodically of progress.
- (iii) Reserves 30681 and 30667; no action will be taken until the proposed Beechina Nature Reserve, System 6 Recommendation M27 is progressed.

**R PUMPHREY
MANAGER
ACQUISITIONS, ROADS & RESERVES
LAND OPERATIONS DIVISION**

May 11, 1993

05SMLP08

*Re: 4623, pls cancel
13/5/93
12/5/93*

*14.5.93
Reserves Clerk*

*13/5/93
SC Reserves*





Department of LAND ADMINISTRATION

011229F3102

AND LAND MANAGEMENT

PO BOX 104

COMO, W.A.

Your Ref: 011409F3102, 01129F3102, 02113F3103
ORIGINAL *021123F3102 (copy)*

Our Ref: 3365/989, 3504/988V3, 3781/897 DC:NM

Telephone: 323 1614
Enquiries: D. CHAN

EXECUTIVE DIRECTOR
DEPARTMENT OF CONSERVATION
AND LAND MANAGEMENT
PO BOX 104
COMO 6152

I advise for your information that Executive Council has:-

1. Approved of Reserve No. 26238 (Preston Agricultural Area) to comprise Preston Agricultural Area Lot 397 in lieu of Lot 251 and of its area being increased accordingly.
2. Approved of the amendment of Reserve No. 14275 ("Conservation of Flora and Fauna" (Avon Locations 29051, 29052 and 29053) to include Location 29046 and of its area being increased accordingly.
3. Approved of the cancellation of Reserve No. 4623 (Avon Location 29046) "Conservation of Flora and Fauna".

Notice to this effect was published in the Government Gazette dated 15 June, 1993 and I enclose a print showing the said reserve.

[Signature]
R. PUMPHREY
MANAGER
ACQUISITIONS, ROADS AND RESERVES
LAND OPERATIONS DIVISION

June 24, 1993

Enc

06NMLP73

MRK 12.7.92

09.07.93

Lands Clerk & p. 52

52
DL

LB201

**LAND ACT 1933
CANCELLATION OF RESERVES**

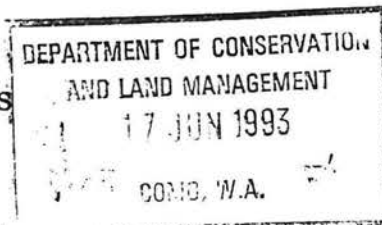

Made by His Excellency the Governor under Section 37.

The following reserves have been cancelled.

DOLA File: 3709/897V2.

Reserve No. 5198 (Coolgardie Town Lot 1182) "Wesleyan Church".

Public Plan: CF37 (2) 09.11. Hunt Street.

Local Authority—Shire of Coolgardie.

DOLA File: 2725/992.

Reserve No. 42430 (Kalannie Lot 85) "Use and Requirements of the Minister for Works".

Public Plan: Kalannie Townsite Prior Street.

Local Authority—Shire of Dalwallinu.

DOLA File: 2386/966.

Reserve No. 28233 (Yilgarn Location 1442) "Government Requirements".

Public Plan: Highclere (50).

Local Authority—Shire of Westonia.

DOLA File: 1992/933.

Reserve No. 28004 (Yilgarn Locations 707 and 1332) "Conservation of Flora and Fauna".

Public Plan: Highclere (50) near Koorda—Southern Cross Road.

Local Authority—Shire of Yilgarn.

DOLA File: 1295/934.

Reserve No. 21340 (Plantagenet Location 4836) "Camping".

Public Plan: Chester Pass NE (25) Smith Road.

Local Authority—Shire of Gnowangerup.

DOLA File: 3781/897.

Reserve No. 4623 (Avon Location 29046) "Conservation of Flora and Fauna".

Public Plans: BH35 (10) 2.2 and BH35 (2) 07.06 Coates Road.

Local Authority—Shire of Northam.

A. A. SKINNER, Chief Executive.

LB701

File No. 1464/1990.
Ex.Co. No. 0872.

**LOCAL GOVERNMENT ACT 1960
PUBLIC WORKS ACT 1902
LAND RESUMPTION**

Road Extension—Kendrew Crescent—Joondalup—City of Wanneroo

Notice is hereby given, and it is hereby declared, that pursuant to a resolution of the City of Wanneroo passed at a meeting of the Council held on or about December 1992 the several pieces or parcels of land described in the Schedule hereto, being all in the Swan District have, in pursuance of the written approval and consent of His Excellency the Governor, acting by and with the advice of the Executive Council, dated the 8th day of June 1993, been set apart, taken or resumed for the purpose of the following public work, namely: Road Extension—Kendrew Crescent—Joondalup—City of Wanneroo.

And further notice is hereby given that the said pieces or parcels of land so set apart, taken, or resumed are marked off and more particularly described on Department of Land Administration Diagram 91159 which may be inspected at the Department of Land Administration, Perth. The additional information contained in the Schedule after the land descriptions is to define locality only and in no way derogates from the Transfer of Land Act description. And it is hereby directed that the said lands shall vest in Her Majesty for the public work herein expressed, freed and discharged from all trusts, mortgages, charges, obligations, estates, interests, rights-of-way or other easements whatsoever.

18-10-93
Lands Clerk, MRR

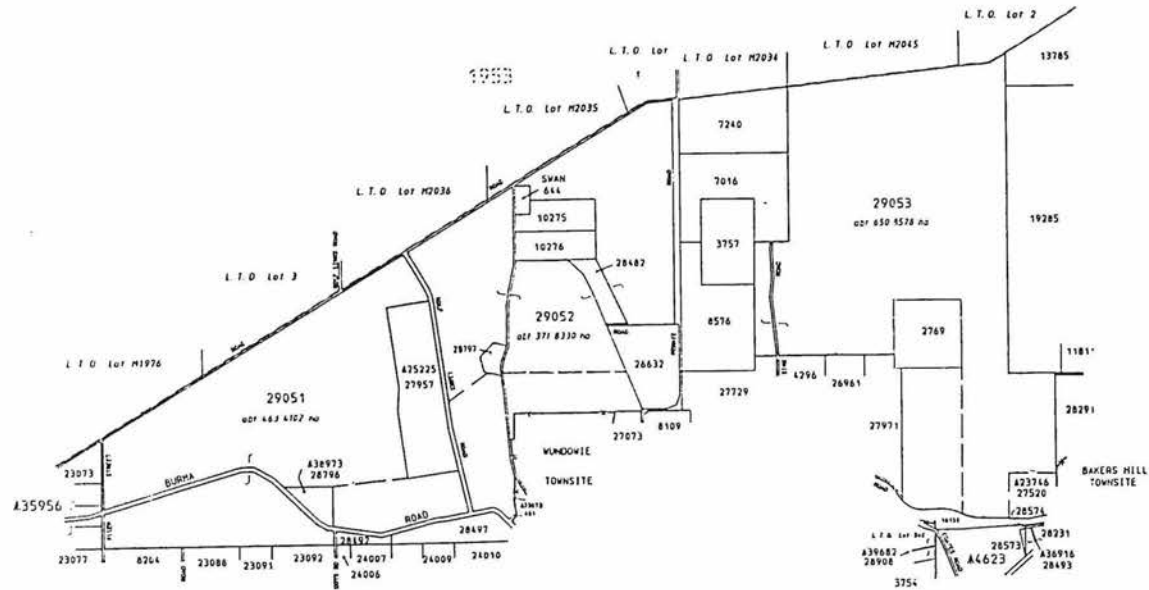

Graphics and "abt." areas are derived from the D. O. L. A. Spatial Cadastral Data Base



RESERVE 14275 Total Area : abt. 1486.1010 ha (Subject to E.P.A. Recommendation 6. C2B)		FILE No. 3504/988 vol. 3
DISTRICT. AVON		SCALE 1:25000
SUBJECT TO SURVEY		REGISTERED BY PUBLIC PLAN
AMENDMENTS		REGISTERED BY
DATE 12/1/88		DEPT OF LAND ADMINISTRATION
MISCELLANEOUS		MISCELLANEOUS

DEPT. OF LAND ADMINISTRATION
MISCELLANEOUS
PLAN No. 1707