

NATURE RESERVE

RESERVE NO: 7128

GOVERNMENT GAZETTE
Date Page No.

FILE NUMBER: 2018/00 FWD 642/83

PURPOSE: WATER & CONS. OF FLORA AND FAUNA 10/6/83 1789

NAME:

CLASS (Land Act):

AREA: 40.4686 ha

VESTING: MIN. WATER RESOURCES 10/6/83 1773

LOCATION NO(S): KOJONUP LOC. 122

CLASSIFICATION:
(Wildlife Act
Section 12A)

LITHO: CARLECATUP SW 1:25 000

LOCAL AUTHORITY: SHIREOF BROOMEHILL

Notes:

RESERVE ACTION SHEET: CONSERVATION RESERVES

RESERVE No. 7128

LOCAL GOVERNMENT: Shire of Broomehill-Tambellup

NAME: Ngopitchup Nature Reserve

PURPOSE: Water and Conservation of Flora and Fauna

VESTING: Conservation Commission

ACTION

Transfer of Reserve 7128 to the Conservation Commission of Western Australia.

Total Area: 40.4686ha

REASON FOR ACTION

The Department of Water has undertaken a review of all their water reserves and are seeking to rationalisation their management responsibilities. As part of this process Reserves 7128 and 2184 were identified as surplus to their department's requirements.

DEC expressed an interest in accepting management of Reserve 7128 and 2184 for addition to the conservation estate. Reserve 2184 contains a unique swamp system, known as Ngopitchup Swamp. Reserve 2184 is linked to Reserve 7128 by a vegetated road reserve. These two reserves are the largest vegetated reserves in the surrounding area.

On the 2 August 2011 Reserve 7128's management was transferred to the Conservation Commission.

Date of amendment: 2/8/2011

Maps: 42

Customer advice: 45

Proposal Summary: 15

IUCN classification:

1	LAND UNIT LEADER	To note	<i>Ed 19/2/2013</i>
2	LAND UNIT	Send copies of advice and maps to: <ul style="list-style-type: none"> • Lisa Wright (Kensington) DIGITAL COPY • District Manager DIGITAL COPY • Regional Manager DIGITAL COPY Attach TENIS gazettal history to file Delete from District Proposals spreadsheets Create Conservation Commission summary	<i>NM 19/2/13</i> <i>NM 19/2/13</i> <i>NM 19/2/13</i>
3	DIRECTOR, NATURE CONSERVATION	To note	
4	C.I.S.	Please rename file/create new file Keyword: Activity: Subject: Free text:	

(GREAT SOUTHERN DISTRICT)
WHEATBELT REGION

Customer Advices for Reserve Actions
1/09/2011 - 30/09/2011

(DEC FILE 2011/006637-1)

Shire of Broomehill-Tambellup 1/09/2011 - 30/09/2011

Reserve No.	Land Description	DPI File No.	Volume/Folio	Action	Document No.	Registered	Street Name	Area	Public Plans
7128	Lot 122 on Deposited Plan 245600	02018-1900-01RO	3061-897 3061-897	Management Order to Conservation Commission of Western Australia, Locked Bag 104, Bentley Delivery Centre, WA 9983 for the designated purpose of "Water & Conservation of Flora & Fauna"	L697335	02/08/2011	Nygopitchup Road	40.4686 Ha	CARTEL CATUP SW 1:25000
7128	Lot 122 on Deposited Plan 245600	02018-1900-01RO	3061-897 3061-897		L697334	02/08/2011	Nygopitchup Road	40.4686 Ha	CARTEL CATUP SW 1:25000

NEW: NATURE RESERVE (+ 40.4686ha)

FORMER "DOW" LAND

PURPOSE - WATER & CONSERVATION OF FLORA & FAUNA

TO: NICOLA MINCHAM,

ALL DATABASES INCLUDING

TENIS AMENDED. RELEVANT DOCUMENTS
ATTACHED TO THIS FILE.

R Dania
11/1/12

WHITE FOLDER - 11/1/12

SHAPEFILE - 22/12/11

TENIS - 22/12/11

MAPINFO - 11/1/12

PROPOSED

TENURE - N/A

Schedule

File No.; Reserve No.; Land Description; Area Hectares; Plan.

- 2766/89; 798; Plantagenet Locations 5070, 5071 and 4420; 50.5073; Mt Barker, S.W. 1:25 000.
- 799/18; 4070; Swan Location 2302; 17.4138; Jumperkine, N.W. 1:25 000.
- 10120/05; 9920; Kojonup Location 3824; 12.5251; Woodanilling, S.W. 1:25 000.
- 2799/17; 16901; Kojonup Location 9256; 17.3313; Martinup, S.E. 1:25 000.
- 2884/17; 16907; Murray Locations 1285, 1294 and 1558; 113.0597; Pinjarra, S.W. 1:25 000.
- 1272/63; 33192; Nelson Location 13134; 18.0605; 442B/40.
- 2452/74; 34772; Meenaar Lot 71; 29.5585; Meenaar Townsite.
- 2015/82; 38303; Pootenup Lots 54 and 56; 47.0300; Pootenup Townsite.

Given under my hand and the Public Seal of Western Australia, at Perth, this 8th day of August 1989.

By His Excellency's Command,
E. K. HALLAHAN,
Minister for Lands.

GOD SAVE THE QUEEN !

Land Act 1933

PROCLAMATION

WESTERN AUSTRALIA } His Excellency the Honourable Sir Francis FRANCIS BURT, } Theodore Page Burt, Companion of the Order of Australia, Knight Commander of the Most Distinguished Order of Saint Michael and Saint George, Queen's Counsel, Lieutenant-Governor and Administrator of the State of Western Australia. [L.S.]

File No. 1900/984.

WHEREAS by section 31 (1) (a) of the Land Act 1933, the Governor may by Proclamation and subject to such conditions as may be expressed therein classify as of Class "A" any such lands of the Crown reserved to Her Majesty for any purpose and whereas it is deemed expedient that the Reserves listed on the attached schedule for the designated purpose of "Water and Conservation of Flora and Fauna" as described, should be classified as of Class "A": Now, therefore, I, the Lieutenant-Governor and Administrator, with the advice and consent of Executive Council do by this my Proclamation classify as of Class "A" the reserves described in the schedule.

Schedule

File No.; Reserve No.; Land Description; Area (Hectares); Plan.

- 2747/83; 641; Victoria Location 7252.; 40.4200;192/80.
- 2018/00; 7128; Kojonup Location 122.; 40.4686; Carlecatup S.W. 1:25 000.
- 12033/03; 10753; Avon Location 5513.; 54.2279; Mears S.W. 1:25 000.
- 6001/07; 11717; Jennaberring Agricultural Area Lot 31.; 36.4217; Pantapin S.W. 1:25 000.
- 3576/04; 11776; Avon Location 6097.; 40.4686; Youndequin N.E. 1:25 000.
- 12235/09; 12712; Avon Locations 10102, 21305 and 21628.; 45.3097; Babakin N.E. 1:25 000.
- 18280/10; 15702; Avon Locations 6418 and 17381.; 301.4908; Mt. Dillon N.W. 1:25 000.
- 13061/08; 15794; Avon Location 20683.; 40.4686; Cadoux N.E. 1:25 000.
- 54/16; 16479; Williams Location 8999.; 77.1837; Sewell S.E. 1:25 000.
- 164/17; 16896; Pintharuka Lot 33.; 4.2567; Pintharuka Townsite.
- 306/21; 17648; Roe Locations 30 and 1005.; 348.0297; Burngup 1:50 000.
- 4702/24; 18735; Roe Location 821.; 121.4057; Lake O'Connor 1:50 000.
- 1899/82; 18773; Jilbadji Location 241.; 450.8198; Moorine Rock 1:50 000.
- 52/26; 19327; Avon Location 23857.; 6.0703; Pikaring S.W. 1:25 000.

- 2821/33; 21180; Ningham Location 4247.; 89.1428; Wialki 1:50 000.
- 6208/51; 23339; Yilgarn Location 1233; 465.9905; Walyahmoning 1:50 000.
- 1922/36; 24465; Yilgarn Locations 1166 and 14043.; 531.7443; Walyahmoning 1:50 000.
- 1548/58; 25126; Yilgarn Location 365; 79.8850; Coorancooping 1:50 000.
- 4157/67; 29249; Roe Locations 223 and 2963.; 317.1124; Mt. Walker and Borayukkin 1:50 000.
- 3252/78; 36448; Ninghan Location 4223.; 12.0883; 89/80.
- 1472/84; 38796; Victoria Location abt 11544.; 32.6500; 156/80.
- 2023/85; 39186; Ninghan Location 3000.; 102.6308; Mollerin 1:50 000.
- 1180/84; 39621; Kojonup Location 9267.;369.2109; Lake Clabburn N.E. 1:25 000.

Given under my hand and the Public Seal of Western Australia, at Perth, this 8th day of August, 1989.

By His Excellency's Command,
E. K. HALLAHAN,
Minister for Lands.

GOD SAVE THE QUEEN !

Residential Tenancies Act 1987

PROCLAMATION

WESTERN AUSTRALIA } His Excellency the Honourable Sir Francis FRANCIS BURT, } Theodore Page Burt, Companion of the Order of Australia, Knight Commander of the Most Distinguished Order of Saint Michael and Saint George, Queen's Counsel, Lieutenant-Governor and Administrator of the State of Western Australia. [L.S.]

UNDER section 2 of the Residential Tenancies Act 1987, I, the Lieutenant-Governor and Administrator, acting with the advice and consent of the Executive Council, do hereby fix 1 October 1989 as the day on which the Residential Tenancies Act 1987 shall come into operation.

Given under my hand and the Seal of the State on 8th August 1989.

By His Excellency's Command,
YVONNE HENDERSON,
Minister for Consumer Affairs.

GOD SAVE THE QUEEN !

AT a meeting of the Executive Council held in the Executive Council Chambers, at Perth, on 8 August 1989 the following Orders in Council were authorised to be issued.

Child Welfare Act 1947

ORDER IN COUNCIL

WHEREAS by section 19(2)(a) of the Child Welfare Act 1947, it is provided that the Lieutenant-Governor and Administrator may appoint such persons, male or female, as he may think fit, to be members of any particular Children's Court and may determine the respective seniorities of such members and whereas by section 19(1)(b)(ii) of the said Act, the Lieutenant-Governor and Administrator may amend, vary or revoke any such appointment: Now therefore His Excellency the Lieutenant-Governor and Administrator do with the advice and consent of the Executive Council doth hereby appoint the person named in the First Schedule hereto to be a member of the Children's Court at the place mentioned and doth hereby revoke the appointment of the person named in the Second Schedule hereto to be a member of the Children's Court at the place mentioned.

First Schedule

Kununurra—Dennis Barr O'Brien.

Second Schedule

Kununurra—Arthur Donald Gray.

G. PEARCE,
Clerk of the Council.

4

1. A. 1. e

2. LANDS CLERK

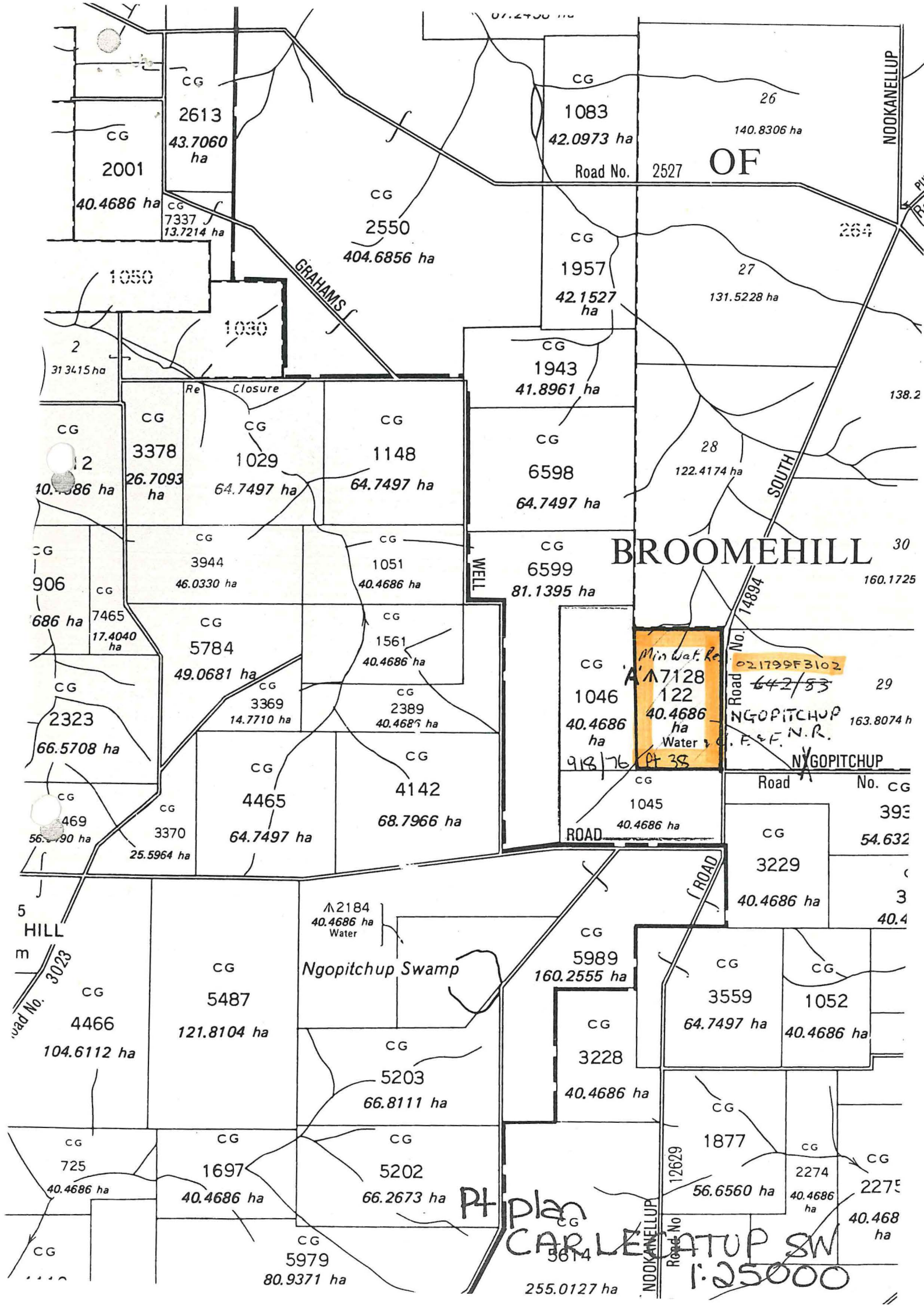

CG
2613
43.7060 ha
CG
2001
40.4686 ha
CG
7337
13.7214 ha

CG
1083
42.0973 ha
Road No. 2527

26
140.8306 ha
OF

CG
2550
404.6856 ha

CG
1957
42.1527 ha

27
131.5228 ha

264

1050

1030

2
313.15 ha

CG
1943
41.8961 ha

138.2

CG
12
10.4386 ha

CG
3378
26.7093 ha

Re Closure
CG
1029
64.7497 ha

CG
1148
64.7497 ha

CG
6598
64.7497 ha

28
122.4174 ha

SOUTH

BROOMEHILL

30
160.1725

CG
906
686 ha

CG
7465
17.4040 ha

CG
3944
46.0330 ha

CG
1051
40.4686 ha

CG
6599
81.1395 ha

CG
1046
40.4686 ha
CG
122
40.4686 ha
Water

Road No. 14894
CG
29
163.8074 ha
NGOPITCHUP
C. F. & F. N. R.
NYGOPITCHUP

CG
2323
66.5708 ha

CG
5784
49.0681 ha

CG
1561
40.4686 ha

CG
2389
40.4686 ha

CG
469
56.490 ha

CG
3370
25.5964 ha

CG
4465
64.7497 ha

CG
4142
68.7966 ha

CG
1045
40.4686 ha

Road No. CG
393
54.632

5 HILL
Road No. 3023
CG
4466
104.6112 ha

CG
5487
121.8104 ha

2184
40.4686 ha
Water
Ngopitchup Swamp

CG
5989
160.2555 ha

CG
3559
64.7497 ha

CG
1052
40.4686 ha

CG
725
40.4686 ha

CG
1697
40.4686 ha

CG
5203
66.8111 ha

CG
3228
40.4686 ha

CG
1877
56.6560 ha

CG
2274
40.4686 ha

CG

CG
5979
80.9371 ha

CG
5202
66.2673 ha

CG
3614
255.0127 ha

CG
2275
40.468 ha

Pt plan CARLEATUP SW
1:25000

