

NATURE RESERVE

RESERVE NO: 8937

GOVERNMENT GAZETTE
Date Page No.

FILE NUMBER: 1163/02 F & W 581/83

PURPOSE: Cons. of Flora & Fauna

1.7.83 2104

NAME:

CLASS (Land Act):

AREA: 34.82 ha

VESTING: W.A.W.A.

1.7.83 2084

LOCATION NO(S): Victoria Loc. 9428

CLASSIFICATION:
(Wildlife Act
Section 12A)

LITHO:Plan 157 A/40

LOCAL AUTHORITY: Shire of Northampton

Notes:

RESERVE ACTION SHEET: CONSERVATION RESERVES

RESERVE NO. 8937

REASON FOR ACTION area of reserve increased by addition of adjoining Crown land (see pp. 97-8)

OFFICER	ACTION	ACTION TAKEN	DATE
LANDS CLERK	Fill in above details	✓	RP 23.9.87
	Attach copies of gazettal notices to file (folios: 91-2)	✓	RP 23.9.87
	Enter relevant details on file cover	✓	RP 23.9.87
OFFICER IN CHARGE - RECORDS	For new reserves: Index Reserve's name	✓	OK
	Index Reserve's number	✓	OK
SENIOR DRAFTSPERSON, LEGAL MAPPING	Amend Litho (see p. 97)	R.D.	30/9/87
	Attach copy of litho to file (mark litho name/number) (Pg 100)	R.D.	30/9/87
LANDS CLERK	Send copies of gazettal notices (or Lands Dept. memo) and map to :		
	Clerk, Woodvale	CF	12.11.87
	Regional Manager		
	District Manager		
	District Wildlife Officer		
Admin. Assistant, Murdoch House			
	Note: Information sent must include: (a) Dept's file number (b) Litho number/name		
SENIOR CLERK RESERVES	To note	RP	23.9.87
MANAGER, WILDLIFE AND LAND ADMIN.	To note		
DIRECTOR NATURE CONSERVATION/ NATIONAL PARKS	No note		

18 AUG 1987
14 August 1987

COMO, W.A.

021769F3102

AMENDMENT OF RESERVES

Department of Land Administration,
Perth, 14 August 1987.

HIS Excellency the Governor in Executive Council has been pleased to approve, under section 37 of the Land Act 1933 of the amendment of the following Reserves—

File No. 3543/981.—No. 7580 (Oldfield District) "Rabbit Department" to exclude that portion now comprised in Oldfield Location 1445, as surveyed and shown on Original Plan 16663, and of its area being reduced to about 1605.084 4 hectares accordingly. (Plan: Starvation Boat Harbour 1:50 000 (Southern Ocean East Road).)

File No. 1163/02.—No. 8937 (Victoria District) "Conservation of Flora and Fauna" to comprise Victoria Location 11553 as surveyed and shown bordered red on Diagram 86422 in lieu of Victoria Location 9428 and of its area being increased to 33.520 3 hectares accordingly. (Plan 157 A/40 (North West Coastal Highway in the Shire of Northampton).)

File No. 10333/906.—No. 23889 (at Meekatharra) "Hospital Site" to comprise Meekatharra Lot 740, as surveyed and shown on Land Administration Diagram No. 87868, and of its area being reduced to 3.283 5 hectares accordingly. (Plan: Meekatharra 1:2 000 Sheets 1 and 3 (High Street).)

File No. 3209/966.—No. 29496 (at Meekatharra) "School Site" comprise Meekatharra Lot 874, as surveyed and shown on Land Administration Diagram No. 87868, in lieu of Lots 744 and 829 and of its area being increased to 5.088 4 hectares accordingly. (Plan: Meekatharra 1:2 000 Sheets 1 and 3 (Gascoyne Junction Road).)

File No. 115/969.—No. 30633 (Roe Location 2947) "Recreation" to include Roe Location 2958 and of its area being increased to 12.517 5 hectares accordingly. (Plan: Swallow Rock 1:50 000 (Beatty Road Shire of Ravensthorpe).)

File No. 3294/969.—No. 30649 (at Karratha) "Rubbish Disposal Site" to comprise Karratha Lots 1078 and 3920, as surveyed and shown red on Original Plan 16652, and of its area being increased to 50.621 5 hectares accordingly. (Plans: Karratha Regional 7.5 and 7.6 and 1:2 000 32.25 (Robins Road).)

File No. 1353/987.—No. 34227 (Wellington District) "Public Recreation" to comprise Wellington Location 5217 as surveyed and shown on Land Administration Diagram 87943 and of its area being reduced to 4.240 2 hectares accordingly. (Plan: Bunbury and Environs 1:2 000 05.33 (Charterhouse Street Bunbury).)

File No. 819/979.—No. 36325 (at Boyanup Brook) "Tourist Information Bay" to comprise Boyanup Brook Lot 359 as surveyed and shown on Original Plan 15757, in lieu of Lots 351 and 352, and of its area being increased to 8 402 square metres accordingly. (Plan: Boyanup Brook 1:2 000 05.17 (Abel Street).)

File No. 445/987.—No. 39875 (Cockburn Sound Location 2890) "Public Recreation and Drainage" to include Cockburn Sound Locations 2781 and 2783 and of its area being increased to 3 011 square metres accordingly. (Plan: Perth 1:2 000 12.08 (Allamanda Drive).)

N. J. SMYTH,
Executive Director.

CANCELLATION OF RESERVES

Department of Land Administration,
Perth, 14 August 1987.

HIS Excellency the Governor in Executive Council has been pleased to approve, under section 37 of the Land Act 1933 of the cancellation of the following Reserves—

File No. 369/94.—No. 8701 (Cue Lots 369, 376, 387, 393, 410, 411 and 412) "Excepted from Sale" (Plan Cue 1:2 000 15.07, 16.07).

File No. 2390/14.—No. 16419 (Beverley Lot 280) "Government Requirements". (Plan Beverley 1:2 000 36.08).

File No. 2345/93.—No. 22794 (Yardarino Agricultural Area Lot 20) "Racecourse". (Plan Yardarino SW 1:25 000 (Midlands Road).)

File No. 115/969.—No. 31605 (Roe Location 2958) "School Site". (Plan Swallow Rock 1:50 000 (Beatty Road, Shire of Ravensthorpe).)

1/ File placed

File No. 641/984.—No. 38804 (Cockburn Sound Location 2781) "Drain". (Plan Perth 1:2 000 12.08 (Allamanda Drive).)

File No. 694/984.—No. 38840 (Cockburn Sound Location 2783) "Public Recreation". (Plan Perth 1:2 000 12.08 (Allamanda Drive).)

File No. 615/985.—No. 39614 (Kalgoorlie Lot 4234) "Use and Requirements of the Government Employees Housing Authority". (Plan Kalgoorlie Boulder and Environs 1:2 000 28.38).

File No. 4151/11D.—No. 39733 (Leonora Lot 463) "Use and Requirements of the Shire of Leonora" (Plan Leonora Townsite Sheet 2 (Stuart Street).)

File No. 4303/21 V2.—No. 39829 (Swan Location 10634) "Use and Requirements of The State Energy Commission of Western Australia" (Plan Perth 2 000 20.33).

N. J. SMYTH,
Executive Director.

CHANGE OF PURPOSE OF RESERVES

Department of Land Administration,
Perth, 14 August 1987.

HIS Excellency the Governor in Executive Council has been pleased to approve, under section 37 of the Land Act 1933, of the change of purpose of the following Reserves—

File No. 1866/962.—No. 26384 (Bremer Bay Lot 649) being changed from "Hall Site (Shire of Gnowangerup)" to "Hall Site". (Public Plan Bremer Bay 1:2 000 17.32 and Pt 18.32 (Mary Street).)

File No. 3276/64.—No. 28044 (Swan Location 7994) being changed from "Water Tower Site (Metropolitan Water Supply Sewerage and Drainage Board)" to "Water Tower Site". (Public Plan: Perth 1:2 000 08.29).

File No. 3390/960.—No. 36134 (Canning Location 3119) being changed from "Government Requirements" to "Recreation". (Public Plan: Perth 1:2 000 17.21 (Briggs Street, Carlisle).)

File No. 819/979.—No. 36325 (Boyanup Brook Lot 359) being changed from "Tourist Information Bay" to "Tourist Information Bay, Drainage and Park". (Public Plan: Boyanup Brook 1:2 000 05.17 (Abel Street).)

N. J. SMYTH,
Executive Director.

CUBALLING TOWNSITE

Amendment and Redescription of Boundaries

Department of Land Administration,
Perth, 14 August 1987.

File No. 1078/897 V2.

HIS Excellency the Governor in Executive Council has been pleased to approve, under section 10 of the Land Act 1933, of the amendment and redescription of the boundaries of Cuballing Townsite as described in the Schedule hereunder.

Schedule

All that portion of land bounded by lines starting from the northwestern corner of Cuballing Lot 241 and extending easterly along the northern boundary of that lot to the southwestern corner of Williams Location 1917; thence easterly along the southern boundary of that Location and onwards to the southwestern corner of Location 1222; thence easterly along the southern boundary of that Location and easterly along the southern boundary of Location 1152 and onwards to a western side of Railway Street; thence generally northerly along sides of that Street to a line in prolongation westerly of the southern boundary of Location 2674; thence easterly to and easterly along that boundary to the western side of Hotham Street; thence southerly along that side and onwards to a northern boundary of Location 13452; thence westerly, southwesterly, northwesterly and again westerly along boundaries of that Location and onwards to a southeastern boundary of Cuballing Lot 244; thence generally southwesterly, westerly, generally north-easterly and general northerly along boundaries of that lot to a line in prolongation easterly of the northern boundary of

2/ LANDS Clerk TA.

- 11001 a ne you
1: 10 000
19.4.89
1. LAND TENURE CLERK
 2. ASST RESERVES CLERK
 3. SENIOR CLERK RESERVES
 4. MAN. W & L
 5. TIMBER PRODUCTION
 6. REGISTRAR 9. SC FAUNA
 7. SC FLORA
 8. CHIEF CLERK 10 ASST RESERV

p 1089-1093, 1108-9, 1119.

1089



Government Gazette

OF

WESTERN AUSTRALIA

(Published by Authority at 3.30 pm)

Department of Conservation
and Land Management
21 APR 1989
COMO, W.A.

No. 36]

PERTH: FRIDAY, 14 APRIL

[1989

Land Act 1933		Schedule				
PROCLAMATION		File Number	Reserve Number	Land Description	Area (Hectares)	Plan
WESTERN AUSTRALIA GORDON REID, Governor. [L.S.]	} By His Excellency Professor Gordon Reid, Companion of the Order of Australia, Governor of the State of Western Australia.	3354/60	2517	Uduc Agricultural Area Lot 54	41.131 2	Harvey Regional 1:10 000 3.4
		2207/894	2547	Uduc Agricultural Area Lot 43	10.117 1	Harvey Regional 1:10 000 3.5
		3718/898	5644	Throssell Estate Lots 14 and 87	41.424 6	Grass Valley S.E. 1:25 000
		1163/02	8937	Victoria Location 11746	32.941 9	157A/40
		13668/03	9159	Plantagenet Location 7606	37.915 1	Chester Pass N.W. 1:25 000
		10234/06	10584	Avon Location 28879	20.689 5	Quajabin N.E. 1:25 000
		4585/09	12154	Avon Locations 9318, 9319 and 28284	about 61.107 5	Koorda S.W. 1:25 000
		8531/08	12329	Avon Locations 9309, 12182, 12208 and 16470	about 160.176 1	Kodj Kodjin
		8000/11	14114	Minnivale Lots 65, 87 and 106	about 150.346 0	Minnivale Townsite 1:2 500 9.28, 9.29, 10.28 and 10.29
		7039/12	14920	Avon Location 28910	131.212 0	Wyalkatchem S.W. 1:25 000
		9821/12	16245	Avon Locations 17996, 20984 and 28825	272.854 4	Koorda N.E. and Lake Wallimbin N.W. 1:25 000
		2520/21	17710	Avon Location 28504	107.157 3	Dowerin 1:50 000
		4042/53	2096	Tenterden Agricultural Area Lot 41	80.596 1	Geekabee N.E. 1:25 000

Notice to Subscribers

As *Government Gazette* (No. 35) pages 1085 to 1088 contained only a determination of restricted publications and as the issue is not covered by the Annual Subscription it was not issued to subscribers in the usual manner. Copies may be purchased from—

Publication Sales,
Ground Floor, Alexander Library Building,
Perth Cultural Centre.

GARRY L. DUFFIELD,
Government Printer.

11 April 1989.

214/89
2. Lands

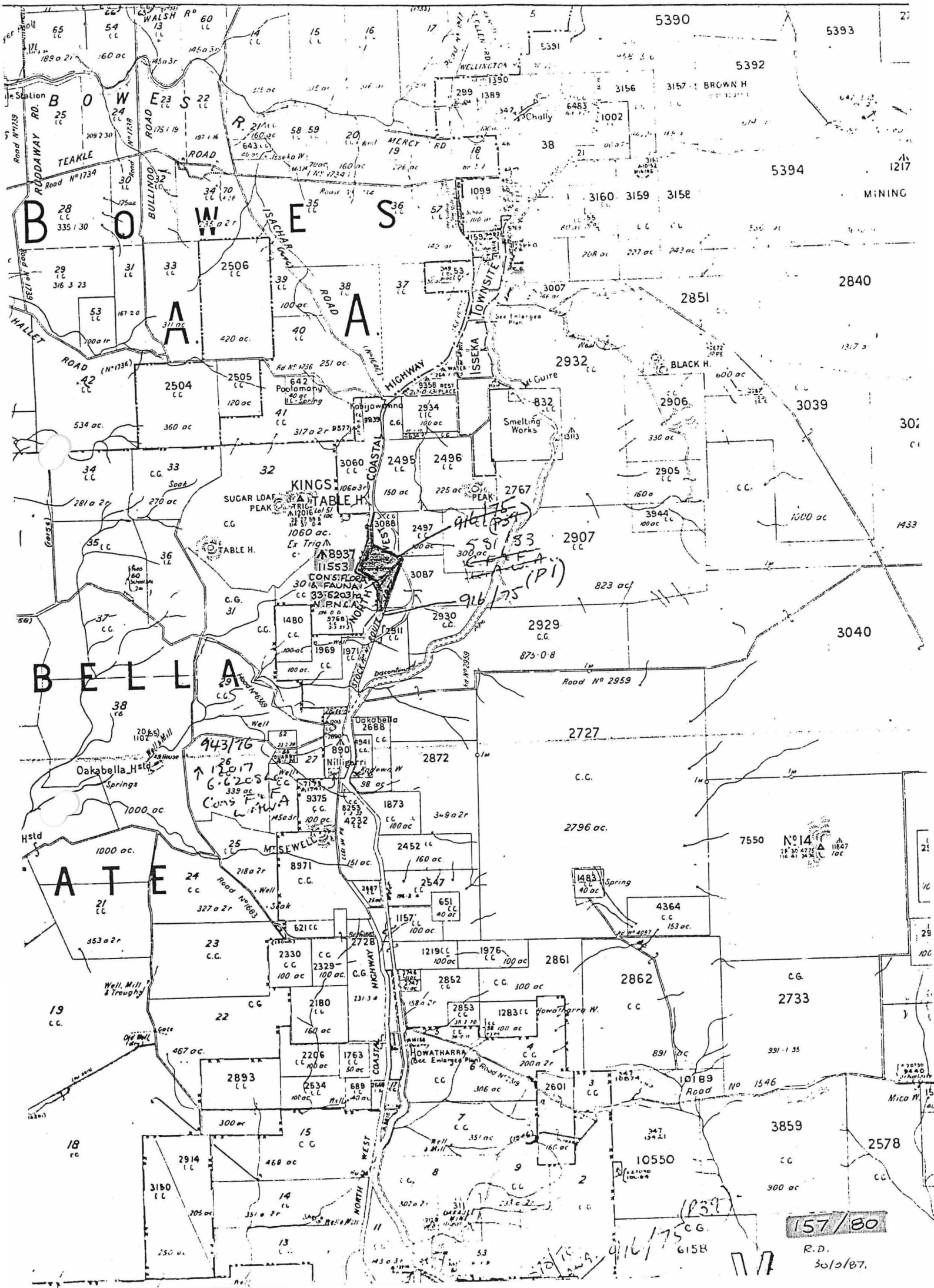

157/80

R.D. 30/10/87.

916/75 (PI)
551/83
126/17
6.62cs
COMS FWA
943/76

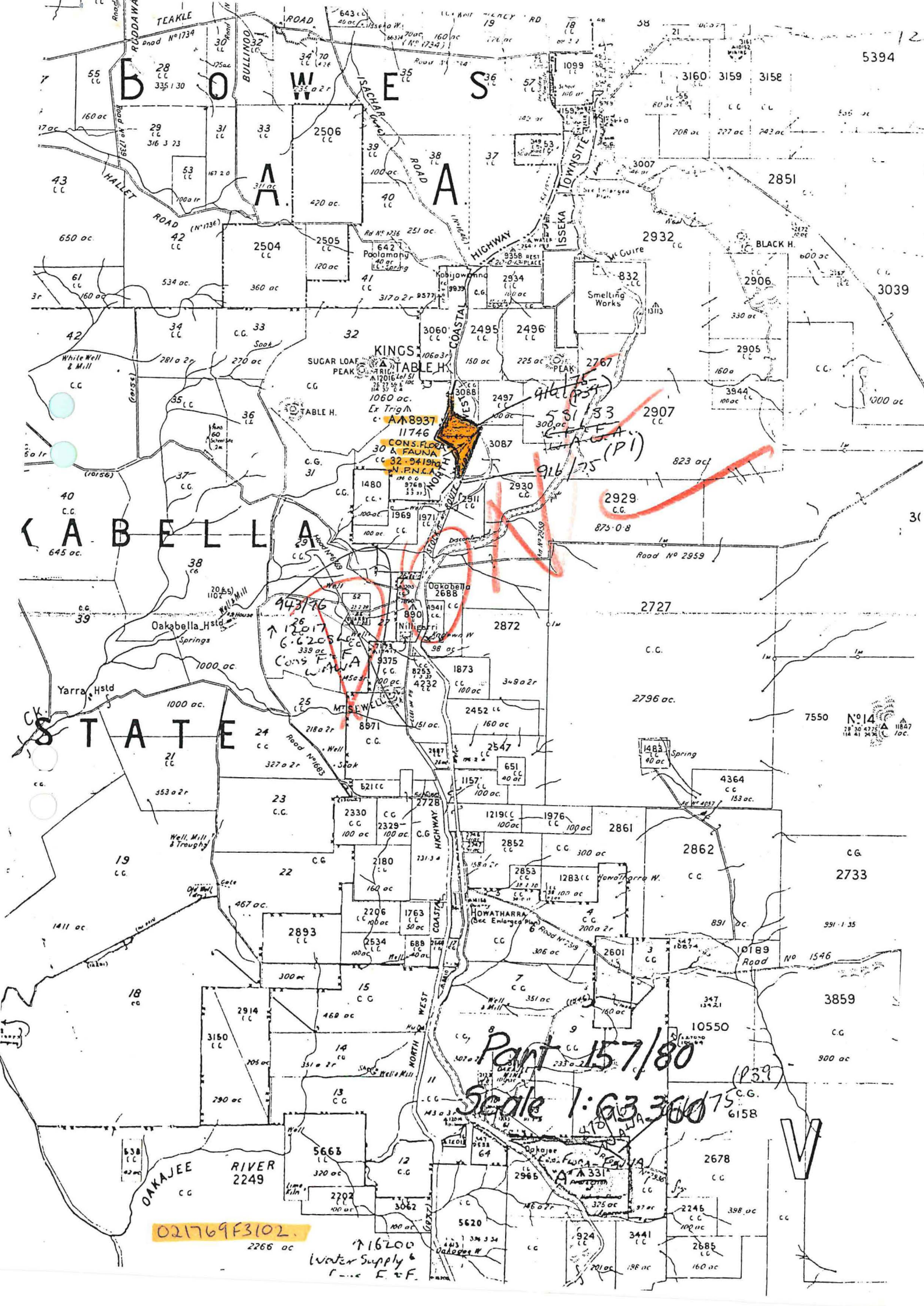

5394

BOWEN

KABELLA

STATE

KINGS TABLE H.

CONS. FLORA 30 & FAUNA
CC 32-3419ha
N.P.N.C.A.

Part 157/80

Scale 1:63,300

021769F3102

16200 Water Supply
C.F.F.

V

Nº 14
18 35 4774
16 41 2421
10c.

3859

2733

7550

2727

2907

3039

2851

3158

3159

3160

2685

2678

10550

2862

2861

2872

2929

2906

2932

2934

2506

2504

2505

2246

2226

2206

2206

2206

2206

2206

2206

2206

2206

2206

2206

2206

2206

2206

2206

2206

2206

2206

2206

2206

2206

2206

2206

2206

2206

2206

2206

2206

2206

2206

2206

2206

2206

2206

2206

2206

2206

2206

2206

2206

2206

2206

2206

2206

2206

2206

2206

2206

2206

2206

2206

2206

2206

2206

2206

2206

2206

2206

2206

2206

2206

2206

2206

2206

2206

2206

2206

2206

2206

2206

2206

2206

2206

2206

2206

2206

2206

2206

2206

2206

2206

2206

2206

2206

2206

2206

2206

2206

2206

2206

2206

2206

2206

2206

2206

2206

2206

2206

2206

2206

2206

2206

2206

2206

2206

2206

2206

2206

2206

2206

2206

2206

2206

2206

2206

2206

2206

2206

2206

2206

2206

2206

2206

2206

2206

2206

2206

2206

2206

2206

2206

2206

2206

2206

2206

2206

2206

2206

2206

2206

2206

2206

2206

2206

2206

2206

2206

2206

2206

2206

2206

2206

2206

2206

2206

2206

2206

2206

2206

2206

2206

2206

2206

2206

2206

2206

2206

2206

2206

2206

2206

2206

2206

2206

2206

2206

2206

2206

2206

2206

2206

2206

2206

2206

2206

2206

2206

2206

2206

2206

2206

2206

2206

2206

2206

2206

2206

2206

2206

2206

2206

2206

2206

2206

2206

2206

2206

2206

2206

2206

2206

2206

2206

2206

2206

2206

2206

2206

2206

2206

2206

2206

2206

2206

2206

2206

2206

2206

2206

2206

2206

2206

2206

2206

2206

2206

2206

2206

2206

2206

2206

2206

2206

2206

2206

2206

2206

2206

2206

2206

2206

2206

2206

2206

2206

2206

2206

2206

2206

2206

2206

2206

2206

2206

2206

2206

2206

2206

2206

2206

2206

2206

2206

2206

2206

2206

2206

2206

2206

2206

2206

2206

2206

2206

2206

C. G.
1429

C. G.
1612

PRICES

018431F3102.

1852

'KARAMARRA
NATURE
RESERVE'

N.P.N.C.A.

A M7765

1851

Conservation of Flora & Fauna.
42 9347ha

Radio Transmitter
Site (MRB)

M35375
4017

1.05ha

M32426
3994

Radio Transmitter Site
(Bush Fires Board)
1 3650ha

M35375
4023
Water Supply
2 9951ha

C.G.
3939

C.G.
1430

(798)

C.G.
1364

C.G.
2994

DANDARAGAN

C.G.
139

KARAMARRA WELL

Part Moora Regional 4.3
Scale 1: 10 000