

LA403*

TRANSFER OF LAND ACT 1893

Department of Land Administration,
Perth.

FILE 3622/1986

His Excellency the Governor in Executive Council has been pleased to appoint under Section 7 of the Transfer of Land Act 1893 John Lindon Gladstone as Registrar of Titles.

ALLAN SKINNER, Chief Executive.

LA601

LAND ACT 1933

Department of Land Administration.

It is hereby notified that it is intended to Grant a Special Lease over King Location 777 to William Westray Burrell under Section 116 of the Land Act 1933 for the purpose of "Tourist Accommodation" for a term of twenty one (21) years.

DOLA Ref: 1356/1994V1

A. A. SKINNER, Chief Executive.

LA801*

LAND ACT 1933
AMENDMENT OF RESERVE

Made by His Excellency the Governor under Section 37

The following reserve has been amended.

DOLA File 2351/993.

Reserve No 9927 (Roe District) "Water Supply (Rabbit Department)" to comprise Location 3136 on Land Administration Plan 10342 and of its area remaining unaltered.

Public Plan: Mount Stewart (50). Tapper Road

Local Authority—Shire of Kondinin.

A. A. SKINNER, Chief Executive.

LA901*

LAND ACT 1933
CHANGE OF PURPOSE OF RESERVES

Made by His Excellency the Governor under Section 37

The purpose of the following reserves have been changed.

DOLA File 2351/993.

Reserve No 9927 (Roe Location 3136) being changed from "Water Supply (Rabbit Department)" to "Water and Conservation of Flora and Fauna".

Public Plan: Mount Stewart (50) Tapper Road.

Local Authority—Shire of Kondinin.

DOLA File 1812/992.

Reserve No 42359 (Cockburn Sound Location 4039) being changed from "Public Recreation" to "Public Recreation and Telecommunications Site".

Public Plan: BG33 (2) 08.11. Crystaluna Drive

Local Authority—City of Rockingham.

A. A. SKINNER, Chief Executive.

1 file - 2 N. Ryan 3 1992 letter - for your info please

*To - CLERK, WOODVALE
FOR YOUR INFORMATION*

DOLA File: 00848-1991-02RO.

Order in Council gazetted on 17 November 1995 vesting "A" Reserve No. 41749 in the Western Australian Planning Commission for the designated purpose of "Public Recreation".

Local Authority—Town of Mosman Park.

DOLA File: 00849-1991-01RO.

Order in Council gazetted on 21 June 1991 vesting Reserve No. 41750 in the State Planning Commission for the designated purpose of "Public Recreation".

Local Authority—Town of Mosman Park.

DOLA File: 00488-1992-01RO.

Order in Council gazetted on 5 June 1992 vesting Reserve No. 42033 in the Commissioner of Police for the designated purpose of "Police Complex".

Local Authority—City of Melville.

DOLA File: 01479-1992-01RO.

Order in Council gazetted on 24 July 1992 vesting Reserve No. 42217 in the Water Authority of Western Australia for the designated purpose of "Access and Public Utility Services".

Local Authority—City of Wanneroo.

DOLA File: 00606-1994-01RO.

Order in Council gazetted on 6 February 1996 vesting Reserve No. 43188 in the Shire of Mundaring for the designated purpose of "Public Recreation".

Local Authority—Shire of Mundaring.

DOLA File: 01918-1994-01RO.

Order in Council gazetted on 30 December 1994 vesting Reserve No. 43248 in the Shire of Busselton for the designated purpose of "Public Recreation".

Local Authority—Shire of Busselton.

DOLA File: 01332-1995-01RO.

Order in Council gazetted on 27 June 1995 vesting Reserve No. 43608 in the City of Bunbury for the designated purpose of "Public Recreation".

Local Authority—City of Bunbury.

DOLA File: 01060-1995-01RO.

Order in Council gazetted on 22 March 1996 vesting Reserve No. 43687 in the City of Wanneroo for the designated purpose of "Public Recreation".

Local Authority—City of Wanneroo.

DOLA File: 02272-1996-01RO.

Order in Council gazetted on 15 November 1996 vesting Reserve No. 44631 in the Water Corporation for the designated purpose of "Pedestrian Accessway and Public Utility Services".

Local Authority—Shire of Gingin.

JOHN PRITCHARD, Clerk of the Council.

LA202*

LAND ACT 1933
ORDERS IN COUNCIL
(VESTING OF RESERVES)

By the direction of His Excellency the Governor under Section 33(2), the following reserves have been vested.

DOLA File: 05347-1899-02RO.

Reserve No 6721 (Leonora Lot 157) vested in the Minister for Education for the designated purpose of "Schoolsite".

Local Authority—Shire of Leonora.

DOLA File: 05144-1904-01RO.

Reserve No 9304 (Kojonup Locations 8141 and 9330) vested in the Shire of Kojonup for the designated purpose of "Landscape Protection".

Local Authority—Shire of Kojonup.

DOLA File: 02351-1993-01RO.









Reserve No 9927 (Roe Location 3136) vested in the National Parks and Nature Conservation Authority for the designated purpose of "Water and Conservation of Flora and Fauna".

Local Authority—Shire of Kondinin.

CALM-MANAGED LANDS AND WATERS

AS AT 30th JUNE 1996

Legend

-  National Park
-  Conservation Park
-  Nature Reserve
-  State Forest, Timber Reserve, Freehold & Other Reserve
-  Section 5(g) Reserve
-  Leasehold in the name of the Executive Director
-  Marine Park / Marine Nature Reserve
-  CALM Region Boundary
-  CALM Regional Office

Scale
0 100 200 300 400 Km

Projection: Polyconic, Origin 121° 0'



CALM
CONSERVATION AND LAND MANAGEMENT

Produced by INFORMATION MANAGEMENT BRANCH

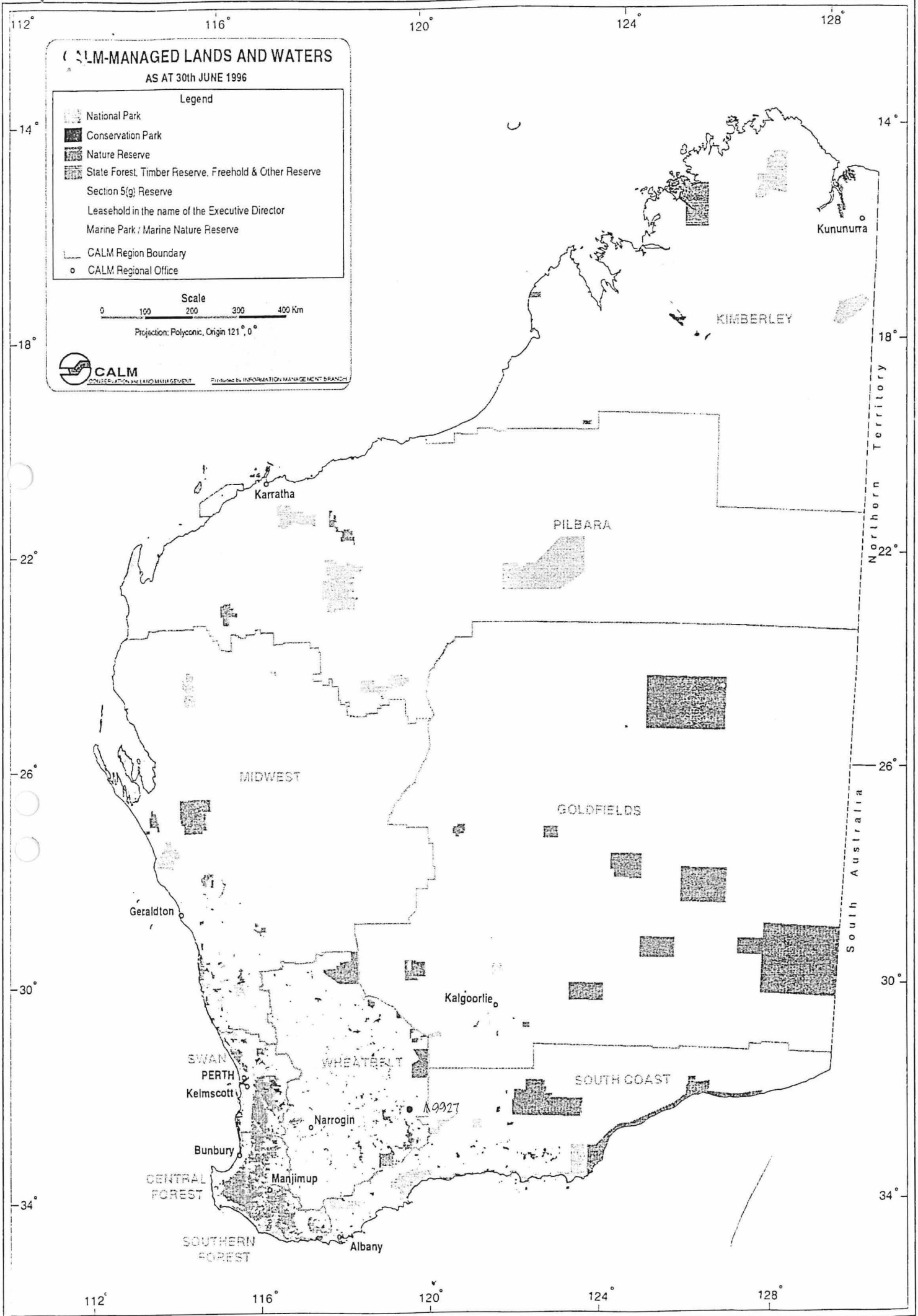

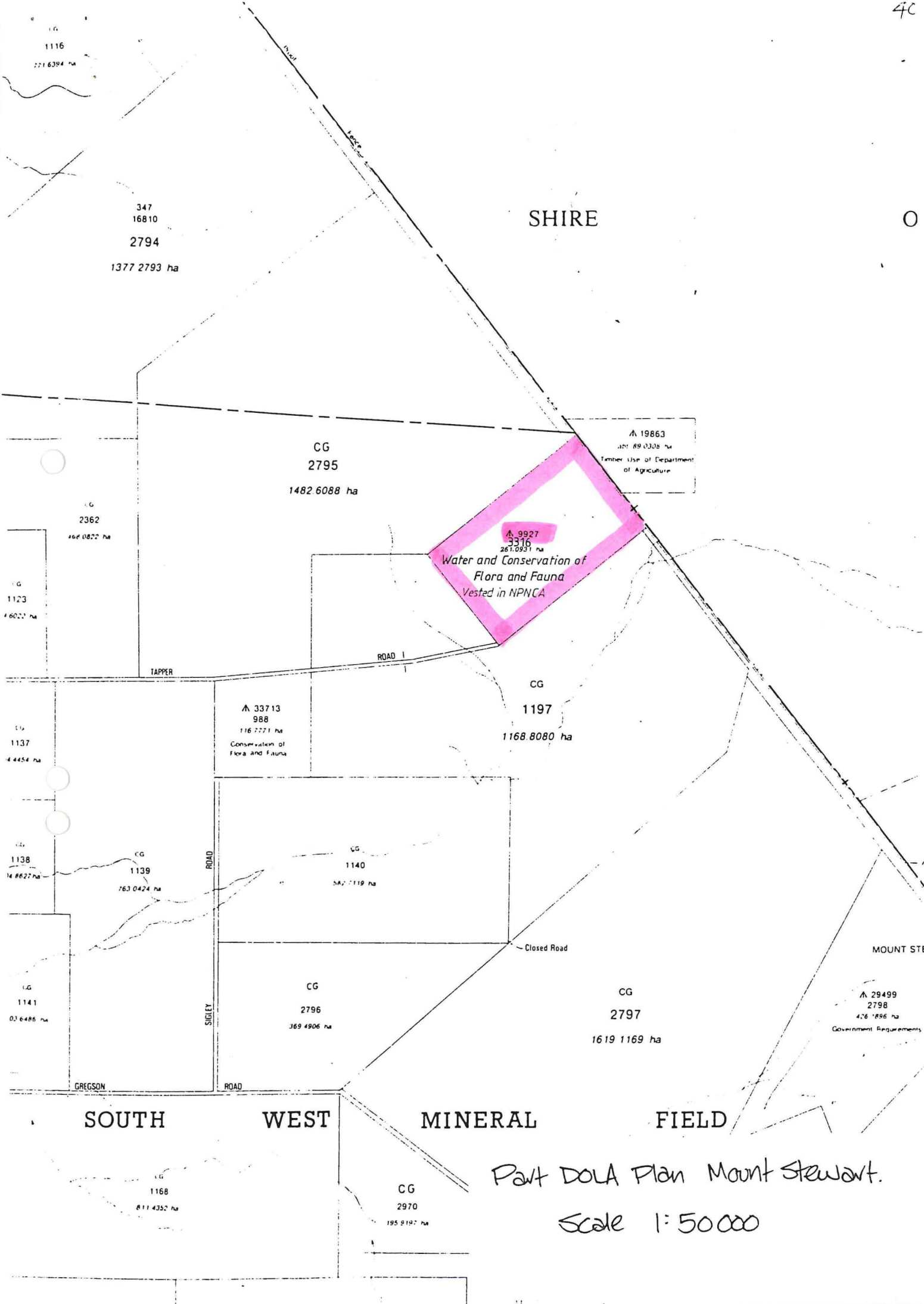

Part DOLA Plan Mount Stewart.
Scale 1:50000

2795
 3663a. 2r 17p
 1482-6088 ha.
 1482-6088 ha.

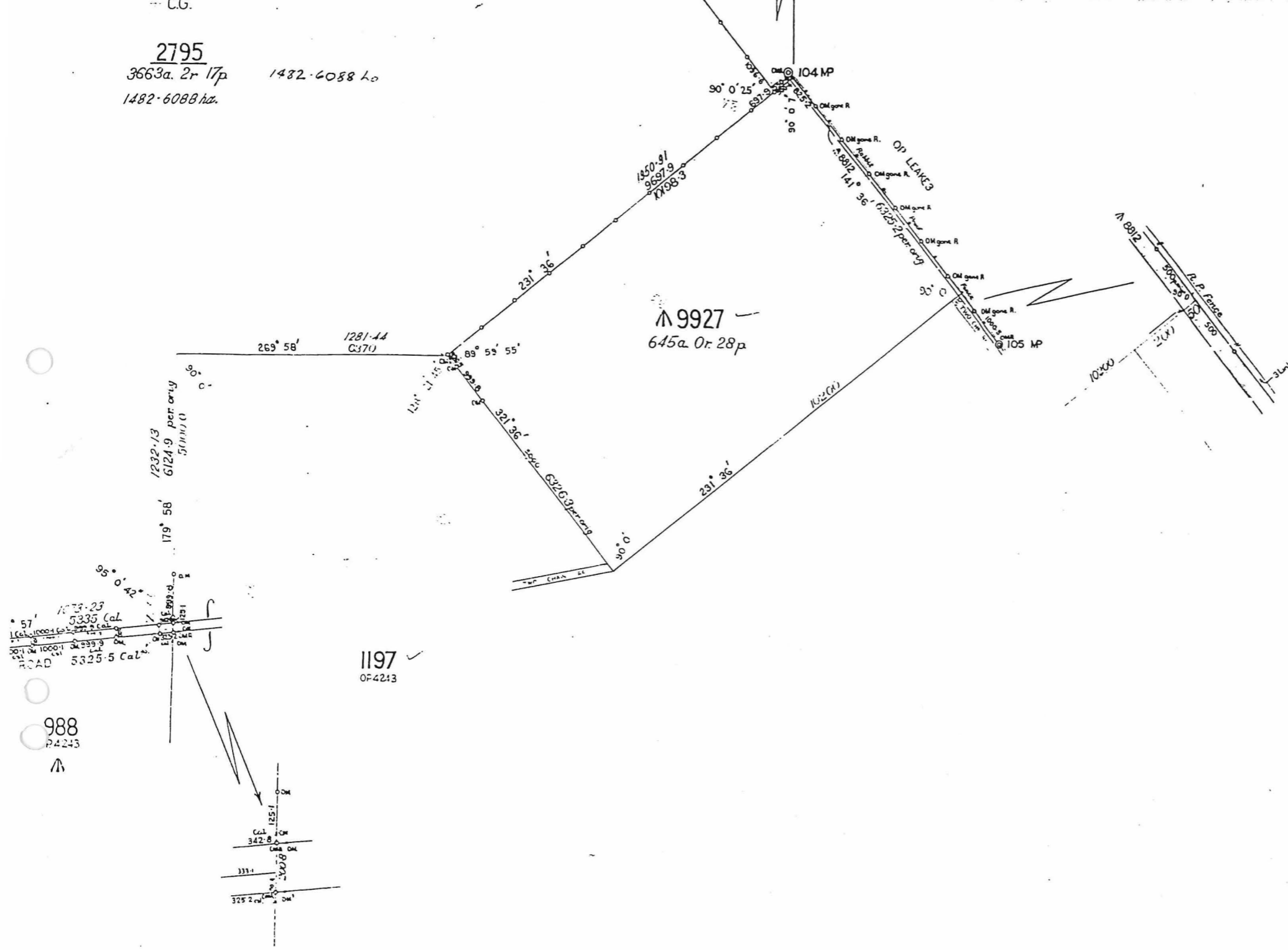

1197
 OF 4213

57' 1073-23
 5335 Cal
 10000 Cal
 10000 Cal
 10000 Cal
 ROAD 5325-5 Cal

988
 P4243

SECTION	ANGLES	N	E	AREA
Loc 2794	-3' 16"	+2-6	-2-2	3402-32916
Loc 2795	-9"	+4-6	+0-2	3463-60614
A 9927	+2"	-0-1	-3-2	645-17431

CERTIFICATE.

I hereby certify that this survey was performed by me personally (or under my personal supervision, inspection and field check), in strict accordance with the Licensed Surveyors (Guidance of Surveyors) Regulations, 1961.

M. J. McKimie
 Licensed Surveyor.

Date.....

Asimuth observed at Δ
 or assumed from.....
 Date of Marking..... 30th APRIL..... 1966
 Field Book No. M.J. MCKIMIE 61-62 Pages 61 pages 1-6-8-10, 62 pages 2, 4-6-11.
 SCALE..... TWENTY..... CHAINS TO AN INCH.
 Public Plan No. 374/80 ^{AP2} 375/80 ^{MT STEWART 1:50000}
 Plan Drawn J. HARRAMP Date 24-8-66
 Account No. M.J.M.K. 5/66 Passed *J.P.* 15 12. 66.
 CA. AYLMORE 1. P86-88
 Calculation Book No. A.J. PRESTON 3. Fol. P. 40.
 Chainage close..... }
 Angular close..... } See Schedule
 Area..... }
 Compared with F.B. *J.P.* 15/12/66
 Tentatively Examined.....
 Examined..... *J.P.* 15/12/66
 Original plan passed *J.P.*
 Date 23.8.66 Inspector of Plans and Surveys.

SURVEY APPROVED *M. J. Anderson*
 Date 23.8.66 SURVEYOR GENERAL
 On Standard Plan.....
 On Public Plan..... L.T. 8.8.66
 On Compilation.....
 Crown Grant Prepared.....

ORIGINAL PLAN No. 10342

Registered *J.P.* 15.9.66