

Query Criteria

Crown Reserve No. = 11962

Special Comments

Crown Reserve: 11962	Tenure: 5(h) Reserve	
Name:	Name Approval: Un-Named Date:	
Vesting: Conservation Commission Of W A	Gazettal Date: 20-Jan-2005	
Purpose: Conservation And Trigonometrical Station	Gazettal Date: 17-Dec-1909	
Class: C	Gazettal Date: 17-Dec-1909	
Area: 0.40	Gazettal Date:	Surveyed Status: Unknown
CALM File:	Management Plan:	
Remark:		

Notes:

Information shown must be considered in the context of the applied query criteria as detailed in full on the cover sheet.

2005 F001362 v01

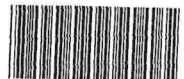

D049166

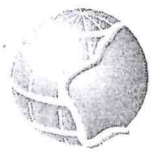

Department for Planning and Infrastructure
Government of Western Australia

Land Asset Management Services

Your ref: 017272F3102
Our ref: 01799-1989-01RO (Job NO: 044005)
Enquiries: Kris Hogan Ph: (08) 9347 5070
Fax: (08) 9347 5005
Email: kris.hogan@dpi.wa.gov.au

11 April 2005

Executive Director
Department of Conservation and Land Management
Locked Bag 104 Bentley Delivery Centre
BENTLEY WA 6983

Dear Sir

RESERVE 11962, CONSERVATION AND TRIGONOMETRICAL STATION.

Further to my letter of 24 January 2005, it is advised that the registration process for Lot 13469 on Deposited Plan 13469, to comprise Reserve 11962, for the purpose of "Conservation and Trigonometrical Station" has now been completed.

A Management Order (formerly Vesting Order) has been issued in favour of the Conservation Commission of Western Australia, the duplicate of which is enclosed for your retention.

Under the State's single land registration system, Management Orders are registered on the Crown Land Title (CLT) and become effective on the date of registration. I also enclose a copy of the CLT for your records.

Yours faithfully

KRIS HOGAN
for **MANAGER LAND ASSET – SOUTH WEST**
LAND ASSET MANAGEMENT SERVICES

15 APR 2005

On file to Powell (2005 F001362 v01).

4005kh01.doc

**Customer Advices for Reserve Actions
1/02/2005 - 28/02/2005**

Shire of Manjimup 1/02/2005 - 28/02/2005

Reserve No.	Land Description	DOLA File No.	Volume/Folio	Action	Document No.	Registered	Street Name	Area	Public Plans
11962	Lot 13469 on Deposited Plan 92305		3105-406	Change of Purpose to ""Conservation and Trigonometrical Station""	J157547	20/01/2005		4047 sqm	Saddle Island NW and Pt chatham Island NE (25)
11962	Lot 13469 on Deposited Plan 92305		3105-406 3105-406	Management Order to Conservation Commission of Western Australia, of corner of Hackett Drive and Australia Il Drive Crawley WA 6009 for the designated purpose of ""Conservation and Trigonometrical Station""	J157548	20/01/2005		4047 sqm	Saddle Island NW and Pt chatham Island NE (25)
22259	Lot 11833 on Deposited Plan 39775	01715-1939-01RO	3087-212	Reserve Cancellation ""	J154644	18/01/2005	Kim Road	1.0117 Ha	Pemberton NE (25), bg28 (10) 7.2
25168		01321-1958-01RO	3061-221	Revocation of Management Order (Shire of Manjimup) for the designated purpose of "Community Purposes".	J134868	24/12/2004	Vista Street	1012 sqm	BH26(2) 25.10
25168		01321-1958-01RO	3061-221	Management Order to Commissioner of Police of 2 Adelaide Terrace, East Perth for the designated purpose of "Community Purposes"	J134870	24/12/2004	Vista Street	1012 sqm	BH26(2) 25.10
25168	Lot 163 on Deposited Plan 208512	01321-1958-01RO	3061-221	Change of Purpose to "Police Purposes"	J134869	24/12/2004	Vista Street	1012 sqm	BH26(2) 25.10

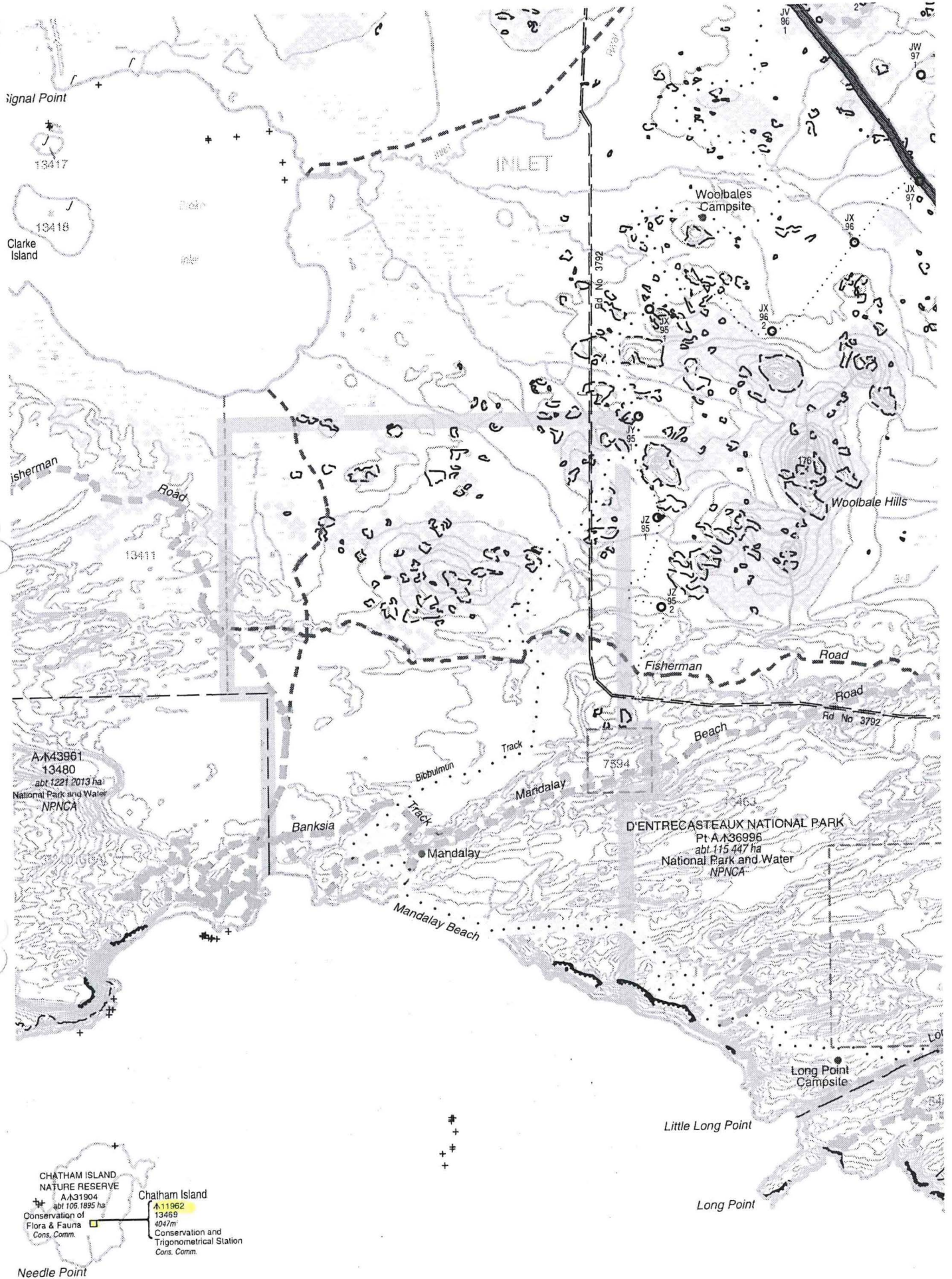

PART CAMP PLANS:
WALPOLE + BROKE INLET
SCALE 1:50 000

DP 36739

EDVER	AMENDMENT	BY	SIGNATURE	DATE	APPROVED	
					Authorized Land Officer	Date

TYPE	CROWN
PURPOSE	SUBDIVISION
PLAN OF	LOT 13821

DISTRICT	NELSON	DOLA FILE	3253/1972
TOWNSITE			
LOCAL AUTHORITY	SHIRE OF MANJIMUP		
FORMER TENURE	ON	REFERENCE	
	DP 91216		

SCALE: ALL DISTANCES ARE IN METRES 1:15 000

SUBJECT TO SURVEY
NOT FOR ALIENATION PURPOSES

LODGED DATE	9.4.2003	TYPE OF VALIDATION	FULL AUDIT <input checked="" type="checkbox"/>	SURVEY FIRM	DOLA - PWK 4/4/2003
FEE PAID	N/A	LEGAL COMPONENT			
ASSESS No.	N/A	CERTIFIED CORRECT	<i>W. Smith 18/4/03</i> Manager, Statutory Services		
IN ORDER FOR DEALINGS					
SUBJECT TO	<i>Redescription of A 31004</i>				



APPROVED

D. Williams 15/4/03
FOR AUTHORIZED LAND OFFICER DATE

DEPOSITED PLAN
36739

SHEET 1 OF 1
EDITION 1 VERSION 1

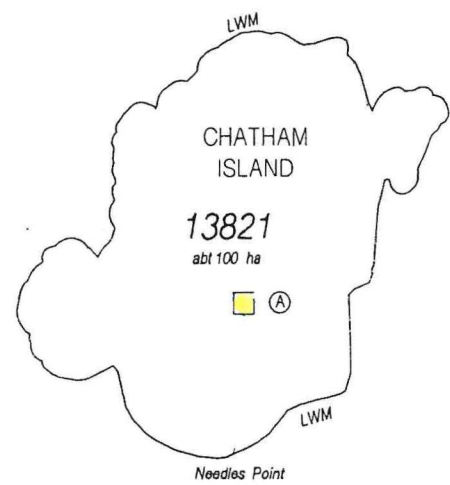
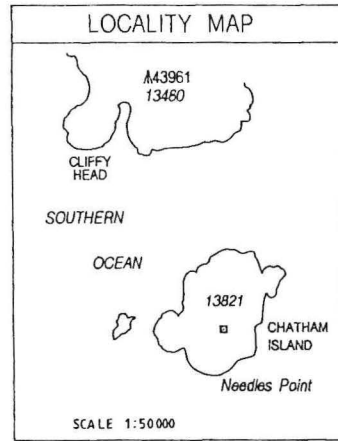

Enlargement at **A**
SCALE 1:2000

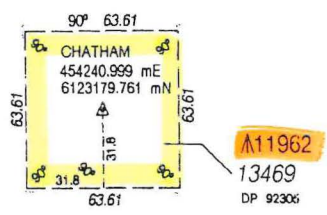

CO-ORDINATES ARE GDA 94
GRAPHICS DERIVED FROM THE SCDB - APRIL 2003
WATERLINES SHOWN HEREON DO NOT NECESSARILY DEPICT AN EXACT CADASTRAL BOUNDARY