

NATURE RESERVE

RESERVE NO: 14330

GOVERNMENT GAZETTE  
Date Page No.

FILE NUMBER: 963/76

PURPOSE: Cons. of Flora 5.4.63 1024

NAME:

CLASS (Land Act):

AREA: 4.3251 ha 20.9.12 4077

VESTING:

LOCATION NO(S): Avon 19491

CLASSIFICATION:  
(Wildlife Act  
Section 12A)

LITHO: 27C/40

LOCAL AUTHORITY: NORTHAM SHIRE

Notes:

N/A Flora Reserve 7220 907/76



DEPARTMENT OF LANDS AND SURVEYS

Cathedral Avenue,  
Perth,  
Western Australia 6000

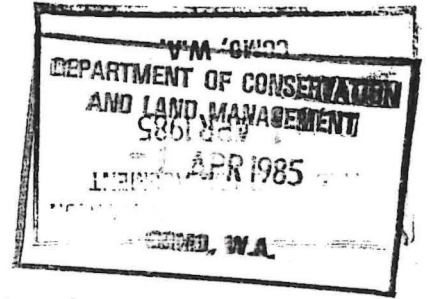

Your Ref. F & W 907/76  
Our Ref. 936/00v<sup>2</sup> CN:LD  
Telephone Enquiries 323 1278

Executive Director  
Department of Conservation and  
Land Management  
State Operations Headquarters  
50 Hayman Road  
COMO CDO

RESERVES 7220 AND 14330 FOR CONSERVATION OF FLORA

Further to your memo of February 15, 1985 I advise for your information that Executive Council has:-

- 1) approved of:-
  - a) the cancellation of Reserve No. 14330 (Avon Location 19491) "Conservation of Flora".
  - b) the amendment of Reserve No. 7220 (Avon Location 19492) "Conservation of Flora" to include Avon Location 19491 and of its area being increased to 17.6848 hectares.
  - c) the purpose of Reserve No. 7220 (Avon Locations 19491 and 19492) being changed from "Conservation of Flora" to "Conservation of Flora and Fauna" and issued an Order in Council directing that Reserve No. 7220 (Avon Locations 19491 and 19492) shall vest in and be held by the Western Australian Wildlife Authority in trust for the purpose of "Conservation of Flora and Fauna".

Notice to this effect was published in the Government Gazette of March 22, 1985 and I enclose a print showing the said amendment and the relevant Vesting Order.

*B. L. O'Halloran*

UNDER SECRETARY FOR LANDS

March 28, 1985

Encl.

*1/ Mr Powell. 30/4/85*

*GRASS VALLEY 1,501,000  
cf 29.8.86*

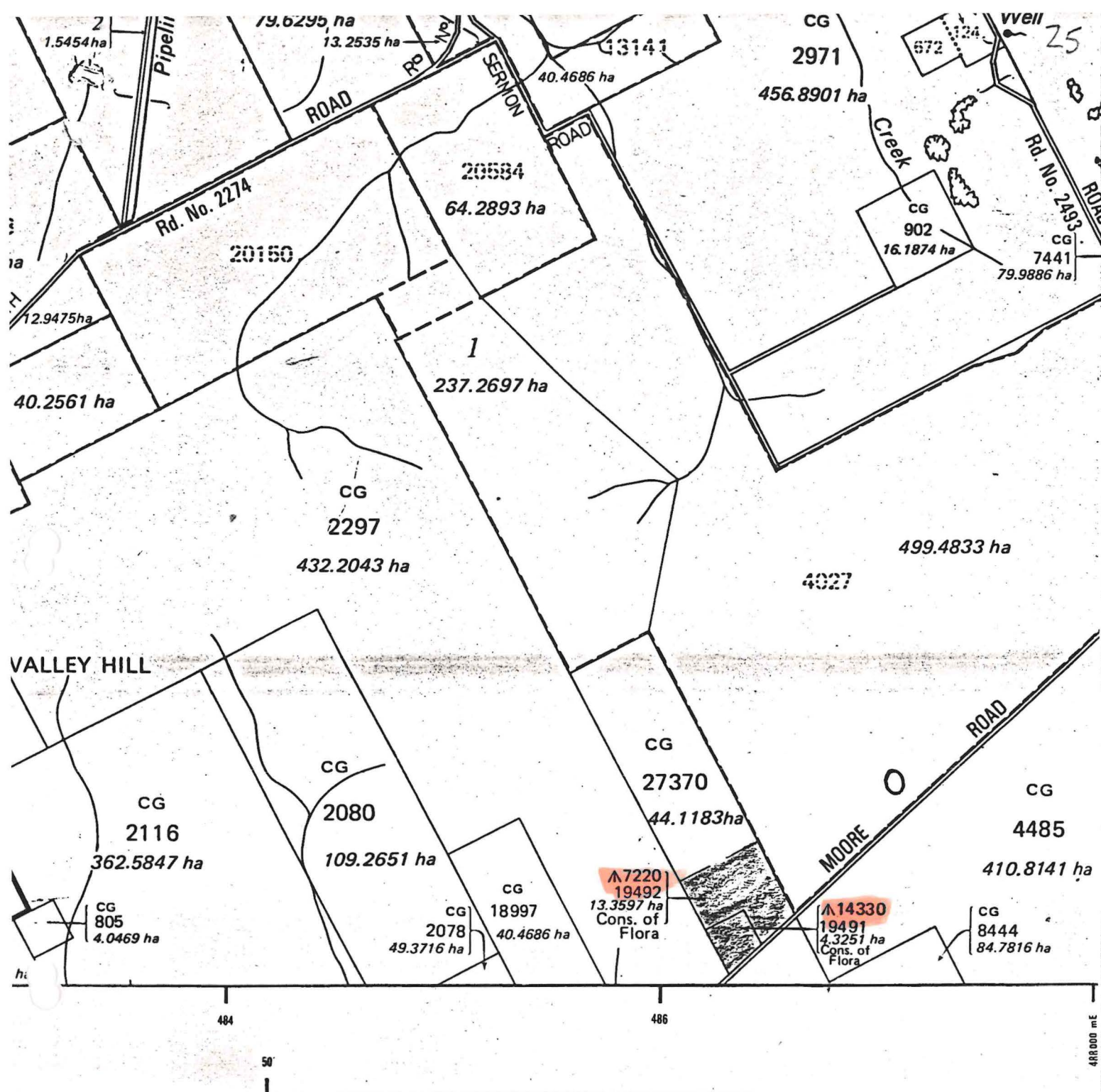

# GRASS VALLEY

SHEET 223  
CADASTRAL

For topographic  
Grass Valley Sheet 22

INDEX TO ADJOIN

Jeanacobbie 2235-III	Gr
SE	SW
NE	NW
Northam 2234-IV	Gr
SE	SW

- Airstrip.....
- Rock .....
- River or Watercourse ; direction of flow ..
- Major Weirs and Reservoirs .....
- Swamp or Marsh .....
- Spring or Soak .....



- Subdivided Location Boundary.....
- Grouped Location or Lot Boundaries .....
- Surveyed Road .....
- Unsurveyed Road .....
- Transmission Line.....
- Railway, Station, Siding.....
- Bridge.....
- Pastoral Lease Boundary (Unsurveyed).....
- Named, unsurveyed and undedicated  
constructed road .....
- Trigonometrical Station .....

Plan: Grass Valley NW

Scale: 1:25000

Regional Manager

Local Authority: Shire of Northam