

RESERVE ACTION SHEET: CONSERVATION RESERVES

Conservation Library
Dept. of Environment
and Conservation
Kensington, W.A.

RESERVE No. 15556

LOCAL GOVERNMENT: City of Cockburn

NAME : Thomson Lake Nature Reserve

PURPOSE: Conservation of Fauna & Research & Drainage
Commission

VESTING: Conservation

ACTION

Decrease in reserve area due to redefinition of lots to include Lots 500, 501, 502 on Deposited Plan 62437 in lieu of Lot 2256 on Deposited Plan 202611.

Total Area: 550.84 to 550.74ha

REASON FOR ACTION

In March 2008 the Thomson Lake Nature Reserve was increased in area from 542.64ha to 550.84 by the inclusion of Lots 500, 501 and 502 on Deposited Plan 62437.

On the 12 January 2010 Lot 2256 on Deposited Plan 202611 was excised from the reserve to facilitate the widening of Hammonds Road.

Date of amendment: 12.1.2010

Maps: 16, 9

Customer advice: 12

Proposal Summary: 19

IUCN classification: 1a

Native Title: Extinguished due to gazettal in 1963

1	LAND UNIT LEADER	To note	<i>SL 15/3/2011</i>
2	LAND UNIT	Send copies of advice and maps to: <ul style="list-style-type: none"> • Lisa Wright • District Manager • Regional Manager Attach TENIS gazettal history to file Delete from District Proposals spreadsheets Create Conservation Commission summary	✓ 15/3/11 ✓ 15/3/11 ✓ 15/3/11 ✓ 15/3/11 ✓ 15/3/11
3	DIRECTOR, NATURE CONSERVATION	To note	
4	C.I.S.	Please rename file/create new file Keyword: Activity: Subject: Free text:	

LAND ADMINISTRATION OFFICER
LAND UNIT
PLANNING AND ESTATE BRANCH

'A' Reserve 15556 within Swan/Swan Coastal Region/District, was
created/amended, effective from 17 August 2007.

- A copy of the customer advice can be found at folio 41.
The addition / ^{sketch}excision / amendment is shown on the associated Deposited
Plan / Diagram which is listed below:

Deposited Plan 52083 lot / location 301-303 folio 42-44 incl.

Other relevant deposited plans / diagrams:

_____ lot / location _____ folio _____

- A locality plan with the addition / excision / amendment shown highlighted can be
found at folio 45.
- Copies of other relevant notifications pertinent to this reserve action have been
placed at folios 46-48.

Would you please advise the relevant offices of this amendment through your Reserve
Action Sheet.

Recommended IUCN classification 1a (no change)

Geoffrey Banks

Date 28.11.08

Program Leader
Tenure Group, GIS
Information Management Branch

**Customer Advices for Reserve Actions
1/10/2007 - 31/10/2007**

City of Cockburn 1/10/2007 - 31/10/2007

Reserve No.	Land Description	DPI File No.	Volume/Folio	Action	Document No.	Registered	Street Name	Area	Public Plans
15556 15556	Lot 2726 on Deposited Plan 215761	04791-1913-08RO	3139-963 3139-964	Amendment of Reserve to To comprise Lots 301-3 on Deposited Plan 52083 in lieu of Lot 2726 and the area being reduced to 550.8457 hectares.	K309112	17/08/2007	Russell Road, Beerliar	550.8457 Ha	BG34 (10) 3.1
15556; 15556		04791-1913-08RO	3139-963 3139-964	Revocation of Management Order (National Parks and Nature Conservation Authority) for the designated purpose of "Fauna Conservation & Research & Drainage".	K309109	17/08/2007	Russell Road, Beerliar	551.0305 Ha	BG34 (10) 3.1
29241		00724-1990-02RO	0000-000	Revocation of Management Order (National Parks & Nature Conservation Authority) for the designated purpose of "Research and Conservation of Flora and Fauna".	K309110	17/08/2007	Russell Road, Beerliar	253.7379 Ha	BG34 (10) 3.1
29241	Cockburn Sound Location 2130	00724-1990-02RO	0000-000	Amendment of Reserve to To now comprise Lot 300 on Deposited Plan 52083 in lieu of Cockburn Sound Location 2130 and the area being reduced to 231.2702 hectares.	K309114	17/08/2007	Russell Road, Beerliar	231.2702 Ha	BG34 (10) 3.1
49243	Lot 890 on Deposited Plan 53324	50727-2006-01RO	0000-000	Reserve Creation for the designated purpose of "Police Station".	K317951	24/08/2007	Nicholson Road, Canning Vale	3698 sqm	BG34(2) 18.12, 18.13
49243	Lot 890 on Deposited Plan 53324	50727-2006-01RO	0000-000 0000-000	Management Order to Minister responsible for the administration of the Police Act 1892, for the time being known as the Minister for Police and Emergency Services care of the Western Australian Police Service, PO Box 1737, MIDLAND WA 6936. To be utilised for the designated purpose of "Police Station" only for the designated purpose of "Police Station"	K317952	24/08/2007	Nicholson Road, Canning Vale	3698 sqm	BG34(2) 18.12, 18.13
49304	Lot 226 on Deposited Plan 52780	50640-2007-01RO	3145-688 3145-688	Management Order to City of Cockburn of PO Box 1215, BIBRA LAKE DC WA 6965 To be utilised for the designated purpose of "Public Recreation" only for the designated purpose of "Public Recreation"	K370756	09/10/2007	Bounded by Versailles Parkway and Camden Boulevard, Aubin Grove.	3783 sqm	BG34 (2) 14.40
49304	Lot 226 on Deposited Plan 52780 (Sheet 2).	50640-2007-01RO	3145-688	Reserve Creation for the designated purpose of "Public Recreation".	K370755	09/10/2007	Bounded by Versailles Parkway and Camden Boulevard, Aubin Grove.	3783 sqm	BG32 (2) 14.40
49321	Lot 8014 on Deposited Plan 54243	50878-2007-01RO	3147-692 3147-692	Management Order to City of Cockburn, PO Box 1215, BIBRA LAKE DC WA 6965. To be utilised for the designated purpose of "Public Recreation" only for the designated purpose of "Public Recreation"	K370105	09/10/2007	Bounded by Lucretia Circle and Orsino Boulevard, North Coogee.	6461 sqm	BG34 (2) 07.08
49321	Lot 8014 on Deposited Plan 54243 (Sheet 3).	50878-2007-01RO	3147-692	Reserve Creation for the designated purpose of "Public Recreation".	K370105	09/10/2007	Bounded by Lucretia Circle and Orsino Boulevard, North Coogee	6461 sqm	BG34 (2) 07.08

decrease in area of 1848m is same as in excused from A for road widening.

*Greg Banks - for your action plans please, and please return file to me.
Sharon Collier
16.9.08*

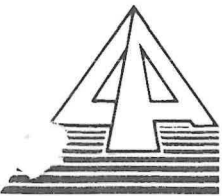

Department of
LAND ADMINISTRATION

024282F3102

274
CR

Your Ref: 024282F3102

Our Ref: 2591/72 CA:ESG

Telephone: 323 1614 C ABEY
Enquiries:

EXECUTIVE DIRECTOR
DEPARTMENT OF CONSERVATION AND
LAND MANAGEMENT
C D O

Department of Conservation
and Land Management
17 JAN 1989
COMO, W.A.

RESERVE NO. 15556

I advise for your information that in accordance with the Reserves and Land Revestment Act No. 67 of 1988 that Reserve No. 15556, classified as of Class A, containing 538.4751 hectares, set apart for "Fauna Conservation and Research and Drainage" and vested in the National Parks and Nature Conservation Authority is hereby amended by including an area of 12.7192 hectares or thereabouts, comprising Cockburn Sound Location 2256.

Appropriate action is currently proceeding.

I enclose a print showing the said reserve.

S BURGESS
A/MANAGER
PROPERTY MANAGEMENT BRANCH
LAND OPERATIONS DIVISION

January 16, 1989

Enc.

PM013G4

File No. 2344/983.

YURABI—No. 40861 (about 256 hectares) (Use and Benefit of Aboriginal Inhabitants) Location No. 45 Reserve Diagram 751 Public Plan Noonkanbah 1:250 000 (On Cherrabun Station).

N. J. SMYTH,
Executive Director.

AMENDMENT OF RESERVE No. 31723

Department of Land Administration,
Perth, 13 January 1989.

File No. 1948/72.

HIS Excellency the Governor in Executive Council has been pleased to approve, under section 37 of the Land Act 1933 of the amendment of Reserve No. 31723 (Kambalda Lot 439) "Pedestrian Access and Recreation" to exclude that portion delineated and shown bordered green, the subject of Land Administration Diagram 88856 and of its area being reduced to 3857 square metres accordingly. (Plan Kambalda 1:2 000 01.27 (The Crossing).

N. J. SMYTH,
Executive Director.

CANCELLATION OF RESERVE No. 10870

Department of Land Administration,
Perth, 13 January 1989.

File No. 803/986.

HIS Excellency the Governor in Executive Council has been pleased to approve, under section 37 of the Land Act 1933 of the cancellation of Reserve No. 10870 (Victoria District) "Gravel". (Plan Yardarino S.W. 1:25 000) (Piggery Lane).

N. J. SMYTH,
Executive Director.

CHANGE OF PURPOSE OF RESERVES

Department of Land Administration,
Perth, 13 January 1989.

HIS Excellency the Governor in Executive Council has been pleased to approve, under section 37 of the Land Act 1933, of the change of purpose of the following reserves—

File No. 4986/898—No. 5805 (Mundaring Lot 24) being changed from "Schoolsite" to "Use and Requirements of the Minister for Works". Public Plan: Perth 1:2 000 BG34/31.31 (Hartung Street).

File No. 2900/988—No. 24444 (Avon Location 27824) being changed from "Recreation" to "Use and Requirements of the Minister for Works". (Plan Bakers Hill 1:2 000 11.11 and 12.11) (Great Eastern Highway in the Shire of Northam).

File No. 1470/73—No. 33778 (Marble Bar Lot 267) being changed from "Power Supply Purposes" to "Power Station Site". (Plan Marble Bar Townsite) (Ironclad Street).

N. J. SMYTH,
Executive Director.

RESERVES AND LAND REVESTMENT ACT 1988

IT is hereby notified that pursuant to the above Act assented to on 14 December 1988, the undermentioned reserves have been dealt with in the manner shown.

Amendment of Reserves

The following reserves have been amended as described—

1. Class A Reserve 31737 "National Park" to include Kent Locations 612, 613, 614, 629, 630, 854, 877, 2073, 2074, 2075, 2076, 2077, 2078, 2079, 2080 and 2082 as shown on Reserve Plan 283 (Sheet 3) and of its area being increased to about 319602 hectares. Public Plans Darlingup, Drummond, Jacup, Mainnarup, Twertup, Whoogerup 1:50 000. Files 2614/75V6, 3137/54V6.
2. Class A Reserve 39962 "Conservation of Flora and Fauna a Passive Recreation" to include Waterman Lot 6 as shown on Diagram 88464 and of its area being increased by 1 128 square metres. Public Plan Perth 1:2 000 07.36. File 3129/77V3.

3. Class A Reserve 25113 "Conservation of Fauna" to comprise Kent Locations 788, 789, 790, 791, 792, 793, 794, 952, 986, 2112 and Roe Location 3102 as shown on Reserve Plan 280 and of its area being increased to about 107 615 hectares. Public Plan Magenta, Cameron Creek, Cairlocatup and Lake Bryde 1:50 000. File 5856/52V2.
4. Class A Reserve 38924 "Conservation of Flora and Fauna" to include Avon Location 28937 as shown on Diagram 88322 and of its area being increased by 8 880 square metres. Public Plan Toodyay SW 1:25 000. File 911/984.
5. Class A Reserve 27322 "Park and Recreation" to comprise Geraldton Lot 2873 on Original Plan 16832 and of its area being increased to 2.7073 hectares. Public Plans Geraldton 1:2 000 15.20, 15.21. File 2673/63.
6. Class A Reserve 25555 "Conservation of Flora and Fauna" to include Avon Locations 28800, 28801, 28802 and 28803 on Original Plan 16377 and Diagrams 86950 and 86951 and of its area being increased by 116.273 1 hectares. Public Plan Woywering 1:25 000 NW. File 2659/59V2.
7. Class A Reserve 37883 "National Park" to comprise Kununurra Lot 1636 as shown on Original Plan 16842 and of its area being increased to 2067.930 hectares. Public Plans Burt Range NW and Deception Range NE 1:25 000. File 620/68V2.
8. Class A Reserve 24258 "National Park and Recreation" to include Plantagenet Location 7640 as shown on Diagram 88318 and of its area being increased by 19.093 0 hectares. Public Plan Albany and Environs 1:10 000 11.37. File 1036/66.
9. Class A Reserve 10922 "National Park" to comprise Sussex Locations 4783 and 4834 on Diagram 85972 and Original Plan 16872 and of its area being increased to 167.840 2 hectares. Public Plans Yallingup SW and Pt Clairault SE 1:25 000. File 5287/07.
10. Class A Reserve 15556 "Fauna Conservation and Research and Drainage" to include Cockburn Sound Location 2256 and of its area being increased by 12.719 2 hectares. Public Plan Perth 1:10 000 3.1. File 2591/72.
11. Class A Reserve 32590 "National Park" to include Oldfield Location 1464 on Miscellaneous Diagram 137 and of its area being increased by 233.438 1 hectares. Public Plan Moonanup 1:50 000. File 3381/64V2.
12. Class A Reserve 32376 "National Park" to include Sussex Location 4815 as shown on Diagram 87388 and of its area being increased by 1 299 square metres. Public Plan Augusta 1:2 000 15.38. File 2377/982.
13. Class Reserve 38333 "National Park" to include De Witt Location 181 as shown on Reserve Plan 223 and of its area being increased by 16.187 4 hectares. Public Plan Pyramid 1:250 000. File 26444/53V3.
14. Class A Reserve 8731 "Public Park and Recreation" to exclude that portion now comprised in Swan Location 11071 as shown on Diagram 88514 and of its area being reduced by 8 549 square metres. Public Plan Perth 1:2 000 11.28. File 17/98V5.
15. Class A Reserve 9286 "Water Supply" to exclude that portion now comprised in Kalgoorlie Lot 4346 as shown on Diagram 88401 and of its area being reduced by 3.068 3 hectares. Public Plan Kalgoorlie Boulder 1:2 000 28.36. File 6060/00V2.
16. Class A Reserve 17375 "Recreation" to exclude that portion now comprised in Swan Location 11012 as shown on Diagram 88377 and of its area being reduced by 3.876 0 hectares. Public Plan Perth 1:2 000 11.21. File 292/20V5.
17. Class A Reserve 36915 "Conservation of Flora and Fauna" to exclude that portion now comprised in De Witt Location 219 as shown on Diagram 87702 and of its area being reduced by 362 square metres. Public Plan Dampier and Barrow Island 1:250 000. File 3677/68.
18. Class A Reserve 23580 "Recreation and Parkland" to exclude that portion now comprised in Avon Location 28896 as shown on Diagram 88114 and of its area being reduced by 16.919 0 hectares. Public Plan Merredin Regional 1:10 000 8.8. File 1984/51.

289/1-59



Conservation Commission
of Western Australia

RECEIVED

15 MAR 2006

CONSERVATION COMMISSION OF WA

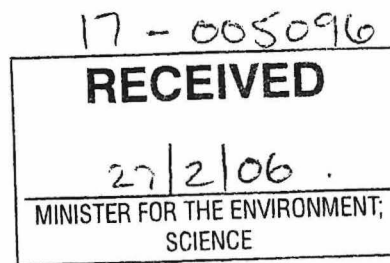

C04911

MINISTER FOR THE ENVIRONMENT; RACING AND GAMING

**EXCISIONS FROM THOMSONS LAKE NATURE RESERVE (RESERVE A15556)
AND HARRY WARING MARSUPIAL RESERVE (RESERVE A29241) DUE TO
THE REALIGNMENT AND WIDENING OF RUSSELL ROAD**

Thomsons Lake Nature Reserve (Reserve A15556) and Harry Waring Marsupial Reserve (Reserve A29241) are both class A nature reserves vested in the Conservation Commission of Western Australia.

In October 2005, the City of Cockburn contacted the Department of Conservation and Land Management (CALM) requesting approval to realign and widen Russell Road, which runs between the two reserves (Map 1).

The eastern part of Russell Road, between Thomsons Lake Nature Reserve and Harry Waring Marsupial Reserve, is located north of the dedicated road reserve. It is proposed to realign this portion of Russell Road so that it is now located entirely within the road reserve (Map 2). Additionally, this portion of Russell Road will be widened (as indicated in the Metropolitan Region Scheme – Map 3) and will require the excision of land from both Thomsons Lake Nature Reserve and Harry Waring Marsupial Reserve (Map 4).

The proposed realignment and widening are the result of the need to provide a safe traffic intersection on the eastern boundary of Thomsons Lake Nature Reserve and Harry Waring Marsupial Reserve.

In February 2006, the proposal was endorsed by the Conservation Commission of Western Australia on the condition that the City of Cockburn should do the following.

1. Remove the existing road base through Thomsons Lake Nature Reserve and rehabilitate the area (about 0.4 ha) with local native species to the satisfaction of CALM.
2. Remove any bitumen road base, pipes and other debris associated with previous roads from the northern portion of Harry Waring Marsupial Reserve.
3. Re-align the vermin-proof fence at Harry Waring Marsupial Reserve to the satisfaction of CALM.
4. Provide an agricultural fence along the revised cadastral boundary at the south-east corner of Thomsons Lake Nature Reserve.

I therefore seek your approval to excise approximately 1846 m² from Thomsons Lake Nature Reserve (Reserve A15556) and approximately 203 m² from Harry Waring Marsupial Reserve (Reserve A29241) for the alignment and widening of Russell Road.

Section 45(4) of the *Land Administration Act 1997* (LAA) requires excisions for roads to be tabled in Parliament and to be subject to disallowance. There is no requirement under the LAA for you to approve such excisions but I would prefer to obtain your approval.

The road excision papers will be tabled in Parliament by the Minister for Planning and Infrastructure, who is responsible for administering the LAA.

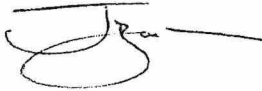

Dr John Bailey
CHAIRMAN

27 February 2006

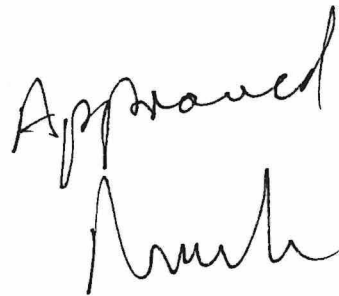

212
60

INCLUSION OF COCKBURN SOUND LOCATION 2256 INTO A A 15556

PUBLIC PLAN:- PERTH 10 000 3:1

CORR. 2591/72

SCALE 1:20 000

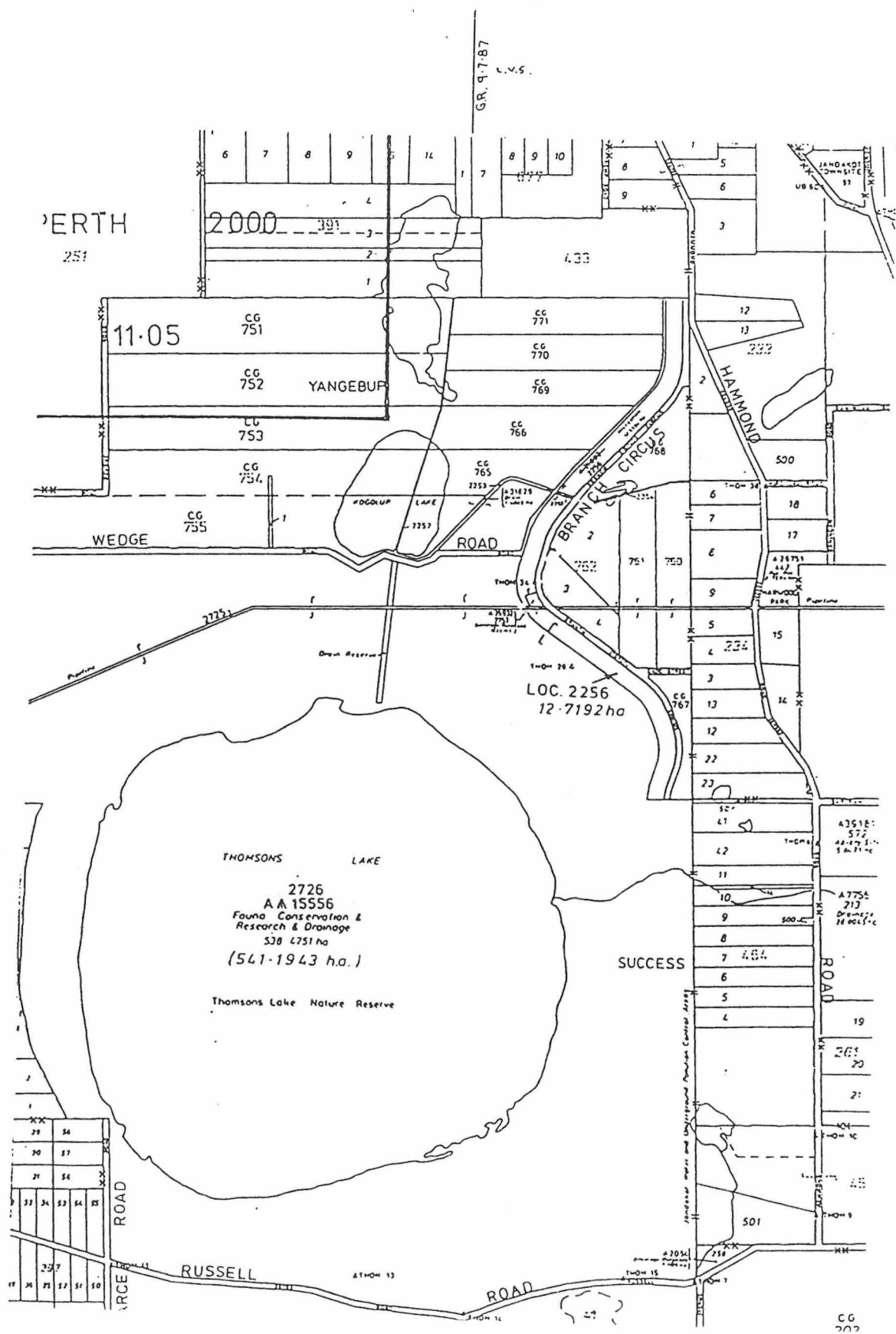

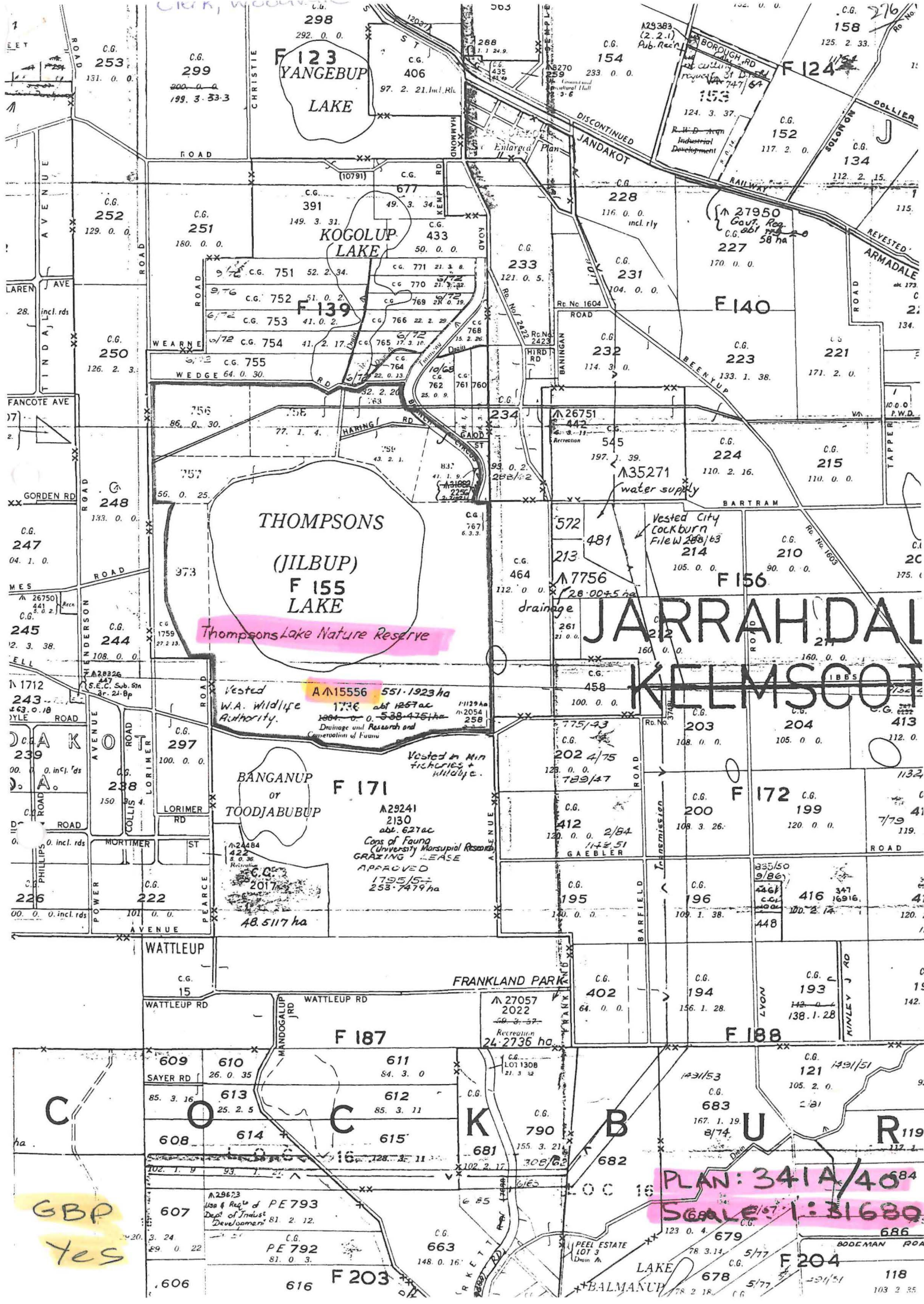

F 123
YANGEBUP
LAKE

KOGOLUP
LAKE

THOMPSONS
(JILBUP)
F 155
LAKE

Thompsons Lake Nature Reserve

Vested
W.A. Wildlife
Authority.
A 15556 551.1923 ha
1736 abt 1257 ac
1894-0-0-538-475/ha
Drainage and Research and
Conservation of Fauna

BANGANUP
or
TOODJABUBUP

F 171

A 29241
2130
abt. 627 ac
Cons of Fauna
(University Marsupial Research)
GRAZING LEASE
APPROVED
1795/5-
253-7479 ha

Vested in Min
fisheries +
wildlife.

BOROUGH RD
R.W.D. Agri
Industrial
Development

A 27950
Govt. Reg.
C.G. abt 58 ha
58 ha

A 35271
water supply

Vested City
Lockburn
File W 280/63

A 7756
drainage

JARRAH DAL
KEELMSCOT

A 2024/75
789/17

A 412
142/51
GAEBLER

A 195

A 27057
2022
50-3-57
Recreation
24 2736 ha

PLAN: 341A/40
SCALE: 1:31680

GBP
Yes

PEEL ESTATE
LOT 3
Drain A

LAKE
BALMANUP

F 204

118
103 2 35

LANDGATE COPY OF ORIGINAL NOT TO SCALE Fri Sep 26 10:38:53 2008 JOB 31052857

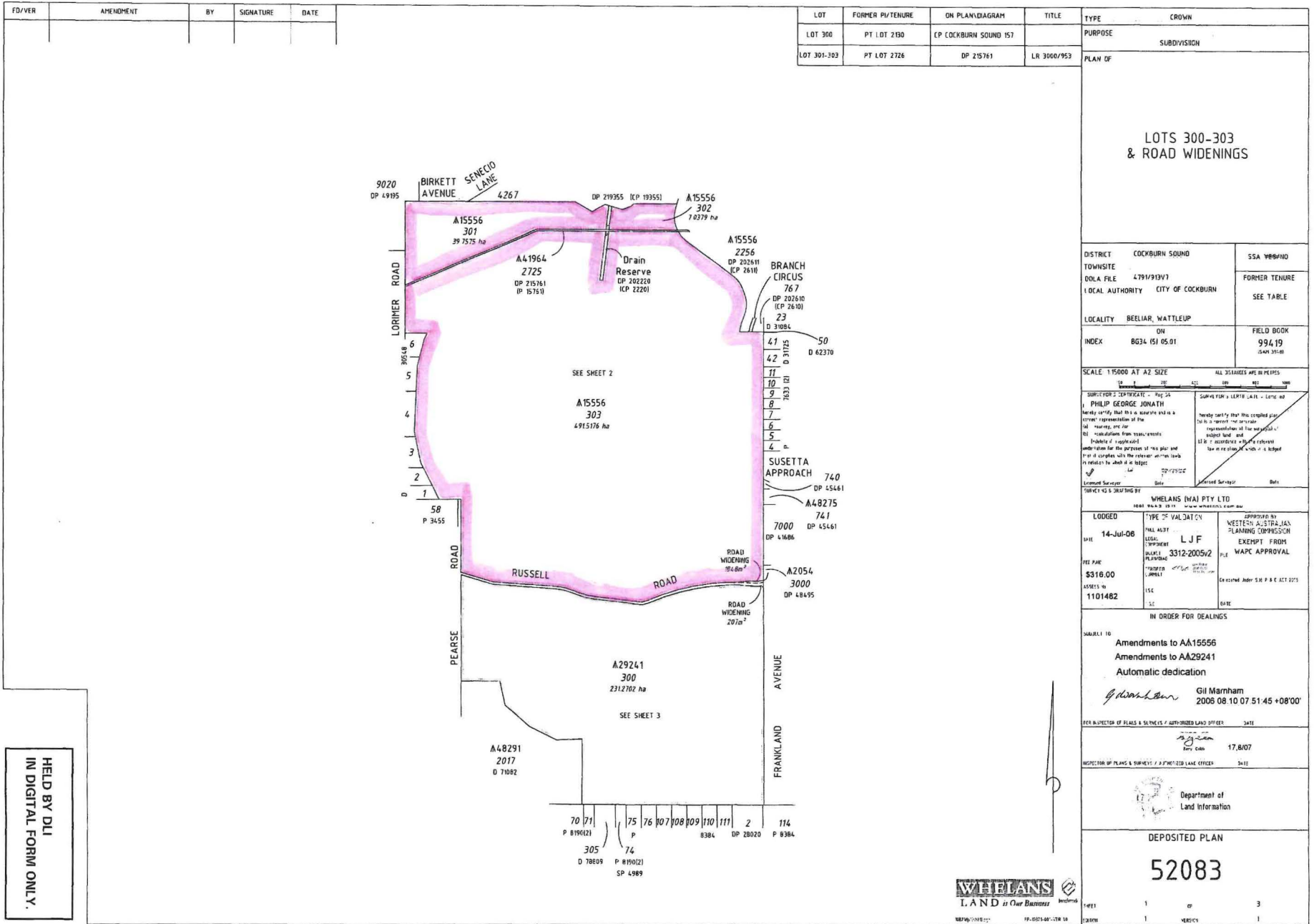

HELD BY DLI IN DIGITAL FORM ONLY.



TL

LANDGATE COPY OF ORIGINAL NOT TO SCALE Fri Sep 26 10:38:53 2008 JOB 31052857

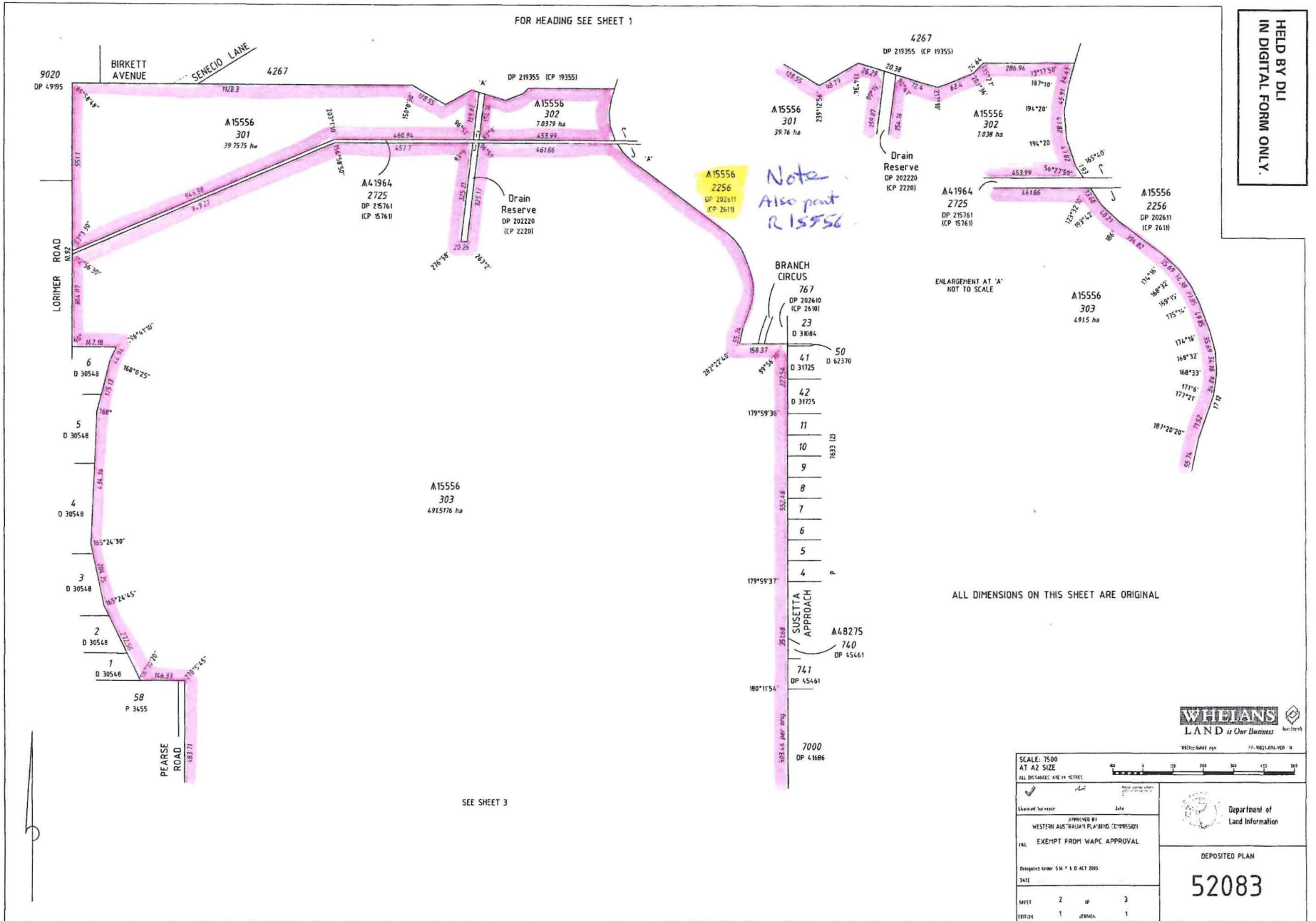

HELD BY DLI
IN DIGITAL FORM ONLY.



SCALE: 7500 AT A2 SIZE			
ALL DIMENSIONS ARE IN METRES			
Drawn by	July	 Department of Land Information	
APPROVED BY WESTERN AUSTRALIAN PLANNING COMMISSION			
EXEMPT FROM WAPC APPROVAL		DEPOSITED PLAN	
Designated under S 111 of ACT 2005		52083	
DATE		SHEET	2 of 3
FIGURE	1	VERSION	1

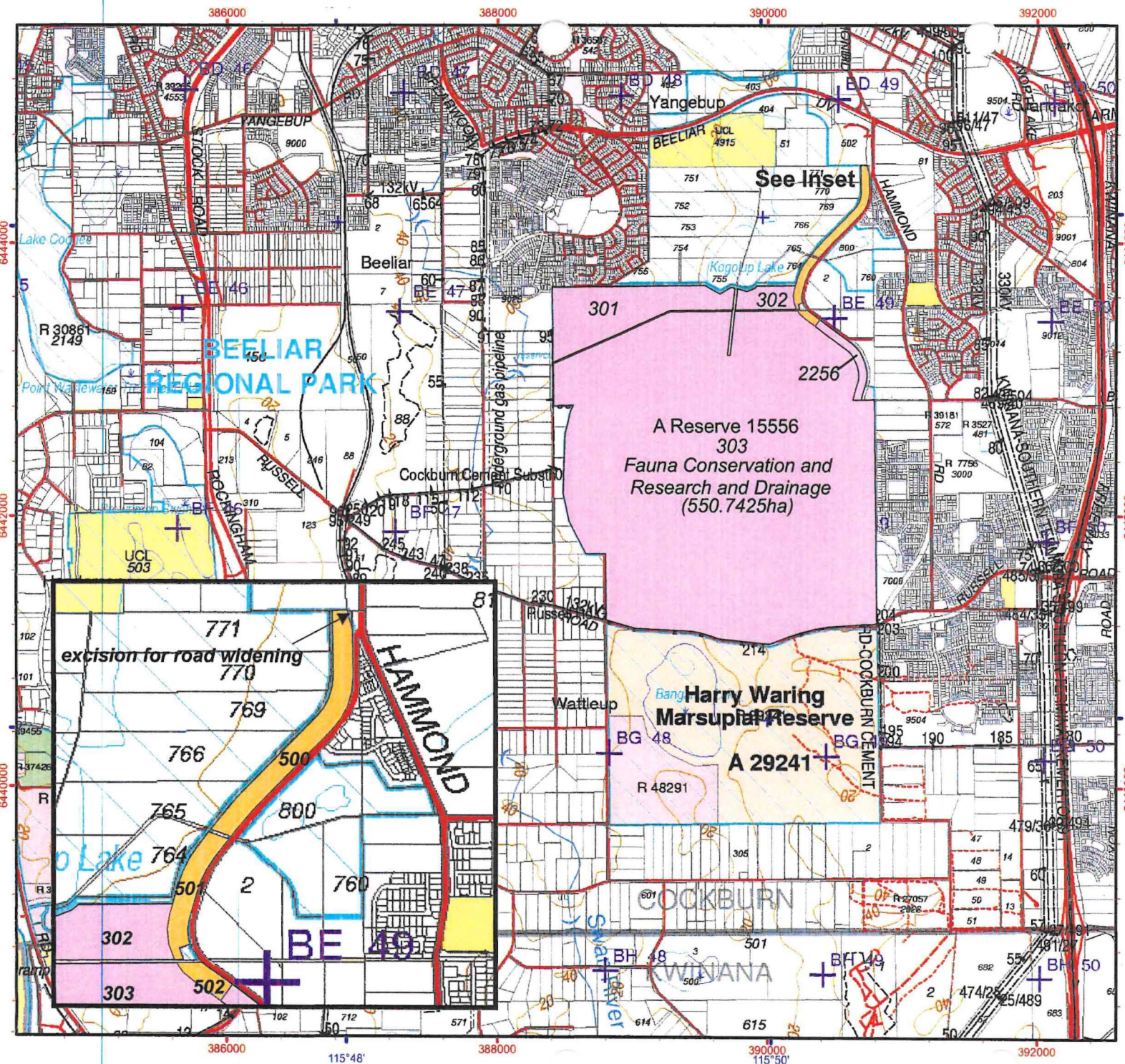

Legend

- March_Customer_Advice_amendment
- Reserve_15556



1:40,000 (A4)

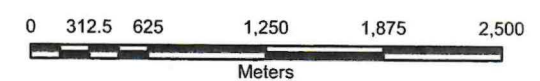

Projection: Universal Transverse Mercator
MGA Zone 50. Datum: GDA94

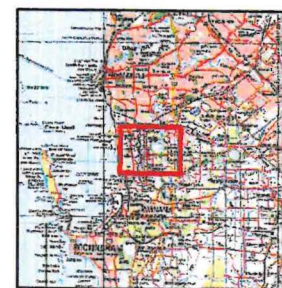

Produced by the
Department of
Environment and Conservation

Graticule shown at 2 minutes intervals
Grid shown at 2000 metre intervals

The Dept. of Environment and Conservation does not guarantee that this map is without flaw of any kind and disclaims all liability for any errors, loss or other consequences which may arise from reliance on any information displayed

LANDGATE COPY OF ORIGINAL NOT TO SCALE Tue Jun 15 14:15:09 2010 JOB 34646959

VERSION	AMENDMENT	AUTHORISED BY	DATE

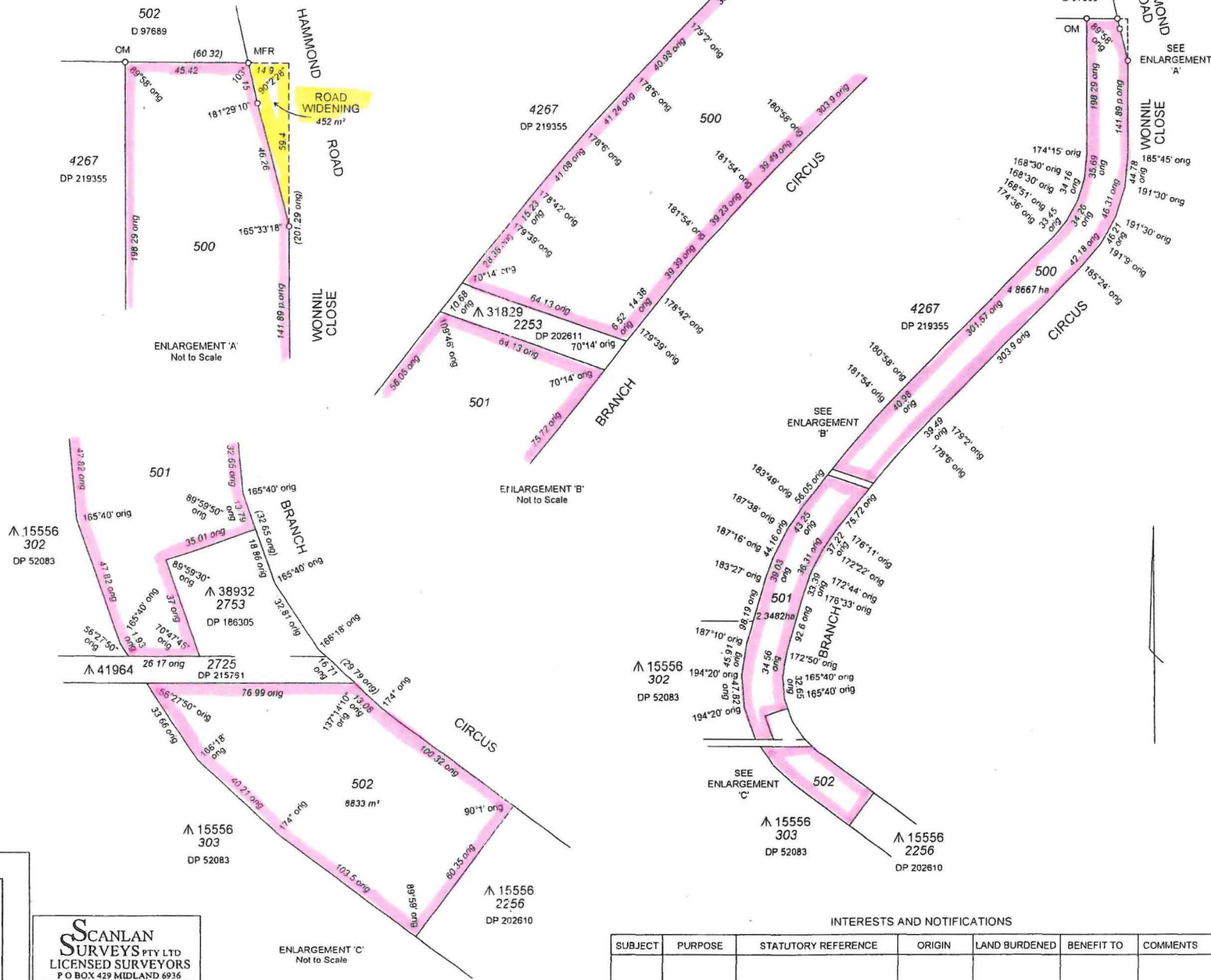

TYPE		CROWN	
PURPOSE		SUBDIVISION	
PLAN OF			
LOTS 500, 501, 502 AND ROAD WIDENING			
DISTRICT	COCKBURN SOUND	SSA NO	FORMER TENURE
TOWNSHIP		FILE	LOT 2256
LOCAL AUTHORITY	CITY OF COCKBURN	LOCAL AUTHORITY	DP 202611
LOCALITY	BEELIAR	LOCALITY	LR 3139/965
INDEX	ON BG34(2)12 05 BG34(2)12 04	INDEX	108794
SCALE 1:4000 @ A2			
0m 40m 80m 160m			
SURVEYOR'S CERTIFICATE - Page 54		SURVEYOR'S CERTIFICATE - Completed	
W M SCANLAN			
I hereby certify that this plan is accurate and is a correct representation of the actual survey and/or calculations from measurements taken in the field and is in accordance with the relevant law in relation to which it is lodged.		I hereby certify that this copy is a true and correct representation of the original plan and is in accordance with the relevant law in relation to which it is lodged.	
W M Scanlan Licensed Surveyor			
SURVEY FIRM			
SCANLAN SURVEYS			
LODGED DATE	11-Nov-08	TYPE OF VALIDATION	FULL AUDIT LEGAL CERTIFICATION GGM
FEE PAID	N/A	DELETED	1770-2005/16
ASSESS NO	N/A	EXEMPT FROM	FILE VAPC APPROVAL
IN ORDER FOR DEALINGS			
SUBJECT TO			
- Reserve Action			
- Section 28(1) LAA Automatic Dedication			
FOR INSPECTION OF PLANS & SURVEYS / AUTHORIZED LAND OFFICER DATE			
APPROVED			
23-3-2010			
INSPECTOR OF PLANS & SURVEYS / AUTHORIZED LAND OFFICER DATE			
Landgate Western Australian Land Information Authority			
DEPOSITED PLAN			
62437			
SHEET 1 OF 1			
VERSION 1			

INTERESTS AND NOTIFICATIONS						
SUBJECT	PURPOSE	STATUTORY REFERENCE	ORIGIN	LAND BURDENED	BENEFIT TO	COMMENTS

HELD BY LANDGATE IN DIGITAL FORM ONLY.

SCANLAN SURVEYS PTY LTD
LICENSED SURVEYORS
P O BOX 429 MIDLAND 6916
PH: 08 9250 2261 FAX: 08 9274 6206
Email: surveys@scanlansurveys.com.au
8215 081 GC



Government of **Western Australia**
Department of **Regional Development and Lands**

Lands Division

Your ref: 2002F001804/2
Our ref: 00567/2008 (Job No. 082206)
Enquiries: Neville Watson Ph: (08) 9347 5103
Fax: (08) 9347 5002
neville.watson@lands.rdl.wa.gov.au

14 January 2010

Jacinta Overman
A/Manager, Community and Regional Parks Branch
Department of Environment and Conservation
PO Box 1535
FREMANTLE WA 6959

Dear Ms Overman

EXCISION OF LAND FROM CLASS 'A' RESERVE 15556, FOR WIDENING OF HAMMOND ROAD, SUCCESS - CITY OF COCKBURN

Please note that the proposal to excise a small portion of land from Class 'A' Reserve 15556 has now passed the Parliamentary process.

Documents amending Class 'A' Reserve 15556 to exclude land required for dedication as part of Hammond Road, as above, were lodged at Landgate on 12th January 2010. The documents have been registered as dealing number L198830-L198831, for your information.

I enclose a copy of relevant Deposited Plan 62437, which provides for the road widening, and also the redescription of existing reserve Lot 2256, to now comprise Lots 500, 501 and 502 on the said plan. A current copy of Landgate's 'smartplan', showing the location of the subject land, is also enclosed.

Note, the lodged documents are now subject to examination by Landgate examiners. Subject to the examiners satisfaction with the lodged documents, the road widening on the plan is dedicated as part of Hammond Road, with effect from the date of registration, being 12th January 2010.

In the meantime, if you want to enquire concerning progress in this matter, you can contact Landgate's Progress and Issuing direct on telephone 9273 7314.

Yours Sincerely

NEVILLE WATSON
for **MANAGER**
STATE LANDS - METROPOLITAN
LANDS DIVISION

082206nw06

(SWAN COASTAL DIST)
SWAN REGION

Customer Advices for Reserve Actions
1/03/2010 - 31/03/2010

City of Cockburn 1/03/2010 - 31/03/2010

Reserve No.	Land Description	DPI File No.	Volume/Folio	Action	Document No.	Registered	Street Name	Area	Public Plans
15556	Lot 2256 on Deposited Plan 202611	00567-2008-01RO	3139-965	Amendment of Reserve to To now comprise Lots 500, 501 and 502 on Deposited Plan 62437 in lieu of Lot 2256 on Deposited Plan 202611 and its area being reduced to 550.7425 hectares accordingly in accordance with section 45(4) of the Land Administration Act 1997.	L266162	23/03/2010	Between Russell Road and Burkett Avenue in Beeliar/Wattleup (Lots 301 to 303) and adjoining Hammond Road, Wonnill Close and Branch Circus, in Beeliar (Lots 500, 501 and 502).	550.7425 Ha	BG34(2) 12.04 & 12.05 and BG34(5) 05.01
50526	Lot 500 on Deposited Plan 60401 Lot 501 on Deposited Plan 60401	50599-2007-01RO	0000-000 0000-000	Reserve Creation for the designated purpose of "Pedestrian Accessway".	L247142	03/03/2010	Phoenix Road, Bibra Lake	18 sqm	BG34 (2) 10.09

THOMSONS LAKE N R.

WHITE FOLDER - 16/6/10
SHAPEFILE - 16/6/10.
MAPINFO - 16/6/10
TENIS - 16/6/10.

ROAD WIDENING
ON LOT 500
REDUCTION OF
0.1032 ha.

(assuming resurvey caused
additional loss of 0.0230m²)

2009/004748 ..

DOC NO K374437

2005F004074 V01

BOKHO,

CUSTOMER ADVICE MARIO COMPLETED
ALL DATABASES AMENDED & UPDATED

R. Doice
16/6/10