

RESERVE ACTION SHEET - CONSERVATION RESERVES

RESERVE No. 16262

REASON FOR ACTION

- Addition to the estate of a class 'C' nature reserve vested in the NPNCA for the purpose of "Conservation of Flora and Fauna". Area: 80.9371 ha
- Reserve was previously unvested, with the purpose "Public Utility". It is largely surrounded by cleared land and is located in a forest-woodland transition zone. It contains a wide variety of vegetation and provides habitat for a number of mammals and birds. It is undisturbed and occurs in a region with limited conservation estate.
- Gazettal date: 3.2.1998 See folios 41 and 42
- Plans at folios 43 and 45

	OFFICER	ACTION	
1	RESERVES <i>sc</i>	- Fill in above details - Attach copies of gazettal notices to file	 ✓ ✓
2	INDEX CLERK, RECORDS	- Index reserve's name - Index reserve's number	 _____
3	RESERVES CLERK <i>sc</i>	Send copies of gazettal notices and Map to: - Lisa Wright, Woodvale - District Manager, Walpole - Regional Manager, SFR	 ✓ ✓ ✓
4	CONSERVATION ESTATE OFFICER	To note: <i>S. Colliss 25.3.98</i>	
5	LAND ACQUISITIONS OFFICER	To note:	
6	MANAGER, PLANNING & VISITOR SERVICES	To note:	
7	DIRECTOR, NATURE CONSERVATION/ NATIONAL PARKS	To note:	

RESERVE ACTION SHEET - CONSERVATION RESERVES

RESERVE No. 16262

REASON FOR ACTION

- The area of class C Reserve No. 16262 (NPNCA, 'Conservation of Flora and Fauna) has been increased by about 3.3 ha due to a recalculation of its boundaries. Area: 84.24 ha.
- Technological advancements within DOLA since the original gazettal of this reserve has enabled a more accurate spatial definition of it.
- Date of DOLA's advice: 16 December 1999 See folio: 48
- Plans at folios: 49 to 51

OFFICER	ACTION	
1	CONSERVATION ESTATE OFFICER	- Fill in above details - Attach DOLA's advice to file Send copies of advice & maps to: - Lisa Wright, Woodvale - District Manager, Walpole - Regional Manager, SFR IUCN classification: 1a
	To note:	 16/3/00
2	INDEX CLERK, RECORDS	To note:
3	LAND ACQUISITIONS OFFICER	To note:
3.	MANAGER, PLANNING & VISITOR SERVICES	To note:
5	DIRECTOR, NATURE CONSERVATION	To note:

DOLA File: 02124-1968-01RO.

Reserve No: 29437 (Fitzgerald Lot 31) "Recreation" to include Lot 48 (formerly Lot 32) as surveyed on Land Administration Plan 10950 and of its area being increased to 12.5123 hectares accordingly.

Public Plan/s: Fitzgerald Townsite Mistletoe Way

Local Authority: Shire of Ravensthorpe.

DOLA File: 02923-1980-01RO.

Reserve No: 37326 (Sussex Locations 4744, 4841 and 4994) "Public Recreation" to include Location 5127 (formerly Lot 15 on Plan 21964) and of its area being increased to 9.1466 hectares accordingly.

Public Plan/s: BF29 (10) 2.1 and 2.8 and BF28 (2) 6.40 corner Wallcliffe and Caves roads

Local Authority: Shire of Augusta/Margaret River.

DOLA File: 01156-1981-01RO.

Reserve No: 37624 (at Kojonup) "Frail Aged Centre" to comprise Lot 350 as surveyed and shown bordered red on Land Administration Plan 19631 in lieu of Lot 320 and of its area being increased to 8247 square metres accordingly.

Public Plan/s: BJ29 (2) 9.17 Soldier Road

Local Authority: Shire of Kojonup.

DOLA File: 02513-1981-01RO.

Reserve No: 37943 (at Kojonup) "Public Recreation" to comprise Lot 352 as surveyed and shown bordered red on Land Administration Plan 19631 in lieu of Lot 322 and of its area being increased to 1.1078 hectares accordingly.

Public Plan/s: BJ29 (2) 9.17 and 10.17 Thorn Place

Local Authority: Shire of Kojonup.

DOLA File: 02684-1988-01RO.

Reserve No: 40791 (at Kojonup) "Administration Centre" to comprise Lot 353 as surveyed and shown bordered red on Land Administration Plan 19631 in lieu of Lot 328 and of its area being increased to 1.763 hectares accordingly.

Public Plan/s: BJ29 (2) 9.17 and 10.17 Pensioner Road

Local Authority: Shire of Kojonup.

DOLA File: 01622-1992-01RO.

Reserve No: 42298 (at Nanson) "Park" to comprise Lots 104 and 105 as surveyed and shown bordered red on Land Administration Plan 19664 in lieu of Lot 102 and of its area being reduced to 3.9467 hectares accordingly.

Public Plan/s: Nanson Townsite cnr East Terrace and Eastough Street

Local Authority: Shire of Chapman Valley.

A. A. SKINNER, Chief Executive.

LA901*

LAND ACT 1933

CHANGE OF PURPOSE OF RESERVES

Made by His Excellency the Governor under Section 37.

The purposes of the following reserves have been changed.

DOLA File: 02040-1989-01RO.

Reserve No. 4073 (Boulder Lot 4613) being changed from "Police" to "Licensing and Other Transport Related Activities".

Public Plan/s: CF37 (2) 30.34 Piesse Street

Local Authority: City of Kalgoorlie/Boulder.

DOLA File: 05009-1914-03RO.

Reserve No. 7125 (Cockburn Sound Locations 23, 46, 330, 408, 409, 526, 2778, 4364 and Mundijong Lot 144) being changed from "Health Purposes" to "Health (Hospital and Allied Services)".

Public Plan/s: BG33 (10) 5.6, (2) 21.26 and 21.27 South Western Highway

Local Authority: Shire of Serpentine/Jarrahdale.

DOLA File: 11880-1909-01RO.

Reserve No. 12548 (Dumbleyung Lot 65) being changed from "Road Board Office" to "Depot Site".

Public Plan/s: Dumbleyung Townsite Taylor Street

Local Authority: Shire of Dumbleyung.

DOLA File: 04355-1915-01RO.

Reserve No. 16262 (Hay Location 3878) being changed from "Public Utility" to "Conservation of Flora and Fauna".

Handwritten notes: 25.02.98, 25.02.98 see p. 43, 45, 46. 2. Mv have IMB for your action

Public Plan/s: Tenterden SW (25) Martagallup Road

Local Authority: Shire of Plantagenet.

This Reserve is automatically vested in the National Parks and Nature Conservation Authority pursuant to Section 7 of the CALM Act 1984.

DOLA File: 02552-1935-01RO.

Reserve No. 21473 (Guilderton Lot 426) being changed from "Recreation" to "Recreation and Landscape Protection".

Public Plan/s: BF36 (2) 31.11 and 32.11 Whitfield Street

Local Authority: Shire of Gingin.

DOLA File: 00180-1937-01RO.

Reserve No. 21705 (Roe Location 1920) being changed from "Rifle Range" to "Conservation of Flora and Fauna".

Public Plan/s: Hyden and Kerrigan (50) Karlgarin Road East

Local Authority: Shire of Kondinin.

This Reserve is automatically vested in the National Parks and Nature Conservation Authority pursuant to Section 7 of the CALM Act 1984.

DOLA File: 06111-1951-01RO.

Reserve No. 28055 (Nanson Lots 106, 107, 108 and 109) being changed from "Camping, Park and Recreation" to "Park and Recreation".

Public Plan/s: Nanson Townsite cnr Geraldton-Yuna Road and Eastough Street

Local Authority: Shire of Chapman Valley.

DOLA File: 03803-1967-01RO.

Reserve No. 29135 (Swan Location 8300) being changed from "Public Recreation" to "Use and Requirements of the City of Belmont".

Public Plan/s: BG34 (2) 18.25 Hardey Road

Local Authority: City of Belmont.

DOLA File: 01491-1975-01RO.

Reserve No. 33991 (Northam Lot 376) being changed from "Police" to "Licensing and Other Transport Related Activities".

Public Plan/s: BH35 (2) 21.18 Fitzgerald Street

Local Authority: Town of Northam.

DOLA File: 01527-1976-01RO.

Reserve No. 34045 (Swan Location 9466) being changed from "Police" to "Licensing and Other Transport Related Activities".

Public Plan/s: BG34 (2) 22.31 and 22.32 Padbury Terrace

Local Authority: Shire of Swan.

DOLA File: 01052-1974-02RO.

Reserve No. 34561 (Cockburn Sound Location 4226) being changed from "School and Telecommunications Facility" to "School".

Public Plan/s: BG34 (2) 10.11 and 11.11 North Lake Road

Local Authority: City of Melville.

DOLA File: 02776-1983-01RO.

Reserve No. 38509 (Canning Location 3359) being changed from "Police" to "Licensing and Other Transport Related Activities".

Public Plan/s: BG34 (2) 19.20 Murray and Welshpool Roads

Local Authority: City of Canning.

DOLA File: 02155-1988-01RO.

Reserve No. 40717 (Margaret River Lot 213) being changed from "Public Utilities Services" to "Public Utilities Services and Access".

Public Plan/s: BF29 (2) 09.02 near Farelly Street

Local Authority: Shire of Augusta/Margaret River.

DOLA File: 01622-1992-01RO.

Reserve No. 42298 (Nanson Lots 104 and 105) being changed from "Park" to "Park and Recreation".

Public Plan/s: Nanson Townsite cnr East Terrace and Eastough Street

Local Authority: Shire of Chapman Valley.

**Customer Advices for Reserve Actions
1/12/1999 - 31/12/1999**

Shire of Plantagenet 1/12/1999 - 31/12/1999

Reserve No.	Land Description	DOLA File No.	Volume/Folio	Action	Document No.	Lodge Date	Street Name	Area	Public Plans
18262	Plantagenet Locallion 3878	04355-1915-01RO	3082-88	Amendment of Reserve to Reserve 18262 now comprises Hay Locallion 2388 on Land Administration Diagram 93674, in lieu of Plantagenet Locallion 3878	11304348	18/12/99	Martagallup Tenterden Road	84.2449 Ha	Tenterden SW
26279		02405-1901-01RO	3111-241	Management Order to Minister for Education, 161 Royal Street, East Perth, WA 6004, for the designated purpose of "High School Site"	11304306	08/12/99	Albany Highway (Mt Barker) near Morgans street	239.0891 Ha	BJ27 (10) 8.2
20279	Plantagenet Locallion 8869 and Plantagenet Locallions 7072 and 7340 on Office of Titles Diagram 35948 and Land Administration Diagram 81740 respectively.	01220-1991-01RO	3082-527	Amendment of Reserve to To now comprise Plantagenet Locallion 7939 on Land Administration Plan 19918 in lieu of Locallion 8869, and Locallions 7072 and 7340 and its area being recalculated at 239.0891 hectares.	11304303	08/12/99	Woogenlup Road	239.0891 sqm	BJ27 (10) 8.2
26279	Plantagenet Locallions 7939, 7072 and 7340	02405-1901-01RO	3082-527	Change of Purpose to "High School Site"	11304304	08/12/99	Woogenlup Road	239.0891 sqm	Mount Barker NE (25), BJ27 (10) 8.2



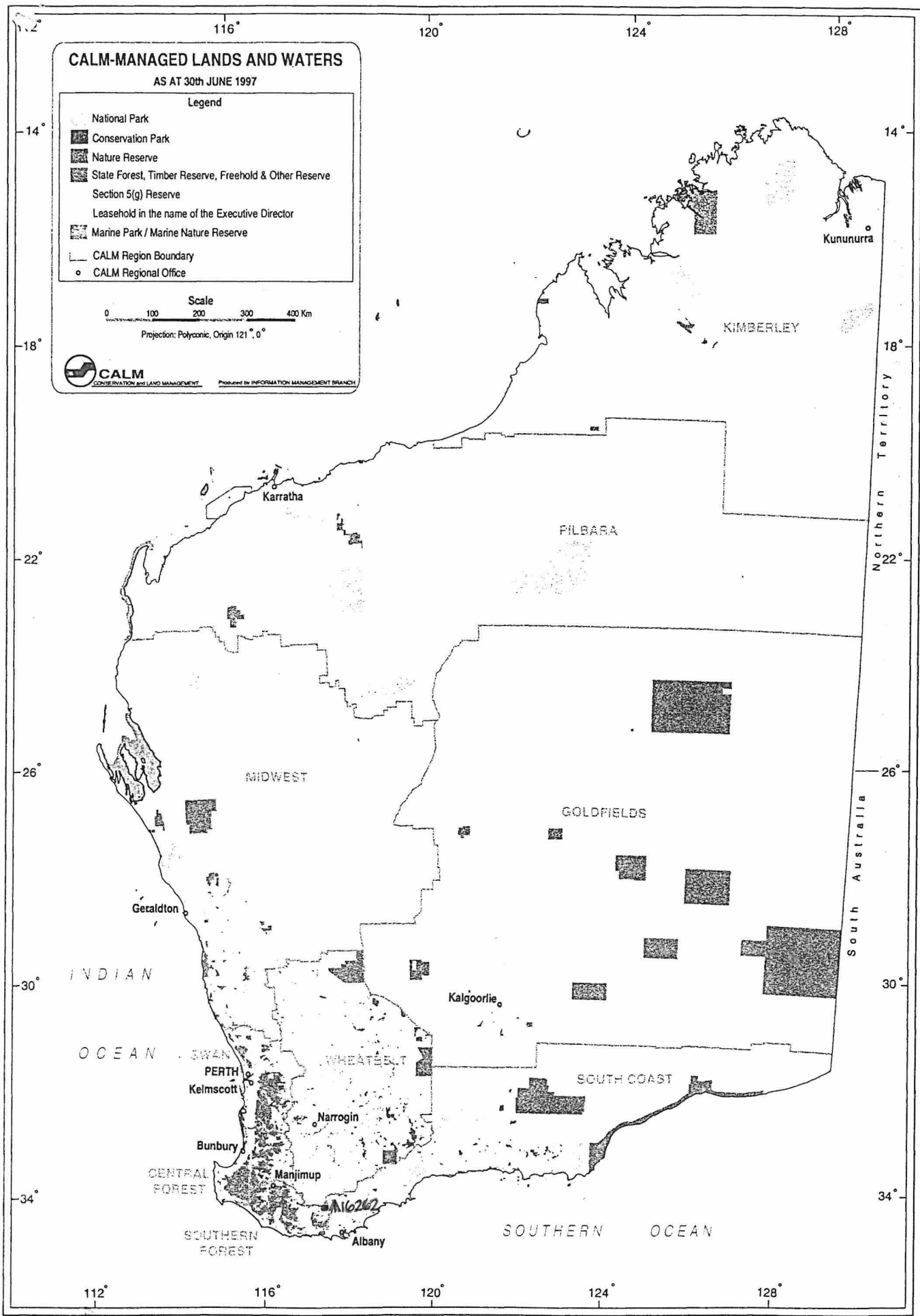





1/ G. HOARE
 FOR PLAN + TO
 AMEND YOUR
 RECORDS IF NECESSARY,
 THANK YOU.
 C. BATHGATE 22/2/00
 GJM 19/3



CALM-MANAGED LANDS AND WATERS

AS AT 30th JUNE 1999

Legend

-  National Park
-  Conservation Park
-  Nature Reserve
-  State Forest, Timber Reserve, Freehold & Other Reserve
-  Section 5(g) Reserve
-  Leasehold in the name of the Executive Director
-  Marine Park / Marine Nat Res / Marine Management Area
-  CALM Region Boundary
-  CALM Regional Office

Scale
0 100 200 300 400 Km

Projection: Polyconic, Origin 121°, 0°



Produced by INFORMATION MANAGEMENT BRANCH

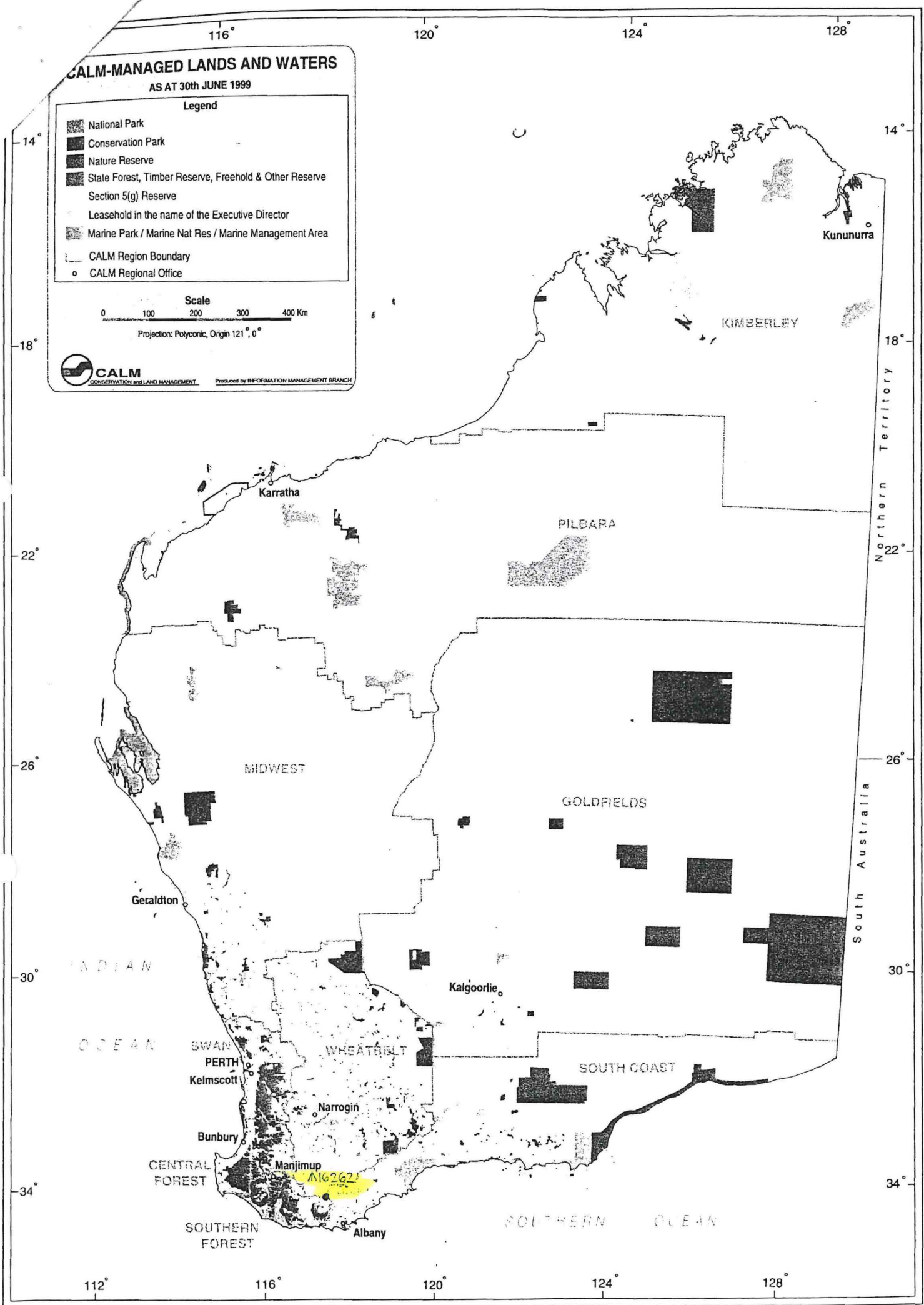

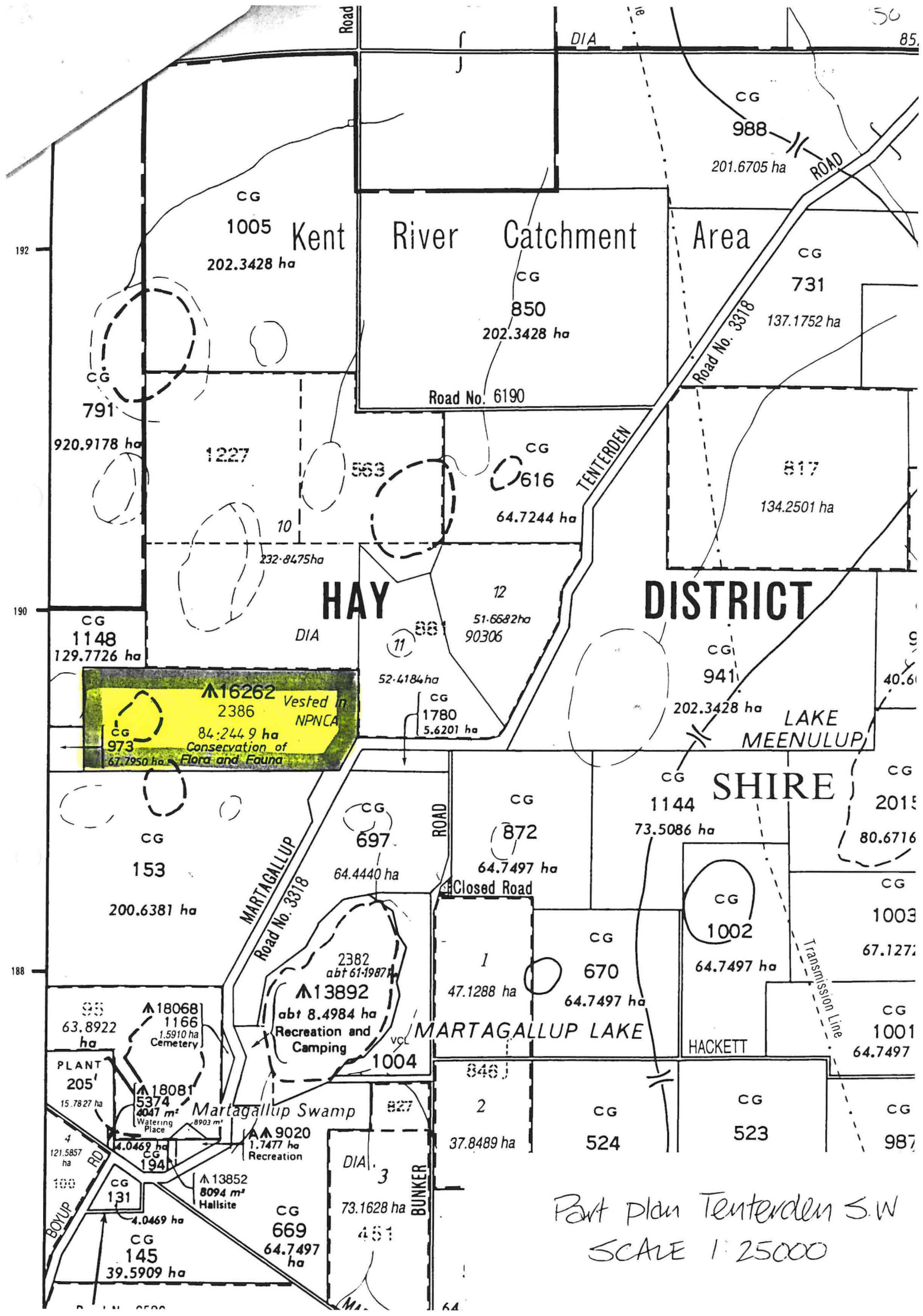

Part plan Tenterden S.W
 SCALE 1:25000

1148
DIA 45994

973
DIA 45742

153
DIA 17364

881
DIA 45529

L.T.O. Lot 10
L.T.O. Dia. 90306

L.T.O. Lot 11
L.T.O. Dia. 90306

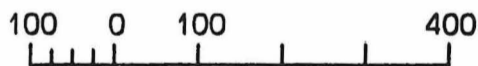
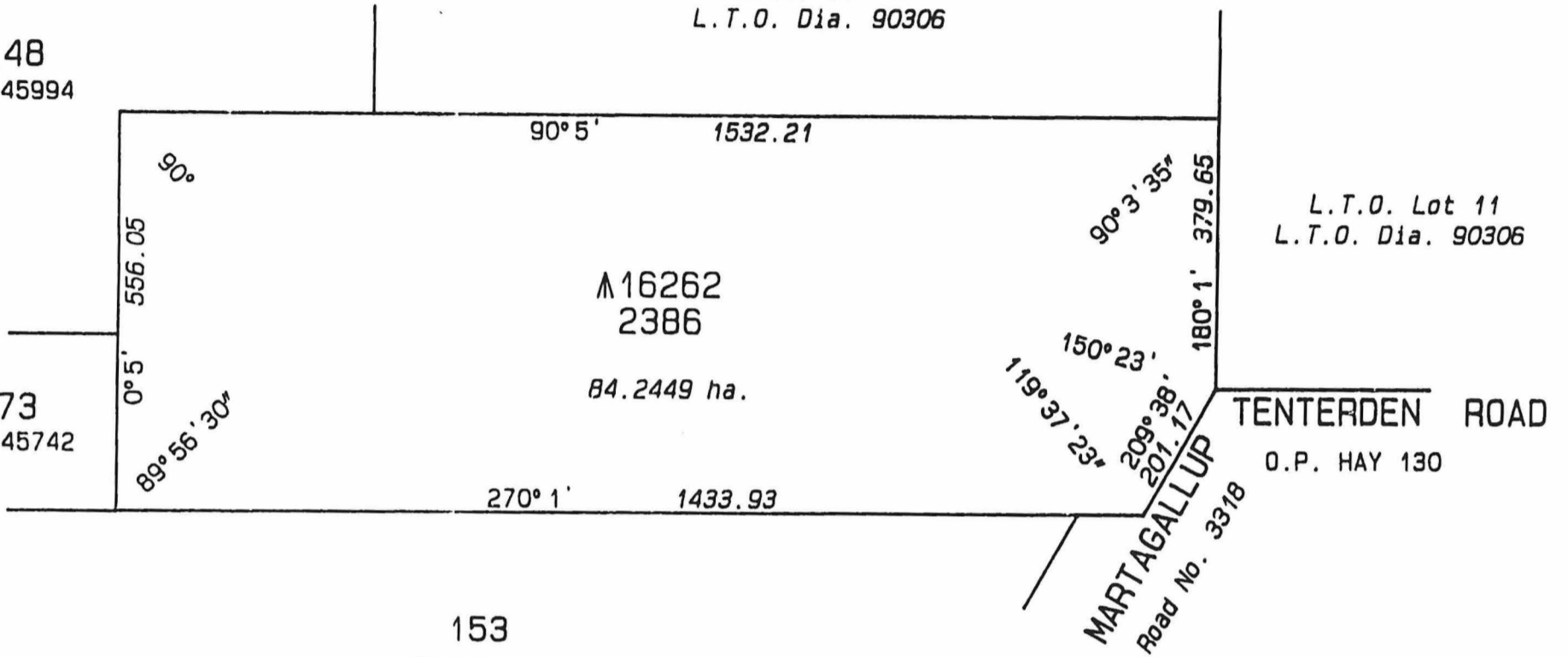

COMPILED FROM O.P. HAY 130, DIAGRAMS 17364, 45742, 45994 & L.T.O. DIAGRAM 90306

DISTRICT HAY		LOCATION 2386		FILE 4355/915
SITE				SCALE 1: 10000 ALL DISTANCES ARE IN METRES
Surveyor's Certificate - (REG 54) I hereby certify that this is a correct representation of the survey plan and measurements recorded in the field book lodged for the purposes of this certificate and that it complies with the relevant provisions of the Survey Act in relation to which it is lodged.	LOCAL AUTHORITY SHIRE OF PLANTAGENET	APPROVED BY WESTERN AUSTRALIAN PLANNING COMMISSION		IN ORDER FOR DEALINGS SUBJECT TO <u>RESERVATION</u> FOR AUTHORIZED LAND OFFICER <u>John Mackay</u> 6-7-98
	LOCALITY MARTAGALLUP	FILE _____		
	PUBLIC PLAN(S) TENTERDEN S.W. (25)	FOR CHAIRMAN _____ DATE _____		APPROVED
	SURVEY INDEX PLAN(S) TENTERDEN S.W. (25)	TYPE OF VALIDATION		AUTHORIZED LAND OFFICER _____ DATE _____ LAND ADMINISTRATION ACT DIAGRAM 93574
	FIELD BOOK COMPILED PAGE _____	FULL AUDIT _____ DATE _____ LEGAL COMPONENT <u>TYANVILLE</u> DATE <u>2-7-98</u> CERTIFIED CORRECT <u>8</u> DATE <u>6-7-98</u>		
	AZIMUTH FROM DIAGRAM 17364	EARLY ISSUE <input type="checkbox"/> F.S.C. No. _____ LODGED DATE 5-4-98 MBJ		
Surveyor's Certificate - COMPILED PLAN I hereby certify that this is a correct and accurate representation of the land of the subject land; and in accordance with the relevant law in relation to which it is lodged.	<u>Scanlon</u> 24/4/1998 Surveyor Date		 DOLA DEPARTMENT OF LAND ADMINISTRATION	