

NATURE RESERVE

RESERVE NO: 16779

GOVERNMENT GAZETTE
Date Page No.

FILE NUMBER: 514/68

PURPOSE: Water & Cons. of
Flora & Fauna 15.8.69 2347

NAME: Yalyering Well

CLASS (Land Act):

AREA: 7.2843 ha

VESTING: Min. for Water
Supplies 15..8.69 2335

LOCATION NO(S): Avon Locn. 13407

CLASSIFICATION:
(Wildlife Act
Section 12A)

LITHO: 25/80 A2

LOCAL AUTHORITY: KELLERBERRIN SHIRE

Notes:

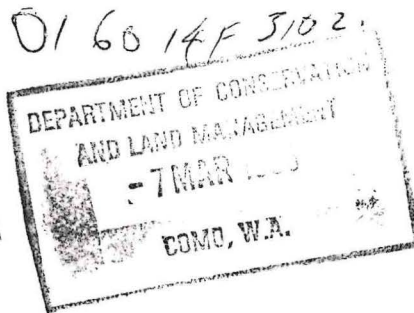

Your Ref: 016014F3102
Our Ref: 2785/989
Telephone: 273 7287
Enquiries: Ms Assunta Dinardo

Executive Director
Department of Conservation
and Land Management

INCLUSION OF RESERVE 16779 INTO "A" CLASS RESERVE 563

p. 62
Further to your memo dated 12 January, 1994 I advise that Reserves Bill action has now been completed with the cancellation of Reserve 16779 and its former area included into Class "A" Reserve 563 (Avon Location 9380 , 13407 and 13408) "Conservation of Flora and Fauna" and with its area being increased to 94.4156 hectares accordingly.

p. 71
Notice to this effect was published in the Government Gazette dated 20 December, 1994 and I enclose a print delineating the said area.

Assunta
S. BURGESS
A/MANAGER
ACQUISITIONS, ROADS AND RESERVES
LAND OPERATIONS DIVISION

2 March, 1995

3adwk5

Reserves Clerk

CLERK, WOODVALE - F.I.

LA401

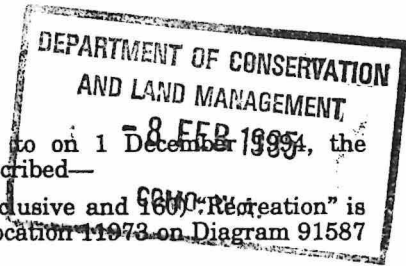
**RESERVES ACT (No. 2) 1994
(No. 66 of 1994)**

It is hereby notified that pursuant to the above Act assented to on 1 December 1994, the undermentioned reserves have been dealt with in the manner described—

1. Class "A" Reserve 1669 (Melville Suburban Lots 117 to 129 inclusive and 160) "Recreation" is amended by the excision of that area now comprised in Swan Location 11973 on Diagram 91587 with its area being reduced to 23.9458 hectares.
Public Plan: BG34 (2) 10.20
DOLA File: 2966/976
2. Class "A" Reserve 40250 (Sussex District) "National Park" is amended to now comprise Locations 4975 and 4976 as shown on Reserve Diagram 1215 and its area being reduced to about 683.1593 hectares.
Public Plans: BF29 (10) 6.8
DOLA File: 1799/987
3. Class "A" Reserve 27004 (Victoria District) "National Park" is amended by the excision of that area now comprised in Location 11987 on Plan 18484 with its area being reduced to 183,004.4018 hectares.
Public Plans: BD46(2) 27.11, 27.12, BD46(10) 5.2, Gantheaume (50) and Murchison (50)
DOLA File: 3139/954V5
4. Class "A" Reserve 35918 (Jarmura Location 1) "Conservation of Flora and Fauna" is amended by the inclusion of Location 2 on Reserve Diagram 518 with its area being increased to 17729.0000 hectares.
Public Plan: McLarty Hills (250)
DOLA File: 2297/978
5. Class "A" Reserve 39399 (Kojonup District) "Conservation of Flora and Fauna" is amended to now comprise Location 9307 on Diagram 91227 in lieu of Location 9305 with its area being increased to 138.7441 hectares.
Public Plan: Carlecatup NW (25)
DOLA File: 2366/982
6. (i) Class "A" Reserve 28933 (Dunsborough Lots 174 and 178) "Recreation" is cancelled.
Public Plan: BF30 (10) 2.1
DOLA File: 4110/967
(ii) Class "C" Reserve 24165 (Dunsborough Lot 106) "Fish Processing Depot" is cancelled.
Public Plan: BF30 (2) 8.05
DOLA File: 5130/954
(iii) Class "C" Reserve 26857 (Sussex Location 4359) "Recreation" is cancelled.
Public Plan: BF30(10) 2.2
DOLA File: 132/958
(iv) Class "A" Reserve 21751 (Sussex Locations 1241, 4717, 4718 and 4719) "Recreation and Camping" is amended by the excision of those areas now comprised in Locations 4969, 4970 and 4971 on Reserve Plan 413, with its area being reduced to about 66.3132 hectares.
Public Plans: BF30(10) 1.2 and 2.2, BF30(2) 8.05 and 8.06
DOLA File: 8209/913
(v) Class "A" Reserve 21629 (Sussex Locations 947 and 4954 and Dunsborough Lot 264) "Conservation and Recreation" is amended to include Sussex Locations 4359, 4969, 4970, 4971 and 4972 and Dunsborough Lots 106, 174 and 178 on Reserve Plan 413 with its area being increased to about 570, 9231 hectares.
Public Plans: BF30(10) 1.2 and 2.2, BF30(2) 8.05 and 8.06
DOLA File: 1424/977V3
7. (i) Class "A" Reserve 17671 (Kojonup Location 7669) "Recreation Picnic Ground" is cancelled.
Public Plan: Badgebup Townsite
DOLA File: 990/912
(ii) Class "A" Reserve 42677 (Kojonup Locations 6790, 7647 and Badgebup Lots 57 and 61) "Landscape Protection" is amended by the inclusion of Kojonup Location 7669 with its area being increased to 200.5826 hectares.
Public Plan: Badgebup Townsite
DOLA File: 2221/986
8. (i) Class "C" Reserve 16779 (Avon Location 13407) "Water and Conservation of Fauna" is cancelled.
Public Plan: Yorkrakine (25) SE
DOLA File: 2785/989
(ii) Class "A" Reserve 563 (Avon Location 9380 and 13408) "Conservation of Flora and Fauna" is amended by the inclusion of Location 13407 with its area being increased to 94.4156 hectares.
Public Plan: Yorkrakine (25) SE
DOLA File: 4353/915

2: MS. COPIES - for either pls.

14.2.95

MKR
Sujolio 74

RESERVES BILL

No. 2

1994

BRIEFING NOTES



67

CLAUSE 12

Reserve No. 563 in the Shire of Kellerberrin

25 12. (1) Reserve No. 16779, classified as of Class C, containing 7.284 3 hectares and set apart for "Water and Conservation of Fauna", and vested in the Minister for Water Resources, is cancelled.

(2) Reserve No. 563, classified as of Class A, containing 87.131 3 hectares, set apart for "Conservation of Flora and Fauna" vested in the Authority, and shown on Diagram No 3207, is amended by including the area referred to in subsection (1) (also shown on Diagram No. 3207) so that the reserve contains an area of 94.415 6 hectares.

CLAUSE 12

Class "C" Reserve 16779 is set apart for the purpose "Water and Conservation of Flora" and is vested in the Minister for Water Supplies (Water Authority of Western Australia). The reserve has an area of 7.2843 hectares and WAWA has confirmed that it is no longer required for water supply purposes.

Reserve 16779 is surrounded by Class "A" "Conservation of Flora and Fauna" Reserve 563 which is vested in the National Parks and Nature Conservation Authority and CALM has agreed to the lands being amalgamated.

The Kellerberrin Shire Council and Department of Minerals and Energy have no objection to the proposal.

In view of the "A" Classification over Reserve 563, Reserves Bill action is necessary to complete the addition.

ELECTORAL DISTRICT OF MERREDIN
AGRICULTURAL ELECTORAL REGION
SHIRE OF KELLERBERRIN

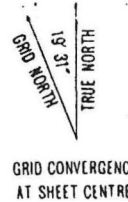
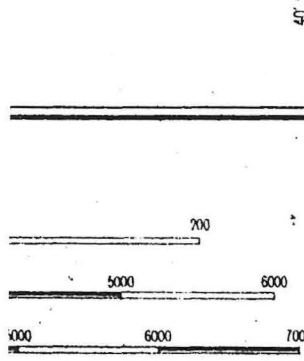
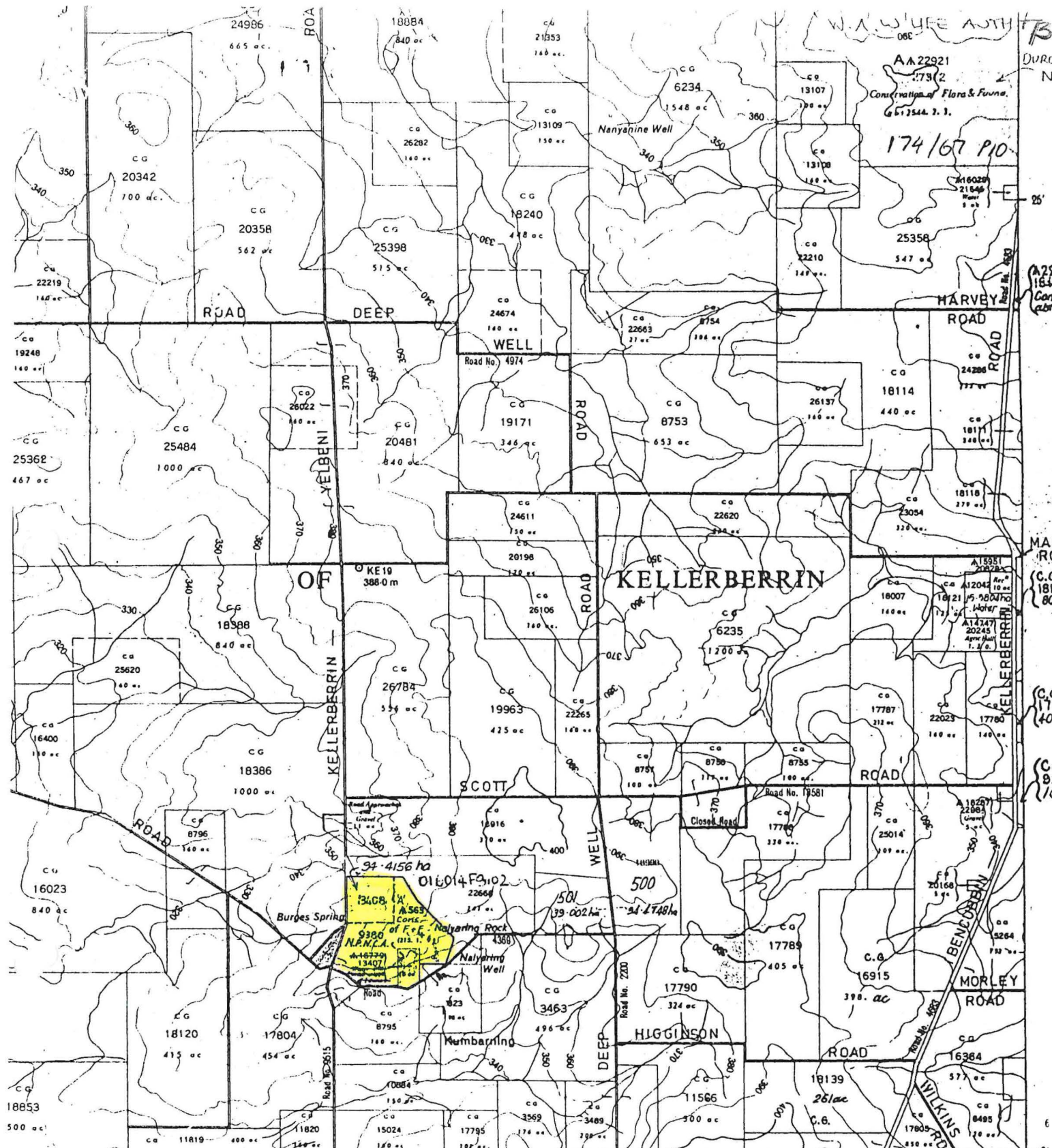

SHEET 2435-III

Pt. YORKRAKINE

Scale 1:50 000
INDEX TO ADJOINING SHEETS

I Wyalatchem 2435	IV Yelbeni 2435	I Trayning
-------------------------	-----------------------	---------------