

RESERVE ACTION SHEET: CONSERVATION RESERVES

RESERVE No. 17911

LOCAL GOVERNMENT: Shire of Kulin

NAME: Un-named 5(1)(h) reserve

PURPOSE: Conservation and Seed Orchard

VESTING: Conservation Commission

ACTION

Transfer of Reserve 17911, being Lot 21805 on Plan 146079, to the Conservation Commission and amend the purpose from 'Water' to 'Conservation and Seed Orchard'.

Total Area: 10.752ha

REASON FOR ACTION

In January 2002 DEC sought to acquire management of Reserve 17911 for the purpose of 'Conservation and Experimental Site'. Reserve 17911 was composed of Lots 14111 and 14112 on Plan 233561 and Lot 21805 on Plan 146079. Lots 14111, 14112 and part Lot 21805 were historically cleared and it was proposed that DEC would undertake revegetation trials on this land.

A subsequent site inspection in 2009 recommended that the cleared portions not be revegetated and instead sold to the adjacent land owners.

Since the revegetation trials could not be implemented the Wheatbelt region proposed the purpose of Reserve 17911 was to be changed to 'Conservation and Seed Orchard'.

The amended Reserve 17911 was vested in the Conservation Commission on the 22 January 2010.

Date of amendment: 22/1/2010

Maps: 16, 12,

Customer advice: 11

Proposal Summary: 7-8

IUCN classification:

1	LAND UNIT LEADER	To note	<i>DL 26/6/2012</i>
2	LAND UNIT	Send copies of advice and maps to: <ul style="list-style-type: none"> • Lisa Wright (Kensington) DIGITAL COPY • District Manager DIGITAL COPY • Regional Manager DIGITAL COPY Attach TENIS gazettal history to file Delete from District Proposals spreadsheets Create Conservation Commission summary	<div style="margin-bottom: 5px;"><i>NM 26/6/12</i></div> <div style="margin-bottom: 5px;"><i>NM 26/6/12</i></div> <div style="margin-bottom: 5px;"><i>NM 26/6/12</i></div> <div style="margin-bottom: 5px;"><i>NM 26/6/12</i></div> <div style="margin-bottom: 5px;"><i>NM 26/6/12</i></div> <div style="margin-bottom: 5px;"><i>NM 26/6/12</i></div>
3	DIRECTOR, PARKS AND VISITOR SERVICES	To note	
4	C.I.S.	Please rename file/create new file Keyword: Activity: Subject: Free text:	

**Customer Advices for Reserve Actions
1/11/2010 - 30/11/2010**

Shire of Kulin 1/11/2010 - 30/11/2010

Reserve No.	Land Description	DPI File No.	Volume/Folio	Action	Document No.	Registered	Street Name	Area	Public Plans
17911	Lot 14111 on Deposited Plan 146079 Lot 14112 on Deposited Plan 233561	07091-1921-02RO	3144-107 3144-109	Amendment of Reserve to To exclude Lot 14111 and Lot 14112 on Deposited Plan 233561 and its area decreased to 10.752 hectares accordingly.	L485578	22/11/2010	LAKE GRACE ROAD, KULIN.	10.752 Ha	KULIN (25) S.E JILAKIN (50)
17911	Lot 21805 on Deposited Plan 146079	07091-1921-02RO	3144-107	Change of Purpose to "Conservation and Seed Orchard."	L485581	22/11/2010	LAKE GRACE ROAD, KULIN.	10.752 Ha	KULIN (25) S.E JILAKIN (50)
17911	Lot 21805 on Deposited Plan 146079	07091-1921-02RO	3144-107 3144-107	Management Order to Conservation Commission of Western Australia, Corner of Hackett Drive and Australia II Drive, Crawley WA 6009 To be used for its designated purpose of "Conservation and Seed Orchard" only. for the designated purpose of "Conservation and Seed Orchard"	L485584	22/11/2010	LAKE GRACE ROAD, KULIN.	10.752 Ha	KULIN (25) S.E JILAKIN (50)
17911	Lot 21805 on Deposited Plan 146079	07091-1921-02RO	3144-107 3144-107	?	L485582	22/11/2010	LAKE GRACE ROAD, KULIN.	10.752 Ha	KULIN (25) S.E JILAKIN (50)

New 5(1)(L) reserve created from ~~res~~ northern portion of 17911

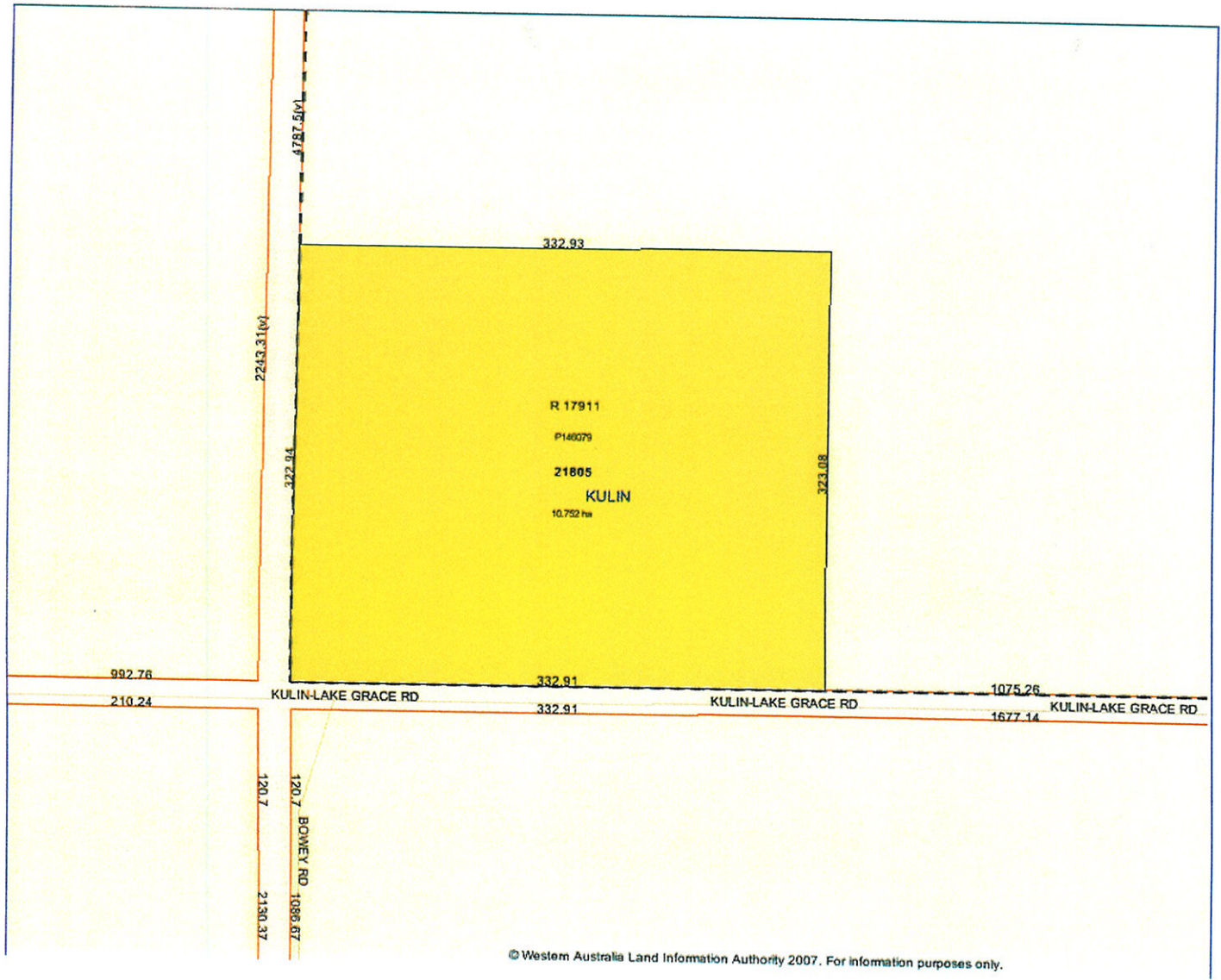

© Western Australia Land Information Authority 2007. For information purposes only.

