

NATURE RESERVE

RESERVE NO: 19068

GOVERNMENT GAZETTE  
Date Page No.

FILE NUMBER: 659/80

PURPOSE: CONSERVATION FLORA AND FAUNA 19/10/81 3375

NAME:

CLASS (Land Act):

AREA: 43.5037 ha

VESTING: W.A.W.A. 19/10/81 3359

LOCATION NO(S): KOJONUP LOCATION 8426

CLASSIFICATION:  
(Wildlife Act  
Section 12A)

LITHO: N.W. 1.25000

LOCAL AUTHORITY: BROOMHILL

Notes:

L.196

LAND ACT, 1933  
(Section 33)

022516F3102

30

VESTING ORDER

File No. 4196/25

I, Professor Gordon Reid, Companion of the Order of Australia, Governor of the State of Western Australia, do hereby, in pursuance of the powers enabling me in that behalf, and under and by virtue of the provisions of Section 33 of the Land Act, 1933, direct that Reserve No. Class 'A' 19068 (Kojonup Location 8426)

shall vest in and be held by National Parks and Nature Conservation Authority

in trust for the following objects and purposes (that is to say)

Conservation of Flora and Fauna

subject nevertheless to the powers reserved to me by Section 37 of the said Act.

Given under my hand, at Perth

this 21st day  
of February 1989

  
GOVERNOR

Clerk Woodvale

027466F3101

30  
10



Department of  
**LAND ADMINISTRATION**

Your Ref: 027466F3101

Our Ref: 1900/984 NM

Telephone: 323 1678  
Enquiries:

EXECUTIVE DIRECTOR  
DEPARTMENT OF CONSERVATION AND  
LAND MANAGEMENT

February 24, 1989

Department of Conservation  
and Land Management  
24 Feb 1989  
COMO, W.A.

Dear Sir

BAILEY COMMITTEE REPORT : REVIEW OF CLASS B AND C NATURE RESERVES

I advise for your information that Executive Council has:-

1. Issued Orders in Council revoking:-
  - (a) the Order in Council dated 8 May, 1963 whereby Reserve Nos. 9508, 10016, 17337, 26785 and 26787 were vested in The Fauna Protection Advisory Committee of Western Australia in trust for the purpose of "Conservation of Flora and Fauna" and approve the cancellation of the relevant Vesting Order accordingly.
  - (b) the Orders in Council whereby Reserve Nos. 2457, 6798, 13797, 15855, 19068, 19122, 20066, 20095, 20878, 20985, 21067, 24599, 26150, 26668, 26669, 28656, 30298 and 36942 were vested in the Western Australian Wildlife Authority in trust for the purpose of "Conservation of Flora and Fauna" and approve the cancellation of the relevant Vesting Orders accordingly.
  - (c) the Order in Council dated 6 April, 1986 whereby Reserve No. 21284 was vested in The Fauna Protection Advisory Committee of Western Australia in trust for the purpose of "Flora and Fauna" and approve the cancellation of the relevant Vesting Order accordingly.
  - (d) the Order in Council dated 7 March, 1963 whereby Reserve No. 21286 was vested in The Fauna Protection Advisory Committee of Western Australia in trust for the purpose of "Protection of Flora and Fauna" and approve the cancellation of the relevant Vesting Order accordingly.

*1. Asst Reserves*

...2

- (e) the Orders in Council dated January 28, 1986, August 16, 1988, February 3, 1987 and August 16, 1988 whereby Reserve Numbers 6799, 9714, 9629 and 10142 respectively were vested in the National Parks and Nature Conservation Authority in trust for the purpose of "Conservation of Flora and Fauna" and approve the cancellation of the relevant Vesting Orders accordingly.
2. Approved of the purpose of Reserve Nos. 21284 "Flora and Fauna", 21286 "Protection of Flora and Fauna", 27481 "Preservation of Flora" 27223, and 29906 "Conservation of Flora" being changed to "Conservation of Flora and Fauna".
3. Issued Proclamations classifying as of Class "A":-
- (a) Reserve Nos. 2457, 6798, 6799, 9508, 9629, 9714, 10016, 10142, 13797, 15855, 17339, 19068, 19122, 20066, 20095, 20878, 20985, 21067, 21284, 21286, 21827, 24599, 26150, 26668, 26669, 26785, 26787, 27223, 27481, 27644, 28656, 29906, 30298, 36942 and 39718 "Conservation of Flora and Fauna".
- (b) Reserve No. 31163 "Research and Conservation of Flora and Fauna".
- (c) Reserve No. 29241 "Research and Conservation of Flora and Fauna".
4. Issued Orders in Council directing that Class "A" Reserve Nos. 2457, 9629, 6798, 6799, 9508, 9714, 10016, 10142, 13797, 15855, 17339, 19068, 19122, 20066, 20095, 29878, 20985, 21067, 21284, 21286, 21827, 24599, 26150, 26668, 26669, 26785, 26787, 27223, 27481, 27644, 28656, 29906, 30298, 36942 and 39718 shall vest in and be held by the National Parks and Nature Conservation Authority in trust for the purpose of "Conservation of Flora and Fauna".

Notice to this effect was published in the Government Gazette dated February 24, 1989 and I enclose all the relevant Vesting Orders and a copy of the schedule.

Would you please return to this office the superseded Vesting Orders for cancellation.

Yours faithfully



P. COYNE  
MANAGER  
PROPERTY MANAGEMENT BRANCH  
LAND OPERATIONS DIVISION

Enc

PM054NM3

1. Assistant Reserves Clerk -

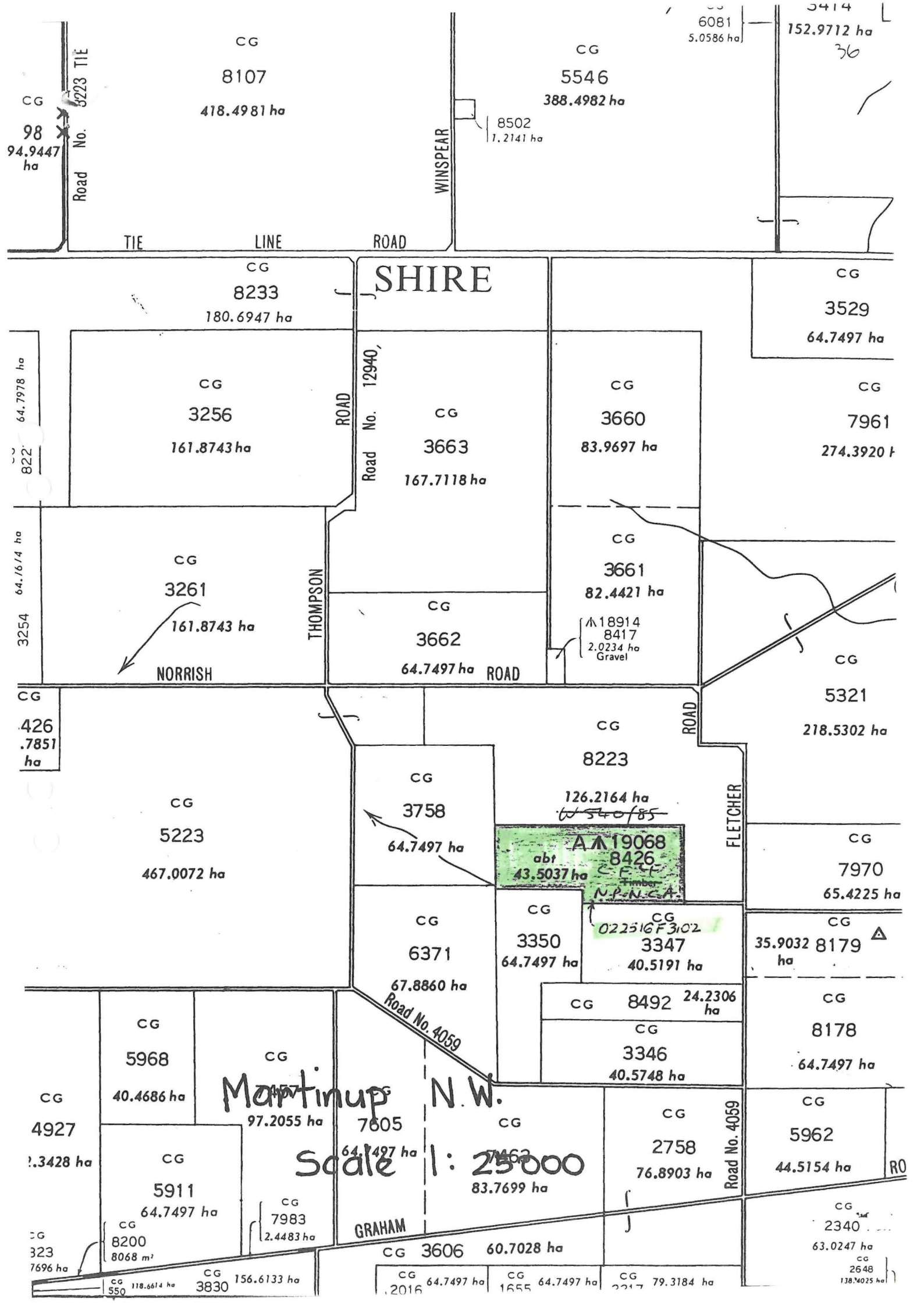

6081  
5.0586 ha

814  
152.9712 ha  
36

CG  
8107  
418.4981 ha

CG  
5546  
388.4982 ha

8502  
1.2141 ha

CG  
98  
94.9447 ha

Road No. 5223 TIE

WINSPEAR ROAD

TIE LINE ROAD

SHIRE

CG  
8233  
180.6947 ha

CG  
3529  
64.7497 ha

64.7978 ha  
822

CG  
3256  
161.8743 ha

ROAD

Road No. 12940,

CG  
3663  
167.7118 ha

CG  
3660  
83.9697 ha

CG  
7961  
274.3920 ha

64.1614 ha  
3254

CG  
3261  
161.8743 ha

THOMPSON ROAD

CG  
3662  
64.7497 ha

CG  
3661  
82.4421 ha

18914  
8417  
2.0234 ha  
Gravel

CG  
5321  
218.5302 ha

CG  
426.7851 ha

CG  
5223  
467.0072 ha

CG  
3758  
64.7497 ha

CG  
8223  
126.2164 ha  
W 540/85

A 19068  
abt 43.5037 ha  
C.P.F. Timber  
N.P.N.G.A.

FLETCHER ROAD

CG  
7970  
65.4225 ha

CG  
6371  
67.8860 ha

CG  
3350  
64.7497 ha

CG  
3347  
40.5191 ha

CG  
8179  
35.9032 ha

CG 8492 24.2306 ha

CG  
3346  
40.5748 ha

CG  
8178  
64.7497 ha

Martinup N.W.

CG  
4927  
1.3428 ha

CG  
5911  
64.7497 ha

CG  
7983  
2.4483 ha

CG  
7805  
64.7497 ha

CG  
7462  
83.7699 ha

CG  
2758  
76.8903 ha

Road No. 4059

CG  
5962  
44.5154 ha

CG  
323  
7696 ha

CG  
8200  
8068 m²

CG  
550  
118.6614 ha

CG  
3830  
156.6133 ha

GRAHAM

CG 3606 60.7028 ha

CG 2016 64.7497 ha

CG 1655 64.7497 ha

CG 2217 79.3184 ha

CG  
2340  
63.0247 ha  
CG  
2648  
138.9025 ha

Scale 1: 25000