

RESERVE ACTION SHEET - CONSERVATION RESERVES

RESERVE No. 21980

REASON FOR ACTION

- Change of purpose from 'School Site' to 'Conservation of Flora and Fauna' with vesting in the NPNCA (previously vested in the Ministry for Education). Area: 1.69 hectares.
- This reserve contains *Eremophila adenoticha*, a species of rare Western Australian flora, which has been recorded on CALM's Priority One Flora List (taxa that are known from one or a few (generally fewer than five) populations that are under threat). It also consists of a diverse array of vegetation unlike nearby nature reserves.
- The reserve's area has also been increased by about 0.007 ha to 1.69 ha due to a recalculation of its boundaries. Technological advancements within DOLA since the original gazettal of this reserve has enabled a more accurate spatial definition of it.
- Date of DOLA's advice: 24 December 1999 See folio: 46
- Plans at folios: 47-9

OFFICER	ACTION
1 CONSERVATION ESTATE OFFICER	- Fill in above details - Attach DOLA's advice to file Send copies of advice & maps to: - Lisa Wright, Woodvale - District Manager, Merredin - Regional Manager, Narrogin Rec. IUCN classification: 1a To note: <i>Batt 16/3/00</i>
2 INDEX CLERK, RECORDS	To note:
3 LAND ACQUISITIONS OFFICER	To note:
4 MANAGER, PLANNING & VISITOR SERVICES	To note & approve IUCN classification:
5 DIRECTOR, NATURE CONSERVATION	To note:
6 PROGRAM LEADER (TENURE)	To note & update IUCN records:
7 ADMIN. OFFICER, FLORA	To note:

**Customer Advices for Reserve Actions
1/12/1999 - 31/12/1999**

P. 33
ADVICE

Shire of Yilgarn 1/12/1999 - 31/12/1999

Reserve No.	Land Description	DOLA File No.	Volume/Folio	Action	Document No.	Lodge Date	Street Name	Area	Public Plans
17009		00291-1918-01RO	3111-708	Management Order to Water and Rivers Commission of Hyatt Centre 3 Plain Street East Perth for the designated purpose of "Water"	H323544	24/12/99	Bullfinch - Evanston Road	191.404 Ha	Jackson (250)
17009		00291-1918-01RO	3111-708	Revocation of Management Order () for the designated purpose of "Water"	H323545	24/12/99	Bullfinch - Evanston Road	194.2491 Ha	JACKSON (250)
17009	Yilgarn Location 1598 on Land Administration Miscellaneous Diagram 93796	00291-1918-01RO	3111-708	Amendment of Reserve to To comprise Yilgarn Location 1598 on Land Administration Miscellaneous Diagram 93796 and its area being recalculated (reduced) to 191.4040 hectares.	H323546	24/12/99	Bullfinch - Evanston road	191.404 Ha	Jackson (250)
18773		01899-1982-01RO	3060-738	Revocation of Management Order (Waters and Rivers Commission) for the designated purpose of "Water and Conservation of Flora and Fauna".	H308238	13/12/99	Gobetti Road	447.5926 Ha	Moorine Rock (50)
18773		01899-1982-01RO	3060-738	Management Order to Water and Rivers Commission of Hyatt Centre 3 Plain Street, East Perth Power to Lease for the designated purpose of ""	H308237	13/12/99	Gobetti Road	447.5926 Ha	Moorine Rock (50)
18773	Jilbadji Location 241	01899-1982-01RO	3060-738	Amendment of Reserve to To comprise Jilbadji Location 241 on Land Administration Diagram 94039 and its area being reduced (recalculated) to 447.5926 hectares.	H308239	13/12/99	Gobetti Road	447.5926 Ha	Moorine Rock (50)
18920		01900-1982-01RO	3092-832	Revocation of Management Order (Water & Rivers Commission) for the designated purpose of "Water".	H323549	24/12/99	Irving Road cnr Nulla South Road	178.5002 Ha	Moorine Rock 1: 50000
18920		01900-1982-01RO	3092-832	Management Order to Water and Rivers Commission of Hyatt Centre 3 Plain Street East Perth for the designated purpose of "Water"	H323548	24/12/99	Irving Road cnr Nulla South Road	178.5002 Ha	Moorine Rock 1:50000
20447		01344-1930-01RO	3008-660	Revocation of Management Order () for the designated purpose of "Water Supply".	H323542	24/12/99	Dorothy Street	0.6374 Ha	BM37(2)07.10
20447		01344-1930-01RO	3008-660	Management Order to Water and Rivers Commission of Hyatt Centre 3 Plain Street East Perth for the designated purpose of "Water Supply"	H323540	24/12/99	Dorothy Street	0.6374 Ha	BM37(2)07.10
20447	Bullfinch Lot 302 on Miscellaneous Diagram 94011	01344-1930-01RO	3008-660	Amendment of Reserve to Bullfinch Lot 302 on Land Administration Miscellaneous Diagram 94011 and its area remaining unaltered	H323541	24/12/99	Dorothy Street	0.6374 Ha	BM37(2)07.10
21980		02155-1938-01RO	3072-212	Management Order to National Parks and Nature Conservation Authority of P.O Box 104, Como for the designated purpose of "Conservation of Flora and Fauna."	H323529	24/12/99	Holleton Townsite	1.6997 Ha	Holleton (50)
21980	Leake Location 194 on Land Administration Miscellaneous Diagram 94244	02155-1938-01RO	3072-212	Change of Purpose to "Conservation of Flora and Fauna"	H323532	24/12/99	Holleton Townsite	1.6997 Ha	Holleton (50)
21980	Leake Location 194 on Land Administration Miscellaneous Diagram 94244	02155-1938-01RO	3072-212	Amendment of Reserve to To comprise Leake Location 194 on Land Administration Miscellaneous Diagram 94244 and its area being increased (recalculated) to 1.6997 hectares	H323531	24/12/99	Near Holleton Road	1.6997 Ha	Holleton 1:50000









NOTE FOR C. BATHIGANE => INCLUDE MILE O'DENMARK IN THE ACTION SHEET 1

THANKS
 C. BATHIGANE 3/2/00
 1/ CLARENCE HOALE (LMB)
 (A) FOR PLAN (B) TO AMEND YOUR RECORDS IF NECESSARY
 4/4 9/3
 46

CALM-MANAGED LANDS AND WATERS

AS AT 30th JUNE 1999

Legend

-  National Park
-  Conservation Park
-  Nature Reserve
-  State Forest, Timber Reserve, Freehold & Other Reserve
-  Section 5(g) Reserve
-  Leasehold in the name of the Executive Director
-  Marine Park / Marine Nat Res / Marine Management Area
-  CALM Region Boundary
-  CALM Regional Office

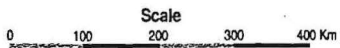

Projection: Polyconic, Origin 121°, 0°



CALM
CONSERVATION AND LAND MANAGEMENT

Produced by INFORMATION MANAGEMENT BRANCH

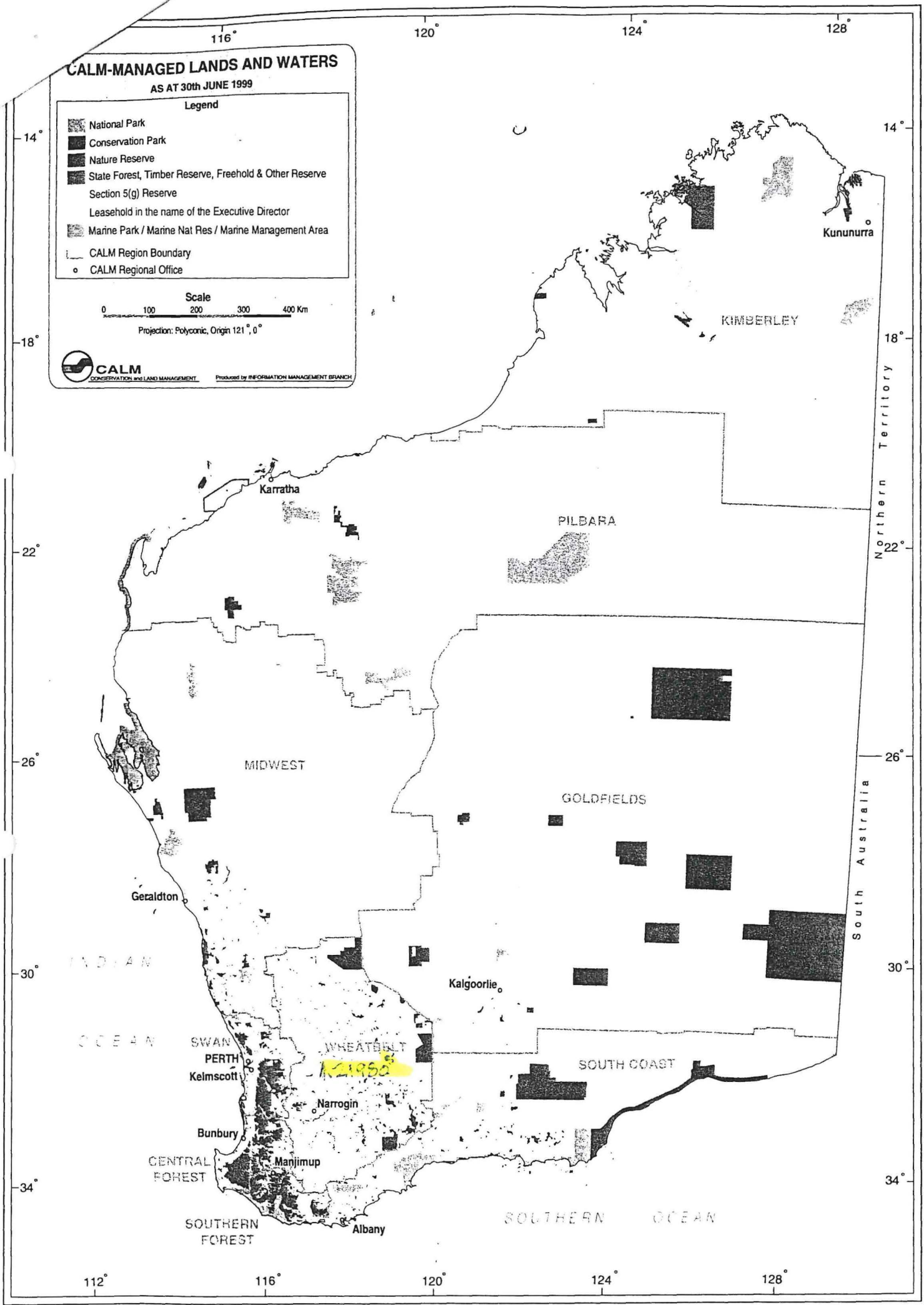

268

995-1574 ha

306

987-4522 ha

470

816/80

55

MODRINE

LEAKE

EUCLA

465

816/80

▲ 19923

3091-7980 ha

Timber (Mining)

▲ 19578

192

1.6920 ha

Recreation

Holleton

See Enlarged Plan

▲ 21086

8 2556 ha

Aerial

Landing

Ground

▲ 20209

189

1246 ha

Water

▲ 20161
188
2.0411 ha
Sanitary Site

▲ 21980

194

1.6997 ha

(Cons of

Flora & Fauna

Vested in NPWCA

▲ 19577

Holleton lot 2

1012 m²

Hall Site

▲ 20937
191
4.0469 ha
Cemetery

HOLLETON ROAD

CG

9

404-8880 ha

CG

8

442-5769 ha

CG

193

661-0060 ha

ROAD

SOUTH

CG

3

482-3347 ha

• LOOKOUT HILL

6460 000mN

ROAD

CG

10

558-8456 ha

HOLLETON

SHIRE

OF

NAREM

CG

7

643-6803 ha

ROAD

MODRINE

CG

6

524-9481 ha

ROE DISTRICT
SOUTH-WEST LAND DIVISION
SOUTH WEST MINERAL FIELD

Rd. No. 521
Rd. No. 10715
Cl. 241
520 4991 ha

Part plan Holleton 695
SCALE 1:50,000

32° 00'

119° 00'

650000mE

05'

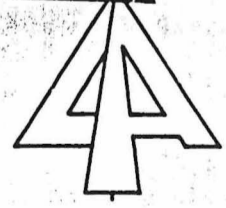
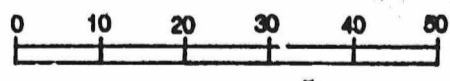
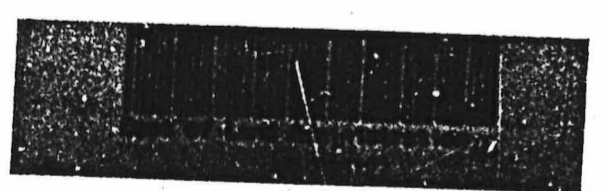
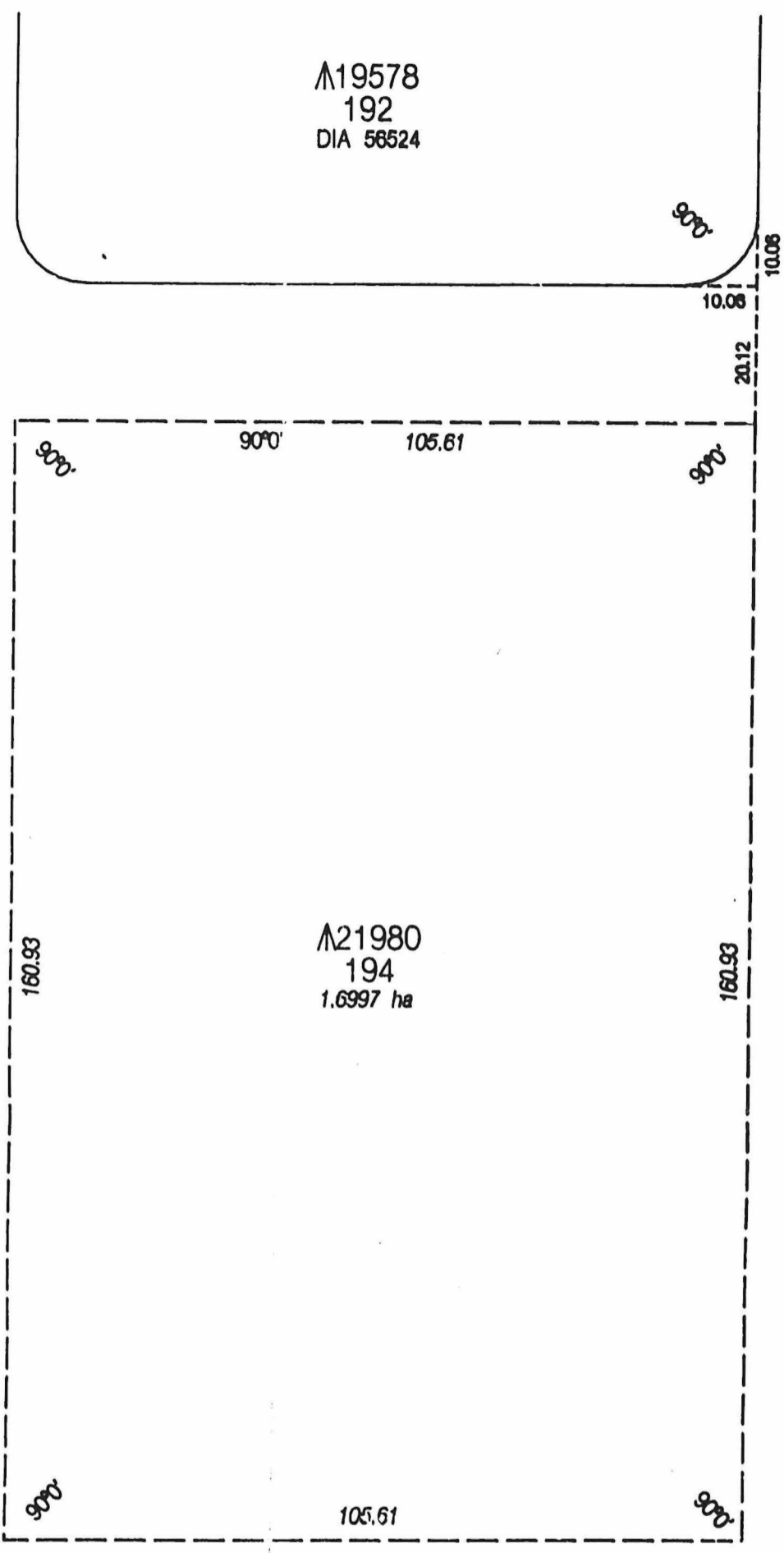

LEAKE		LOCATION 194		IN ORDER FOR DEALINGS	
AUTHORITY SHIRE OF YILGARN				SUBJECT TO	
55/938		SUBJECT TO SURVEY NOT FOR ALIENATION PURPOSES		
1:1000 metres				
LETON (50)		On S.I.P. HOLLEYON (50) Recorded on Public Plan Document Registered		FOR AUTHORIZED LAND OFFICER DATE <i>W. J. ... 2.6.99</i>	
Page Date 1.8.99 Date 2.6.99 Date 3.6.99				APPROVED AUTHORIZED LAND OFFICER Date	
Pearson <i>W. J. ...</i> Date 2.6.99 Date 3.6.99 Director Manager Statutory Services.				 LAND ADMINISTRATION ACT MISCELLANEOUS DIAGRAM 94244	