



Department of
LAND ADMINISTRATION

File: 024959F3201

CLERK, WOODVALE

23
R

Your Ref:

Our Ref: 2531/54V3 CA:LW

Telephone: 323 1614 C. ABEY
Enquiries:

Department of Conservation
and Land Management
17 JAN 1989
GOMU, W.A.

EXECUTIVE DIRECTOR
DEPARTMENT OF CONSERVATION AND
LAND MANAGEMENT
CDO

²⁴⁴⁹¹
RESERVE NO. -23589 AT MERREDIN

I advise for your information that in accordance with Reserves and Land Revestment Act No. 67 of 1988 that:-

Reserve No. 24491, classified as of Class A, containing 39.975 hectares or thereabouts, set apart for "National Park" and vested in the National Parks and Nature Conservation Authority is hereby amended by:-

- (a) excluding an area of 16.1900 hectares being Victoria Location 11736.
- (b) including an area of 16.1900 hectares being Victoria Location 10359.

Further formal action as a result is now necessary and when finalised you will be informed accordingly.

I enclose a print showing the said reserve.

M.

S. BURGESS
ACTING MANAGER
PROPERTY MANAGEMENT BRANCH
LAND OPERATIONS DIVISION

January 13, 1989

Enc.

PM012LW1

23-1-89
1/DMA p291
2/SC Reserves

19. Class A Reserve 4561 "Parklands" to comprise Canning Location 3597 as shown on Original Plan 16929 and of its area being increased to 498.228 3 hectares. Public Plans Perth 1:2 000 23.01, 24.01 Peel 1:2 000 23.38, 23.39, 23.40, 24.39, 24.40, 25.39 and Peel 1:10 000 10.16. File 2295/97V2.
20. Class A Reserve 1668 "Recreation" to comprise Swan Location 10693 as shown on Diagram 87053 and of its area being reduced to 9.132 7 hectares. Public Plan Perth 1:2 000 09.19. File 3128/47.
21. Class A Reserve 1624 "Recreation" to comprise Swan Location 10694 as shown on Original Plan 16425 and of its area being increased to 8.450 hectares. Public Plan Perth 1:2 000 09.19. File 3128/47.
22. Class A Reserve 12397 "Water" to comprise Avon Location 28942 as shown on Diagram 88385 and of its area being reduced to 3.710 9 hectares. Public Plan Mears NW 1:25 000. File 79/06V2.
23. Class A Reserve 15860 "Parklands and Recreation" to comprise Bridgetown Lot 894 as shown on Original Plan 16454 and of its area being increased to 4.670 hectares. Public Plans Bridgetown 1:2 000 30.01, 31.01. File 434/981.
24. Class A Reserve 24491 "National Park" to exclude that portion now comprised in Victoria Location 11736 as shown on Diagram 88283 and include Victoria Location 10359 as shown on Original Plan 6632 and of its area remaining unaltered. Public Plan Tanche 1:50 000. File 2531/54V3.
25. Class A Reserve 35118 "Historical Site and Buildings" to include Onslow Lot 699 and of its area being increased by 20.487 2 hectares. Public Plan Onslow Townsite Sheet 1. File 2070/70.
26. Class A Reserve 6627 "Conservation of Flora and Fauna" to include Murray Location 1847 and of its area being increased by 19.424 9 hectares. Public Plan Mandurah and Environs 1.10 000 1-5. File 3543/99.
27. Class A Reserve 18705 "National Park" to exclude the area coloured pink on Miscellaneous Plan 1657 and of its area being reduced by 590 hectares. Public Plans Deeside SW, SE, Mount Johnston NW, Shannon NE, SE, SW, NW Wainbup NE, NW 1:25 000. File 1851/22V4.
28. Class A Reserve 17495 "National Park" to exclude that portion now comprised in Nelson Location 13304 as shown on Diagram 88657 and of its area being reduced by 98.940 hectares. Public Plan Gardner River NW 1:25 000. File 894/44V4.
29. Class A Reserve 38881 "Recreation, Camping, Caravan Park and Holiday Cottages" to include Nelson Location 13304 and of its area being increased by 98.940 hectares. Public Plan Gardner River NW 1:25 000. File 894/44V4.

Change of Purpose of Reserves

The purposes of the following reserves have been changed:—

1. Class A Reserve 39825 from "Conservation and the Agreement defined in Section 2 of the Alumina Refinery Agreement Act 1961" to "National Park" Public Plans Jarrahdale 1:2 000 25.22, Peel 1:10 000 5.3, 5.4, 5.5, 6.5, Jarrahdale NW, SW 1:25 000. File 449/987.
2. Class A Reserve 1624 from "Recreation" to "Parkland and Recreation". Public Plan Perth 1:2 000 09.19. File 3128/47.
3. Class A Reserve 17826 from "Park and Gardens" to "Park Gardens and Parking". Public Plans Perth 1:2 000 14.23, 14.24. File 2745/21.
4. Class A Reserve 27322 from "Park and Recreation" to "Recreation and Foreshore Management".

Cancellation of Reserve

Class A Reserve 8103 "Recreation" vested in the Shire of Boulder has been cancelled. Public Plan Kalgoorlie-Boulder and Environs 30.32. File 4095/01.

N. J. SMYTH,
Executive Director,
Department Land Administration.

LAND ACT 1933

Notice of Intention to grant a special lease under Section 116

Department of Land Administration,
Perth, 23 December 1988.

Corres. 2786/984

IT is hereby notified that it is intended to grant a lease over Roe Location 3098 to Co-Operative Bulk Handling Limited for a term of twenty one (21) years for the purpose of "Grain Handling Facilities".

N. J. SMYTH,
Executive Director.

LAND ACT 1933

Notice of Intention to Grant a Special Lease Under section 116

Department of Land Administration,
Perth, 13 January 1989.

Corres. 792/987.

IT is hereby notified that it is intended to grant a lease over Luman Location 51 to the Yarrunga Community for a term of fifty (50) years for the purpose of "The Use and Benefits of Aboriginal Inhabitants and Land Management".

N. J. SMYTH,
Executive Director.

Department of Land Administration
and Land Management
17 JAN 1989
COMO, W.A.

LAND ACT 1933

Department of Land Administration,
Perth, 13 January 1989.

File 2316/33.

I HEREBY appoint, pursuant to section 173 (1) of the Land Act 1933 Eric James Horlin as an Authorised Land Officer.

YVONNE HENDERSON,
Minister for Lands.

INDUSTRIAL DEVELOPMENT (RESUMPTION OF LAND) ACT 1945

Dedication of Land

Department of Land Administration,
Perth, 13 January 1989.

File 2254/980.

HIS Excellency the Governor in Executive Council has been pleased to approve, under section 11 of the Industrial Development (Resumption of Land) Act 1945 of the dedication of Clarence Lot 150 to the purposes of that Act.

N. J. SMYTH,
Executive Council.

CORRIGENDUM

Department of Land Administration,
Perth, 13 January 1989.

File 3280/970.

IN the Notice at page 2920 of the Government Gazette dated 19 August 1988 with reference to Reserve No. 351, in line four amend about 299 hectares to read about 290 hectares.

N. J. SMYTH,
Executive Director.

Records pls file 2 Asst. Reserves
6.2.89



Your ref:
Our ref: 2006F000011
Enquiries: Alex Errington
Phone: 9334 0260
Fax: 9334 0278
Email: alexe@calm.wa.gov.au

ACTING MINISTER FOR THE ENVIRONMENT; SCIENCE

LAND PURCHASES: MIDWEST REGION - VICTORIA LOCATION 4184 AND MELBOURNE LOCATION 2001

Further to my minute of 22 December 2005 - copy attached as Attachment A - agreement has now been reached on the second property.

Victoria Location 4184 is a 4-hectare property located within Watheroo National Park. Melbourne Location 2001 is a 5-metre-wide strip of land which runs for about 16 kilometres to provide access to Victoria Location 4184 - see Attachment B. We first attempted to buy this enclave in 1988 but until now have always been unsuccessful. However, the former owner died in 2004 and we have now reached agreement to buy the property from his daughter.

Attached is a copy of the conditional offer and acceptance (Attachment C). The purchase price of \$32,000 is supported by the Valuer General (Attachment D).

I recommend that you endorse the purchase of this property for \$32,000 (your endorsement is sought consistent with CALM's established practice, but it is not a statutory requirement under either the CALM Act or the Land Administration Act). We will then obtain formal approval for the purchase from the Department for Planning and Infrastructure, acting under delegation from the Minister for Planning and Infrastructure.

I would appreciate it if you could give this matter early attention.

Keiran McNamara
EXECUTIVE DIRECTOR

5 January 2006

Atts

Customer Advices for Reserve Actions
1/11/2007 - 30/11/2007

Shire of Coorow 1/11/2007 - 30/11/2007

sundry etc

Reserve No.	Land Description	DPI File No.	Volume/Folio	Action	Document No.	Registered	Street Name	Area	Public Plans
24491	Lot 1584 on Deposited Plan 240050	02531-1954-04RO	3092-658	Order for Addition of Land to Certain Class 'A' Reserves to. & area = 39944 Hectares	K418551	20/11/2007	Warro Road, Coorow	39944 Ha	
	Lot 2055 on Deposited Plan 240050		3092-658						
	Lot 3101 on Deposited Plan 240050		3092-658						
	Lot 3493 on Deposited Plan 240050		3092-658						
	Lot 8744 on Deposited Plan 240050		3092-658						
	Lot 8745 on Deposited Plan 240050		3092-658						
	Lot 8749 on Deposited Plan 240050		3092-658						
	Lot 8929 on Deposited Plan 240050		3092-658						
	Lot 10328 on Deposited Plan 240050		3092-658						
	Lot 10329 on Deposited Plan 240050		3145-591						
	Lot 10330 on Deposited Plan 240050								
	Lot 10334 on Deposited Plan 240050								
	Lot 10359 on Deposited Plan 240050								
	Lot 10360 on Deposited Plan 240050								
	Lot 10363 on Deposited Plan 240050								
	Lot 10705 on Deposited Plan 240050								
	Lot 11075 on Deposited Plan 240050								
	Lot 9812 on Deposited Plan 240050								

24491	Lot 1584 on Deposited Plan 240050 Lot 2055 on Deposited Plan 240050 Lot 3101 on Deposited Plan 240050 Lot 3493 on Deposited Plan 240050 Lot 8744 on Deposited Plan 240050 Lot 8745 on Deposited Plan 240050 Lot 8749 on Deposited Plan 240050 Lot 8929 on Deposited Plan 240050 Lot 10328 on Deposited Plan 240050 Lot 10329 on Deposited Plan 240050 Lot 10330 on Deposited Plan 240050 Lot 10334 on Deposited Plan 240050 Lot 10359 on Deposited Plan 240050 Lot 10360 on Deposited Plan 240050 Lot 10363 on Deposited Plan 240050 Lot 10705 on Deposited Plan 240050 Lot 11075 on Deposited Plan 240050 Lot 9812 on Deposited Plan 240050 Lot 2001 on Deposited Plan 202104 Lot 4184 on Deposited Plan 202104	02531-1954-04RO	3092-658 3092-658 3092-658 3092-658 3092-658 3092-658 3092-658 3092-658 3092-658 3092-658 3092-658 3092-658 3092-658 3092-658 3092-658 3092-658 3092-658 3092-658 3145-591 3149-831 3149-830	Amendment of Reserve to To redescribe Reserve 24491 as Lot 350 on Deposited Plan 53159.	K418552 <i>sundry doc</i>	20/11/2007	Warro Road, Coorow	39944 Ha	
-------	---	-----------------	--	---	------------------------------	------------	--------------------	----------	--

4/1

Reserve Enquiry Detail [5100L]

Screen Friendly Print Page

Reserve 24491 Legal Area (ha) 39944.0
 Name Status Current
 Type Current Purpose NATIONAL PARK

Notes

File Number 2531/54 V3

Additional Reserve Information RESERVE COMPRISES LOT 350 ON DP53159 (K418552)

Class	Responsible Agency	Date of Last Change
A	DEPARTMENT OF ENVIRONMENT AND CONSERVATION	23/11/2007

Management Orders	Document	Land Use	Local Government Authority
NATIONAL PARKS AND NATURE CONSERVATION AUTHORITY	E817272	NATIONAL PARK	COOROW, SHIRE OF DANDARAGAN, SHIRE OF MOORA, SHIRE OF

Should be Cons. Comm.

Add Item	CLT Number	Parcel Identifier	Street Address	Suburb	File Number	PIN	Area (s)
<input type="checkbox"/>	LR3149-832	Lot 350 On Plan 53159		BOOTHENDARRA	02531-1954- 04RO	11615680	4205768
<input type="checkbox"/>	LR3149-832	Lot 350 On Plan 53159		BOOTHENDARRA	02531-1954- 04RO	11615681	7237974
<input type="checkbox"/>	LR3149-832	Lot 350 On Plan 53159		BOOTHENDARRA	02531-1954- 04RO	11615682	2062737
<input type="checkbox"/>	LR3149-832	Lot 350 On Plan 53159		BOOTHENDARRA	02531-1954- 04RO	11615683	22438.0
<input type="checkbox"/>	LR3149-832	Lot 350 On Plan 53159		BOOTHENDARRA	02531-1954- 04RO	11615684	3.132338
<input type="checkbox"/>	LR3149-832	Lot 350 On Plan 53159		BOOTHENDARRA	02531-1954- 04RO	11615685	7.267252

Reserve Number 24491

Previous Certificates of Title		Historic Crown Allotments		
CL520-1955	Cancelled	MELBOURNE	Location	1584
CL532-1964	Cancelled	MELBOURNE	Location	2055
LR3096-535	Cancelled	MELBOURNE	Location	3101
		VICTORIA	Location	3493
		VICTORIA	Location	8744
		VICTORIA	Location	8745
		VICTORIA	Location	8749
		VICTORIA	Location	8929
		VICTORIA	Location	10328
		VICTORIA	Location	10329
		VICTORIA	Location	10330
		VICTORIA	Location	10334
		VICTORIA	Location	10359
		VICTORIA	Location	10360
		VICTORIA	Location	10363
		VICTORIA	Location	10705

VICTORIA Location 11075





Gaz Page/Document	Date	Type	Text
K418552	20/11/2007	Current Area	39944.0000
K418552	20/11/2007	Historical Responsible Agency	EXECUTIVE DIRECTOR OF THE DEPARTMENT OF CONSERVATION & LAND MANAGEMENT
E817272	26/02/1992	Current Vesting	MANAGEMENT ORDER NATIONAL PARKS AND NATURE CONSERVATION AUTHORITY
E817272	26/02/1992	Historical Vesting	MANAGEMENT ORDER NATIONAL PARKS AND NATURE CONSERVATION AUTHORITY
496	31/01/1992	Historical Area	ABOUT 39936.7500
79	13/01/1989	Location	VICTORIA LOC 3493,8744,8745,8749,8929,10328,10329, 10330,10334,10359,10360,10363,10705,11075, MELBOURNE LOC 1584,2055 AND 3101
	13/01/1989	Survey Number	DIA:88283, OP:6632
2100	13/07/1984	Historical Area	ABT 39975.0000 ACT 6 - 1984 INCLUDE LOC 10363
2126	08/07/1977	Area Reduced by	39768.8178 BY RD.15798
2126	08/07/1977	Vesting Revoked	
1852	17/06/1977	Area Reduced by	39768.8178 BY RD.15798
3120	20/08/1976	Area Increased by	39788.0000
1422	14/05/1976	Area Increased by	39438.4218
4015	31/10/1975	Area Increased by	34174.3140
2033	21/06/1974	Area Increased by	30384.1421
4344	10/11/1972	Boards	
4344	10/11/1972	Vesting Revoked	
3161	18/08/1972	Area Reduced by	28324.9877 BY RD.14729
2100	30/06/1972	Class	A
2115	30/06/1972	Area Increased by	70036.2.13
4889	26/11/1971	Historical Class	A
4901	26/11/1971	Area Increased by	69962.1.9
118	15/01/1971	Current Name	WATHEROO NATIONAL PARK
2462	07/08/1970	Historical Class	A
2477	07/08/1970	Area Increased by	69362.1.9
3055	17/10/1969	Historical Class	A
3058	17/10/1969	Historical Vesting	VEST NATIONAL PARKS BOARD OF W A
3072	17/10/1969	Current Purpose	NATIONAL PARK
1878	28/07/1967	Area Reduced by	65434.3.17
31	11/01/1957	Area Increased by	65488.0.0

1674	06/07/1956 Original Gazettal and page	ORIGINAL GAZETTE
	06/07/1956 Correspondence File Number	2531/54 V3
	06/07/1956 Historical Vesting	CONT NATIONAL PARKS AUTHORITY OF W A ACT 19 - 1976
	06/07/1956 Original Area	62500.0.0
	06/07/1956 Public Plan	HERSCHELL, PINJARREGA, BADGINGARRA, TANCHE AND WATHEROO 1:50000
	06/07/1956 Street Name	COALARA RD
	01/01/0001 Historical Purposes	FLORA

This product is for information purposes only. A search of the original documentation is required for all legal purposes

Western Australian Land Information Authority (Landgate)

LEGEND

-  REGION BOUNDARY
-  DISTRICT BOUNDARY
-  REGION HQ
-  DISTRICT HQ

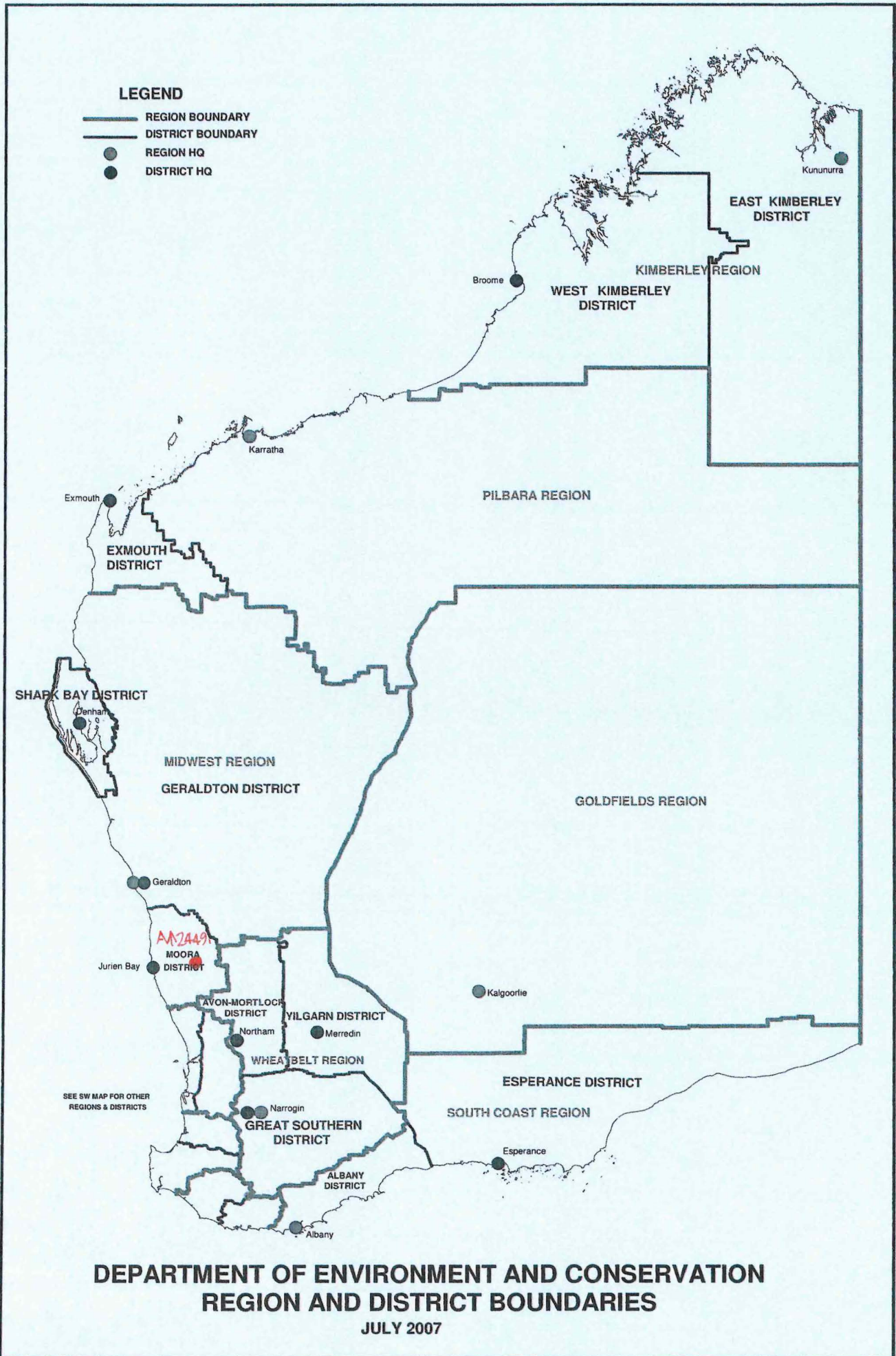

DEPARTMENT OF ENVIRONMENT AND CONSERVATION
REGION AND DISTRICT BOUNDARIES
 JULY 2007

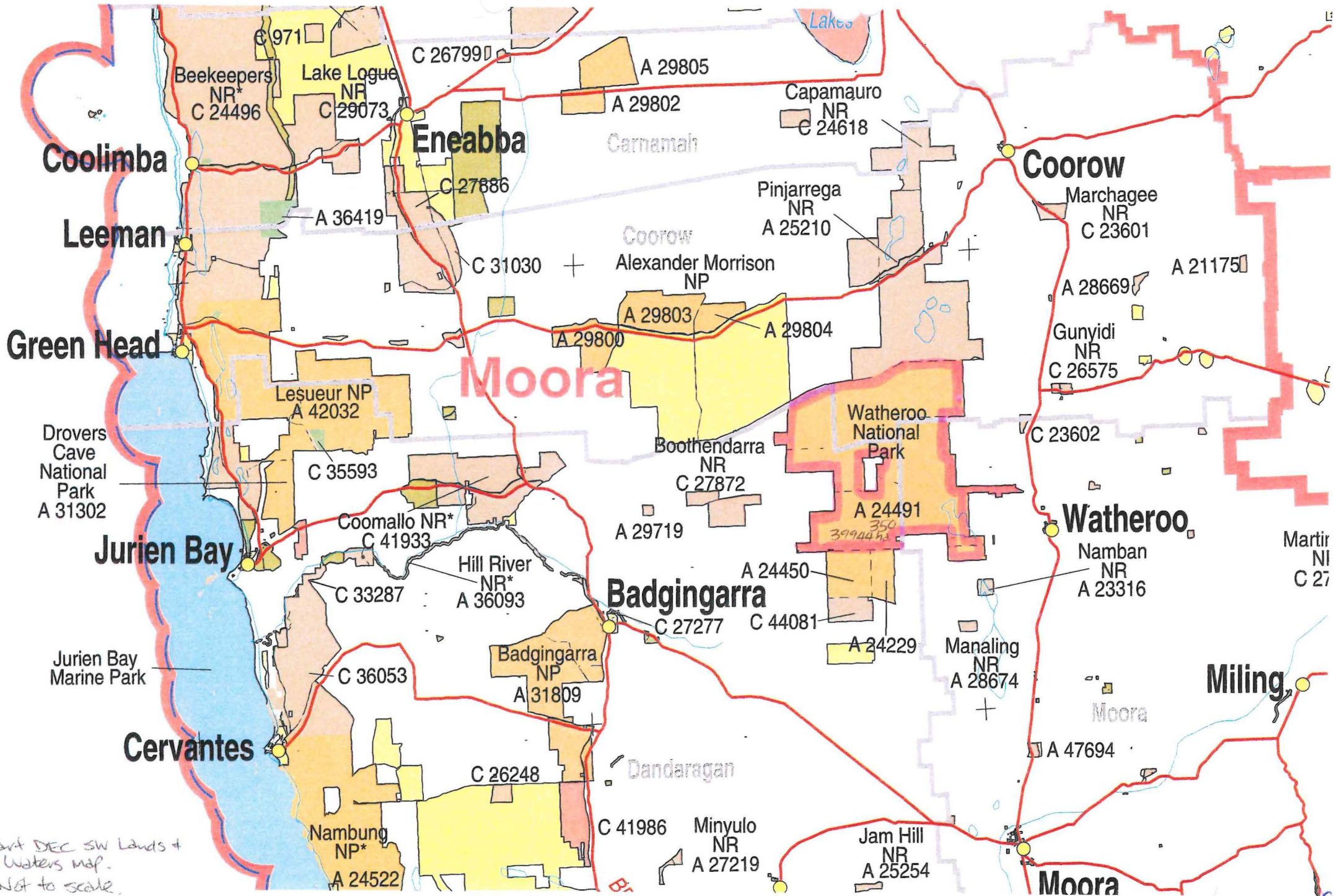

Part DEC SW Lands +
Waters map.
Not to scale.

APPROVED	DATE	SIGNATURE	DT
Authorized Land Officer			

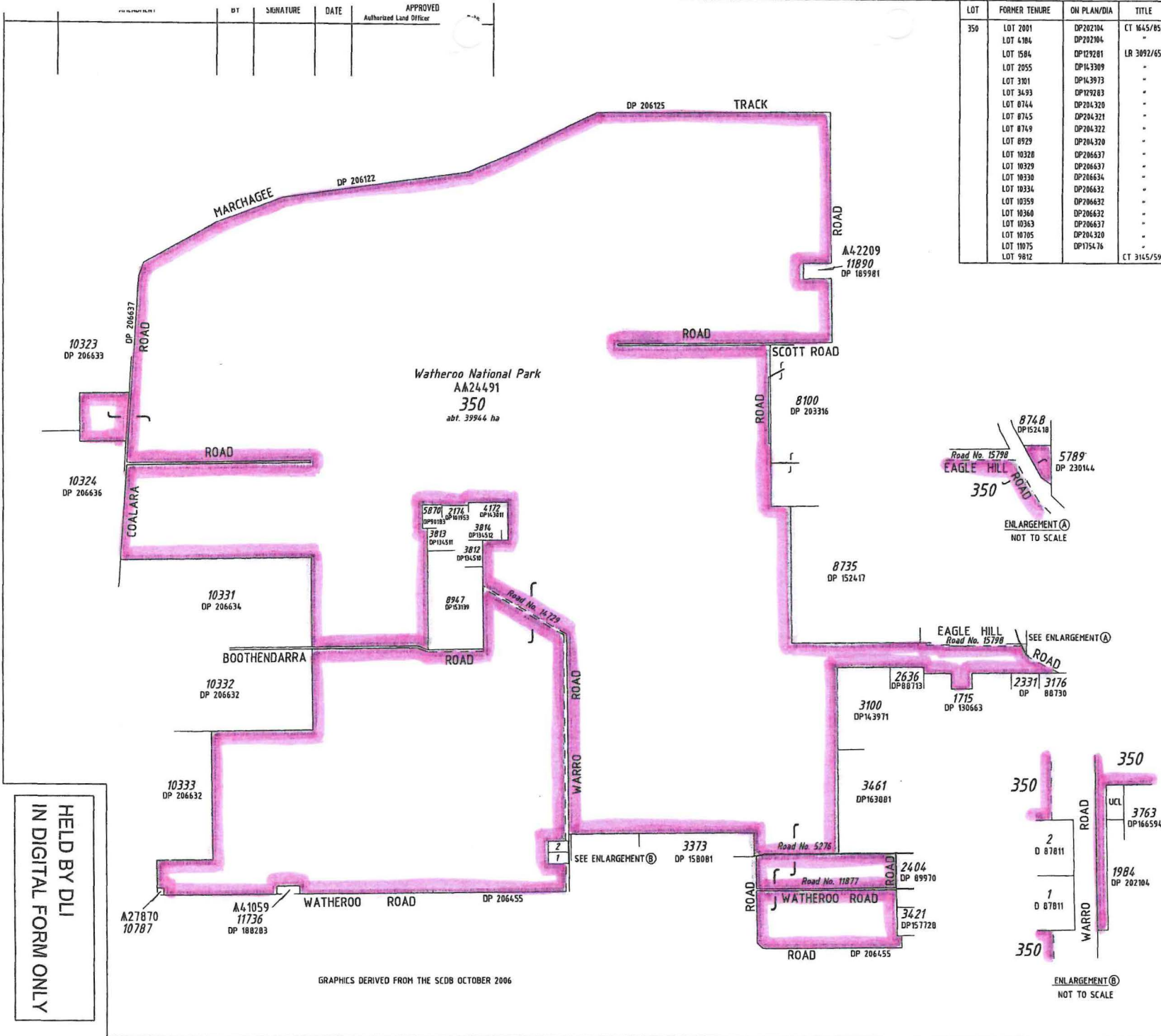

LOT	FORMER TENURE	ON PLAN/DIA	TITLE
350	LOT 2001	DP202104	CT 1645/855
	LOT 4104	DP202104	"
	LOT 1504	DP129281	LR 3092/658
	LOT 2055	DP143309	"
	LOT 3101	DP143973	"
	LOT 3493	DP129283	"
	LOT 8744	DP204320	"
	LOT 8745	DP204321	"
	LOT 8749	DP204322	"
	LOT 8929	DP204320	"
	LOT 10320	DP206637	"
	LOT 10329	DP206637	"
	LOT 10330	DP206634	"
	LOT 10334	DP206632	"
	LOT 10359	DP206632	"
	LOT 10360	DP206632	"
	LOT 10363	DP206637	"
	LOT 10705	DP204320	"
	LOT 11075	DP175476	"
	LOT 9812		CT 3145/591

TYPE	CROWN	
PURPOSE	SUBDIVISION	
PLAN OF	LOT 350	
DISTRICT	MELBOURNE & VICTORIA	FORMER TENURE
TOWNSITE		SEE TABLE
FILE	2531-1954 v4	
LOCAL AUTHORITY	SHIRE OF COOROW	
LOCALITY	WATHEROOD	
OH		REFERENCE
		(CORR 2531-1954v4 page 51)

SCALE @A1:
ALL DISTANCES
ARE IN METRES

1:75 000

0 750 1500 2250 3000 3750

SUBJECT TO SURVEY
NOT FOR ALIENATION PURPOSES

SURVEY FIRM	DLI - C.FIORENTINO	
LOGGED	TYPE OF VALIDATION	
DATE: 17/11/2008	PRL ADJUT	PMK
FILE PAD	LEGAL COMMENT	
N/A	N/A	
ASSESS No.	CERTIFIED CORRECT	
N/A	Blind 21/11/2008 Manager Statutory Services	

IN ORDER FOR DEALINGS	
SUBJECT TO	
1. REVESTMENT OF LOTS 4184 & 2001	
2. AMENDMENT AND REDESCRIPTION OF AA24491	
FOR AUTHORIZED LAND OFFICER	DATE
<i>[Signature]</i>	21/11/2008

APPROVED

AUTHORIZED LAND OFFICER DATE

Department of Land Information
Government of Western Australia

DEPOSITED PLAN

53159

SHEET 1 OF 1
EDITION 1 VERSION 1

HELD BY DLI
IN DIGITAL FORM ONLY

GRAPHICS DERIVED FROM THE SCDB OCTOBER 2006

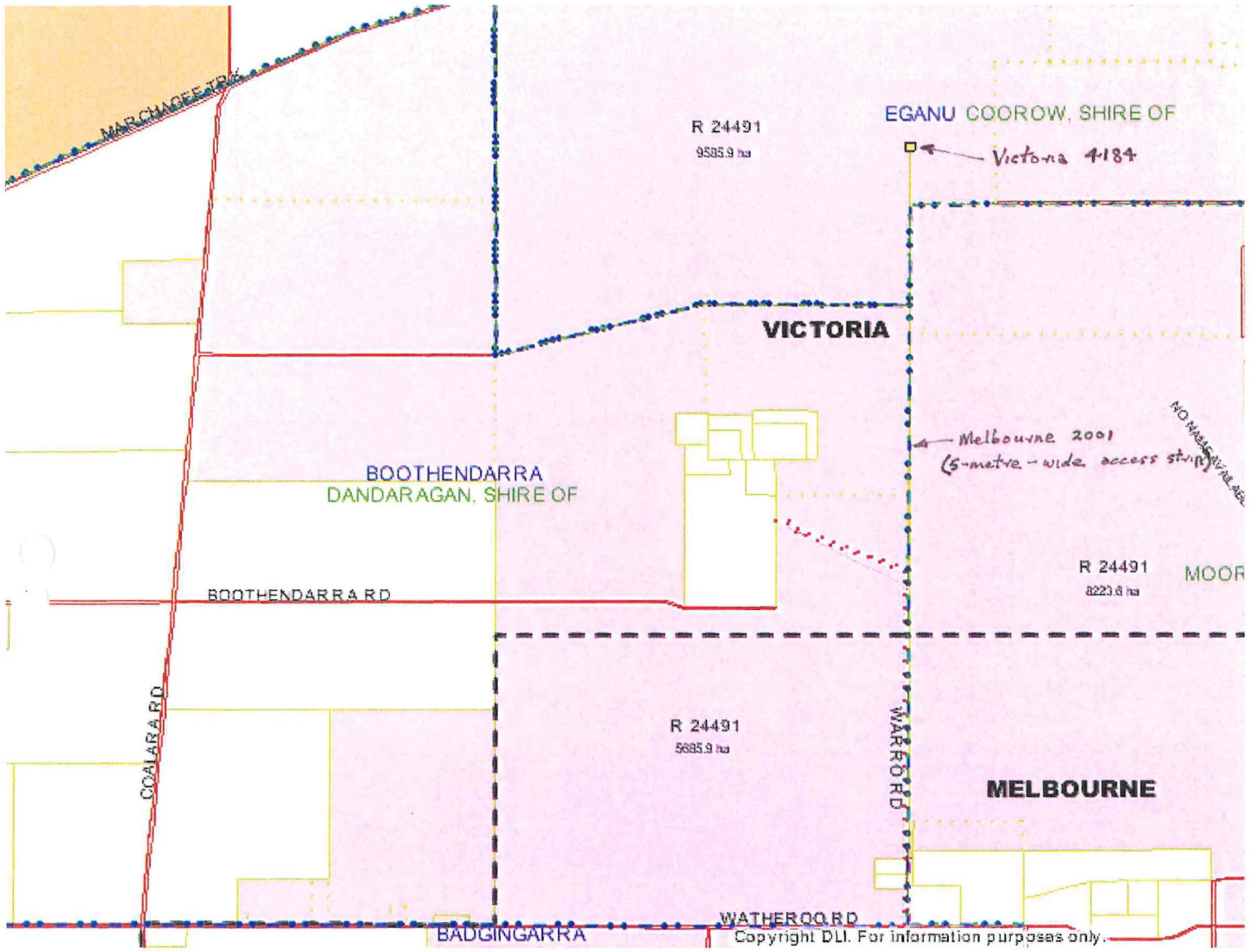

AUSTRIA

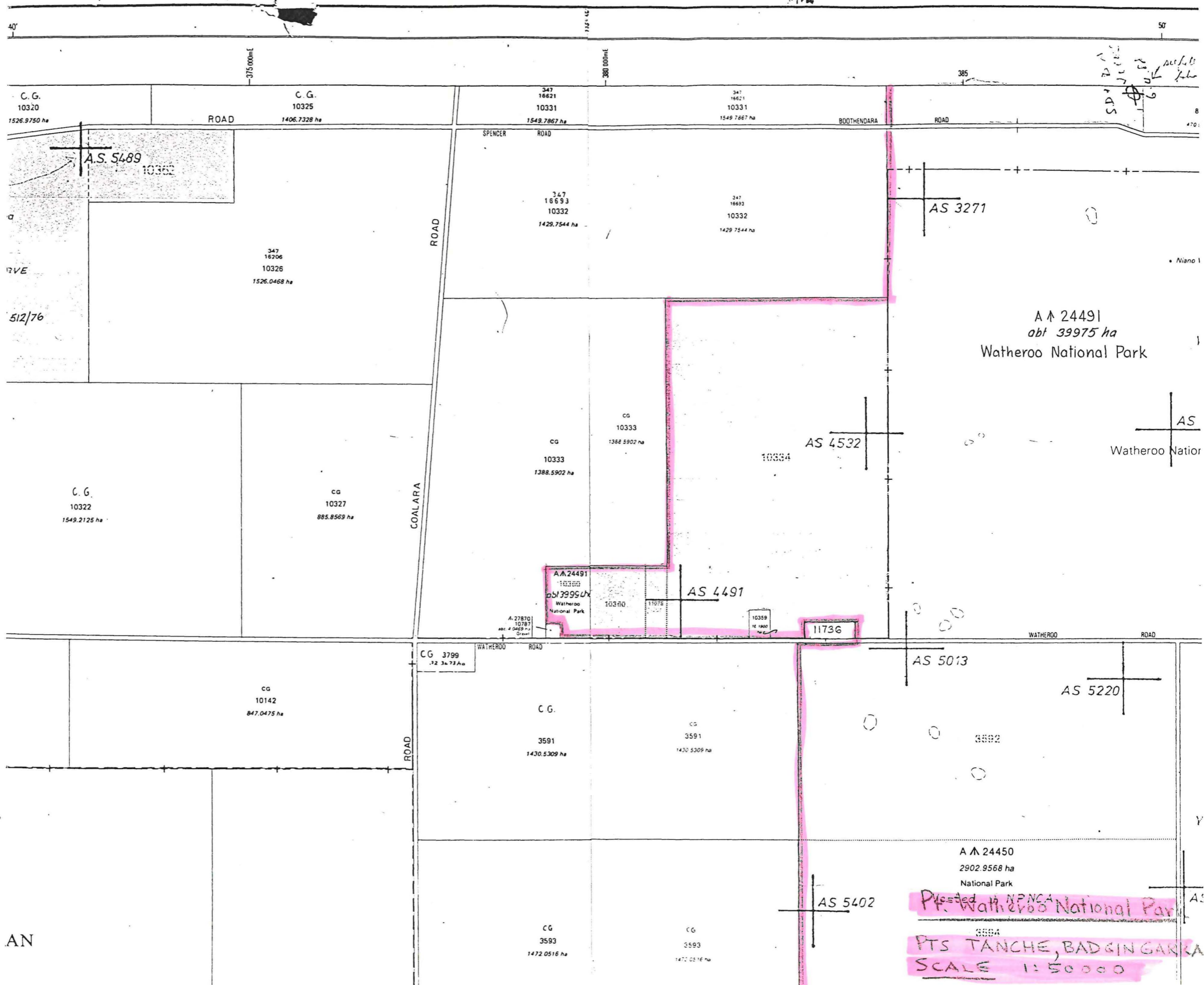

A 24491
obt 39975 ha
Watheroo National Park

Plotted in NP/PCA
Pt. Watheroo National Park

PTS TANCHE, BADGINGANKA
SCALE 1:50000

AN

INCLUSION OF VICTORIA LOCATION 10359 AND EXCISION OF VICTORIA LOCATION 11736 FROM CLASS "A" RESERVE 24491

PUBLIC PLAN TANCHE 1:50 000
CORR. No. 2531/54 Vol.3

S.G.H. 30.5.88
Erdi

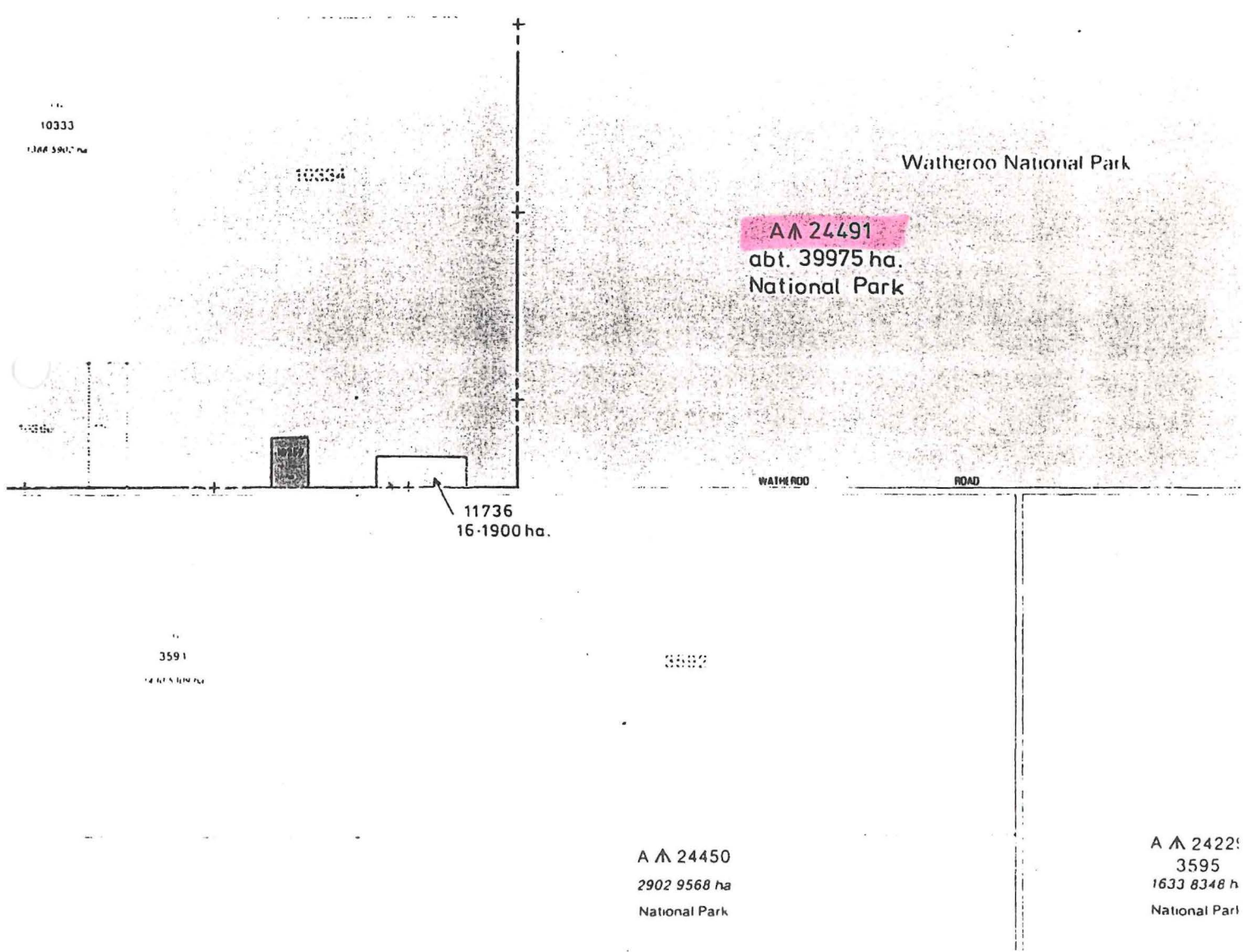

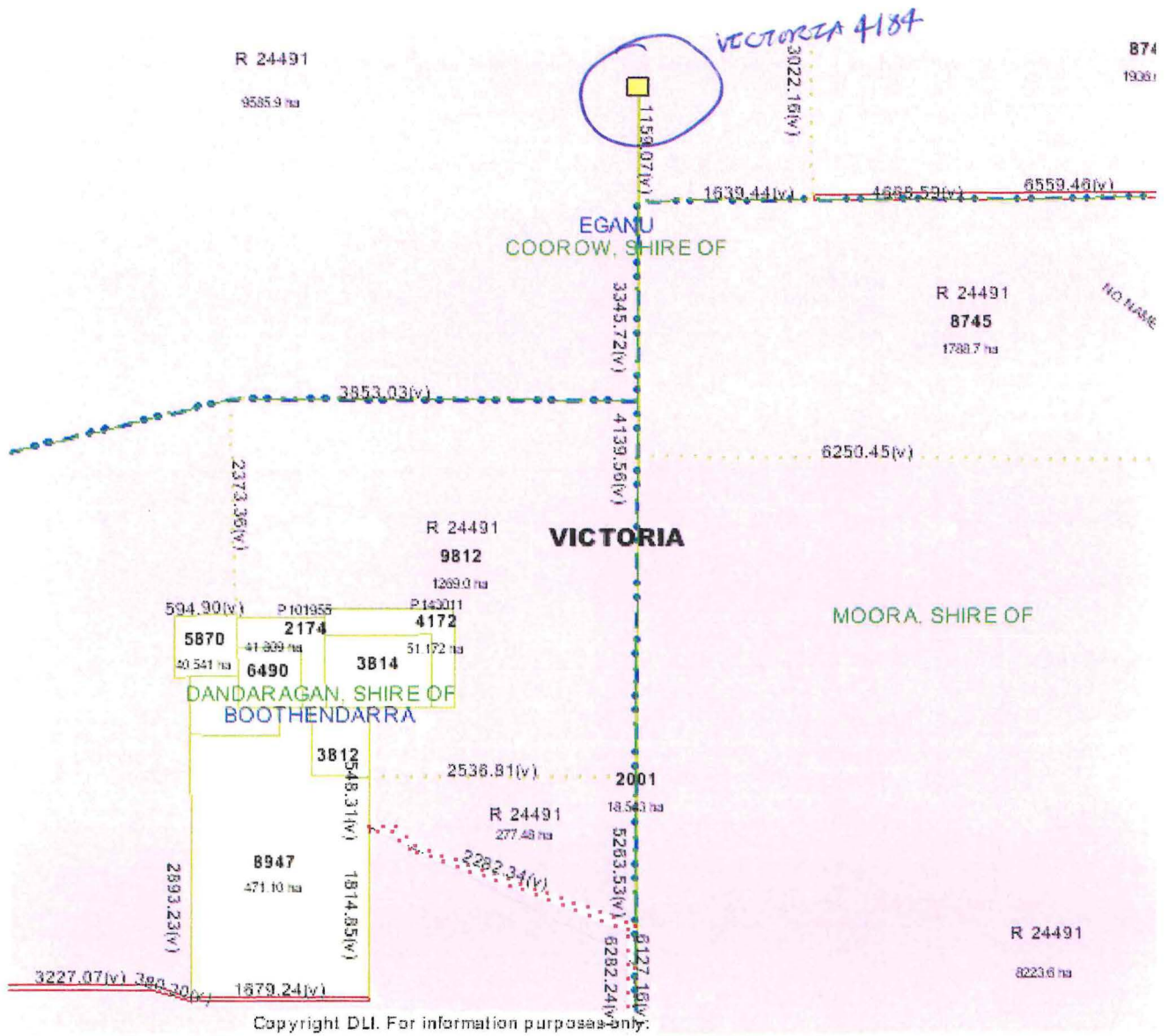

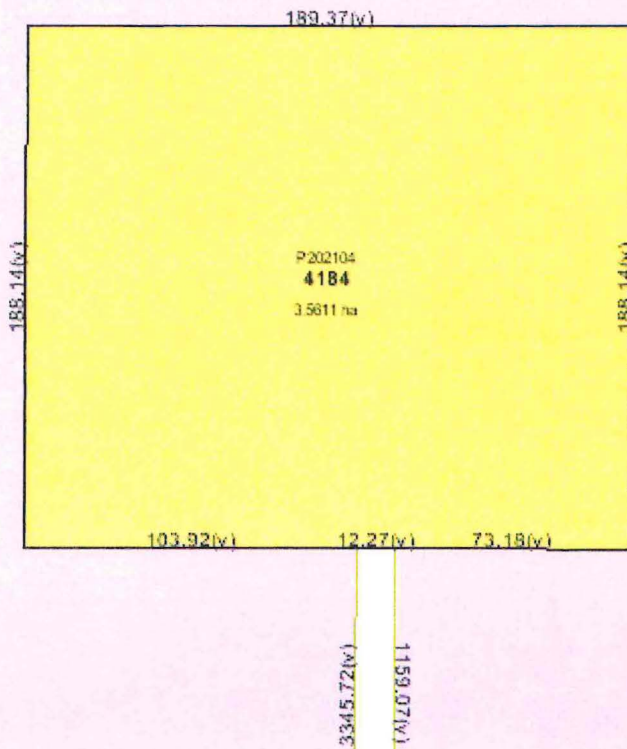

Copyright DLI. For information purposes only.

11 Galvin Heights
CLARKSON 6030.

Yvonne WARD

9407 8157

2/11

1/12 - \$25 000 ?

14/12 - would her name
\$95 000 ?
3 or 4 years - also see \$4000 -

(3 brothers)

Kevin