

NATURE RESERVE

RESERVE NO: 24496

GOVERNMENT GAZETTE
Date Page No.

FILE NUMBER: 319/65

PURPOSE: Protection of Flora

6.7.56

1674

NAME:

CLASS (Land Act):

AREA: 69 863.⁰⁶³²3867 ha.

3.12.82

4701

VESTING:

LOCATION NO(S): Vic 3940, 11295

CLASSIFICATION:

(Wildlife Act Shooting or Hunting
Section 12A) Area
94/80

4. 5.79

7147

LITHO: 91/80, 93/80 Beagle Island
92/80 124/80 Logue 1:50 000

LOCAL AUTHORITY: DANDARAGAN, COOROW,
CARNAMAH & IRWIN SHIRES

Notes:

**RESERVE GAZETTAL ACTION SHEET
FOR REGIONS AND DISTRICTS**

LANDS CLERK: Attach a copy of a map and forward to the following:

- 1. REGIONAL MANAGER:
CENTRAL FOREST, MIDWEST, GOLDFIELDS, KIMBERLEY, SWAN REGION
PILBARA, SOUTH COAST, SOUTHERN FOREST, WHEATBELT
- 2. DISTRICT MANAGER: MOORA
- 3. DISTRICT WILDLIFE OFFICER: MOORA
- 4. CLERK WOODVALE
- 5. O.I.C. INVENTORY BUNBURY/KELMSCOTT/MANJIMUP

REASON FOR GAZETTAL:

'SEE ATTACHED ACTION SHEET'

RESERVE NUMBER: 27496

CALM FILE NUMBER: 03302FF3102

NAME OF RESERVE: (BEEKEEPERS)

PURPOSE: Protection of flora

CLASS: C

AREA: 69, 161.0 ha

VESTING: NPNCA

DATE OF CURRENT GAZETTAL: 29.12.92

MAP REFERENCE: copy of survey diagram not available

SHIRE: Conamook, Mandakyan, Gairdner, Coorow

[Signature]
LANDS CLERK
09 367 0221
3370212

11 June 1993
DATE

Note: copy of survey diagram not yet forwarded by DOLA.

Gazetted 24/12/92.

RESERVE ACTION SHEET: CONSERVATION RESERVE

RESERVE NO: 24496

REASON FOR ACTION: reduction in area of 2,736.0 ha to alt
69,161 ha due to excision of an area (now reserve
42477) for to allow for coastal squatter shacks currently
occupying the area.

OFFICER	ACTION	ACTION DATE
1. <u>Lands Clerk</u>	Fill in above details	14.5.
2. <u>Reserves Clerk</u>	Attach copies of gazettal notices to file (folios: ...9.7.....) Enter relevant details on file cover.	"
3. Officer In Charge Records Index Officer	For new reserves: Index Reserves name: Index Reserves number:	
4. Senior Drafts person Legal mapping	Amend Litho: <u>See folios 148 and 149.</u> Attach/copy of litho to file (mark litho name/number)	18.5.93 8
5. Lands Clerk	Send copies of gazettal notices (or Lands Department memo) and map to: Clerk Woodvale _____ Regional Manager _____ OIC Inventory _____ Kelmscott/Bunbury _____ District Manager _____ District Wildlife Officer _____ Note: Information sent must include: (a) Dept file No. (b) Litho no./name	
6. Senior Clerk Reserves	To Note	
7. Manager Land Admin	To Note	
8. Director Nature Conservation/National parks	To Note	

CONSERVATION ESTATE OFFICER
LAND ADMINISTRATION SECTION
PARK POLICY AND TOURISM BRANCH

Reserve 24496 within MIDWEST/MOORA Region/District, was
~~created~~/amended, effective from 23 JUNE 2005.

- A copy of the customer advice can be found at folio 56.
The ~~addition~~ / excision / ~~amendment~~ is shown on the associated Deposited Plan / Diagram which is listed below:

Deposited Plan 218516 lot / location 12793/4 folio 65-68 incl.

Other relevant deposited plans / diagrams:

_____ lot / location _____ folio _____

- A locality plan with the addition / excision / amendment shown highlighted can be found at folio 69.
- Copies of other relevant notifications pertinent to this reserve action have been placed at folios 70.

Would you please advise the relevant offices of this amendment through your Reserve Action Sheet.

Recommended IUCN classification 1a (no change)

[Signature]

Program Leader
Tenure Group, GIS
Information Management Branch

28/7/06



**Customer Advices for Reserve Actions
1/10/2004 - 31/10/2004**

Shire of Carnamah 1/10/2004 - 31/10/2004

Reserve No.	Land Description	DOLA File No.	Volume/Folio	Action	Document No.	Registered	Street Name	Area	Public Plans
14867		04220-1912-03RO	3023-162	Revocation of Management Order (Shire of Carnamah, of PO Box 80, Carnamah WA 6517) for the designated purpose of ""Recreation Racecourse Showground & Golf Links"".	I959366	20/07/2004		6.3232 Ha	Carnamah 03 13.35
14867	Carnamah Lots 2 to 5 inclusive, 33 to 37 inclusive 66, 99, 100 and 106.	04220-1912-03RO	0000-000	Amendment of Reserve to To comprise Lots 158 and 160 on Deposited Plan 220452 In lieu of Carnamah Lots 2 to 5 inclusive, 33 to 37 inclusive 66, 99, 100 and 106 and of its area being decreased to 4.6164 Hectares.	I527384	24/06/2003		4.6164 Ha	
14867	Lots 158 on Deposited Plan 220452 Lots 160 on Deposited Plan 220452	04220-1912-03RO	3114-692 3114-694	Amendment of Reserve to To now comprise Lots 169 and 170 on Deposited Plan 221403 , and with its area being decreased to 3.9771 ha, accordingly.	I959367	20/07/2004		3.9771 Ha	Carnamah 03 13.35
14867 14867	Lots 169 and 170 on DP 221403	04220-1912-03RO	3122-751 3122-752 3122-752 3122-752	Management Order to Shire of Carnamah, of PO Box 80, Carnamah WA 6517 (i) To be utilised for the designated reserve purpose. (ii) Power to lease (or sub lease or licence) for the designated purpose is granted for the whole or any portion thereof for any term not exceeding twenty one (21) years from the date of the lease subject to the approval in writing of the Minister for Lands being first obtained to each and every lease or assignment of lease, pursuant also to the provisions of section 19 of the Land Administration Act 1997. for the designated purpose of ""Recreation Racecourse Showground & Golf Links""	I959368	20/07/2004		3.9771 Ha	Carnamah 03 13.35
24234		01314-1954-02RO	3102-480	Revocation of Management Order () for the designated purpose of "Water Supply".	I959363	20/07/2004		60.8267 Ha	
24234 24234 24234		01314-1954-02RO	3122-748 3122-749 3122-750	Management Order to Shire of Carnamah of PO Box 80, Carnamah WA 6517 To be utilised for the designated purpose of "Water Supply" only, for the designated purpose of ""Water Supply""	I959365	20/07/2004	Carnamah-Eneabba Road & Slater Street	59.7381 Ha	BG40 (2) 13.35 & (10) 3.7
24234	Lot 152 on Deposited Plan 218572	01314-1954-02RO	3102-480 3102-480	Amendment of Reserve to To now comprise Lots 166, 167 and 168 on Deposited Plan 221403, and with its area being reduced to 59.7381 ha, accordingly.	I959364	20/07/2004	Carnamah-Eneabba Road & Slater Street	59.7381 Ha	BG40 (2) 13.35, 13.36, BG40 (1) 3.7

Handwritten notes:
 pls prepare plans & return files to V.O. 16/11/05.
 21/10/05

24496	Victoria Location 3940 on Deposited Plan 232363 Victoria Location 3943 on Deposited Plan 134885 Victoria Location 6655 on Deposited Plans 83151 and 210684 Victoria Location 7138 on Deposited Plan 143625 Victoria Location 7142 on Deposited Plan 202298 Victoria Location 8345 on Deposited Plan 203754 Victoria Location 8441 on Deposited Plan 204375 Victoria Location 10003 on Deposited Plan 207015 Victoria Location 11295 on Deposited Plan 214269 Victoria Location 11865 Victoria Location 11928 on Deposited Plan 207015 Victoria Location 9947 Victoria Location 10004 Victoria Location 10191 Victoria Location 10200	05153-1948-10RO	3098-892 0000-000 0000-000 0000-000 0000-000 0000-000 0000-000 3098-892 0000-000 3098-892 3098-892 0000-000 0000-000 3098-892	Amendment of Reserve to To exclude: (i) Victoria Location 12679 on Deposited Plan 31647 (ii) Victoria Location 12680 on Deposited Plan 31646 (iii) Victoria Location 12681 on Deposited Plan 31648 Reserve 24496 now comprises Lots 9759, 11888, 12174-12179, 12799-12806, 12810-12812 and 12817 on Deposited Plan 39607 ONLY and its area now being 66537.4146 hectares.	I330013	17/12/2002	Indian Ocean Drive	64544.875 Ha	Dongara SE (25)
24496	Victoria Locations 3940 on Deposited Plan 232363, 3943 on Deposited Plan 134885, 6655 on Deposited Plans 83151 and 210684, 7138 on Deposited Plan 143625, 7142 on Deposited Plan 202298, 8345 on Deposited Plan 203754, 9947, 10003, 10004, 10200 and 10191 on Lands & Surveys Miscellaneous Roll Plan 175 and 11295 on Deposited Plan 214269 and 11928 on Deposited Plan 207015.	05153-1948-10RO	000-000	Amendment of Reserve to To include Victoria Location 8441 on Deposited Plan 204375, and Victoria Location 11865	I330012	17/12/2002	Indian Ocean Drive	0 sqm	Dongara SE (25)
24496	Victoria Locations 3940, 9947, 10200, 11295 and 11928	05153-1948-10RO	3098-892	Amendment of Reserve to To now include Victoria Locations 3943, 6655, 7138, 7142, 8345, 10003, 10004, and 10191 on Lands and Surveys Miscellaneous Roll Plan 175, as per Government Gazette notice dated 6 July 1956. Reserve description to correct anomaly. Area comprising about 140,000 acres.	I330011	17/12/2002	Indian Ocean Drive	140000	Land & Surveys Miscellaneous Roll, Plan 175
46982	Victoria Location 12679 on Deposited Plan 31647	02257-2002-01RO	3127-806 3127-806 3127-806	Reserve Creation for the designated purpose of "Marl Extraction".	I330016	17/12/2002	Indian Ocean Drive	81.5452 Ha	BE40 (2) & (10) 37.33
46983	Victoria Location 12681 on Deposited Plan 31648	02258-2002-01RO	3127-808 3127-808 3127-808	Reserve Creation for the designated purpose of "Marl Extraction".	I330015	17/12/2002	Indian Ocean Drive	18.8907 Ha	BE40 (2) & (10) 37.33
46984	Victoria Location 12680 on Deposited Plan 31646	02259-2002-01RO	3127-807 3127-807 3127-807	Reserve Creation for the designated purpose of "Marl Extraction".	I330017	17/12/2002	Indian Ocean Drive	14.69 Ha	BE40 (2) & (10) 37.33
47108	Lot 159 on Deposited Plan 220452.	01442-2003-01RO	3114-693	Reserve Creation for the designated purpose of "Waste Recycling".	I527387	24/06/2003		1.3988 Ha	

see p. 16

CIS: pls send 2005F001496V01 and 2005F001966V01 to VFL with this.

Customer Advices for Reserve Actions 1/10/2005 - 31/10/2005

Shire of Irwin 1/10/2005 - 31/10/2005

Reserve No.	Land Description	DOLA File No.	Volume/Folio	Action	Document No.	Registered	Street Name	Area	Public Plans
24496	Lot 9759 on Deposited Plan 39607 Lot 12174 on Deposited Plan 39607 Lot 11888 on Deposited Plan 39607 Lot 12175 on Deposited Plan 39607 Lot 12176 on Deposited Plan 39607 Lot 12177 on Deposited Plan 39607 Lot 12178 on Deposited Plan 39607 Lot 12179 on Deposited Plan 39607 Lot 12799 on Deposited Plan 39607 Lot 12800 on Deposited Plan 39607 Lot 12801 on Deposited Plan 39607 Lot 12802 on Deposited Plan 39607 Lot 12803 on Deposited Plan 39607 Lot 12804 on Deposited Plan 39607 Lot 12805 on Deposited Plan 39607 Lot 12806 on Deposited Plan 39607 Lot 12810 on Deposited Plan 39607 Lot 12811 on Deposited Plan 39607 Lot 12812 on Deposited Plan 39607 Lot 12817 on Deposited Plan 39607	00144-1969-02RO	3074-20 3110-928 3090-515 3110-929 3110-930 3110-931 3110-932 3110-933 3133-22 3133-23 3133-24 3133-25 3133-26 3133-27 3133-28 3133-29 3133-149 3133-150 3133-151 3133-387	Amendment of Reserve to To exclude land now identified as Lots 12793 and 12794 on Deposited Plan 218516 and the area being reduced to 66503.7582 hectares.	J333114	23/06/2005	Indian Ocean Drive	66503.7582 Ha	BEHARRA 1:50000

2005F001966V01
SERIAL NO: 2005F001966V01

DEPARTMENT OF CONSERVATION & LAND MANAGEMENT
2 1 NOV 2005
KENSINGTON WA

Pls prepare plans for 24496.
Thanks, Vin. 21/10/05
JLF



Report Name: Gazettal History

Query Criteria

Crown Reserve No. = 24496

Special Comments

Crown Reserve **24496** Class: **C**
 Name: **Beekkeepers Nature Reserve** Name Approval: Unofficial
 Tenure: Nature Reserve Area: 64,544.9 ha
 Purpose: Protection Of Flora
 Vesting: Conservation Commission

<u>Date</u>	<u>Gazettal Action</u>	<u>Description</u>
17-Nov-2004	Comment	Entry Dated 17-12-2002 Also Includes Area Recalc To Correct Original Area Anomaly (see Reserve Action Sht 1-10 To 31-10-2004)
17-Dec-2002	Area	66537.4146 (I330013)
17-Dec-2002	Formerly	Victoria Locs 3940, 3943, 6655, 7138, 7142, 8345, 8441, 9947, 10003, 10004, 10191, 10200, 11295, 11865, 11928 (I330011 & I330012)
17-Dec-2002	Lot	Lots 9759, 11888, 12174- 12179, 12799- 12806, 12810- 12812 & 12817 On Dp39607 (I330013)
17-Dec-2002	Survey No.	Dp39607 (I330013)
16-Nov-2000	Comment	Conservation Commission Established Due To CALM Amendment Act 2000 (No 35 of 2000). Supersedes LFC And NPNCA.
25-Feb-1998	Comment	Entry Of 6 Feb In History And Front Tennis Screen Was Only A Correction Notice For 13 Jan. The 13 Jan Should Be The Gazettal Date For The Area Change.
13-Jan-1998	Area	67909.2705 (Resumed By Road No. 17911)
25-Nov-1997	Area	68041.9966 (Resumed By Road No. 18811)
15-Oct-1996	Area	68063.3765
15-Oct-1996	Public Plan	Dongara SE (25)
14-Nov-1995	Area	About 68063.4165
24-Feb-1995	Area	About 68236.0215
13-Dec-1994	Area	68851.4165 Reduced By Land Resumption
14-Jun-1994	Area	69024.0215
1-Dec-1993	Area	69158.0215
26-Jun-1992	Area	About 70922.0000
26-Jun-1992	DOLA File	5153/948 V7; 5153/48 V2; 5153/948 V8 Pf
26-Jun-1992	Formerly	As To Loc 11928- fmly Loc 10001
26-Jun-1992	Previous Locations	Victoria Locs 3940, 11295, 10200, 9947 & 11928
24-Jan-1992	Area	About 68971.0000
24-Jan-1992	Street	Green Head - Leeman Road And Coast Road Coorow - Green Head Rd
23-Aug-1991	Vesting	National Parks & Nature Conservation Authority
16-Sep-1988	Area	69049.0
10-Jun-1988	Area	Abt 69066.0000
31-Mar-1987	Easement	Subject To Easement 3134B/67
14-Oct-1983	Area	69519.7606 By Rd. 15675
23-Sep-1983	Area Excision	69863.3867
12-Aug-1983	Area Addition	69905.3179 By Rd. 16153 Superceds Above Action
03-Dec-1982	Area Addition	Abt 69863.3867 Include Loc 11295
18-Jun-1982	Area Excision	Abt 69859.1672
28-Nov-1980	Area Excision	69859.4907 By Rd. 6963
07-Nov-1980	Area Excision	Abt69860.2731 By Rd. 16153 Superceded Below
21-Dec-1979	Area Excision	Abt70012.6577

LAND ACT 1933

Reserves

Department of Land Administration,
Perth, 10 June 1988.

HIS Excellency the Governor in Executive Council has been pleased to set apart as Public Reserves the land described below for the purpose therein set forth.

File No. 1178/988.

MEEKATHARRA.—No. 40507 (Church Site), Lot No. 872 (2 015 square metres). (Diagram 87155, Public Plan Meekatharra Townsite Sheet 3 (McCleary Street).)

File No. 2589/983.

VICTORIA.—No. 40534 (Quarry (Shell)), Location No. 11682 (4.088 6 ha). (Diagram 88338, Public Plan Lesueur and Pt. Greenhead 1:50 000.)

File No. 3386/986.

DELISSER.—No. 40551 (Use and Benefit of Aboriginal Inhabitants), Location No. 7 (16 586 ha). (Reserve Diagram 656, Public Plan Forrest 1:500 000.)

File No. 747/972V2.

VICTORIA.—No. 40588 (Use and Requirements of the Commissioner of Main Roads), Location No. 11762 (5.488 2 ha). (Diagram 88594, Public Plan Nanson S.W. 1:25 000.)

N. J. SMYTH,
Executive Director.

AMENDMENT OF RESERVES

Department of Land Administration,
Perth, 10 June 1988.

HIS Excellency the Governor in Executive Council has been pleased to approve, under section 37 of the Land Act 1933 of the amendment of the following Reserves—

File No. 5153/948V7.—No. 24496 (Victoria District) "Protection of Flora" to exclude those portions now comprised in—

- (a) Victoria Location 11682 as surveyed and shown bordered red on Land Administration Diagram 88338.
- (b) Victoria Location 11761 as designated and shown bordered red on Reserve Plan 286, and of its area being reduced to about 69 066 hectares accordingly.

(Plan Lesueur and Pt. Greenhead 1:50 000 Beagle Island and Logue 1:50 000.)

File No. 2093/56V2.—No. 22521 (Victoria District) "Camping and Water" to comprise Location 11761 as designated and shown bordered red on Reserve Plan 286, in lieu of Location 9759 and of its area being increased to about 1 020.051 8 hectares accordingly. (Plan Greenhead 1:2 000 Pt. 38.33, Leeman Reg. 1:10 000, Lesueur and Pt. Greenhead 1:50 000, Beagle Island and Logue 1:50 000.)

N. J. SMYTH,
Executive Director.

CANCELLATION OF RESERVE No. 22522

Department of Land Administration,
Perth, 10 June 1988.

File No. 2094/956.

HIS Excellency the Governor in Executive Council has been pleased to approve, under section 37 of the Land Act 1933 of the cancellation of Reserve No. 22522 (Victoria Location 9758) "Camping and Water". (Plan Lesueur and Pt. Greenhead 1:50 000.)

N. J. SMYTH,
Executive Director.

CHANGE OF PURPOSE OF RESERVE

Department of Land Administration,
Perth, 10 June 1988.

File No. 2093/956 V2.

HIS Excellency the Governor in Executive Council has been pleased to approve, under section 37 of the Land Act 1933, of the purpose of Reserve No. 22521 (Victoria Location 11761) being changed from "Camping and Water" to "Parkland and Recreation". (Public Plan: Lesueur and Pt. Greenhead 1:50 000, Beagle Island and Logue 1:50 000.)

N. J. SMYTH,
Executive Director.

LOCAL GOVERNMENT ACT, 1960

Department of Lands and Surveys,
Perth, 10 June 1988.

IT is hereby declared that, pursuant to the resolution of the City of Geraldton passed at a meeting of the Council held on or about 3 April 1986 and 19 February 1987 the undermentioned lands have been set apart, taken, or resumed under section 17 of the Public Works Act 1902, for the purpose of a new road, that is to say—

Geraldton

2775/984.

Road No. 1977 (Chapman Road) (widening of parts). Those portions of Geraldton Lots 783, 787, 788, 1367, 1378 and Victoria Location 72 and 191 as delineated and coloured dark brown on Land Administration Plan 16986.

51 square metres being resumed from Geraldton Lot 788.

50 square metres being resumed from Geraldton Lot 787.

103 square metres being resumed from Geraldton Lot 783.

50 square metres being resumed from Geraldton Lot 1367.

50 square metres being resumed from Geraldton Lot 1378.

170 square metres being resumed from Victoria Location 72.

52 square metres being resumed from Victoria Location 191.

(Public Plan Geraldton 1:2 000 15.19, 16.19, 16.20; N244-4 Chain)

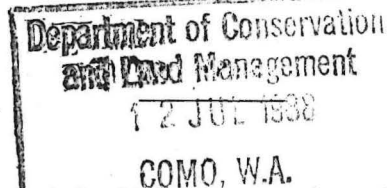

IT is hereby declared that, pursuant to the resolution of the Shire of Greenough passed at a meeting of the Council held on or about 30 November 1984 the undermentioned lands have been set apart, taken, or resumed under section 17 of the Public Works Act 1902, for the purpose of a new road, that is to say—

Greenough

747/72 P/F.

Road No. 2462 (Geraldton-Mt. Magnet Road) (widening of part). That portion of Railway Reserve as delineated and coloured dark brown on Land Administration Diagram 88592.

Road No. 17716 (extension). A strip of land varying in width, commencing at the eastern terminus of the existing road and extending generally northeastward as delineated and shown coloured mid and dark brown on Land Administration Diagram 88593 through Victoria Locations 11121 and 9453 (Reserve No. 20773) to terminate at the northwestern side of Geraldton-Mt. Magnet Road (Road No. 2462).

2.939 8 hectares being resumed from Victoria Location 11121.

Reserve No. 20773 is hereby reduced by 6 758 square metres.

(Notice of Intention to Resume Gazetted 25 September 1987.)

(Public Plan Nanson S.W. 1:25 000; 157C/40 chain)

CLERK, WOODVALE

Records - please file + return @ Lands CI

02024F 3100

24 December 1992]

GOVERNMENT GAZETTE, WA

DEPARTMENT OF CONSERVATION
AND LAND MANAGEMENT 8295
- 5 JAN 1993

97
144
43

LA403

CONSERVATION AND LAND MANAGEMENT ACT 1984
RESERVATION OF STATE FOREST ORDER

CALM File: 029956F3001.

DOLA File: 2532/928.

Made by His Excellency the Deputy of the Lieutenant-Governor and Administrator under section 8.
It is directed that the area described in the schedule be dedicated as an addition to State Forest No. 30.

Schedule

The whole of the Closed Road comprising an area of about 3.4625 hectares (formerly Road No. 6199), commencing from a northeastern side of Hester Cascades Road (Road No. 4654) and extending generally northwesterly through State Forest No. 30 and Nelson Location 6816 (State Forest No. 30) to terminate at the southern boundary of Location 6687.

Public Plans: Bridgetown SE 1:25 000 and BG29 (10) 6.2.

D. G. BLIGHT, Clerk of the Council.

LA701

LAND ACT 1933
RESERVATION NOTICE

Made by His Excellency the Governor under Section 29.

The Crown land described below has been set apart as a public reserve.

DOLA File: 1108/969.

Reserve No. 42477 comprising Illawong Lots 1 to 30 inclusive, 32 to 37 inclusive, 39 to 41 inclusive, 43 to 57 inclusive, Coolimba Lots 1 to 62 inclusive and 64 and Victoria Locations 11957 and 11959 inclusive with an area of about 2736.0167 hectares on Land Administration Reserve Diagram 392 for the designated purpose of "Parkland, Recreation" and the letting of cottages existing thereon on 18 May 1992.

Public Plans: Beagle Island, Logue and Beharra—Pt. Cliff (50) BE40 (10) Pt. 8.1 and 8.2, BE40 (2) 37.33, 31.12 and 31.13.

Local Authority—Shire of Carnamah.

H. HOUGHTON, Acting Chief Executive.

LA801

LAND ACT 1933
AMENDMENT OF RESERVE

Made by His Excellency the Governor under Section 37.

The following reserve has been amended.

DOLA File: 5153/948V8.

Reserve No. 24496 (Victoria Locations 3940, 9947, 10200, 11295 and 11928) "Protection of Flora" to exclude that portion now delineated and shown bordered red on Land Administration Reserve Plan 392 (Reserve 42477) and of its area being reduced to about 69161.1390 hectares accordingly.

Public Plans: BE40 (2) 37.33, (10) 8.1 and 8.2, Beagle Island, Logue and Mount Lefroy (50) and Dongara NE and SE (25).

Local Authority—Shires of Carnamah, Dandaragan, Irwin and Coorow.

H. HOUGHTON, Acting Chief Executive.

7.1.93
Dfile
5/5/93

LB201

LAND ACT 1933
CANCELLATION OF RESERVE

Made by His Excellency the Governor under Section 37.

The following reserve has been cancelled.

DOLA File: 3188/970.

Reserve No. 31200 (at Coolimba) "Recreation".

Public Plan: BE40 (2) 31.12 and 31.13.

Local Authority—Shire of Carnamah.

H. HOUGHTON, Acting Chief Executive.

DOLA File: 5153/948V8.

Reserve No. 24496 (Victoria Locations 3940, 9947, 10200, 11295 and 11928) "Protection of Flora" to exclude that portion containing about 134 hectares as shown on Land Administration Miscellaneous Plan 1854 and of its area being reduced to about 69024.0215 hectares accordingly.

Public Plans: BE40(2) 37.33, (10) 8.1 and 8.2, Beagle Island, Logue and Mount Lefroy (50) and Dongara NE & SE (25).

Local Authority—Shires of Carnamah, Dandaragan, Irwin and Coorow.

DOLA File: 3007/916V2.

Reserve No. 16670 (Kyarra District) "Use and Benefit of Aborigines" to comprise Location 194 as shown delineated and bordered red on Land Administration Reserve Diagram 1252 and of its area being reduced (recalculated) to 4246.9858 hectares accordingly.

Public Plan: Belele (250). Wilgie Mia Road.

Local Authority—Shire of Cue.

DOLA File: 5743/951

Reserve No. 23938 (Narrogin Lots 1343, 1397, 1428 and 1446) "Railway Purposes (Housing)" to exclude Lot 1343 and of its area being reduced to 2777 square metres accordingly.

Public Plan: BJ31 (2) 11.37. Fox and Northwood Streets.

Local Authority—Tbwn of Narrogin.

DOLA File: 3567/976V2.

Reserve No. 34503 (Wellington Locations 5224 and 5276) "Public Recreation" to exclude Location 5276 and of its area being reduced to 1725 square metres accordingly.

Public Plans: BG30 (2) 5.34 and 6.34. Mayne Way.

Local Authority—Shire of Harvey.

DOLA File: 2277/959V3.

Reserve No. 25412 (at Dongara) "Caravan Park" to comprise Lot 94 as surveyed and shown bordered pink on Land Administration Diagram 91394 in lieu of Lot 59 and of its area being reduced to 1.9466 hectares accordingly.

Public Plans: BE42 (2) 34.02 and 34.03. Church Street.

Local Authority—Shire of Irwin.

DOLA File: 3406/980.

Reserve No. 38046 (Dongara Lots 66 and 78) "Protection of Foreshore" to:—

(i) exclude that portion containing 2591 square metres now comprised in Lot 94 as shown bordered pink on Land Administration Diagram 91394 and

(ii) include Lot 93 as surveyed and shown bordered pink on Land Administration Diagram 91394 and of its area being increased to about 4.6243 hectares accordingly.

Public Plan: BE43 (2) 34.02 and 34.03. Church Street.

Local Authority—Shire of Irwin.

DOLA File: 3041/923.

Reserve No. 18746 (Bencubbin Lot 129) "Police" to exclude that portion now comprised in Lot 277 as surveyed and shown bordered green on Land Administration Diagram 91313 and of its area being reduced to 5296 square metres accordingly.

Public Plans: BK37 (2) 12.31 and 12.32. Hammond Street.

Local Authority—Shire of Mount Marshall.

DOLA File: 12125/909.

Reserve No. 12477 (Fremantle Townsite and Cockburn Sound District) "Recreation" to comprise Fremantle Lot 2091 as shown delineated and bordered red on Land Administration Reserve Plan 411 in lieu of Location 2473 and Lots 1586 and 1958 and of its area being increased to about 6.2700 hectares accordingly.

Public Plan: BG34 (2) 07.11. Marine Terrace.

Local Authority—City of Fremantle.

DOLA File: 1955/894.

Reserve No. 594 (at Fremantle) "Historic Buildings and Park" to comprise Lot 2078 as surveyed and shown bordered pink on Land Administration Diagram 90591 in lieu of Lots 313 to 316 inclusive, 341, 343 to 345 inclusive 1937, 1954 and 1955 and of its area being increased (recalculated) to 1.1158 hectares accordingly.

Public Plan: BG34 (2) 07.14. Adelaide Street.

Local Authority—City of Fremantle.

CLERK,

WOODVALE-

F.Y.I.

1. file

19.9.94

3. N. RYAN.

2. Mr. Collins - for your usual action
re a letter job. Thanks

A. A. SKINNER, Chief Executive.

24496

201
279

2. Public Work: Extension of Richmond Street (Road No 2614)

Local Authority: City of Canning

Plan/Diagram No. showing Land resumed: Diagram 91848

Council Resolution Date: 21 December 1993 DOLA Ref:428/1994

Schedule

Owner or Reputed Owner	Occupier or Reputed Occupier	Description	Area (approx.)
Kenneth Ernest Clark	K.E. Clark	Part of Lot 59 on Plan 2580 (sheet 1) being part of the land contained in Certificate of Title Volume 1954 Folio 614	1 250m ²

3. Public Work: Widening of Victor Road (Road No 1664)

Local Authority: Shire of Mundaring

Plan/Diagram No. showing Land resumed: Diagram 91486

Council Resolution Date: 23 June 1992 DOLA Ref:1925/1992

Schedule

Owner or Reputed Owner	Occupier or Reputed Occupier	Description	Area (approx.)
Simon Gunther Ludwig Wahl and Maria Stauble	S.G.L. Wahl and M. Stauble	Part of Lot 52 on Plan 4508 (sheet 3) being part of the land contained in Certificate of Title Volume 1421 Folio 392	123m ²

November 24, 1994.

GEORGE CASH, Minister for Lands.

December 6, 1994.

DAVID K. MALCOLM, The Lieutenant-Governor and deputy of the Governor.

SCHEDULE No.:A20/1994

DOLA 70/1994

**LOCAL GOVERNMENT ACT 1960
PUBLIC WORKS ACT 1902
NOTICE OF RESUMPTION OF LAND**

For the purposes of the public work described in the Schedule, the land described in the Schedule ("the resumed land") has been set apart, taken or resumed.

A plan and a more particular description of the resumed land may be inspected between 8.00 a.m. and 5.00 p.m. on working days at:

Department of Land Administration, Midland Square, Midland

The resumed land shall, by force of the Public Works Act 1902 and Local Government Act 1960, be vested in Her Majesty for an estate in fee simple (except those lands being under the Land Act or dedicated or reserved for a public purpose, which will be vested in Her Majesty absolutely) for the public work, freed and discharged of all trusts, mortgages, charges, obligations, estates, interest, right-of-way, or other easements whatsoever.

SCHEDULE

1. Public Work: Widening and Extension of Coast Road (Road No 11381)

Local Authority: Shire of Carnamah

Plan/Diagram No. showing Land resumed: Plans 18262 and 18261

Council Resolution Date: 19 October 1993 DOLA Ref:1609/1981

CLARK WOOD VALL - FYT

0-1-95

033024F3102

270
275

13 December 1994]

GOVERNMENT GAZETTE, WA

6737

Schedule

Owner or Reputed Owner	Occupier or Reputed Occupier	Description	Area (approx.)
Crown	National Parks and Nature Conservation Authority as Vestee	Portion of Victoria Locations 10200 and 10191 being part of the land set aside as Reserve 24496 for the "Protection of Flora"	172.605 7ha

2. Public Work: Extension of Lakes Parade
 Local Authority: Shire of Harvey
 Plan/Diagram No. showing Land resumed: Diagram 91755
 Council Resolution Date: 24 August 1993 DOLA Ref:1304/1993

Schedule

Owner or Reputed Owner	Occupier or Reputed Occupier	Description	Area (approx.)
Binningup (South) Pty Ltd	Binningup (South) Pty Ltd	Part of Lot 165 on Diagram 39312 being part of the land contained in Certificate of Title Volume 1715 Folio 961	8 191m ²

SCHEDULE

3. Public Work: Boronia Road
 Local Authority: Shire of Augusta-Margaret River
 Plan/Diagram No. showing Land resumed: Diagram 91627
 Council Resolution Date: 7 May 1992 DOLA Ref:1614/1951

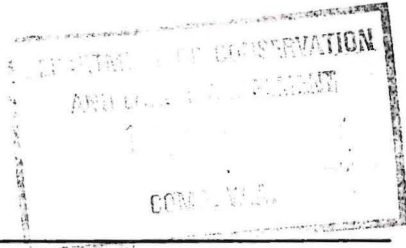

Schedule

Owner or Reputed Owner	Occupier or Reputed Occupier	Description	Area (approx.)
Crown	Vacant	Portion of Sussex Location 4004 set aside as Reserve 23473 for the purpose of "Sanitary Site"	8 793m ²

November 24, 1994.

GEORGE CASH, Minister for Lands.

December 6, 1994.

DAVID K. MALCOLM, The Lieutenant-Governor and deputy of the Governor.

DOLA 70/1994

SCHEDULE No.:A23/1994

LOCAL GOVERNMENT ACT 1960
PUBLIC WORKS ACT 1902
NOTICE OF RESUMPTION OF LAND

For the purposes of the public work described in the Schedule, the land described in the Schedule ("the resumed land") has been set apart, taken or resumed.

A plan and a more particular description of the resumed land may be inspected between 8.00 a.m. and 5.00 p.m. on working days at:

Department of Land Administration, Midland Square, Midland

The resumed land shall, by force of the Public Works Act 1902 and Local Government Act 1960, be vested in Her Majesty for an estate in fee simple (except those lands being under the Land Act or dedicated or reserved for a public purpose, which will be vested in Her Majesty absolutely) for the public work, freed and discharged of all trusts, mortgages, charges, obligations, estates, interest, right-of-way, or other easements whatsoever.

1. A. Lee - x

2. Mr. Collins - for
3. Mr. Ryan

MR 16.1

*See p 10 2-
S. Collins
6-7
action*

DOLA File 3201/989.

Reserve No. 44408 comprising Sussex Location 5070 (formerly Lot 208 on Diagram 78464) area of 3856 square metres. for the designated purpose of "Public Recreation".

Section 20A.

Public Plan: BF29 (2) 26.37. Grebe Ct.

Local Authority—Shire of Busselton.

DOLA File 3028/966.

Reserve No. 44413 comprising Gascoyne Junction Lot 17 with an area of 1518 square metres on Original Plan 9642 for the designated purpose of "Use and Requirements of the Shire of Upper Gascoyne."

Public Plan: BF53 (2) 07.28. Gregory and Scott Streets.

DOLA File 639/995.

Reserve No. 44482 comprising Victoria Location 11998 with an area of 400 square metres on Land Administration Diagram 92090 for the designated purpose of "Parkland, Recreation and the Letting of Cottages."

Public Plan: Dongara SE (25).

Local Authority—Shire of Irwin.

DOLA File 1714/991.

Reserve No. 44490 comprising Lancelin Lot 323 with an area of 8600 square metres on Original Plan 10259 for the designated purpose of "Recreation and Civic Buildings."

Public Plan: BF37 (2) 21.07. Atkinson and Rock Ways.

Local Authority—Shire of Gingin.

DOLA File 2727/995

Reserve No. 44507 comprising Cockburn Sound Location 4269 (formerly the land coloured brown and marked Pedestrian Accessway on Diagram 39682) with an area of 382 square metres for the designated purpose of "Buffer Strip".

Public Plan: BG34 (2) 08.09 and 08.10. Paulik Way/Rockingham Road.

Local Authority—City of Cockburn.

DOLA File 888/996.

Reserve No. 44541 comprising Jarrahdale Lot 118 (formerly Lot 119 on Plan 21063) with an area of 2144 square metres for the designated purpose of "Public Recreation"

Section 20A.

Public Plan: BG33 (2) 26.22. McNeil Grove.

Local Authority—Shire of Serpentine-Jarrahdale.

DOLA File 491/944

Reserve No. 44576 comprising Fremantle Lot 1755 with an area of 6076 square metres on Land Administration Diagram 59981 for the designated purpose of "Government Requirements"

Public Plan: BG 34 (2) 07.08. McTaggart Road.

Local Authority—City of Cockburn.

DOLA File 492/992v2.

Reserve No. 44544 comprising Cockburn Sound Location 4253 with an area of 5.8124 hectares on Land Administration Plan 19341 for the designated purpose of "Use and Requirements of the Minister for Works".

Public Plans: BG34 (2) 12.11,13.11. Farrington Road.

Local Authority—City of Melville.

DOLA File No. 557/995.

Reserve No. 44390 comprising Nelson Location 13475 with an area of 5685 square metres on Land Administration Diagram 92311 for the designated purpose of "Telecommunications Site"

Public Plan: Quindalup NW (25). Bokerup Road.

Local Authority—Shire of Cranbrook.

A. A. SKINNER, Chief Executive.

LA801*

LAND ACT 1933
AMENDMENT OF RESERVES

Made by His Excellency the Governor under Section 37.

The following reserves have been amended.

DOLA File 5153/948V8.

Reserve No. 24496 (Victoria Locations 3940, 9947, 10200, 11295 and 11928) "Protection of Flora" to exclude that portion of Location 9947 shown bordered red on Land Administration Diagram 92090 and of its area being reduced to about 68063.3765 hectares accordingly.

Public Plan: Dongara SE (25).

Local Authority—Shire of Irwin.

22-10-96

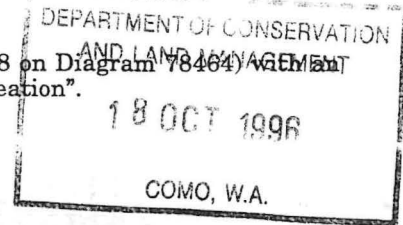

CALM-MANAGED LANDS AND WATERS

AS AT 30th JUNE 1996

- Legend
- National Park
 - Conservation Park
 - Nature Reserve
 - State Forest, Timber Reserve, Freehold & Other Reserve
 - Section 5(g) Reserve
 - Leasehold in the name of the Executive Director
 - Marine Park / Marine Nature Reserve
 - CALM Region Boundary
 - CALM Regional Office

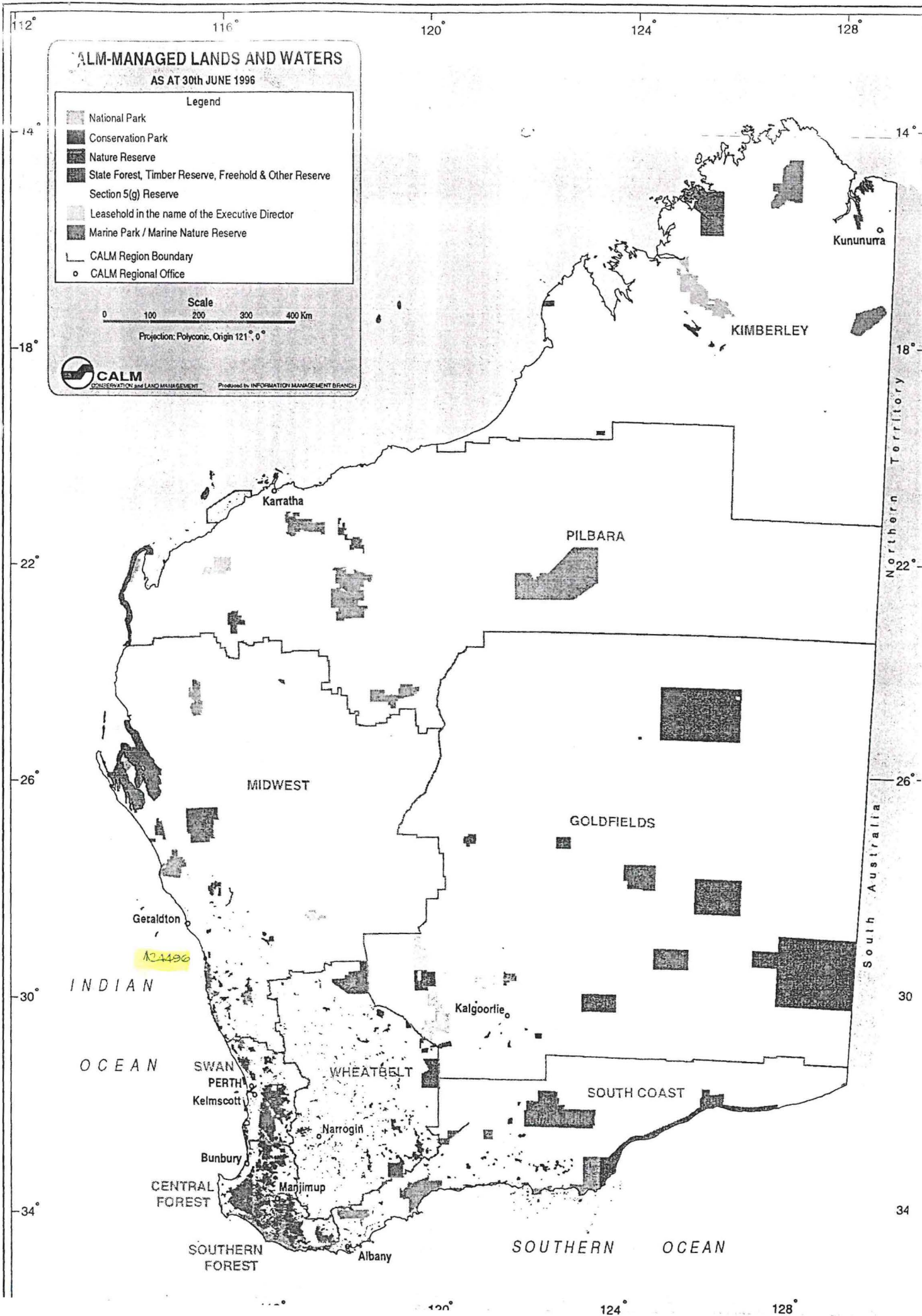
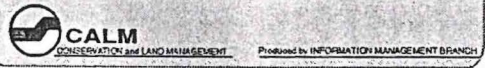
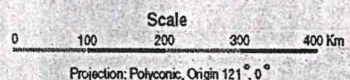

124496

Northern Territory
South Australia

INDIAN OCEAN

SOUTHERN OCEAN

SWAN PERTH
KELMSCOTT
BUNBURY
CENTRAL FOREST

WHEATBELT
NARROGIN
MANJIMUP

SOUTHERN FOREST

MIDWEST

GOLDFIELDS

PILBARA

KIMBERLEY

Kununurra

Karratha

Kalgoorlie

Albany

Bunbury

Perth

Kelmscott

Narrogin

Manjimup

SOUTH COAST

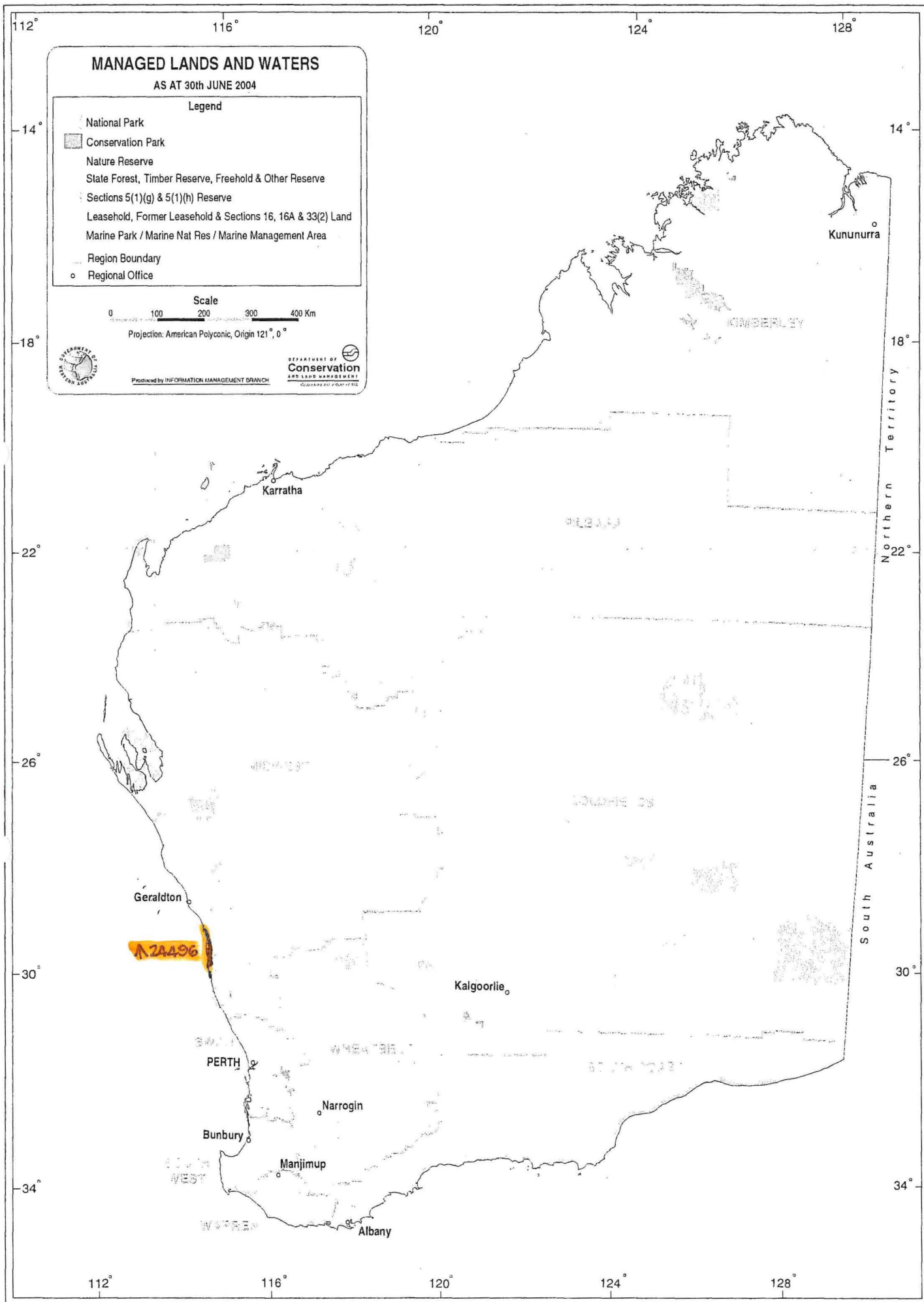

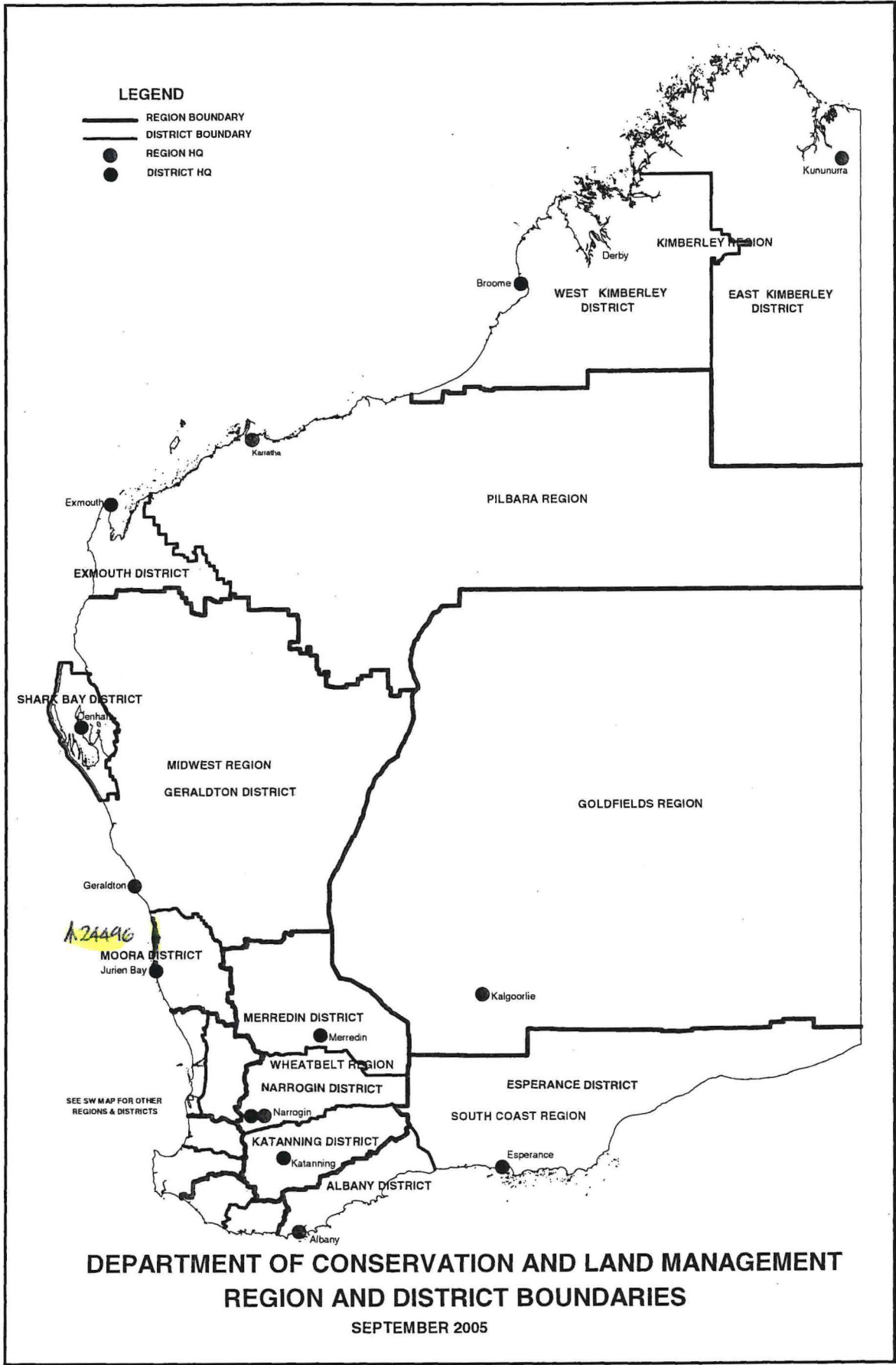

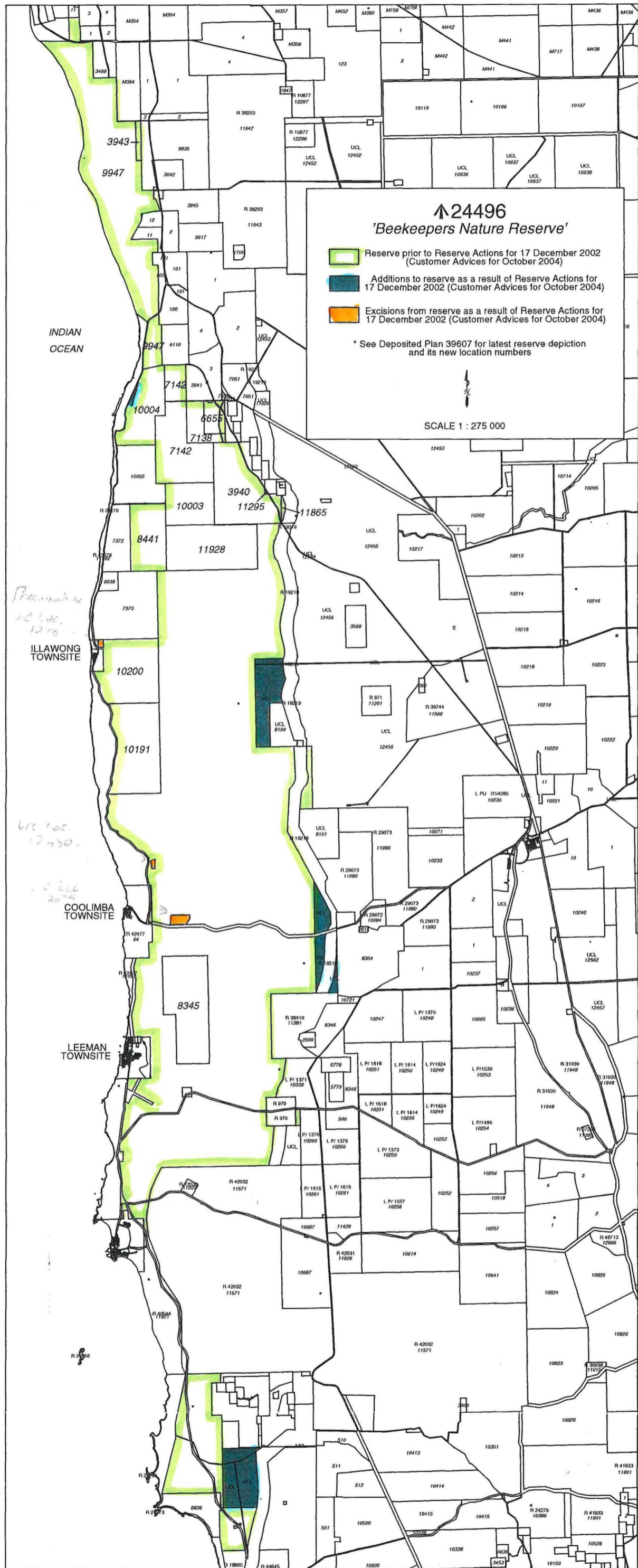

↑ 24496
'Beekeepers Nature Reserve'

- Reserve prior to Reserve Actions for 17 December 2002 (Customer Advices for October 2004)
- Additions to reserve as a result of Reserve Actions for 17 December 2002 (Customer Advices for October 2004)
- Excisions from reserve as a result of Reserve Actions for 17 December 2002 (Customer Advices for October 2004)

* See Deposited Plan 39607 for latest reserve depiction and its new location numbers

SCALE 1 : 275 000

*Proposed by
 20 Dec. 2004*

*UPL 100
 12-20-04*

*UPL 100
 20-04*

*Corresponding DLI plans are:
 Dongara (1839-2), Mt Lefroy
 (1939-3), Cliff (1838-1), Benah
 (1938-4), Beagle Islands (1836-
 Logue (1930-3), Greenhead (183
 + Lesueur (1937-4),
 Boulanger (1837-2) + Hill
 River (1937-3)*

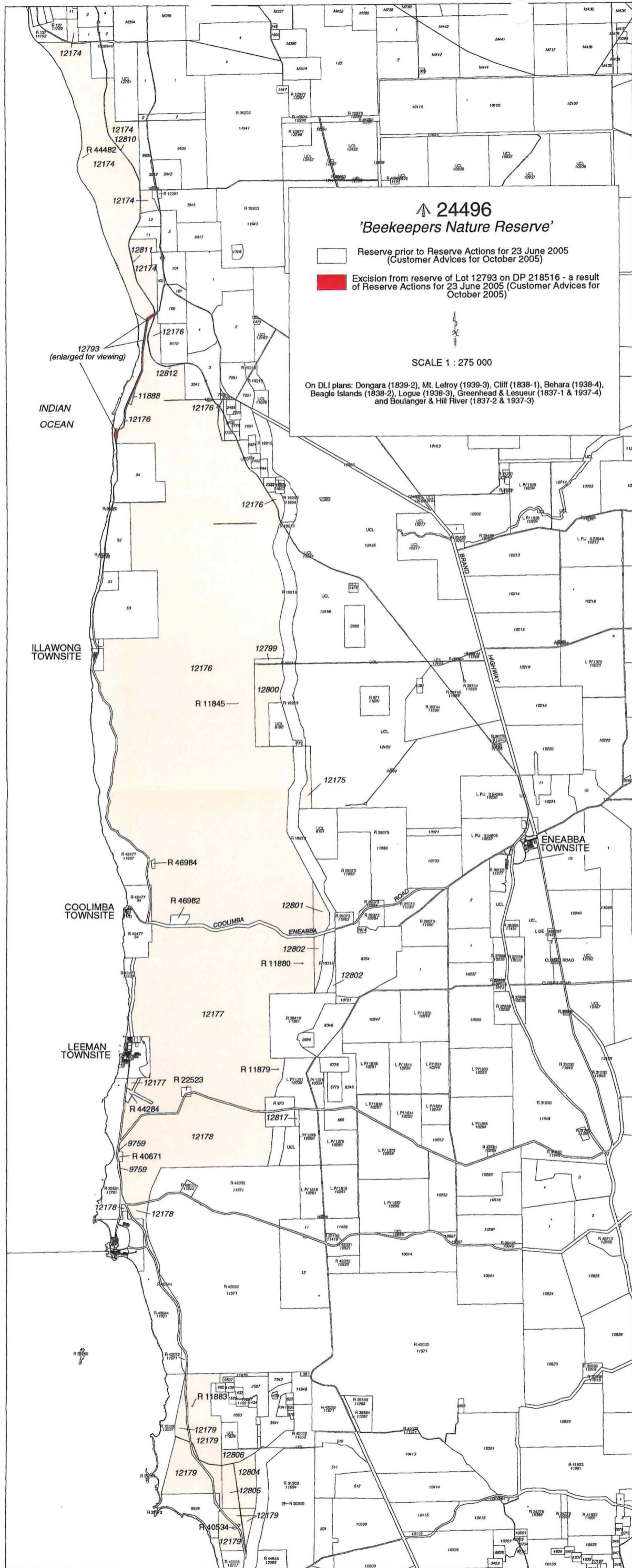

24496
'Beekeepers Nature Reserve'

- Reserve prior to Reserve Actions for 23 June 2005 (Customer Advices for October 2005)
- Excision from reserve of Lot 12793 on DP 218516 - a result of Reserve Actions for 23 June 2005 (Customer Advices for October 2005)

SCALE 1 : 275 000

On DLI plans: Dongara (1839-2), Mt. Lefroy (1939-3), Cliff (1838-1), Behara (1938-4), Beagle Islands (1838-2), Logue (1936-3), Greenhead & Lesueur (1837-1 & 1937-4) and Boulanger & Hill River (1837-2 & 1937-3)

12793
(enlarged for viewing)

INDIAN OCEAN

ILLAWONG TOWNSITE

COOLIMBA TOWNSITE

LEEMAN TOWNSITE

ENEABBA TOWNSITE

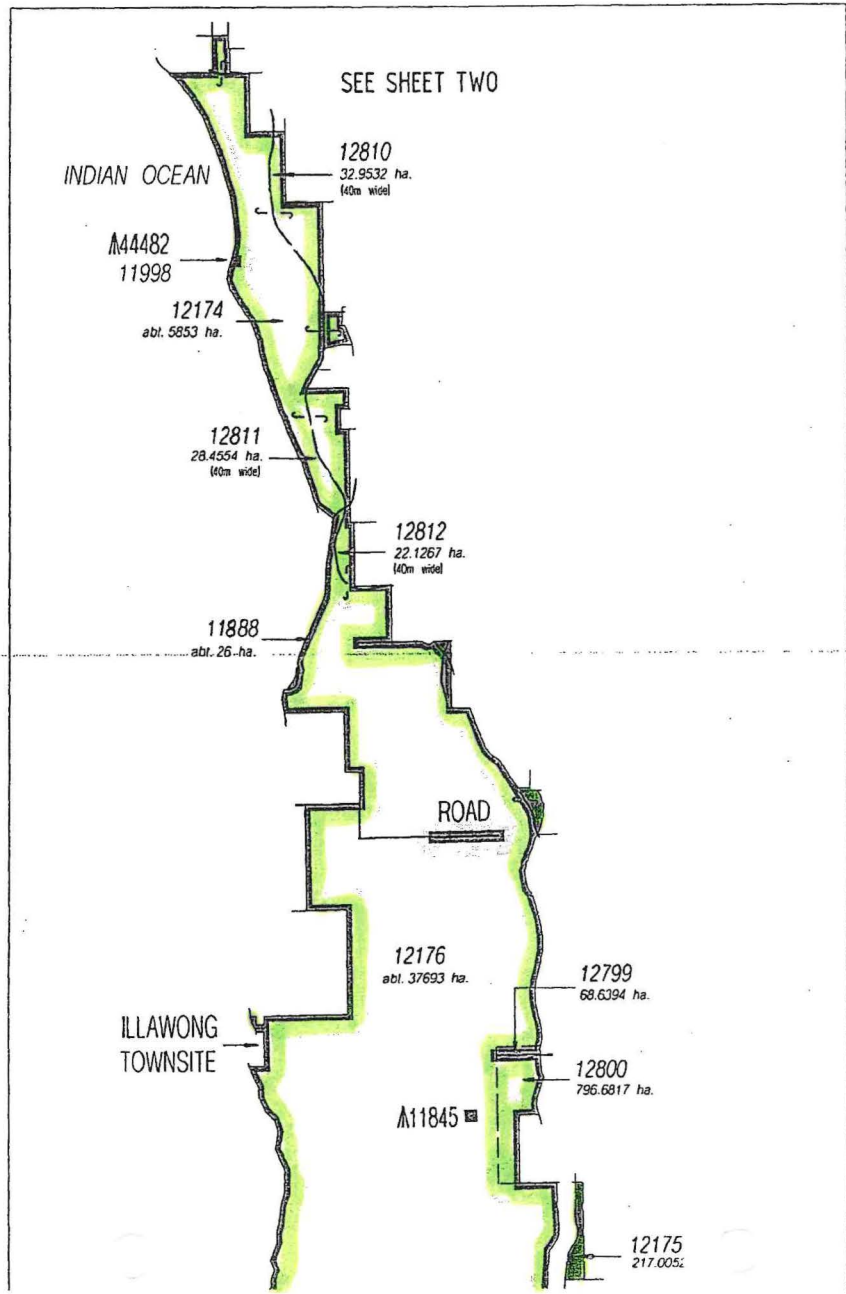

SEE SHEET TWO

INDIAN OCEAN

M44482
11998

12174
abt. 5853 ha.

12811
28.4554 ha.
(40m wide)

12812
22.1267 ha.
(40m wide)

11888
abt. 26 ha.

ROAD

12176
abt. 37693 ha.

12799
68.6394 ha.

12800
796.6817 ha.

M11845

12175
217.0052

ILLAWONG
TOWNSITE

<p>Department of Land Information Government of Western Australia</p>		<p>DEPOSITED PLAN</p> <h1>39607</h1>		<p>SHEET 1 OF 3 EDITION 1 VERSION 1</p>
<p>IN ORDER FOR DEALINGS</p> <p>SUBJECT TO <i>Redescription of A 244496</i></p>		<p>DATE <i>17.12.2002</i></p>		<p>APPROVED AUTHORISED LAND OFFICER</p>
<p>TYPE OF VALIDATION</p> <p>FULL ABUT</p> <p>LEGAL</p> <p>CERTIFIED CORRECT <i>14/11/03</i> <i>68/2002</i> Multiple Subdivisions</p>		<p>APPROVED AUTHORISED LAND OFFICER</p>		
<p>LOGGED</p> <p>DATE <i>12.11.03</i></p>	<p>FEE PAID</p> <p>ASSESS NO. <i>N/A</i></p>	<p>DATE <i>12.11.03</i></p> <p>ASSESS NO. <i>N/A</i></p>	<p>OSSES</p> <p>IB (AUG 03)</p> <p>JO NOT</p> <p>IAL BOUNDARY</p>	

FOR HEADING SEE SHE

INDIAN OCEAN

A4482
11998
D.P. 19290

12174
abt. 5853 ha

9835
D.P. 161699

12809
Dc. 53065

A36902
11429
Dc. 53065

12811
28,454 ha
(40m wide)

12
Plan 18579

11
Plan 18579

102
P. 2328B

A3078
11982
D.P. 243167

12176

JOINS (A) ABOVE RIGHT

OCEAN DR.

100
P. 2328B

INDIAN

ILLAWONG
TOWNSITE

D.P. 218262 Rd. No.

INDIAN OCEAN

12681
D.P. 31646

A42477
57
D.P. 240383

D.P. 218262

INDIAN OCEAN DRIVE

A11846
12122
D.P. 92424

D.P. 218262

Road No 11281

INDIAN OCEAN DR.

COOLIMBA
TOWNSITE

A42477
64
D.P. 240383

D.P. 218261

COOLIMBA - ENEABBA

12176
abt. 37683 ha.

A11845

12799
68,639 ha.

abt. 1985

abt. 1975

abt. 5645

abt. 963

abt. 6035

abt. 5645

abt. 5645

abt. 5645

abt. 5645

abt. 5645

abt. 5645

abt. 5645

abt. 5645

abt. 5645

abt. 5645

abt. 5645

abt. 5645

abt. 5645

abt. 5645

abt. 5645

abt. 5645

abt. 5645

abt. 5645

abt. 5645

abt. 5645

abt. 5645

abt. 5645

abt. 5645

abt. 5645

abt. 5645

abt. 5645

abt. 5645

abt. 5645

abt. 5645

abt. 5645

abt. 5645

abt. 5645

abt. 5645

A19219
Stock Route
Road No. 301

ROAD

abt. 1975

abt. 5645

abt. 963

abt. 6035

abt. 5645

abt. 5645

abt. 5645

abt. 5645

abt. 5645

abt. 5645

abt. 5645

abt. 5645

abt. 5645

abt. 5645

abt. 5645

abt. 5645

abt. 5645

abt. 5645

abt. 5645

abt. 5645

abt. 5645

abt. 5645

abt. 5645

abt. 5645

abt. 5645

abt. 5645

abt. 5645

abt. 5645

abt. 5645

abt. 5645

abt. 5645

abt. 5645

abt. 5645

abt. 5645

abt. 5645

abt. 5645

abt. 5645

8190
D.P. 149788

Stock Route

A19219

Road No. 301

UCL

12456

D.P. 221031

12175

217,0052 ha.

8191

D.P. 149788

JOINS SHEET 3

12801
abt. 267 ha.

D.P. 218411 Rd No 1505

ROAD

A19219

Road No. 301

1 203

1306.5886 ha

6125

1242.

6125

135

- Area subject to excision
- ↑ 24496 boundary

former VCL

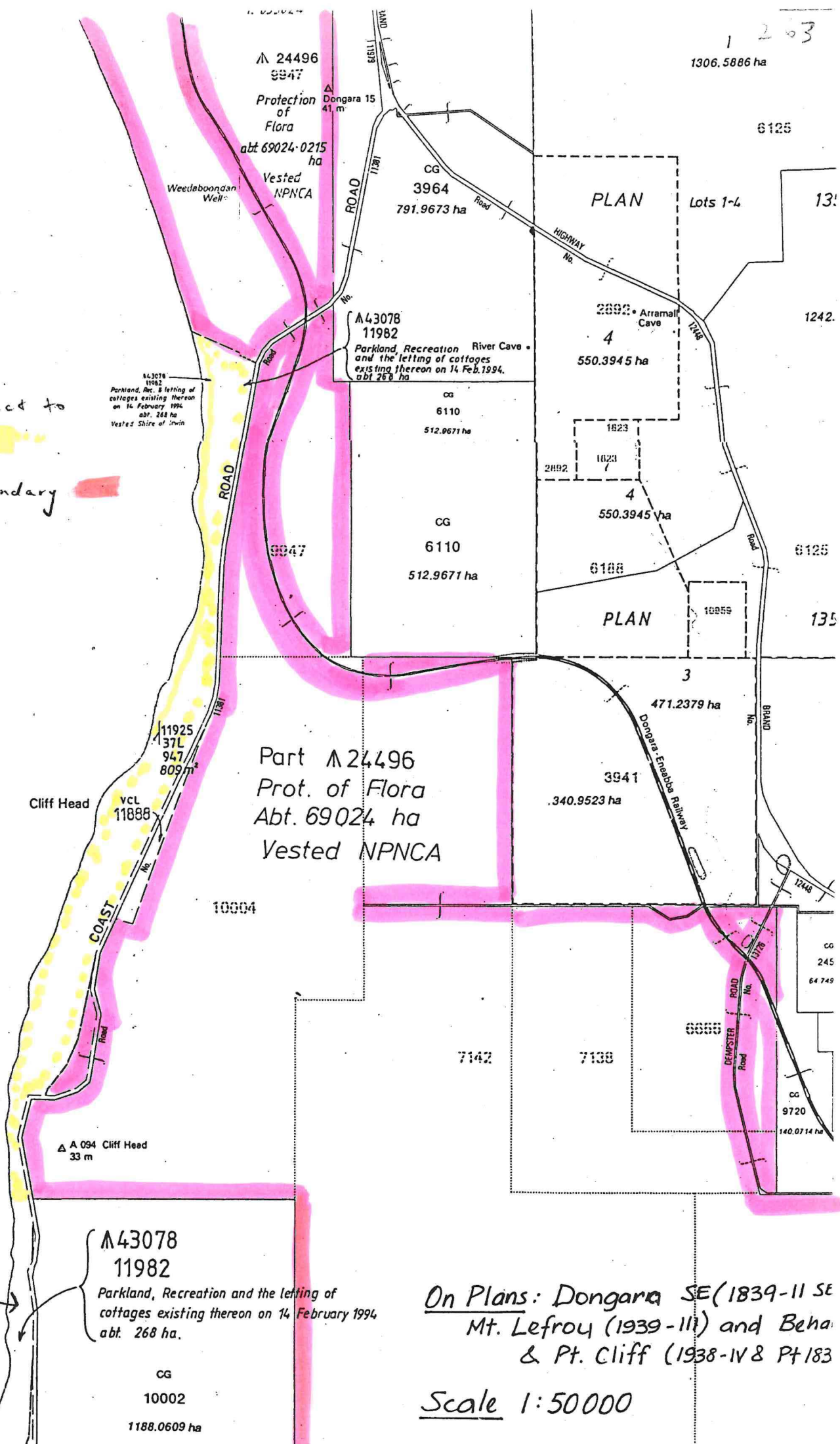

On Plans: Dongara SE(1839-II SE
Mt. Lefroy (1939-III) and Beha
& Pt. Cliff (1938-IV & Pt 183

Scale 1:50000

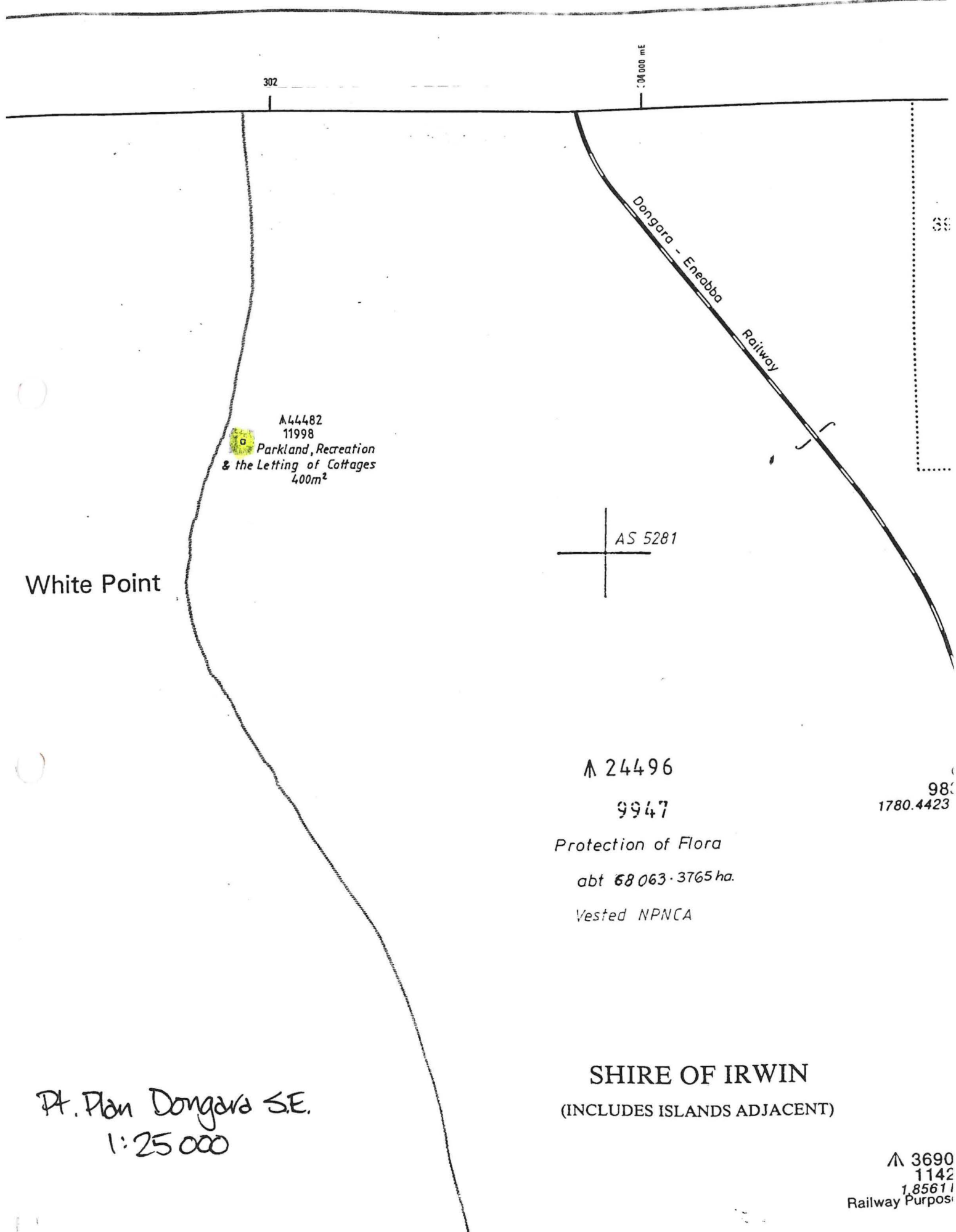

A44482
11998
Parkland, Recreation
& the Letting of Cottages
400m²

White Point

Dongara - Eneabba
Railway

AS 5281

24496

9947

Protection of Flora
abt 68 063.3765 ha.
Vested NPNCA

980
1780.4423

Pt. Plan Dongara S.E.
1:25 000

SHIRE OF IRWIN
(INCLUDES ISLANDS ADJACENT)

3690
1142
1,85611
Railway Purpos

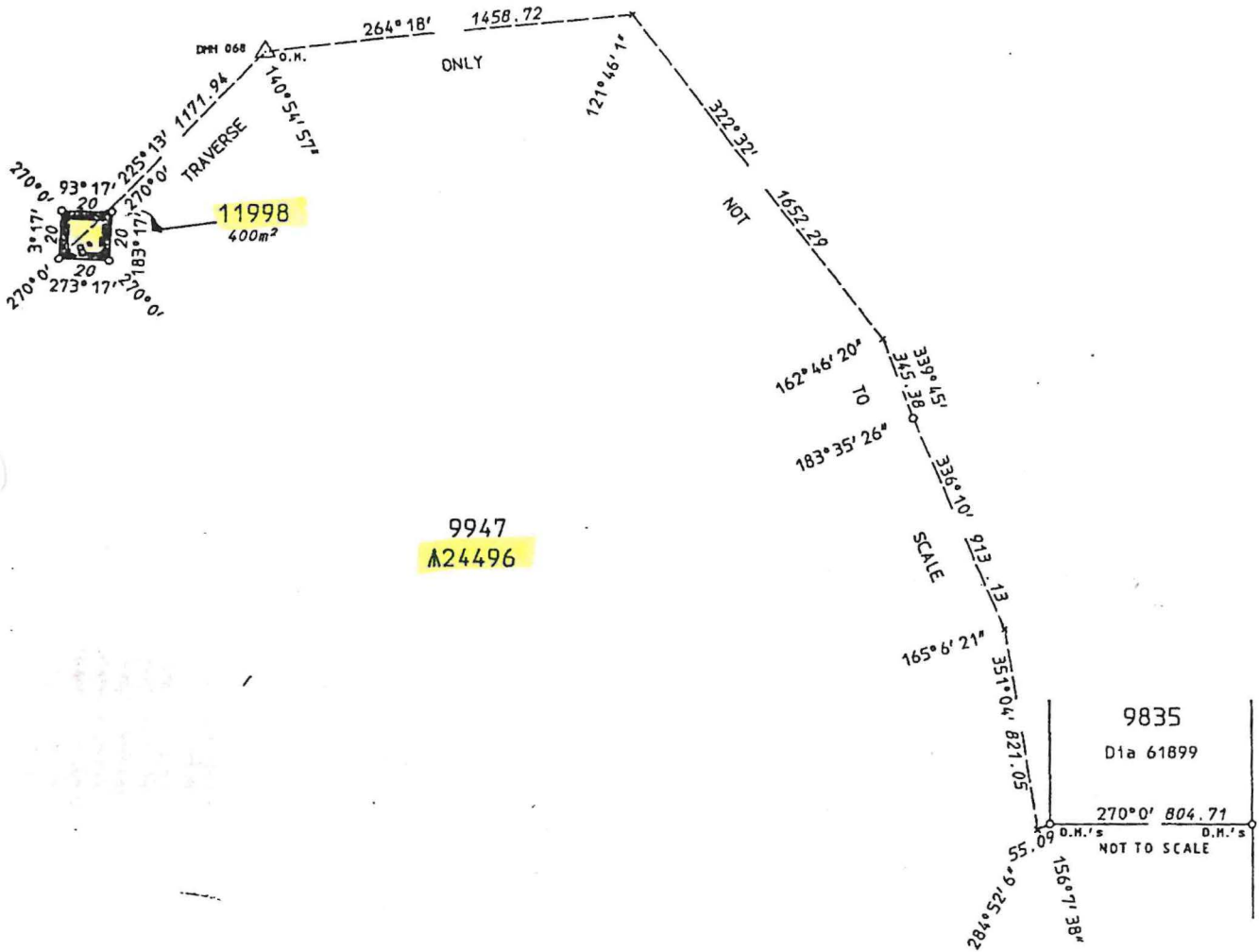

9947
A24496

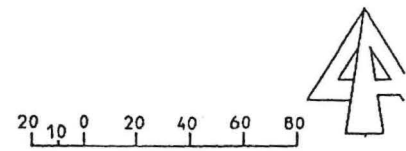

LAND DISTRICT VICTORIA		LOCATION 11998			
SURVEYOR'S CERTIFICATE				SCALE <i>Reduced</i> 1:2000 measurements in metres	FILE 1115/969
I hereby certify that:- (a) this plan of survey is a correct and accurate representation of the survey carried out by me personally / under my own personal supervision, inspection and field check and recorded in Fieldbooks lodged for the purpose of this plan of survey; (b) the measurements are in strict accordance with the Licensed Surveyors (Guidance of Surveyors) Regulations 1961 and in particular regulations 23 and 34 of those regulations; and (c) this survey and this plan of survey are in strict accordance with the requirements of the Licensed Surveyors (Guidance of Surveyors) Regulations 1961 and the relevant law in relation to which it is lodged. Licensed Surveyor <i>A.G. Thompson</i> Date <i>22nd Dec 1994</i> 22/94 is struck out which was: Date this copy:				SURVEYOR A.G. THOMPSON.	PUBLIC PLANS DONGARA S.E. (25)
				FIELD BOOK 67994 Page 1-3 & B	SURVEY INDEX PLANS DONGARA S.E. (25)
Prepared by: B.O. DWYER.		In order for certification		DATE OF MARKING 9.12.94	RECORDED ON SURVEY INDEX PLAN D.S. 19-1 95
Examined <i>[Signature]</i> Date <i>12.1.95</i>		DIAGRAM CERTIFIED CORRECT		RECORDED ON PUBLIC PLAN	DEPARTMENT OF LAND ADMINISTRATION
In order for further action		Authorized Land Officer		LODGED W.S.S. 13.1.95	DIAGRAM 92090

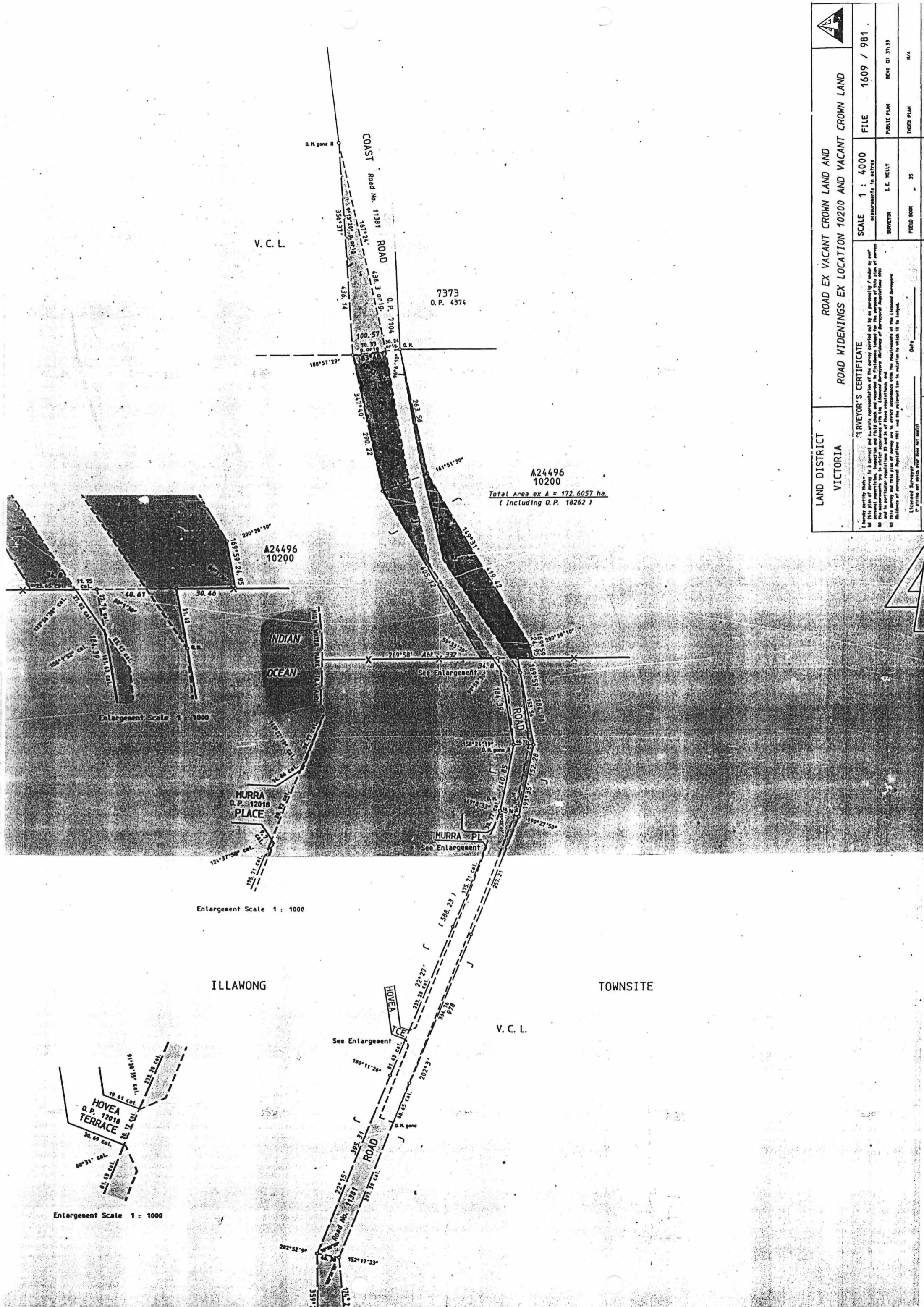

	ROAD EX VACANT CROWN LAND AND	SCALE 1 : 4000 <small>measurements in metres</small>	FILE 1609 / 981
	ROAD WIDENINGS EX LOCATION 10200 AND VACANT CROWN LAND		
LAND DISTRICT	VICTORIA	SURVEYOR	T. E. KELLY
		PUBLIC PLAN	BE40 CI 371.33
		INDEX PLAN	N/A
		FIELD BOOK	95
SURVEYOR'S CERTIFICATE <small>I hereby certify that the survey and the representation of the same described by the plan of this plan of survey are in accordance with the provisions of the Survey Act 1958 and the regulations made thereunder and that the measurements are in accordance with the provisions of the Survey Act 1958 and the regulations made thereunder and that the plan of this plan of survey is in accordance with the provisions of the Survey Act 1958 and the regulations made thereunder and that the plan of this plan of survey is in accordance with the provisions of the Survey Act 1958 and the regulations made thereunder.</small>			
		DATE	
		IN WITNESS WHEREOF	BE40 CI 371.33

V. C. L.

7373
O.P. 4374

A24496
10200
Total Area ex A = 172.6057 ha.
(Including O.P. 18262)

A24496
10200

Enlargement Scale 1 : 1000

Enlargement Scale 1 : 1000

ILLAWONG

TOWNSITE

V. C. L.

Enlargement Scale 1 : 1000

VG

TOWNSITE



A24496
 Total Area ex'd = 172.6057 ha
 (Including O.P. 18261)

	ROAD EX A24496 (INCLUDING LOCATIONS 10191 & 10200)		FILE	1609 / 981
	SCALE	1 : 12500	FILE	1609 / 981
SURVEYOR'S CERTIFICATE		I hereby certify that the survey is correct and accurate representation of the survey carried out by me personally or under my supervision and that the bearings and distances are correct and true for the purposes of this plan of survey. I am a duly qualified and registered Surveyor in accordance with the (Licensed Surveyors Act) (Victoria) Regulations 1961. I am a duly qualified and registered Surveyor in accordance with the (Licensed Surveyors Act) (Victoria) Regulations 1961. I am a duly qualified and registered Surveyor in accordance with the (Licensed Surveyors Act) (Victoria) Regulations 1961.		
LAND DISTRICT	VICTORIA	SURVEYOR	I. C. KELLY	INDEX PLAN
Prepared by: I. C. KELLY Date: _____ In order for certification: _____		FIELD BOOK	33	RECORDED ON MAPS
		RECORDED ON MAPS	RECORDED ON MAPS	RECORDED ON MAPS



is A 29759
549/65
Drummond Rock
WAWA

LEEMAN
LEEMAN
See Enlarged Plan

REGIONAL
1:10,000

549/68
WAWA
WEBB ISLAND

IB Δ 11881
18m

11209

LEEMAN ROAD

