

NATURE RESERVE

RESERVE NO: 24912

GOVERNMENT GAZETTE  
Date Page No.

FILE NUMBER: 118/58

PURPOSE: Conservation of Flora  
and Fauna 21.2.58 341

NAME: Little Murapin Lake

CLASS (Land Act):

AREA: 28.3280 ha

VESTING: W.A.W.A. 17.4.70 1077

LOCATION NO(S): Kojonup 9092

CLASSIFICATION:  
(Wildlife Act  
Section 12A)

LITHO: 409/80 C4, 416/80 C1

LOCAL AUTHORITY: WOODANILLING SHIRE

Notes:

DEPARTMENT OF CONSERVATION AND LAND MANAGEMENT

HEAD OFFICE  
HACKETT DRIVE CRAWLEY  
WESTERN AUSTRALIA  
Phone (09) 386 8811  
Telex AA 94585  
Facsimile (09) 3861578

STATE OPERATIONS HEADQUARTERS  
50 HAYMAN ROAD COMO  
WESTERN AUSTRALIA  
Phone (09) 367 0333  
Telex AA 94616  
Facsimile (09) 367 0466

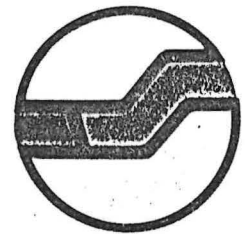

71  
B.L

Please address all correspondence to Executive Director, P.O. Box 104, COMO W.A. 6152

Your Ref: 1900/984  
Our Ref: 027466F3103 TR:RC  
Enquiries: Ms T Rankin  
Phone: 367 0426

EXECUTIVE DIRECTOR  
DEPT OF LAND ADMINISTRATION

Attention: C Carroll

Dear Sir

In response to your memo of 29 May 1989, please find enclosed the following Superseded Vesting Orders for cancellation:-

- 17946, 18340, 18342, 18381, 18950, 19036, 19093,
- 19116, 19118, 19650, 20262, 20479, 20482, 20834,
- 21056, 21153, 21230, 21830, 21981, 22792, 23008,
- 23141, 23156, 23171, 23316, 23325, 23566, 23665,
- 23934, 24532, 24534, 24677, 24835, 24891, 24912,
- 24944, 24979, 25546, 26196, 26266, 26403, 26508,
- 26564, 26569, 26661, 26687, 26792, 26809, 26819,
- 27108, 27146, 27283 and 27354.

S.S.  
Syd Shea  
EXECUTIVE DIRECTOR  
per *[Signature]*.....

7 June 1989

enc

69  
B.L.

1148/980—16235; Jilbadji Locations 983 and 984; 760.2455; Westonia 1:50 000.  
 4361/15—16293; Avon Location 18017; 21.5304; Nangeenan 1:50 000.  
 371/16—16346; Avon Locations 18023 and 28634 and the land coloured blue on Original Plan 11755; 44.3636; Pickering 1:50 000.  
 4225/15—16412; Avon Location 21547; about 60.7028; Quajabin 1:50 000.  
 7455/19—16493; Avon Location 21202; 54.4302; Babakin S.W. 1:25 000.  
 3494/16—16683; Ninghan Location 1123; 82.8948; Lake Wallambin N.E. 1:25 000.  
 2780/18—17055; Kojonup Location 4748; 90.8407; Boscabel N.E. 1:25 000.  
 4827/19—17257; Kojonup Location 4749; about 54.2279; Boscabel N.E. 1:25 000.  
 6820/20—17771; Ninghan Locations 377 and 4191; 104.5455; Lake Wallambin N.E. 1:25 000.  
 1517/21—17778; Ninghan Locations 439, 1088 and 3978; 27.2430; Ballidu S.E. 1:25 000.

Given under my hand and the Public Seal of Western Australia, at Perth, on 18 April 1989.

By His Excellency's Command,

E. K. HALLAHAN,  
Minister for Lands.

GOD SAVE THE QUEEN !

X

#### Land Act 1933

#### PROCLAMATION

WESTERN AUSTRALIA } By His Excellency Professor Gordon Reid, Com-  
 GORDON REID, } panion of the Order of Australia, Governor of the  
 Governor. } State of Western Australia.  
 [L.S.]

File No. 1900/984.

WHEREAS by section 31 (1) (a) of the Land Act 1933, the Governor may by Proclamation and subject to such conditions as may be expressed therein classify as of Class "A" any such lands of the Crown reserved to Her Majesty for any purpose; and whereas it is deemed expedient that the Reserves listed in the attached schedule for the purpose of "Conservation of Flora and Fauna" as described, should be classified as of Class "A": now, therefore I, the Governor, with the advice and consent of Executive Council do by this my Proclamation classify as of Class "A" the reserve described in the attached schedule.

#### Schedule

File No.; Reserve No.; Land Description; Area (hectares);  
Plan.

545/22—17946; Victoria Location 11535; 259.0619; 190/80.  
 3676/23—18340; Denmark Estate Lots 409 and 441; 83.6687; Denmark S.W. 1:25 000.  
 866/20—18342; Avon Location 23254; 0.4629; Pantapin 1:50 000.  
 4646/23—18381; Ninghan Location 2129; 16.1975; Kalannie 1:50 000.  
 2786/25—18950; Ninghan Location 969; 4.0469; Lake Wallambin N.E. 1:25 000.  
 1466/25—19036; Ninghan Location 2291; 9.0295; Lake Wallambin N.E. 1:25 000.  
 179/63—19093; Williams Location 14715; about 84.9840; Mugerugging N.W. 1:25 000.  
 2455/54—19116; Williams Locations 8256 and 9355; 129.4994; Mugerugging N.W. 1:25 000.  
 3316/57—19118; Williams Location 14194; 207.7428; Yilliminning 1:50 000.  
 3457/26—19650; Ninghan Locations 1138, 1139 and 2771; 62.3191; Kalannie 1:50 000.  
 3627/29—20262; Jilbadji Locations 478 and 745; 1018.7072; Moorine Rock 1:50 000.  
 6581/13—20479; Williams Location 6277; 64.7497; Piesseville S.W. 1:25 000.  
 629/30—20482; Ninghan Location 4239; 188.5640; Kalannie 1:50 000.  
 2794/62—20834; Williams Location 9988; 63.3333; Piesseville N.E. and S.E. 1:25 000.

2773/30—21056; Williams Location 11351; 144.5562; Yilliminning N.W. 1:25 000.  
 621/988—21153; Avon Location 17066; 40.4686; Doodlakine 1:50 000.  
 2580/29—21230; Williams Locations 9325 and 15387; 68.7966; Pingelly S.E. 1:25 000.  
 6835/21—21830; Williams Location 3941; 44.7658; Narrogin N.W. 1:25 000.  
 2236/20—21981; Avon Location 21687; 215.1714; Mt Observation S.E. 1:25 000.  
 671/29—22792; Avon Locations 23870, 28456 and 28701; 668.8153; Wogerlin 1:50 000.  
 5647/48—23008; Avon Location 14881; 64.7978; Koorda S.W. 1:25 000.  
 2517/25—23141; Avon Location 14754; about 60.7028; Pikaring N.E. 1:25 000.  
 1816/982—23156; Avon Location 20153; 343.1734; Cadoux S.W. 1:25 000.  
 4537/48—23171; Hay Locations 2023 and 2024; about 607.0285; Kwoornicup S.E. 1:25 000.  
 4643/51—23316; Melbourne Location 3660; 292.0692; Tanche 1:50 000.  
 6041/51—23325; Denmark Estate Lot 378; about 23.4718; Denmark S.W. 1:25 000.  
 3315/52—23566; Avon Location 27288; 255.8726; Kellerberrin S.W. 1:25 000.  
 4440/52—23665; Ninghan Location 1694; about 105.2183; Cadoux N.W. 1:25 000.  
 854/54—23934; Melbourne Location 3726; 212.8369; Capitela S.W. 1:25 000.  
 4106/29—24532; Nangeenan Lots 69, 116, 144 to 149 incl. and 152; 60.7682; Nangeenan Townsite.  
 2628/56—24534; Ninghan Location 3153; 307.3009; Beacon 1:50 000.  
 5915/19—24677; Kojonup Location 7078; 74.6190; Uannap S.W. 1:25 000.  
 7945/08—24835; Avon Location 27920; 59.1282; Nangeenan 1:50 000.  
 4051/56—24891; Plantagenet Location 7475; 103.6680; Redmond S.E. 1:25 000.  
 4830/19—24912; Kojonup Location 9092; about 28.3280; Boscabel N.E. 1:25 000.  
 2526/57—24944; Jilbadji Location 752; 416.8869; Moorine Rock 1:50 000.  
 4505/57—24979; Lancelin and Edwards Islands; about 8.6189; Lancelin 1:2000 21.06.  
 4250/57—25112; Kwoylin Agricultural Area Lot 319; 95.9940; Pantapin N.E. 1:25 000.  
 2156/59—25546; Avon Location 28005; 16.1874; Lomo N.W. and S.W. 1:25 000.  
 943/60—25809; Plantagenet Location 6803 and Elleker Lots 74, 75, 76, 91 and 92; 192.0107; Torbay N.E. and S.E. 1:25 000 and Elleker Townsite.  
 807/13—26196; Wilroy Lot 3; 331.0607; 156/80.  
 912/61—26266; Kwoylin Agricultural Area Lots 362 and 391; 148.4741; Pantapin N.E. 1:25 000.  
 3351/60—26403; Yilgarn Location 356; 113.3651; Coorancooping 1:50 000.  
 2858/20—26508; Nelson Location 12602; 16.1385; Boyup Brook N.E. 1:25 000.  
 834/62—26564; Plantagenet Location 5814; 9.7909; Porongurup S.E. and Noorubup S.W. 1:25 000.  
 2059/62—26569; Kent Location 1371; 128.4573; Ongerup 1:50 000.  
 916/61—26661; Roe Location 2437; about 347.2203; Lake O'Connor 1:50 000.  
 626/62—26687; Avon Location 25285; 303.2893; Lake Wallambin S.W. and S.E. 1:25 000.  
 986/63—26792; Kent Location 1819; 1038.8609; Woodingellup 1:50 000.  
 3411/57—26809; Avon Location 27991; about 107.8487; Kellerberrin N.E. 1:25 000.  
 10365/09—26819; Victoria Locations 10634 and 10635; 347.4505; 122/80.  
 2933/29—27108; Avon Location 20210; 231.7382; Kwoylin 1:50 000.  
 2826/62—27146; Yilgarn Location 1371; 115.9956; Warralakin 1:50 000.  
 1584/64—27219; Melbourne Location 3908; 199.7629; Dandaragan 1:50 000.

23-5-89  
i. hands

1979 at pages 3079-3080 and varied from time to time thereafter by inserting in the Schedule, after Part 15, the following Part—

Part 16

All that portion of land bounded by lines starting from the southernmost southwestern corner of Paraburdoo Lot 6, as surveyed and shown on Department of Land Administration Original Plan 16987, and extending generally northeasterly and generally easterly along southeastern and southern boundaries of that lot to the prolongation northerly of the eastern side of Robe Avenue; thence southerly to and along that side and onwards to a northwestern boundary of the southeastern severance of Windell Location 30; thence generally southwesterly, generally westerly, northwesterly and northeasterly along boundaries of that severance to a south-western side of Camp Road; thence generally northwesterly and generally southwesterly along sides of that road to an eastern side of Beasley Road and thence northerly and generally northwesterly along sides of that road to the starting point.

(Department of Land Administration Public Plans Paraburdoo Regional and Paraburdoo 2000 02.34, 03.34, 03.35, 04.34 and 04.35. )

Given under my hand and the Seal of the State on 2 May 1989.

By His Excellency's Command,

KAY HALLAHAN,  
Minister for Local Government.

GOD SAVE THE QUEEN !

At a Meeting of the Executive Council held in the Executive Council Chamber, at Perth, this 18th day of April 1989, the following Orders in Council were authorised to be issued.

Child Welfare Act 1947  
ORDER IN COUNCIL

WHEREAS by section 19 (2) (a) of the Child Welfare Act 1947 it is provided that the Governor may appoint such persons, male or female, as he may think fit, to be members of any particular Children's Court and may determine the respective seniorities of such members and whereas by section 19 (1) (b) (ii) of the said Act the Governor may amend, vary or revoke any such appointment: Now therefore His Excellency the Governor by and with the advice and consent of the Executive Council hereby appoints the person named in the First Schedule hereto to be a member of the Children's Court at the place mentioned and hereby revokes the appointment of the persons named in the Second Schedule hereto to be members of the Children's Court at the place mentioned.

First Schedule

Newman—Rhonda Diane Chapman.

Second Schedule

Newman—

Peter John Alfred Collins.  
Elizabeth Margaret Jayes.

G. PEARCE,  
Clerk of the Council.

Child Welfare Act 1947  
ORDER IN COUNCIL

WHEREAS by section 19 (2) (a) of the Child Welfare Act 1947 it is provided that the Governor may appoint such persons, male or female, as he may think fit, to be members of any particular Children's Court and may determine the respective seniorities of such members, and whereas by section 19 (1) (b) (ii) of the said Act the Governor may amend, vary or revoke any such appointment: Now therefore His Excellency the Governor by and with the advice and consent of the Executive Council hereby revokes the appointment of the person named in the Schedule hereto as a member of the Children's Court at the place mentioned.

Schedule

Norseman—Betty Logan.

G. PEARCE,  
Clerk of the Council.

Child Welfare Act 1947

ORDER IN COUNCIL

WHEREAS by section 19 (2) (a) of the Child Welfare Act 1947 it is provided that the Governor may appoint such persons, male or female, as he may think fit, to be members of any particular Children's Court and may determine the respective seniorities of such members and whereas by section 19 (1) (b) (ii) of the said Act the Governor may amend, vary or revoke any such appointment: Now therefore His Excellency the Governor by and with the advice and consent of the Executive Council hereby appoints the persons named in the First Schedule hereto to be members of the Children's Court at the place mentioned and hereby revokes the appointment of the persons named in the Second Schedule hereto to be members of the Children's Court at the place mentioned.

First Schedule

Onslow—

Maisie Hyland.  
John Hayes.  
Elsie Lavinia Munro.

Second Schedule

Onslow—

Alec Francis Tucker.  
Kevin Zanetti.

G. PEARCE,  
Clerk of the Council.

Land Act 1933

ORDERS IN COUNCIL

WHEREAS by section 33 of the Land Act 1933, it is made lawful for the Governor to direct that any Reserve shall vest in and be held by any person or persons to be named in the order in trust for the like or other public purposes to be specified in such order: And whereas it is deemed expedient as follows—

File No. 1900/984.—That Class "A" Reserves 17946, 18340, 18342, 18381, 18950, 19036, 19093, 19916, 19118, 19650, 20262, 20479, 20482, 20834, 21056, 21153, 21230, 21830, 21981, 22792, 23008, 23141, 23156, 23171, 23316, 23325, 23566, 23665, 23934, 24532, 24534, 24677, 24835, 24891, 24912, 24944, 24979, 25112, 25546, 25809, 26196, 26266, 26403, 26508, 26564, 26569, 26661, 26687, 26792, 26809, 26819, 27108, 27146, 27219, 27283 and 27354, should vest in and be held by the National Parks and Nature Conservation Authority in trust for the purpose of "Conservation of Flora and Fauna".

File No. 1900/984.—That Class "A" Reserves 27384, 27387, 27452, 27837, 28047, 28313, 28317, 28318, 28319, 28471, 28940, 29012, 29018, 29019, 29020, 29021, 29022, 29023, 29025, 29026, 29027, 29253, 29256, 29257, 29258, 29259, 29260, 29303, 29322, 29326, 29576, 29589, 29680, 29810, 30430, 30469, 30516, 30903, 30969, 31561, 31742, 31743, 31744, 31799, 31908, 31909, 31913, 32129, 32130, 32131, 32549, 32776, 32783, 32864, 32865, 32993 and 32995, should vest in and be held by the National Parks and Nature Conservation Authority in trust for the purpose of "Conservation of Flora and Fauna".

File No. 1900/984.—That Class "A" Reserves 33113, 33828, 33842, 33854, 34197, 34257, 34295, 35217, 35413, 35428, 35621, 36056, 36183, 36334, 36550, 36608, 36967, 37054, 37316, 38296, 38334, 38415, 38522, 38544, 38545, 38574, 38578, 38703, 38800 and 39038, should vest in and be held by the National Parks and Nature Conservation Authority in trust for the purpose of "Conservation of Flora and Fauna".

File No. 2745/21.—That Class "A" Reserve No. 17826 (Perth Lots S35, 66, 461, 732 and portion of Lot 567) should vest in and be held by the City of Perth in trust for the purpose of "Park Gardens and Parking".

File No. 169/64.—That Class "A" Reserve No. 27139 (Plantagenet Location 5961) should vest in and be held by the National Parks and Nature Conservation Authority in trust for the purpose of "Conservation of Flora and Fauna".

File No. 296/61.—That Class "A" Reserve No. 28167 (Peel Estate Lots 26 and 442) should vest in and be held by the National Parks and Nature Conservation Authority in trust for the purpose of "Conservation of Flora and Fauna".

38296 May 16, 1983.  
 38334 May 31, 1983.  
 38415 August 2, 1983.  
 38522 October 25, 1983.  
 38544 November 22, 1983.  
 38545 November 8, 1983.  
 38574 January 24, 1984.  
 38578 December 20, 1983.  
 38703 March 20, 1984.  
 38800 June 26, 1984.  
 39038 March 12, 1985.

27146 May 3, 1983.  
 27219 January 10, 1979.  
 27283 October 1, 1980.  
 27354 January 14, 1976.

Now, therefore, His Excellency the Governor, by and with the advice and consent of the Executive Council, hereby directs that the beforementioned Orders in Council be revoked and the Vesting Orders cancelled accordingly.

G. PEARCE,  
 Clerk of the Council.

File No. 1900/984.—And whereas by Order in Council issued on dates specified in the attached Schedule the respective Reserves were vested in the Western Australian Wildlife Authority in trust for the purpose of "Conservation of Flora and Fauna".

Schedule  
 Reserve Nos; Order in Council Date.

17946 January 10, 1984.  
 18340 March 5, 1980.  
 18342 September 22, 1976.  
 18381 October 1, 1980.  
 18950 May 31, 1983.  
 19036 May 31, 1983.  
 19093 June 9, 1972.  
 19116 June 7, 1978.  
 19118 January 11, 1978.  
 19650 February 8, 1979.  
 20262 September 9, 1970.  
 20479 March 21, 1979.  
 20482 August 21, 1984.  
 20834 May 24, 1978.  
 21056 January 10, 1973.  
 21153 August 3, 1981.  
 21230 March 17, 1971.  
 21830 July 21, 1977.  
 21981 September 9, 1970.  
 22792 October 4, 1979.  
 23008 February 19, 1985.  
 23141 November 16, 1977.  
 23156 May 31, 1983.  
 23171 June 22, 1977.  
 23316 May 16, 1983.  
 23325 August 3, 1981.  
 23566 November 9, 1978.  
 23665 October 4, 1979.  
 23934 August 16, 1978.  
 24532 July 19, 1983.  
 24534 May 31, 1983.  
 24677 July 19, 1978.  
 24835 July 24, 1984.  
 24891 January 10, 1979.  
 24912 April 8, 1970.  
 24944 August 2, 1983.  
 24979 October 30, 1976.  
 25112 August 8, 1979.  
 25546 September 17, 1980.  
 25809 February 23, 1977.  
 26196 September 18, 1979.  
 26266 August 3, 1981.  
 26403 May 3, 1983.  
 26508 September 17, 1980.  
 26564 February 7, 1984.  
 26569 July 1, 1970.  
 26661 August 2, 1983.  
 26687 March 18, 1981.  
 26792 May 24, 1978.  
 26809 September 13, 1978.  
 26819 December 13, 1978.  
 27108 October 17, 1979.

Land Act 1933

ORDERS IN COUNCIL

WHEREAS by section 33 of the Land Act 1933, it is made lawful for the Governor to direct that any Reserve shall vest in and be held by any person or persons to be named in the order in trust for the like or other public purposes to be specified in such order: And whereas it is deemed expedient as follows—

File No. 1391/67—That Class "A" Reserve No. 29255 (Sandland Island) should vest in and be held by the National Parks and Nature Conservation Authority in trust for the purpose of "Conservation of Flora and Fauna".

File No. 1390/67—That Class "A" Reserve No. 29254 (Wedge Island) should vest in and be held by the National Parks and Nature Conservation Authority in trust for the purpose of "Conservation of Flora and Fauna".

File No. 1388/67—That Class "A" Reserve No. 29252 (Green Islets Group—North, South and Buller Islands and Whittell Islets) should vest in and be held by the National Parks and Nature Conservation Authority in trust for the purpose of "Conservation of Flora and Fauna".

Now, therefore, His Excellency the Governor, by and with the advice and consent of the Executive Council, does hereby direct that the beforementioned Reserves shall vest in and be held by the aforementioned bodies in trust for the purposes aforesaid, subject nevertheless to the powers reserved to him by section 37 of the said Act.

G. PEARCE,  
 Clerk of the Council.

Land Act 1933

ORDER IN COUNCIL

File No. 1900/984.

WHEREAS by section 34B(1) of the Land Act 1933, it is made lawful for the Governor to revoke an Order in Council issued pursuant to section 33 of that Act. And whereas by Order in Council dated 9 November, 1978 Class "B" Reserve No's 29252, 29254 and 29255 were vested in the Western Australian Wildlife Authority in trust for the purpose of "Conservation of Flora and Fauna".

Now, therefore, His Excellency the Governor, by and with the advice and consent of the Executive Council, hereby directs that the beforementioned Order in Council be revoked and the Vesting Order cancelled accordingly.

G. PEARCE,  
 Clerk of the Council.

AT a meeting of the Executive Council held in the Executive Council Chambers, at Perth, on 2 May 1989 the following Orders in Council were authorised to be issued.

Land Act 1933

ORDERS IN COUNCIL

WHEREAS by section 33 of the Land Act 1933, it is made lawful for the Governor to direct that any Reserve shall vest in and be held by any person or persons to be named in order in trust for the like or other public purposes to be specified in such order: And whereas it is deemed expedient as follows—

File No. 1136/72—Reserve No. 29876 (Canning Locations 2236 and 2619) should vest in and be held by the Water Authority of Western Australia in trust for the purpose of "Drainage".

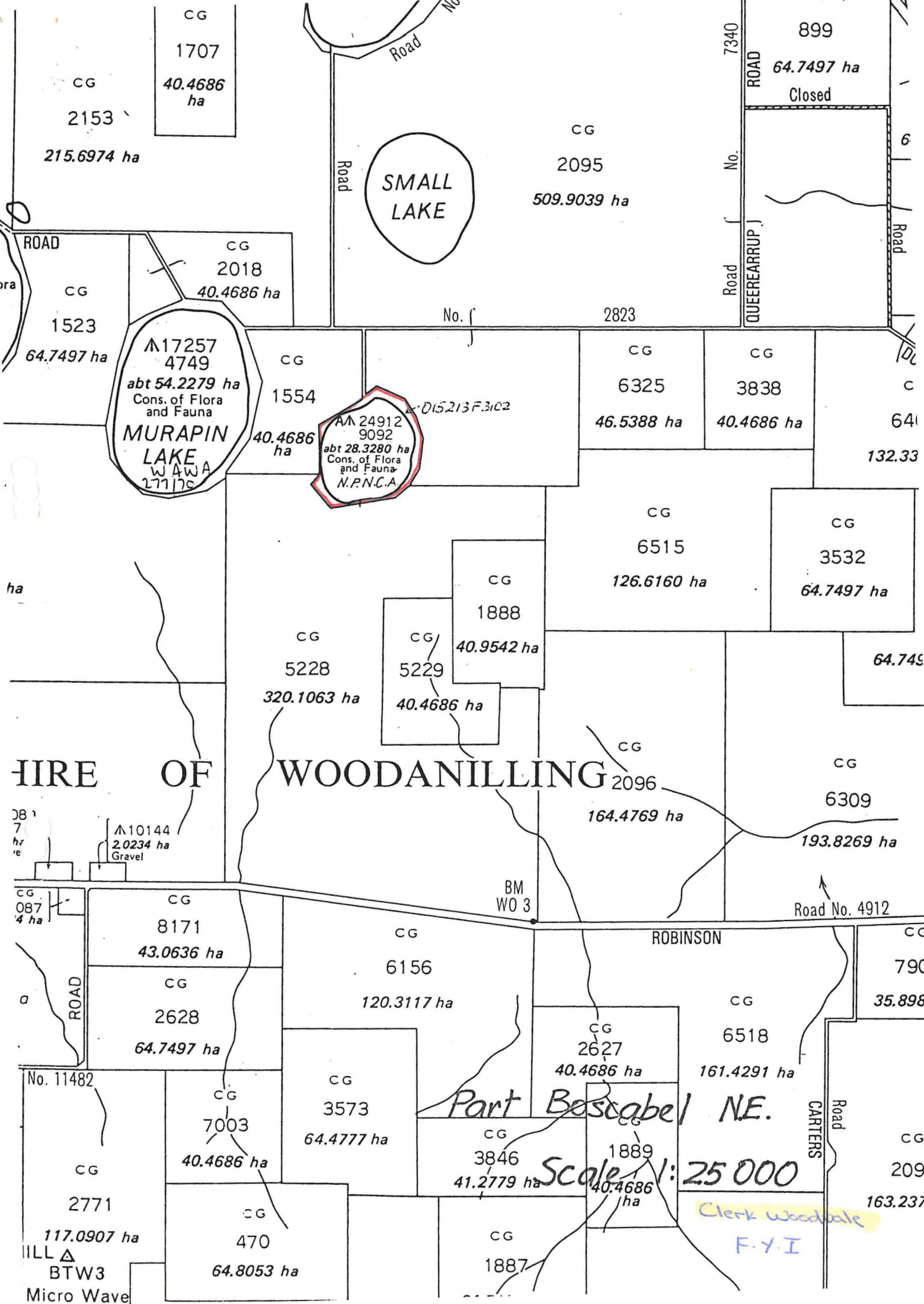

CG  
1707  
40.4686 ha

CG  
2153  
215.6974 ha

Road No. 7340  
CG  
2095  
509.9039 ha  
SMALL LAKE

CG  
899  
64.7497 ha  
Closed  
Road No. 6  
Road

ROAD  
CG  
1523  
64.7497 ha  
CG  
2018  
40.4686 ha

M 17257  
4749  
abt 54.2279 ha  
Cons. of Flora and Fauna  
MURAPIN LAKE  
WAWA  
277176

CG  
1554  
40.4686 ha

M 24912  
9092  
abt 28.3280 ha  
Cons. of Flora and Fauna  
N.P.N.C.A.

No. 2823  
CG  
6325  
46.5388 ha  
CG  
3838  
40.4686 ha  
CG  
641  
132.33

CG  
5228  
320.1063 ha  
CG  
1888  
40.9542 ha  
CG  
6515  
126.6160 ha  
CG  
3532  
64.7497 ha  
CG  
1887  
40.4686 ha

CG  
2096  
164.4769 ha  
CG  
6309  
193.8269 ha  
CG  
8171  
43.0636 ha  
CG  
2628  
64.7497 ha  
CG  
6156  
120.3117 ha  
CG  
790  
35.898 ha

CG  
8171  
43.0636 ha  
CG  
2628  
64.7497 ha  
CG  
7003  
40.4686 ha  
CG  
3573  
64.4777 ha  
CG  
3846  
41.2779 ha  
CG  
1889  
40.4686 ha  
CG  
2771  
117.0907 ha  
CG  
470  
64.8053 ha  
CG  
1887  
CG  
6518  
161.4291 ha  
CG  
2099  
163.2375 ha  
CG  
790  
35.898 ha

Part Boscobel NE.  
Scale 1:25 000

Clerk Wooddale  
F.Y.I

CG  
10144  
2.0234 ha  
Gravel  
CG  
807  
4 ha  
ROAD  
No. 11482  
CG  
2771  
117.0907 ha  
HILL  
BTW3  
Micro Wave

BM  
WO 3  
ROBINSON  
CARTERS  
Road  
Road No. 4912