

- 4 NOV 1996

LA404

FORFEITURES

Department of Land Administration

The following leases and licences together with all rights, title and interest therein have this day been forfeited to the Crown under the Land Act 1933 for the reasons stated.

Dated 22 October 1996.

A. A. SKINNER, Chief Executive Officer.

Name; Lease or Licence No.; District; Reason; Corres No.; Plan.

Murchison Region Aboriginal Corporation; 345B/2427; Yalgoo Lot 178; Non-Compliance with Conditions; 3705/953; CS D44024 BH44 (2) 21.25.

Murchison Region Aboriginal Corporation; 345B/2426; Yalgoo Lot 176; Non-Compliance with Conditions; 3110/969; CS D44024 BH44 (2) 21.25.

Belle-Sonne, Mirielle Helen; 345B/2054; Coomalbidgup Lot 26; Non-Compliance with Conditions; 2519/982; CF29 (2) 25.28.

LA701*

RESERVES ACT 1996

(No. 32 of 1996)

It is hereby notified that pursuant to the above Act assented to on 19 September, 1996, the undermentioned reserves have been dealt with in the manner described—

1. Class 'A' Reserve 4561 (Canning Locations 3469 and 3597) "Parklands" is amended by the inclusion of Location 3895 on Diagram 91837 with its area being increased to 499.4387 hectares.
Public Plan: BG33(2) 24.40
DOLA File: 2295/897 V3
2. The classification of the following reserves have been downgraded from Class 'A' to Class 'C'—
 - (i) Reserve 23243 (Nelson Location 2931) "Hallsite".
Public Plan: BH29(2) 14.18
DOLA File: 3080/904
 - (ii) Reserve 24679 (Borden Lot 45) "Camping and Caravan Park".
Public Plan: BK28(2) 33.29
DOLA File: 2766/933
 - (iii) Reserve 24943 (Plantagenet Location 6172) "Preservation of Flora".
Public Plan: BJ27(10) 8.2
DOLA File: 1050/958
3. Class 'A' Reserve 15927 (Bunbury Lots 380, 358, 384, 397, 451, 452 and 575) "Recreation and Parking" is amended to exclude Lot 759 on Diagram 91861 with its area being decreased to about 8.1002 hectares.
Public Plans: BG30(2) 01.32 & 02.32
DOLA File: 4651/903 V4.
4. Class 'A' Reserve 23000 (Wellington Locations 4583 and 5174) "Travellers Stopping Place and Caravan Park" is amended by the inclusion of Location 5629 on Diagram 90968 with its area being increased to 136.5891 hectares.
Public Plans: BF30(10) 8.4 & 8.5
DOLA File: 579/945
5. (i) Class 'C' Reserve 36196 (Tenterden AA Lot 105) "Gravel" is cancelled.
(ii) Class 'A' Reserve 2218 (Tenterden AA Lot 17) "Conservation of Flora and Fauna" is amended by the inclusion of AA Lot 105 with its area being increased to 55.7512 hectares.
Public Plan: Tenterden (2) NW
DOLA File: 2978/891
6. Class 'A' Reserve 36996 (Nelson District) "National Park and Water" is amended by:-
 - (a) the excision of that area now contained in Locations 13471 to 13474 inclusive as depicted on Reserve Plan 431.
 - (b) the inclusion of Location 13481 as depicted on Miscellaneous Diagram 525.

The reserve being redescribed to comprise Locations 3706, 4418, 5222, 5223, 5224, 5225, 5239, 5472, 5603, 6464, 6950, 6951, 6955, 6962, 6964, 6965, 6966, 6967, 6968, 7202, 7203, 7562, 7594, 7612, 7636, 7640, 7645, 7646, 7649, 7658, 7659, 7660, 7661, 7662, 7669, 7670, 7671, 7672, 7673, 7674, 7675, 7676, 7678, 7679, 7680, 7681, 7682, 7683, 7760, 7831, 7832, 7833, 7834, 7835, 7836, 7837, 7838, 7839, 7840, 7841, 7842, 7843, 7844, 7845, 7846, 7847, 7848, 7849, 7850, 7851, 7852, 7853, 7854, 7855, 7856, 7857, 7858, 7859, 7860, 7861, 7862, 7863, 7864, 7898, 7899, 8288, 9277, 9957, 11100, 12730, 12731, 12873, 12887, 12891, 12896, 12901, 12902, 12903, 12910, 12917, 12918, 12919, 12920, 12921, 12922, 12923, 12924, 12925, 12926, 12927, 12928, 12929, 12930, 12932, 12933, 12934, 12936, 12937, 12938, 12939, 12940, 12941, 12942, 12953, 13057, 13058, 13078, 13324, 13370, 13382, 13383, 13384, 13385, 13386, 13387,

5-11-96

3

m. Collins - for your letter re

CLAUSE 17

Class "A" Reserve 24943 was set aside for the purpose of "Preservation of Flora" in 1958. Via Reserves and Road Closure Act (No. 95) 1972 its area was reduced from 4.1430 hectares to 2.5243 hectares.

Vesting of the reserve in the National Parks and Nature Conservation Authority was pursuant to Section 7 of the Conservation and Land Management Act (as amended) 1984.

Subsequent inspection of the reserve by Conservation and Land Management staff revealed that this area was unsuitable for retention as a nature reserve. It is intended to amend the reserve's purpose to "Landscape Protection" and vest in the Shire of Plantagenet. Both Council and CALM have indicated support for this proposal.

Classification of Reserve 24943 as Class "A" is not considered appropriated for this area and Parliament's approval is sought to reduce this status to Class "C". All subsequent adjustments can then be carried out via normal processes under the Land Act 1933.

Electoral District of Stirling
South-West Electoral Region
Shire of Plantagenet

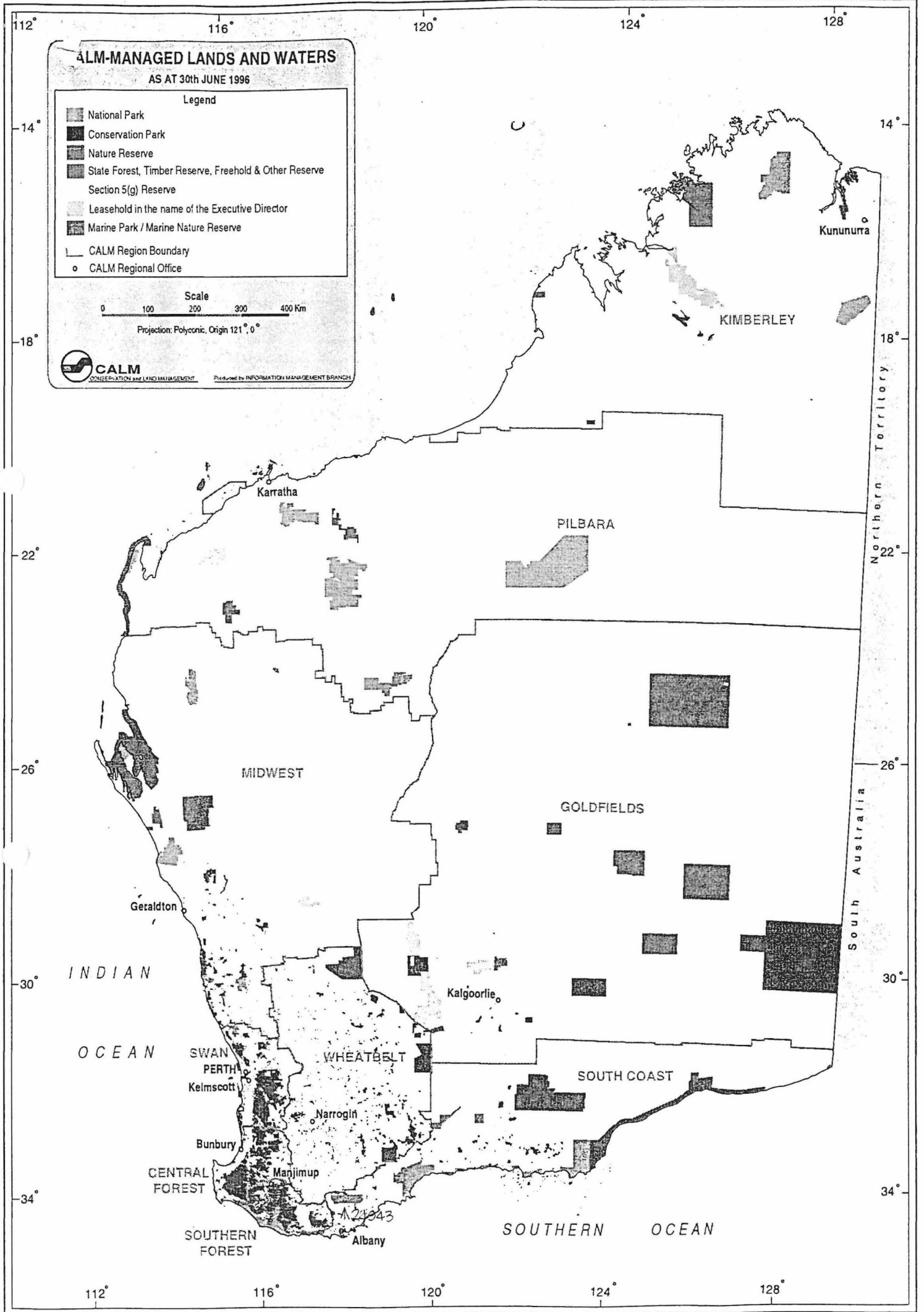

CALM-MANAGED LANDS AND WATERS

AS AT 30th JUNE 1996

Legend

- National Park
- Conservation Park
- Nature Reserve
- State Forest, Timber Reserve, Freehold & Other Reserve
- Section 5(g) Reserve
- Leasehold in the name of the Executive Director
- Marine Park / Marine Nature Reserve
- CALM Region Boundary
- CALM Regional Office

Scale
0 100 200 300 400 Km

Projection: Polyconic, Origin 121° 0'



Produced by INFORMATION MANAGEMENT BRANCH

INDIAN OCEAN

SWAN PERTH
Kelmscott

WHEATBELT

SOUTH COAST

CENTRAL FOREST

SOUTHERN FOREST

SOUTHERN OCEAN

Northern Territory
South Australia

A21943

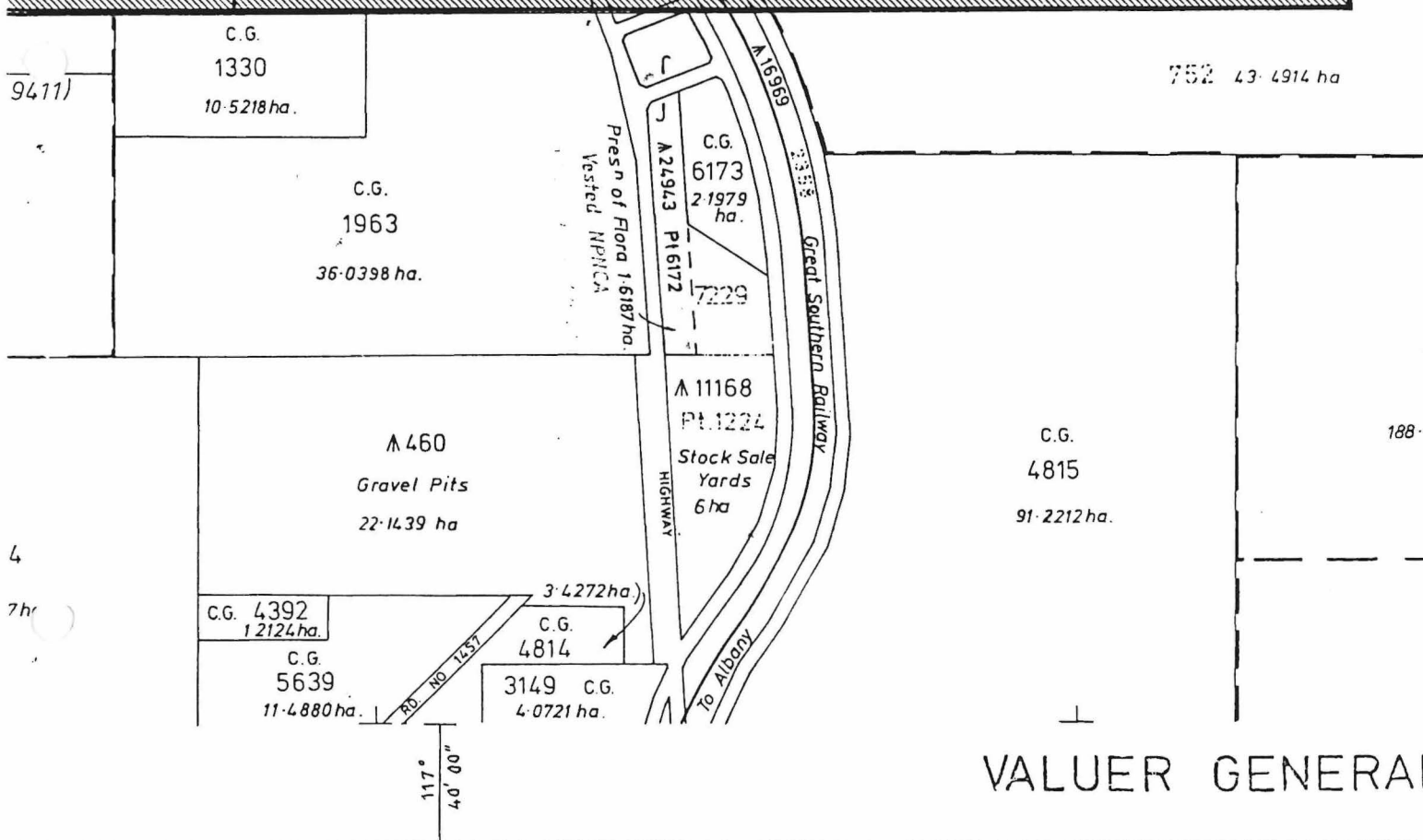
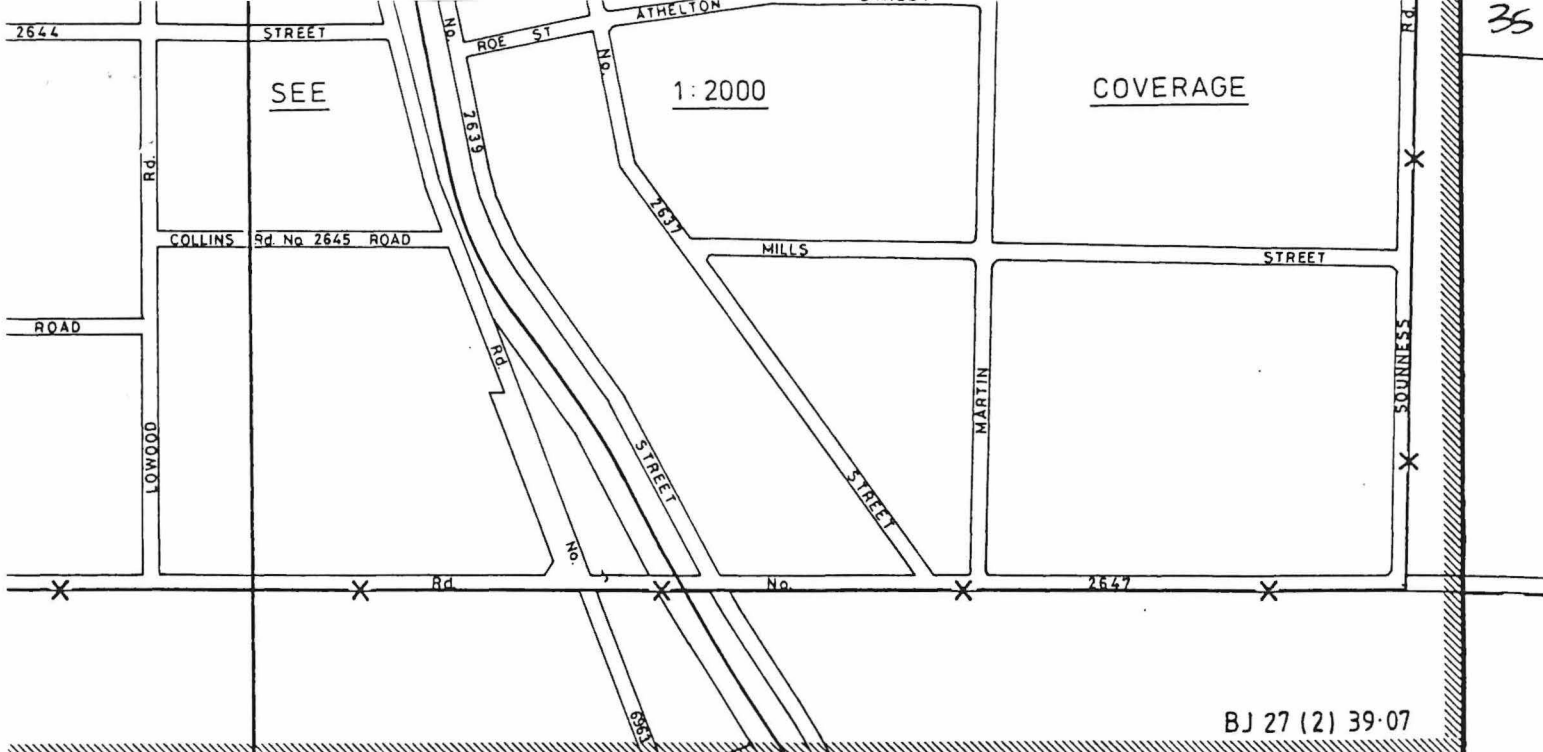

ADJOINING SHEETS

| | | |
|--|-----|--|
| | | |
| | 8.2 | |
| | | |

SCALE 1:10000

Pt. Plan Mt Barker Regional.
BJ 27/8-2

AND DISTRICT
LOCAL AUTHORITY

1/10 Hectare approx 1 Acre 1 link approx 20 Centimetres

PLAN MT BARKER (25)

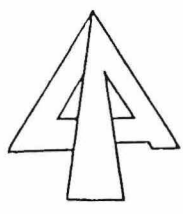

DECLASSIFICATION OF A 24943 FROM CLASS "A" TO CLASS "C"

PUBLIC PLAN BJ27 10000 8.2
PLANTAGENET DISTRICT
CORR: 1050/958

