

NATURE RESERVE

RESERVE NO: 25872

GOVERNMENT GAZETTE  
Date Page No.

FILE NUMBER: FWD 1113/76

PURPOSE: CONSERVATION OF FLORA AND FAUNA 18.11.83 4575

NAME:

CLASS (Land Act):

AREA: 536.7904 ha

VESTING: W.A.W.A. 18.11.83 4562

LOCATION NO(S): HINES HILL LOT 91 AND AVON LOCATION 18954

CLASSIFICATION:  
(Wildlife Act  
Section 12A)

LITHO: Diagram 509

LOCAL AUTHORITY: Merredin

Notes:



DEPARTMENT OF LANDS AND SURVEYS

Cathedral Avenue,  
Perth,  
Western Australia 6000

Your Ref. W113/76 DW  
Our Ref. 2900/59 CN:JG  
Telephone Enquiries 323 1278

Department of Conservation  
and Land Management  
14 JUL 1986  
COMO. W.A.

Executive Director  
DEPARTMENT OF CONSERVATION  
AND LAND MANAGEMENT

RESERVE 25872

I refer to my memo of May 16, 1986 and advise for your information that Executive Council has:-

1. issued an Order in Council revoking the Order in Council dated November 8, 1983 whereby Reserve No. 25872 was vested in the Western Australian Wildlife Authority in trust for the purpose of "Conservation of Flora and Fauna".
2. approved of the amendment of Reserve No. 25872 (Hines Hill Lot 91 and Avon Location 18954) "Conservation of Flora and Fauna" and include Avon Location 28881 and of its area being increased to 538.3922 hectares and issued an Order in Council directing that Reserve No. 25872 shall vest in and be held by the National Parks and Nature Conservation Authority in trust for the purpose of "Conservation of Flora and Fauna".

Notice to this effect will be published in the Government Gazette of July 11, 1986 and I enclose a print showing the said amendment and the relevant Vesting Order. Would you please return to this Office the superseded Vesting Order dated November 8, 1983 for cancellation.

Yours faithfully

*R. W. Mickle*  
ACTING EXECUTIVE DIRECTOR

July 10, 1986

enc

*Rp17-7-86.*

DEPARTMENT OF CONSERVATION AND LAND MANAGEMENT

Form CLM 80B

From: LAND CLERK  
To: REGIONAL MANAGER  
KATANNING.  
Your Ref:  
Our Ref: 018618 F 3102  
Enquiries: M. BRIGGS.  
Phone: 3670454  
Subject: RESERVE 25872

Please find attached for your information, copies of correspondence relating to the abovementioned reserve.

  
LAND CLERK

DISTRIBUTION:

CLERK, WOODVALE - for your information  
DISTRICT MANAGER, NARROGIN.

would you please arrange  
the distribution of  
attached copies to the  
appropriate Wildlife  
Officer.

Done  
2.2.87



DOLA

Department of LAND ADMINISTRATION

Your Ref: 018618 F3102

Our Ref: 2900/959 (Job No. 965271) KE:JF 1 DEC 1996

Telephone: 273 7284

Enquiries: Mr Kevin Emrose

Executive Director  
Department of Conservation and  
Land Management  
Locked Bag 104  
BENTLEY DELIVERY CENTRE WA 6983

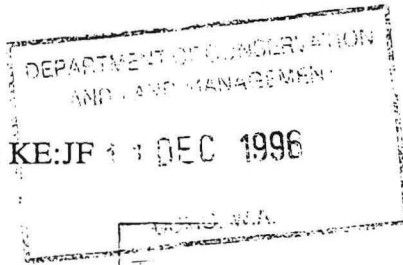

MIDLAND SQUARE, MIDLAND  
WESTERN AUSTRALIA  
Postal Address: PO Box 2222  
Midland, Western Australia 6056

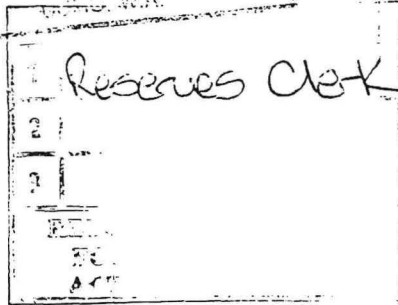

5 DEC 1996

CLASS 'A' RESERVE 25872 AT HINES HILL

Thank you for your memorandum dated 22 November, 1996 concerning the amendment of the abovementioned reserve. Subsequent to my advice dated 14 February 1995, Crown Solicitors Office advice (July 1995) indicated that Reserves Bill action was not necessary where changes to Class 'A' reserves will simply reflect area re-calculations, allocation of land parcel identifiers and compiled graphical support, where the reserve's purpose and external boundaries remain unaltered. These actions were considered in-house maintenance tasks.

Acting on this advice the following reserves were identified as meeting the abovementioned criteria.

Reserve No.	Purpose	Land Description	Area	Re-calculated Area	Graphic Support	
12329	Conservation of Flora and Fauna	Avon Locations 9309, 12182, 12208 and 16470	about 160.1761 ha	about 147.2262 ha	Partly surveyed on O.P. Avon 1174 and Diagram 72237 and depicted on Reserve Diagram 524	Area miscalculation due to the double counting of the area of Location 9309. ie Present area about 160.1761 Location 9309 - $\frac{12,9499}{147,2262}$  A reduction in calculated area of approximately 8%.
31197	Conservation of Flora and Fauna	Esperance District	16.0508 ha	about 11.0341 ha	Created using a technical description in 1972; supporting sketch being page 30 of DOLA File 792/68. Reserve Diagram 1307 now created.	Original area was calculated incorrectly from the sketch. Using sketch information a new graphic has been created and the area recalculated to 11.0341 ha, a reduction in calculated area of approximately 30%.
30298	Conservation of Flora and Fauna	Avon Location 23913	28.7175 ha	about 22.1642 ha	Diagram 51196 depicts Avon Location 23913 and a portion of one chain road. Compiled Diagram 92149 now created to depict Location 23913.	Portion of the one chain road depicted on Diagram 51196 was closed and its area incorporated into the 1970 reservation. Area miscalculation stems from the calculation of the closed road area. A new diagram (No. 92149) has been compiled and the reserve's area re-calculated to 22.1642 hectares. A calculated area reduction of 23%.
19118	Conservation of Flora and Fauna	Williams Locations 14196 and 15576	207.7428 ha	about 102.7553 ha	Location 15576 is surveyed on OP 8201 however Location 14194 is unsurveyed. Compiled Diagram No. 92205 created to depict the reserve in its entirety.	Area miscalculation due in part to lack of support data for Location 14194. The area is surveyed by surround accordingly a new compiled diagram (No. 92205) has been prepared. The calculated area being 102.7553 ha. This represents a calculated area reduction of approximately 50%.

File - 12-12-96 Reserves Clerk



Reserve No.	Purpose	Land Description	Area	Re-calculated Area	Graphic Support	
25872	Conservation of Flora and Fauna	Hines Hill Lot 91 and Avon Locations 18954 and 28881	538.3922 ha	about 414.3242 ha	Avon Location 18954, is surveyed on OP Avon 1456, Location 28881 on Diagram 87156, Hines Hill Lot 91 unsurveyed. Reserve Diagram 509 created to depict the reserve.	The original area calculation of Location 18954 via survey was established at 1312 acres (530.9476 ha). However Locations 22921 and 24127 were created comprising portions of Location 18954. The excision of these areas (totalling 123.7200) was overlooked when compiling Reserve Diagram 509 upon which amendment of the area of the reserve was supported in 1983.  Reserve Diagram 509 has been amended to reflect the re-calculated area of 414.3242 hectares. A reduction in calculated area of approximately 23%.

Accordingly Departmental records have been updated in the following manner.

- Reserve No. 12329 - Its area re-calculated to about 147.2262 hectares.
- Reserve No. 31197 - Reserve Diagram No. 1307 created, Esperance Location 2096 allocated and its area being re-calculated to about 11.0341 hectares.
- Reserve No. 30298 - Crown Survey Diagram No. 92149 compiled and area re-calculated to 22.1642 hectares.
- Reserve No. 19118 - Crown Survey Diagram No. 92205 compiled, Williams Location 15848 issued in lieu of 14194 and 15576 and area re-calculated to 102.7553 hectares.
- Reserve No. 25872 - Reserve Diagram No. 509 updated and area re-calculated to about 414.3242 hectares.

Enclosed is a copy of the supporting graphics for these actions.

*[Signature]*  
 for **T THOMSON**  
**MANAGER**  
**ACQUISITIONS, ROADS & RESERVES**  
**LAND OPERATIONS DIVISION**

December 3, 1996

Enc. 5271JF01

*File - 3-1-97*  
*Mr Ryan noted Mr [unclear]*  
*Mr [unclear] - for more attention as discussed. gils*  
*Thomson*  
*MR*  
 Plans and records amended < callie [unclear]

GOVERNMENT GAZETTE  
14-30-1986  
COMO, W.A. 68

W 1113/76 22-7 WL

11 July 1986.]

GOVERNMENT GAZETTE, W.A.

2343

**INDUSTRIAL AND COMMERCIAL EMPLOYEES' HOUSING ACT 1973 (AS AMENDED)**

HIS Excellency, the Governor in Council, acting pursuant to section 8 (2) (c) (iii) of the Industrial and Commercial Employees Housing Act 1973 (as amended) has been pleased to appoint Mr Frederick Albert Smith as a Member of the Industrial and Commercial Employees' Housing Authority from 1 May 1986.

Dated this 7th day of July, 1986.

KEITH WILSON,  
Minister for Housing.

**INDUSTRIAL AND COMMERCIAL EMPLOYEES' HOUSING ACT 1973 (AS AMENDED)**

HIS Excellency, the Governor in Council, acting pursuant to section 8 (2) (b) of the Industrial and Commercial Employees' Housing Act 1973 (as amended) has been pleased to appoint Mr Patrick John Mahoney as a Member of the Industrial and Commercial Employees' Housing Authority from 27 June 1986.

Dated this 7th day of June, 1986.

KEITH WILSON,  
Minister for Housing.

**AMENDMENT OF RESERVES**

Department of Land Administration,  
Perth, 11 July 1986.

HIS Excellency the Governor in Executive Council has been pleased to approve, under section 37 of the Land Act 1933 of the amendment of the following Reserves:—

File No. 696/72.—No. 36435 (Canning Location 3087) "Parks and Recreation" to exclude Canning Location 3497, as surveyed and shown bordered red on Lands and Surveys Diagram 87254, and of its area being reduced to 91.053 7 hectares accordingly. (Plan Perth 2 000 14.19, 14.20, 15.19, 15.20 (Jackson Road and Kent Street).)

File No. 2900/59.—No. 25872 (Hines Hill Lot 91 and Avon Location 18954) "Conservation of Flora and Fauna" to include Avon Location 28881, as shown bordered in red on Lands and Surveys Diagram 87156, and of its area being increased to 538.392 2 hectares accordingly. (Plan Nangeenan 1:50 000 (Hines Hill Road in the Shire of Merredin).)

File No. 824/93.—No. 2263 (Kimberley District) "Resting Place for Travellers and Stock" to exclude that portion now comprised in Luman Location 30, as surveyed and shown bordered red on Original Plan 16007, and of its area being reduced to 2 424.767 9 hectares accordingly. (Plan Dixon Range 1:250 000 (Great Northern Highway in the Shire of Halls Creek).)

File No. 746/90.—No. 1902 (Hay District) "Public Utility" to comprise Hay Location 2359, as surveyed and shown bordered red on Lands and Surveys Diagram 87386 and its area remaining unaltered. (Plan Warrenup S.W. 1:25 000 (Boyacup Road).)

R. W. MICKLE,  
Acting Executive Director.

**LAND ACT 1933**

**Reserves**

Department of Land Administration,  
Perth, 11 July 1986.

HIS Excellency the Governor in Executive Council has been pleased to set apart as Reserves the land described below for the purposes therein set forth.

File No. 2701/984.

LUMAN.—No. 39493 (Repeater Station Site), Location No. 30 (7.236 9 hectares). (Original Plan 16007, Plan Dixon Range 1:250 000 (Great Northern Highway in the Shire of Halls Creek).)

File No. 2704/984.

LUMAN.—No. 39494 (Repeater Station Site), Location No. 31 (11.695 9 hectares). Original Plan 16008, Plan Dixon Range 1:250 000 (near Turkey Creek in the Shire of Halls Creek).)

File No. 2591/985.

WILUNA.—No. 39501 (Use and Benefit of Aboriginal Inhabitants), Lot No. 546 (999 square metres). (Original Plan Wiluna 4531 Plan Wiluna Townsite (Thompson Street).)

File No. 2614/985.

WILUNA.—No. 39502 (Vehicular Access), Lot No. 13 (1 012 square metres). (Original Plan Wiluna 149, Plan Wiluna Townsite (Woodley Street).)

File No. 2590/985.

WILUNA.—No. 39503 (Use and Benefit of Aboriginal Inhabitants), Lot No. 41, 43 and 44 (3 036 square metres). (Original Plan Wiluna 149, Plan Wiluna Townsite (Wotton Street).)

File No. 1224/985.

SWAN.—No. 39504 (Water Supply), Location No. 10743 (4 331 square metres). (Diagram 87429, Plan Swan 2 000 09.05 (Edgewater Drive).)

File No. 898/986.

CANNING.—No. 39506 (Rubbish Transfer Site), Location No. 3497 (1.858 0 hectares). (Diagram 87254, Plan Perth 2 000 14.20 (Hayman Road).)

File No. 1755/986.

EXMOUTH.—No. 39508 (Drainage), Lot No. 1016 (1 107 square metres). (Diagram 87408, Plan Exmouth Townsite 2 000 15.11 (Patterson Way).)

R. W. MICKLE,  
Acting Executive Director.

**CANCELLATION OF RESERVE No. 29775**

Department of Land Administration,  
Perth, 11 July, 1986.

HIS Excellency the Governor in Executive Council has been pleased to approve, under section 37 of the Land Act 1933 of the cancellation of the following Reserve:—

File No. 3401/68.—No. 29775 (Merredin Lots 1184 and 1213) "Use and Requirements of the Government Employees Housing Authority". (Plan Merredin 2 000 36.36 (Warne Street and Muscat Street).)

R. W. MICKLE,  
Acting Executive Director.

22-8-86

*y. Wildlife & Land Admin*

**CHANGE OF PURPOSE OF RESERVES**

Department of Land Administration,  
Perth, 11 July 1986

HIS Excellency the Governor in Executive Council has been pleased to approve, under section 37 of the Land Act 1933, of the change of purpose of the following Reserves:—

File No. 1473/69.—No. 31540 (Esperance Locations 1950, 1953 and Esperance Lot 732) being changed from "Recreation" to "Public Recreation". (Plan Esperance 2 000 15.11 (Twilight Beach Road).)

File No. 746/90.—No. 1902 (Hay Location 2359) being changed from "Public Utility" to "Parklands" (Plan Warrenup S.W. 1:25 000 (Boyacup Road).)

R. W. MICKLE,  
Acting Executive Director.



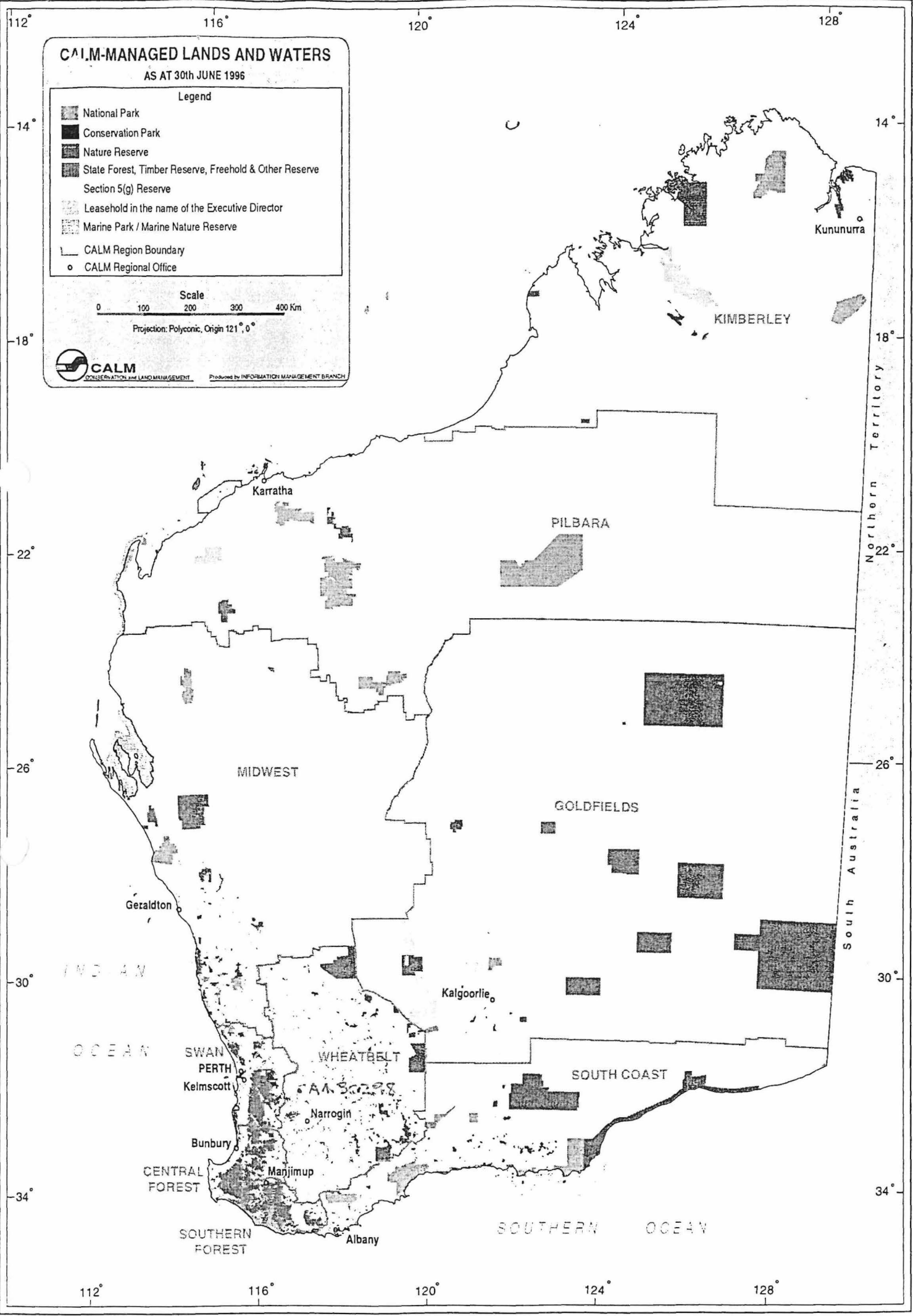





*Rec'd*  
*These attach to (W) 1113/76 + return*  
*also 20/11/86 13/8/86*



# CALM-MANAGED LANDS AND WATERS

AS AT 30th JUNE 1996

## Legend

-  National Park
-  Conservation Park
-  Nature Reserve
-  State Forest, Timber Reserve, Freehold & Other Reserve
-  Section 5(g) Reserve
-  Leasehold in the name of the Executive Director
-  Marine Park / Marine Nature Reserve
-  CALM Region Boundary
-  CALM Regional Office

Scale  
0 100 200 300 400 Km

Projection: Polyconic, Origin 121° 0'



Produced by INFORMATION MANAGEMENT BRANCH

Northern Territory

South Australia

INDIAN OCEAN

SOUTHERN OCEAN

SWAN PERTH  
Kelmiscott

Bunbury

CENTRAL FOREST

SOUTHERN FOREST

Manjimup

Narrogin

WHEATBELT

Karratha

MIDWEST

Geraldton

PILBARA

GOLDFIELDS

Kalgoorlie

SOUTH COAST

KIMBERLEY

Kununurra

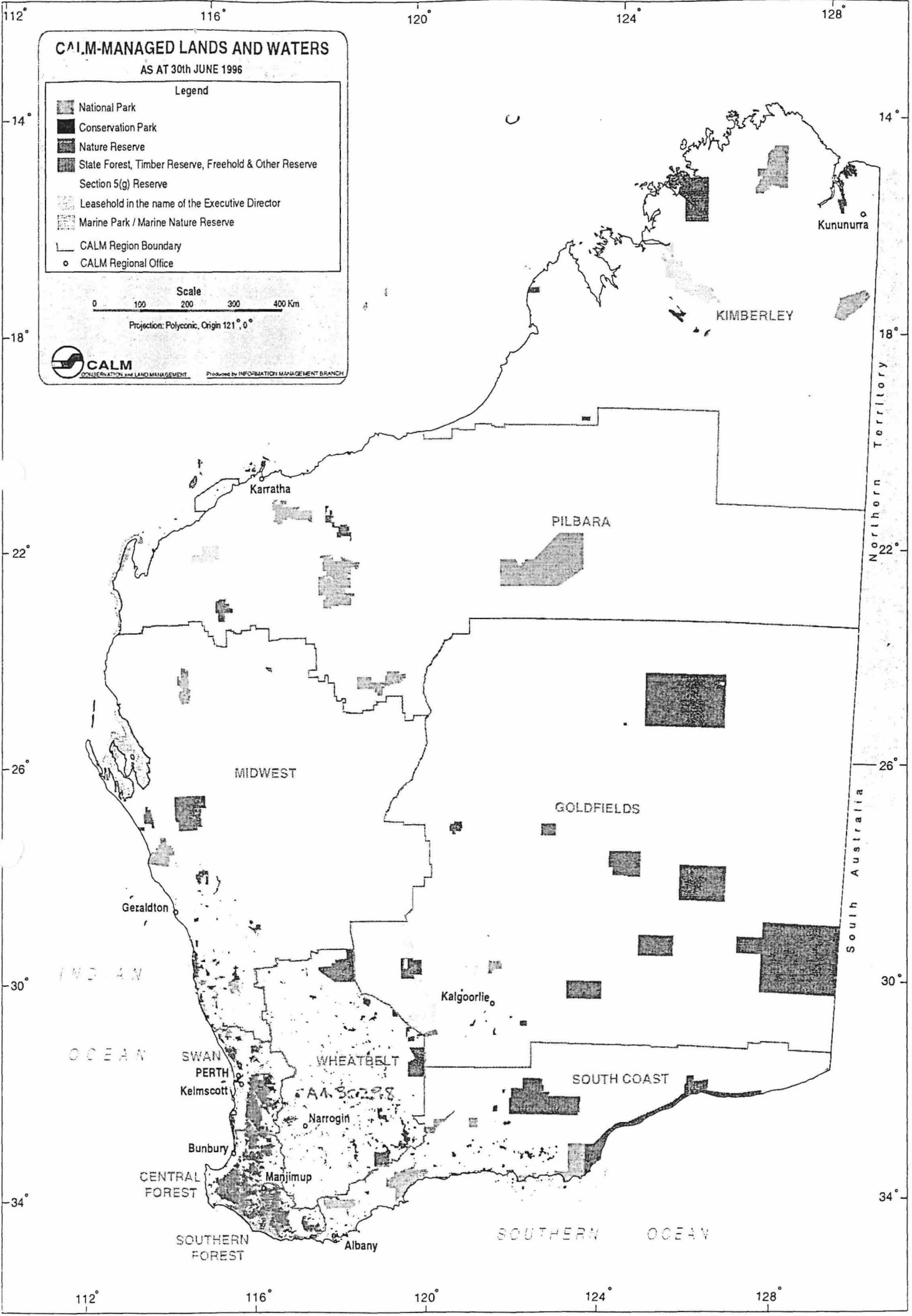

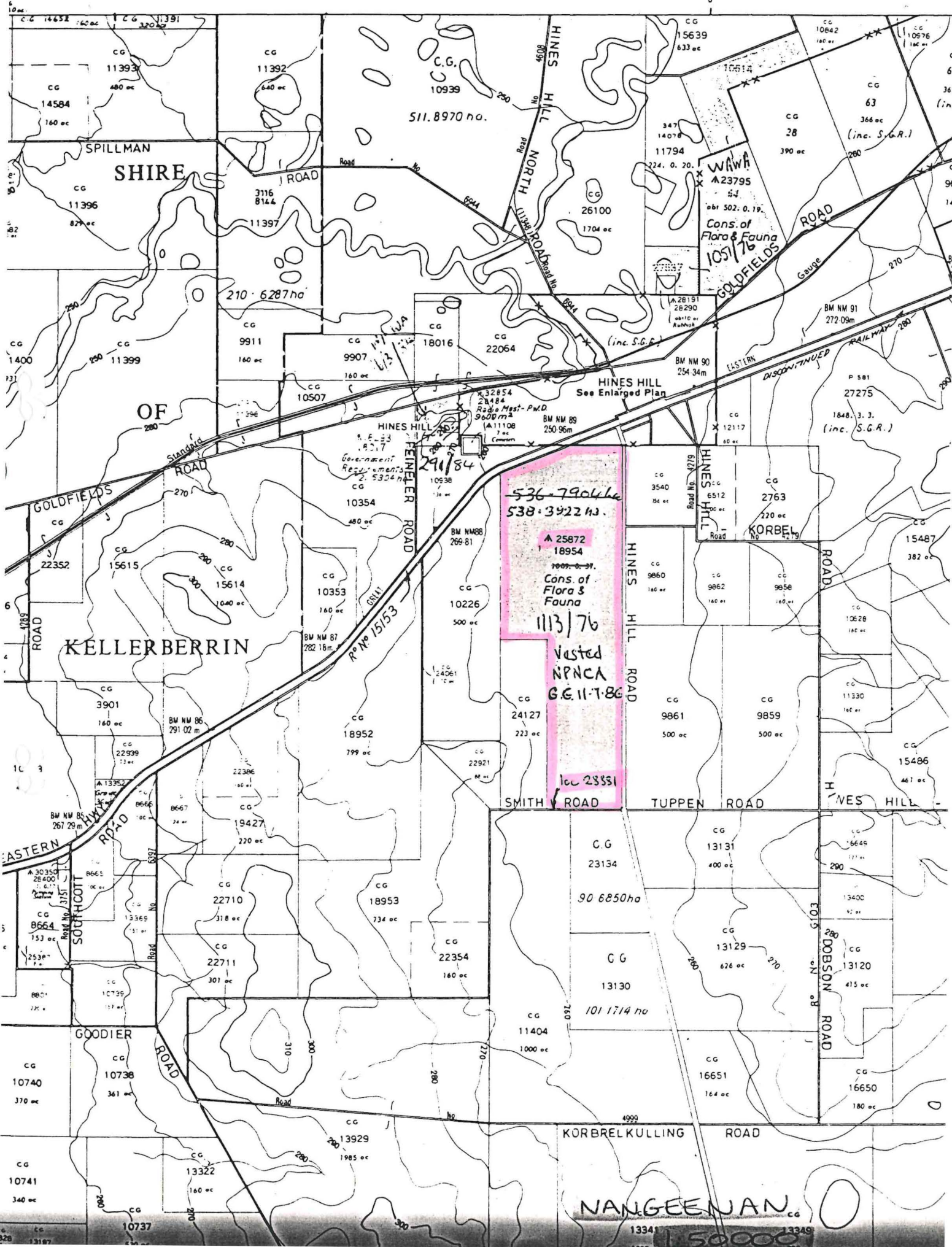

HINES HILL TOWNSITE

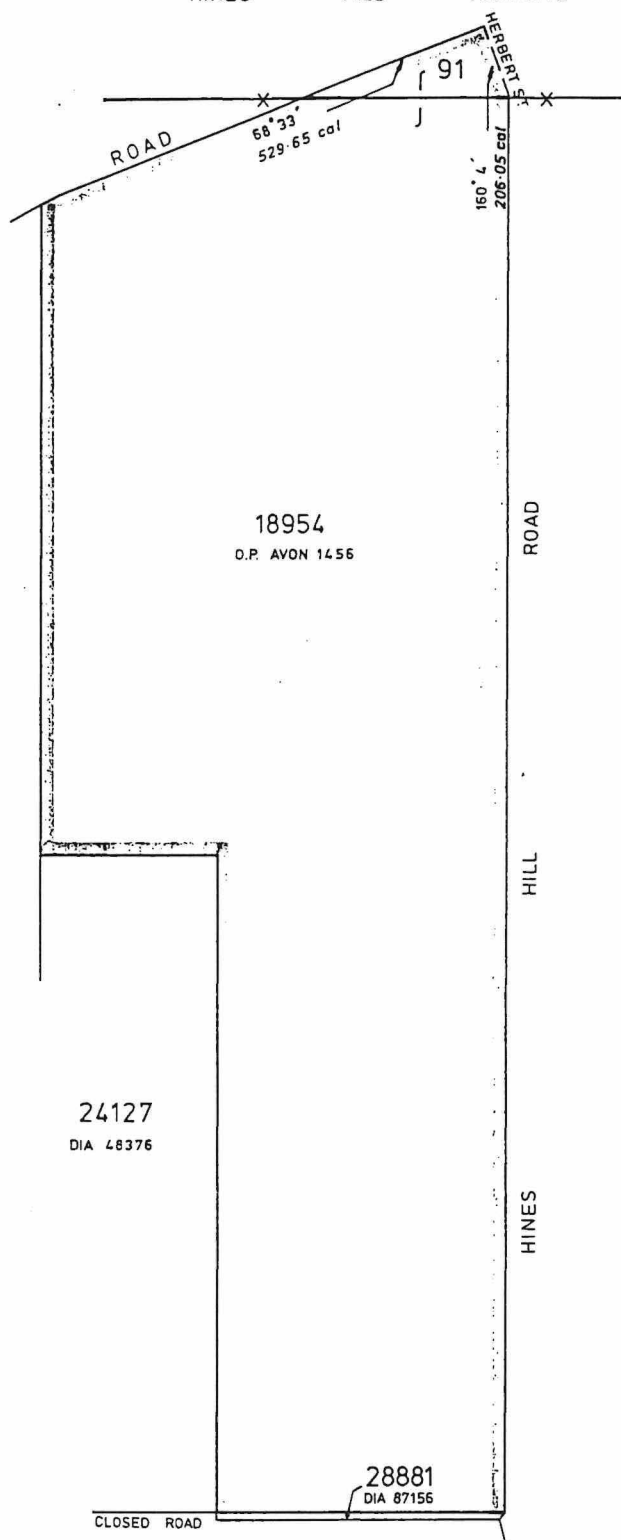

10226  
DIA 25639

ROAD  
HILL  
HINES



RESERVE No. A25872 Purpose Conservation of Flora and Fauna TOTAL 538 3922 ha Area 536 7904 ha

CORR. No. 2900/59  
DISTRICT AVON  
PUBLIC PLAN HINES HILL T/S  
NANGEEAN 1:50000  
PREPARED BY A.J.CAMPBELL Date 14.9.83  
CAL. BOOK REF A.J.C. 2 Page 66  
CHECKED *Anderson* 20.9.83  
Supt Mapping Branch



AMENDMENTS					
Gaz	Page	Intls	Gaz	Page	Intls
11-7-86	2343	LJN			
12-4-91	1597	TBD			
SUBJECT TO SURVEY					

SCALE 1:15 000 414.3242 ha  
All measurements in metres  
GAZETTED 18-11-83 PAGE 4575  
Recorded on Public Plan A.M.G. 12-12-83  
Registered 22.9.1983  
On Key Plan NANGEEAN Custodian of Plans  
RESERVE DIAGRAM No. 509

2400/59

AMENDMENTS 90

63

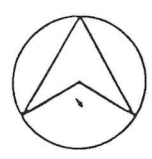
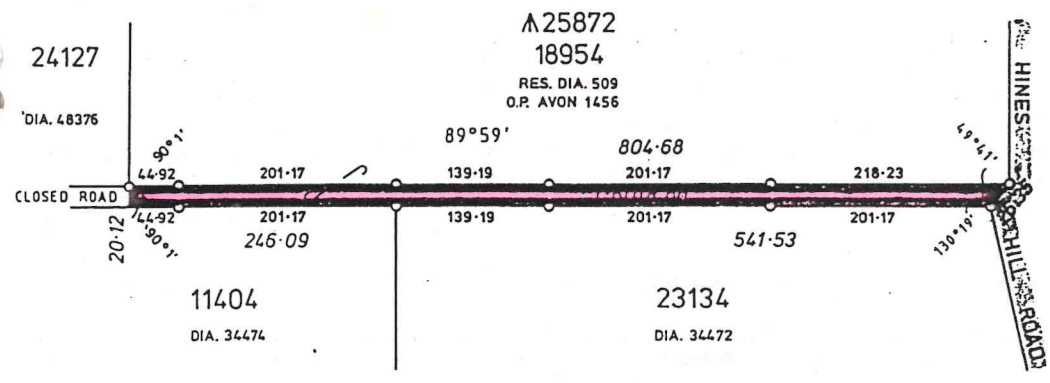

LAND DISTRICT <b>AVON</b>		LOCATION <b>28881</b>		FILE No. <b>16/929</b>
				SCALE <b>1:5000</b> All measurements in metres
<b>SURVEYOR'S CERTIFICATE</b> I hereby certify that this survey was performed by me personally (or under my personal supervision, inspection and field check), in strict accordance with the Licensed Surveyors (Guidance of Surveyors) Regulations.  <b>COMPILED</b> Licensed Surveyor. Date .....		Azimuth observed at ..... or assumed from <b>O.P. AVON 1456</b> Date of marking ..... Surveyor ..... Field Book No. .... Page ..... Cadastral Plan. <b>NANGEENAN 1:50000</b> Reference <b>602506</b> Diagram Drawn <b>O.B.HILL</b> Date <b>8.10.85</b>	Calc. Bk. No. <b>F.S. BEAHAN</b> Fol. .... Compared with F.B. <i>[Signature]</i> 12/4/85 Examined <i>[Signature]</i> 12/11/85 Diagram passed Inspector of Plans and Surveys Date .....	<b>SURVEY APPROVED</b> Date ..... Surveyor General Recorded on Public Plan. Registered On Key Plan No. 1:50000 Custodian of Plans <i>[Signature]</i> 12.10.1985 <b>DEPT. OF LANDS AND SURVEYS</b> <b>DIAGRAM No. 87156</b>