

## RESERVE ACTION SHEET - CONSERVATION RESERVES

**RESERVE No. 26363**

### REASON FOR ACTION

- Addition of Reserve No. 26363, not of class A, to CALM Estate, excluding Avon Location 29184, vested in the NPNCA for the purpose "Conservation of Flora and Fauna" (formerly unvested for the purpose 'Timber'). Area: 122.3452 ha
- The reserve has high values for conservation as it is situated high in the landscape and supports undisturbed flora communities. Avon Location 29184 has been excluded for vesting in the Shire of Wandering for the purpose 'Gravel'.
- Gazettal date: 27 November 1998 See folio 70
- Plans at folios 79 and 80

OFFICER	ACTION	
1 <b>CONSERVATION ESTATE OFFICER</b>	<ul style="list-style-type: none"> <li>- Fill in above details</li> <li>- Attach copies of gazettal notices to file</li> </ul> <p>Send copies of gazettal notices and Map to:</p> <ul style="list-style-type: none"> <li>- Lisa Wright, Woodvale</li> <li>- District Manager, <i>Narrogin</i></li> <li>- Regional Manager, <i>Wheatbelt</i></li> </ul> <p>To note:</p>	<hr/> <hr/>  <hr/> <hr/> <hr/> <hr/>
2 <b>INDEX CLERK, RECORDS</b>	<ul style="list-style-type: none"> <li>- Index reserve's name</li> <li>- Index reserve's number</li> </ul>	<hr/> <hr/>
3 <b>LAND ACQUISITIONS OFFICER</b>	To note:	<hr/>
4 <b>MANAGER, PLANNING &amp; VISITOR SERVICES</b>	To note:	<hr/>
5 <b>DIRECTOR, NATURE CONSERVATION/ NATIONAL PARKS</b>	To note:	<hr/>

## RESERVE ACTION SHEET - CONSERVATION RESERVES

**RESERVE No. 26363**

**REASON FOR ACTION**

- Amendment of the area of Reserve No. 26363 vested in the National Parks and Nature Conservation Authority for the purpose of 'Conservation of Flora and Fauna'. Area: 56.4069 ha
  
- The area of Reserve No. 26363 has been amended from 122.3452 hectares to 56.4069 hectares as a result of an area calculation error detected by CALM's Information Management Branch (IMB). No physical change to the reserve's boundary has occurred.
  
- Date of DOLA's advice: 29 June 1999 See folio 151
  
- Plans at folios 132 & 150

OFFICER	ACTION	
1	<b>CONSERVATION ESTATE OFFICER</b>	<ul style="list-style-type: none"> <li>- Fill in above details _____</li> <li>- Attach copies of gazettal notices to file _____</li>   <li>Send copies of gazettal notices and Map to:                             <ul style="list-style-type: none"> <li>- Lisa Wright, Woodvale _____</li> <li>- District Manager, Narrogin _____</li> <li>- Regional Manager, Wheatbelt _____</li> </ul> </li>   <li>To note:</li> </ul>
2	<b>INDEX CLERK, RECORDS</b>	<ul style="list-style-type: none"> <li>- Index reserve's name _____</li> <li>- Index reserve's number _____</li> </ul>
3	<b>LAND ACQUISITIONS OFFICER</b>	To note:
4	<b>MANAGER, PLANNING &amp; VISITOR SERVICES</b>	To note:
5	<b>DIRECTOR, NATURE CONSERVATION/ NATIONAL PARKS</b>	To note:

Customer Advices for Reserve Actions  
1/11/98 - 30/11/98

Shire of Wandering 1/11/98 - 30/11/98

Reserve No.	Land Description	DOLA File No.	Volume/Folio	Action	Document No.	Lodge Date	Street Name	Area	Public Plans
26363	Avon Location 5888 on Land Administration Diagram 13158	03444-1961-01RO	3075-293	Amendment of Reserve to To exclude Avon Location 29184 on Land Administration Diagram 92841 and its area being reduced to 122.3452 hectares	G962524	27/11/98	near Wandering North Road	134.7252 Ha	Dattening NW (25)
26363	Avon Location 5888 on Land Administration Diagram 13158	03444-1961-01RO	3075-293	Change of Purpose to "Conservation of Flora and Fauna"	G962526	27/11/98	near Wandering North Road	122.3452 Ha	Dattening NW (25)
45506	Avon Location 29184 on Land Administration Diagram 92841	02095-1998-01RO	3107-687	Reserve Creation for the designated purpose of "Gravel".	G962528	27/11/98	near Wandering North Road	12.3802 Ha	Dattening NW (25)
45506		02095-1998-01RO	3107-687	Management Order to Shire of Wandering for the designated purpose of "Gravel"	G962529	27/11/98	near Wandering North Road	12.3802 Ha	Dattening NW (25)



DOLA

FILE REFERENCE No.  
043381F1999

MIDLAND SQUARE, MIDLAND  
WESTERN AUSTRALIA  
Postal Address: PO Box 2222  
Midland, Western Australia 6936

Department of LAND ADMINISTRATION

Your ref: 043381F1999  
Our ref: 3444/1961  
Job No.: 960471  
Telephone: (08) 9273 7300 Fax (08) 9273 7683  
Enquiries: David Forrest

DEPARTMENT OF CONSERVATION  
AND LAND MANAGEMENT  
30 JUN 1999  
GOMU, W.A.

**EXECUTIVE DIRECTOR  
CALM  
LOCKED BAG 104  
BENTLEY DELIVERY CENTRE WA 6983**

Attention: Sharon Colliss *SC* 1.7.99

**RESERVE 26363 "CONSERVATION OF FLORA AND FAUNA"**

I refer to your facsimile dated 29 December 1998 regarding the area of the above reserve.

Please find enclosed CLT 3018/913 which provides the amended area.

*Forrest*

*for* **GRAHAM HIGGINS  
REGIONAL MANAGER, SOUTH WEST  
LAND ADMINISTRATION SERVICES BRANCH**

29 June 1999

① CIS Please cancel Blup at p148

*Thankyou S. Colliss*

② *SC 2/7/99.*  
~~Carissa Bathgate:~~

- To note please and notify relevant Region/District
- Also note that  $\uparrow$  is shown as vested in NPWSA in CLT (p149)

③ Derek Minigham - to note registration of vesting at page 149.

*S. Colliss  
1.7.99*

NOT TO BE REMOVED FROM THE DEPARTMENT OF LAND ADMINISTRATION

**NO DUPLICATE ISSUED**

REGISTER  
VOLUME

FOLIO

**3018**

**913**

Application G962525  
Amendment of Reserve G962524  
Corr. 3444/1961  
Volume Folio  
3075 293

WESTERN



AUSTRALIA



**QUALIFIED CERTIFICATE  
OF  
CROWN LAND TITLE**

UNDER THE "TRANSFER OF LAND ACT 1893" AS AMENDED  
AND THE "LAND ADMINISTRATION ACT 1997"

The undermentioned land is Crown land, in the name of the  
**STATE of WESTERN AUSTRALIA,**  
subject to the interests and status orders in the First Schedule which interests and status orders are subject to the  
interests, easements, encumbrances and notices shown in the Second Schedule hereto.

Dated 27 November 1998



REGISTRAR OF TITLES

**LAND REFERRED TO**

Avon Location 5888 on Land Administration Diagram 13158 delineated on the sketch in the Third Schedule.

**THIRD SCHEDULE**

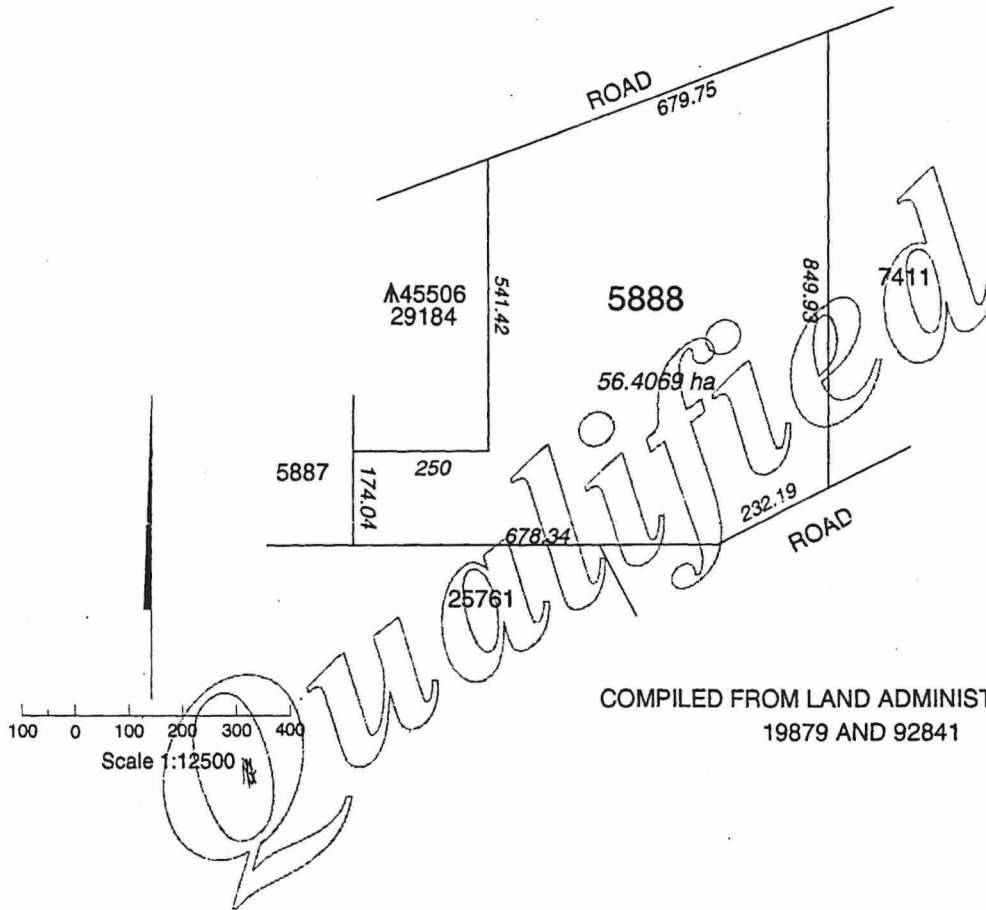

COMPILED FROM LAND ADMINISTRATION DIAGRAMS  
19879 AND 92841









WARNING: (1) THE LAND AND INTERESTS ETC. SHOWN HEREON MAY BE AFFECTED BY INTERESTS ETC. THAT CAN BE, BUT ARE NOT, SHOWN ON THE REGISTER.  
(2) THE INTERESTS ETC. SHOWN HEREON MAY HAVE A DIFFERENT PRIORITY THAN SHOWN.



# CALM-MANAGED LANDS AND WATERS

AS AT 30th JUNE 1998

## Legend

-  National Park
-  Conservation Park
-  Nature Reserve
-  State Forest, Timber Reserve, Freehold & Other Reserve
-  Section 5(g) Reserve
-  Leasehold in the name of the Executive Director
-  Marine Park / Marine Nat Res / Marine Management Area
-  CALM Region Boundary
-  CALM Regional Office

## Scale

0 100 200 300 400 Km

Projection: Polyconic, Origin 121°, 0°



**CALM**  
CONSERVATION and LAND MANAGEMENT

Produced by INFORMATION MANAGEMENT BRANCH

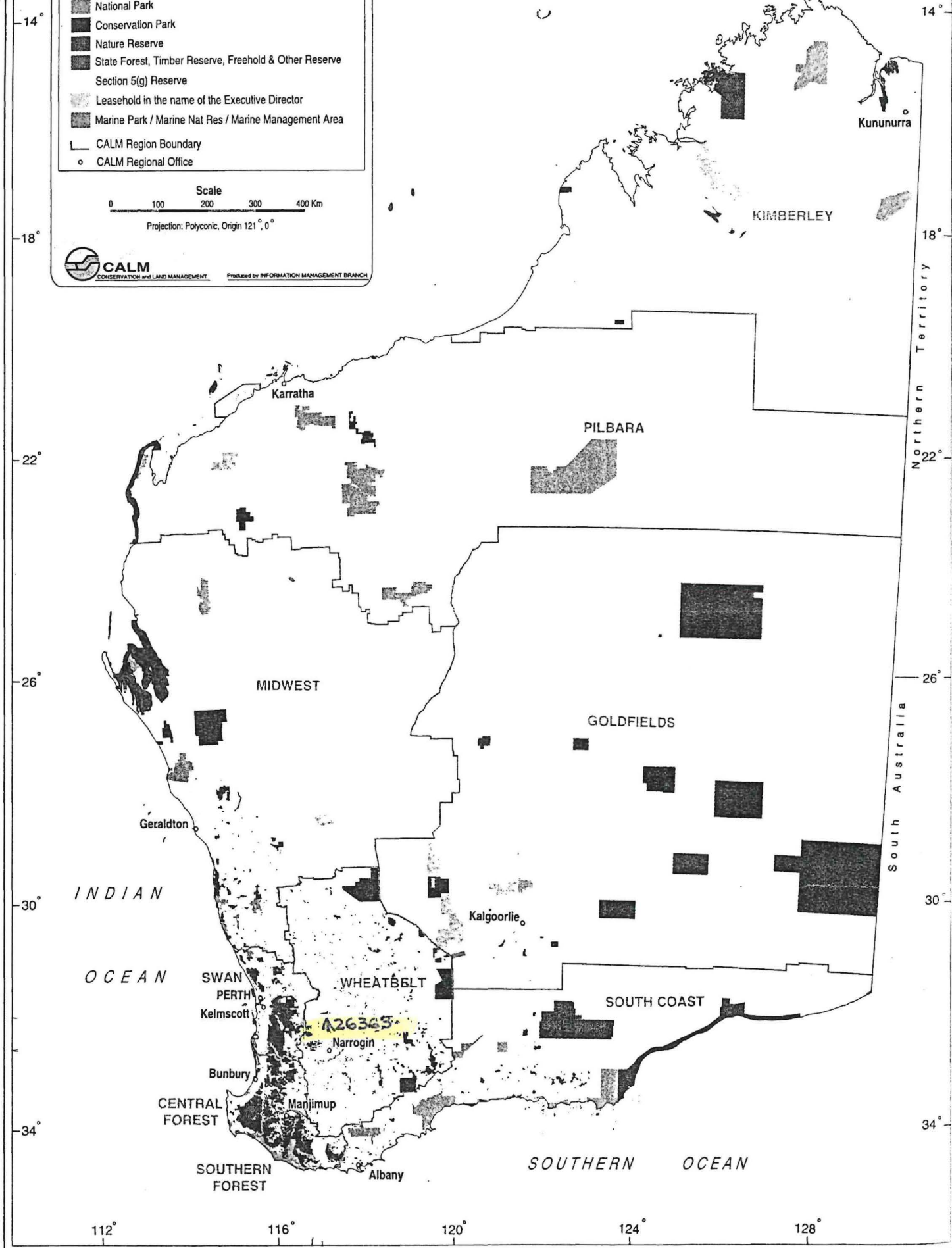

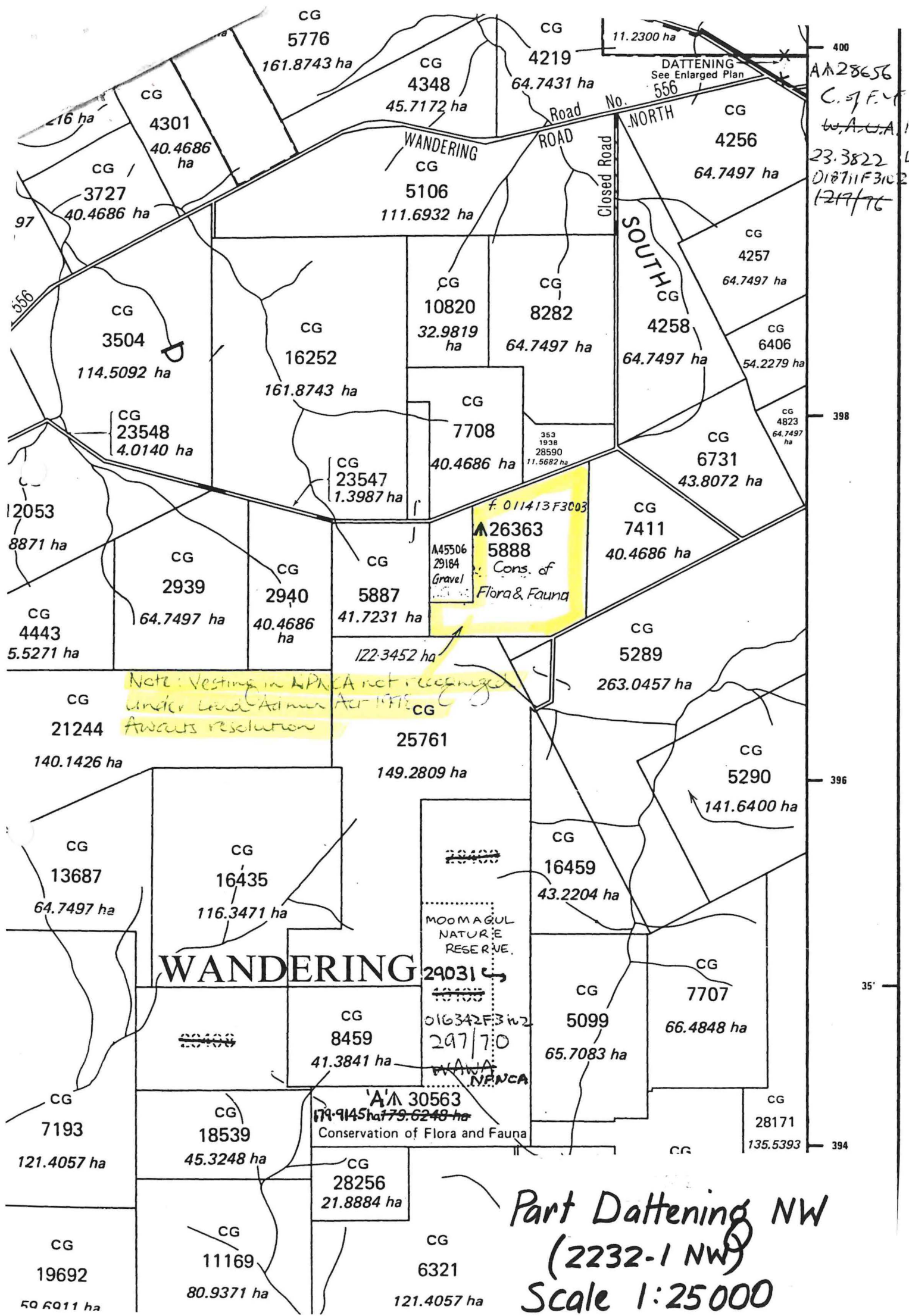

Note: Vesting in WPA not recognized under Land Admin Act 1975 Awaits resolution

AA28656  
C. J. F. W. A. W. A. N. F.  
23.3822 ha  
D18711F3102  
12/17/76

**26363**  
5888  
Cons. of  
Flora & Fauna

**WANDERING**

MOOMAGUL  
NATURE  
RESERVE

AA 30563  
179.9145 ha  
Conservation of Flora and Fauna

Part Dattening NW  
(2232-1 NW)  
Scale 1:25000