

NATURE RESERVE

RESERVE NO: 26664

GOVERNMENT GAZETTE  
Date Page No.

FILE NUMBER: 134/63

PURPOSE: Conservation of Flora and Fauna 15.3.63 864

NAME: Lake Dumbleyung

CLASS (Land Act):

AREA: 3958.5561ha 15.3.63 864

VESTING: W.A.W.A. 15.3.63 854

LOCATION NO(S): Williams

CLASSIFICATION:  
(Wildlife Act  
Section 12A)

LITHO: 408A/40, 408D/40

LOCAL AUTHORITY: DUMBLEYUNG & WAGIN SHIRES

Notes: X

Game Reserve

TO CHIEF CLERK WOODWALE  
FOR YOUR INFORMATION

Reserve No. 26664 (Williams District) "Conservation of Flora and Fauna" to comprise Location 15797 as delineated and shown bordered red on Land Administration Reserve Plan 427 and of its area being increased to about 4094 hectares accordingly.

Public Plan: BJ30(2) 30.28, Dumblebung SE, NE, & NW (25), Nippering Townsite.  
Local Authorities—Shires of Dumblebung and Wagin.  
Reserve 26664 is automatically vested in the National Parks and Nature Conservation Authority pursuant to Section 7 of the CALM Act 1984.  
DOLA File 1457/967.

Reserve No. 30342 (Cockburn Sound Location 2169) "Recreation" to include Location 4232 (formerly Lots 15 and 51 on Plans 13613 and 14232 respectively) and of its area being increased to 10.8776 hectares accordingly.  
Public Plans: BG32 (10) 3.7 and (2) 12.34, near Rodareda Crescent.  
Local Authority—Shire of Murray.  
DOLA File 3579/977.

Reserve No. 35489 (Margaret River Lot 170) "Public Recreation" to include Lot 257 (formerly Lot 391 on Plan 20997) and of its area being increased to 6349 square metres accordingly.  
Public Plan: BF29 (2) 10.01, Larch Loop and Oak Glen.  
Local Authority—Shire of Augusta-Margaret River.  
DOLA File 726/979.

Reserve No. 36240 (Bridgetown Lots 883 and 884) "Public Recreation" to include Lot 919 (formerly Lot 32 on diagram 64261) and of its area being increased to 5358 square metres accordingly.  
Public Plan: BG29 (2) 31.03, Orchard Close.  
Local Authority—Shire of Bridgetown-Greenbushes.  
DOLA File 1628/981

Reserve No. 37319 (Swan Location 10202) "Public Recreation" to include Swan Location 12582 (formerly Lot 273 on Diagram 54547) and of its area being recalculated (increased) to 2.8437 hectares accordingly.  
Section 20A  
Public Plan: BG34 (2) 23.30, Elder Street.  
Local Authority—Shire of Mundaring.  
DOLA File 2636/979

Reserve No. 38646 (Cockburn Sound Locations 2769 and 4119) to include Cockburn Sound Location 4239 (formerly Lot 296 on Plan 20759) and of its area being increased to 6.3219 hectares accordingly.  
Public Plan: BG33 (2) 05.27, Dargin Way.  
Local Authority—City of Rockingham.  
DOLA File 834/995

Reserve No. 43995 (Swan Location 12356) "Public Recreation" to include Swan Location 12605 (formerly Lot 83 on Plan 20777) and of its area being increased to 6.0760 hectares accordingly.  
Public Plan: BG34 (2) 24.34, Tatlock Way.  
Local Authority—Shire of Swan.  
DOLA File 415/995

Reserve No. 44177 (Swan Locations 12128 and 12129) to include Swan Location 12130 (formerly Lot 254 on Plan 14542) and of its area being increased to 2.9875 hectares accordingly.  
Section 20A  
Public Plan: BG34 (2) 12.36, Roding Court.  
Local Authority—City of Wanneroo.

A.A. SKINNER, Chief Executive.

LA901\*

LAND ACT 1933

Change of Purpose of Reserves

Made by His Excellency the Governor under Section 37.  
The purpose of the following reserves have been changed.  
DOLA File 5073/946  
Reserve No. 22617 (Yilgarn Location 1354) being changed from "Sheep Dip" to "Landscape Protection".  
Public Plan: WARRALAKIN (50), Stoneman Road.  
Local Authority—Shire of Westonia.

file - 2 - Mrs Collins - for your litho pls.  
GUM 25/10  
MAR  
2 10 96

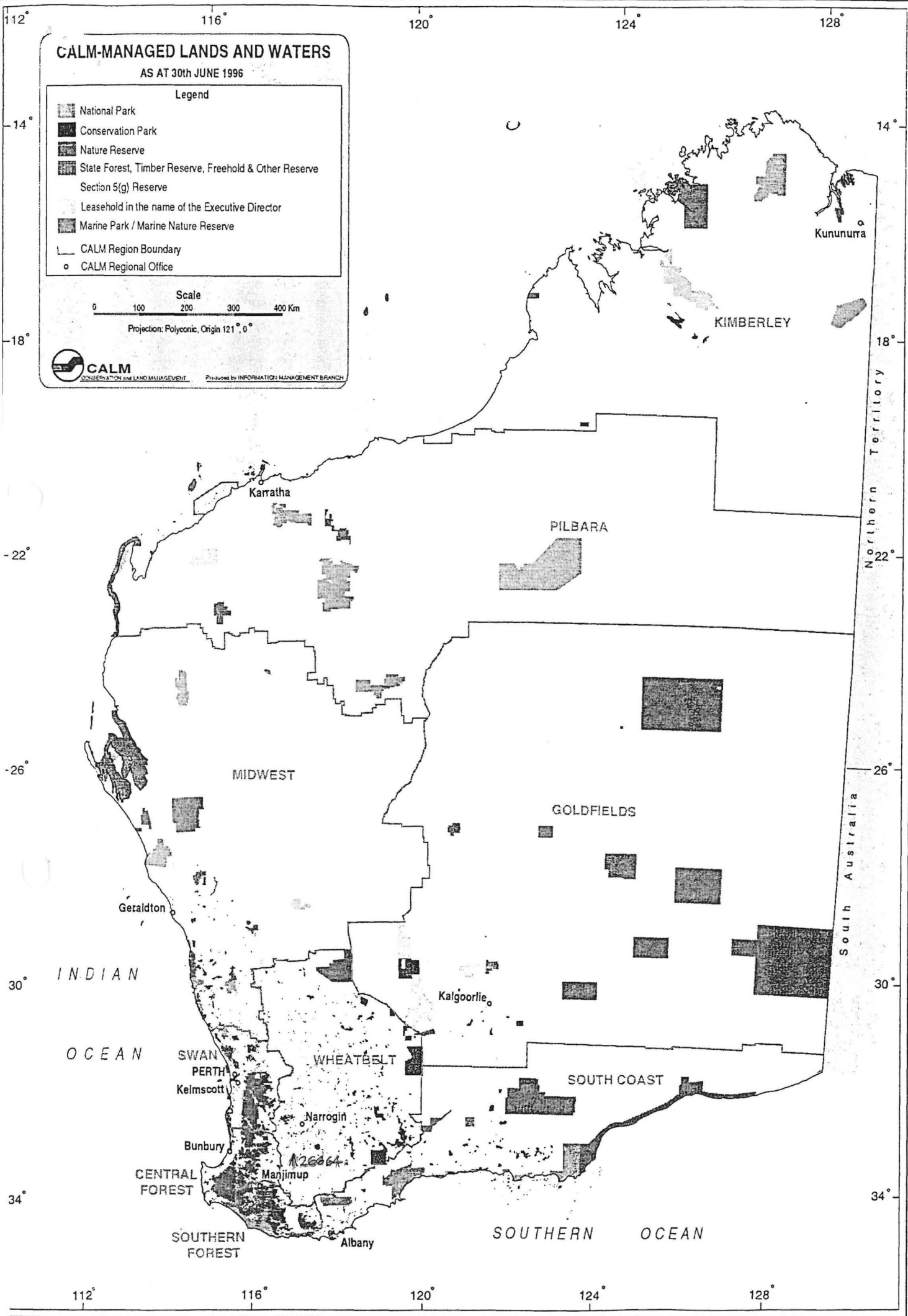

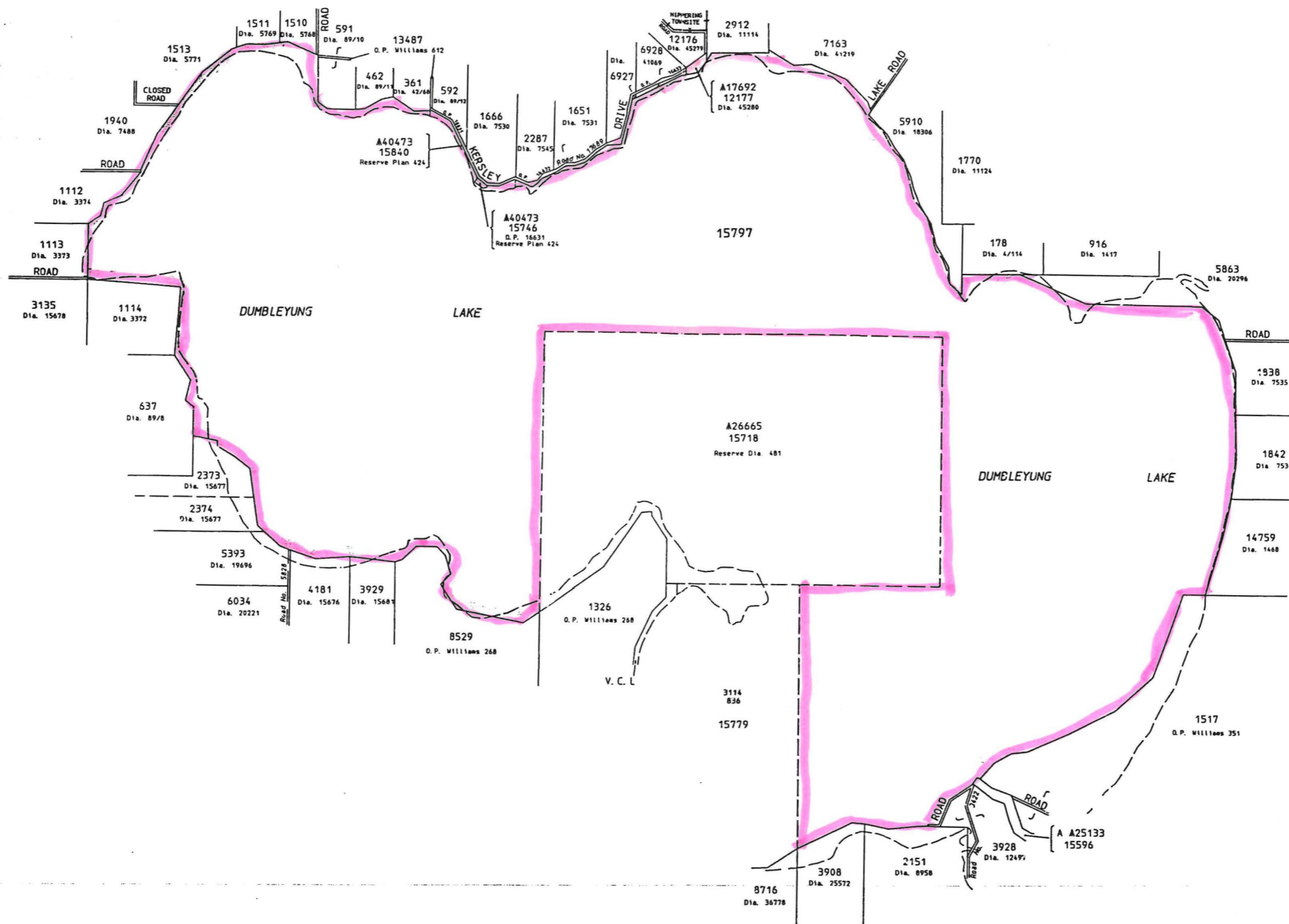

Also On Pt. Plans Dumbleyung NE, NW & SE  
1:25000

Water lines shown hereon do not necessarily depict an exact cadastral boundary  
Graphics have been derived from the D.O.L.A. Spatial Cadastral Data Base

RESERVE No. 26664 AREA abt. 4094 ha		FILE No. 1227/962 V2	DEPT. OF LAND ADMINISTRATION RESERVE PLAN No. 427															
Purpose Conservation of Flora & Fauna		SCALE 1:20000 All measurements in metres																
DISTRICT WILLIAMS		<table border="1"> <tr> <td>Registered</td> <td>Page</td> </tr> <tr> <td colspan="2">Recorded on Public Plan</td> </tr> <tr> <td>Registered</td> <td>Date 21/2/95</td> </tr> <tr> <td colspan="2">Per Manager Statutory Services</td> </tr> <tr> <td colspan="2">Survey Index Plan</td> </tr> <tr> <td colspan="2">DEPT. OF LAND ADMINISTRATION</td> </tr> <tr> <td colspan="2">RESERVE PLAN No. 427</td> </tr> </table>		Registered	Page	Recorded on Public Plan		Registered	Date 21/2/95	Per Manager Statutory Services		Survey Index Plan		DEPT. OF LAND ADMINISTRATION		RESERVE PLAN No. 427		
Registered	Page																	
Recorded on Public Plan																		
Registered	Date 21/2/95																	
Per Manager Statutory Services																		
Survey Index Plan																		
DEPT. OF LAND ADMINISTRATION																		
RESERVE PLAN No. 427																		
Public Plan DUMBLEYUNG S.E. N.E. & S.W. & 25000 Public Plan WILKINS DRIVE & 2500 8/26/94 20 Prepared by G. BALDRE Date 23/2/95 Checked <i>[Signature]</i> Date 1-3-1996 Approved <i>[Signature]</i> Date 1-3-95 Manager Statutory Services		<table border="1"> <tr> <th colspan="3">SUBJECT TO SURVEY AMENDMENTS</th> </tr> <tr> <th>Gozette</th> <th>Page</th> <th>Initials</th> </tr> <tr> <td> </td> <td> </td> <td> </td> </tr> <tr> <td> </td> <td> </td> <td> </td> </tr> <tr> <td> </td> <td> </td> <td> </td> </tr> </table>		SUBJECT TO SURVEY AMENDMENTS			Gozette	Page	Initials									
SUBJECT TO SURVEY AMENDMENTS																		
Gozette	Page	Initials																

