

NATURE RESERVE

RESERVE NO: 28471

GOVERNMENT GAZETTE  
Date Page No.

FILE NUMBER: 429/66

PURPOSE: Conservation of Flora  
and Fauna 10.3.67 699

NAME: Wingedyne

CLASS (Land Act):

AREA: 253.7379 ha

VESTING: W.A.W.A. 11.2.72 269

LOCATION NO(S): Kojonup 8231, 8427, 8428

CLASSIFICATION:  
(Wildlife Act  
Section 12A)

LITHO: 416/80 D1 & Woodanilling 1:50 000

LOCAL AUTHORITY: WOODANILLING SHIRE

Notes:

015 781 F 318.2 1466 5101

9A

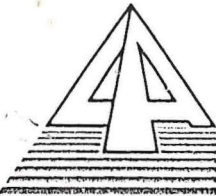

Department of  
**LAND ADMINISTRATION**

Your Ref:

Our Ref: 1900/984 CC:LW

Telephone: 323 1614 C. CARROLL  
Enquiries:

NATIONAL PARKS AND NATURE  
CONSERVATION AUTHORITY  
50 HAYMAN ROAD  
COMO WA 6152

Department of Conservation  
and Land Management  
5 SEP 1989  
COMO WA

DEPARTMENT OF CONSERVATION  
AND LAND MANAGEMENT  
7 JUN 1989  
COMO WA

Sent direct

Dear Sir

I advise for your information that Executive Council has:-

1. Issued an Order in Council revoking the Orders in Council whereby Reserve No's. 27384, 27387, 27452, 27837, 28047, 28313, 28317, 28318, 28319, 28471, 28940, 29012, 29018, 29019, 29020, 29021, 29022, 29023, 29025, 29026, 29027, 29303, 29322, 29326, 29576, 29589, 29680, 29810, 30430, 30469, 30516, 30903, 30969, 31561, 31742, 31743, 31744, 31799, 31908, 31909, 31913, 32129, 32130, 32131, 32549, 32776, 32783, 32864, 32865, 32993, and 32995 were vested in the Western Australian Wildlife Authority in trust for the purpose of "Conservation of Flora and Fauna" and approve the cancellation of the relevant Vesting Orders accordingly.
2. Issued a Proclamation classifying as of Class "A" Reserve No's. 19784, 21424, 23029, 23085, 27384, 27386, 27387, 27452, 27769, 27837, 28047, 28313, 28317, 28318, 28319, 28471, 28669, 28759, 28846, 28940, 29012, 29018, 29019, 29020, 29021, 29022, 29023, 29025, 29026, 29027, 29303, 29322, 29326, 29576, 29589, 29680, 29810, 30430, 30469, 30516, 30903, 30969, 31561, 31742, 31743, 31744, 31799, 31908, 31909, 31913, 32129, 32130, 32131, 32549, 32776, 32783, 32864, 32865, 32993, 32995, 39379, 39404 and 39465 "Conservation of Flora and Fauna".
3. Issued an Order in Council directing that Class "A" Reserve No's. 27384, 27387, 27452, 27837, 28047, 28313, 28317, 28318, 28319, 28471, 28940, 29012, 29018, 29019, 29020, 29021, 29022, 29023, 29025, 29026, 29027, 29303, 29322, 29326, 29576, 29589, 29680, 29810, 30430, 30469, 30516, 30903, 30969, 31561, 31742, 31743, 31744, 31799, 31908, 31909, 31913, 32129, 32130, 32131, 32549, 32776, 32783, 32864, 32865, 32993, and 32995 shall vest in and be held by the National Parks and Nature Conservation Authority in trust for the purpose of "Conservation of Flora and Fauna".

1. file

../2.

2. LANDS CLERK

95  
BL

28471

Notice to this effect was published in the Government Gazette of May 5, 1989 and I enclose the relevant Vesting Orders.

Would you please return to this Office the superseded Vesting Orders for cancellation.

Yours faithfully

*Clawell*

*J* P. COYNE  
MANAGER  
PROPERTY MANAGEMENT BRANCH  
LAND OPERATIONS DIVISION

June 2, 1989

Enc.

PM151LW1

CLERK, WOODVALE - F.Y.E.

with the advice and consent of Executive Council do by this my Proclamation classify as of Class "A" the reserve described in the schedule.

## Schedule

File Number; Reserve Number; Land Description; Area (hectares); Plan.

- 2106/66—33113; Fitzgerald Locations 1589, 1622 and 1623; 8859.5543; 392/80.
- 100/73—33828; Charlie Island; Indeterminable; Edel 1:250 000.
- 3270/06—33842; All those portions of land delineated and bordered red on Lands and Surveys Reserve Plan No. 35 including Hay Locations 788, 158, 216, 113, 110, 111, 142, 692 and 1724 to 1734 (inclusive) together with Plantagenet Locations 1598, 1209, 4367 and 3123 and excluding roads; 3825.4123; Parry Inlet NW & NE and Owingup SW 1:25 000.
- 2361/70—33854; Ninghan Location 4189; 19.5084; 65/80.
- 4281/74—34197; Jilbadji Location 936; 637.4387; 23/80.
- 3265/72—34257; Swan Island; about 29.0322; Yampi 1:250 000.
- 2043/67—34295; Roe Location 2688; 929.0621; 346/80.
- 5433/27—35217; Ninghan Locations 4206 and 4207; 70.1177; 65/80.
- 1375/28—35413; Avon Location 25238; 592.1195; Trayning 1:50 000 and Kodi Kodjin 1:50 000.
- 3736/11—35428; Plantagenet Locations 7412 and 7427; about 97.1726; Tambellup SE 1:25 000.
- 681/52—35621; Denmark Lot 352; 12.3176; Denmark 1:2 000 20.12 and 20.13.
- 3268/72—36056; Rocky Islets; about 40.9500; 422/80.
- 3624/78—36183; Esperance Location 1873; 357.5296; 402/80 and 403/80.
- 1472/78—36334; Pintharuka Lot 37; 61.5892; Pintharuka Townsite.
- 1604/69—36550; Plantagenet Location 7453; 174.0938; Two Peoples Bay NE 1:25 000.
- 3946/77—36608; Fitzgerald Location 1649; 80.6128; Dowak Townsite.
- 3379/980—36967; Kent Location 2042; 145.8710; 418/80.
- 2534/980—37054; Williams Location 15700; 16.3127; Congelin SW 1:25 000.
- 1817/70—37316; Victoria Location 10572; about 60.7028; Wongoondy NW 1:25 000.
- 1237/983—38296; Avon Location 28716; 143.9107; Norpa 1:50 000 and 24/80.
- 800/982—38334; Neridup Location 484; 407.8176; 400/80.
- 573/26—38415; Wellington Location 2642; 40.4686; Muja SE 1:25 000.
- 1747/983—38522; Yarding Lot 37; 69.2599; Yarding Townsite.
- 2788/983—38544; Neridup Location 495; 839.0247; 400/80.
- 3245/982—38545; Neridup Location 488; 1670.5074; 400/80.
- 4340/29—38574; Ninghan Location 4237; 92.1582; Beacon 1:50 000.
- 1108/17—38578; South Kumminin Lot 37 and Avon Location 19666; 81.2932; South Kumminin Townsite.
- 6850/10—38703; Amery Lot 31; 70.2161; Amery Townsite.
- 3097/983—38800; Yilgarn Location 1517; 66.3183; 54/80.
- 2496/28—39038; Ninghan Location 2790; 185.1051; Newcarlbeon NW 1:25 000.

Given under my hand and the Public Seal of Western Australia, at Perth, on 18 April 1989.

By His Excellency's Command,  
E. K. HALLAHAN,  
Minister for Lands.

GOD SAVE THE QUEEN !

Land Act 1933

## PROCLAMATION

WESTERN AUSTRALIA } By His Excellency Professor Gordon Reid, Com-  
GORDON REID, } panion of the Order of Australia, Governor of the  
Governor. } State of Western Australia.  
[L.S.]

File No. 1900/984.

WHEREAS by section 31 (2) of the Land Act 1933, the governor may by Proclamation cancel the reservation of any land classified as of Class "B"; and whereas it is deemed expedient that the Reserves described and listed in the attached Schedule for the purpose of "Conservation of Flora and Fauna" should be cancelled: Now therefore, I, the Governor, with the advice and consent of Executive Council do by this my Proclamation cancel the reservation as of Class "B" the land described in the Schedule.

## Schedule

File numbers; Reserve numbers; Land Description; Area (hectares); Plan.

- 1389/67—29253; North, Middle and South Cervantes Islands; about 4000; Cervantes Regional.
- 1392/67—29256; Fisherman Islands—North and South Islands; about 5.2419; Greenhead and Hill River 1:50 000.
- 1393/67—29257; North, Middle and South Essex Rocks and other unnamed Rocks; about 7.2580; Boullanger and Hill River 1:50 000.
- 1394/67—29258; Outer Rocks; indeterminable; Boullanger and Hill River 1:50 000.
- 1395/67—29259; Milligan, Lipfert, Webb and Snag Islands, Drummond and Orton Rocks; about 6.3709; Greenhead and Lesueur 1:50 000.
- 1396/67—29260; Ronsard Rocks; indeterminable; Boullanger and Hill River 1:50 000.

Given under my hand and the Public Seal of Western Australia, at Perth, on 18 April 1989.

By His Excellency's Command,  
E. K. HALLAHAN,  
Minister for Lands.

GOD SAVE THE QUEEN !

Land Act 1933

## PROCLAMATION

WESTERN AUSTRALIA } By His Excellency Professor Gordon Reid, Com-  
GORDON REID, } panion of the Order of Australia, Governor of the  
Governor. } State of Western Australia.  
[L.S.]

File No. 1900/984.

WHEREAS by Section 31 (1) (a) of the Land Act 1933, the Governor may by Proclamation and subject to such conditions as may be expressed therein classify as of Class "A" any such lands of the Crown reserved to Her Majesty for any purpose; and whereas it is deemed expedient that the reserves listed in the attached schedule for the purpose of "Conservation of Flora and Fauna" as described, should be classified as of Class "A": Now, therefore I, the Governor, with the advice and consent of Executive Council do by this my Proclamation classify as of Class "A" the reserve described in the attached schedule.

## Schedule

File numbers; Reserve numbers; Land Description; Area (hectares); Plan.

- 466/28—19784; Wellington Location 4003; 40.4737; Blackwood River S.W. and N.W. 1:25 000.
- 7129/23—21424; Avon Location 23508; 153.7805; Lomos N.W. 1:25 000.
- 5160/49—23029; Ninghan Location 1311; 161.5202; Mollerin 1:50 000.
- 1742/50—23085; Avon Location 28907; 78.2856; Yorkrakine S.E. 1:25 000.
- 3579/64—27384; Neridup Location 218; 604.7327; Burdett 1:50 000.
- 3584/64—27386; Neridup Location 271; 1417.2235; 402/80.
- 3585/64—27387; Neridup Location 286; 812.2041; Burdett 1:50 000.
- 140/63—27452; Avon Location 28192; 39.4973; Bruce Rock 1:50 000.

23-5-89  
I. Lands



92.  
B.L.

015781F3102

- 4812/01—27769; Kojonup Location 9155; 46.1657; Boscabel S.E. 1:25 000.
- 245/66—27837; Roe Locations 1120, 2142 and 2972; about 2154; 375/80.
- 479/61—28047; Roe Location 1401; 628.2922; Lake Liddelow 1:50 000.
- 2802/66—28313; Victoria Locations 9328 and 10803; 928.9585; 155/80.
- 2562/66—28317; Avon Location 24828; 26.4134; Quairading N.E. 1:25 000.
- 3089/66—28318; Avon Locations 14447, 25418 and 26575; 55.5102; Quairading N.E. 1:25 000.
- 3090/66—28319; Avon Location 13181; 40.4762; Quairading N.E. 1:25 000.
- 1267/64—28471; Kojonup Locations 8231, 8427 and 8428; about 253.7379; Boscabel N.E. 1:25 000.
- 1491/67—28669; Victoria Location 10955; 157.7338; Marchagee 1:50 000.
- 4013/66—28759; Roe Locations 971 and 1176; 397.2774; Magenta and Newdegate 1:50 000.
- 2922/67—28846; Esperance Location 1886; 56.0236; Bostock Swamp 1:50 000.
- 2714/46—28940; Jilbadji Locations 913, 969 and 975; 4377.3492; 24/80.
- 1607/66—29012; Esperance Location 1876; 1403.5257; Scadden 1:50 000.
- 177/68—29018; Roe Location 2601; 1659.7650; Lake Bidy 1:50 000.
- 178/68; 29019; Roe Location 2602; 3322.8966; Lake Bidy 1:50 000.
- 2162/67—29020; Roe Location 2603; 1527.6377; Lake Bryde 1:50 000.
- 2163/67—29021; Roe Location 2604; 107.0520; Lake Bryde 1:50 000.
- 2164/67—29022; Roe Location 2606; about 50.0000; Lake Bryde 1:50 000.
- 2165/67—29023; Roe Location 2607; 1528.8492; Lake Bryde 1:50 000.
- 2167/67—29025; Roe Location 2609; 206.9158; Burngup 1:50 000.
- 2168/67—29026; Roe Location 2874; 32.3445; Lake Bryde 1:50 000.
- 210/68—29027; Roe Locations 2487 and 2488; 1251.9721; 375/80.
- 1389/67—29253; North, Middle and South Cervantes Islands; about 4.0000; Cervantes Regional.
- 1392/67—29256; Fisherman Islands—North and South Islands; about 5.2419; Greenhead and Hill River 1:50 000.
- 1393/67—29257; North, Middle and South Essex Rocks and other unnamed rocks; about 7.2580; Boullanger and Hill River 1:50 000.
- 1394/67—29258; Outer Rocks; indeterminable; Boullanger and Hill River 1:50 000.
- 1395/67—29259; Milligan, Lipfert, Webb and Snag Islands, Drummond and Orton Rocks and adjacent unnamed rocks; about 6.3709; Greenhead and Lesueur 1:50 000.
- 1396/67—29260; Ronsard Rocks; indeterminable; Boullanger and Hill River 1:50 000.
- 222/67—29303; Ninghan Location 4180; about 194.2491; Blain 1:50 000.
- 570/17—29322; Avon Locations 6777, 13007, 15043 and 28696; 221.5533; Brookton 1:50 000.
- 2254/68—29326; Nugadong Lot 39; about 8.4352; Nugadong 1:2 000 20.19.
- 2541/68—29576; Roe Location 2753; 511.6416; Gulson 1:50 000.
- 4634/65—29589; Williams Location 15538; 40.4686; Yilliminning N.W. 1:25 000.
- 2456/25—29680; Red Lake Lots 33, 34, 37 and 38; 76.0624; Red Lake Townsite.
- 2516/67—29810; Roe Location 2949; about 1133.1198; Lake Liddelow 1:50 000.
- 2716/46—30430; Yilgarn Location 1477; 120.3257; Boodarockin 1:50 000.
- 1708/70—30469; Plantagenet Location 7532; 10.3792; Albany 1:2 000 13.14 and 14.14.
- 2712/46—30516; Avon Location 27093; 106.2198; Norpa 1:50 000.
- 11956/10—30903; Kwolyin Agricultural Area Lot 420; 11.4324; Pantapin N.E. 1:25 000.
- 2633/21—30969; Kwolyin Agricultural Area Lots 344 and 345; 283.0043; Kwolyin 1:50 000.
- 1187/61—31561; Denmark Estate Lot 346; 52.3056; Denmark Regional North.
- 1739/72—31742; Oldfield Location 1240; 1179.3830; 403/80.
- 1740/72—31743; Oldfield Locations 1122 and 1262; 95.6854; 403/80.
- 1741/72—31744; Oldfield Location 1123; 288.3031; 403/80.
- 2488/72—31799; Neridup Locations 360, 362 and 381; 3617.5380; Lilliecrona 1:50 000.
- 3263/72—31908; Shelter Island; about 10.0000; Torbay N.E. and S.E. 1:25 000.
- 3256/72—31909; Glasse Island; about 4.0000; 447/80.
- 4489/57—31913; Wellington Locations 4010, 4663 and 5141; 1161.2125; Blackwood River N.E. and N.W. 1:25 000.
- 412/73—32129; Neridup Location 337; 1751.5680; 424/80.
- 411/73—32130; Neridup Location 334; 2480.5458; 424/80.
- 413/73—32131; Neridup Location 342; 1057.6586; 424/80.
- 900/70—32549; Roe Locations 1229, 2976, 3046 and 3072; 3619.0744; Eclipse Lake 1:50 000.
- 1638/74—32776; Neridup Location 404; 4732.1055; 401/80.
- 1645/74—32783; Neridup Location 436; 7082.1326; 401/80.
- 1117/68—32864; Yilgarn Locations 1462 and 1463; 1436.9125; 67/80.
- 2332/988—32865; Yilgarn Location 1465; 579.1684; 67/80.
- 569/69—32993; Ninghan Location 4226; 43.5838; 54/80.
- 2535/72—32995; Jilbadji Location 928; 1886.0468; Holleton 1:50 000.
- 3195/985—39379; Kulyaling Lots 59 and 60; 17.2617; Kulyaling Townsite.
- 1859/985—39404; Murray Location 1805; 184.3700; Mandurah 1:10 000 1.4 and 1.5 and 1:25 000 S.E.
- 1272/986—39465; Sussex Location 4557; 15.9522; Leeuwin N.W. 1:25 000.

Given under my hand and the Public Seal of Western Australia, at Perth, on 18 April 1989.

By His Excellency's Command,  
E. K. HALLAHAN,  
Minister for Lands.

GOD SAVE THE QUEEN !

Land Act 1933  
PROCLAMATION

WESTERN AUSTRALIA } By His Excellency Professor Gordon Reid, Com-  
GORDON REID, } panion of the Order of Australia, Governor of the  
Governor. } State of Western Australia.  
[L.S.]

File No. 1900/984.

WHEREAS by section 31 (1) (a) of the Land Act 1933, the Governor may by Proclamation and subject to such conditions as may be expressed therein classify as of Class "A" any such lands of the Crown reserved to Her Majesty for any purpose; and whereas it is deemed expedient that the reserves listed in the attached schedule for the purpose of "Conservation of Flora and Fauna" as described, should be classified as of Class "A": now, therefore I, the Governor, with the advice and consent of Executive Council do by this my Proclamation classify as of Class "A" the reserve described in the attached schedule.

Schedule

File No.; Reserve No.; Land Description; Area (hectares); Plan.

6134/97—4313; Avon Location 24527; 43.7060; Quelagetting 1:50 000.

8947/96—8830; Avon Location 28513; 23.9117; Cunderdin 1:50 000.

3261/14—15564; Avon Location 9421; about 16.9968; Bencubbin 1:50 000.

2769/54—15570; Avon Location 20307; 40.4686; Lake Wallambin S.E. 1:25 000.

6370/14—16136; Torbay Agricultural Area Lot 183; 15.7777; Torbay N.W. and S.W. 1:25 000.

1979 at pages 3079-3080 and varied from time to time thereafter by inserting in the Schedule, after Part 15, the following Part—

Part 16

All that portion of land bounded by lines starting from the southernmost southwestern corner of Paraburdoo Lot 6, as surveyed and shown on Department of Land Administration Original Plan 16987, and extending generally northeasterly and generally easterly along southeastern and southern boundaries of that lot to the prolongation northerly of the eastern side of Robe Avenue; thence southerly to and along that side and onwards to a northwestern boundary of the southeastern severance of Windell Location 30; thence generally southwesterly, generally westerly, northwesterly and northeasterly along boundaries of that severance to a south-western side of Camp Road; thence generally northwesterly and generally southwesterly along sides of that road to an eastern side of Beasley Road and thence northerly and generally northwesterly along sides of that road to the starting point.

(Department of Land Administration Public Plans Paraburdoo Regional and Paraburdoo 2000 02.34, 03.34, 03.35, 04.34 and 04.35. "

Given under my hand and the Seal of the State on 2 May 1989.

By His Excellency's Command,

KAY HALLAHAN,  
Minister for Local Government.

GOD SAVE THE QUEEN !

At a Meeting of the Executive Council held in the Executive Council Chamber, at Perth, this 18th day of April 1989, the following Orders in Council were authorised to be issued.

Child Welfare Act 1947

ORDER IN COUNCIL

WHEREAS by section 19 (2) (a) of the Child Welfare Act 1947 it is provided that the Governor may appoint such persons, male or female, as he may think fit, to be members of any particular Children's Court and may determine the respective seniorities of such members and whereas by section 19 (1) (b) (ii) of the said Act the Governor may amend, vary or revoke any such appointment: Now therefore His Excellency the Governor by and with the advice and consent of the Executive Council hereby appoints the person named in the First Schedule hereto to be a member of the Children's Court at the place mentioned and hereby revokes the appointment of the persons named in the Second Schedule hereto to be members of the Children's Court at the place mentioned.

First Schedule

Newman—Rhonda Diane Chapman.

Second Schedule

Newman—

Peter John Alfred Collins.  
Elizabeth Margaret Jayes.

G. PEARCE,  
Clerk of the Council.

Child Welfare Act 1947

ORDER IN COUNCIL

WHEREAS by section 19 (2) (a) of the Child Welfare Act 1947 it is provided that the Governor may appoint such persons, male or female, as he may think fit, to be members of any particular Children's Court and may determine the respective seniorities of such members, and whereas by section 19 (1) (b) (ii) of the said Act the Governor may amend, vary or revoke any such appointment: Now therefore His Excellency the Governor by and with the advice and consent of the Executive Council hereby revokes the appointment of the person named in the Schedule hereto as a member of the Children's Court at the place mentioned.

Schedule

Norseman—Betty Logan.

G. PEARCE,  
Clerk of the Council.

Child Welfare Act 1947

ORDER IN COUNCIL

WHEREAS by section 19 (2) (a) of the Child Welfare Act 1947 it is provided that the Governor may appoint such persons, male or female, as he may think fit, to be members of any particular Children's Court and may determine the respective seniorities of such members and whereas by section 19 (1) (b) (ii) of the said Act the Governor may amend, vary or revoke any such appointment: Now therefore His Excellency the Governor by and with the advice and consent of the Executive Council hereby appoints the persons named in the First Schedule hereto to be members of the Children's Court at the place mentioned and hereby revokes the appointment of the persons named in the Second Schedule hereto to be members of the Children's Court at the place mentioned.

First Schedule

Onslow—

Maisie Hyland.  
John Hayes.  
Elsie Lavinia Munro.

Second Schedule

Onslow—

Alec Francis Tucker.  
Kevin Zanetti.

G. PEARCE,  
Clerk of the Council.

Land Act 1933

ORDERS IN COUNCIL

WHEREAS by section 33 of the Land Act 1933, it is made lawful for the Governor to direct that any Reserve shall vest in and be held by any person or persons to be named in the order in trust for the like or other public purposes to be specified in such order: And whereas it is deemed expedient as follows—

File No. 1900/984.—That Class "A" Reserves 17946, 18340, 18342, 18381, 18950, 19036, 19093, 19916, 19118, 19650, 20262, 20479, 20482, 20834, 21056, 21153, 21230, 21830, 21981, 22792, 23008, 23141, 23156, 23171, 23316, 23325, 23566, 23665, 23934, 24532, 24534, 24677, 24835, 24891, 24912, 24944, 24979, 25112, 25546, 25809, 26196, 26266, 26403, 26508, 26564, 26569, 26661, 26687, 26792, 26809, 26819, 27108, 27146, 27219, 27283 and 27354, should vest in and be held by the National Parks and Nature Conservation Authority in trust for the purpose of "Conservation of Flora and Fauna".

File No. 1900/984.—That Class "A" Reserves 27384, 27387, 27452, 27837, 28047, 28313, 28317, 28318, 28319, 28471, 28940, 29012, 29018, 29019, 29020, 29021, 29022, 29023, 29025, 29026, 29027, 29253, 29256, 29257, 29258, 29259, 29260, 29303, 29322, 29326, 29576, 29589, 29680, 29810, 30430, 30469, 30516, 30903, 30969, 31561, 31742, 31743, 31744, 31799, 31908, 31909, 31913, 32129, 32130, 32131, 32549, 32776, 32783, 32864, 32865, 32993 and 32995, should vest in and be held by the National Parks and Nature Conservation Authority in trust for the purpose of "Conservation of Flora and Fauna".

File No. 1900/984.—That Class "A" Reserves 33113, 33828, 33842, 33854, 34197, 34257, 34295, 35217, 35413, 35428, 35621, 36056, 36183, 36334, 36550, 36608, 36967, 37054, 37316, 38296, 38334, 38415, 38522, 38544, 38545, 38574, 38578, 38703, 38800 and 39038, should vest in and be held by the National Parks and Nature Conservation Authority in trust for the purpose of "Conservation of Flora and Fauna".

File No. 2745/21.—That Class "A" Reserve No. 17826 (Perth Lots S35, 66, 461, 732 and portion of Lot 567) should vest in and be held by the City of Perth in trust for the purpose of "Park Gardens and Parking".

File No. 169/64.—That Class "A" Reserve No. 27139 (Plantagenet Location 5961) should vest in and be held by the National Parks and Nature Conservation Authority in trust for the purpose of "Conservation of Flora and Fauna".

File No. 296/61.—That Class "A" Reserve No. 28167 (Peel Estate Lots 26 and 442) should vest in and be held by the National Parks and Nature Conservation Authority in trust for the purpose of "Conservation of Flora and Fauna".

File No. 1875/960.—And whereas by Order in Council dated 11 May, 1977, Reserve No. 25766 was vested in the Shire of Kalamunda in trust for the purpose of "Municipal Purposes".

File No. 7917/12.—And whereas by Order in Council dated 1 February, 1962, Reserve No. 26205 was vested in the Minister for Native Welfare in trust for the purpose of "Native Housing".

File No. 169/64.—And whereas by Order in Council dated 24 February, 1966, Reserve 27139 was vested in the Fauna Protection Advisory Committee of Western Australia in trust for the purpose of "Conservation of Flora and Fauna".

File No. 296/61.—And whereas by Order in Council dated 29 June, 1966, Reserve 28167 was vested in the Fauna Protection Advisory Committee of Western Australia in trust for the purpose of "Conservation of Flora and Fauna".

File No. 1060/73.—And whereas by Order in Council dated 16 May, 1973, Reserve 32017 was vested in the Minister of Water Supply Sewerage and Drainage in trust for the purpose of "Water Supply".

File No. 1528/79.—And whereas by Order in Council dated 20 February, 1980, Reserve 36519 was vested in the Western Australian Wildlife Authority in trust for the purpose of "Conservation of Flora and Fauna".

File No. 2592/79.—And whereas by Order in Council dated 29 October, 1980, Reserve 36943 was vested in the City of Stirling in trust for the purpose of "Recreation".

File No. 2831/982.—And whereas by Order in Council dated 30 September, 1983, Reserve 38477 was vested in the Shire of Wyndham-East Kimberley in trust for the purpose of "Aged Persons Homes".

File No. 2056/985.—And whereas by Order in Council dated 27 August, 1985, Reserve 39189 was vested in the Shire of Kent in trust for the purpose of "Recreation (Go Kart Racing)" with power, subject to the approval in writing of the Minister for Lands being first obtained, to lease the whole or any portion thereof for any term not exceeding twenty one (21) years from the date of the lease.

File No. 1900/984.—And whereas by Order in Council issued on dates specified in the attached Schedule the respective Reserves were vested in the Western Australian Wildlife Authority in trust for the purpose of "Conservation of Flora and Fauna".

Schedule  
Reserve Nos; Date of Order in Council.

4313	November 21, 1980.
8830	November 5, 1975.
15564	August 2, 1983.
15570	May 1, 1980.
16136	April 29, 1981.
16235	July 5, 1983.
16293	March 6, 1984.
16346	May 24, 1978.
16412	May 28, 1980.
16493	October 29, 1980.
16683	June 21, 1983.
17055	April 8, 1970.
17257	April 8, 1970.
17771	May 31, 1983.
17778	June 29, 1981.

File No. 1900/984.—And whereas by Orders in Council issued on dates specified in the attached Schedule the respective Reserves were vested in the Western Australian Wildlife Authority in trust for the purpose of "Conservation of Flora and Fauna".

Schedule  
Reserve Nos; Order in Council Date.

27384	August 3, 1981.
27387	July 5, 1983.
27452	September 18, 1979.
27837	July 11, 1973.
28047	August 26, 1981.
28313	July 9, 1980.
28317	May 1, 1980.
28318	May 13, 1980.
28319	May 13, 1980.
28471	January 26, 1972.
28940	November 8, 1983.

29012	August 2, 1983.
29018	February 4, 1970.
29019	February 4, 1970.
29020	January 14, 1970.
29021	February 4, 1970.
29022	January 14, 1970.
29023	January 14, 1970.
29025	February 4, 1970.
29026	February 4, 1970.
29027	November 21, 1980.
29253	November 9, 1978.
29256	November 9, 1978.
29257	November 9, 1978.
29258	November 9, 1978.
29259	November 9, 1978.
29260	November 9, 1978.
29303	May 1, 1980.
29322	May 1, 1984.
29326	October 1, 1980.
29576	October 25, 1983.
29589	July 5, 1983.
29680	April 15, 1971.
29810	November 12, 1969.
30430	July 9, 1980.
30469	July 19, 1983.
30516	July 5, 1983.
30903	August 8, 1979.
30969	September 5, 1979.
31561	August 2, 1983.
31742	August 30, 1983.
31743	June 29, 1981.
31744	July 5, 1983.
31799	May 16, 1983.
31908	March 21, 1973.
31909	March 21, 1973.
31913	March 6, 1984.
32129	September 30, 1983.
32130	September 30, 1983.
32131	July 19, 1983.
32549	November 21, 1980.
32776	July 17, 1974.
32783	July 17, 1974.
32864	May 3, 1983.
32865	May 3, 1983.
32993	May 3, 1983.
32995	November 27, 1974.

File No. 1900/984.—And whereas by Orders in Council issued on dates specified in the attached schedule the respective Reserves were vested in the Western Australian Wildlife Authority in trust for the purpose of "Conservation of Flora and Fauna".

Schedule  
Reserve Nos; Date of Order in Council.

33113	January 22, 1975.
33828	January 14, 1976.
33842	January 28, 1976.
33854	January 28, 1976.
34197	August 11, 1976.
34257	September 8, 1976.
34295	August 3, 1981.
35217	August 3, 1978.
35413	July 5, 1978.
35428	July 19, 1983.
35621	August 2, 1983.
36056	May 2, 1979.
36183	July 11, 1979.
36334	October 17, 1979.
36550	March 5, 1980.
36608	February 18, 1981.
36967	November 14, 1980.
37054	August 2, 1983.
37316	August 3, 1981.

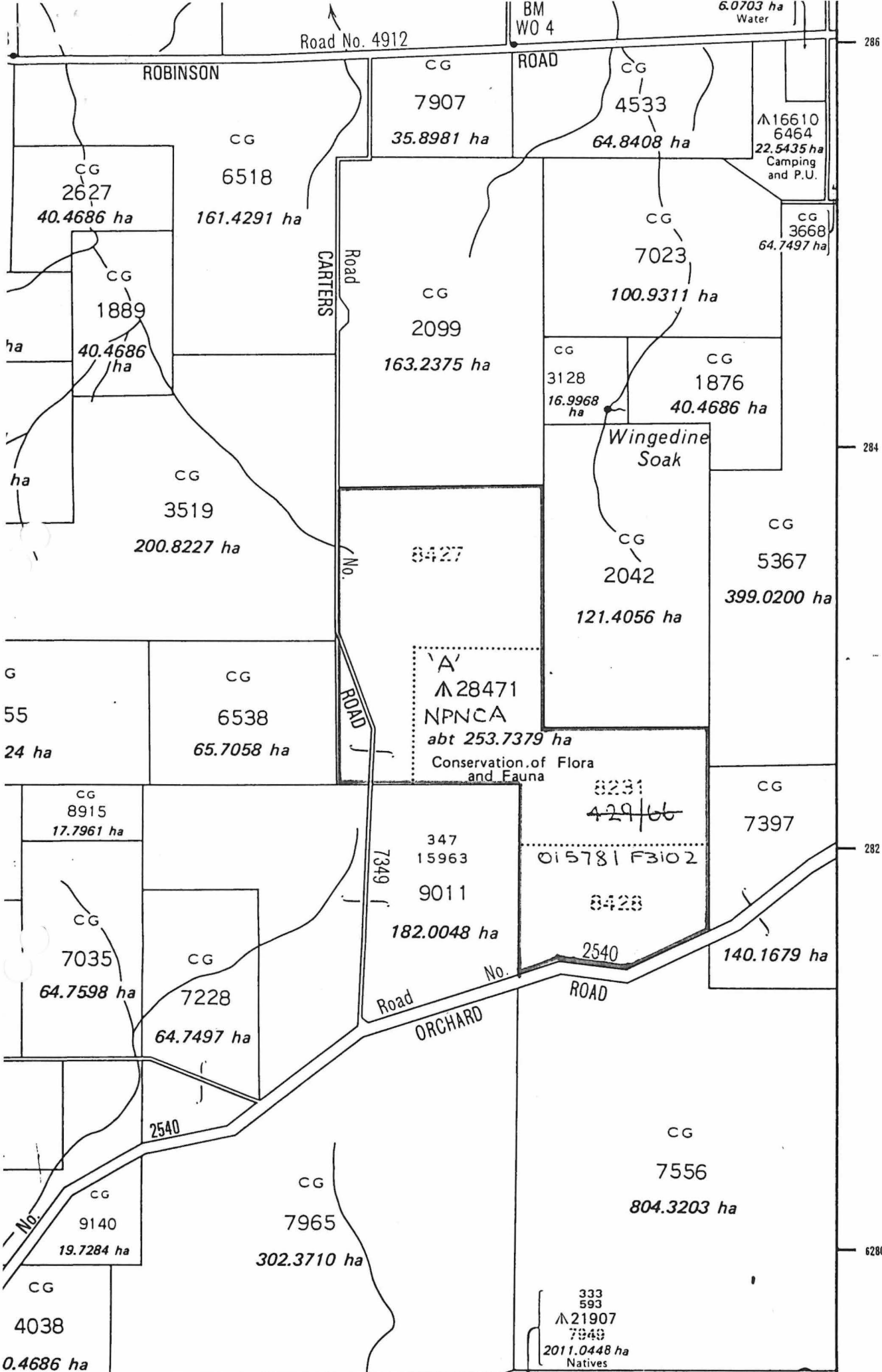

Pt plan 520 BOSCABEL NE  
1:25000