

RESERVE GAZETTAL ACTION SHEET
FOR REGIONS AND DISTRICTS

LANDS CLERK: Attach a copy of map and forward to the following:

1. REGIONAL MANAGER:
CENTRAL FOREST, GREENOUGH, GOLDFIELDS, KIMBERLEY,
NORTHERN FOREST, PILBARA, SOUTH COAST, SOUTHERN FOREST,
WHEATBELT
2. DISTRICT MANAGER: _____
3. CLERK, WOODVALE _____
4. O.I.C. INVENTORY BUNBURY/KELMSCOTT/MANJIMUP _____
5. DISTRICT WILDLIFE OFFICER: Greenough

REASON FOR GAZETTAL:

change in vesting from "National Parks Board" to "Geha". change in
purpose from "Housing - National Parks Board" to "Housing - Geha".

RESERVE DETAILS

RESERVE NUMBER: 28760, 29831 and 30949.
CALM FILE NUMBER: 024506 F1803.
MAP REFERENCE: KALBARRI TOWNSITE.
SHIRE: NORTHAMPTON.

CHANGES MADE AT GIVEN GAZETTAL DATE

NAME OF RESERVE: _____
PURPOSE: HOUSING "GEHA"
CLASS: _____
AREA: _____
VESTING: GEHA.
DATE AND PAGE NO. OF CURRENT GAZETTAL: _____

LANDS CLERK

(09) 367 0221

28/1/92.
DATE

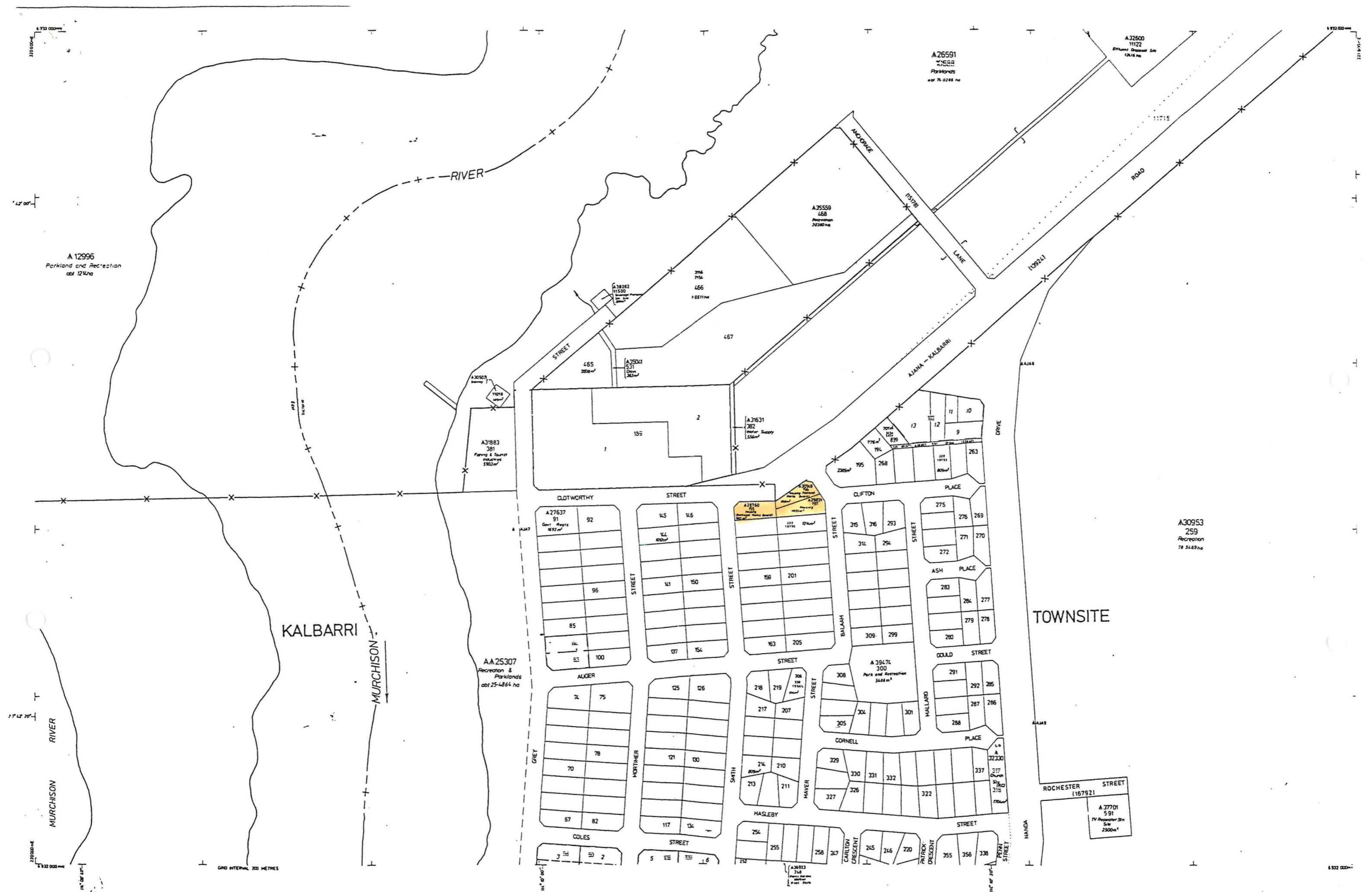

PRODUCED AS PART OF THE STATE LARGE SCALE SERIES OF CADASTRAL AND TOPOGRAPHICAL MAPS AT SCALES OF 1:4000, 1:5000, 1:6000, 1:8000, 1:10000 AND BASED UPON THE AUSTRALIAN MAP GRID TO A STANDARD RECTANGULAR SHEET SYSTEM OF 800 mm x 800 mm

UNIVERSAL TRANSVERSE MERCATOR PROJECTION ZONE No 50 HORIZONTAL DATUM - AUSTRALIAN GEODETIC DATUM 1984 VERTICAL DATUM - AUSTRALIAN HEIGHT DATUM

© 2000 THE AUSTRALIAN GOVERNMENT OF LANDS & SURVEYS

Surveyed Boundary
 Unsurveyed Boundary
 Ground Line or Locum Boundary
 Townsite Boundary (Under Land Act)
 Township Boundary (Under Land Act)

Freehold Land
 Land Leased Under Commonwealth Purchase
 Land Leased Under Section 118
 Vacant Crown Land
 Reserves
 Freehold Reserves

UNCOLOURED
 PINE WASH
 PINE WASH WITH GREEN BORDER

KALBARRI TOWNSITE		WESTERN AUSTRALIA	
LAND DISTRICT	EEDEL & VICTORIA	Scale	1:2000
LOCAL AUTHORITY	SHIRE OF NORTHAMPTON		reduced
ON PLAN	KALBARRI 10000 80 46/Pls 52, 53, 62, 63	SOUTH WEST MINERAL FIELD	

ADJOINING SHEET	
	26.13
	26.12
OVERLAY IDENTIFIC	