

RESERVE ACTION SHEET: CONSERVATION RESERVES

RESERVE No. 28862 **LOCAL GOVERNMENT:** Shire of Serpentine/Jarrahdale

NAME : Serpentine National Park

PURPOSE: National Park

VESTING: Conservation Commission

ACTION

Inclusion of Lot 4 Falls Road (11.992 hectares), portions of Selkirk Road which are now closed (3.9 hectares), and former Cockburn Location 262 (about 11 hectares) into the Reserve and a redescription and recalculation of the total area, resulting in a nett increase of approximately 30.6 hectares to the reserve's area.

Total Area: 663.0 hectares

REASON FOR ACTION

Portions of the added land overlook the Serpentine Falls area, provide extensive views, and support extensive stands of Rock Sheoak. The addition of this land was recommended in the Serpentine National Park Management Plan 2000.

Date of amendment: 14/3/2006

Maps: pp. 41, 42, 43, 49 & 50

Customer advice: p. 38

Summary of Action: see p. 44

Background Information: pp. 45-51

IUCN classification: 1 (a)

Native Title: Native title is extinguished for Reserve 28862 due to vesting prior to 23 December 1996 (Ward High Court decision).

1	LAND SERVICES CO-ORDINATOR	To note	SC
	LAND & EXTERNAL FUNDING UNIT	Send copies of advice and maps to: <ul style="list-style-type: none"> • Lisa Wright (Woodvale) • District Manager • Regional Manager Attach TENIS gazettal history to file Add report to Conservation Commission summary	
3	SENIOR POLICY OFFICER, P.V.S.	To note native title clearance	
4	SENIOR POLICY OFFICER, CRAWLEY (for purchases)	To note	
5	DIRECTOR, NATURE CONSERVATION/ DIRECTOR, PARKS AND VISITOR SERVICES	To note	
6	C.I.S.	Please rename file/create new file	
	LAND & EXTERNAL FUNDING UNIT	Delete from District Proposals spreadsheet	

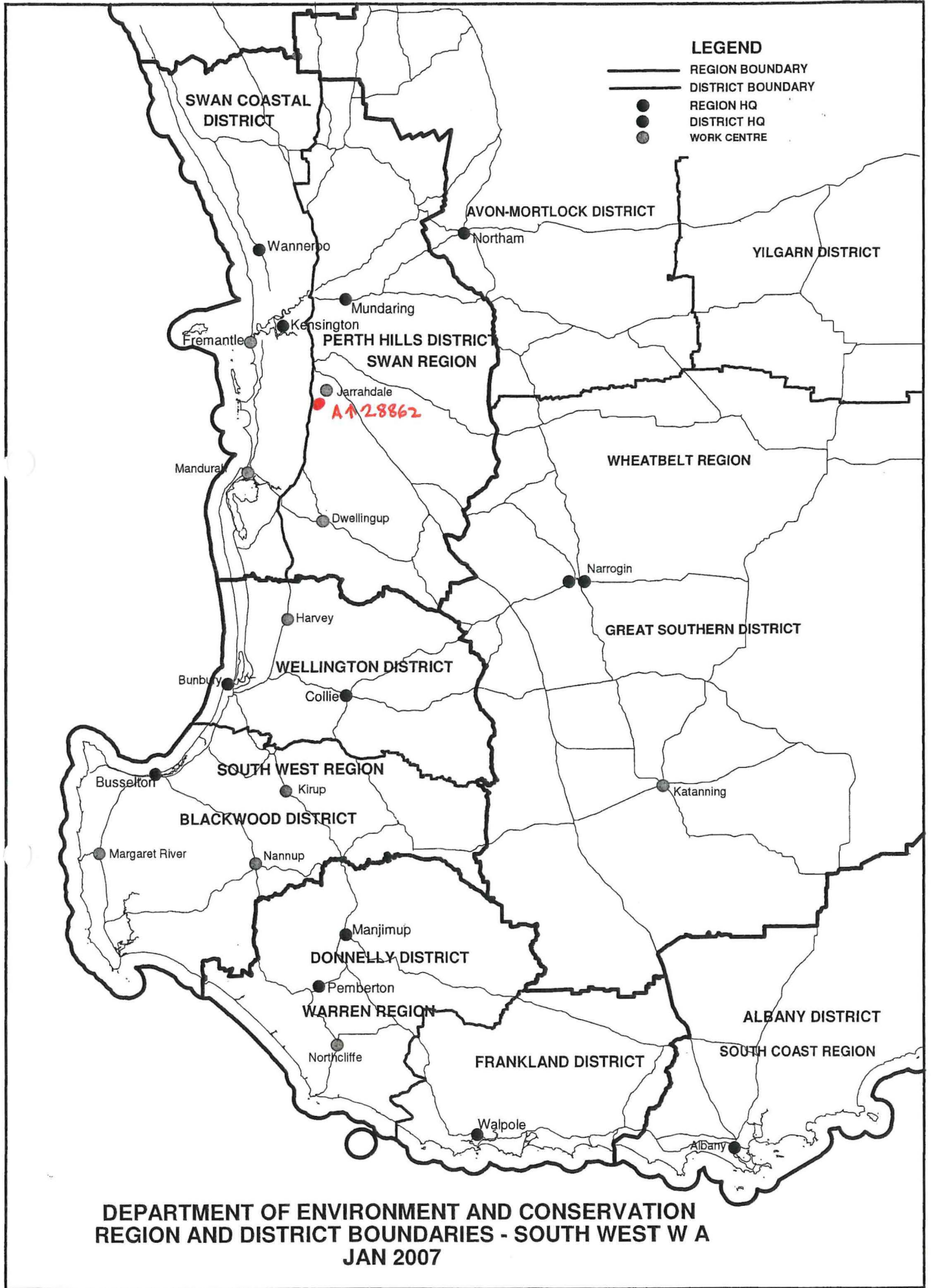

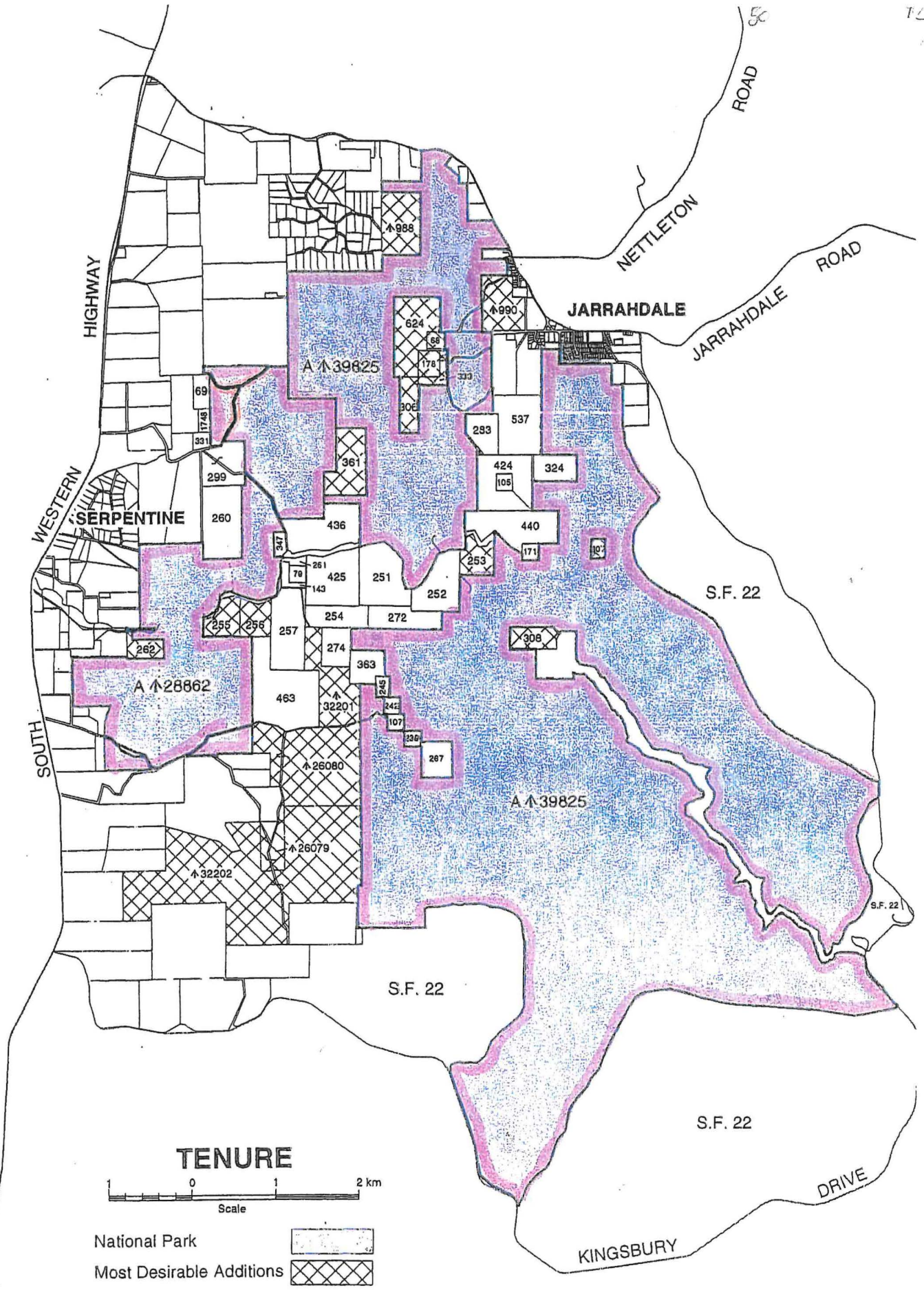

Serpentine National Park (CA ↑ 28862)



closed road to be added to Serpentine National Park.

Figure 2

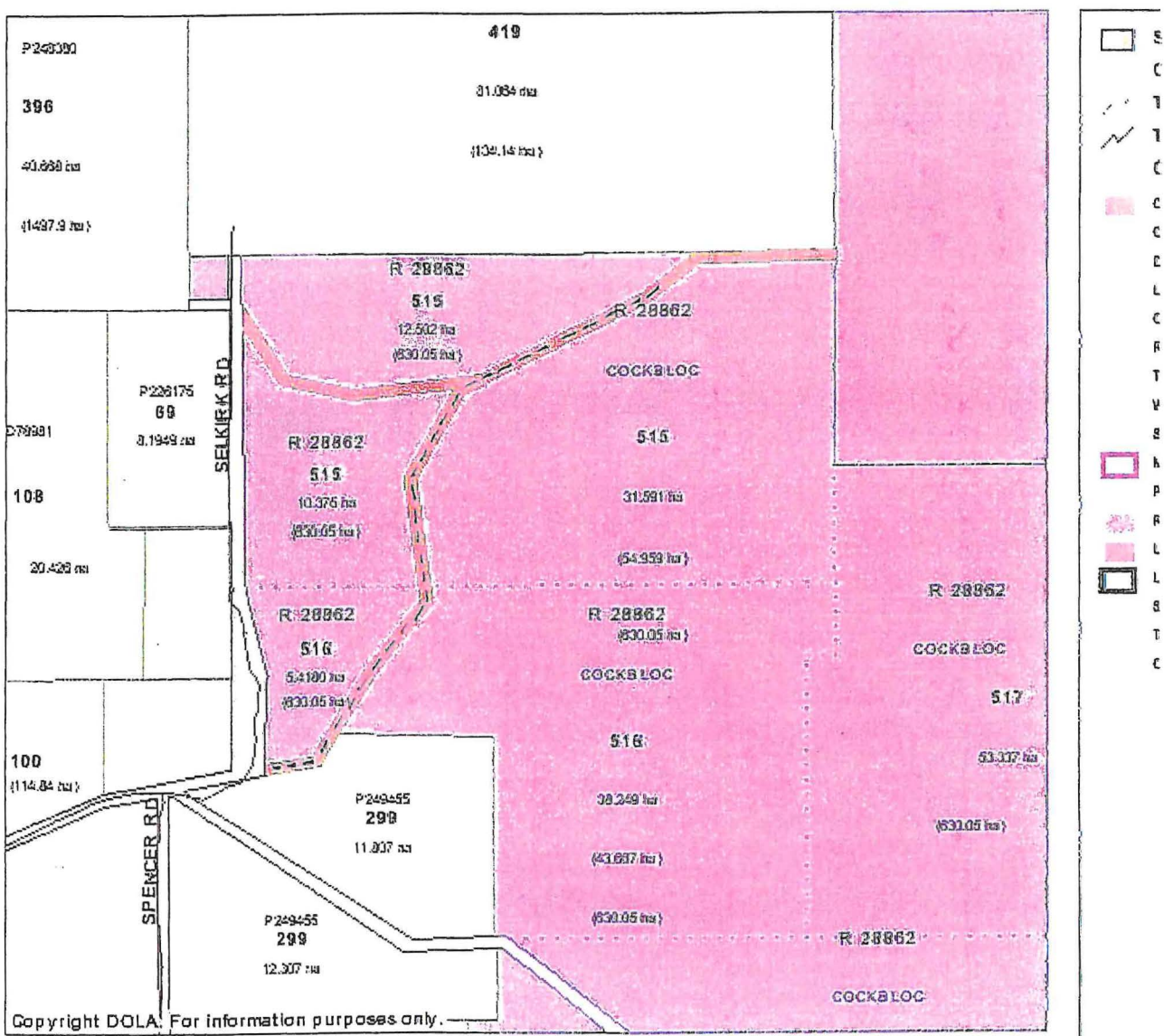
MAP 2



Scale 1:12853
 Comment:

-  Serpentine National Park (A#28862)
-  Closed road to be added to Serpentine National Park, that is unconstructed.
-  Closed road to be added to Serpentine National Park, that is constructed (gravel).

Disclaimer

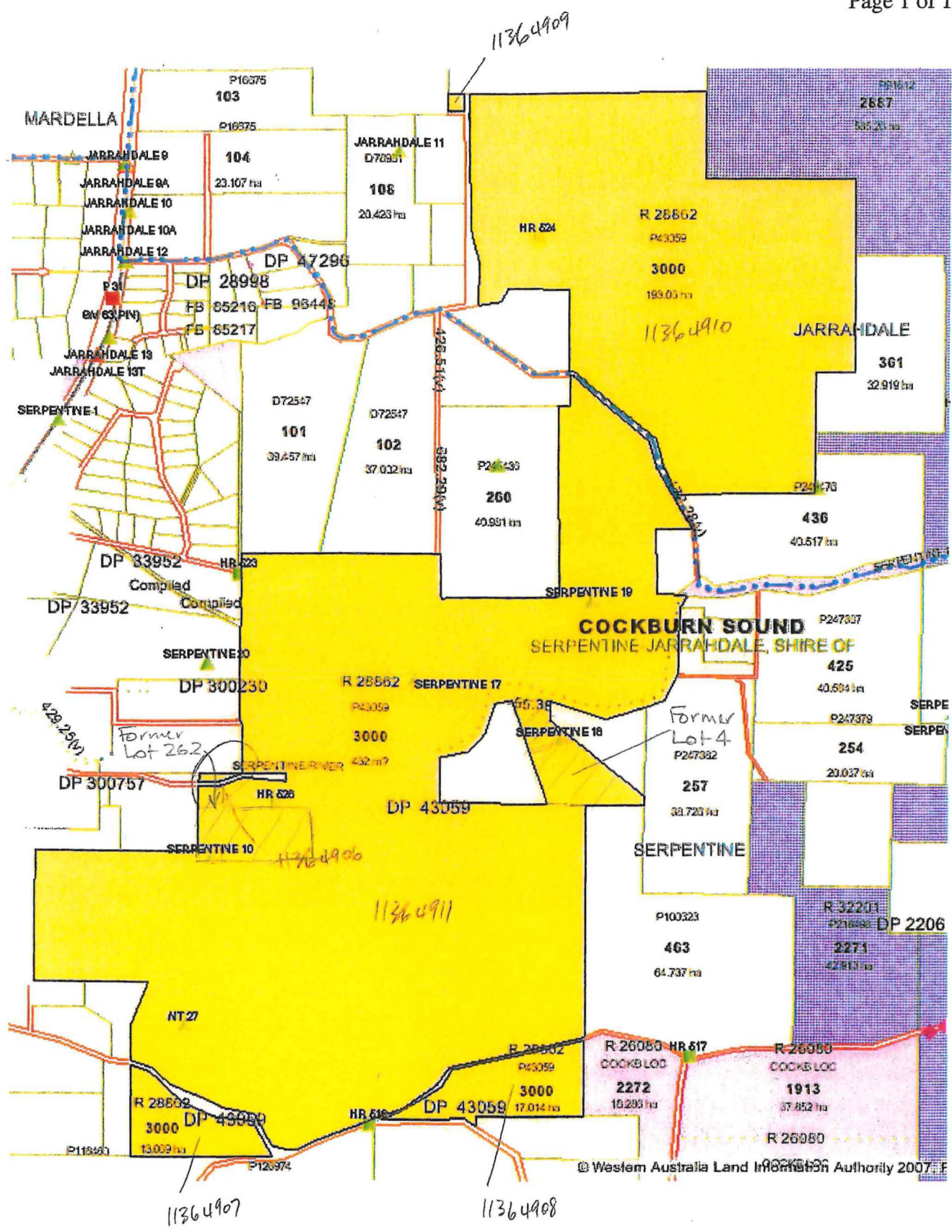

ED/YER	AMENDMENT	BY	SIGNATURE	DATE	APPROVED Authorized Land Officer	Date

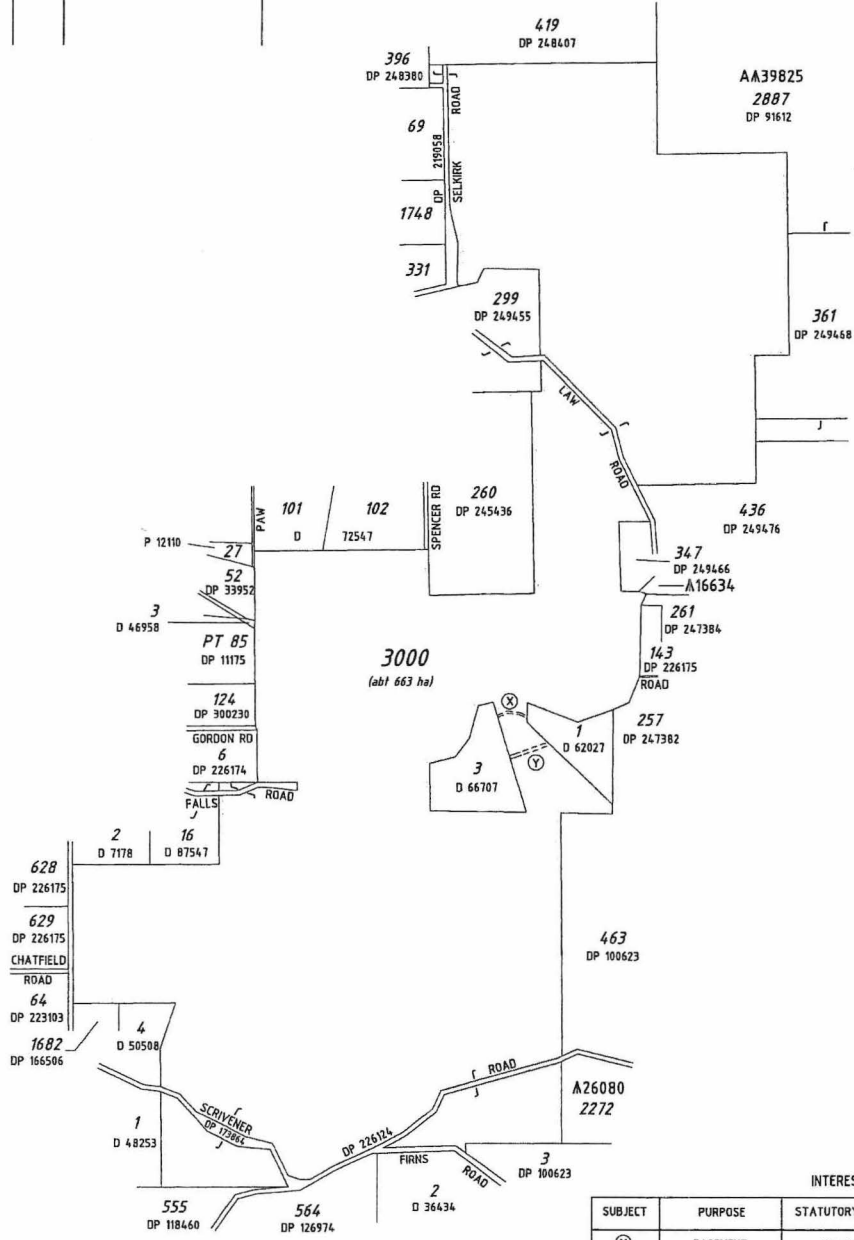

FORMER TENURE TABLE		
LOT NO.	PLAN	CLY - C/T
4	D 66707	2120-772 (C/T)
84	DP 226114	3010-65
262	DP 248405	1960-577 (C/T)
515	DP 104181	3049-784
516	DP 105948	3049-788
517	DP 107756	3049-794
520	DP 105949	3049-798
627	DP 128615	3049-826
821	DP 180638	3050-404
1727	-	3050-923
2117	-	3052-117
2118	-	3052-142
2119	-	3052-143
4143	DP 219058	3105-448

TYPE		CROWN	
PURPOSE		SUBDIVISION	
PLAN OF		LOT 3000	
DISTRICT	COCKBURN SOUND	FORMER TENURE	
TOWNSITE	-	FILE	SEE TABLE
FILE	4189-1895V4	LOCAL AUTHORITY	SHIRE OF SERPENTINE-JARRAHDALE
LOCAL AUTHORITY	SHIRE OF SERPENTINE-JARRAHDALE	LOCALITY	JARRAHDALE
LOCALITY	JARRAHDALE	ON	REFERENCE
SCALE (QAD)	1:15 000		

**SUBJECT TO SURVEY
NOT FOR ALIENATION PURPOSES**

SURVEY FIRM		DLI - PWK 15/10/2004	
LODGED	20-Oct-2004	TYPE OF VALIDATION	
DATE	20-Oct-2004	LEGAL INSTRUMENT	
FILE NO.	N/A	ASSESS NO.	

IN ORDER FOR DEALINGS

SUBJECT TO

- Revestment of lots 4, and 262
- Re-description of AA28862

Peter Kilchin
 FOR AUTHORIZED LAND OFFICER DATE 21-Oct-2004

APPROVED

14/3/06

AUTHORIZED LAND OFFICER DATE

Department of Land Information
 Government of Western Australia

DEPOSITED PLAN

43059

SHEET 1 OF 1
EDITION 1 VERSION 1

INTERESTS AND NOTIFICATIONS					
SUBJECT	PURPOSE	STATUTORY REFERENCE	ORIGIN	LAND BURDENED	BENEFIT TO
(X)	EASEMENT	T.L ACT 1893	D266901	LOT 3000	LOT 3 ON D 66707
(Y)	EASEMENT	T.L ACT 1893	A723286	LOT 3000	M.W.S.&D.B.
-	EASEMENT	T.L ACT 1893	D266900	LOT 3 ON D 66707	LOT 3000 ON THIS PLAN

GRAPHICS DERIVED FROM DLI'S SCDB/OCT 2004 - GDA 94 - ZONE 501
WATERLINES SHOWN HEREON DO NOT NECESSARILY DEPICT AN EXACT CADASTRAL BOUNDARY

HELD BY DLI
IN DIGITAL FORM ONLY