

NATURE RESERVE

RESERVE NO: 29073

GOVERNMENT GAZETTE
Date Page No.

FILE NUMBER: 334/68

PURPOSE: Conservation of
Flora and Fauna

5.4.68 894

NAME: Eneabba

CLASS (Land Act):

AREA: 4886 ha

14.6.74 1891

VESTING:

LOCATION NO(S): Vic. 10985

CLASSIFICATION:
(Wildlife Act
Section 12A)

LITHO: 94/80 A4

LOCAL AUTHORITY: CARNAMAH SHIRE

Notes:

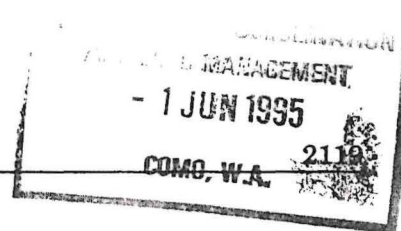

DOLA File 2669/898.

Reserve No 5690 (Swan District) "Police" to comprise Location 11771 as surveyed and shown on Land Administration Diagram 90716 in lieu of Location 11635 and of its area being increased (recalculated) to 2625 square metres accordingly.

Public Plan: BG34 (2) 11.25. Bagot and Hensman Roads. Local Authority—City of Subiaco.

DOLA File 2174/989.

Reserve No 16688 (Plantagenet District) "Trigonometrical Station" to comprise Location 7725 on Reserve Diagram 1108 and of its area remaining unaltered at 4047 square metres.

Public Plan: Breaksea NW (25) Local Authority—Shire of Albany.

DOLA File 3116/917.

Reserve No 21271 (Murray Location 1014) "National Park" to:-

- (i) exclude Location 1944 as surveyed and shown bordered red on Land Administration Diagram 91987 and.
- (ii) include Location 751 as surveyed and shown on Land Administration Diagram 33076 and of its area being increased to 632.8087 hectares accordingly.

Public Plans: BF32 (2) 40.28 and (10) 8.6. Tims Thicket Road. Local Authority—City of Mandurah.

Reserve 21271 is automatically vested in the National Parks and Nature Conservation Authority pursuant to Section 7 of CALM Act 1984.

DOLA File 570/951.

Reserve No 22927 (Bunbury Lots 326, 327 and 379) "Government Requirements" to include Lots 325 and 432 and of its area being increased to 4920 square metres accordingly.

Public Plan: BG30 (2) 01.33 Local Authority—City of Bunbury.

DOLA File 781/955.

Reserve No 24198 (Murray District) "Camping and Recreation" to comprise Location 1943 as surveyed and shown bordered red on Land Administration Diagram 91987 in lieu of Locations 751 and 1495 and of its area being reduced to 48.2368 hectares accordingly.

Public Plans: BF32 (2) 40.28 and (10) 8.6. Tims Thicket Road. Local Authority—City of Mandurah.

DOLA File 1314/954.

Reserve No 24234 (at Carnamah) "Water Supply" to comprise Lot 152 as surveyed and shown bordered red on Land Administration Plan 18572 in lieu of Lots 92 to 96 inclusive, 98, 101, 104, 108 and 109 and of its area being reduced to 60.8267 hectares accordingly.

Public Plans: BG40 (2) 13.35 and (10) 3.7. Carnamah—Eneabba Road and Slater Street. Local Authority—Shire of Carnamah.

DOLA File 3065/989.

Reserve No 26271 (Wellington District) "Rubbish Dump" to comprise Location 5661 as surveyed and shown bordered red on Land Administration Diagram 91808 in lieu of Locations 4782 and 5100 and of its area being reduced to 5.1212 hectares accordingly.

Public Plan: BG30 (2) 7.38. Ditchingham Place. Local Authority—Shire of Harvey.

DOLA File 3453/963.

Reserve No 27560 (Swan Location 8900) "Public Recreation" to include Location 12101 (formerly Lot 72 on Diagram 42379) and of its area being increased to 3794 square metres accordingly.

Public Plan: BG34 (1) 29.64. Robyn Street Local Authority—City of Bayswater.

DOLA File 48/963.

Reserve No 28009 (Plantagenet Locations 7020 and 7021) "Native Housing" to exclude that portion now comprised in Location 7753 as surveyed and shown bordered green on Land Administration Diagram 91893 and of its area being reduced to 4882 square metres accordingly.

Public Plan: Kendenup Townsite. Austin Street. Local Authority—Shire of Plantagenet.

DOLA File 308/968V2.

Reserve No 29073 (Victoria District) "Conservation of Flora and Fauna" to exclude that portion containing 11.8983 hectares as surveyed and shown bordered green on Land Administration Diagram 91334 and of its area being reduced to 4823.3194 hectares accordingly.

Public Plan: Beagle Island and Logue (50). Coolimba—Eneabba Road. Local Authority—Shire of Carnamah.

DOLA File 873/968.

Reserve No 30163 (Swan Locations 8480, 8549 and 9147) "Public Recreation" to include Location 12100 (formerly Lot 40 on Diagram 37263) and of its area being increased to 4003 square metres accordingly.

Public Plan: BG34 (1) 30.64. Crowhurst Way Local Authority—City of Bayswater.

DOLA File 2908/970.

Reserve No 30628 (Avon Location 28374) "Site for Club and Club Premises" to include Location 29143 (formerly Location 26633) as surveyed and shown on Land Administration Diagram 54982 and of its area being increased to 4.2031 hectares accordingly.

Public Plans: BJ34 (2) 23.18 and Quairading NE (25). Quairading—York Road. Local Authority—Shire of Quairading.

CLERK, WOODVALE - FYI

1. file.

2. N. Ryan

3.

See Jola 96 SC. 14.8.95
Mo. Collins for list
sh. Khandu

29073

030351F 3102

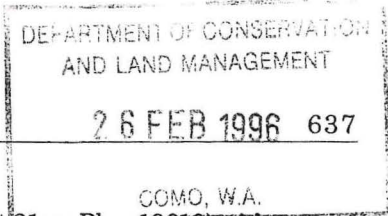

20 February 1996]

GOVERNMENT GAZETTE, WA

26 FEB 1996 637

DOLA File 1436/995.

Reserve No. 44106 comprising Wellington Location 5726 (formerly Lot 21 on Plan 19610) with an area of 7.9767 hectares for the designated purpose of "Foreshore Management".

Section 20A.

Public Plan: BG31 (10) 2.1. Devlin Road.

Local Authority—Shire of Harvey.

DOLA File 2336/995.

Reserve No. 44107 comprising Denmark Estate Lot 1015 (formerly Lot 4 on Diagram 87931) with an area of 1927 square metres for the designated purpose of "Public Recreation".

Section 20A.

Public Plan: BJ26 (10) Pts 4.2, 4.3, 5.2 and 5.3. Richie Road.

Local Authority—Shire of Denmark.

DOLA File 408/995.

Reserve No. 44108 comprising Cockburn Sound Location 4111 (formerly the land coloured blue and marked Drain Reserve on Plan 14185) with an area of 284 square metres for the designated purpose of "Drainage".

Section 20A.

Public Plan: BG34 (2) 08.12. Doig Place.

Local Authority—City of Fremantle.

DOLA File 454/995.

Reserve No. 44109 comprising Swan Locations 12477 and 12478 (formerly Lots 981 and 982 the subject of Plans 20547 and 20548 respectively) with an area of 154 square metres for the designated purpose of "Pedestrian Accessway".

Public Plans: BG34 (2) 15.35 and 15.36 and (5) 07.15. Marshall Road.

Local Authority—Shire of Swan.

A. A. SKINNER, Chief Executive.

LA801

LAND ACT 1933
AMENDMENT OF RESERVES

Made by His Excellency the Governor under Section 37.

The following reserves have been amended.

DOLA File 1381/907V2.

Reserve No 11555 (at Kellerberrin) "Cemetery" to comprise Lot 427 as surveyed and shown bordered red on Land Administration Plan 18586 and of its area being reduced (recalculated) to 7.0920 hectares accordingly.

Public Plan: BK35 (2) 3.22. Moore Street.

Local Authority—Shire of Kellerberrin.

DOLA File 5755/912.

Reserve No 14291 (at Kellerberrin) "Gravel Pit" to comprise Lot 428 as surveyed and shown bordered red on Land Administration Plan 18586 in lieu of Lot 302 and of its area being reduced to 3.2035 hectares accordingly.

Public Plan: BK35 (2) 3.22. Moore Street.

Local Authority—Shire of Kellerberrin.

DOLA File 2545/927V2.

Reserve No 19825 (Hampton Locations 38 and 266) "Timber Sandalwood" to exclude that portion of Location 38 containing 208.6200 hectares now comprised in the area shown bordered green on Land Administration Plan 18863 and of its area being reduced to 13233.0132 hectares accordingly.

Public Plan: Kurnalpi (250). Kurnalpi-Pinjin Road.

Local Authority—City of Kalgoorlie-Boulder.

DOLA File 308/968V2

Reserve No 29073 (Victoria District) "Conservation of Flora and Fauna" to comprise Locations 11980 and 11983 as delineated and shown bordered pink on Land Administration Reserve Plan 419 in lieu of Location 10985 and of its area being increased to 5036.9915 hectares accordingly.

Public Plan: Beagle Island & Logue (50).

Local Authority—Shire of Carnamah

Reserve 29073 is automatically vested in the National Parks and Nature Conservation Authority pursuant to Section 7 of the CALM Act 1984.

28.02.96

3

Mr. Collins - for your letter pls. thanks MK 2.2.96

L. Aite = 1. d. Ayer

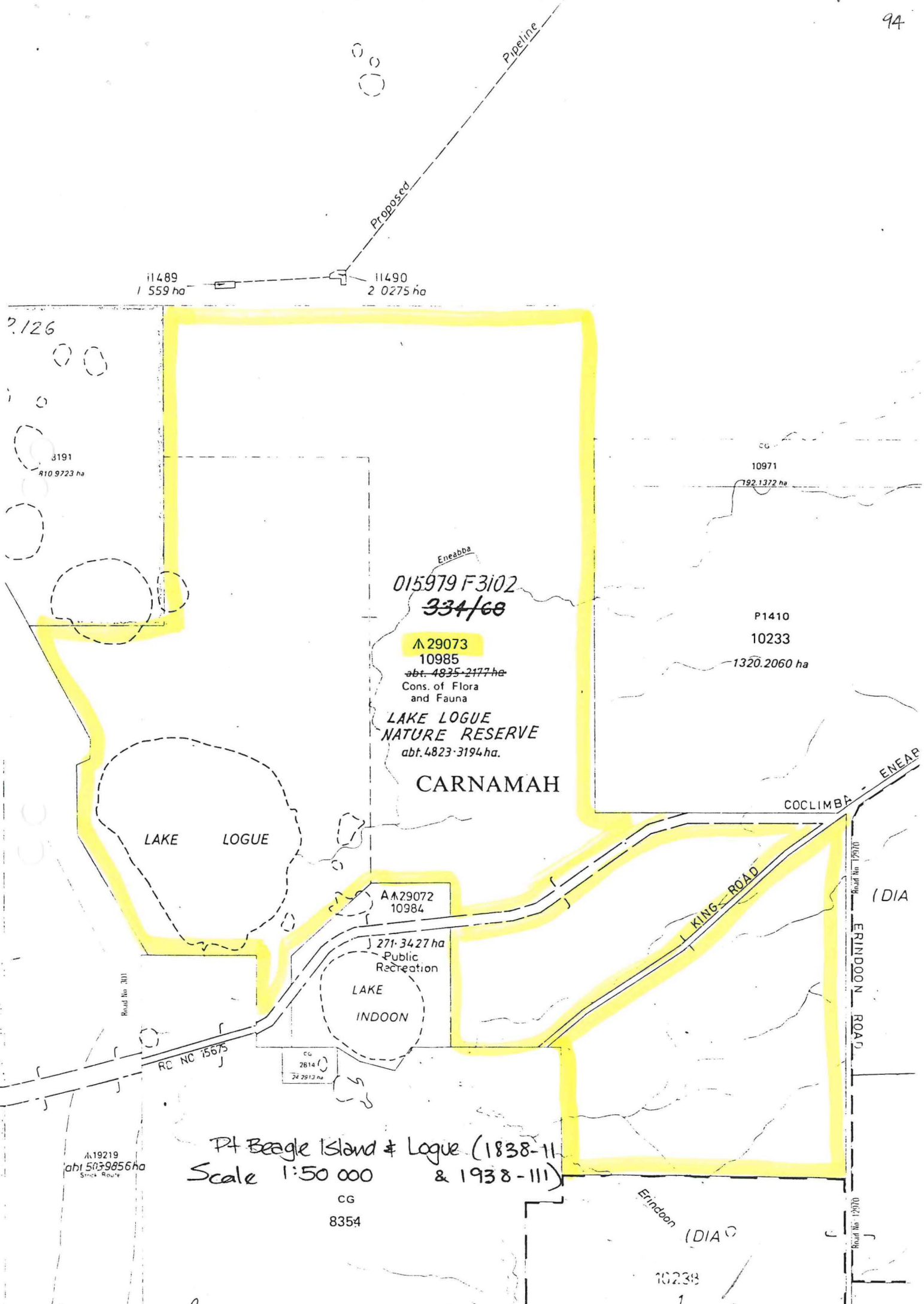

11489 / 559 ha
 11490 / 2 0275 ha

2126
 3191
 810 9723 ha

Eneabba
 015979 F3102
 334/68

A 29073
 10985
 abt. 4835-2177 ha
 Cons. of Flora
 and Fauna

**LAKE LOGUE
 NATURE RESERVE**
 abt. 4823-3194 ha.

CARNAMAH

CG
 10971
 192 1372 ha
 P1410
 10233
 1320.2060 ha

LAKE LOGUE

A 29072
 10984
 271-3427 ha
 Public
 Recreation

LAKE
 INDOON

Road No. 301

RC NC 15675

CG
 2814
 24 2913 ha

A 19219
 abt 503-9856 ha
 Struck Route

P4 Beagle Island & Logue (1838-11
 Scale 1:50 000 & 1938-111)

CG
 8354

Erindoon (DIA)

10238
 1

ENEABBA
 COCLIMBA
 KING ROAD
 ERINDOON ROAD
 (DIA)

8190
404.7767 ha

Stock Route
Road No. 307
16.1824 ha

Woodada Well

11569
Cons. Flora & Fauna
2683.4980 ha
Proposed petroleum operations
to be referred to C.A.L.M. for
appropriate conditions.
F. 023376 F3102
N.P.N.C.A.

11489
1 559 ha

11490
2 0275 ha

Wawadji Cave

Road No. 307

8191
810.9723 ha

P.126

015979 F3102
334/68

29073
11980
abt. 4835-2177 ha
Cons. of Flora
and Fauna

LAKE LOGUE
NATURE RESERVE

CARNAMAH
(5036.9915 ha)

10971
192.1372 ha

P1410
10233
1320.2060 ha

OF

LAKE LOGUE

271.3427 ha
Public
Recreation

11983

LAKE
INDOON

A 29072
10984

CG
7814
24.2913 ha

ROAD

RD NO 15675

A 19219
abt. 5079856 ha
Stock Route

CG
8354

GL Δ 11880
104m
1m

YANGET
LAKE

Erimoon (DIA)

10234
1
1821.1602 ha

(DIA)
1105.6766 ha.

10234

59694

CG
10237
491.0785 ha

ROCKY SPRING

GOULD SIMPSON ROAD

A 36419

11381
1384.6261 ha

Cons. of Flora, water
keepers Cave and Protection of Caves
N.P.N.C.A.
Aiyennu Cave

319/65

WHITE LAKE

ROAD

Part Beagle Island & Logue (1838-II & 1938-III)
Scale 1:25 000

CG
10247
1247.8254 ha

P1370
10248
1181.6163 ha

CG
10665
1514.3590 ha

Creek

(GREEN)

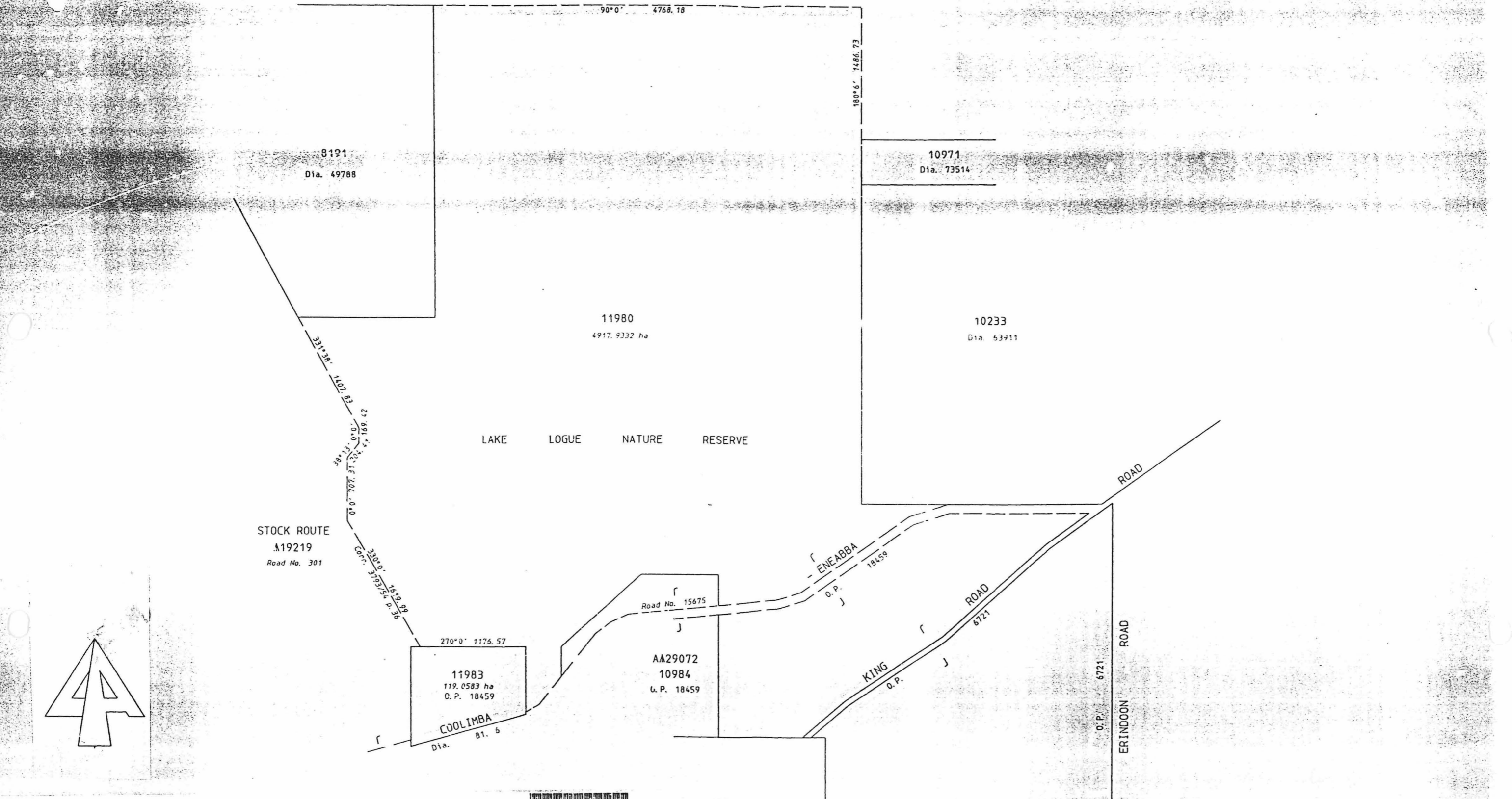

VICTORIA LOCATION 11980 IS CREATED ON THIS DOCUMENT

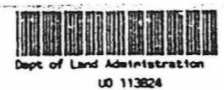

RESERVE No. 29073 - TOTAL AREA 5036.9915 ha Purpose Conservation Of Flora And Fauna		FILE No. 308/968 V2	DEPT. OF LAND ADMINISTRATION RESERVE PLAN No. 419
DISTRICT. VICTORIA		SCALE All measurements in metres 1:25000	
Public Plan Beagle Island & Logue 1:50000		Registered 30.5.95 Page 2119 Recorded on Public Plan PB 3.7.95	
SUBJECT TO SURVEY AMENDMENTS		Registered R.J. Newton Date 16.2.94 For Manager Statutory Drafting and Assents Survey Index Plan Beagle Island & Logue 1:50000	
Reference	Page	DEPT. OF LAND ADMINISTRATION	
Prepared by R.J. Newton	Date 21.2.94	RESERVE	
Checked <i>Clayton</i>	Date 2.5.94	PLAN No. 419	
Approved <i>W. S. ...</i>	Date 4.5.94		
Manager Statutory Drafting and Assents			

