

NATURE RESERVE

RESERVE NO: 30428

GOVERNMENT GAZETTE
Date Page No.

FILE NUMBER: 1427/76

PURPOSE: Conservation of Flora & Fauna 29/7/77 2446

NAME: Tank Hill 16/11/84 3698

CLASS (Land Act):

AREA: 592.0551 ha

VESTING: W.A.W.A. 29/7/77 2423

LOCATION NO(S): Avon 24811

CLASSIFICATION:
(Wildlife Act
Section 12A)

LITHO: 24/80 B1-2

LOCAL AUTHORITY: MERREDIN SHIRE

Notes:

RESERVE ACTION SHEET: CONSERVATION RESERVES

RESERVE No. 30428 **LOCAL GOVERNMENT:** Shire of Merredin

NAME : Tank Hill Nature Reserve

PURPOSE: Conservation of Flora & Fauna **VESTING:** Conservation Commission of WA

ACTION

Addition of 109.7168 ha, increasing the reserve's area from 592.1310 ha to 701.478 ha.

Total Area: 701.8 ha

REASON FOR ACTION

Purchase of land containing thickets of sheoak, herb-fields on granite, mallee, and open woodlands of *Eucalyptus capillosa*. Much of the vegetation is associated with granite, which was not well represented in the nature reserve.

Date of amendment: 7/6/07

Maps: pp. 26-29

Customer advice: p. 25

Summary of Action: see p. 30

Background Information: pp. 21-22

IUCN classification: 1 (a)

Native Title: Native title extinguished over added area of Reserve 30428 due to previous vesting (Ward High Court decision).

1	LAND SERVICES CO-ORDINATOR	To note	<i>RP</i>
2	LAND & EXTERNAL FUNDING UNIT	Send copies of advice and maps to: <ul style="list-style-type: none"> ✓ • Lisa Wright (Woodvale) • District Manager • Regional Manager Attach TENIS gazettal history to file Add report to Conservation Commission summary	
3	SENIOR POLICY OFFICER, P.V.S.	To note native title clearance	
4	SENIOR POLICY OFFICER, CRAWLEY (for purchases)	To note	
5	DIRECTOR, NATURE CONSERVATION/ DIRECTOR, PARKS AND VISITOR SERVICES	To note	
6	C.I.S.	Please rename file/create new file	
	LAND & EXTERNAL FUNDING UNIT	Delete from District Proposals spreadsheet	

LEGEND

- REGION BOUNDARY
- DISTRICT BOUNDARY
- REGION HQ
- DISTRICT HQ
- WORK CENTRE

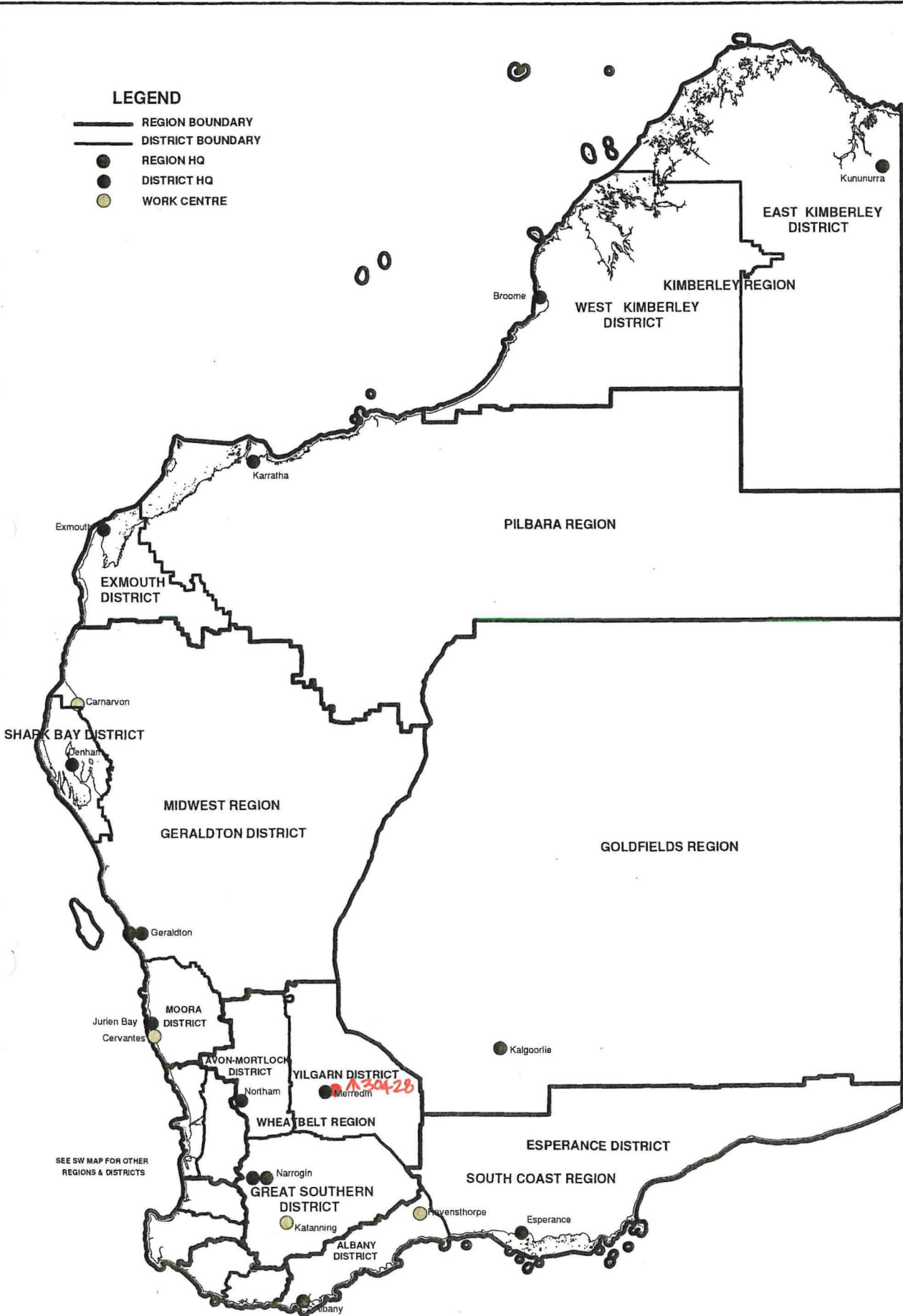

DEPARTMENT OF ENVIRONMENT AND CONSERVATION
REGION AND DISTRICT BOUNDARIES

JAN 2007

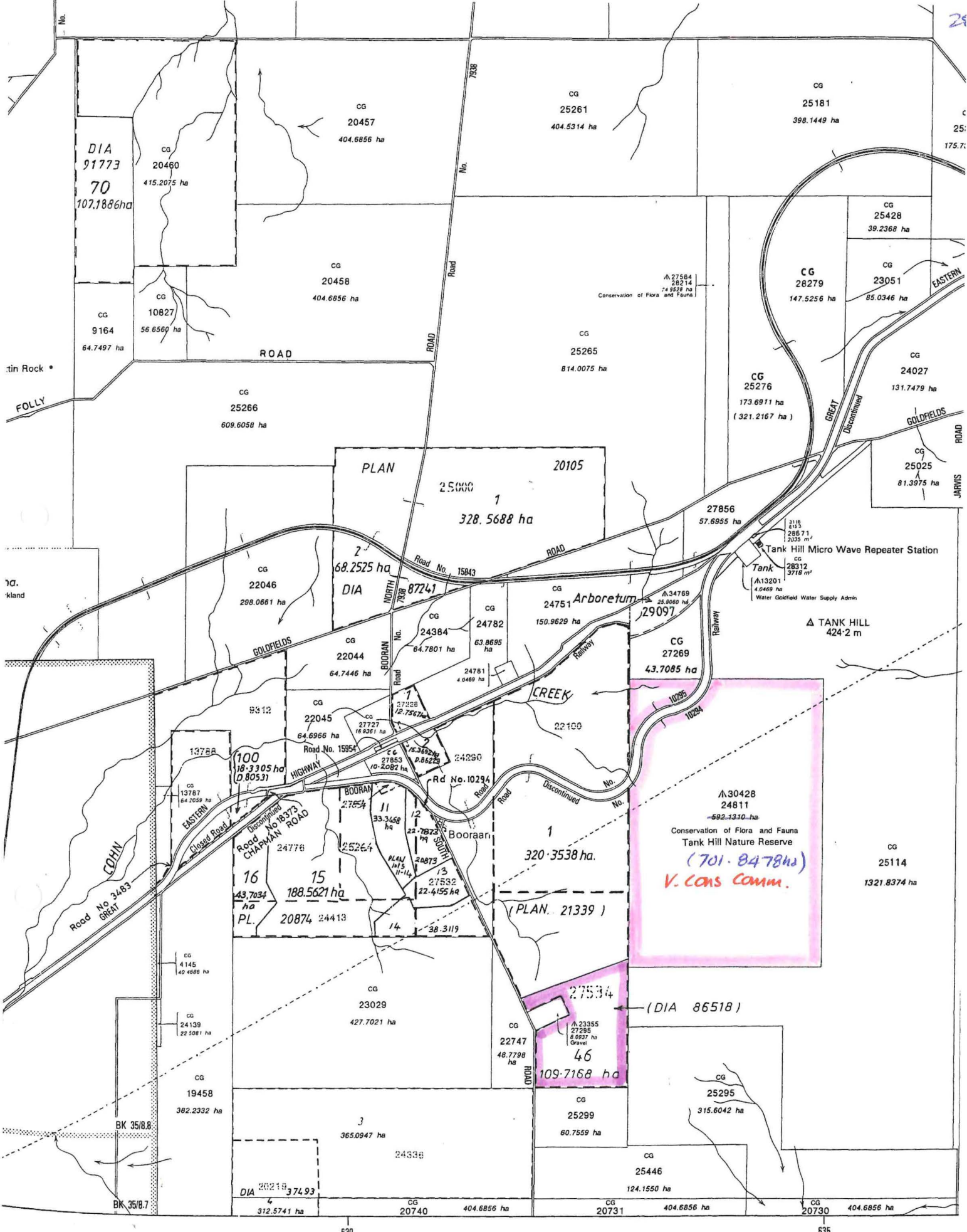

ORIGINAL AREA OF A30428 PRIOR TO GAZETAL 7-6-06.





ADDITION OF LOT 46 TO A30428.

Scale 1 : 50 000

Port Landgate plan : Merredin 2535-11

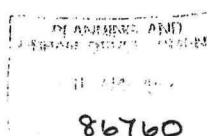
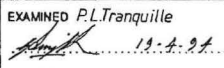
LAND DESCRIPTION	ON	CERTIFICATE OF TITLE	FIELD BOOK	DIA 86518 
PT AVON LOCATION 27534	PLAN CS DIAGRAM 48003 INDEX MERREDIN (150) PUBLIC MERREDIN 1:50,000	VOLUME 1431 FOLIO 898	66228	

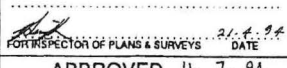

SURVEYOR'S CERTIFICATE REG 54: I JAN. CAMPBELL, ROSS hereby certify that: (a) this plan of survey is a correct and accurate representation of the survey carried out by me personally/ under my own personal supervision, inspection and field check, and recorded in field books lodged for the purposes of this plan of survey; (b) the measurements are in strict accordance with the Licensed Surveyors (Guidance of Surveyors) Regulations 1961 and in particular regulations 23 and 34 of those regulations; and (c) this survey and this plan of survey are in strict accordance with the requirements of the Licensed Surveyors (Guidance of Surveyors) Regulations 1961 and the relevant law in relation to which it is lodged.		APPROVED BY STATE PLANNING COMMISSION FILE 86760  FOR CHAIRMAN DATE 21-4-94 		LODGED DATE 30.3.94 FEE PAID \$208 ASSESSMENT NO 50696 EXAMINED P.L. Tranquille  19.4.94 DOCKET PLAN/DIAGRAM 79873 CERTIFIED CORRECT  19.4.94 F.S.C. No.		SCALE 1:7500 ALL DISTANCES ARE IN METRES IN ORDER FOR DEALINGS SUBJECT TO FOR INSPECTOR OF PLANS & SURVEYS  21.4.94 DATE APPROVED 11.7.94 DATE APPROVED INSPECTOR OF PLANS & SURVEYS OFFICE OF TITLES DIAGRAM 86518	
Ian C. Ross 27 Nov 93 Licensed Surveyor Date		[Signature] Date		 DOLA Department of LAND ADMINISTRATION			