



State Land Services

Your ref: 2005F002475V01; D074324
Our ref: 04286-1965/02 Prompt Job No.070303
Enquiries: Leanne Shaw Ph: (08) 9347 5083
Fax: (08) 9347 5001
leanne.shaw@dpi.wa.gov.au

24 January 2008

Department of Environment and Conservation
Locked Bag 104
BENTLEY DC WA 6983



Attention: Ms Sharon Colliss

RESERVE "A" 31107 – COMPILED GRAPHICAL SUPPORT.

Thank you for your letter of 19 April 2007.

The documents to create a Crown Land Title as per Deposited Plan 52596 for "A" Class Reserve 31107 were lodged for registration on 23 January 2008, the document/dealing numbers are – K485586 to K485587 inclusive.

If you want to ascertain the progress of this matter it is suggested you telephone Progress and Issuing Registration Services on (08) 9273 7314.

I have enclosed a complimentary copy of Deposited Plan 52596 for your records, showing that "A" Class Reserve 31107 now comprises of Lot 340.

Could you please advise if the proposal for the creation of a conservation park comprised of parts of Lot 341, Reserve 12747 and portion of Kimberley Downs Pastoral Lease is still to be held in abeyance? I understand that discussions were taking place with the native title claimants and their legal representatives and subject to the outcome of these discussions, the proposal may proceed.

Please note that this agency is pursuing the referral process for the inclusion of Lot 343 on Deposited Plan 52596 into adjoining "A" Class Reserve 46235 as a separate matter and to quote Prompt Job No. 080295 in any future correspondence.

Leanne Shaw
A/Senior State Land Officer
State Lands – Kimberley/Pilbara
State Land Services

① Called KLC - no answer, so left message for someone to call me
② Called Leanne & advised that the KLC was to proceed the conservation park proposal to a meeting of Kimberley claimants in July 2007. Leanne to prod for me

**Customer Advices for Reserve Actions
1/02/2008 - 29/02/2008**

Shire of Derby-West Kimberley 1/02/2008 - 29/02/2008

Reserve No.	Land Description	DPI File No.	Volume/Folio	Action	Document No.	Registered	Street Name	Area	Public Plans
31107	Fitzroy Meda	04286-1965-02RO	0000-000	Amendment of Reserve to To now comprise Lot 340 on Deposited Plan 52596 and it's area being reduced (re-calculated) to about 2049.97 hectares accordingly.	K485587	23/01/2008	Fairfield-Leopold Downs Road	2049.97 Ha	Lennard River (250)

*Cliff Banks, Tenure Group, GIS Section
For amended plans + return of
the file to me please.
Stuart Collins
19.9.08*

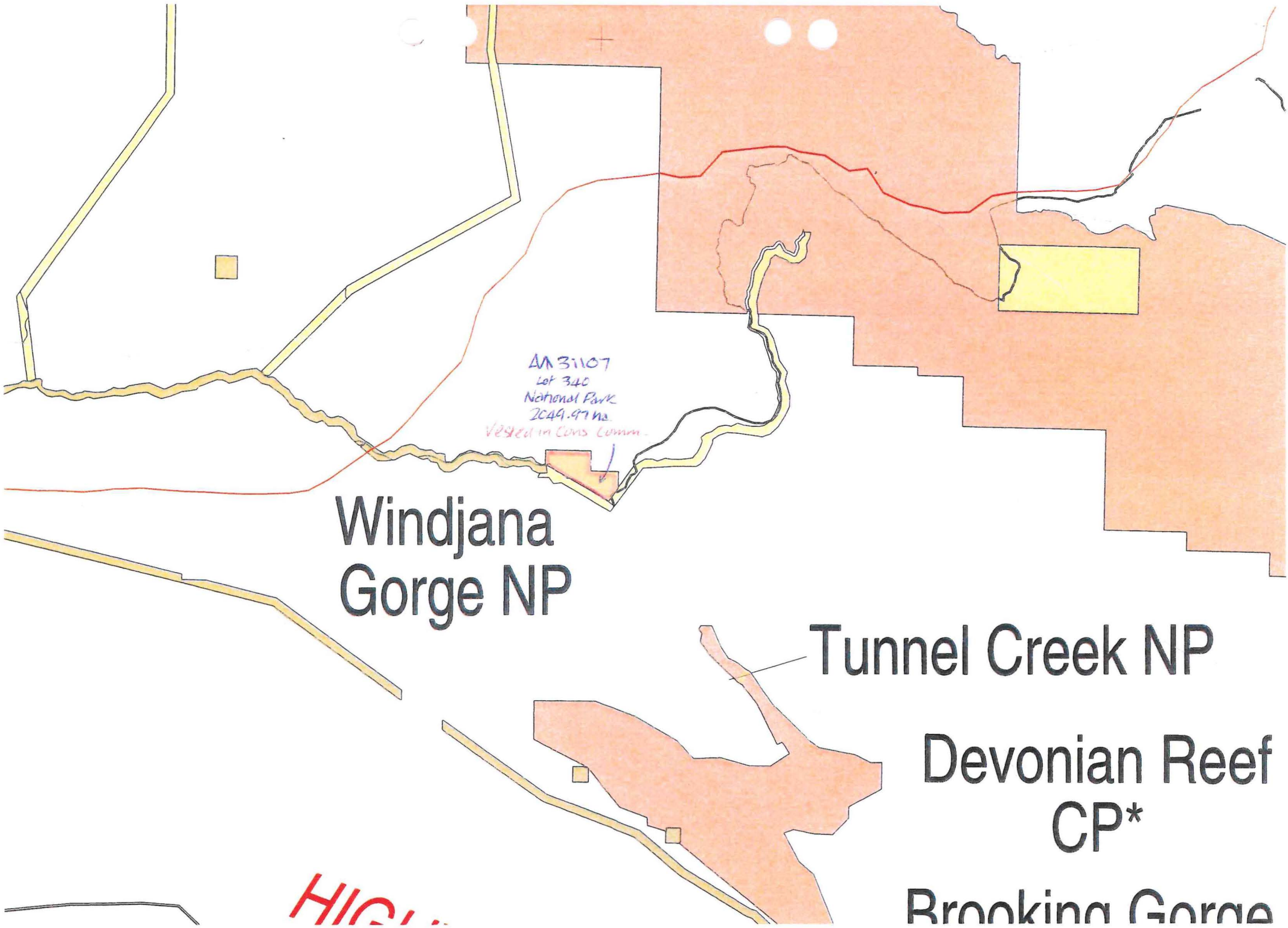

AM 31107
Lot 340
National Park
2049.97 ha
Vested in Cons Comm.

Windjana
Gorge NP

Tunnel Creek NP

Devonian Reef
CP*

Brooking Gorge

HIGHWAY

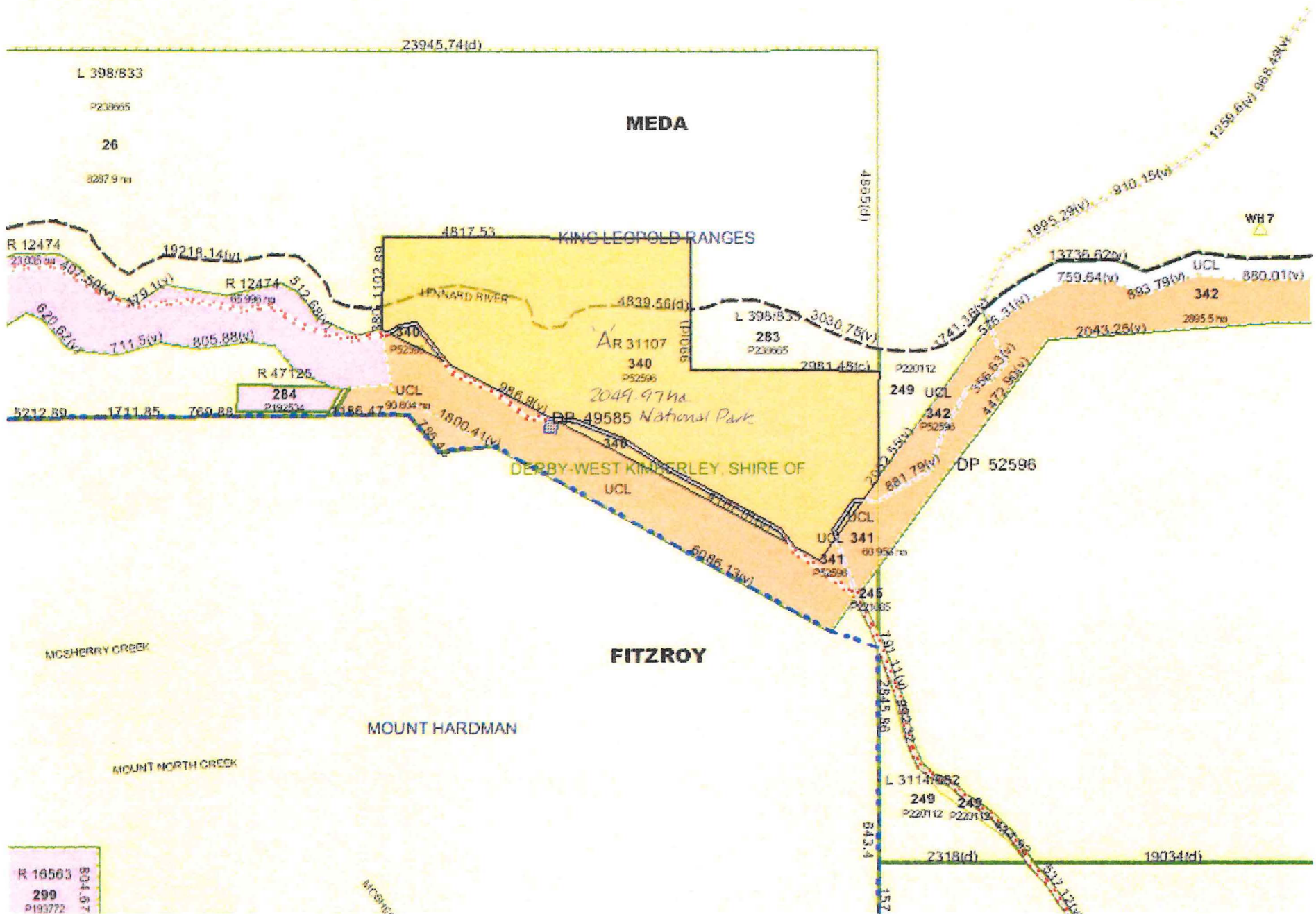

HELD BY DLI
IN DIGITAL FORM ONLY

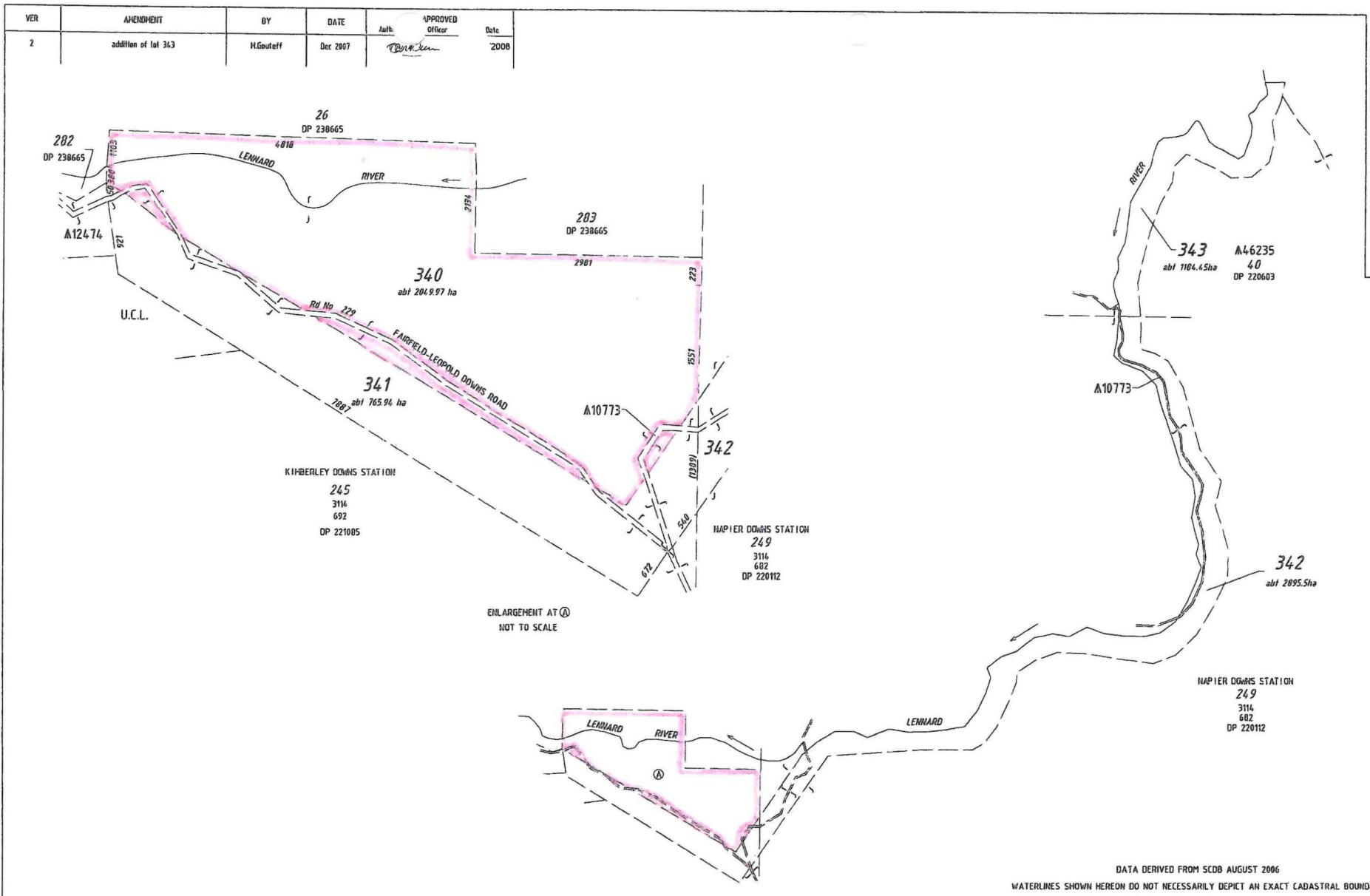

DATA DERIVED FROM SCDB AUGUST 2006
WATERLINES SHOWN HEREON DO NOT NECESSARILY DEPICT AN EXACT CADASTRAL BOUNDARY

TYPE PURPOSE	CROWN SUBDIVISION	FORMER TENURE	SCALE @A: ALL DISTANCES ARE IN METRES	1:100000 	LODGED DATE 24.11.2008	TYPE OF VALIDATION FULL AUDIT P.V.E.	IN ORDER FOR DEALINGS SUBJECT TO Redescription of AA31107 (LOT 340)	 Department of Land Information Government of Western Australia
PLAN OF	LOTS 340, 341, 342 & 343			SUBJECT TO SURVEY NOT FOR ALIENATION PURPOSES	FEE PAID ADDRESS No. U/A U/A CERTIFIED CORRECT 27/11/2008 Registrar of Land Services	APPROVED <i>M.Gouteff</i> FOR AUTHORIZED LAND OFFICER DATE 27/11/2008	DEPOSITED PLAN <h1 style="margin: 0;">52596</h1> SHEET 1 OF 1 EDITION 1 VERSION 2	
DISTRICT FILE LOCAL AUTHORITY	FITZROY, HEDA & IMHALGWI 4286-1965/02 SHIRE OF DERBY-WEST KIMBERLEY	TOWNSITE LOCALITY	KING LEOPOLD RANGES		SURVEY FIG#	DLI - M.GOUTEFF 26/09/2006		