

NATURE RESERVE

RESERVE NO: "A"31188

GOVERNMENT GAZETTE
Date Page No.

FILE NUMBER: 441/78

PURPOSE: Cons. of Flora & Fauna

25.8.78 3118

NAME:

CLASS (Land Act): "A"

AREA: 46.0109 ha

25.8.78 3104

VESTING: W.A.W.A.

25.8.78 3106

LOCATION NO(S): Sussex Loc. 4564, 4646

CLASSIFICATION:
(Wildlife Act
Section 12A)

LITHO: 413B/40

LOCAL AUTHORITY: BUSSELTON

Notes:

RESERVE ACTION SHEET - CONSERVATION RESERVES

RESERVE No. A31188

REASON FOR ACTION

An addition to Sabina Nature Reserve (A↑ 31188), vested in the Conservation Commission for the purpose "Conservation of Flora and Fauna".

Area: 75.648 hectares

Amendment to Sabina Nature Reserve to include Sussex Location 5205, on Office of Title Plan 22210. The location is 29.637 hectares and contains important riparian vegetation. The area was ceded to the Crown for conservation purposes under Section 20A of the *Town Planning and Development Act* as part of a subdivision approval.

- Date of amendment: 10 August 2001
- Plans at folios: pp. 79, 89, 121-22
- Native title: part of a freehold subdivision
- Customer Advice: pp 120
- See folio: pp. 80 & 123

OFFICER	ACTION
---------	--------

1 **CONSERVATION ESTATE OFFICER**

Send copies of advice & maps to:

- Lisa Wright, Woodvale
- Manager, Blackwood District
- Manager, South West Region
- Melissa D'Silva, Finance

✓ 12/11/02

19/11

Recommended IUCN classification 1 a

2 **LAND ACQUISITIONS OFFICER**

to note: _____

3 **UNIT LEADER, LAND & EXTERNAL FUNDING**

to note & approve IUCN classification:
to note native title clearance: _____

4 **A/DIRECTOR, NATURE CONSERVATION**

to note: _____

5 **INDEX CLERK, RECORDS**

to note: _____

6 **CONSERVATION ESTATE OFFICER**

reserve details to
inside cover: _____

RESERVE ACTION SHEET - CONSERVATION RESERVES

RESERVE No. A31188

SHIRE: Busselton

TENURE: unnamed nature reserve (known as Sabina Nature Reserve by CALM)

REASON FOR ACTION

Lot 126 on Plan 23470 has been added to class A reserve 31188 for the purpose of "Conservation of Flora and Fauna". The reserve is automatically vested in the Conservation Commission of Western Australia pursuant to section 7 of the *CALM Act*.

Additional Area: 26.833
hectares

Total Area: 102.4819
hectares

Lot 126 was created as a condition of subdivision under Section 20A of the Town Planning and Development Act, with the land to be ceded to the State for conservation. CALM supported the addition as the land forms part of the Vasse Wonerup wetland and protects riparian vegetation at the lower end of the Sabina River.

Date of amendment: 3 December 2003
Plans at folios: pp.178-179, 161
Native title clearance: previous freehold history
IUCN classification: 1a

Customer Advice: p. 177
Folio: 170-173

	OFFICER	ACTION	
1	LAND UNIT	Send copies of advice & maps to: - Lisa Wright, Woodvale - Manager, Blackwood District - Manager, South West Region - Manager, WATSCU	_____ _____ _____ _____
2	LAND SERVICES COORDINATOR	to note:	_____
3	SENIOR POLICY OFFICER, PVS	to note native title clearance:	_____
4	DIRECTOR, NATURE CONSERVATION	to note:	_____
5	CIS	pls add to abstract that lot 126 has been added to the nature reserve	_____

RESERVE ACTION SHEET: CONSERVATION RESERVES

RESERVE No. 31188

LOCAL GOVERNMENT: Busselton

NAME : Sabina Nature Reserve

PURPOSE: Conservation of Flora and Fauna

VESTING: Conservation and Parks Commission

ACTION

Addition of Lot 2000 on Deposited Plan 75004 into Sabina Nature Reserve.

Total Area: 116.5868 to 123.2402 hectares

REASON FOR ACTION:

As a condition of freehold subdivision a portion of land (Lot 2000 on Plan 75004) was ceded to the Crown for the purpose of conservation.

Lot 2000 is part of a system of remnant vegetation surrounding the Vasse-Wonnerup Estuary and was added to Sabina Nature Reserve to fulfil the subdivision conditions and ensure the protection of the lot's conservation values.

The addition of Lot 2000 was completed on 30 May 2017.

Date of amendment: 30/05/2017

Maps: pp.15, 43-44

Customer advice: p.46

Proposal Summary: see pp. 33

IUCN classification: la

Native Title: Harris Family

1	LAND UNIT LEADER	To note	<i>bl 28/8/2017</i>
2	LAND UNIT	Send scan of RAS, customer advice, Reserve Enquiry Detail and maps to: <ul style="list-style-type: none"> • Lisa Wright (Kensington) DIGITAL COPY • District Manager DIGITAL COPY • Regional Manager DIGITAL COPY • Geoffrey Banks GIS Branch DIGITAL COPY Attach Landgate RED to file Strikethrough from District Proposals spreadsheets Create Conservation and Parks Commission summary	
3	DIRECTOR, SCIENCE AND NATURE CONSERVATION	To note	
4	C.I.S.	Please rename file/create new file Keyword: Activity: Subject: Free text:	

Customer Advices for Reserve Actions
1/04/2002 - 30/04/2002

Shire of Busselton 1/04/2002 - 30/04/2002

Reserve No.	Land Description	DOLA File No.	Volume/Folio	Action	Document No.	Registered	Street Name	Area	Public Plans
* 31188 CLASS A	Sussex Location 4646 on Office of Titles Plan 11567 Sussex Location 4564 on Office of Titles Plan 9778	02007-1970-01RO	3069-164	Amendment of Reserve to To include Sussex Location 5205 on Office of Titles Plan 22210 and its area being increased to 75.6480 hectares	H836917	10/08/2001	Estuary Waters Drive	75.648 Ha	BF29 (10) 6.7 & 6.8 (2) 27.35
38558		03544-1982-03RO	3090-133	Revocation of Management Order (Shire of Busselton) for the designated purpose of "Recreation & Community Purposes".	H665370	30/03/2001	Queen Street	6.945 sqm	BF29 (2) 24.36 & 25.36
38558	Busselton Lot 424 on Land Administration Diagram 69798	00834-2000-01RO	3090-133	Amendment of Reserve to To comprise Busselton Lot 447 on Land Administration Diagram 93977, in lieu of Busselton Lot 424, and of its area being reduced to 5.5779 hectares accordingly.	H665369	09/02/2001	Queen Street	5.5779 Ha	BF 29 (2) 24.36 and 25.36
38558		00834-2000-01RO	3111-998	Management Order to Shire of Busselton of Southern Drive BUSSELTON WA WPL 21 years for the designated purpose of "Recreation & Community Purposes"	H665372	30/03/2001	Queen Street	5.5779 sqm	BF 29 (2) 24.36 and 25.36
46187	Busselton Lot 448 on Land Administration Diagram 93977	00834-2000-01RO	3111-999	Reserve Creation for the designated purpose of "Tennis Club".	H665373	09/02/2001	near Marine Terrace	698 sqm	BF 29 (2) 24.36 and 25.36
46187		00834-2000-01RO	3111-999	Management Order to Shire of Busselton of Southern Drive BUSSELTON WA WPL 21 years for the designated purpose of "Tennis Club"	H665374	09/02/2001	near Marine Terrace	698 sqm	BF 29 (2) 24.36 and 25.36
31188 CLASS A	Sussex Location 4646 on Office of Titles Plan 11567 Sussex Location 4564 on Office of Titles Plan 9778	02007-1970-01RO	3069-164	Amendment of Reserve to To include Sussex Location 5205 on Office of Titles Plan 22210 and its area being increased to 75.6480 hectares	H836917	10/08/2001	Estuary Waters Drive	75.648 Ha	BF29 (10) 6.7 & 6.8 (2) 27.35

Duplicate *
RECORD !!

Customer Advices for Reserve Actions
1/12/2004 - 31/12/2004

Shire of Busselton 1/12/2004 - 31/12/2004

Reserve No.	Land Description	DOLA File No.	Volume/Folio	Action	Document No.	Registered	Street Name	Area	Public Plans
31188	Lot 4564 on Office of Titles Plan 9778 Lot 4646 on Office of Titles Plan 11567 Lot 5205 on Office of Titles Plan 22210	02007-1970-01RO	3069-49 3069-164 3092-12	Amendment of Reserve to include Lot 5407 on Office of Titles Plan 23470 and of its area being increased to 102.4819 Hectares	J716767	03/12/2003	Barracks Drive Sabina River	102.4819 Ha	BF29 (2) 28.36, (10) 6.8
42881	Lot 4693 on Diagram 79954	01468-1993-01RO	3046-203 3046-203	Revocation of Management Order (Shire of Busselton) for the designated purpose of "Drainage".	J077998	08/11/2004	near Queen Elizabeth Ave, West Busselton	1469 sqm	BF29 (2) 23.34
42881	Lot 4693 on Diagram 79954	01468-1993-01RO	3046-203 3046-203	Amendment of Reserve to include Lot 5573 on Deposited Plan 38070 and the area being increased to 1712 square metres.	J077999	08/11/2004	near Queen Elizabeth Ave & Links Court, West Busselton	1712 sqm	BF29 (2) 23.34
42881 42881	Lot 4693 on Diagram 79954	01468-1993-01RO	3046-203 3134-737 3134-737 3134-737	Management Order to Shire of Busselton of Locked Bag 1, BUSSELTON WA 6280 To be utilised for the designated purpose of "Drainage" only, for the designated purpose of "Drainage"	J077696	08/11/2004	near Queen Elizabeth Ave & Links Court, West Busselton	1712 sqm	BF29 (2) 23.34

(Lot 126 on Plan 23470)
26.834 ha

- TGIS dbase amended
- white folder "

GLH
19/11

**Customer Advices for Reserve Actions
1/07/2017 - 31/07/2017**

City of Busseton 1/07/2017 - 31/07/2017

Reserve No.	Land Description	DoL File No.	Volume/Folio	Action	Document No.	Registered	Street Name	Area	Public Plans
B1188	Lot 2000 on Deposited Plan 75004	02007-1970-01RO	3163-144	Amendment of Reserve to add Lot 2000 on Deposited Plan 75004 and its area being increased to 123.2402 hectares accordingly.	N635452	30/05/2017		123.2402 sqm	
52591	Lot 8002 on Deposited Plan 60330	00515-2016-01RO	3154-150	Reserve Creation for the designated purpose of "Pedestrian Accessway".	N631116	24/05/2017	Casselton Loop, Geographe	1 sqm	
52592	Lot 8001 on Deposited Plan 60330	00516-2016-01RO	3154-149 3154-149	Management Order to City of Busseton of LOCKED BAG 1 BUSSELTON WA 6280 To be utilised for the designated purpose of "Public Recreation" only, for the designated purpose of "Public Recreation"	N644298	12/06/2017	Casselton Loop, Geographe	0.0223 Ha	
52592	Lot 8001 on Deposited Plan 60330	00516-2016-01RO	3154-149	Reserve Creation for the designated purpose of "Public Recreation".	N644297	12/06/2017	Casselton Loop, Geographe	0.0223 Ha	
52593	Lot 8000 on Deposited Plan 60330	00517-2016-01RO	3154-148	Reserve Creation for the designated purpose of "Pedestrian Accessway".	N631098	24/05/2017	Dotterell Crescent, Geographe	199 sqm	
52671 52671	Lot 8021 on Deposited Plan 406545 Lot 8022 on Deposited Plan 406545	00654-2016-01RO	3167-138 3167-139 3167-138 3167-138	Management Order to City of Busseton of LOCKED BAG 1 BUSSELTON WA 6280 To be utilised for the designated purpose of "Public Recreation and Drainage" only, for the designated purpose of "Public Recreation and Drainage"	N631095	24/05/2017	Waterville Road, Dunsborough	1530 sqm	
52671	Lot 8021 on Deposited Plan 406545 Lot 8022 on Deposited Plan 406545	00654-2016-01RO	3167-138 3167-139	Reserve Creation for the designated purpose of "Public Recreation and Drainage".	N631094	24/05/2017	Waterville Road, Dunsborough	1530 sqm	
52747	Lot 120 on Deposited Plan 405345	00814-2016-01RO	3167-294 3167-294	Management Order to City of Busseton of LOCKED BAG 1 BUSSELTON WA 6280 To be utilised for the designated purpose of "Recreation for Community Facilities" only, for the designated purpose of "Recreation for Community Facilities"	N631121	24/05/2017	Napoleon Promenade, Vasse	595 sqm	
52747	Lot 120 on Deposited Plan 405345	00814-2016-01RO	3167-294	Reserve Creation for the designated purpose of "Recreation for Community Facilities".	N631120	24/05/2017	Napoleon Promenade, Vasse	595 sqm	

Comment [NM4]: Purpose checked: Conservation and Parks Commission 'Conservation of Flora and Fauna'

Comment [NM5]: Addition of Lot 2000 (condition of subdivision) to Sabina Nature Reserve A31188)

 Log Out

Quicklinks to available enquiries:

- [Crown Allotment Enquiry](#)
- [Crown Lease/Permit Conversion](#)
- [District/Town Reference Enquiry](#)
- [Duplicate Title Production](#)
- [Issuing Enquiry](#)
- [Power of Attorney Enquiry](#)
- [Reserve Enquiry](#)

- [Enquiries Help](#)

Reserve Enquiry History Result



Print Friendly Version.

Disclaimer: Results displayed are for information purposes only. Please refer to original documents for legal purposes.

Reserve: 31188 Crown Allotments/Historic Tenures

SUSSEX LOCATIONS 4564

SUSSEX LOCATIONS 4646

SUSSEX LOCATIONS 5205

Gaz-Page/Document	Date	Type	Text
1716767	03/12/2003	CA	102.4819 VESTING
1409284	11/03/2003	CV	CONSERVATION COMMISSION OF WESTERN AUSTRALIA
3118	25/08/1978	CP	CONSERVATION OF FLORA & FAUNA
3104	25/08/1978	CC	A
J122494	16/12/2004	VR	REVOKED
1409284	11/03/2003	HV	VESTING CONSERVATION COMMISSION OF WESTERN AUSTRALIA
H836917	10/08/2001	HA	75.6480
H836917	10/08/2001	LC	SUSSEX,4564,4646,5205
688	04/03/1977	HA	46.0109
688	04/03/1977	HP	PUBLIC RECREATION
4465	18/12/1987	HN	SABINA NATURE RESERVE
3106	25/08/1978	HV	VEST W A WILDLIFE AUTHORITY
279	11/02/1972	FM	FORMERLY PTN SUSSEX 1,LOT 6,P:9778
279	11/02/1972	OG	ORIGINAL GAZETTE
	01/01/0001	HP	RECREATION
	01/01/0001	MC	3.9609,P12
	11/02/1972	OA	9.3.6

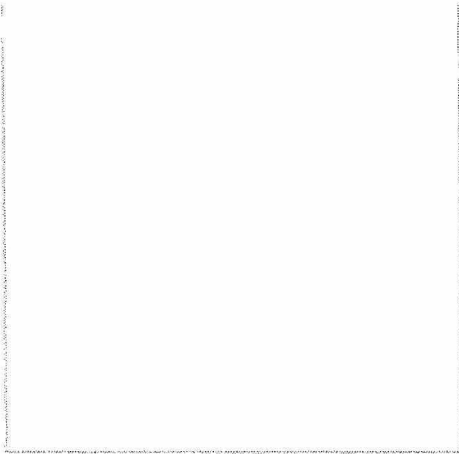

11/02/1972 PP	BUSSELTON (10) 6.8
11/02/1972 ST	BARRACKS DRIVE, SABINA RIVER
16/11/1984 HN	SAB INA NATURE RESERVE
10/08/2001 PL	SUSSEX, 4564, 4646
13/08/2001 FN	02007/1970/01RO
11/03/2003 HV	VEST: CONSERVATION COMMISSION PURSUANT TO SECTION 7 OF C A L M ACT 1984



© Copyright 2003 | [Minister for Land Information](#)
[Terms of Use](#) | [Disclaimer](#) | [Contact Us](#)
[Privacy Statement](#)

Page Updated: 9th December 2004



Landgate Survey Channel

Gateway to Western Australia's Land and Property Information

- [Home](#)
- [Start](#)
- [Tools](#)
- [Publications](#)
- [Useful Links](#)
- [Change Channel](#)
- [User Profile](#)

Quicklinks to available enquiries:

- [Crown Allotment Enquiry](#)
- [Crown Lease/Permit Conversion](#)
- [District/Town Reference Enquiry](#)
- [Duplicate Title Production](#)
- [Issuing Enquiry](#)
- [Power of Attorney Enquiry](#)
- [Reserve Enquiry](#)
- [Enquiries Help](#)

Reserve Enquiry Result



Disclaimer: Results displayed are for information purposes only. Please refer to original documents for legal purposes.

Reserve Name	Legal Area (ha)	Status
31188 No name recorded	102.4819	Current
		History

Current Purpose
CONSERVATION OF FLORA & FAUNA

Notes

Class	Responsible Agency	Last Change Date
A	EXECUTIVE DIRECTOR OF THE DEPARTMENT OF CONSERVATION & LAND MANAGEMENT	16/12/2004

Additional Reserve Information

RESERVE COMPRISES LOT 4564 ON P9778, LOT 4646 ON P11567, LOT 5205 ON P22210 & LOT 126 ON P23470 (I716767)

Management Orders/Vesting	Document	Land Use	Local Government Authority
CONSERVATION COMMISSION OF WA	1409284	CONSERVATION FAUNA PROTECTION OF FLORA	BUSSELTON, SHIRE OF

CLT Number	PI	Street Address	File Number	PIN	Area (sqm)
LR3134/804	1P023470 126		01875-2000-01RO	1296931	268339
LR3069/49	1P009778 4564	LOT 4564 OSPREY DR, REINSCOURT LOT 4646	02007-1970-01RO. 02007-	530780	39601.903

LR3069/164	1P011567 4646	TUART DR, WONNERUP	1970- 01RO.	527002	420500
LR3092/12	1P022210 5205		02007- 1970- 01RO.	1216835	296371



© Copyright 2003 | [Minister for Land Information](#)
[Terms of Use](#) | [Disclaimer](#) | [Contact Us](#)
[Privacy Statement](#)

Page Updated: 9th December 2004

Reserve Enquiry Detail [5100L]

Screen Friendly Pr

Reserve Name	31188	Legal Area (ha)	123.2402
Type	Subject to 152	Status	Current
Notes		Current Purpose	CONSERVATION OF FLORA & FAUNA
File Number	02007/1970/01RO		
Additional Reserve Information	RESERVE COMPRISES LOT 4564 ON P9778, LOT 4646 ON P11567, LOT 5205 ON P22210, LOT 126 ON P23470 & LOT 2000 ON DP75004 (N635452)		

Class	Responsible Agency	Date of Last Change
A	DEPARTMENT OF PARKS AND WILDLIFE	11/07/2017

Management Orders	Document	Land Use	Local Government Authority
CONSERVATION COMMISSION OF WA	I409284	CONSERVATION FAUNA PROTECTION OF FLORA	BUSSELTON, CITY OF

Add Item	CLT Number	Parcel Identifier	Street Address	Suburb	File Number	PIN	Area (sqm)	Map
<input type="checkbox"/>	LR3069-49	Lot 4564 On Plan 9778			02007-1970-01RO.	530780	180657.95	
<input type="checkbox"/>	LR3069-164	Lot 4646 On Plan 11567			02007-1970-01RO.	527002	420500.0	
<input type="checkbox"/>	LR3092-12	Lot 5205 On Plan 22210			02007-1970-01RO.	1216835	291640.073	
<input type="checkbox"/>	LR3134-804	Lot 126 On Plan 23470			01875-2000-01RO	1296931	232994.114	
<input type="checkbox"/>	LR3163-144	Lot 2000 On Plan 75004			02007-1970-01RO	12011669	66534.0	

Reserve Number 31188

Previous Certificates of Title	Historic Crown Allotments		
	SUSSEX	Location	4564
	SUSSEX	Location	4646
	SUSSEX	Location	5205

Gaz Page/Document	Date	Type	Text
N635452	30/05/2017	Current Area	123.2402
J122494	16/12/2004	Vesting Revoked	REVOKED
I716767	03/12/2003	Historical Area	102.4819
I409284	11/03/2003	Current Vesting	VEST CONSERVATION COMMISSION OF WESTERN AUSTRALIA
I409284	11/03/2003	Historical Vesting	VESTING CONSERVATION COMMISSION OF WESTERN AUSTRALIA
	11/03/2003	Historical Vesting	VEST: CONSERVATION COMMISSION PURSUANT TO SECTION 7 OF C A L M ACT 1984
	13/08/2001	Correspondence File Number	02007/1970/01RO
H836917	10/08/2001	Historical Area	75.6480
H836917	10/08/2001	Location	SUSSEX,4564,4646,5205
	10/08/2001	Previous Lot/Locations	SUSSEX,4564,4646
4465	18/12/1987	Historical Name	SABINA NATURE RESERVE
	16/11/1984	Historical Name	SABINA NATURE RESERVE
3104	25/08/1978	Class	A
3106	25/08/1978	Historical Vesting	VEST W A WILDLIFE AUTHORITY
3118	25/08/1978	Current Purpose	CONSERVATION OF FLORA & FAUNA

688	04/03/1977 Historical Area	46.0109
688	04/03/1977 Historical Purposes	PUBLIC RECREATION
279	11/02/1972 Formerly	FORMERLY PTN SUSSEX 1,LOT 6,P:9778
279	11/02/1972 Original Gazettal and page	ORIGINAL GAZETTE
	11/02/1972 Original Area	9.3.6
	11/02/1972 Public Plan	BUSSELTON (10) 6.8
	11/02/1972 Street Name	BARRACKS DRIVE,SABINA RIVER
	01/01/0002 Historical Purposes	RECREATION
	01/01/0002 Metric Conversion	3.9609,P12

This product is for information purposes only. A search of the original documentation is required for all legal purposes
Western Australian Land Information Authority (Landgate)

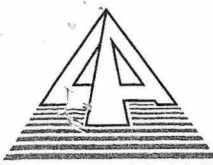

DOLA

Department of LAND ADMINISTRATION

FILE REFERENCE No:

028458F3102

MIDLAND SQUARE, MIDLAND
WESTERN AUSTRALIA
Postal Address: PO Box 2222
Midland, Western Australia 6056

Your Ref:

Our Ref: 2007/970 (Job No. 990483) TT:LM

Telephone: (08) 9273 7300 Fax: (08) 9273 7682

Enquiries: MR T THOMSON

Email: trevor_thomson@dola.wa.gov.au



Executive Director
Conservation and Land Management
50 Hayman Road
COMO WA 6152

Dear Sir

CLASS "A" RESERVE NO. 31188 - VASSE ESTUARY

Class "A" Reserve No. 31188 is set apart for the purpose of "Conservation of Flora and Fauna" and is managed by the Western Australian Wildlife Authority, subject to the condition that the public has access thereto.

Pursuant to Section 20A of the Town Planning and Development Act Lot 136 (re-described as Sussex Location 5205) containing 29.6371 ha was ceded to the Crown as part of a freehold subdivision for conservation purposes. Please find enclosed a copy of Office of Titles Plan showing Lot 136 bordered red.

It is proposed to amend Class "A" Reserve 31188 to include the area of Lot 136 and to issue a fresh Management Order in favour of the National Parks and Nature Conservation Authority to contain the composite area under the provisions of the Land Administration Act 1997.

*necessary?
see
p. 131.*

I would be pleased to obtain your comments in relation to the proposal.

Section 45(2)(a) requires the approval of the Minister for the Environment and this approval is sought prior to DOLA proceeding with further action to comply with the LAA in relation to the proposal.

Yours faithfully

Trevor Thomson
TREVOR THOMSON
FOR REGIONAL MANAGER
SOUTH-WEST SERVICES
LAND ADMINISTRATION SERVICES BRANCH

18 February 2000

CONSERVATION ESTATE OFFICER
LAND ADMINISTRATION SECTION
PARK POLICY AND TOURISM BRANCH

'A' Reserve 31188 within SOUTH WEST / BLACKWOOD Region/District, was
created/amended, effective from 10 ~~OCTOBER~~ 2001.
AUGUST.

Copies of notification of this action and amended plans have been placed at
folios 79, 120-123 md.

Would you please advise the relevant offices of this amendment through your
Reserve Action Sheet.



Program Leader
Tenure Group, GIS
Information Management Branch

24.6.02

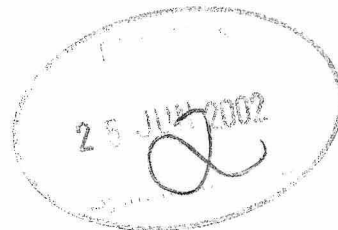

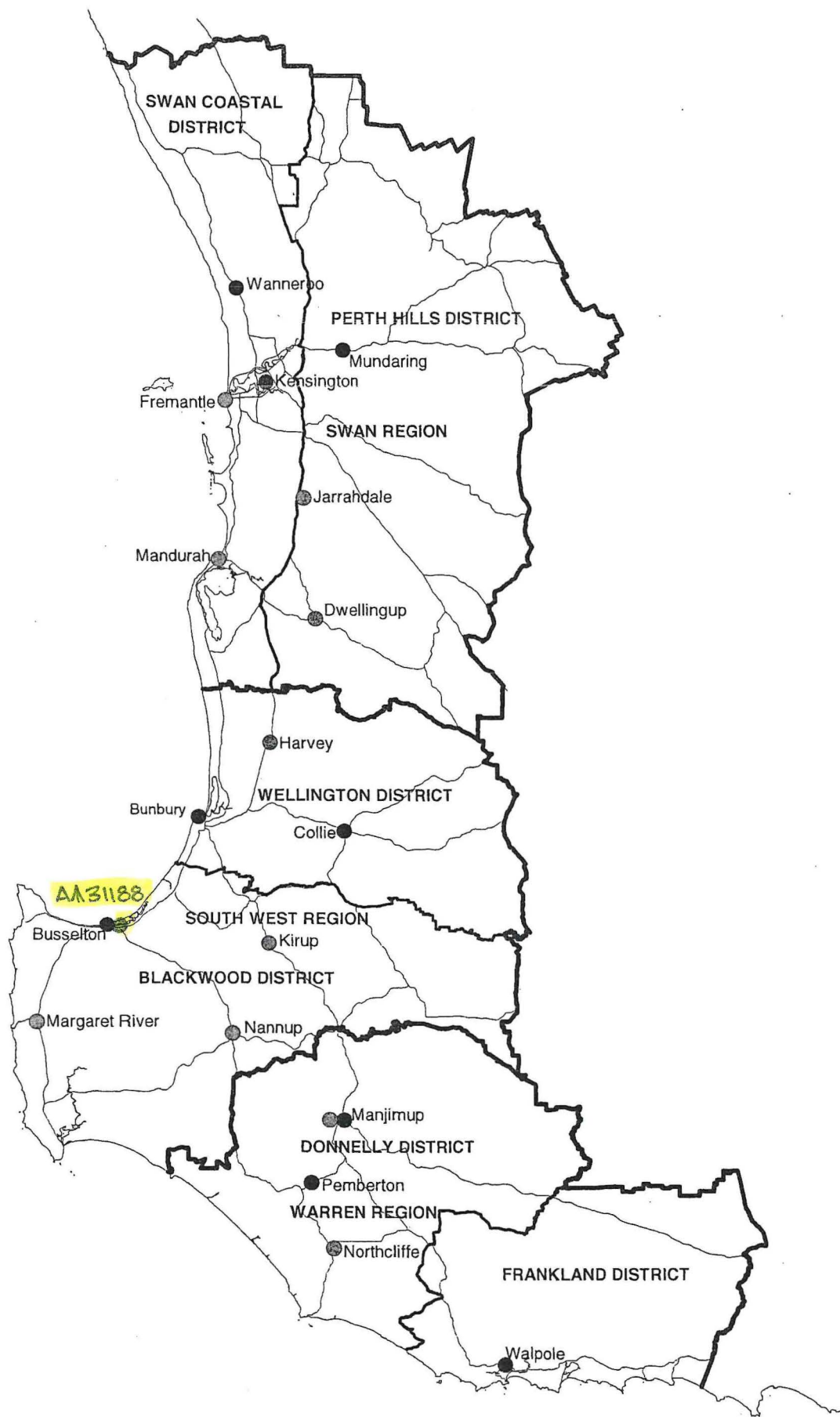

**DEPARTMENT OF CONSERVATION AND LAND MANAGEMENT
REGION AND DISTRICT BOUNDARIES - SOUTH WEST W A
OCTOBER 2001**

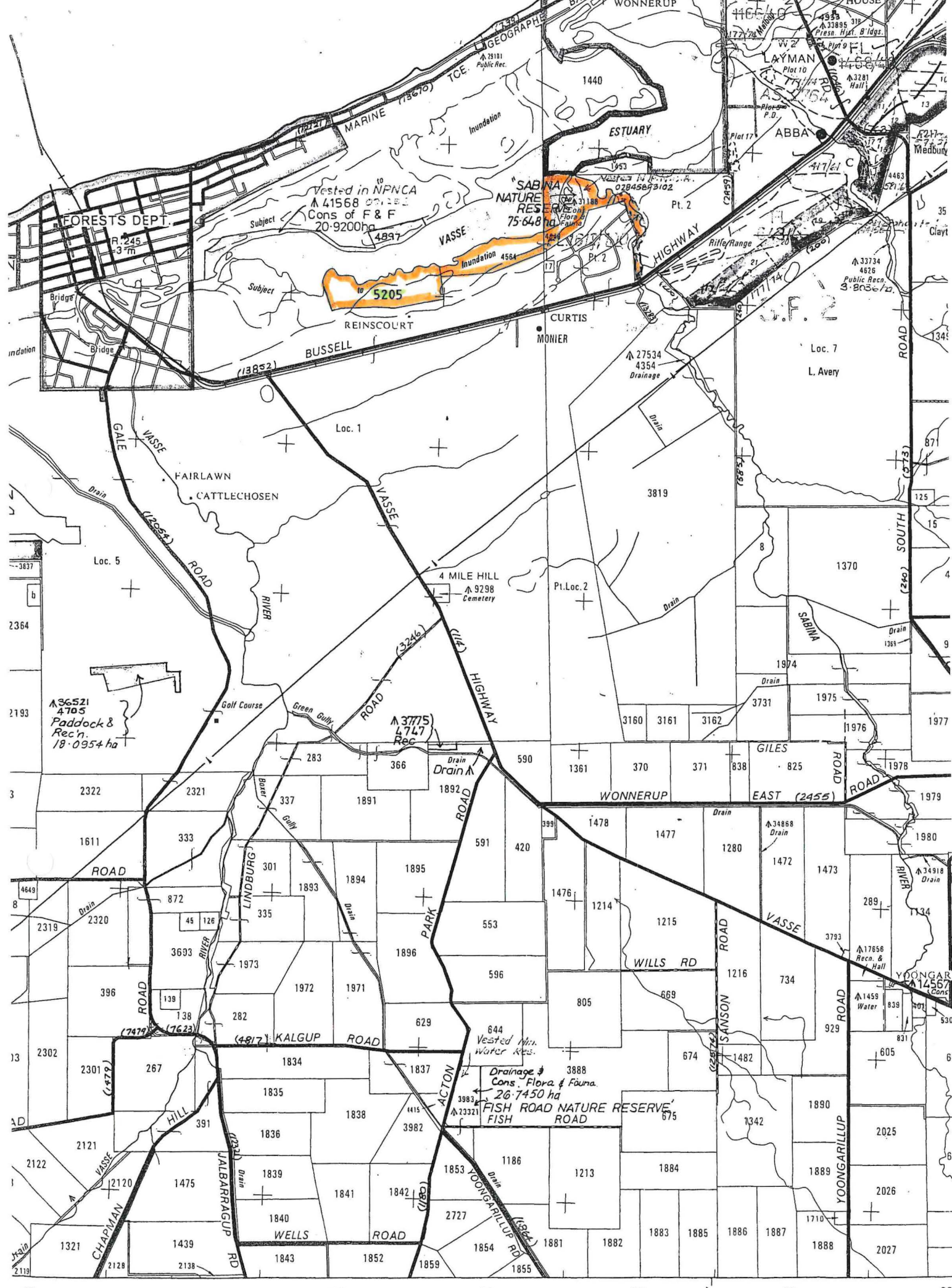

Pt BUSSETON
SCALE 1:50000

350,000 m

ADDITION OF SUSSEX LOCATION 5205 TO SABINA NATURE RESERVE (AT 31188)

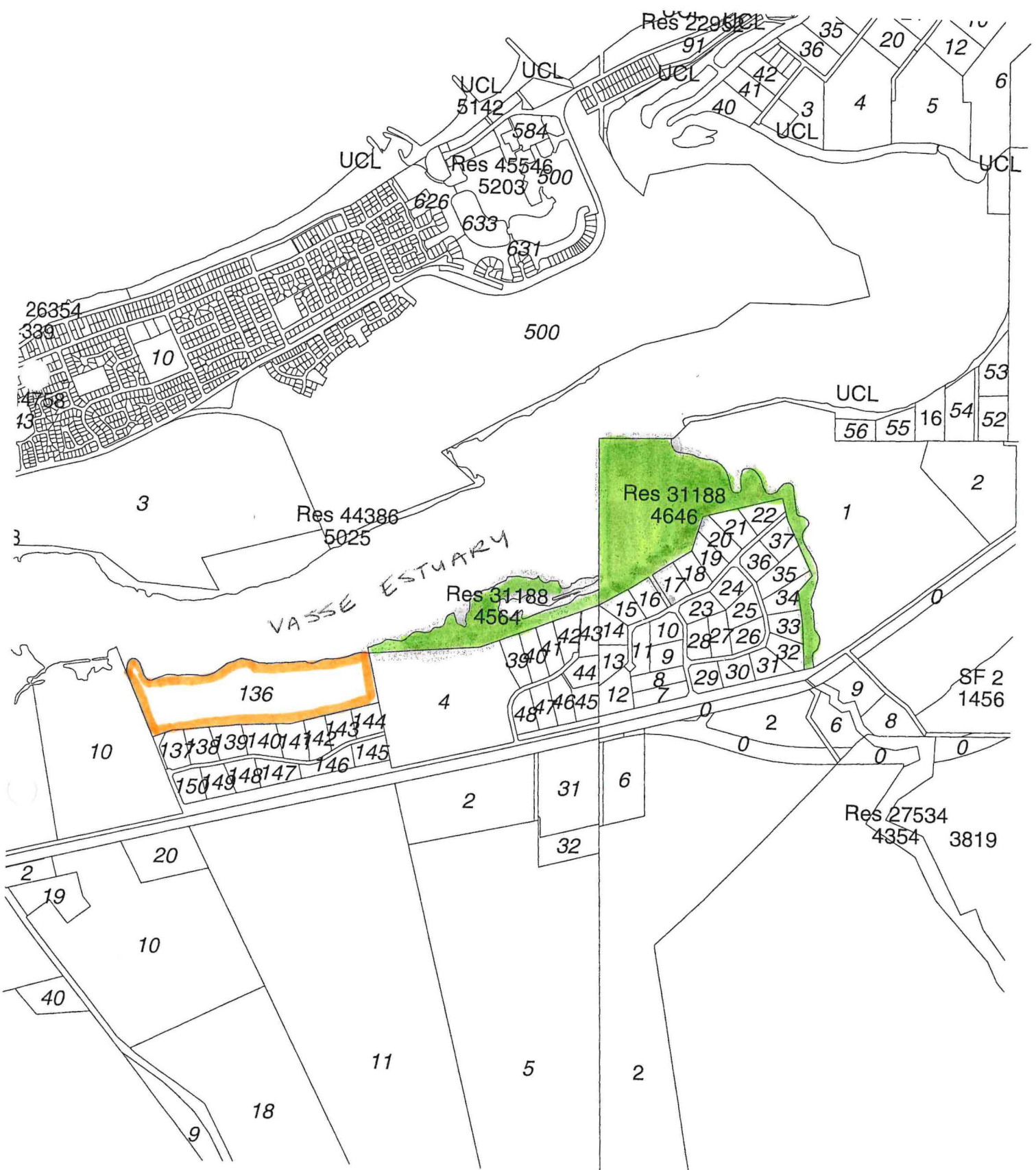

Sabina Nature Reserve (AT 31188)



Sussex Loc. 5205 (previously Lot 136)

LAND DESCRIPTION	ON	CERTIFICATE OF TITLE	FIELD BOOK	TOTAL AREA
Pt LOT 20 OF SUSSEX LOCATION 1	PLAN DIAGRAM 45876 (INDEX OF 2001 & BUSSELTON SE, SW (25) PUBLIC	VOLUME FOLIO 2000 179	73873	320756Ha

PLAN 22210

LOCAL AUTHORITY: SHIRE OF BUSSELTON
 LOCALITY: EAST BUSSELTON

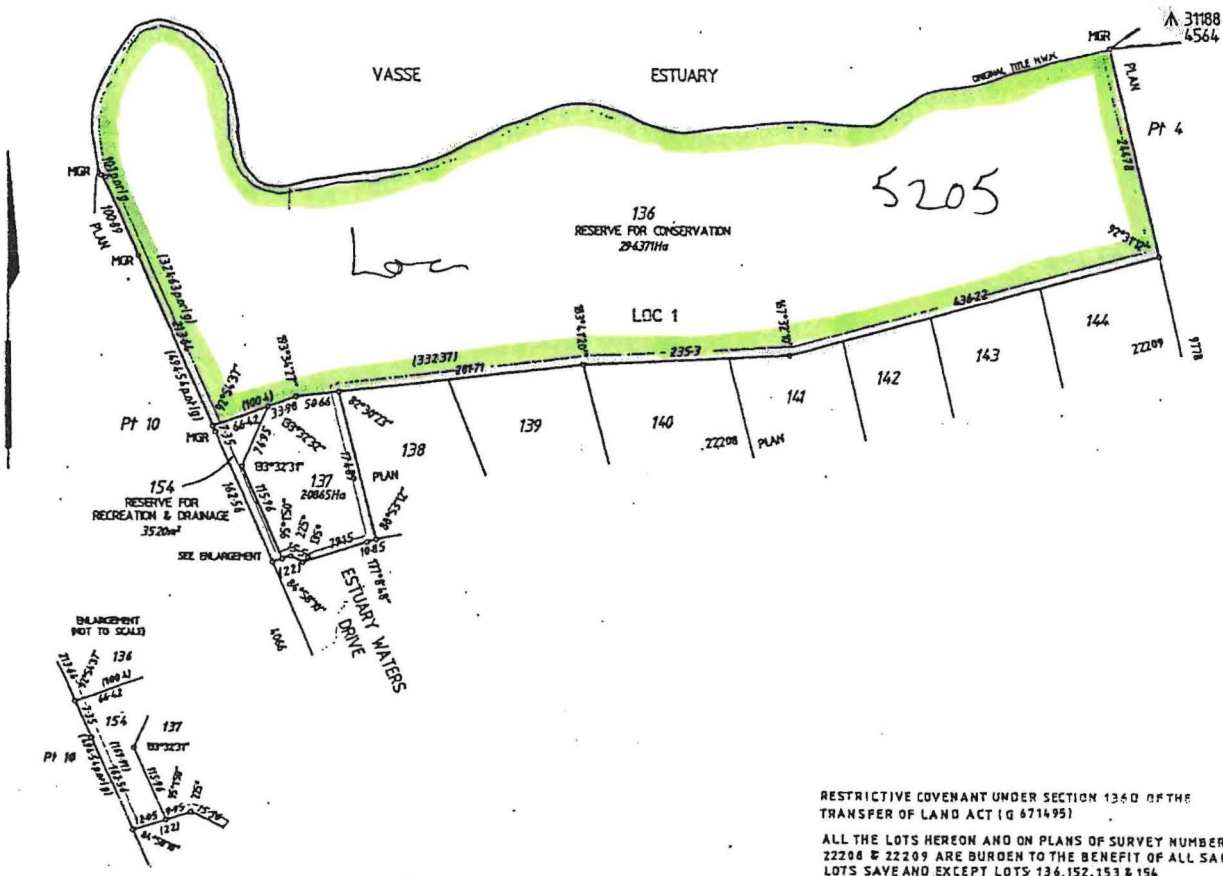

RE-CERTIFIED CORRECT
 (RESTRICTIVE COVENANT)
 22-12-97
 FOR INSPECTOR OF PLANS & SURVEYS

RESTRICTIVE COVENANT UNDER SECTION 1340 OF THE TRANSFER OF LAND ACT (G 671495)
 ALL THE LOTS HEREON AND ON PLANS OF SURVEY NUMBERED 22208 & 22209 ARE BURDEN TO THE BENEFIT OF ALL SAID LOTS SAVE AND EXCEPT LOTS 136, 152, 153 & 154

WATER BOUNDARIES ON THIS PLAN MAY NOT BE DEPICTED ACCURATELY
 LOT 154, RESERVE FOR CONSERVATION & LOT 154, RESERVE FOR RECREATION & DRAINAGE TO VEST IN THE CROWN UNDER SECTION 20A OF THE T.P. & D. ACT

MO - NPCCA

BUSSELTON SURVEY OFFICE
 LIC. SURVEYORS & PROJECT MANAGERS
 72 SUSSEX STREET, BUSSELTON
 WA 6155-1000 FAX 9438-1000

SURVEYOR'S CERTIFICATE

I, the undersigned, being a duly qualified and licensed Surveyor, do hereby certify that this plan of survey is a correct and accurate representation of the survey carried out and recommended under my personal supervision, inspection and field check, and recorded in field books lodged for the purposes of this plan of survey. The measurements are in metric accordance with the Licensed Surveyors' Guide to Surveying Regulations 1981 and in accordance with the regulations 22 and 23 of those regulations, and this survey and this plan of survey are in strict accordance with the requirements of the Licensed Surveyors' Guide to Surveying Regulations 1981 and the relevant law in relation to which it is lodged.

Licensed Surveyor: *[Signature]*

APPROVED BY STATE PLANNING COMMISSION

FILE 99782
[Signature]
 FOR CHAIRMAN
 DATE 22/12/97
 99782
 LODGED
 DATE 16-10-97
 FEE PAID \$248

SCALE 1: 4000
 ALL DISTANCES ARE IN METRES

IN ORDER FOR DEALINGS

APPROVED 18/1/98

OFFICE OF TITLES
 PLAN
22210

LAND DESCRIPTION
 Pt. LOT 1 OF SUSSEX LOCATIONS
 1453 & 2

PLAN	DIAGRAM	INDEX	PUBLIC.	ON	CERTIFICATE OF TITLE	FIELD BOOK	TOTAL AREA
74331		BE. 22. 131. & B.		W/1 UNF	FOUO	78421	2772011a
				1816	550		
				P/W 2178	938		

PLAN 23470
 161
 1238

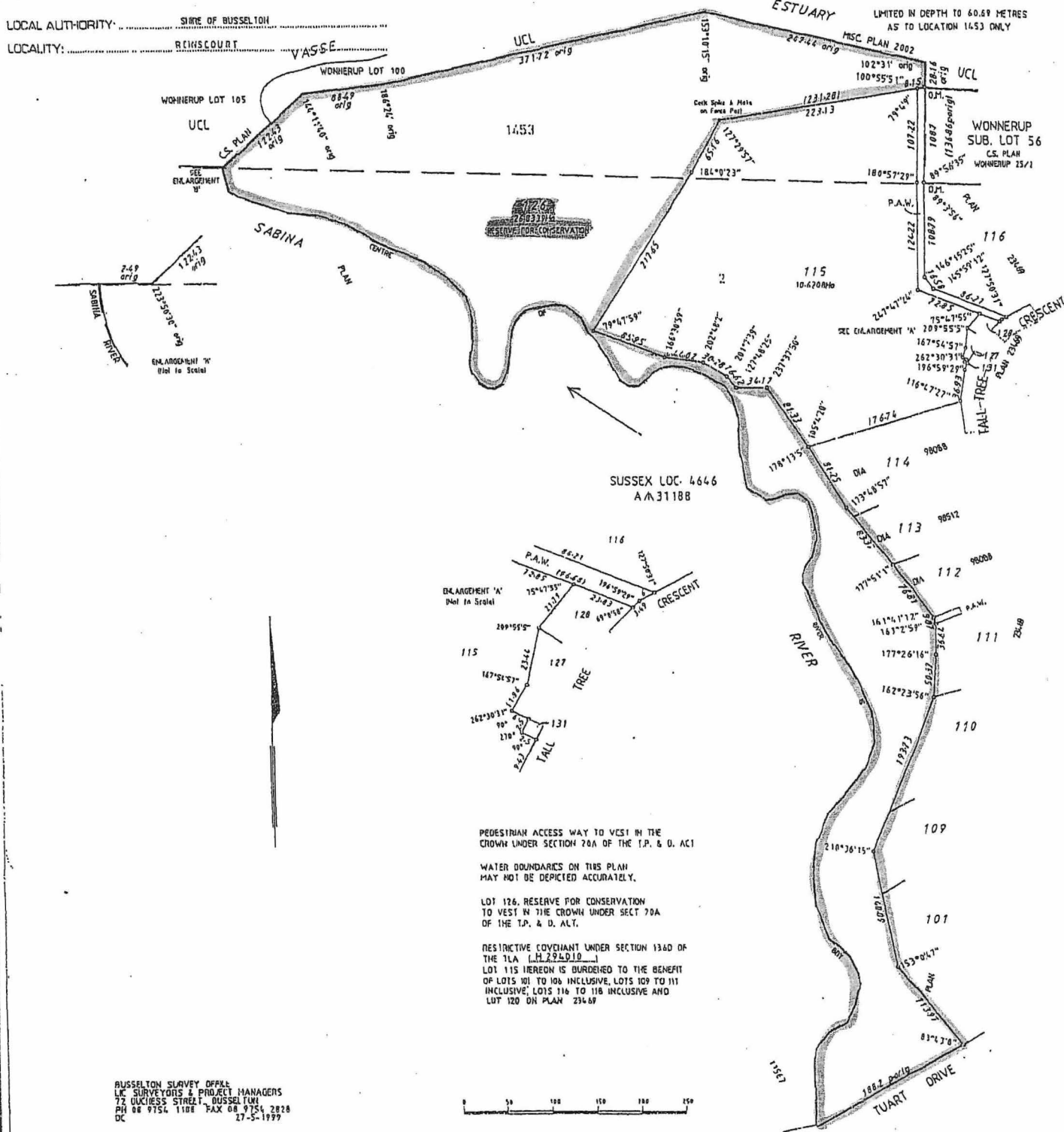

RUSSELLTON SURVEY OFFICE
 LIC. SURVEYORS & PROJECT MANAGERS
 72 GURNESS STREET, BUSSELTON
 PH 08 9754 1108 FAX 08 9754 2828
 DC 27-5-1999

PEDESTRIAN ACCESS WAY TO WEST IN THE CROWN UNDER SECTION 20A OF THE T.P. & D. ACT
 WATER BOUNDARIES ON THIS PLAN MAY NOT BE DEPICTED ACCURATELY.
 LOT 126, RESERVE FOR CONSERVATION TO VEST IN THE CROWN UNDER SECT 20A OF THE T.P. & D. ACT.
 RESTRICTIVE COVENANT UNDER SECTION 136D OF THE TLA (M.284010) LOT 115 HEREON IS BURDENED TO THE BENEFIT OF LOTS 101 TO 106 INCLUSIVE, LOTS 109 TO 111 INCLUSIVE, LOTS 116 TO 118 INCLUSIVE AND LOT 120 ON PLAN 23469

SURVEYOR'S CERTIFICATE—Reg 54
 I, *Michaela Grace, Chartered*, hereby certify that this plan is a correct representation of the survey and/or calculations from measurements recorded in the field book lodged for the purpose of this plan and that it complies with the relevant provisions of the Act in relation to which it is lodged.
 Licensed Surveyor Date 15-11-99

SURVEYOR'S CERTIFICATE—Compiled
 I, *Michaela Grace, Chartered*, hereby verify that this compiled plan—
 (a) is a correct and accurate representation of the survey(s) of the subject land and
 (b) is in accordance with the relevant law in relation to which it is lodged.
 Licensed Surveyor Date

APPROVED BY
WESTERN AUSTRALIAN PLANNING COMMISSION
 FILE NO. 108786
Eugene Thomas CHAIRMAN
 DATE 25/10/1999

EARLY REVIEW LOUDED DATE 20-11-99
 FEE PAID \$200 ASSESS No. 244444

TYPE OF VALIDATION
 TIAL ALPH LEGAL COMPONENT CHECKED BY ANY CHAIRMAN CERTIFIED CORRECT F.O.C. DATE 19/11/99

SCALE 1 3000
 ALL DISTANCES ARE IN METRES
 IN ORDER FOR DEALINGS
 SUBJECT TO:
 Prior approval of Plans 21469,
 See 136 D T.L.A. =
 See 20A T.P. & D. Act

FOR INSPECTOR OF PLANS & SURVEYS
 APPROVED 29-11-99
 INSPECTOR OF PLANS & SURVEYS DATE

DOLA
 OFFICE OF TITLES
 PLAN
23470

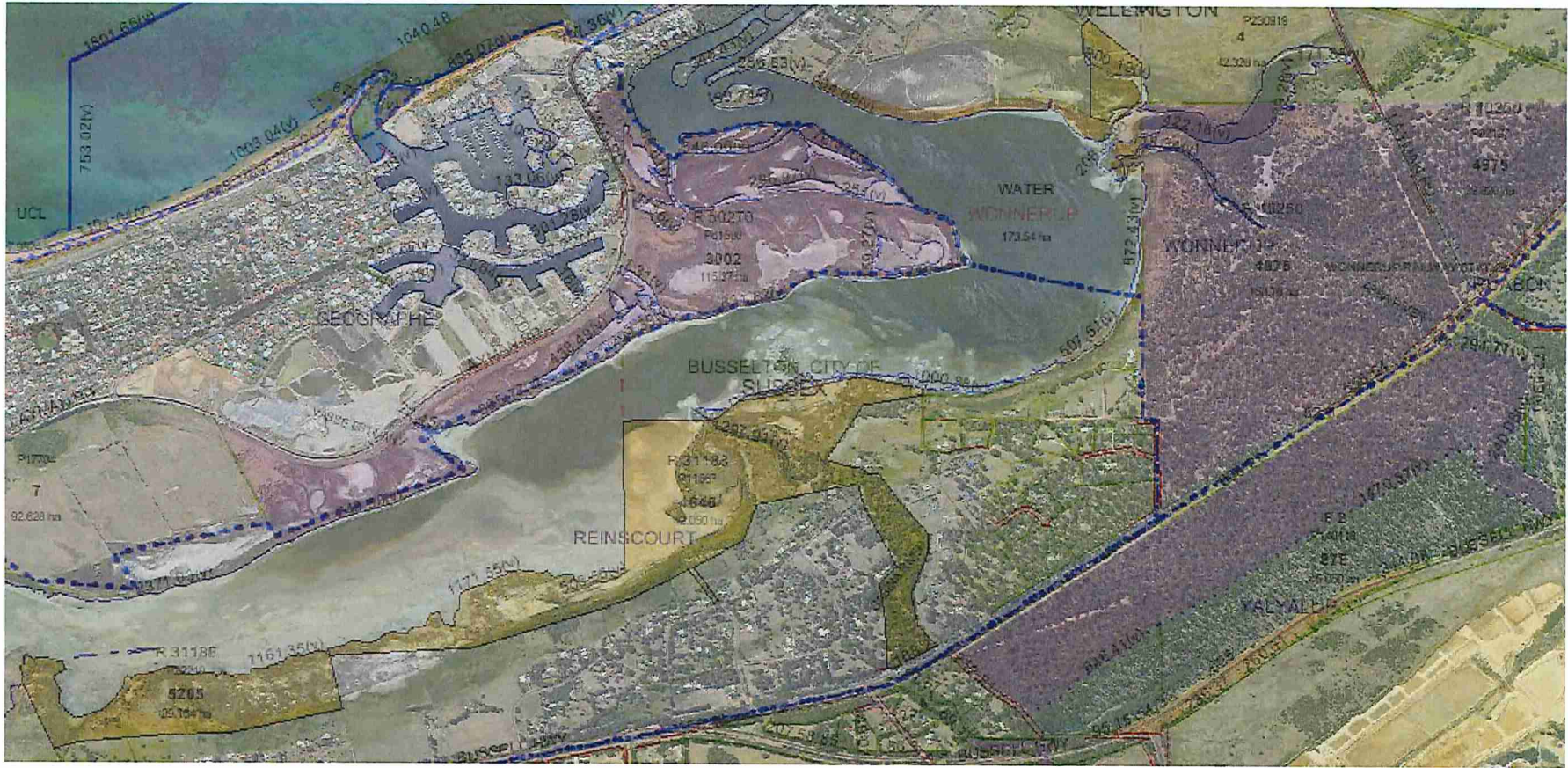

Landgate MAP VIEWER Close Window

Window Show/Hide | Cadastral Parcels

Catalogue (tick box to select) help

- Property View
- Aerial Photography
- Street Maps

Service Details - Property View help

Transparency Legend Search

Layers Crown Reserve

Number:

Search Type:

Submit Reset





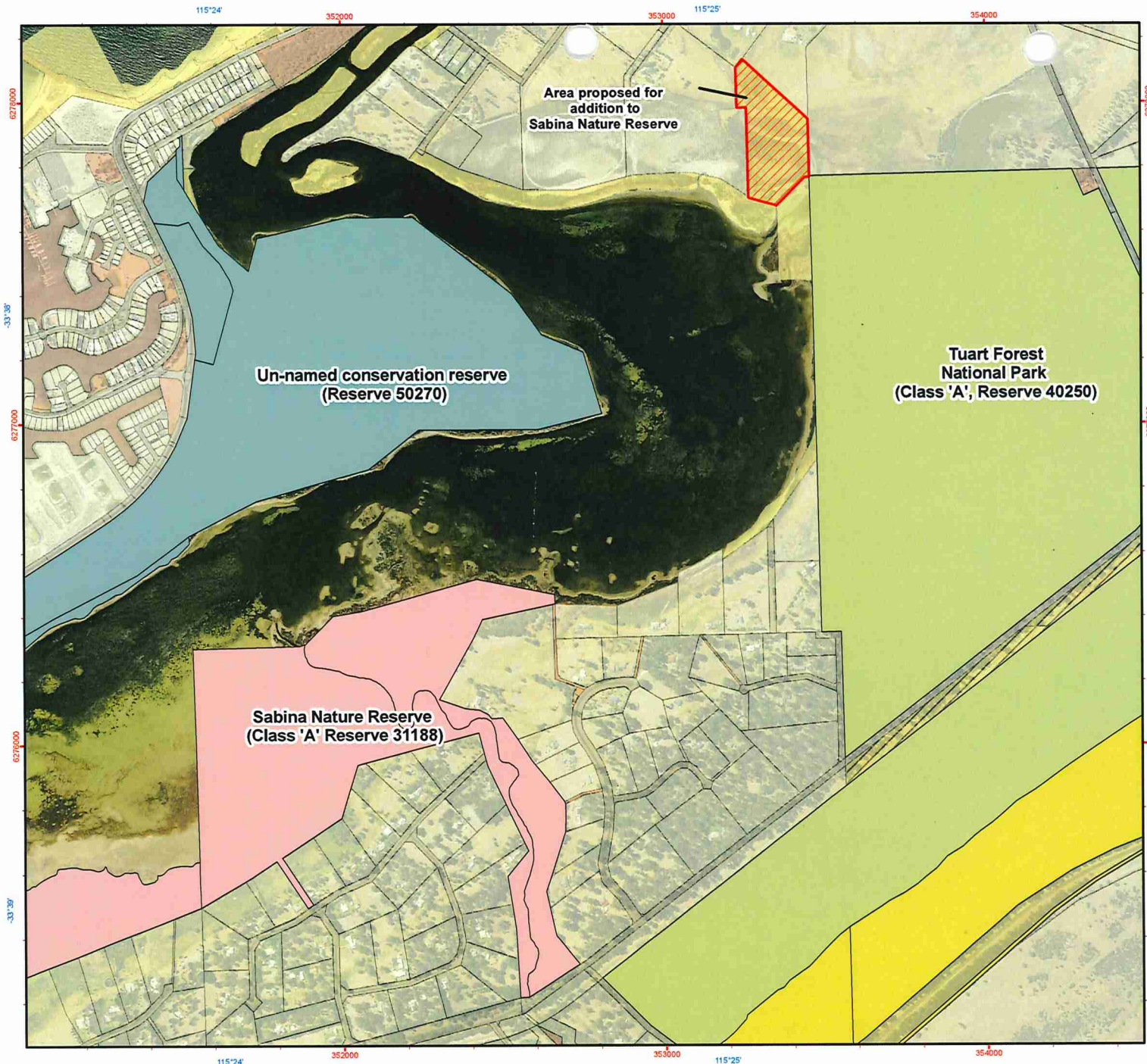



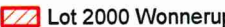

Map help

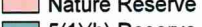
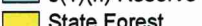
Scale 1: 26,236 Latitude: -33.641302 Longitude 1 record selected



**Lot 2000 on Deposited Plan 75004
Proposed addition to
Sabina Nature Reserve
(Class 'A', Reserve 31188)**

Legend

-  Lot 2000 Wonerup
-  National Park
-  Nature Reserve
-  5(1)(h) Reserve
-  State Forest
-  Crown Reserve
-  State Forest / Timber Reserve
-  Freehold
-  Unallocated Crown Land
-  Public Roads
-  Other Public Lands



1:12,065

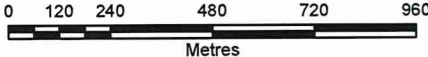

Projection: Universal Transverse Mercator
MGA Zone 50, Datum: GDA94



Produced by the
Department of
Parks and Wildlife



Graticule shown at 1 minute intervals
Grid shown at 1000 metre intervals

The Dept. of Parks and Wildlife does not guarantee that this map is without flaw of any kind and disclaims all liability for any errors, loss or other consequence which may arise from relying on any information depicted.
Roads and tracks on land managed by DP&W may contain unmarked hazards and their surface condition is variable. Exercise caution and drive to conditions on all roads.

Produced at 9:39am, on July 15, 2016