

NATURE RESERVE

RESERVE NO: 31675

GOVERNMENT GAZETTE
Date Page No.

FILE NUMBER: 551/72

PURPOSE: Cons. of Flora & Fauna 8.12.72 4625

NAME: Wanagarran^e N/R 29.5.81 1623

CLASS (Land Act):

AREA: 11 137.5 ha 12.12.80 4225

VESTING: W.A.W.A. 8.12.72 4614

LOCATION NO(S): Melbourne 3980

CLASSIFICATION:
(Wildlife Act
Section 12A)

LITHO: 59/80

LOCAL AUTHORITY: DANDARAGAN SHIRE

Notes:

Report Name: Gazettal History

Query Criteria

Crown Reserve No. = 31675

Special Comments

Crown Reserve **31675**

Class: **C**

Name: **Wanagarren Nature Reserve**

Name Approval: **Gazetted**

Tenure: **Nature Reserve** Area: **11,062.5 ha**

Purpose: **Conservation Of Flora And Fauna**

Vesting: **National Parks And Nature Conservation Authority**

<u>Date</u>	<u>Gazettal Action</u>	<u>Description</u>
21 Feb-1995	Area	About 11062.5000 --
2 Feb-1995	Public Plan	Wongonderrah;Walyengarra 1:50000, Wedge Island(50)
12-Oct-1984	Area	11069.4272 By Rd 17252
29-May-1981	Name	Wanagarren Nature Reserve
12-Dec-1980	Area	Abt 11137.5000
16-Sep-1977	Area Excision	Abt 9283.9643
08-Dec-1972	Class	C
08-Dec-1972	DOLA File	1492/72
08-Dec-1972	Location	Melbourne, 3980
08-Dec-1972	Original Area	Abt 9550.0000
08-Dec-1972	Purpose	Conservation Of Flora & Fauna
08-Dec-1972	Street	Nr Lancelin Tste
08-Dec-1972	Survey No.	Res. Plan 182
08-Dec-1972	Vesting	W A Wildlife Authority
08-Dec-1972	Original Gazettal	

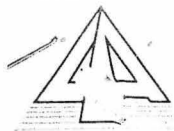

DOLA

Department of LAND ADMINISTRATION

MIDLAND SQUARE, MIDLAND
WESTERN AUSTRALIA
Postal Address: PO Box 2222
Midland, Western Australia 6056

Your Ref:

Our Ref: 1492/1972

Telephone: 273 7286

Enquiries: Mr N.BUKHARY

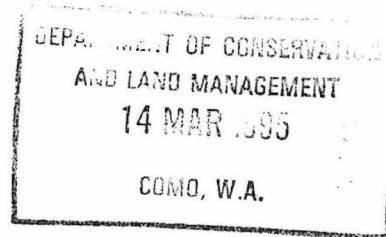

EXECUTIVE DIRECTOR
DEPARTMENT OF CONSERVATION
AND LAND MANAGEMENT
PO BOX 104
COMO 6152.

Dear Sir

Reserve 31675

I advise for your information that Executive Council has approved the amendment of Reserve 31675 (Melbourne Location 3980) "Conservation of Flora and Fauna" to exclude that portion now comprised in Location 4153 on Reserve Diagram 1283 and of its area being reduced accordingly.

Notice to this effect was published in the Government Gazette dated and I enclose a print showing the said reserve.

Yours faithfully,

J. S. BURGES
A/MANAGER
ACQUISITIONS, ROADS AND RESERVES
LAND OPERATIONS DIVISION



9 March 1995

Encl

C C SHIRE OF DANDARAGAN FOR INFORMATION
03NBAR18

RESERVE GAZETTAL

Reserves Clerk,
Land Administration Branch. *MLL*

Reserve No. 31675 has been amended/~~created~~ in the Government Gazette of
24.2.1995

Copies of the relevant gazettal notices and plans are at folios 28, 31, 39 and 40

Our records have been amended. Please initiate your Reserve Gazettal Action Sheet for Regions and Districts.

Shanan Colliss

28.6.95.

for
Project Leader - Tenure,
Land Information Branch.

Date

MLL
Mr Ryan, 11.9.95

I believe that the new area quoted in the gazettal notice of 24.2.95 for 31675 is in error. It appears that the 75 ha excised has been subtracted from the area as it stood in December 1980, rather than the area as it was in October 1984 (see copy of Gazettal History which is extracted from DOLA's Crown Reserve Register at plio 41.) The correct area should be abt. 10994.4272 ha.

Would you please inform DOLA of the discrepancy so that a corrigendum can be issued.

DEPARTMENT OF CONSERVATION AND LAND MANAGEMENT

HEAD OFFICE
HACKETT DRIVE CRAWLEY
WESTERN AUSTRALIA
Phone (09) 442 0300
Facsimile (09) 386 1578

STATE OPERATIONS HEADQUARTERS
50 HAYMAN ROAD COMO
WESTERN AUSTRALIA
Phone (09) 334 0333
Facsimile (09) 334 0466
Teletype (09) 334 0546

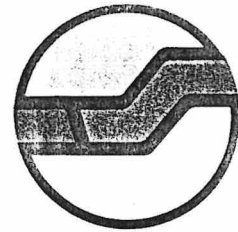

#8

Please address all correspondence to Executive Director, P.O. Box 104, COMO W.A. 6152

Your Ref: 1492/972
Our Ref: 035957F3102
Enquiries: Mr N. Ryan
Phone: 3340220

Chief Executive
Department of Land Administration

RESERVE C31675 - AREA DISCREPANCY

^{P. 28}
It has come to my attention the area quoted in the most recent gazettal notice of 24 February 1995 is incorrect. It is apparent the 75 ha quoted has been subtracted from the area as it stood in December 1980, rather than the area as described in October 1984. The correct area should be about 10994.4272 ha.

^{P. #1, 28,}
Attached for your information is a copy of the gazettal history together with the relevant gazettal notices.

I would appreciate your comments on the above together with action for the appropriate corrigendum to be published in the next available Govt Gazette.

MRR
For Syd Shea
EXECUTIVE DIRECTOR
11 September 1995

B/np. 11-2-96
Resumes clerk

MRR

note: action sheet yet to be initiated. - f. #2



DOLA

Department of LAND ADMINISTRATION

Your Ref: 035957F3102

Our Ref: 1492/972

Telephone: 273 7286 Fax: 273 7683

Enquiries: Tina Richard

**EXECUTIVE DIRECTOR
DEPARTMENT OF CONSERVATION
& LAND MANAGEMENT**

Attention: Mr N Ryan

Dear Sir

RESERVE NO. 31675 - AMENDMENT OF AREA

Thank you for your letter of 11 September 1995, advising of the discrepancy in the area of Reserve No. 31675.

A correction notice amending the area to 10994.4272 hectares was published in the Government Gazette dated 12 January 1996. Please find a copy of the Gazette notice enclosed.

Yours faithfully

for **K EMROSE
A/MANAGER
ACQUISITIONS, ROADS & RESERVES
LAND OPERATIONS DIVISION**

17 January 1996

Enc.

01TRRE01

035957F3102.

90

MIDLAND SQUARE, MIDLAND
WESTERN AUSTRALIA
Postal Address: PO Box 2222
Midland, Western Australia 6056

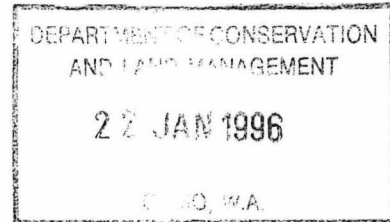

032 71 77 3102

8

DOLA File 2633/981.

Reserve No. 13438 (Williams District) "Excepted from Sale" to comprise Location 15824 as surveyed and shown bordered red on Land Administration Diagram 91762 in lieu of Location 10260 and of its area being increased to 175.5450 hectares accordingly.

Public Plan: Kukerin NW (25). Boundary Road.

Local Authority—Shire of Dumbleyung.

DOLA File 1575/918V2.

Reserve No. 17711 (Victoria Locations 7019 and 9726) "Water Supply Purposes" to exclude:

- (a) that portion now comprised in Location 11979 as surveyed and shown bordered red on Land Administration Diagram 91947
- (b) Locations 11508 and 11509 and of its area being reduced to 2247.3541 accordingly.

Public Plans: Nanson SE and Eradu SW (25). Geraldton Mount Magnet Road.

Local Authority—Shire of Greenough.

DOLA File 2168/969V2.

Reserve No. 18865 (Victoria District) "Excepted from Sale" to exclude that portion containing about 111.5000 hectares now comprised in Victoria Location 12007 as shown delineated and bordered red on Land Administration Miscellaneous Plan 1865 and of its area being reduced to about 1736.0018 hectares accordingly.

Public Plan: Boullanger and Hill River (50). near Jurien Road.

Local Authority—Shire of Dandaragan.

DOLA File 2831/925V2.

Reserve No. 19206 (Melbourne District) "Public Utility" to comprise Melbourne Location 4154 and Victoria Locations 12007 and 12008 as shown delineated and bordered red on land Administration Miscellaneous Plan 1865 and of its area being increased to about 1913 hectares accordingly.

Public Plans: Lesueur & Pt Green Head, Boullanger & Hill River (50) and BF39 (10) 1.1 and 1.2.

Local Authority—Shire of Dandaragan.

DOLA File 1616/939.

Reserve No. 24464 (Norseman Lots 723 and 724) "Public Utility" to exclude Lot 724 and of its area being reduced to 961 square metres accordingly.

Public Plan: Norseman 09.38 & 10.38 (2) Princep Street.

Local Authority—Shire of Dundas.

DOLA File 5153/948V8.

Reserve No. 24496 (Victoria Locations 3940, 9947, 10200, 11295 and 11928) "Protection of Flora" to exclude that portion containing about 788 hectares now comprised in Location 12007 as shown delineated and bordered red on Land Administration Miscellaneous Plan 1865 and of its area being reduced to about 68236.0215 hectares accordingly.

Public Plans: BE40 (2) 37.33, (10) 8.1 and 8.2, Beagle Island, Logue and Mount Lefroy, Lesueur and Pt Green Head (50) and Dongara NE & SE (25).

Local Authority—Shires of Carnamah, Dandaragan, Irwin and Coorow.

DOLA File 2559/965.

Reserve No. 28623 (Victoria Locations 10950 and 11900) "Public Recreation" to exclude Location 10950 and of its area being reduced to 4070 square metres accordingly.

Public Plan: BE43 (2) 16.18. Webberton Road.

Local Authority—City of Geraldton.

DOLA File 1492/972.

Reserve No. 31675 (Melbourne Location 3980) "Conservation of Flora and Fauna" to exclude that portion containing about 75 hectares now comprised in Location 4153 as shown delineated and bordered red on Land Administration Reserve Diagram 1283 and of its area being reduced to about 11062.5000 hectares accordingly. Area in error - see folio 42

Public Plan: Wedge Island (50).

Local Authority—Shire of Dandaragan.

DOLA File 2361/966.

Reserve No. 31993 (Canning Locations 2096, 2460, 2499, 2899, 3085 and 3188) "Bird Sanctuary and Park" to include:

- (i) Canning Location 3933 (formerly portion of Canning Location 16 and being Lot 10 on LTO Diagram 52712)
- (ii) Canning Location 3934 (formerly portions of Canning Location 16 and being Lots 7 - 9 inclusive, 12, 20, 22, 505 and 506) and of its area being increased to 16.1967 hectares accordingly.

Public Plan: BG34 (2) 21.10, 21.11, 22.10 and 22.11.

Local Authority—City of Gosnells.

13.03.95.

3. Mr. Collins - for letter pls
See folio 42
S. Collins
28.6.95
MKR
14.3.

1. Aiter
MKR

035957 F3102

DEPARTMENT OF CONSERVATION
AND LAND MANAGEMENT
17 JAN 1996 107

12 January 1996]

GOVERNMENT GAZETTE, WA

LAND ADMINISTRATION

LA101

CORRECTIONS

DOLA File 5735/950V23.

In the Proclamation notice at page 5491 of the *Government Gazette* dated 28 November 1995 in respect to Schedule I the reference to DOLA File 2146/995 is amended to read 2145/995.

DOLA File 1492/972.

In the notice at page 649 of the *Government Gazette* dated 24 February 1995 in respect to Reserve No. 31675 the reference to about 11062.5000 hectares is amended to read about 10994.4272 hectares.

DOLA File 984/942V4.

In the notice at page 5298 of the *Government Gazette* dated 14 November 1995 in respect to Reserve No. 43707 the reference to 2230 square metres is amended to read 1724 square metres.

DOLA File 1623/990.

In the notice at page 5141 of the *Government Gazette* dated 31 October 1995 in respect to Reserve No. 41414 the reference to 3.9634 hectares is amended to read 3.9409 hectares.

A. A. SKINNER, Chief Executive.

* *Julius 48 refers:*

LA201

**LAND ACT 1933
ORDERS IN COUNCIL
(Revocations of Vestings)**

By the direction of the Lieutenant-Governor and deputy of the Governor under Section 34B(1), the following Orders in Council and associated Vestings Orders are revoked.

DOLA File 6538/903.

Order in Council gazetted on 8 July 1960 vesting Reserve No. 8789 in the Tammin Road Board for the designated purpose of "Recreation".

DOLA File 10626/908.

Order in Council gazetted on 31 August 1984 vesting Reserve No. 13591 (Doodlakine Lot 89) in Colin Edgar Smith, Alexander Wallace Tiller, Francis Richard Nicholls and Arthur William Reynolds for the designated purpose of "Hall Site".

Local Authority—Shire of Kellerberrin.

DOLA File 1304/989V2.

Order in Council gazetted on 26 June 1992 vesting Reserve No. 17464 (Plantagenet Locations 7334, 7336 and 7697) in the Shire of Albany for the designated purpose of "Common".

DOLA File 2389/988.

Order in Council gazetted on 10 April 1964 vesting Reserve No. 27170 (Broome Lot 518) in the Minister for Works for the designated purpose of "Departmental Housing (P.W.D.)".

Local Authority—Shire of Broome.

JOHN PRITCHARD, Clerk of the Council.

LA202

CLERK WOODVALE
FYE

**LAND ACT 1933
ORDERS IN COUNCIL
(Vesting of Reserves)**

By the direction of the Lieutenant-Governor and the deputy of the Governor under Section 33(2), the following reserves have been vested.

DOLA File 6538/903.

Reserve No 8789 (Tammin Lots 45 and 121, Tammin Agricultural Area Lots 119 and 120) vested in the Shire of Tammin for the designated purpose of "Recreation" with power, subject to the approval in writing of the Minister for Lands to each and every lease or assignment of lease being first obtained, to lease the whole or any portion thereof for any term not exceeding twenty one (21) years from the date of the lease.

3. *Mr. Callery - see note
Noted above above pls. 19.01.1996 - f. Reserve
clerk*



Parts Wedge Island (1936-III), Cervantes (1936-IV),
 Wongonderrah (1936-I) & Walyengarrah (1936-II)
 Scale 1:50 000

WOOLKA WOOLKA

WOOLKA WOOLKA
 abt. 6710 ha

3114
 646
 6710.0000 ha
 4116
 Tombstone Rocks

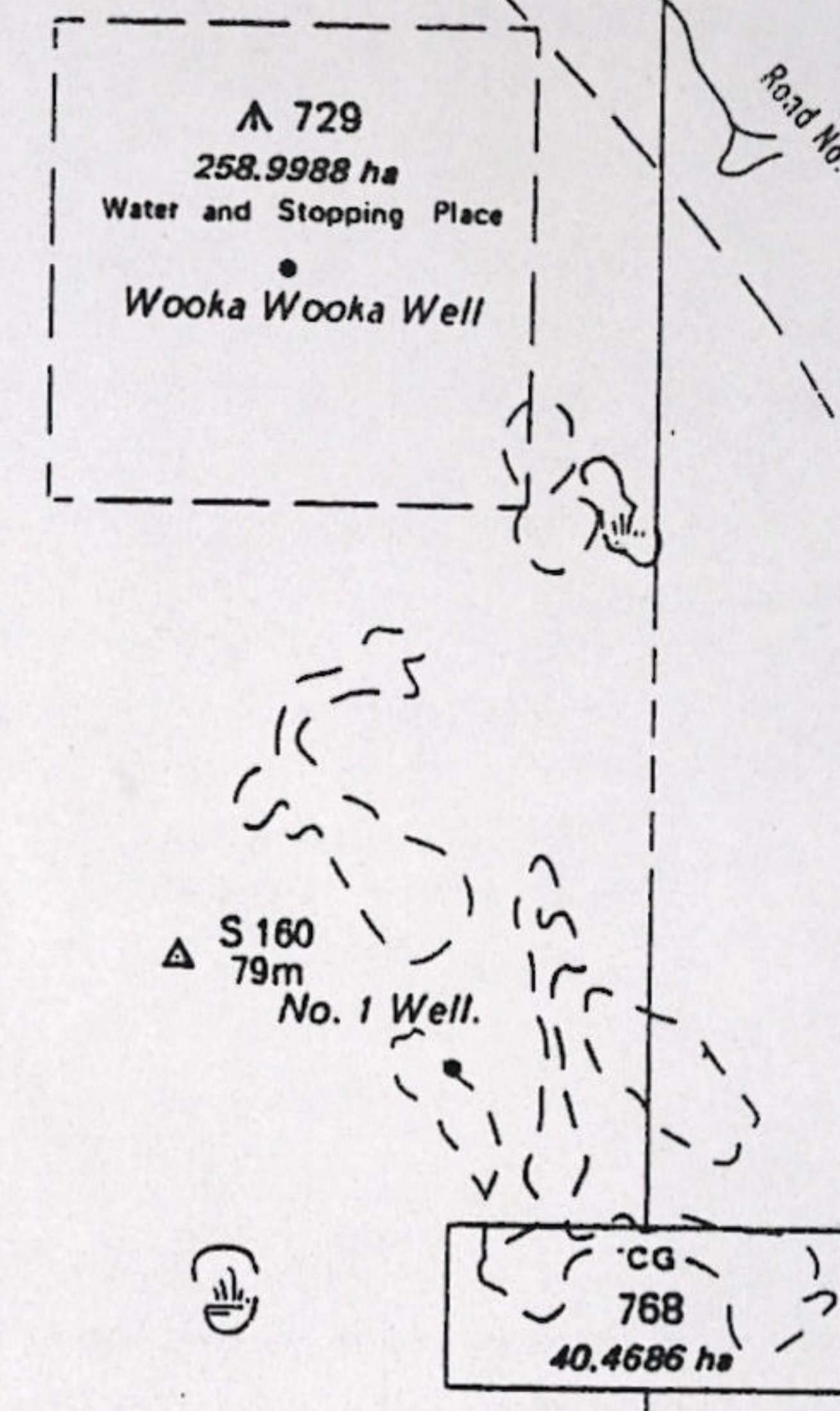
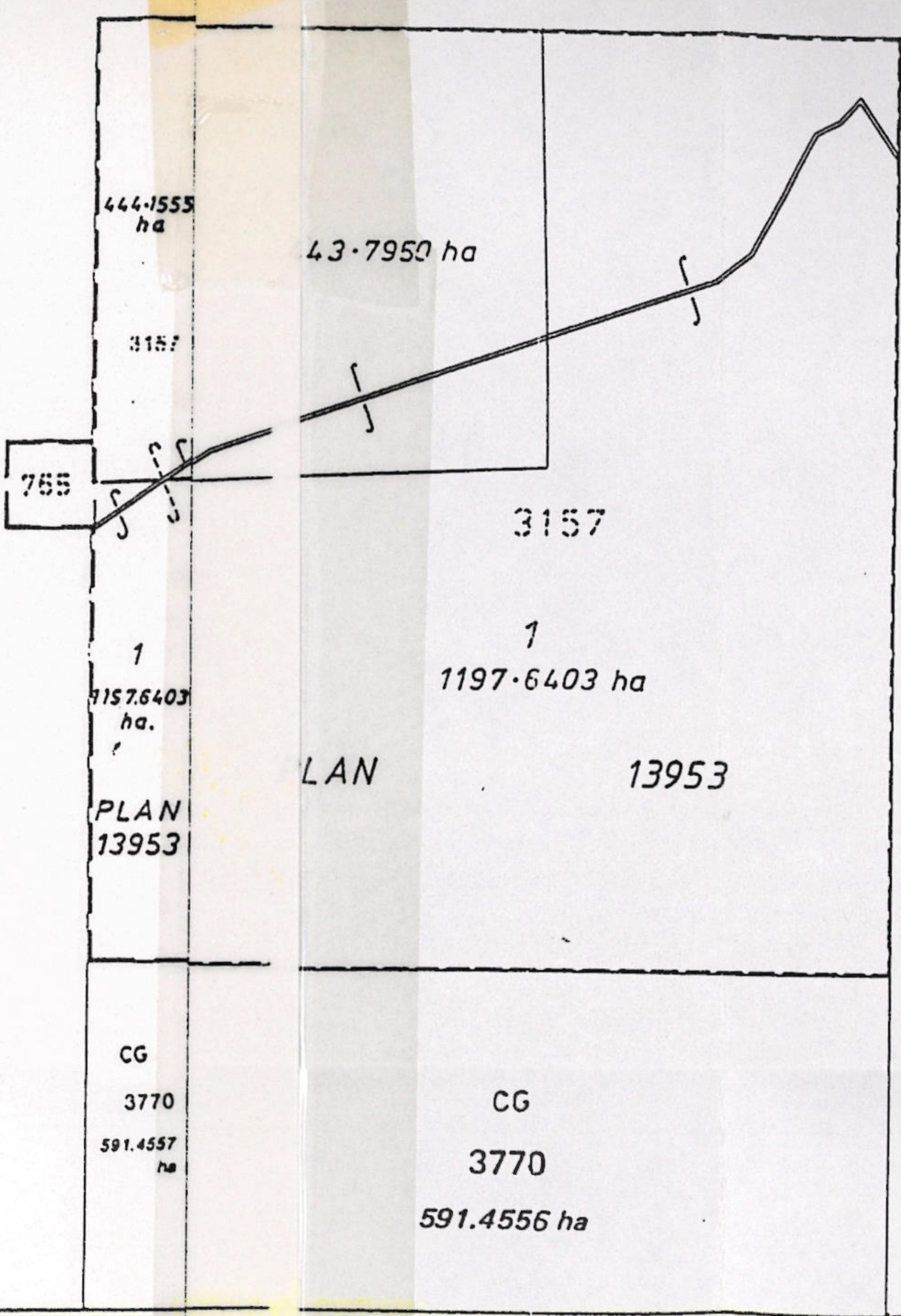

Wanagarran Nature Reserve

A 31675
 3980
 Conservation of Flora and Fauna
 Abt. 10994.4272 ha
 Vested NPNC
 SHIRE

OF

DANDARAGAN SHIRE

A 43283
 4153
 Parkland, Res. & the
 Lifting of Cottages
 existing thereon on
 14 Jan 1935
 abt 213 ha

A A 29254
 4309 ha
 Conservation of
 Flora and Fauna
 Wedge Island
 Nature Reserve
 Hill River 18
 18 m
 A 11907
 4047 m
 Trigonometrical Station

A 828
 106 m

A Hill River 52
 83 m

Duggan Well

Hill River 51 58 m

Jack Storey Well SHIRE

A 355
 3988
 11853 ha

A 11908
 4031
 Trigonometrical Station

A 37L
 855
 3988
 11853 ha

100
247.

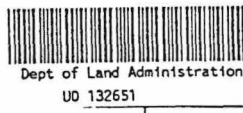
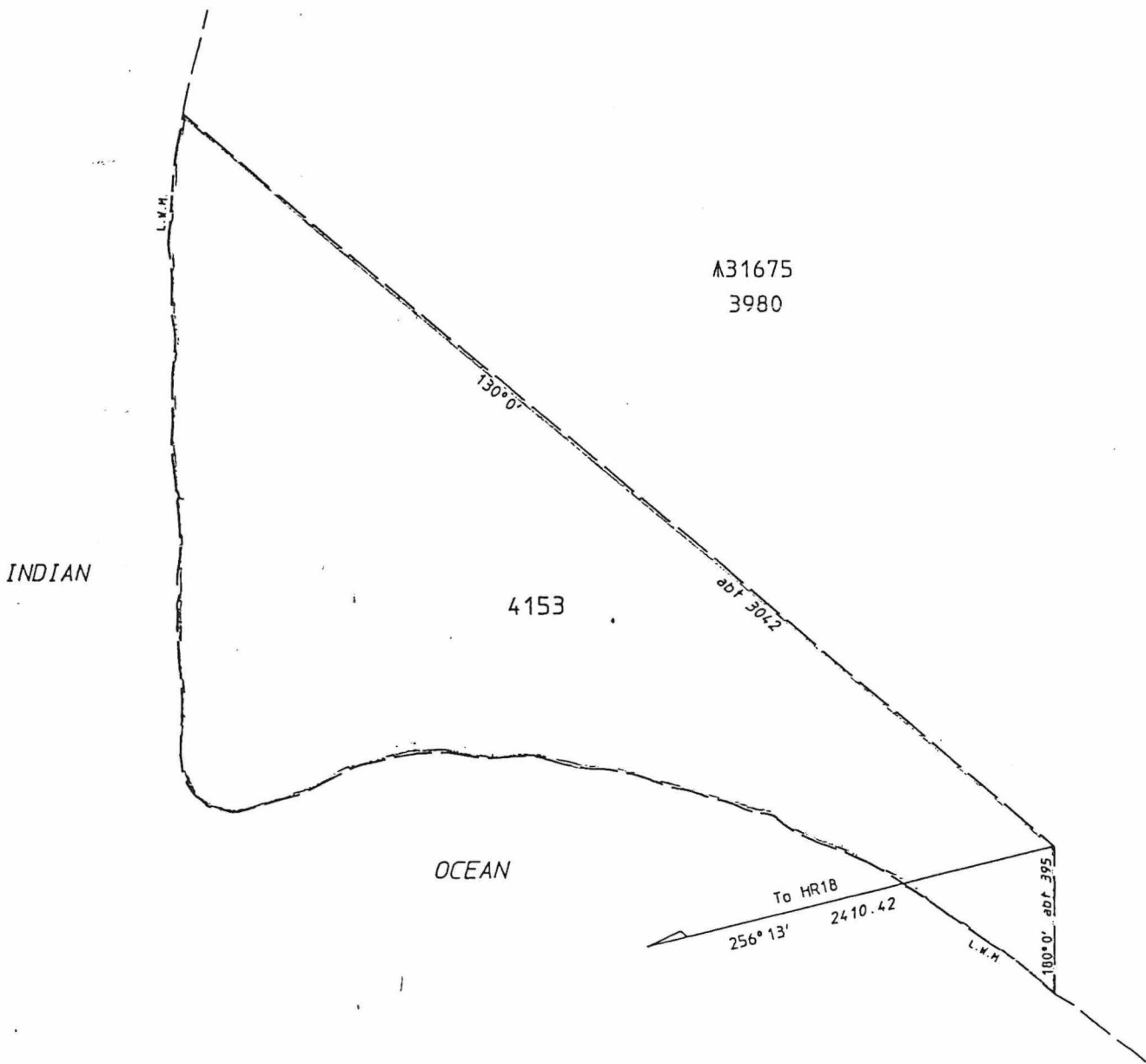

RESERVE No. Area. <i>abt 213ha</i>		FILE No. 201/961 Vol.2
Purpose <i>Parkland, Recreation and the Letting of Cottages</i>		SCALE All measurements in metres 1:12500 <i>NOT TO SCALE</i>
DISTRICT. MELBOURNE	SUBJECT TO SURVEY	
Public Plan <i>WEDGE ISLAND (S01)</i>	AMENDMENTS	
Reference <i>201/961, Vol.2</i> Page <i>201, 201A, 213, 214</i>	Gazette	Page
Prepared by <i>G. MARSHALL</i> Date <i>26/9/1994</i>		Initials
<i>[Signature]</i> <i>26.9.1994</i>		
		Gazetted Page
		Recorded on Public Plan
		Registered <i>[Signature]</i> for Manager Statutory Drafting and Amendments
		On Key Plan <i>WEDGE ISLAND (S01)</i>
		DEPT. OF LAND ADMINISTRATION RESERVE