

NATURE RESERVE

RESERVE NO: "A" 34606

GOVERNMENT GAZETTE
Date Page No.

FILE NUMBER: 454/77

PURPOSE: Cons. Flora & Fauna

22.4.77 1116

NAME: Gibson Desert

CLASS (Land Act): "A"

22.4.77 1088

AREA: 1,859,286 ha (approx)

VESTING: W.A.W.A.

22.4.77 1090

LOCATION NO(S): Milyuga & Tugaila

CLASSIFICATION:
(Wildlife Act
Section 12A)

LITHO: RAWLINSON & WELLS 1:500 000

LOCAL AUTHORITY: WILUNA SHIRE

Notes:

RESERVE ACT 1996 (NO 32 OF 1996)

155

13388, 13389, 13390, 13391, 13392, 13393, 13394, 13395, 13396, 13397, 13398, 13399, 13400, 13401, 13402, 13403, 13404, 13405, 13406, 13407, 13408, 13409, 13410, 13411, 13412, 13413, 13414, 13415, 13416, 13417, 13418, 13420, 13421, 13422, 13423, 13424, 13425, 13426, 13427, 13428, 13432, 13463 and 13481 as shown bordered red on Reserve Plan 367 (Sheets 1 to 6 inclusive) and Miscellaneous Diagrams 309, 316 and 525 and its area be established at about 115447 hectares.

DOLA File: 604/978

CONSERVATION AND MANAGEMENT
4 NOV 1996
S.W.A.

- 7. (i) Class 'C' Reserve 43182 (Canning Location 3893) "Conservation of Flora and Fauna" is cancelled.
- (ii) Class 'A' Reserve 23076 (Canning Location 3766) "Conservation of Flora and Fauna" is amended by the inclusion of Locations 3893 and 4107 (formerly Lot 35 on Plan 4742) and its area being increased to 21.9901 hectares.
Public Plans: BG34(2) 23.21, 24.21 and 24.22
DOLA File: 1930/950.
- 8. (i) Class 'A' Reserve 34772 (Meenaar Lot 71) "Conservation of Flora and Fauna" is cancelled.
- (ii) Class 'A' Reserve 29977 (Avon Location 28608) "Conservation of Flora and Fauna" is amended by the inclusion of Meenaar Lot 71 and its area being increased to 94.1208 hectares.
Public Plans: Meenaar Townsite
DOLA File: 3592/968
- 9. (i) Class 'C' Reserve 18625 (Bowgada Lot 52) "School Site" is cancelled.
- (ii) Class 'A' Reserve 29745 (Bowgada Lot 59) "Conservation of Flora and Fauna" is amended by the inclusion of Lot 52 and its are being increased to 152.2472 hectares.
Public Plan: BG41 (2) 30.35
DOLA File: 2046/969
- 10. Class 'A' Reserve 15162 (Plantagenet District) "Parklands" is amended by:-
 - (a) the excision of that area now contained in Location 7761.
 - (b) redescribing the reserve to comprise Plantagenet Location 6923 on Land Administration Plan 18597 and of its area being reduced to 58.0970 hectares.
Public Plans: Mount Barker (25) SE and BJ27(10) 8.2
DOLA File: 8777/913
- 11. Class 'A' Reserve 18325 (Swan Locations 3301, 3762, 5563, 7727 and 7583) "Recreation" is amended by the excision of the area now comprised on Location 11985 and its area being reduced to 161.5586 hectares.
Public Plans: BG34(2) 14.28 and 14.29
DOLA File: 5192/896 V7
- 12. Class 'A' Reserve 25039 (Emu Hill Lots 1 to 14 inclusive, 16, 17, 19 to 63 inclusive, 66, 67, 71, 72 and 73) "Conservation of Flora and Fauna" is amended by—
 - (a) the inclusion of Lot 74 (formerly Lot 15 on Plan 1711),
 - (b) by recalculation of its area so that the reserve comprises 61.7839 hectares.
Public Plan: Emu Hill Townsite
DOLA File: 2318/993
- 13. Class 'A' Reserve 39962 (Hamersley Lots 16 and 17, North Beach Lots 709 and 710 and Waterman Lots 4 and 6) "Conservation of Flora and Fauna, and Passive Recreation" is amended by the inclusion of North Beach Lot 715 and its area being increased to 95.9144 hectares.
Public Plan: BG34(2) 7.35
DOLA File: 3129/977 V4
- 14. (i) Class 'A' Reserve 35291 (Avon Location 28572) "Conservation of Flora and Fauna" is cancelled.
- (ii) Class 'A' Reserve 33254 (Avon Location 29024) "Conservation of Flora and Fauna" is amended by the inclusion of Location 28572 and its area being increased to 14.1015 hectares.
Public Plans: Northam (25) SW and Toodyay (25) SE
DOLA File: 544/972
- 15. Class 'A' Reserve 38924 (Avon Locations 28805 and 28937) "Conservation of Flora and Fauna" is amended by the inclusion of Location 29096 on Diagram 91497 and its area being increased to 931.7567 hectares.
Public Plan: Toodyay (25) SW, BG35(10) 8.3 and 8.4
DOLA File: 911/984 V2
- 16. (i) Class 'A' Reserve 34606 (Milyuga Location 13) "Conservation of Flora and Fauna" is amended by the excision of that area now comprised in Milyuga Location 14 on Reserve Diagram 1303 and of its area being reduced to about 1,842,864 hectares.
Public Plan: Rawlinson 1:500,000
DOLA File: 1687/976
- (ii) Class 'A' Reserve 29452 (Milyuga District) "Use and Benefit of Aboriginal Inhabitants" is amended to comprise Milyuga Location 14 on Reserve Diagram 1303 and of its area being increased to about 20,566 hectares.
Public Plan: Rawlinson 1:500,000
DOLA File: 1397/968

TO: CERIK WOODVALL

5-11-96
A. A. SKINNER, Chief Executive
Mr. Collins - for your litho pls.
6.11.96

CLAUSE 22

Reserve 29452 was proclaimed Class 'A' in November 1988 and vested in the Aboriginal Lands Trust for the "Use and Benefit of Aboriginal Inhabitants" with power to lease the whole or any portion thereof for any term. The reserve contains Milyuga Location 2 and comprises an area of about 4144 hectares. It is situated in the Gibson Desert.

In October 1994 Cabinet approved of the excision of an area, (now calculated at about 16,422 hectares), from Class 'A' "Conservation of Flora and Fauna" Reserve 34606 - known as the Gibson Desert Nature Reserve - and its inclusion into contiguous Class 'A' Reserve 29452. This approval was subject to Department of Minerals and Energy clearance. That Department has subsequently advised that no objection to the proposal is raised.

The inclusion of the subject land into Reserve 29452 will increase the area of this reserve from about 4144 hectares to about 20,566 hectares. Correspondingly the area of Reserve 34606 would be decreased from about 1,859,286 hectares to about 1,842,864 hectares.

As Reserve 34606 was vested in 1977 in the then Western Australian Wildlife Authority (now the National Parks and Nature Conservation Authority) and Reserve 29452 in the Aboriginal Lands Trust (1988) the implementation of the proposal represents minimal impact on the possible existence of native title rights and interests. The proposal having the effect of transferring care, control and management from one Agency to another.

In view of the Class 'A' classification of both reserves, this clause seeks the approval of both Houses of Parliament to give effect to Cabinet's decision.

Electoral District of Eyre
Mining and Pastoral Electoral Region
Shire of Ngaanyatjarraku

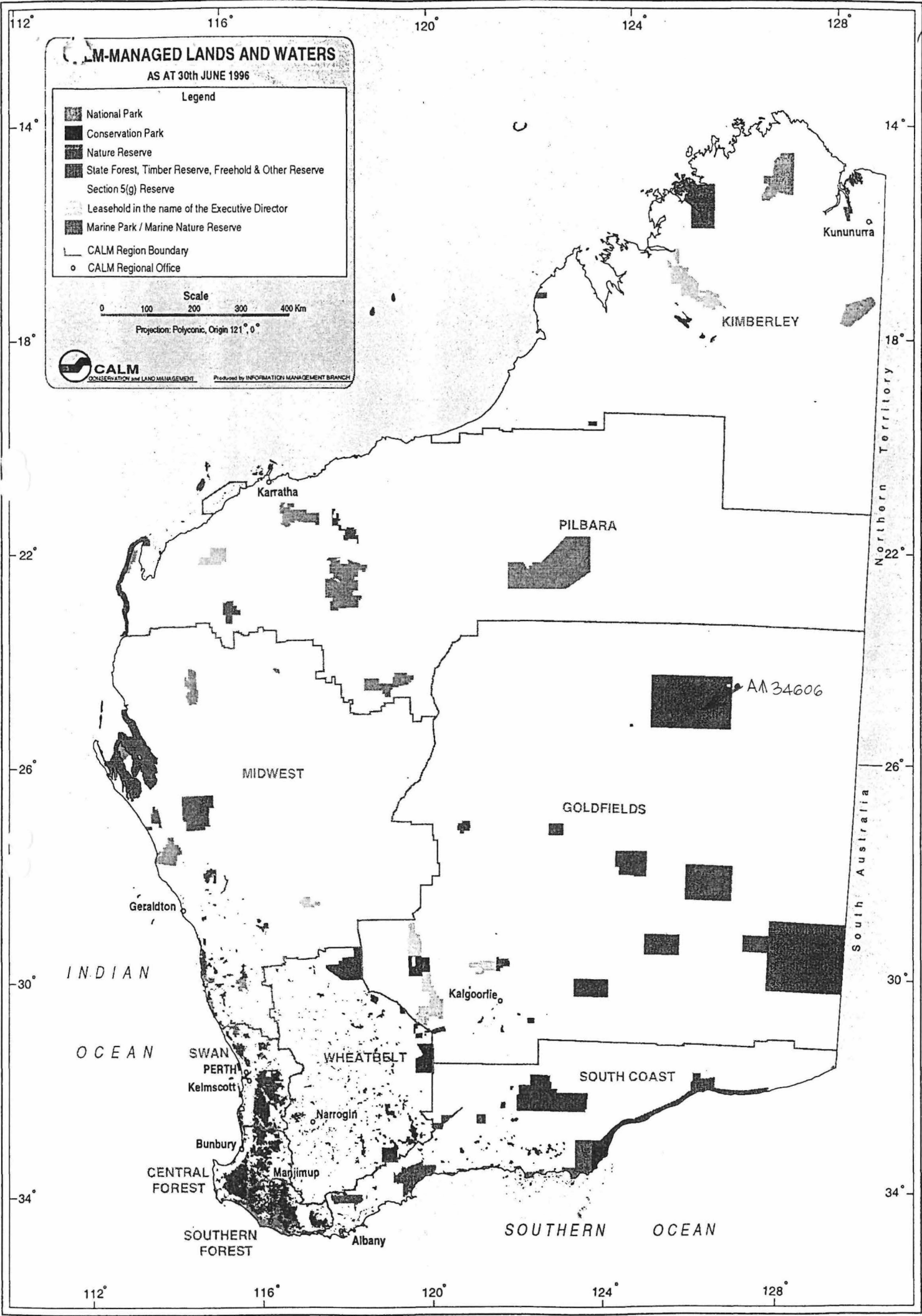

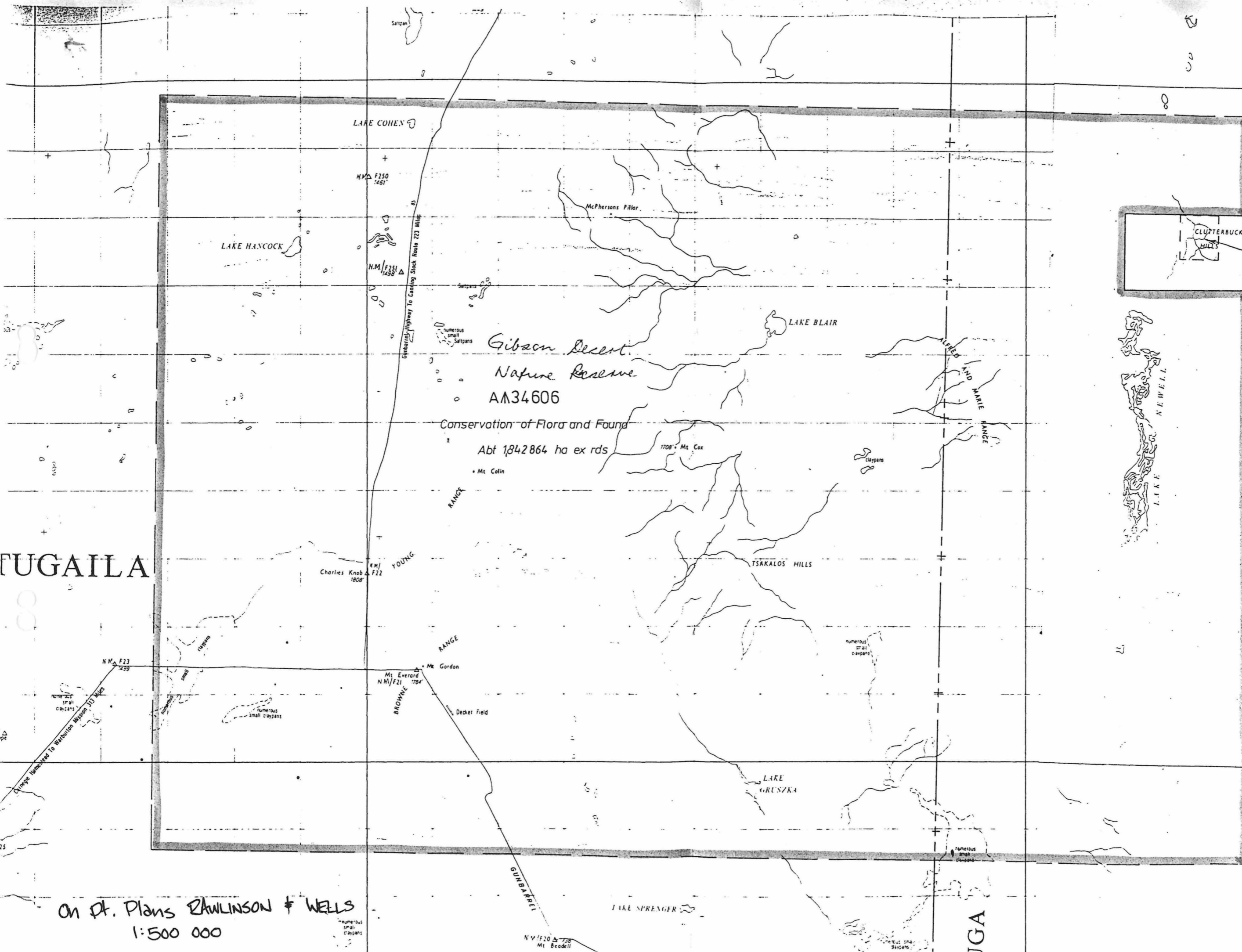

Gibson Desert
 Nature Reserve
 A 34606

Conservation of Flora and Fauna
 Abt 1842864 ha ex rds
 • Mt Colin

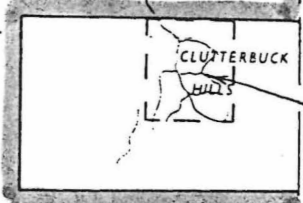

A 29452
 2
 Use & Benefit of
 Aborigines
 abt 20566 ha

FUGAILA

On Pt. Plans RAWLINSON & WELLS
 1:500 000

JGA



156
158

1. THE EXCISION OF THE AREA COLOURED BLUE FROM CLASS "A" RESERVE 34606.
2. THE AMENDMENT OF CLASS "A" RESERVE 29452 TO INCLUDE THE AREA COLOURED BLUE.

MILYUGA DISTRICT
 PUBLIC PLAN : RAWLINSON 1:500 000
 Corr. 1397/968
 SCALE 1 : 500 000

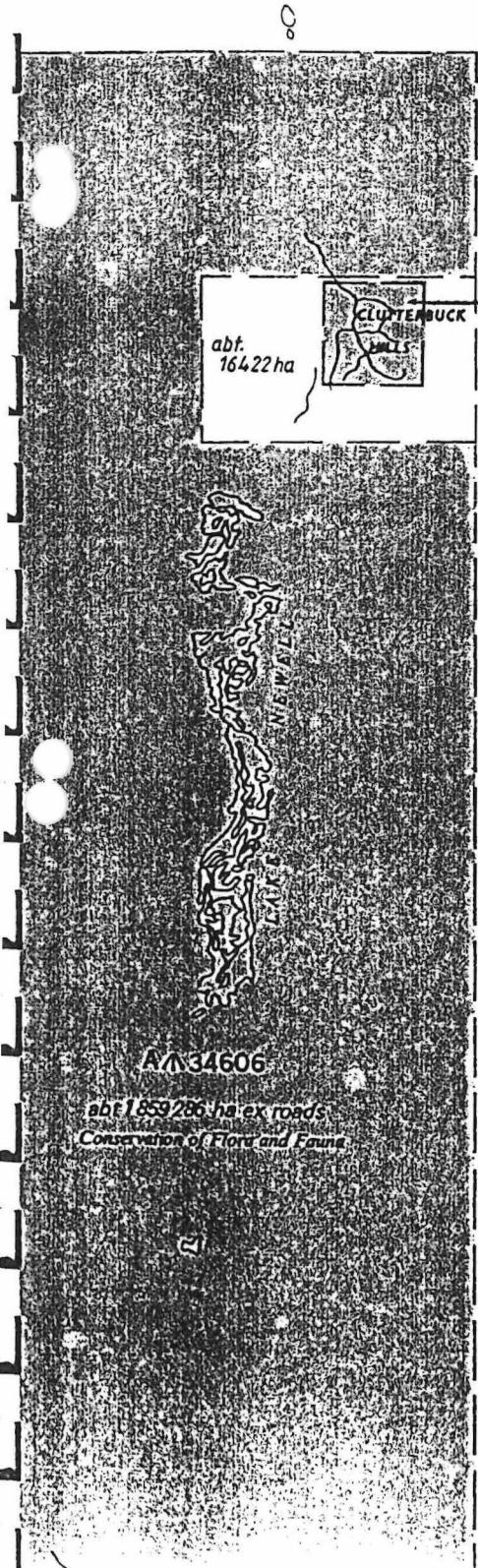

AA29452
 2
 abt 41439810 ha
 Use and Benefit of Aboriginal Inhabitants

G I B S O N

D E S E R T

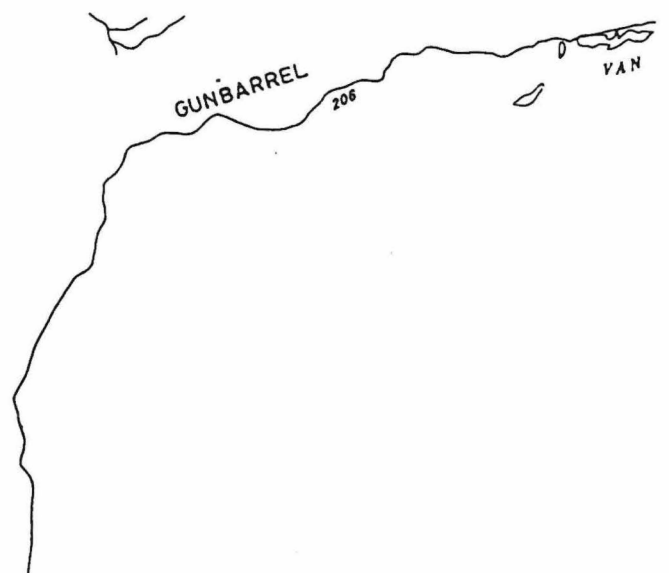

1543
156

Dimensions shown hereon are SUBJECT TO SURVEY
Supersedes Reserve Diagram 722
Includes Milyuga Location 2, & Ptn. AA34606 (Milyuga Location 13).

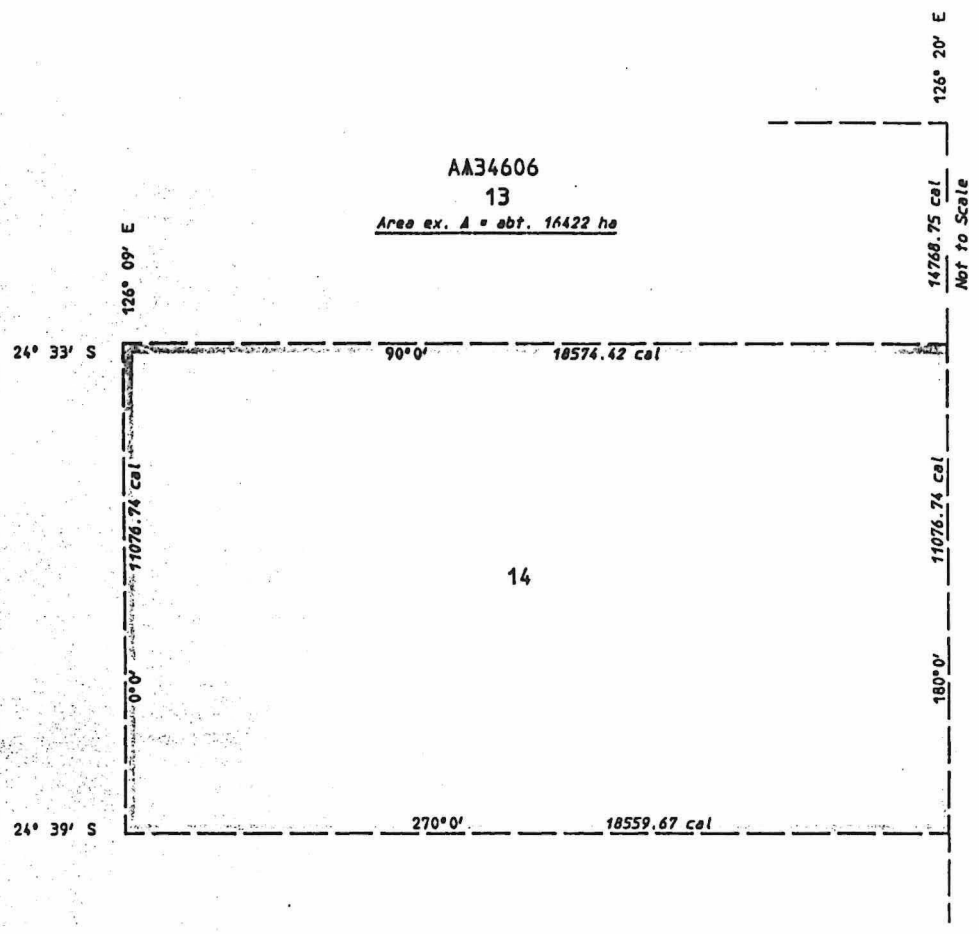







MILYUGA Location 14 created on this Diagram.



RESERVE No. A29452 AREA abt. 20566 ha Purpose Use & Benefit of Aboriginal Inhabitants		FILE No. 1397/968
DISTRICT, MILYUGA		SCALE 1:100 000 All measurements in metres
Public Plan Amelton 1:200 000 Page 33 Reference P/L 17 Col. Book Prepared by P.J. Pearce Checked <i>[Signature]</i> Date 11.5.98 Approved <i>[Signature]</i> Date 12.5.98 Manager Statutory Services	SUBJECT TO SURVEY	
	AMENDMENTS	
	Gazette	Page
	Initials	
		Gazetted 25-10-96 Page 5445 Recorded on Public Plan RL 19-11-96 Registered P.J. Pearce Per Manager Statutory Services Date 27/4/1998 Survey Index Plan
		DEPT. OF LAND ADMINISTRATION RESERVE DIAGRAM No. 1303

RESERVE ACTION SHEET: CONSERVATION RESERVES
--

RESERVE NUMBER: 34606**LOCAL GOVERNMENT:** Shire of Ngaanyatjaraku**NAME:** Pila Nature Reserve**PURPOSE:** Conservation Flora and Fauna**VESTING:** Conservation and Parks Commission and Warnpurru Aboriginal Corporation**ACTION:** Joint vesting of class A nature reserve**Total Area:** 1,842,864 hectares**REASON FOR ACTION:** Outcome of the Gibson Desert Nature Reserve Compensation and Lurtjurrululu Palakitjalu Settlement Agreement finalised 29/10/2020**Date of amendment:** 13/03/2024**Map:** Attached**Customer advice:** Attached**Proposal Summary:** MIN2047-20**Recommended IUCN classification:** 1a**Native Title:** Warnpurru Aboriginal Corporation

1. LAND UNIT LEADER	To note	 27/3/26
2. LAND UNIT	Send scan of RAS, customer advice, Reserve Enquiry Detail and maps to:	 27/3/26
	• Lisa Wright (Kensington) DIGITAL COPY	 27/3/26
	• District Manager DIGITAL COPY	 27/3/26
	• Regional Manager DIGITAL COPY	 27/3/26
	• Geoffrey Banks GIS Branch DIGITAL COPY	N/A
	• Matt Cavana Vis Comms PVS DIGITAL COPY	 27/3/26
	• Attach Landgate RDR to file	 27/3/26
	Added to completed proposals spreadsheet	N/A
Create Conservation Commission summary	N/A	
TENIS amended	N/A	
3. EXECUTIVE DIRECTOR, PARKS AND VISITOR SERVICES	To note	
4. KM	File Number: 2023-004736 and 2021/002552	

Customer Advices for Reserve Actions
1/08/2024 - 31/08/2024

Shire of Ngaanyatjarraku 1/08/2024 - 31/08/2024

Reserve No.	Land Description	DPLH File No.	Volume/Folio	Action	Document No.	Registered	Street Name	Area	Public Plans
34606	Lot 13 on Deposited Plan 91083	01687-1976	3084-739	Revocation of Management Order No. G319569 and the Order in Council Gazetted on 22 April 1977.	P915599	13/03/2024	Gunbarrel Highway	1842864 Ha	Rawlinson (500)

-- Map Viewer Plus --

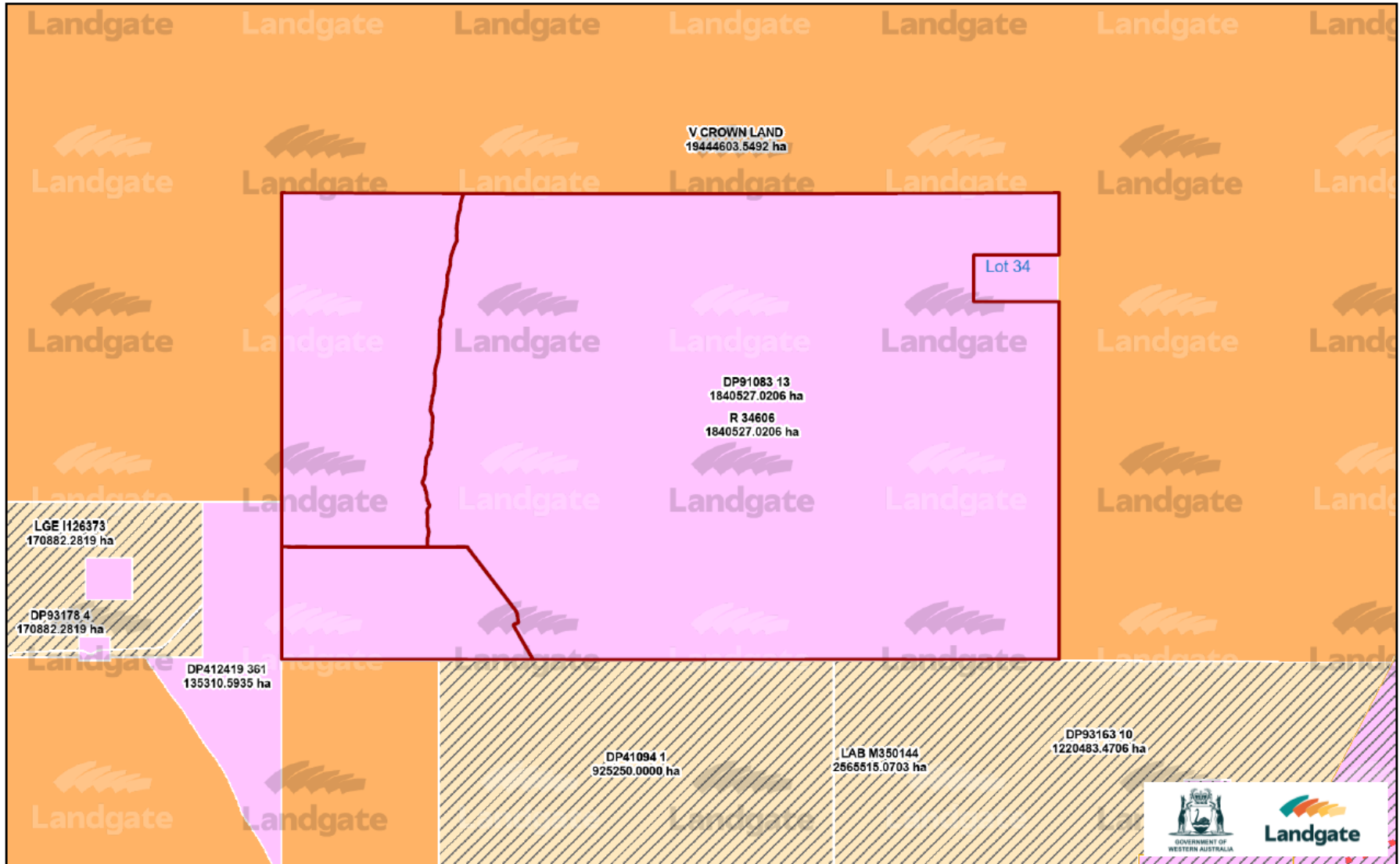

Author:

https://map-viewer-plus.landgate.gov.au/#land_id=3074099&layers=%22on%22%20%22Lot%20on%20Plan%20-%20Annotation%22%20&theme=hybrid

0 14 28 47 56 km

OFFICIAL

OFFICIAL

Reserve Details Report - 34606

Reserve	34606	Legal Area (ha)	1842864
Name	PILA NATURE RESERVE	Status	CURRENT
Type	N/A	Current Purpose	CONSERVATION OF FLORA & FAUNA
File Number	1687/1976		
Notes	N/A		
Additional Reserve Information			

Class	Responsible Agency	Date of Last Change
A	DEPARTMENT OF BIODIVERSITY, CONSERVATION AND ATTRACTIONS (SCLM)	07/08/2024

Management Order	Document Number
VEST CONSERVATION AND PARKS COMMISSION, WARNPURRU (ABORIGINAL CORPORATION) RNTBC	P915600

Land Use
CONSERVATION
PROTECTION OF FLORA
FAUNA

Local Government Authority
SHIRE OF NGAANYATJARRAKU

CLT Number	Parcel Identifier	Street Address, Suburb	File Number	PIN	Area (m ²)
LR3084/739	Lot 13 On Deposited Plan 91083	No Street Address Information Available	1687/1976.	780999, 12441925, 12441926	18405270206

Previous Certificates of Title	Status
LR3105/438	Cancelled

OFFICIAL

Page 2

Document Number/Gazette Page	Date	Type	Text
P915599	13/03/2024	Vesting Revoked	REVOKED
P915600	13/03/2024	Current Vesting	VEST CONSERVATION AND PARKS COMMISSION, WARNPURRU (ABORIGINAL CORPORATION) RNTBC
P915600	13/03/2024	Responsible Agency	DEPARTMENT OF BIODIVERSITY, CONSERVATION AND ATTRACTIONS (SCLM)
O689588	31/03/2021	Current Name	PILA NATURE RESERVE
G319569	04/11/1996	Historical Responsible Agency	DEPARTMENT OF PLANNING, LANDS AND HERITAGE (SLSD)
5645	25/10/1996	Current Area	1842864.0000 (PURSUANT TO THE RESERVES ACT 1996/NO 32 OF 1996).
5645	25/10/1996	Public Plan	RAWLINSON 1:500,000 (PURSUANT TO THE RESERVES ACT 1996/NO.32 OF 1996).
6153	14/12/1990	Historical Name	GIBSON DESERT NATURE RESERVE
1088	22/04/1977	Class	A
1090	22/04/1977	Historical Vesting	VEST W A WILDLIFE AUTHORITY
1116	22/04/1977	Original Gazettal and page	ORIGINAL GAZETTE
N/A	22/04/1977	Current Purpose	CONSERVATION OF FLORA & FAUNA
N/A	22/04/1977	Correspondence File Number	1687/76
N/A	22/04/1977	Historical Area	ABT1859286.0000
N/A	22/04/1977	Location	MILYUGA, 13
N/A	22/04/1977	Street Name	GUNBARREL HIGHWAY
N/A	22/04/1977	Survey Number	RES.D:84
N/A	N/A	Comment	YOUNG RANGE