

NATURE RESERVE

RESERVE NO: 35428

GOVERNMENT GAZETTE
Date Page No.

FILE NUMBER: FWD 592/81

PURPOSE: Cons. Flora & Fauna

29.7.83

2789

NAME:

CLASS (Land Act):

AREA: 97.1726 ha

VESTING: W.A.W.A.

29.7.83

2783

LOCATION NO(S): Loc 7412 & 7427 Plantagenet

CLASSIFICATION:
(Wildlife Act
Section 12A)

LITHO: Plan Moodiarrup SE 1:25 000

LOCAL AUTHORITY: ~~WEST ARTHUR~~ *TAMBLELLUP.*

Notes:

RESERVE ACTION SHEET - CONSERVATION RESERVES

WANSBROUGH NATURE RESERVE

RESERVE No. A35428

SHIRE: Tambellup

REASON FOR ACTION

Amendment to include Plantagenet Locations 7795 and 7765 in Reserve A35428. The Locations were previously Reserve A13289 vested in the Water and Rivers Commission for the purpose "Water and Conservation of Flora and Fauna".

Reserve 35428 is a class A reserve vested in the Conservation Commission for the purpose "Conservation of Flora and Fauna".

Plantagenet Locations 7795 and 7765 have been informally managed by CALM as part of Reserve A35428, since at least 1988, due to their high conservation values.

Area:
Addition – 21.1861 ha
Reserve - 126.2917 hectares

Date of amendment: 3 July 2003 Customer Advice: p. 212
Plans at folios: pp. 206, 211 & 213 Folio: pp. 197-201 & 214
Native title clearance: Ward High Court decision (previously vested in 1985, Minister for Water Resources)
IUCN classification: Ia

	OFFICER	ACTION	
1	LAND UNIT	Send copies of advice & maps to: - Lisa Wright, Woodvale - Manager, Katanning District - Manager, Wheatbelt Region	<u>✓ 22/12/03</u> _____ _____
2	A/LAND COORDINATOR	to note:	_____
3	SENIOR POLICY OFFICER, PVS	to note native title clearance:	_____
4	A/DIRECTOR, NATURE CONSERVATION	to note:	_____
5	CIS	please create new file:	_____
6	CONSERVATION ESTATE OFFICER	reserve details to inside cover:	_____

RESERVE ACTION SHEET - CONSERVATION RESERVES

WANSBROUGH NATURE RESERVE

RESERVE No. A35428

SHIRE: Tambellup

REASON FOR ACTION

Amendment to include Plantagenet Locations 7795 and 7796 in Reserve A35428. The Locations were previously Reserve A13289 vested in the Water and Rivers Commission for the purpose "Water and Conservation of Flora and Fauna".

Reserve 35428 is a class A reserve vested in the Conservation Commission for the purpose "Conservation of Flora and Fauna".

Plantagenet Locations 7795 and 7796 have been informally managed by CALM as part of Reserve A35428, since at least 1988, due to their high conservation values.

Area:
Addition - 29.1191 ha
Reserve - 126.2917 hectares

Date of amendment: 3 July 2003 Customer Advice: p. 212
Plans at folios: pp. 206, 211 & 213 Folio: pp. 197-201 & 214
Native title clearance: Ward High Court decision (previously vested in 1985, Minister for Water Resources)
IUCN classification: Ia

OFFICER	ACTION	
1 LAND UNIT	Send copies of advice & maps to: - Lisa Wright, Woodvale - Manager, Katanning District - Manager, Wheatbelt Region	_____ _____ _____
2 A/LAND COORDINATOR	to note:	_____
3 SENIOR POLICY OFFICER, PVS	to note native title clearance:	_____
4 A/DIRECTOR, NATURE CONSERVATION	to note:	_____
5 CIS	please create new file:	_____
6 CONSERVATION ESTATE OFFICER	reserve details to inside cover:	_____

CONSERVATION ESTATE OFFICER
LAND ADMINISTRATION SECTION
PARK POLICY AND TOURISM BRANCH

'A' Reserve 35428 within WHEATBELT/KATANNING Region/District, was
~~created~~ amended, effective from 3 JULY 2002.

Copies of notification of this action and amended plans have been placed at
folios 206, 211-214 incl.

Would you please advise the relevant offices of this amendment through your
Reserve Action Sheet.

Recommended IUCN classification as previous (1a)

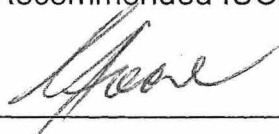

Program Leader
Tenure Group, GIS
Information Management Branch

2.12.03

Customer Advices for Reserve Actions
1/03/2003 - 31/03/2003

Shire of Tambellup 1/03/2003 - 31/03/2003

Reserve No.	Land Description	DOLA File No.	Volume/Folio	Action	Document No.	Registered	Street Name	Area	Public Plans
A13289	Plantagenet Locations 7795 and 7796 on Deposited Plan 218750	14728-1910-01RO	3105-42	Reserve Cancellation "Water and Conservation of Flora and Fauna"	I162456	03/07/2002	Road No. 5063	29.1191 Ha	Tambellup SE 25
A13289	Plantagenet Locations 7795 and 7796 on Land Administration Plan 18750	14728-1910-01RO	3105-42	Revocation of Management Order (Water Authority of WA) for the designated purpose of "Water and Conservation of Flora and Fauna".	I162455	03/07/2002	Road No. 5063	29.1191 Ha	Tambellup SE 25
A35428	Plantagenet Location 7412 on Deposited Plan 91253 Plantagenet Location 7427 on Deposited Plan 91253	03736-1911-01RO	3082-937	Amendment of Reserve to To now include Plantagenet Locations 7795 and 7796 on Deposited Plan 218750 with the area increasing to 126.2917 hectares accordingly.	I162457	03/07/2002	Wansborough Road West	126.2917 Ha	Tambellup SE
A35428	Plantagenet Location 7412 on Land Administration Reserve Diagram 254 Plantagenet Location 7427 on Land Administration Reserve Diagram 254	03736-1911-01RO	3082-937	Management Order to Conservation Commission of Western Australia of Cnr Hackett Drive & Australia II Drive, Crawley, Western Australia 6009 for the designated purpose of "Conservation of Flora and Fauna"	I162458	03/07/2002	Wansborough Road West	126.2917 Ha	Tambellup SE

(+29.1191ha)

• TENS d'base amended
• which folder " " *get 8/4*

WESTERN AUSTRALIA
LAND ADMINISTRATION ACT 1997
TRANSFER OF LAND ACT 1893 AS AMENDED

MANAGEMENT ORDER (XE)

RESERVE DESCRIPTION (NOTE 1)

RESERVE DESCRIPTION (NOTE 1)	EXTENT	VOLUME	FOLIO
Reserve A35428		3082	937
		3082	947.
		3126	677
		3126	678.

MANAGEMENT BODY (NOTE 2)

Conservation Commission of Western Australia of Cnr Hackett Drive & Australia II Drive,
Crawley, Western Australia 6009

ISCLM

CONDITIONS (NOTE 3)

To be used only for the designated purpose of "Conservation of Flora and Fauna"

THE MINISTER FOR LANDS (IN THE NAME OF AND ON BEHALF OF THE STATE OF WESTERN AUSTRALIA) ORDERS THAT THE CARE, CONTROL AND MANAGEMENT OF THE ABOVE RESERVE BE PLACED WITH THE ABOVE DESCRIBED MANAGEMENT BODY FOR THE PURPOSE FOR WHICH THE LAND IS RESERVED UNDER SECTION 41 OF THE LAND ADMINISTRATION ACT 1997, AND FOR PURPOSES ANCILLARY OR BENEFICIAL TO THAT PURPOSE SUBJECT TO THE CONDITIONS STATED ABOVE

Dated this 3rd day of July in the year 2002

ATTESTATION

W. J. M. ...

PROJECT OFFICER
SOUTH EAST REGION
LAND ADMINISTRATION SERVICES

INSTRUCTIONS

- 1. If insufficient space in any section, Additional Sheet Form B1 should be used with appropriate headings. The boxed sections should only contain the words "See Annexure".
- 2. Additional Sheets shall be numbered consecutively and bound to this document by staples along the left margin prior to execution by parties.
- 3. No alteration should be made by erasure. The words rejected should be scored through and those substituted typed or written above them, the alteration being initialled by the person signing this document and their witnesses.

NOTES

- 1. RESERVE DESCRIPTION
Reserve number and details to be stated. The Volume and Folio numbers to be stated.
- 2. MANAGEMENT BODY
State the full name and address of the management body.
- 3. CONDITIONS
Specify all conditions to be observed by the lessee in the operation of the area affected by this permit.
- 4. EXECUTION
A separate attestation is required for every person signing this document. Each signature should be separately witnessed by an Adult Person. The address and occupation of the witness must be stated.

EXAMINED

Office Use Only

DUPLICATE



I 162458 XE

03 Jul 2002 14:28:34 Midland
10 FEB 2002 15:41:15

MANAGEMENT ORDER (XE)

LODGED BY Land Administration Services Branch

ADDRESS DOLA

PHONE No.
FAX No.

REFERENCE No. Shelley Brindal 3736-1911

ISSUING BOX No.

PREPARED BY Land Administration Services Branch

ADDRESS DOLA

PHONE No. FAX No.

INSTRUCT IF ANY DOCUMENTS ARE TO ISSUE TO OTHER THAN LODGING PARTY

TITLES, LEASES, DECLARATIONS ETC LODGED HEREWITH

- 1. _____ Received Items
- 2. _____ Nos.
- 3. _____
- 4. _____ Receiving Clerk
- 5. _____
- 6. _____

973199-008



Registered pursuant to the provisions of the TRANSFER OF LAND ACT 1893 as amended on the day and time shown above and particulars entered in the Register.

DOLA BOX 98



REVOCATION I162455
 RESERVE CANCELLATION I162456
 REVOCATION I379422
 AMENDMENT OF RESERVE I162457
 APPLICATION I162454

WESTERN



AUSTRALIA

REGISTER NUMBER

N/A

QUALIFIED CERTIFICATE
 OF
 CROWN LAND TITLE

UNDER THE TRANSFER OF LAND ACT 1893
 AND THE LAND ADMINISTRATION ACT 1997

VOLUME FOLIO
 LR 3126 677



NO DUPLICATE CREATED

The undermentioned land is Crown land in the name of the STATE of WESTERN AUSTRALIA, subject to the interests and Status Orders shown in the first schedule which are in turn subject to the limitations, interests, encumbrances and notifications shown in the second schedule.

REGISTRAR OF TITLES



LAND DESCRIPTION:

LOT 7795 ON DEPOSITED PLAN 218750

STATUS ORDER AND PRIMARY INTEREST HOLDER:
 (FIRST SCHEDULE continued overleaf)

STATUS ORDER/INTEREST: RESERVE UNDER MANAGEMENT ORDER

PRIMARY INTEREST HOLDER: CONSERVATION COMMISSION OF WESTERN AUSTRALIA OF CNR HACKETT DRIVE
 & AUSTRALIA II DRIVE, CRAWLEY

(XE I162458) REGISTERED 10 FEBRUARY 2003

LIMITATIONS, INTERESTS, ENCUMBRANCES AND NOTIFICATIONS:
 (SECOND SCHEDULE continued overleaf)

1. PART CLASS "A" RESERVE 35428 FOR THE PURPOSE OF CONSERVATION OF FLORA AND FAUNA.
 I162458 MANAGEMENT ORDER. CONTAINS CONDITIONS TO BE OBSERVED. REGISTERED 10.02.2003.

- Warning: (1) A current search of the sketch of the land should be obtained where detail of position, dimensions or area of the lot is required.
 Lot as described in the land description may be a lot or location.
 (2) The land and interests etc. shown hereon may be affected by interests etc. that can be, but are not, shown on the register.
 (3) The interests etc. shown hereon may have a different priority than shown.

-----END OF CERTIFICATE OF CROWN LAND TITLE-----

STATEMENTS:

The statement set out below are not intended to be nor should they be relied on as substitutes for inspection of the land
 and the relevant documents or for local government, legal, surveying or other professional advice.

SKETCH OF THE LAND: DP 218750
 PREVIOUS TITLE: THIS TITLE
 PROPERTY STREET ADDRESS: NO STREET ADDRESS INFORMATION AVAILABLE.
 LOCAL GOVERNMENT AREA: NO LOCAL GOVERNMENT AUTHORITY INFORMATION AVAILABLE.

NOTE 1: A000001A CORRESPONDENCE FILE 03736-1911-01RO
 NOTE 2: LAND PARCEL IDENTIFIER OF PLANTAGENET LOCATION 7795 CHANGED TO LOT 7795 ON
 DEPOSITED PLAN 218750 ON 03-JUL-02 TO ENABLE ISSUE OF A DIGITAL CERTIFICATE OF
 TITLE.

END OF PAGE 1 - CONTINUED OVER

ORIGINAL CERTIFICATE OF CROWN LAND TITLE

REGISTER NUMBER: N/A

VOLUME/FOLIO: LR3126-677

PAGE 2

REGISTER NUMBER 7412/DP91253	
DUPLICATE EDITION N/A	DATE DUPLICATE ISSUED N/A

WESTERN



AUSTRALIA

**RECORD OF QUALIFIED CERTIFICATE
OF
CROWN LAND TITLE**

VOLUME **LR3082** FOLIO **937**

UNDER THE TRANSFER OF LAND ACT 1893
AND THE LAND ADMINISTRATION ACT 1997

NO DUPLICATE CREATED

The undermentioned land is Crown land in the name of the STATE of WESTERN AUSTRALIA, subject to the interests and Status Orders shown in the first schedule which are in turn subject to the limitations, interests, encumbrances and notifications shown in the second schedule.



REGISTRAR OF TITLES

LAND DESCRIPTION:

LOT 7412 ON DEPOSITED PLAN 91253

**STATUS ORDER AND PRIMARY INTEREST HOLDER:
(FIRST SCHEDULE)**

STATUS ORDER/INTEREST: RESERVE UNDER MANAGEMENT ORDER

PRIMARY INTEREST HOLDER: CONSERVATION COMMISSION OF WESTERN AUSTRALIA OF CNR HACKETT DRIVE & AUSTRALIA II DRIVE, CRAWLEY

(XE I162458) REGISTERED 10 FEBRUARY 2003

**LIMITATIONS, INTERESTS, ENCUMBRANCES AND NOTIFICATIONS:
(SECOND SCHEDULE)**

- PART CLASS "A" RESERVE 35428 FOR THE PURPOSE OF CONSERVATION OF FLORA AND FAUNA. I162458 MANAGEMENT ORDER. CONTAINS CONDITIONS TO BE OBSERVED. REGISTERED 10.2.2003.

- Warning: (1) A current search of the sketch of the land should be obtained where detail of position, dimensions or area of the lot is required. Lot as described in the land description may be a lot or location.
- (2) The land and interests etc. shown hereon may be affected by interests etc. that can be, but are not, shown on the register.
- (3) The interests etc. shown hereon may have a different priority than shown.

-----END OF CERTIFICATE OF CROWN LAND TITLE-----

STATEMENTS:

The statements set out below are not intended to be nor should they be relied on as substitutes for inspection of the land and the relevant documents or for local government, legal, surveying or other professional advice.

SKETCH OF LAND: DP91253.
PREVIOUS TITLE: This Title.
PROPERTY STREET ADDRESS: NO STREET ADDRESS INFORMATION AVAILABLE.
LOCAL GOVERNMENT AREA: SHIRE OF TAMBELLUP.

NOTE 1: A000001A CORRESPONDENCE FILE 03736-1911-01RO.
NOTE 2: SUBJECT TO SURVEY - NOT FOR ALIENATION PURPOSES
NOTE 3: LAND PARCEL IDENTIFIER OF PLANTAGENET LOCATION 7412 ON SUPERSEDED PAPER CERTIFICATE OF CROWN LAND TITLE CHANGED TO LOT 7412 ON

END OF PAGE 1 - CONTINUED OVER

Subject to Dealing or Other Actions

ORIGINAL CERTIFICATE OF CROWN LAND TITLE
QUALIFIED

REGISTER NUMBER: 7412/DP91253

VOLUME/FOLIO: LR3082-937

PAGE 2

DEPOSITED PLAN 91253 ON 06-AUG-02 TO ENABLE ISSUE OF A DIGITAL
CERTIFICATE OF TITLE.

NOTE 4:

THE ABOVE NOTE MAY NOT BE SHOWN ON THE SUPERSEDED PAPER CERTIFICATE
OF TITLE.

Subject to Dealing or Other Actions

Subject to Dealing or Other Actions

WESTERN



AUSTRALIA

REGISTER NUMBER 7427/DP91253	
DUPLICATE EDITION N/A	DATE DUPLICATE ISSUED N/A

**RECORD OF QUALIFIED CERTIFICATE
OF
CROWN LAND TITLE**

VOLUME **LR3082** FOLIO **947**

UNDER THE TRANSFER OF LAND ACT 1893
AND THE LAND ADMINISTRATION ACT 1997

NO DUPLICATE CREATED

The undermentioned land is Crown land in the name of the STATE of WESTERN AUSTRALIA, subject to the interests and Status Orders shown in the first schedule which are in turn subject to the limitations, interests, encumbrances and notifications shown in the second schedule.

J. H. Gale
REGISTRAR OF TITLES



LAND DESCRIPTION:

LOT 7427 ON DEPOSITED PLAN 91253

**STATUS ORDER AND PRIMARY INTEREST HOLDER:
(FIRST SCHEDULE)**

STATUS ORDER/INTEREST: RESERVE UNDER MANAGEMENT ORDER

PRIMARY INTEREST HOLDER: CONSERVATION COMMISSION OF WESTERN AUSTRALIA OF CNR HACKETT DRIVE & AUSTRALIA II DRIVE, CRAWLEY

(XE I162458) REGISTERED 10 FEBRUARY 2003

**LIMITATIONS, INTERESTS, ENCUMBRANCES AND NOTIFICATIONS:
(SECOND SCHEDULE)**

- PART CLASS "A" RESERVE 35428 FOR THE PURPOSE OF CONSERVATION OF FLORA AND FAUNA. I162458 MANAGEMENT ORDER. CONTAINS CONDITIONS TO BE OBSERVED. REGISTERED 10.2.2003.

- Warning: (1) A current search of the sketch of the land should be obtained where detail of position, dimensions or area of the lot is required. Lot as described in the land description may be a lot or location.
(2) The land and interests etc. shown hereon may be affected by interests etc. that can be, but are not, shown on the register.
(3) The interests etc. shown hereon may have a different priority than shown.

-----END OF CERTIFICATE OF CROWN LAND TITLE-----

STATEMENTS:

The statements set out below are not intended to be nor should they be relied on as substitutes for inspection of the land and the relevant documents or for local government, legal, surveying or other professional advice.

SKETCH OF LAND: DP91253.
PREVIOUS TITLE: This Title.
PROPERTY STREET ADDRESS: NO STREET ADDRESS INFORMATION AVAILABLE.
LOCAL GOVERNMENT AREA: SHIRE OF TAMBELLUP.

NOTE 1: A000001A CORRESPONDENCE FILE 03736-1911-01RO.
NOTE 2: LAND PARCEL IDENTIFIER OF PLANTAGENET LOCATION 7427 ON SUPERSEDED PAPER CERTIFICATE OF CROWN LAND TITLE CHANGED TO LOT 7427 ON DEPOSITED PLAN 91253 ON 06-AUG-02 TO ENABLE ISSUE OF A DIGITAL

END OF PAGE 1 - CONTINUED OVER

ORIGINAL CERTIFICATE OF CROWN LAND TITLE
QUALIFIED

REGISTER NUMBER: 7427/DP91253

VOLUME/FOLIO: LR3082-947

PAGE 2

NOTE 3:

CERTIFICATE OF TITLE.
THE ABOVE NOTE MAY NOT BE SHOWN ON THE SUPERSEDED PAPER CERTIFICATE
OF TITLE.

Subject to Dealing or Other Actions

REVOCATION I162455
RESERVE CANCELLATION I162456
REVOCATION I379422
AMENDMENT OF RESERVE I162457
APPLICATION I162454

WESTERN



AUSTRALIA

REGISTER NUMBER

N/A

QUALIFIED CERTIFICATE
OF
CROWN LAND TITLE

UNDER THE TRANSFER OF LAND ACT 1893
AND THE LAND ADMINISTRATION ACT 1997

VOLUME FOLIO
LR 3126 678



NO DUPLICATE CREATED

The undermentioned land is Crown land in the name of the STATE of WESTERN AUSTRALIA, subject to the interests and Status Orders shown in the first schedule which are in turn subject to the limitations, interests, encumbrances and notifications shown in the second schedule.

REGISTRAR OF TITLES



LAND DESCRIPTION:

LOT 7796 ON DEPOSITED PLAN 218750

STATUS ORDER AND PRIMARY INTEREST HOLDER:
(FIRST SCHEDULE continued overleaf)

STATUS ORDER/INTEREST: RESERVE UNDER MANAGEMENT ORDER

PRIMARY INTEREST HOLDER: CONSERVATION COMMISSION OF WESTERN AUSTRALIA OF CNR HACKETT DRIVE
& AUSTRALIA II DRIVE, CRAWLEY

(XE I162458) REGISTERED 10 FEBRUARY 2003

LIMITATIONS, INTERESTS, ENCUMBRANCES AND NOTIFICATIONS:
(SECOND SCHEDULE continued overleaf)

1. PART CLASS "A" RESERVE 35428 FOR THE PURPOSE OF CONSERVATION OF FLORA AND FAUNA.
I162458 MANAGEMENT ORDER. CONTAINS CONDITIONS TO BE OBSERVED. REGISTERED 10.02.2003.

- Warning: (1) A current search of the sketch of the land should be obtained where detail of position, dimensions or area of the lot is required.
Lot as described in the land description may be a lot or location.
(2) The land and interests etc. shown hereon may be affected by interests etc. that can be, but are not, shown on the register.
(3) The interests etc. shown hereon may have a different priority than shown.

-----END OF CERTIFICATE OF CROWN LAND TITLE-----

STATEMENTS:

The statement set out below are not intended to be nor should they be relied on as substitutes for inspection of the land and the relevant documents or for local government, legal, surveying or other professional advice.

SKETCH OF THE LAND: DP 218750
PREVIOUS TITLE: THIS TITLE
PROPERTY STREET ADDRESS: NO STREET ADDRESS INFORMATION AVAILABLE.
LOCAL GOVERNMENT AREA: NO LOCAL GOVERNMENT AUTHORITY INFORMATION AVAILABLE.

NOTE 1: A000001A CORRESPONDENCE FILE 03736-1911-01RO
NOTE 2: LAND PARCEL IDENTIFIER OF PLANTAGENET LOCATION 7796 CHANGED TO LOT 7796 ON DEPOSITED PLAN 218750 ON 03-JUL-02 TO ENABLE ISSUE OF A DIGITAL CERTIFICATE OF TITLE.

END OF PAGE 1 - CONTINUED OVER

ORIGINAL CERTIFICATE OF CROWN LAND TITLE

REGISTER NUMBER: N/A

VOLUME/FOLIO: LR3126-678

PAGE 2

Schedule

Reserve No. 8019 comprising Fitzgerald Location 1659 and containing an area of 346.6537 hectares.
(Plans: Scadden 1.50 000.)

Given under my hand and the Public Seal of Western Australia, at Perth, on 18 April 1989.

By His Excellency's Command,
E. K. HALLAHAN,
Minister for Lands.

GOD SAVE THE QUEEN !

Land Act 1933

PROCLAMATION

WESTERN AUSTRALIA } By His Excellency Professor Gordon Reid, Com-
GORDON REID, } panion of the Order of Australia, Governor of the
Governor. } State of Western Australia.
[L.S.]

File No. 1727/09.

WHEREAS by section 31 (1) (a) of the Land Act 1933, the Governor may by Proclamation and subject to such conditions as may be expressed therein classify as of Class "A" any such lands of the Crown reserved to Her Majesty for any purpose; and whereas it is deemed expedient that Reserve Numbers 12049 and 12632 for the purpose of "Conservation of Flora and Fauna, and Water" as described, should be classified as of Class "A": Now, therefore I, the Governor, with the advice and consent of Executive Council do by this my Proclamation classify as of Class "A" the reserve described hereunder.

Schedule

Reserve No. 12049—Wellington Location 1071—79.4196 hectares.

(Plan Hamel S.W. 1:25 000.)

Reserve No. 12632—Wellington Location 5483—38.0339 hectares.

(Plan Hamel S.W. 1:25 000.)

Given under my hand and the Public Seal of Western Australia, at Perth, on 18 April 1989.

By His Excellency's Command,
E. K. HALLAHAN,
Minister for Lands.

GOD SAVE THE QUEEN !

Land Act 1933

PROCLAMATION

WESTERN AUSTRALIA } By His Excellency Professor Gordon Reid, Com-
GORDON REID, } panion of the Order of Australia, Governor of the
Governor. } State of Western Australia.
[L.S.]

File No. 5029/13.

WHEREAS by section 31 (1) (a) of the Land Act 1933, the Governor may by Proclamation and subject to such conditions as may be expressed therein classify as of Class "A" any such lands of the Crown reserved to Her Majesty for any purpose; and whereas it is deemed expedient that Reserve Number 14907 for the purpose of "Water and Conservation of Flora and Fauna" as described, should be classified as of Class "A": Now, therefore I, the Governor, with the advice and consent of Executive Council do by this my Proclamation classify as of Class "A" the reserve described hereunder.

Schedule

Reserve Number 14907 comprising Ninghan Location 1526 and containing an area of 174.8242 hectares.

(Plan Ballidu N.E. 1:25 000.)

Given under my hand and the Public Seal of Western Australia, at Perth, on 18 April 1989.

By His Excellency's Command,
E. K. HALLAHAN,
Minister for Lands.

GOD SAVE THE QUEEN !

Land Act 1933

PROCLAMATION

WESTERN AUSTRALIA } By His Excellency Professor Gordon Reid, Com-
GORDON REID, } panion of the Order of Australia, Governor of the
Governor. } State of Western Australia.
[L.S.]

File No. 4505/57.

WHEREAS by section 31 (2) of the Land Act 1933, the Governor may by Proclamation cancel the reservation of any land classified as of Class "B"; and whereas it is deemed expedient that Reserve No. 24979 for the purpose of "Conservation of Flora and Fauna" as described in the Schedule hereunder should be cancelled: Now therefore, I, the Governor, with the advice and consent of Executive Council do by this my Proclamation cancel the reservation as of Class "B" the land described in the Schedule hereunder.

Schedule

Reserve No. 24979 comprising Lancelin and Edwards Islands containing an area of about 8.6189 hectares.

(Public Plan Lancelin Regional and 1:2 000 21.06.)

Given under my hand and the Public Seal of Western Australia, at Perth on 18 April 1989.

By His Excellency's Command,
E. K. HALLAHAN,
Minister for Lands.

GOD SAVE THE QUEEN !

Land Act 1933

PROCLAMATION

WESTERN AUSTRALIA } By His Excellency Professor Gordon Reid, Com-
GORDON REID, } panion of the Order of Australia, Governor of the
Governor. } State of Western Australia.
[L.S.]

File No. 1528/79.

WHEREAS by section 31 (1) (a) of the Land Act 1933, the Governor may by Proclamation and subject to such conditions as may be expressed therein classify as of Class "A" any such lands of the Crown reserved to Her Majesty for any purpose; and whereas it is deemed expedient that Reserve No. 36519 for the purpose of "Conservation of Flora and Fauna" as described, should be classified as of Class "A": Now, therefore I, the Governor, with the advice and consent of Executive Council do by this my Proclamation classify as of Class "A" the reserve described hereunder.

Schedule

Reserve No. 36519 comprising Avon Location 7019, 7612, 26016 and 28956 and containing an area of 242.8014 hectares accordingly.

(Plan Brookton S.W. 1:25 000.)

Given under my hand and the Public Seal of Western Australia, at Perth, on 18 April 1989.

By His Excellency's Command,
E. K. HALLAHAN,
Minister for Lands.

GOD SAVE THE QUEEN !

Land Act 1933

PROCLAMATION

WESTERN AUSTRALIA } By His Excellency Professor Gordon Reid, Com-
GORDON REID, } panion of the Order of Australia, Governor of the
Governor. } State of Western Australia.
[L.S.]

File No. 1900/984.

WHEREAS by section 31 (1) (a) of the Land Act 1933, the Governor may by Proclamation and subject to such conditions as may be expressed therein classify as of Class "A" any such lands of the Crown reserved to Her Majesty for any purpose; and whereas it is deemed expedient that the reserves listed in the schedule for the purpose of "Conservation of Flora and Fauna" as described, should be classified as of Class "A": Now, therefore I, the Governor,

23.5.89
I. Lands

with the advice and consent of Executive Council do by this my Proclamation classify as of Class "A" the reserve described in the schedule.

Schedule

File Number; Reserve Number; Land Description; Area (hectares); Plan.

- 2106/66—33113; Fitzgerald Locations 1589, 1622 and 1623; 8859.5543; 392/80.
- 100/73—33828; Charlie Island; Indeterminable; Edel 1:250 000.
- 3270/06—33842; All those portions of land delineated and bordered red on Lands and Surveys Reserve Plan No. 35 including Hay Locations 788, 158, 216, 113, 110, 111, 142, 692 and 1724 to 1734 (inclusive) together with Plantagenet Locations 1598, 1209, 4367 and 3123 and excluding roads; 3825.4123; Parry Inlet NW & NE and Owingup SW 1:25 000.
- 2361/70—33854; Ninghan Location 4189; 19.5084; 65/80.
- 4281/74—34197; Jilbadji Location 936; 637.4387; 23/80.
- 3265/72—34257; Swan Island; about 29.0322; Yampi 1:250 000.
- 2043/67—34295; Roe Location 2688; 929.0621; 346/80.
- 5433/27—35217; Ninghan Locations 4206 and 4207; 70.1177; 65/80.
- 1375/28—35413; Avon Location 25238; 592.1195; Trayning 1:50 000 and Kodi Kodjin 1:50 000.
- 3736/11—35428; Plantagenet Locations 7412 and 7427; about 97.1726; Tambellup SE 1:25 000.
- 681/52—35621; Denmark Lot 352; 12.3176; Denmark 1:2 000 20.12 and 20.13.
- 3268/72—36056; Rocky Islets; about 40.9500; 422/80.
- 3624/78—36183; Esperance Location 1873; 357.5296; 402/80 and 403/80.
- 1472/78—36334; Pintharuka Lot 37; 61.5892; Pintharuka Townsite.
- 1604/69—36550; Plantagenet Location 7453; 174.0938; Two Peoples Bay NE 1:25 000.
- 3946/77—36608; Fitzgerald Location 1649; 80.6128; Dowak Townsite.
- 3379/980—36967; Kent Location 2042; 145.8710; 418/80.
- 2534/980—37054; Williams Location 15700; 16.3127; Congelin SW 1:25 000.
- 1817/70—37316; Victoria Location 10572; about 60.7028; Wongoondy NW 1:25 000.
- 1237/983—38296; Avon Location 28716; 143.9107; Norpa 1:50 000 and 24/80.
- 800/982—38334; Neridup Location 484; 407.8176; 400/80.
- 573/26—38415; Wellington Location 2642; 40.4686; Muja SE 1:25 000.
- 1747/983—38522; Yarding Lot 37; 69.2599; Yarding Townsite.
- 2788/983—38544; Neridup Location 495; 839.0247; 400/80.
- 3245/982—38545; Neridup Location 488; 1670.5074; 400/80.
- 4340/29—38574; Ninghan Location 4237; 92.1582; Beacon 1:50 000.
- 1108/17—38578; South Kumminin Lot 37 and Avon Location 19666; 81.2932; South Kumminin Townsite.
- 6850/10—38703; Amery Lot 31; 70.2161; Amery Townsite.
- 3097/983—38800; Yilgarn Location 1517; 66.3183; 54/80.
- 2496/28—39038; Ninghan Location 2790; 185.1051; Newcarlbeon NW 1:25 000.

Given under my hand and the Public Seal of Western Australia, at Perth, on 18 April 1989.

By His Excellency's Command,
E. K. HALLAHAN,
Minister for Lands.

GOD SAVE THE QUEEN !

Land Act 1933

PROCLAMATION

WESTERN AUSTRALIA } By His Excellency Professor Gordon Reid, Com-
GORDON REID, } panion of the Order of Australia, Governor of the
Governor. } State of Western Australia.
[L.S.]

File No. 1900/984.

WHEREAS by section 31 (2) of the Land Act 1933, the governor may by Proclamation cancel the reservation of any land classified as of Class "B"; and whereas it is deemed expedient that the Reserves described and listed in the attached Schedule for the purpose of "Conservation of Flora and Fauna" should be cancelled: Now therefore, I, the Governor, with the advice and consent of Executive Council do by this my Proclamation cancel the reservation as of Class "B" the land described in the Schedule.

Schedule

File numbers; Reserve numbers; Land Description; Area (hectares); Plan.

- 1389/67—29253; North, Middle and South Cervantes Islands; about 4000; Cervantes Regional.
- 1392/67—29256; Fisherman Islands—North and South Islands; about 5.2419; Greenhead and Hill River 1:50 000.
- 1393/67—29257; North, Middle and South Essex Rocks and other unnamed Rocks; about 7.2580; Boullanger and Hill River 1:50 000.
- 1394/67—29258; Outer Rocks; indeterminable; Boullanger and Hill River 1:50 000.
- 1395/67—29259; Milligan, Lipfert, Webb and Snag Islands, Drummond and Orton Rocks; about 6.3709; Greenhead and Lesueur 1:50 000.
- 1396/67—29260; Ronsard Rocks; indeterminable; Boullanger and Hill River 1:50 000.

Given under my hand and the Public Seal of Western Australia, at Perth, on 18 April 1989.

By His Excellency's Command,
E. K. HALLAHAN,
Minister for Lands.

GOD SAVE THE QUEEN !

Land Act 1933

PROCLAMATION

WESTERN AUSTRALIA } By His Excellency Professor Gordon Reid, Com-
GORDON REID, } panion of the Order of Australia, Governor of the
Governor. } State of Western Australia.
[L.S.]

File No. 1900/984.

WHEREAS by Section 31 (1) (a) of the Land Act 1933, the Governor may by Proclamation and subject to such conditions as may be expressed therein classify as of Class "A" any such lands of the Crown reserved to Her Majesty for any purpose; and whereas it is deemed expedient that the reserves listed in the attached schedule for the purpose of "Conservation of Flora and Fauna" as described, should be classified as of Class "A": Now, therefore I, the Governor, with the advice and consent of Executive Council do by this my Proclamation classify as of Class "A" the reserve described in the attached schedule.

Schedule

File numbers; Reserve numbers; Land Description; Area (hectares); Plan.

- 466/28—19784; Wellington Location 4003; 40.4737; Blackwood River S.W. and N.W. 1:25 000.
- 7129/23—21424; Avon Location 23508; 153.7805; Lomos N.W. 1:25 000.
- 5160/49—23029; Ninghan Location 1311; 161.5202; Mollerin 1:50 000.
- 1742/50—23085; Avon Location 28907; 78.2856; Yorkrakine S.E. 1:25 000.
- 3579/64—27384; Neridup Location 218; 604.7327; Burdett 1:50 000.
- 3584/64—27386; Neridup Location 271; 1417.2235; 402/80.
- 3585/64—27387; Neridup Location 286; 812.2041; Burdett 1:50 000.
- 140/63—27452; Avon Location 28192; 39.4973; Bruce Rock 1:50 000.

97

File No. 1875/960.—And whereas by Order in Council dated 11 May, 1977, Reserve No. 25766 was vested in the Shire of Kalamunda in trust for the purpose of "Municipal Purposes".

File No. 7917/12.—And whereas by Order in Council dated 1 February, 1962, Reserve No. 26205 was vested in the Minister for Native Welfare in trust for the purpose of "Native Housing".

File No. 169/64.—And whereas by Order in Council dated 24 February, 1966, Reserve 27139 was vested in the Fauna Protection Advisory Committee of Western Australia in trust for the purpose of "Conservation of Flora and Fauna".

File No. 296/61.—And whereas by Order in Council dated 29 June, 1966, Reserve 28167 was vested in the Fauna Protection Advisory Committee of Western Australia in trust for the purpose of "Conservation of Flora and Fauna".

File No. 1060/73.—And whereas by Order in Council dated 16 May, 1973, Reserve 32017 was vested in the Minister of Water Supply Sewerage and Drainage in trust for the purpose of "Water Supply".

File No. 1528/79.—And whereas by Order in Council dated 20 February, 1980, Reserve 36519 was vested in the Western Australian Wildlife Authority in trust for the purpose of "Conservation of Flora and Fauna".

File No. 2592/79.—And whereas by Order in Council dated 29 October, 1980, Reserve 36943 was vested in the City of Stirling in trust for the purpose of "Recreation".

File No. 2831/82.—And whereas by Order in Council dated 30 September, 1983, Reserve 38477 was vested in the Shire of Wyndham-East Kimberley in trust for the purpose of "Aged Persons Homes".

File No. 2056/85.—And whereas by Order in Council dated 27 August, 1985, Reserve 39189 was vested in the Shire of Kent in trust for the purpose of "Recreation (Go Kart Racing)" with power, subject to the approval in writing of the Minister for Lands being first obtained, to lease the whole or any portion thereof for any term not exceeding twenty one (21) years from the date of the lease.

File No. 1900/84.—And whereas by Order in Council issued on dates specified in the attached Schedule the respective Reserves were vested in the Western Australian Wildlife Authority in trust for the purpose of "Conservation of Flora and Fauna".

Schedule	
Reserve Nos;	Date of Order in Council.
4313	November 21, 1980.
8830	November 5, 1975.
15564	August 2, 1983.
15570	May 1, 1980.
16136	April 29, 1981.
16235	July 5, 1983.
16293	March 6, 1984.
16346	May 24, 1978.
16412	May 28, 1980.
16493	October 29, 1980.
16683	June 21, 1983.
17055	April 8, 1970.
17257	April 8, 1970.
17771	May 31, 1983.
17778	June 29, 1981.

File No. 1900/84.—And whereas by Orders in Council issued on dates specified in the attached Schedule the respective Reserves were vested in the Western Australian Wildlife Authority in trust for the purpose of "Conservation of Flora and Fauna".

Schedule	
Reserve Nos;	Order in Council Date.
27384	August 3, 1981.
27387	July 5, 1983.
27452	September 18, 1979.
27837	July 11, 1973.
28047	August 26, 1981.
28313	July 9, 1980.
28317	May 1, 1980.
28318	May 13, 1980.
28319	May 13, 1980.
28471	January 26, 1972.
28940	November 8, 1983.

29012	August 2, 1983.
29018	February 4, 1970.
29019	February 4, 1970.
29020	January 14, 1970.
29021	February 4, 1970.
29022	January 14, 1970.
29023	January 14, 1970.
29025	February 4, 1970.
29026	February 4, 1970.
29027	November 21, 1980.
29253	November 9, 1978.
29256	November 9, 1978.
29257	November 9, 1978.
29258	November 9, 1978.
29259	November 9, 1978.
29260	November 9, 1978.
29303	May 1, 1980.
29322	May 1, 1984.
29326	October 1, 1980.
29576	October 25, 1983.
29589	July 5, 1983.
29680	April 15, 1971.
29810	November 12, 1969.
30430	July 9, 1980.
30469	July 19, 1983.
30516	July 5, 1983.
30903	August 8, 1979.
30969	September 5, 1979.
31561	August 2, 1983.
31742	August 30, 1983.
31743	June 29, 1981.
31744	July 5, 1983.
31799	May 16, 1983.
31908	March 21, 1973.
31909	March 21, 1973.
31913	March 6, 1984.
32129	September 30, 1983.
32130	September 30, 1983.
32131	July 19, 1983.
32549	November 21, 1980.
32776	July 17, 1974.
32783	July 17, 1974.
32864	May 3, 1983.
32865	May 3, 1983.
32993	May 3, 1983.
32995	November 27, 1974.

File No. 1900/84.—And whereas by Orders in Council issued on dates specified in the attached schedule the respective Reserves were vested in the Western Australian Wildlife Authority in trust for the purpose of "Conservation of Flora and Fauna".

Schedule	
Reserve Nos;	Date of Order in Council.
33113	January 22, 1975.
33828	January 14, 1976.
33842	January 28, 1976.
33854	January 28, 1976.
34197	August 11, 1976.
34257	September 8, 1976.
34295	August 3, 1981.
35217	August 3, 1978.
35413	July 5, 1978.
35428	July 19, 1983.
35621	August 2, 1983.
36056	May 2, 1979.
36183	July 11, 1979.
36334	October 17, 1979.
36550	March 5, 1980.
36608	February 18, 1981.
36967	November 14, 1980.
37054	August 2, 1983.
37316	August 3, 1981.

CLERK, WOODVALE - RYI

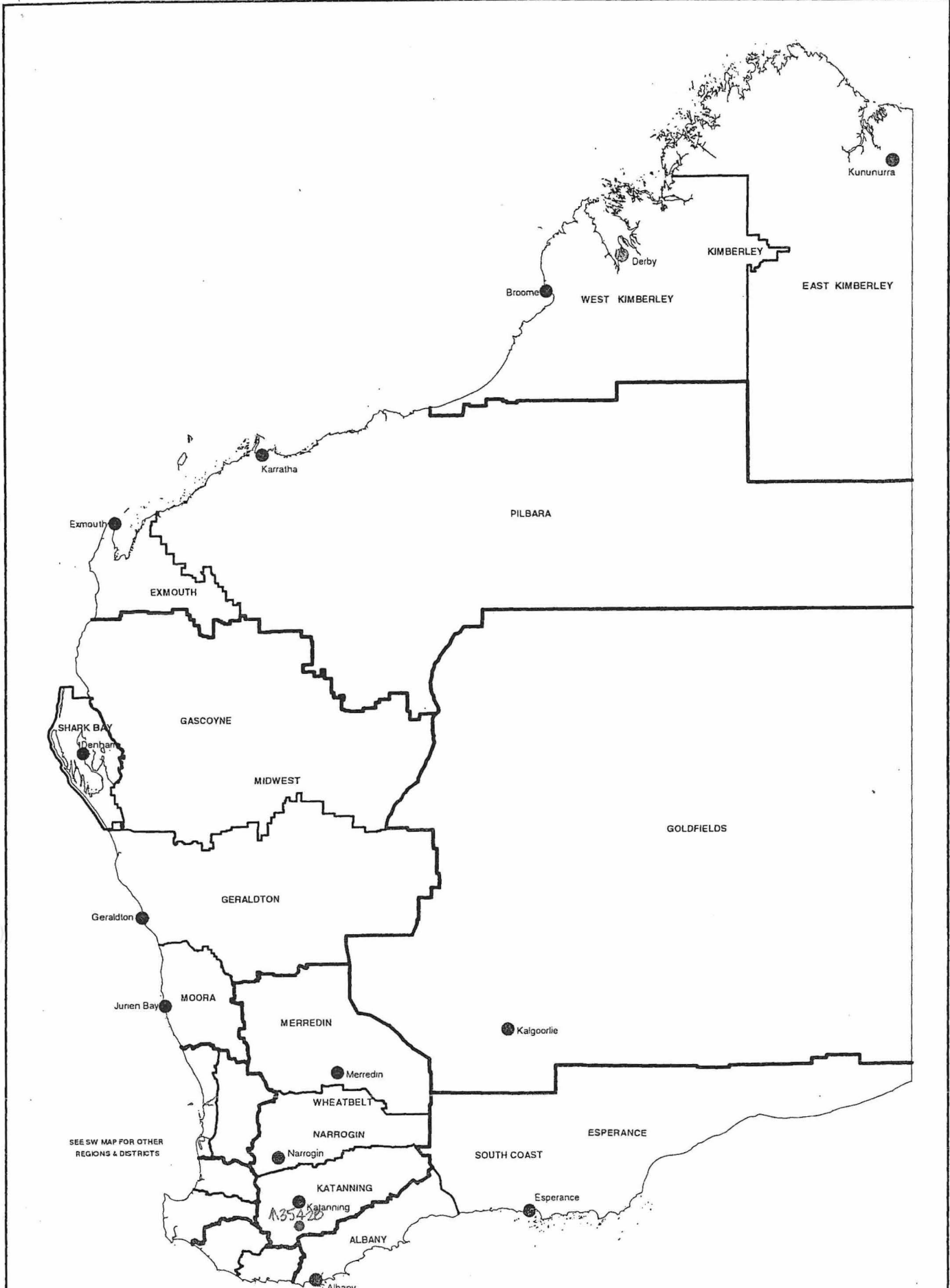

**DEPARTMENT OF CONSERVATION AND LAND MANAGEMENT
REGION AND DISTRICT BOUNDARIES**

OCTOBER 2001

560 562

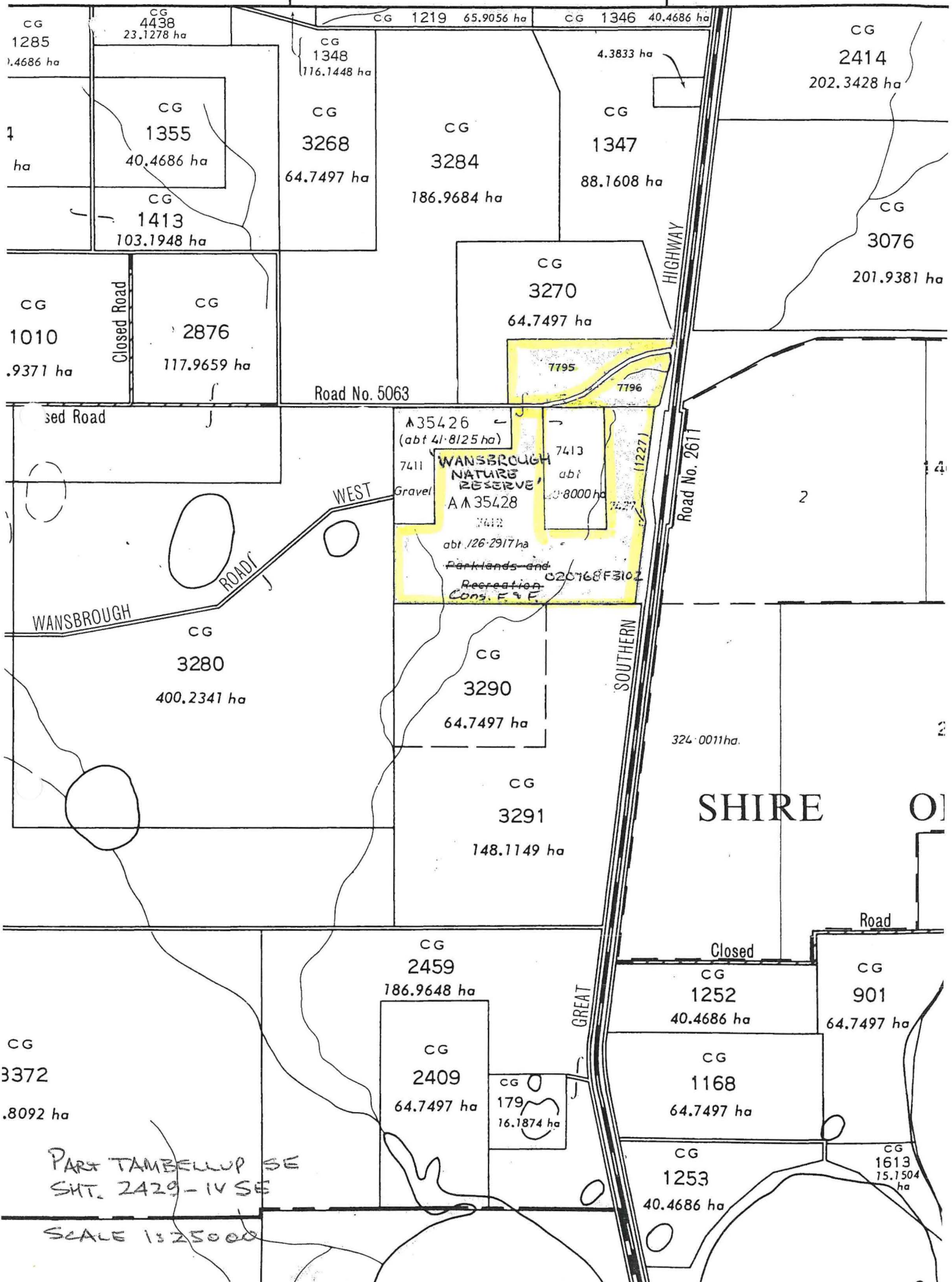

CG 1285 1.4686 ha

CG 4438 23.1278 ha

CG 1348 116.1448 ha

CG 1346 40.4686 ha

CG 1347 88.1608 ha

CG 2414 202.3428 ha

CG 1355 40.4686 ha

CG 3268 64.7497 ha

CG 3284 186.9684 ha

CG 3076 201.9381 ha

CG 1413 103.1948 ha

CG 1010 1.9371 ha

CG 2876 117.9659 ha

CG 3270 64.7497 ha

CG 3280 400.2341 ha

CG 3290 64.7497 ha

CG 3291 148.1149 ha

CG 2459 186.9648 ha

CG 2409 64.7497 ha

CG 179 16.1874 ha

CG 1252 40.4686 ha

CG 1168 64.7497 ha

CG 1253 40.4686 ha

CG 901 64.7497 ha

CG 1613 15.1504 ha

CG 35426 (abt 41.8125 ha)

CG 7411 Gravel

CG 7412 abt 126.2917 ha

CG 7413 abt 8000 ha

CG 7427

CG 7195

CG 7196

CG 320768 F3102

WANSBROUGH NATURE RESERVE

AA 35428

Parklands and Recreation Cons. F & F.

WANSBROUGH ROAD

WEST ROAD

SOUTHERN HIGHWAY

Road No. 5063

Road No. 2617

Closed Road

SHIRE OF TAMBELLUP

PART TAMBELLUP SE SHT. 2429 - IV SE

SCALE 1:25000

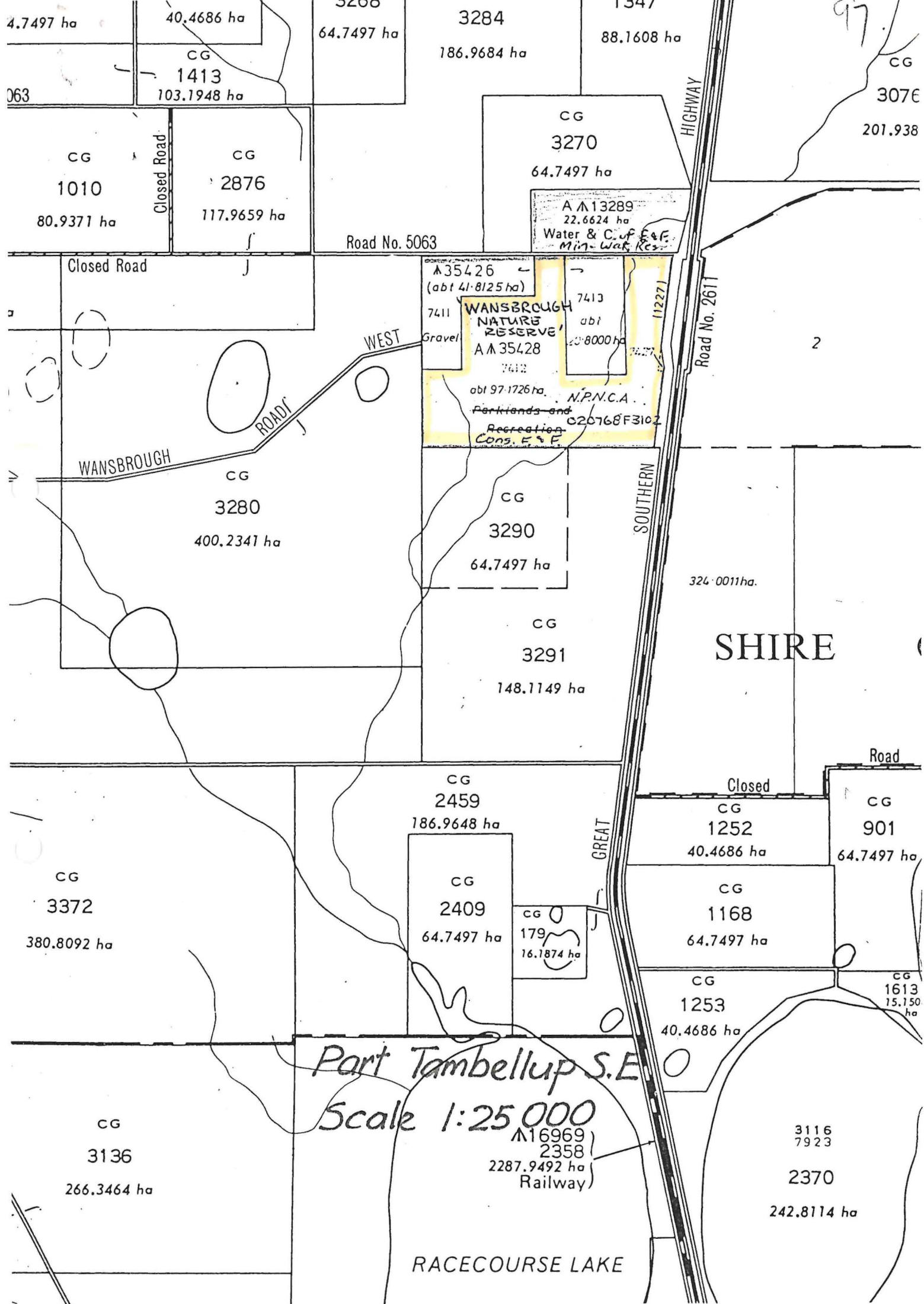

4.7497 ha
063

40.4686 ha
CG
1413
103.1948 ha

3200
64.7497 ha

3284
186.9684 ha

1347
88.1608 ha

97
CG
3076
201.938

CG
1010
80.9371 ha

Closed Road
CG
2876
117.9659 ha

Road No. 5063

CG
3270
64.7497 ha
A M 13289
22.6624 ha
Water & C. of F&F
Min. Wat. Res.

HIGHWAY
Road No. 2611
2

Closed Road
WANSBROUGH ROAD
CG
3280
400.2341 ha

Gravel
A 35426
(abt 41.8125 ha)
7411
WANSBROUGH NATURE RESERVE
A M 35428
7412
abt 97.1726 ha
N.P.N.C.A.
Parkslands and Recreation
Cons. F & F
020768F3102
7413
abt 8000 ha
11227

CG
3290
64.7497 ha

SOUTHERN
324.0011 ha
SHIRE

CG
3291
148.1149 ha

CG
3372
380.8092 ha

CG
2459
186.9648 ha

Closed
CG
1252
40.4686 ha
CG
901
64.7497 ha

CG
2409
64.7497 ha

CG
179
16.1874 ha

CG
1168
64.7497 ha

CG
1253
40.4686 ha

CG
1613
15.150 ha

CG
3136
266.3464 ha

Part Tambellup S.E.
Scale 1:25 000
A 16969
2358
2287.9492 ha
Railway

3116
7923
2370
242.8114 ha
RACECOURSE LAKE

3270
DIA A836

AA13289
7795
19.6470 ha.

7796
9.4721 ha.

A35426
7413
RES DIA 253

A 35428
7412
RES DIA 254

1347
DIA 49092

HIGHWAY

ROAD

SOUTHERN

GREAT

WATERCARRUP

COMPILED FROM O.P. 1758, DIA's A836 & 49092

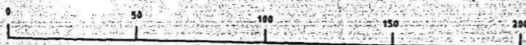

I hereby certify that this plan is a correct and true representation of the land shown on the subject land and that this plan is in accordance with the requirements of the Land Administration Act, 1978.

DATE: 7-95

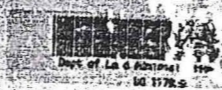

94-118-CSD

LAND DISTRICT PLANTAGENET		LOCATIONS 7795 & 7796		 DEPT. OF LAND ADMINISTRATION PLAN 18750
I hereby certify that: a) this plan is a correct and accurate representation of the survey carried out by me personally or under my supervision; b) the measurements are to correct measurements with the Standard Surveyors' Edition of Surveyors' Regulations 1978 and to particular regulations 7 and 36 of those regulations; and c) this survey and this plan of survey are in strict accordance with the requirements of the Land Administration Act, 1978 and the relevant law in relation to that Act.		SCALE: 1:1500 Measurements to surface	FILE: 14728/910	
Prepared by: JOHN BULLOCK & ASSOCIATES	Compiled: L. P. van der Merwe	SURVEYOR: L. P. van der Merwe	PUBLIC PLAN NO.: TABELLUP DE 028	
TYPE OF VALIDATION: Full Survey	Legal Enquiry: None	FIELD BOOK: None	DEPARTMENT OF LAND ADMINISTRATION	
In order to: Authorised Land Officer	Date: 5-8-95	LOCAL AUTHORITY: SHIRE OF TROBRIKUP LOCALITY: LODGED: M.S.S. 6-3-95	PLAN 18750	