

**RESERVE GAZETTAL ACTION SHEET
FOR REGIONS AND DISTRICTS**

LANDS CLERK: Attach a copy of map and forward to the following:

1. REGIONAL MANAGER:
CENTRAL FOREST, GREENOUGH, GOLDFIELDS, KIMBERLEY,
NORTHERN FOREST, PILBARA, SOUTH COAST, SOUTHERN FOREST,
WHEATBELT
2. DISTRICT MANAGER: PERTH
3. **CLERK, WOODVALE**
4. O.I.C. INVENTORY BUNBURY/KELMSCOTT/MANJIMUP
5. DISTRICT WILDLIFE OFFICER: COMO

REASON FOR GAZETTAL:

change in class "c" to "A" change in purpose from "Conservation of Flora + Fauna" to "Marine Park". to comprise location 11339 in lieu of location 11012 and its area being increased by 1.65ha to 5.52ha.

RESERVE DETAILS

RESERVE NUMBER:	<u>40891</u>
CALM FILE NUMBER:	<u>016368F4101.</u>
MAP REFERENCE:	<u>PERTH 1:2000</u>
SHIRE:	<u>SUBIACO</u>

CHANGES MADE AT GIVEN GAZETTAL DATE

NAME OF RESERVE:	_____
PURPOSE:	<u>Marine Park.</u>
CLASS:	<u>"A"</u>
AREA:	<u>5.52 ha.</u>
VESTING:	<u>NPNCA.</u>
DATE AND PAGE NO. OF CURRENT GAZETTAL:	<u>13/9/91 4791.</u>

LANDS CLERK

14/4/92.
DATE

(09) 367 0221

13/9/91

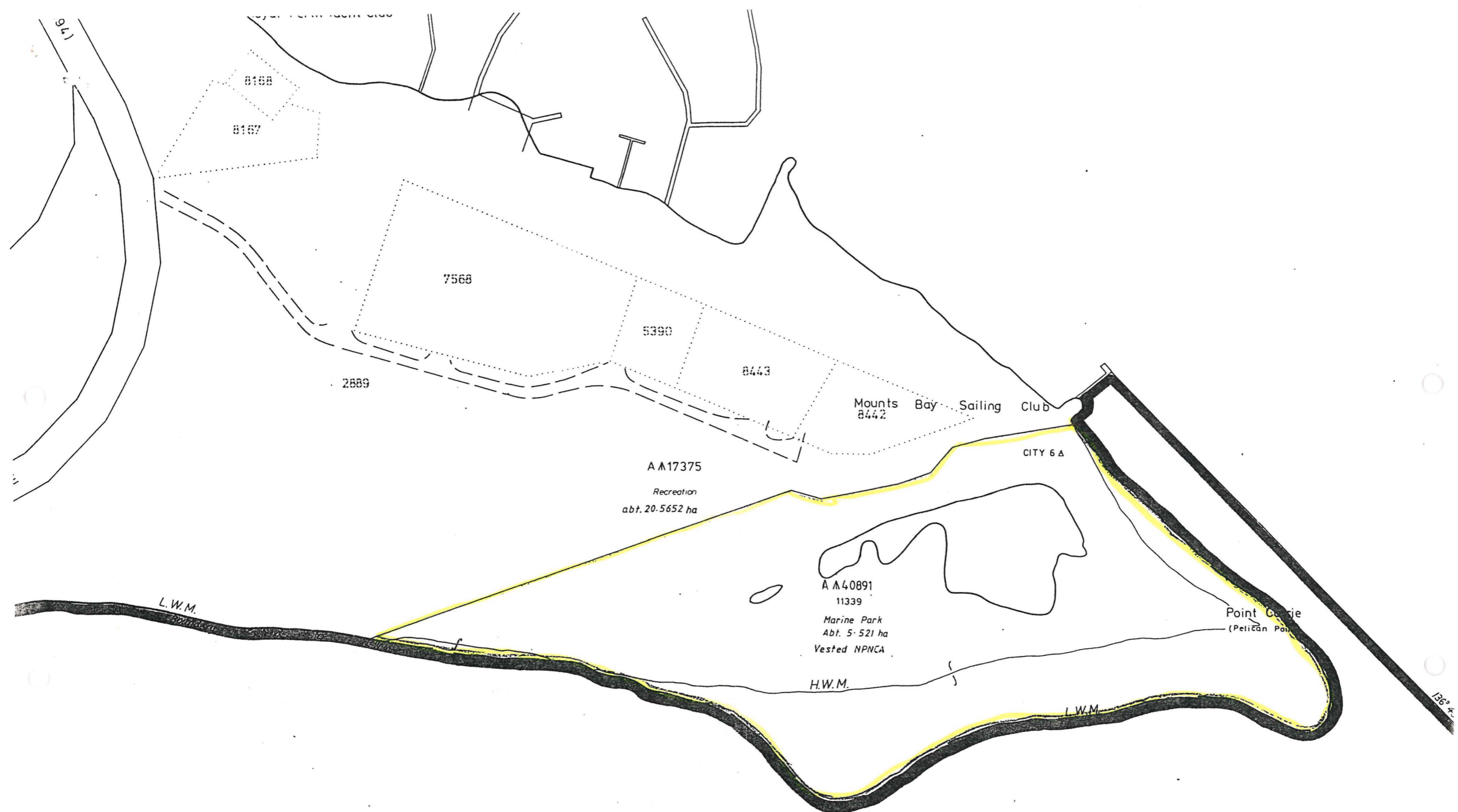

PART CLASS 'A' MARINE RESERVE No 4

'Swan Estuary Marine Park'

N.P.N.C.A.

027715 F4101

MELVILLE

WATER

Part Perth 2000 Bg. 34 / 11.21

Scale 1: 2000

AMENDMENTS



FORMERLY LOCATION 11012 & PT A17375
 SUPERSEDES DIA. #8377

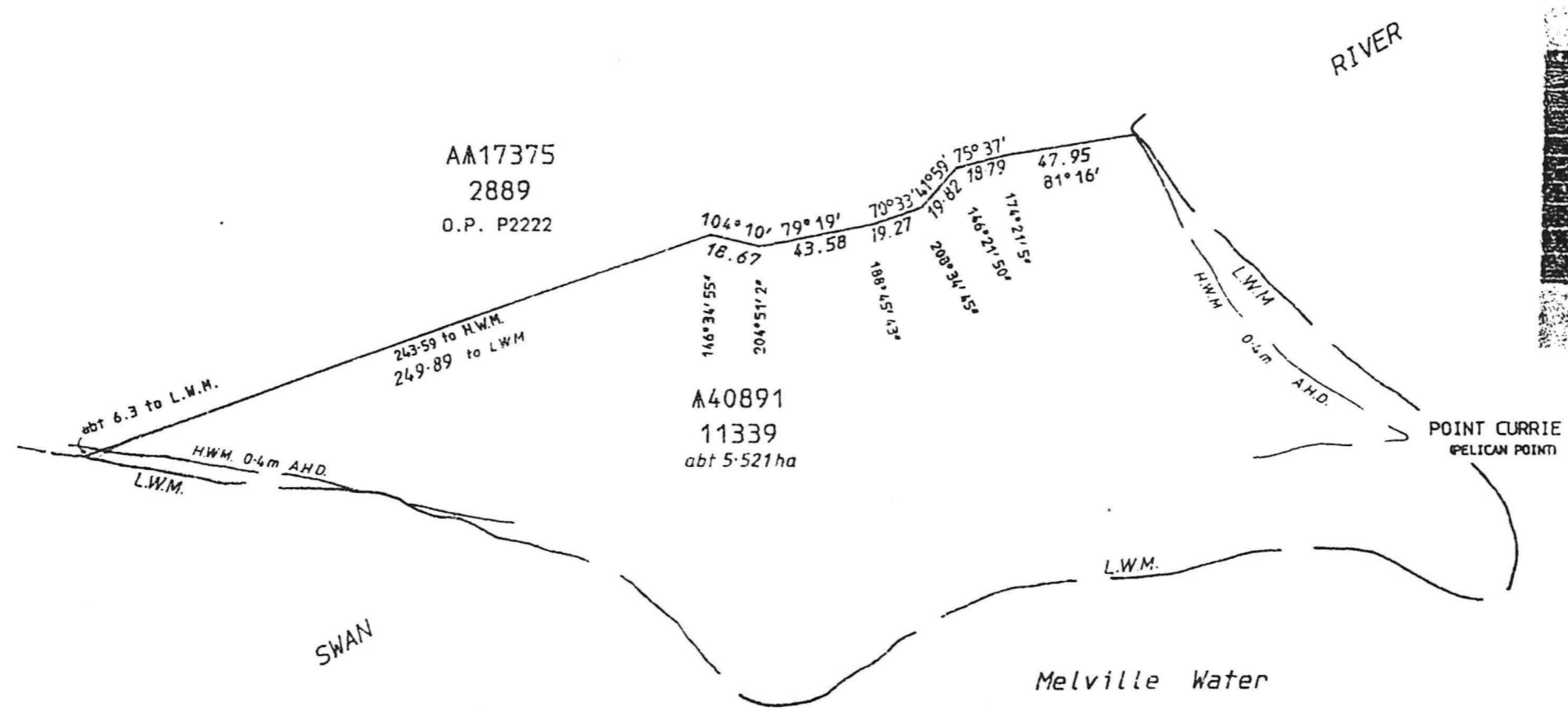

HIGH WATER MARK DERIVED FROM AERIAL PHOTOGRAPHY (W.A. 2501C) DATED 2-7-1987
 WATER LINES SHOWN ON THIS PLAN DO NOT NECESSARILY DEPICT AN EXACT CADASTRAL BOUNDARY

LAND DISTRICT SWAN	LOCATION 11339	FILE No. 954/989
		SCALE 1:2000 ALL measurements in metres
SURVEYOR'S CERTIFICATE I hereby certify that this survey was performed by me personally (or under my personal supervision, inspection and field check), in strict accordance with the Licensed Surveyors (Guidance of Surveyors) Regulations. C.M.P./L.E.D. Licensed Surveyor, Date	Asimuth observed at or assumed from Surveyor Field Book No. Page Public Plan Reference Index Plan	DIAGRAM CERTIFIED CORRECT
	Calculated by Checked with F.B. Examined In order for certification.	DIAGRAM CERTIFIED CORRECT
	Examined by In order for certification.	Date
	Public Plan Reference Index Plan	Recorded on Public Plan
	Perth 2000 11.21	Registered On May Plan
	Perth 2000 11.21	R.P.P. 10-5-90 Perth 2000 11.21
		DEPT. OF LAND ADMINISTRATION DIAGRAM 895