

RESERVE GAZETTAL ACTION SHEET FOR REGIONS AND DISTRICTS

LANDS CLERK: Attach a copy of map and forward to the following:

1. REGIONAL MANAGER:
CENTRAL FOREST, GREENOUGH, GOLDFIELDS, KIMBERLEY, SWAN REGION, PILBARA,
SOUTH COAST, SOUTHERN FOREST, WHEATBELT
2. DISTRICT MANAGER: _____
3. CLERK, WOODVALE
4. O.I.C. INVENTORY BUNBURY / KELMSCOTT / MANJIMUP
5. DISTRICT WILDLIFE OFFICER: _____

REASON FOR GAZETTAL:

Creation of reserve (class C, Cons. of Flora and Fauna)
following donation from private source.

RESERVE DETAILS

RESERVE NUMBER: 42815

CALM FILE NUMBER: 015636F 3102

MAP REFERENCE: YUNA 1941 III SE (25)

SHIRE: CHAPMAN VALLEY

CHANGES MADE AT GIVEN GAZETTAL DATE

NAME OF RESERVE: _____

PURPOSE: Conservation of Flora and Fauna

CLASS: C

AREA: 722.92 Ha

VESTING: NPNCA

DATE AND PAGE NO. OF CURRENT GAZETTAL: 24/8/93; 4567

B2.
LANDS CLERK

(09) ³³⁴~~367~~ 0221

2/3/94
DATE

Vf 9/3/94.

RESERVE ACTION SHEET: CONSERVATION RESERVES

RESERVE No. 42815

LOCAL GOVERNMENT: Shire of Chapman Valley

NAME: McGauran Nature Reserve

PURPOSE: Conservation of Flora and Fauna

VESTING: Conservation Commission of Western Australia

ACTION: Addition of Reserve No. 50299 to Reserve No. 42815 'McGauran Nature Reserve' being Lot 6836 on DP 226769.

Total Area: From 722.93 to 845.78ha

REASON FOR ACTION

Mr Duncan McGauran donated 722ha in 1990 for 'conservation', this area is now identified as McGauran Nature Reserve (class 'A' Reserve 42815). His sister, Miss Jean McGauran, bequeathed the adjoining land being Lot 6836 on DP 226769 to the then Department of Environment and Conservation (DEC). DEC originally proposed that Lot 6836 (now Reserve 50299) be set aside a nature reserve. However, the Shire of Chapman Valley opposed the creation of a class 'A' nature reserve in 2004, so the reserve was created with the purpose of 'Conservation and Seed Orchard'. The Shire has now withdrawn their opposition and supports the addition of Reserve 50299 to class 'A' Reserve 42815 'McGauran Nature Reserve'. The enlarged nature reserves remains class A.

Date of amendment: 16/08/2013

Maps: p. 43

Customer advice: p. 47

Proposal Summary: see p. 47

IUCN classification: 1a

LAND UNIT LEADER	To note	<i>SH</i> 9/7/2014
2 LAND UNIT	Send copies of RAS, advice and maps to: <ul style="list-style-type: none"> • Lisa Wright (Kensington) DIGITAL COPY • District Manager DIGITAL COPY • Regional Manager DIGITAL COPY Attach TENIS gazettal history to file (front cover) Strikethrough from District Proposals spreadsheets Create Conservation Commission summary	<i>SH</i> <i>SH.</i> <i>SH.</i>
3 DIRECTOR, SCIENCE AND NATURE CONSERVATION	To note	
4 C.I.S.	Please rename file/create new file Keyword: Activity: <i>N/A</i> Subject: Free text:	

(MIDWEST REGION
GERALDTON DISTRICT)

Customer Advices for Reserve Actions
1/08/2013 - 31/08/2013

Shire of Chapman Valley 1/08/2013 - 31/08/2013

(DPAW FILE NO 2010/004217)

Reserve No.	Land Description	DoL File No.	Volume/Folio	Action	Document No.	Registered	Street Name	Area	Public Plans
265	Lot 11545 on Deposited Plan 91525	02009-1917-01RO	3075-375	Change of Purpose to "Recreation, Camping and Landscape Protection"	M257211	30/04/2013		45.241 Ha	
265	Lot 11545 on Deposited Plan 91525	02009-1917-01RO	3075-375 3075-375	Management Order to Shire of Chapman Valley of PO Box 1, NABAWA WA 6532 for the designated purpose of "Recreation, Camping and Landscape Protection"	M257212	30/04/2013		45.241 Ha	
265	Lot 11545 on Deposited Plan 91525	02009-1917-01RO	3075-375	?	M257210	30/04/2013		45.241 Ha	
42815 50299	Lot 11931 on Deposited Plan 218247 Lot 6835 on Deposited Plan 226793	00689-1992-01RO	3099-266 3010-624	Amalgamation Order for Certain Class 'A' Reserves to Reserve 50299 to be included into Reserve 42815 & area = 0 Square metres	M373762	16/08/2013		0 sqm	1941-111 S.E
42815 50299	Lot 11931 on Deposited Plan 218247 Lot 6835 on Deposited Plan 226793	00689-1992-01RO	3099-266 3010-624	Amalgamation Order for Certain Class 'A' Reserves to Reserve 50299 to be included into Reserve 42815 & area = 0 Square metres	M373762	16/08/2013		0 sqm	1941-111 S.E

AMALGAMATION OF R50299 INTO R42815 (M^cGAURAN NR)

R50299 CANCELLED (122.9859ha)

AMENDED R42815 NOW INCLUDES R50299 (CANCELLED)

AND TOTAL AREA IS NOW (845.7863ha)

TO: ANNE GREIG (LAND UNIT),

ALL DATABASES INCLUDING TENIS

AMENDED. RELEVANT DOCUMENTS

ADDED TO THIS FILE ON PAGES 43-47.

ROB DORIA

TENURE OFFICER

GIS BRANCH

22/5/14 R.Doria

WHITE FOLDER - 21/5/14 RD.

TENIS - 21/5/14 RD

SHAPE FILE - 21/5/14 RD

PROPOSED

TENURE - N/A

AA102

LAND ACT 1933
CANCELLATION OF "B" CLASSIFICATION
PROCLAMATION

WESTERN AUSTRALIA } By His Excellency Major General Philip Michael
 P. M. Jeffery, Governor. } Jeffery, Officer of the Order of Australia, Military
 [L.S.] } Cross, Governor of the State of Western
 Australia.

DOLA File: 2101/976.

Under section 31 (2) of the Land Act 1933, I, the Governor acting with the advice and consent of the Executive Council, hereby cancel as of Class "B" Reserve No. 1091 (Guildford Lot 186) for the designated purpose of "Government Requirements".

Given under my hand and the Seal of the State on 2 August 1994.

By His Excellency's Command,

GEORGE CASH, Minister for Lands.

GOD SAVE THE QUEEN !

AA103

LAND ACT 1933
CLASSIFICATION OF RESERVED LANDS
PROCLAMATION

WESTERN AUSTRALIA } By His Excellency Major General Philip Michael
 P. M. Jeffery, Governor. } Jeffery, Officer of the Order of Australia, Military
 [L.S.] } Cross, Governor of the State of Western
 Australia.

DOLA File: 689/992.

Under section 31 (1) (a) of the Land Act 1933, I, the Governor acting with the advice and consent of the Executive Council, hereby classify as of Class "A" Reserve No. 42815 comprising Victoria Location 11931 with an area of 722.9283 hectares for the designated purpose of "Conservation of Flora and Fauna".

Local Authority—Shire of Chapman Valley.

Given under my hand and the Seal of the State on 2 August 1994.

By His Excellency's Command,

GEORGE CASH, Minister for Lands.

GOD SAVE THE QUEEN !

CONSERVATION AND LAND MANAGEMENT

CM401

CONSERVATION AND LAND MANAGEMENT ACT 1984
DEPARTMENT OF CONSERVATION AND LAND MANAGEMENT
Montebello Islands Conservation Park

Compatible Operations Notice

Call for public submissions on the intention to issue licences/leases for tourist and commercial recreation operations in Montebello Islands Conservation Park

This notice is made by the Executive Director of the Department of Conservation and Land Management under section 33A of the Conservation and Land Management Act 1984 with reference to compatible operations.

As a management plan does not exist for the Montebello Islands Conservation Park, the CALM Act 1984 requires the Department to notify the public of intentions to conduct "compatible operations" and seek comment on those operations.

The Department of Conservation and Land Management has been approached by tourist operators for approval to operate tourist services and facilities in the Montebello Islands Conservation Park.

The Department intends to call for "Expressions of Interest" by commercial operators to offer a variety of tourist services and facilities that will enhance public enjoyment whilst protecting the environmental integrity of the Park.

Submissions are invited until 6 October 1994. Please do not submit proposals for tourist and commercial operations at this time.

People wishing to make submissions should obtain the "Guide to Submissions" by contacting Denise Hamilton, Department of CALM, Pinnacle House, 16 Ogilvie Road, Mt Pleasant 6153, telephone (09) 364 0777, or Chris Muller, Department of CALM, SGIO Building, Welcome Road, Karratha 6714, telephone (091) 86 8288.

SYD SHEA, Executive Director,
 Department of Conservation and Land Management.

Clark Woodvale FYI.

1. Sharon Colliss - to note above and for plan amendment sheets.

2. Rebecca Clark - for action sheet.

LA302

LAND ACT 1933
LAND (CROWN GRANT IN TRUST) ORDER

DOLA File 1648/962.

Made by His Excellency the Governor under Section 33 (4).

It is directed that Reserve No. 27010 (Swan Location 11672) shall be granted to the Western Australian Fire Brigades Board to be held in trust for the designated purpose of "Fire Station Site" subject to the condition that the grantee shall not transfer, lease or mortgage the whole or any part of the land without the consent of the Governor.

Local Authority: City of Nedlands.

D. G. BLIGHT, Clerk of the Council.

LA401

LAND ACT 1933
ONSLOW TOWNSITE
Amendment of Boundaries

DOLA File 6281/922V5.

His Excellency the Governor in Executive Council has been pleased to approve, under section 10 of the Land Act 1933 of the amendment of the boundaries of Onslow Townsite to include the area described in the Schedule hereunder.

Schedule

All that portion of land the subject of Land Administration Plan 17908.

Public Plan: BE63 (2) 38.05.

A. A. SKINNER, Chief Executive.

LA701

LAND ACT 1933
RESERVATION NOTICES

Made by His Excellency the Governor under Section 29.

The Crown Lands described below have been set apart as public reserves.

DOLA File: 3351/988.

Reserve No. 42256 comprising Plantagenet Locations 2259, 6820, 7419, 7682, 7711 and 7712 on Land Administration Reserve Plan 370 and Location 7746 (formerly portion of Plantagenet Location 466 and being Lots 6 and 7 the subject of Diagram 79397) with an area of about 326.2317 hectares for the designated purpose of "Recreation and Drainage".

Public Plans: Torbay NE and SE (25).

Local Authority—Shire of Albany.

DOLA File: 164/971.

Reserve No. 42629 comprising Swan Location 11853 (formerly portion of each of Swan Locations V and 8815 and being Lot 23 on Plan 18155 and portion of Location 8605) with an area of 6234 square metres on Land Administration Diagram 90997 for the designated purpose of "Public Recreation". Section 20A.

Public Plan: BG34 (2) 13.32 Glanton Way.

Local Authority—City of Stirling.

DOLA File: 689/992.

Reserve No. 42815 comprising Victoria Location 11931 (formerly Victoria Location 6832 and portion of each of Victoria Locations 6835 and 6836) with an area of 722.9283 hectares on Land Administration Plan 18247 for the designated purpose of "Conservation of Flora and Fauna".

Public Plan: Yuna 1941 III SE (25). McGausan Road.

Local Authority—Shire of Chapman Valley.

Reserve 42815 is automatically vested in the National Parks and Nature Conservation Authority pursuant to Section 7 of CALM Act 1984.

*Copy passed to Nat. Park, Geraldton
with the former letter of advice from Vic. Nat. Park
to the Shire of Chapman Valley.*

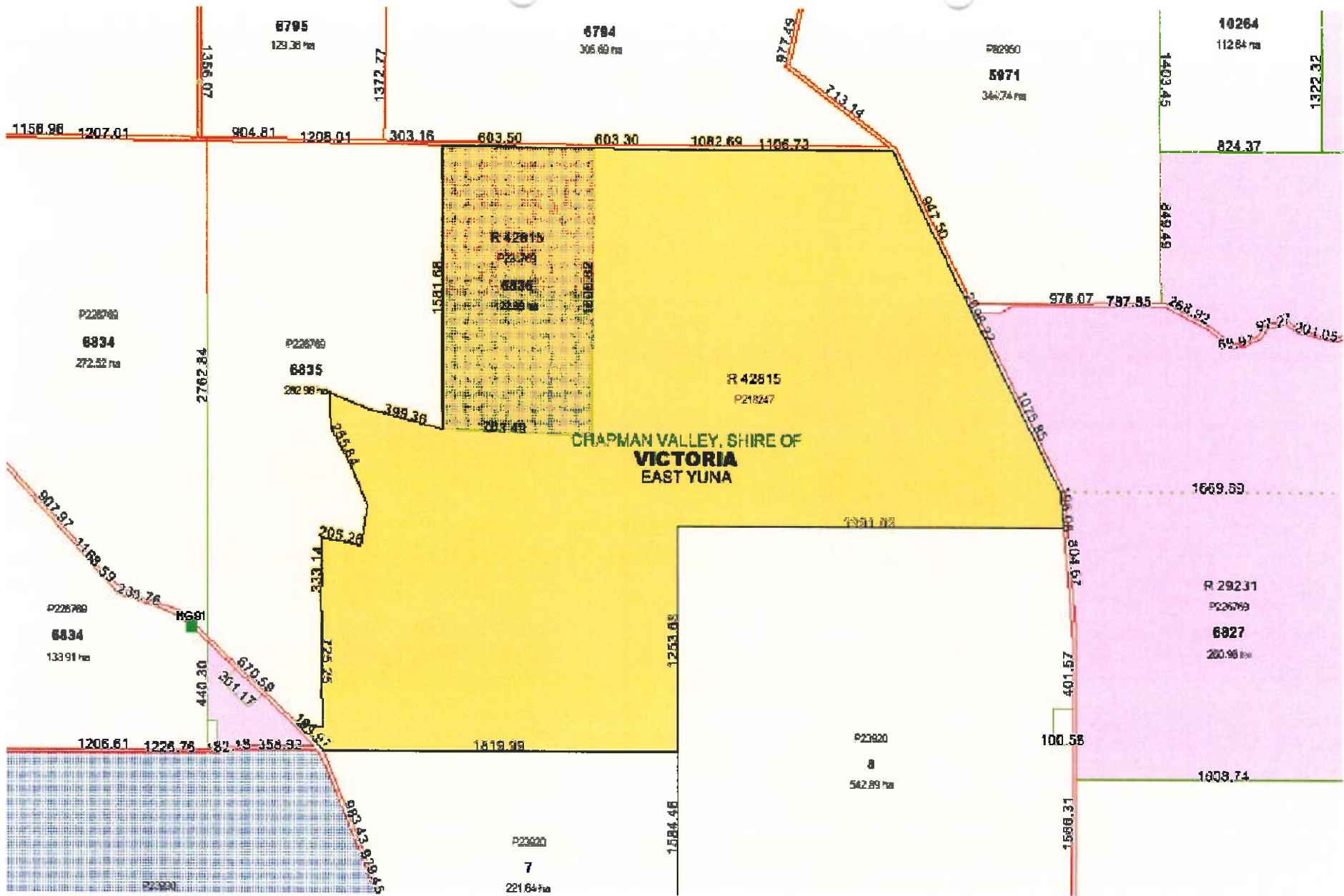

R50299 – formerly 5(1)(h) reserve with an area of 122.9859 ha now amalgamated into R42815 – currently Nature Reserve with an area of 722.9283 ha.

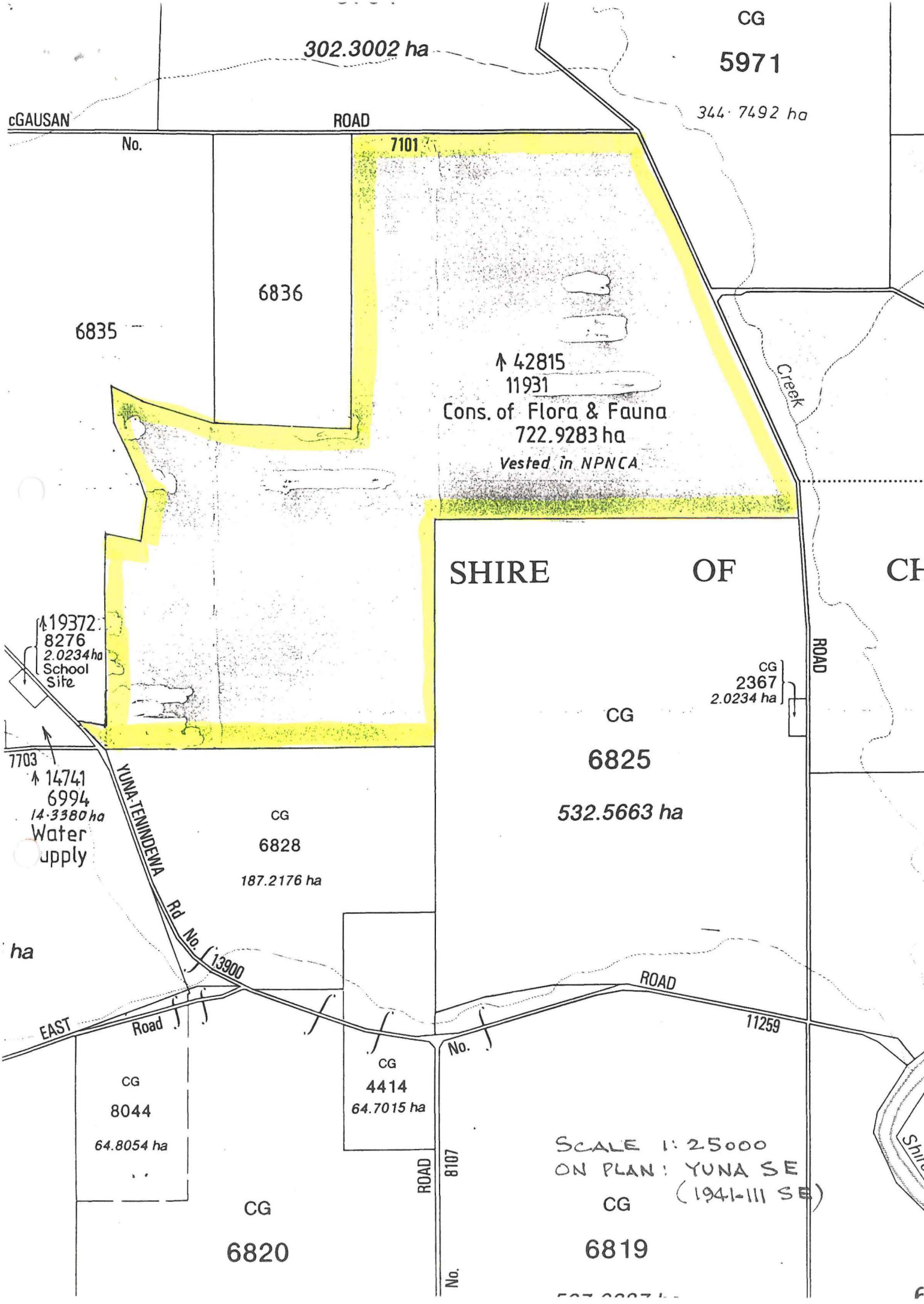

302.3002 ha

CG

5971

344.7492 ha

cGAUSAN

ROAD

No.

7101

6836

6835

↑ 42815
11931

Cons. of Flora & Fauna
722.9283 ha
Vested in NPNCA

Creek

SHIRE

OF

CH

↑ 19372
8276
2.0234 ha
School Site

CG
2367
2.0234 ha

ROAD

CG

6825

532.5663 ha

CG

6828

187.2176 ha

7703

↑ 14741
6994
14.3380 ha
Water supply

YUNA-TENNDEWA Rd. No. 13900

ha

EAST

Road

CG

8044

64.8054 ha

CG

4414

64.7015 ha

No.

ROAD

8107

CG

6820

ROAD

11259

SCALE 1:25000
ON PLAN: YUNA SE
(1941-III SE)

CG

6819

No.

Shire