

RESERVE ACTION SHEET - CONSERVATION RESERVES

RESERVE No. 44838

REASON FOR ACTION

- Amendment to class C Reserve No. 44838, set aside under the care, control and management of the NPNCA for the purpose 'Conservation of Flora and Fauna'. Area: 32.1631 hectares.
- The area of Reserve No. 44838 has been amended from 1.04 hectares to 32.16 hectares as a result of the addition of Wellington Location 5907, which was created as a condition of subdivision under section 20A of the *Town Planning and Development Act*.
- Date of DOLA's advice: 26 October 1999 See folio: 58
- Plans at folios: 59 & 60

OFFICER	ACTION
<p>1 CONSERVATION ESTATE OFFICER ^{CB.}</p>	<p>- Fill in above details ✓</p> <p>- Attach copies of DOLA's advice to file ✓</p> <p>Send copies of advice & maps to:</p> <ul style="list-style-type: none"> - Lisa Wright, Woodvale _____ - District Manager, Busselton _____ - Regional Manager, Bunbury _____ <p>IUCN classification: 1a</p> <p>To note: <i>Robert</i></p>
<p>2 INDEX CLERK, RECORDS</p>	<p>Index reserve's name _____</p> <p>Index reserve's number _____</p>
<p>3 LAND ACQUISITIONS OFFICER</p>	<p>To note: <i>Lyndee 16/12/99</i></p>
<p>4 MANAGER, PLANNING & VISITOR SERVICES</p>	<p>To note:</p>
<p>5 DIRECTOR, NATURE CONSERVATION/ NATIONAL PARKS</p>	<p>To note:</p>

RESERVE ACTION SHEET: CONSERVATION RESERVES

RESERVE No. 44838

LOCAL GOVERNMENT: City of Busselton

NAME: un-named nature reserve

PURPOSE: Conservation of Flora and Fauna

VESTING: Conservation Commission

ACTION

Add Lot 37 on Deposited Plan 401181 to Reserve 44838.

Total Area: 32.1631 hectares to 102.3517 hectares

REASON FOR ACTION

In March 2015 the Department of Lands wrote to Parks and Wildlife seeking comment on management of unallocated Crown land adjacent to the Wonnerup Estuary. Lot 37 on Deposited Plan 401181 had been created under Section 152 of the *Planning and Development Act 2005* as part of a subdivision application and was proposed to be managed for conservation.

Lot 37 has significant conservation values associated with the adjacent estuary including improving conservation management over the Vasse-Wonnerup Ramsar site and was added to Reserve 44838 on 18 June 2015.

Date of amendment: 18/6/2015

Maps: 10, 13, 14

Customer advice: 15

Proposal Summary: 5-8

IUCN classification: Ia

1	LAND UNIT LEADER	To note	Bd 5/10/15
2	LAND UNIT	Send copies of advice and maps to: <ul style="list-style-type: none"> • Lisa Wright (Kensington) DIGITAL COPY • District Manager DIGITAL COPY • Regional Manager DIGITAL COPY Attach TENIS gazettal history to file Delete from District Proposals spreadsheets Create Conservation Commission summary	NM 7/10 NM 7/10 NM 7/10 NA NM 7/10 NM 7/10
3	DIRECTOR, NATURE CONSERVATION	To note	
4	C.I.S.	Please rename file/create new file Keyword: Activity: Subject: Free text:	

RESERVE ACTION SHEET: REGIONAL PARKS CONSERVATION RESERVES

RESERVE No. 44838

LOCAL GOVERNMENT: City of Busselton

NAME:

PURPOSE: Nature Reserve (Conservation of Flora and Fauna)

VESTING: Department of Parks and Wildlife

ACTION: Addition of Lots 8000 and 8001 to R44838.

Total Area: 20.2850 ha

REASON FOR ACTION:

Lots 8000 and 8001 were created as a condition of subdivision (Western Australian Planning Commission 152152 Condition 15), for addition to wetlands reserve in accordance with the Busselton Wetlands Conservation Strategy (WAPC October 2005). The reserve is to be added to existing Nature Reserve R44838, which is vested with the Conservation and Parks Commission's predecessor.

Date of amendment: 5/12/2016

Maps: p. 28

Customer advice: p. 33

Proposal Summary: see pp. 36-45

Recommended IUCN classification: 1a

File: 2015/001852

1	LAND UNIT	Provide populated RAS, customer advice, Reserve Enquiry Detail (RED) to Catherine Prideaux at Regional Parks.	VW 14/3/17
2	REGIONAL PARKS	Complete unpopulated sections above, provide map and proposal summary. Return to Land Unit.	TT 21/3/17
3	LAND UNIT LEADER	To note	
4	LAND UNIT	Send scan of RAS, customer advice, Reserve Enquiry Detail (RED) and maps to: <ul style="list-style-type: none"> • Lisa Wright (Kensington) DIGITAL COPY • Regional Manager DIGITAL COPY • Geoffrey Banks GIS Branch DIGITAL COPY Check and strikethrough from District Proposals spreadsheets Create Conservation Commission summary	VW 21/3/17
			VW 21/3/17
			VW 21/3/17
			VW 21/3/17
			VW 21/3/17
5	DIRECTOR, PARKS AND VISITOR SERVICES	To note	
6	C.I.S.	Please rename file/create new file Keyword: Activity: Subject: Free text:	N/A

RESERVE ACTION SHEET: CONSERVATION RESERVES

RESERVE NUMBER: 44838

LOCAL GOVERNMENT: City of Busselton

NAME:

PURPOSE: Conservation of Flora and Fauna

VESTING: Conservation and Parks Commission

ACTION: Addition of Lot 2 on Plan 3280 (39.9ha) to Reserve 44838

Total Area: 162.5ha

REASON FOR ACTION: Lot 2 was provided as an environmental offset by Bemax Resources (then, Cable Sands WA). Lot 2 links Vasse-Wonnerup wetlands with the Tuart Forest National Park. The ecology and management requirements of this parcel make it suitable for inclusion in Reserve 44838 to be managed as part of the wetlands.

Date of amendment: 14/11/2023

Maps: Attached

Customer advice: Attached

Proposal Summary: see file

Recommended IUCN classification: 1a

Native Title: South West Boojarah ILUA area

1. LAND UNIT LEADER	To note 	Date 03/10/24
2. LAND UNIT	Send scan of RAS, customer advice, Reserve Enquiry Detail and maps to:	
	<ul style="list-style-type: none"> • Lisa Wright (Kensington) DIGITAL COPY 	NM 3/10/24
	<ul style="list-style-type: none"> • District Manager DIGITAL COPY 	NM 3/10/24
	<ul style="list-style-type: none"> • Regional Manager DIGITAL COPY 	NM 3/10/24
	<ul style="list-style-type: none"> • Geoffrey Banks GIS Branch DIGITAL COPY 	NM 3/10/24
	<ul style="list-style-type: none"> • Matt Cavana Vis Comms PVS DIGITAL COPY 	NM 3/10/24
	<ul style="list-style-type: none"> • Attach Landgate RDR to file 	NM 2/10/24
	Added to completed proposals spreadsheet	NM 2/10/24
	Create Conservation Commission summary	NM 2/10/24
	TENIS amended	AG 21/3/24
3. EXECUTIVE DIRECTOR, PARKS AND VISITOR SERVICES	To note	
4. KM	File Number:	2023-004845

**Customer Advices for Reserve Actions
1/10/1999 - 31/10/1999**

Shire of Busselton 1/10/1999 - 31/10/1999

Reserve No.	Land Description	DOLA File No.	Volume/Folio	Action	Document No.	Lodge Date	Street Name	Area	Public Plans
44838	Sussex Locallon 5015 on Office of Titles Plan 85801	01571-1995-01RO	3105-790	Amendment of Reserve to To Include Wellington Locallon 5907 on Office of Titles 18664 Its area being increased to 32.1631 hectares	h260915	26/10/99	Forrest Beach Road	32.1631	BF30 (2) 6.1

+ 31.1213

Tennis a'base amended 4/11/11

(p. 52 refers)

C. Bathgate 15/11/99
~~1/ Graham Hoare~~
 For plan, please

**Customer Advices for Reserve Actions
1/09/2015 - 30/09/2015**

City of Busselton 1/09/2015 - 30/09/2015

Reserve No.	Land Description	DoL File No.	Volume/Folio	Action	Document No.	Registered	Street Name	Area	Public Plans
44838	Lot 37 on Deposited Plan 401181	01571-1995-01RO	3165-19	Amendment of Reserve to add Lot 37 on Deposited Plan 401181 and its area being increased to 102.3517ha accordingly.	N033136	18/06/2015	Forresi Beach Road	71.2304 Ha	
52132	Lot 2593 on Deposited Plan 400537 Lot 2594 on Deposited Plan 400537 Lot 2599 on Deposited Plan 400537	00475-2015-01RO	3165-81 3165-82 3165-84	Reserve Creation for the designated purpose of "Conservation and Drainage".	N042353	26/06/2015	Clydebank Avenue	6.0353 sqm	
52133	Lot 2592 on Deposited Plan 400537	00477-2015-01RO	3165-80	Reserve Creation for the designated purpose of "Conservation and Recreation".	N049829	01/07/2015	Clydebank Avenue	4205 sqm	
52135	Lot 2598 on Deposited Plan 400537	00476-2015-01RO	3165-83	Reserve Creation for the designated purpose of "Conservation, Drainage & Landscape Buffer."	N049844	01/07/2015	Clydebank Avenue	16398 sqm	
52235	Lot 8000 on Deposited Plan 402926	00723-2015-01RO	3165-17	Reserve Creation for the designated purpose of "Landscape Buffer".	N119567	11/09/2015	Layman Road	1044 sqm	
52236	Lot 8001 on Deposited Plan 402926	00724-2015-01RO	3165-18	Reserve Creation for the designated purpose of "Pedestrian Accessway".	N119562	11/09/2015	Bayou Court	222 sqm	

Comment [NM2]: Un-named Nature Reserve. Addition of UCL to MR. Advised DOL of our support 22 April 2015. DOL advised that the Lot was created under section 152 of the Planning and Development Act so no referral process is required (no need for DMP or NT)

**Customer Advices for Reserve Actions
1/02/2017 - 28/02/2017**

City of Busselton 1/02/2017 - 28/02/2017

Reserve No.	Land Description	DoL File No.	Volume/Folio	Action	Document No.	Registered	Street Name	Area	Public Plans
43244	Lot 4985 on Deposited Plan 19168	01989-1994-01RO	3103-945 3103-945	Change of Purpose to "Public Recreation and Drainage"	N512841	19/12/2016	Windlemere Drive, Dunsborough	1376 sqm	
43244	Lot 8000 on Deposited Plan 403468	01989-1994-01RO	3165-25 3165-25	Amendment of Reserve to add Lot 8000 on Deposited Plan 403468 and its area being increased to 1396 meters square accordingly.	N512842	19/12/2016	Windlemere Drive, Dunsborough	1396 sqm	
43244 43244		01989-1994-01RO	3103-945 3165-25	Management Order to Shire of Busselton of LOCKED BAG 1 BUSSELTON WA 6280 for the designated purpose of "Public Recreation"	N512843	19/12/2016	Windlemere Drive, Dunsborough	1396 sqm	
43244		01989-1994-01RO	3103-945	?	N512840	19/12/2016	Windlemere Drive, Dunsborough	1376 sqm	
44836	Lot 8000 on Deposited Plan 407525 Lot 8001 on Deposited Plan 407525	01571-1995-01RO	3167-302 3167-303	Amendment of Reserve to add Lots 8000 and 8001 on Deposited Plan 407525 and its area being increased to 122.6367 hectares, accordingly.	N501234	05/12/2016	adj Wonnerup Estuary, Wonnerup	122.6367 Ha	
45170	Lot 5209 on Plan 22630 Lot 5210 on Plan 22191	02846-1996-01RO	3089-980 3090-272	Amendment of Reserve to add Lot 5209 on Plan 22630 and Lot 5210 on Plan 22191 and its area being increased to 21015 sqm accordingly.	N527033	10/01/2017	College Av, West Busselton	21015 sqm	
45810	Lot 5223 on Plan 23070	01083-1999-01RO	3114-157	Management Order to City of Busselton of LOCKED BAG 1 BUSSELTON WA 6280 To be utilised for the designated purpose of "Public Recreation" only, for the designated purpose of "Public Recreation"	N506712	12/12/2016	Spinnaker Bvd, Geographe	675 sqm	
46071	Lot 5085 on Plan 21425	02037-1996-01RO	3107-870	Management Order to City of Busselton of LOCKED BAG 1 BUSSELTON WA 6280 To be utilised for the designated purpose of "Public Recreation" only, for the designated purpose of "Public Recreation"	N523590	04/01/2017	Pebble Dr, Geographe	7462 sqm	
47818	Lot 34 on Deposited Plan 24493	50290-2004-01RO	3128-783	Management Order to City of Busselton of LOCKED BAG 1 BUSSELTON WA 6280 To be utilised for the designated purpose of "Public Recreation" only, for the designated purpose of "Public Recreation"	N524550	05/01/2017		33695 sqm	
48100	Lot 5557 on Deposited Plan 37401	50462-2004-01RO	3135-249	Management Order to City of Busselton of LOCKED BAG 1 BUSSELTON WA 6280 To be utilised for the designated purpose of "Public Recreation" only, for the designated purpose of "Public Recreation"	N506709	12/12/2016	Butterworth Springs Av, Dunsborough	255 sqm	
48101	Lot 5558 on Deposited Plan 37401	50463-2004-01RO	3135-247	Management Order to City of Busselton of LOCKED BAG 1 BUSSELTON WA 6280 To be utilised for the designated purpose of "Public Recreation" only, for the designated purpose of "Public Recreation"	N506708	12/12/2016	Butterworth Springs Av, Dunsborough	3270 sqm	

Reserve Enquiry Detail [5100L]

Screen Friendly Pr

Reserve	44838	Legal Area (ha)	122.6367
Name		Status	Current
Type	Subject to 20 A & 152	Current Purpose	CONSERVATION OF FLORA AND FAUN
Notes			
File Number	1571/1995		
Additional Reserve Information	RESERVE COMPRISES LOT 5015 ON D85801, LOT 5907 ON P18664, LOT 37 ON DP4011, LOTS 8000 & 8001 ON DP407525 (N501234)		

Class	Responsible Agency	Date of Last Change
C	DEPARTMENT OF PARKS AND WILDLIFE	06/02/2017

Management Orders	Document	Land Use	Local Government Authc
NATIONAL PARKS AND NATURE CONSERVATION AUTHORITY		CONSERVATION FAUNA PROTECTION OF FLORA	BUSSELTON, CITY OF

Add Item	CLT Number	Parcel Identifier	Street Address	Suburb	File Number	PIN	Area (sqm)	Map
<input type="checkbox"/>	LR3103-2	Lot 5015 On Diagram 85801			01571-1995-01RO.	1099178	10418.0	
<input type="checkbox"/>	LR3113-269	Lot 5907 On Plan 18664			01571-1995-01RO.	1099182	311213.0	
<input type="checkbox"/>	LR3165-19	Lot 37 On Plan 401181			01571-1995-01RO	12103416	690173.0	
<input type="checkbox"/>	LR3165-19	Lot 37 On Plan 401181			01571-1995-01RO	12103421	11713.0	
<input type="checkbox"/>	LR3167-302	Lot 8000 On Plan 407525			01571-1995-01RO	12251074	198584.0	
<input type="checkbox"/>	LR3167-303	Lot 8001 On Plan 407525			01571-1995-01RO	12251078	4266.0	

Reserve Number 44838

Previous Certificates of Title	Historic Crown Allotments
LR3105-790 Cancelled	SUSSEX Location 5015 WELLINGTON Location 5907

Gaz Page/Document	Date	Type	Text
N501234	05/12/2016	Current Area	122.6367
N33136	18/06/2015	Historical Area	102.3517
H260915	26/10/1999	Historical Area	32.1631
H260915	26/10/1999	Location	SUSSEX LOC 5015 & WELLINGTON LOC 5907
H260915	26/10/1999	Public Plan	BF30 (10) 6.1
H260915	26/10/1999	Street Name	FORREST BEACH ROAD
H260915	26/10/1999	Survey Number	LTO:PLANS 85801 & 18664
2248	06/05/1997	Class	C
2248	06/05/1997	Current Purpose	CONSERVATION OF FLORA AND FAUNA
2248	06/05/1997	Correspondence File Number	1571/1995
2248	06/05/1997	Historical Area	1.0418
2248	06/05/1997	Original Gazettal and page	ORIGINAL GAZETTE
	06/05/1997	Current Vesting	VEST:NATIONAL PARKS& NATURE CONSERVAT AUTHORITY

DOLA File: 02714-1996-01RO.

Reserve No 44830 comprising (Port Hedland Lot 2241) with an area of 1.0800 hectares on Land Administration Plan 11920 for the designated purpose of "Recreation" Public Plan/s: BL66 (2) 26.24 Paton Road

Local Authority: Town of Port Hedland.

DOLA File: 02491-1996-01RO.

Reserve No 44831 comprising (Cockburn Sound Location 4290) with an area of 422 square metres for the designated purpose of "Drainage"

Section 20A

Public Plan/s: BG32 (2) 07.40 Harlequin Mews

Local Authority: City of Mandurah.

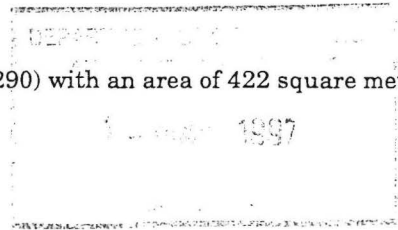

DOLA File: 01571-1995-01RO.

Reserve No 44838 comprising with an area of 1.0418 hectares for the designated purpose of "Conservation of Flora and Fauna"

Section 20A

Public Plan/s: Busselton NE (25) near Forrest Beach Road

Local Authority: Shire of Busselton.

DOLA File: 02516-1996-01RO.

Reserve No 44845 comprising (Guildford Lot 238) with an area of 236 square metres for the designated purpose of "Public Recreation"

Section 20A

Public Plan/s: BG34 (2) 20.31 Claymore Close

Local Authority: Shire of Swan.

DOLA File: 02786-1996-01RO.

Reserve No 44846 comprising (Swan Location 12685) with an area of 1549 square metres for the designated purpose of "Public Recreation"

Section 20A

Public Plan/s: BG35 (1) 38.04 Sherbrooke Retreat and Daintree Loop

Local Authority: Shire of Swan.

DOLA File: 02691-1995-01RO.

Reserve No 44850 comprising (Victoria Location 12066) with an area of 20 square metres on Land Administration Diagram 92439 for the designated purpose of "Protection of Grave"

Public Plan/s: Yuna NE (25) off Wandin Road

Local Authority: Shire of Chapman Valley.

DOLA File: 01175-1996-01RO.

Reserve No 44857 comprising (Cockburn Sound Location 4238) with an area of 240 square metres for the designated purpose of "Water Supply"

Section 20A

Public Plan/s: BG33 (2) 08.21 Juania Place and Primus Place

Local Authority: City of Rockingham.

DOLA File: 00979-1996-01RO.

Reserve No 44858 comprising (Cockburn Sound Location 4231) with an area of 6968 square metres for the designated purpose of "Drainage"

Section 20A

Public Plan/s: BG33 (2) 10.23 Eighty Road and Safety Bay Road

Local Authority: City of Rockingham.

DOLA File: 02176-1996-01RO.

Reserve No 44863 comprising (Swan Location 12655) with an area of 1585 square metres for the designated purpose of "Drainage"

Section 20A

Public Plan/s: BG35 (2) 10.04 Wanneroo Road

Local Authority: City of Wanneroo.

DOLA File: 00842-1997-01RO.

Reserve No 44865 comprising (Swan Location 11985) with an area of 1.8114 hectares as shown bordered pink on Land Administration Diagram No 91590 for the designated purpose of "Landscape Protection"

Public Plan/s: BG34 (2) 14.28 and 14.29 Walter Road, Hamer Parade and Eighth Avenue

Local Authority: City of Stirling.

A. A. SKINNER, Chief Executive.

Handwritten notes at the bottom of the page: '1. file', '2. 16.5.97', '3. no copies for your litho plan', and a date '19.5.97'.









Handwritten notes at the top: 'TO CLERK 040716F3103' and 'for your information'.

Handwritten initials 'SL' and 'DL' in the top right corner.

CALM-MANAGED LANDS AND WATERS

AS AT 30th JUNE 1996

Legend

-  National Park
-  Conservation Park
-  Nature Reserve
-  State Forest, Timber Reserve, Freehold & Other Reserve
-  Section 5(g) Reserve
-  Leasehold in the name of the Executive Director
-  Marine Park / Marine Nature Reserve
-  CALM Region Boundary
-  CALM Regional Office

Scale

0 100 200 300 400 Km

Projection: Polyconic, Origin 121°, 0°



CALM

CONSERVATION AND LAND MANAGEMENT



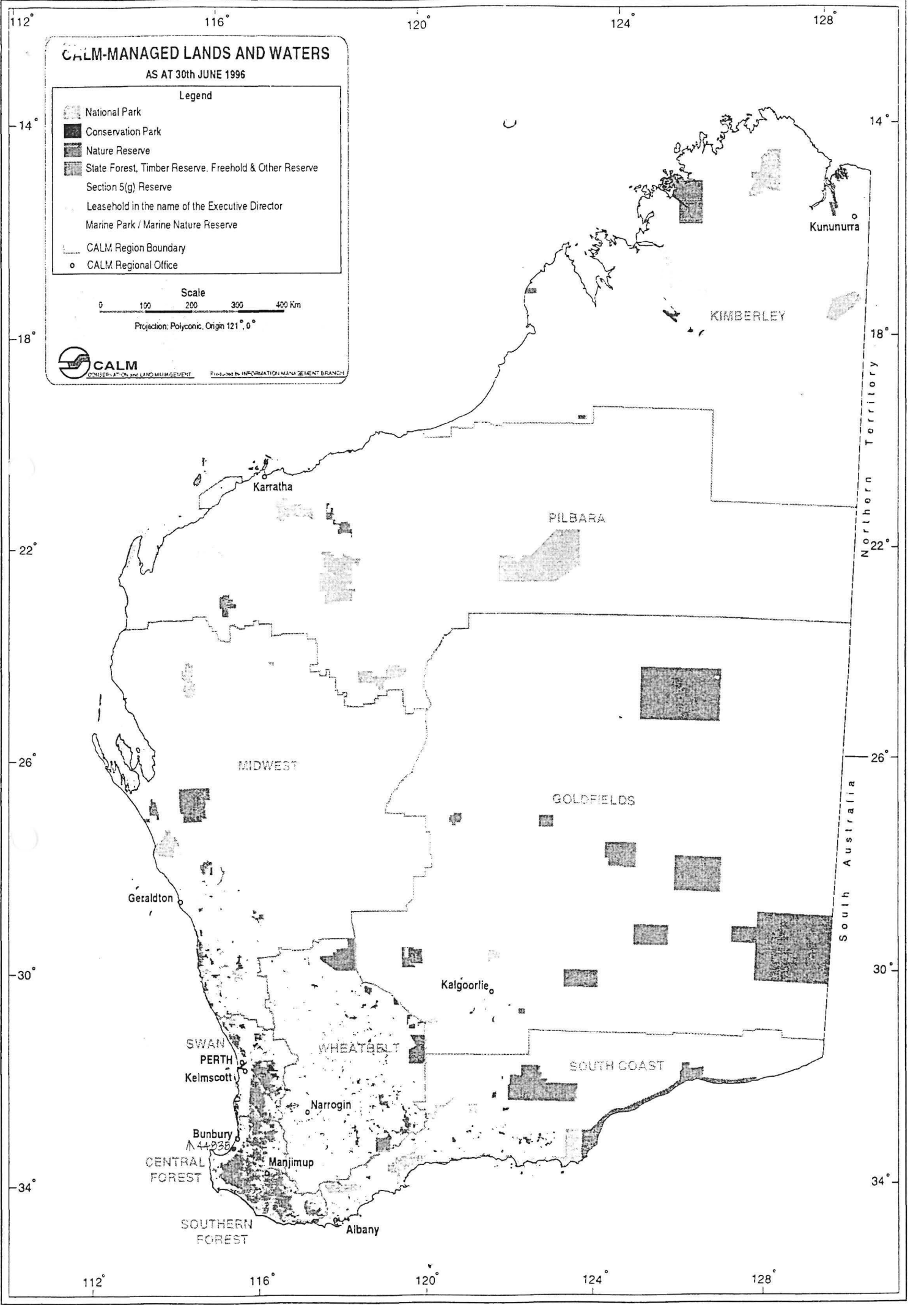





PROGRAMS IN INFORMATION MANAGEMENT BRANCH



CALM-MANAGED LANDS AND WATERS

AS AT 30th JUNE 1998

Legend

-  National Park
-  Conservation Park
-  Nature Reserve
-  State Forest, Timber Reserve, Freehold & Other Reserve
-  Section 5(g) Reserve
-  Leasehold in the name of the Executive Director
-  Marine Park / Marine Nat Res / Marine Management Area
-  CALM Region Boundary
-  CALM Regional Office

Scale
0 100 200 300 400 Km

Projection: Polyconic, Origin 121°, 0°



Produced by INFORMATION MANAGEMENT BRANCH

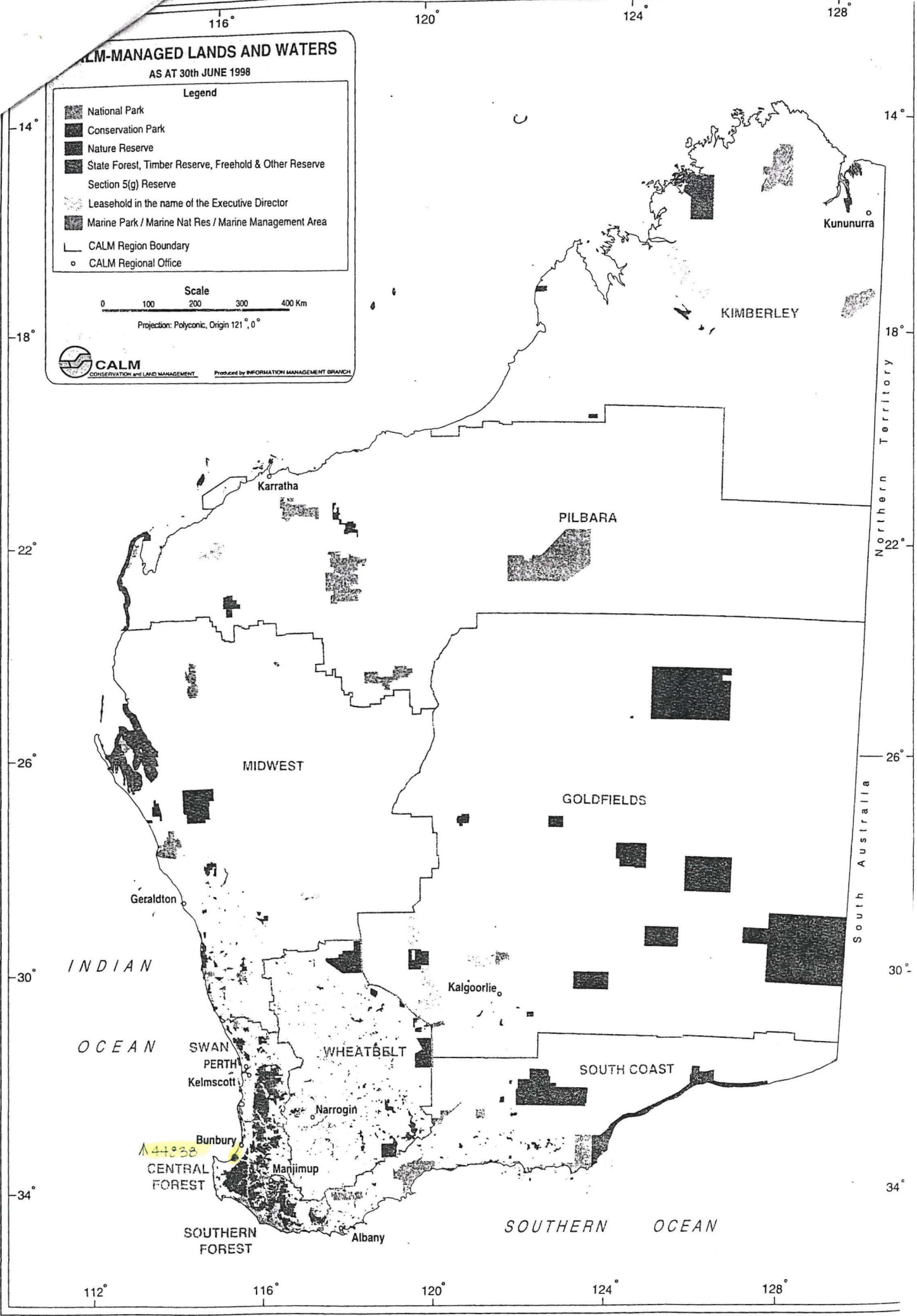

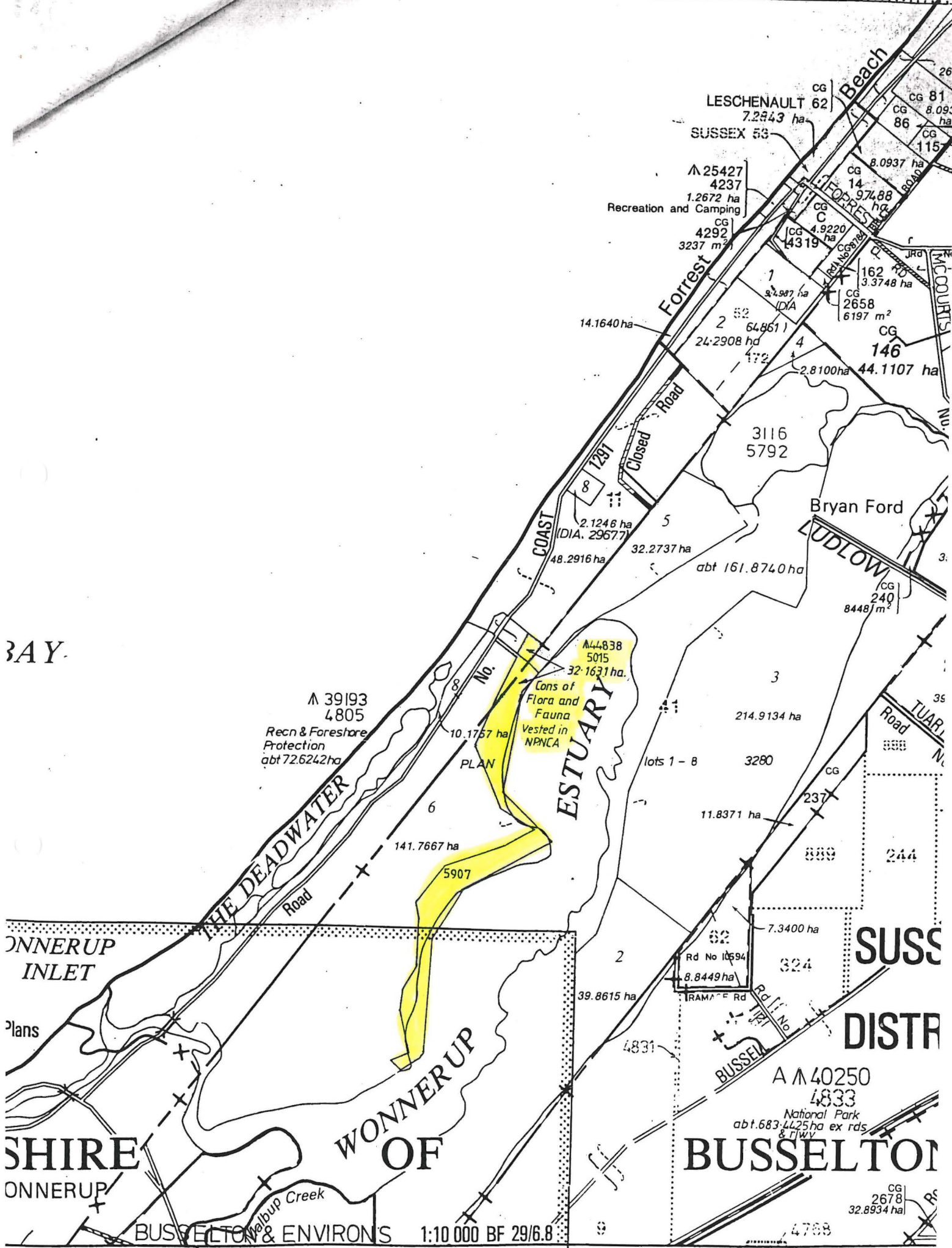

BAY

WONNERUP INLET

SHIRE OF WONNERUP

BUSSELTON & ENVIRONS 1:10 000 BF 29/6.8

A 40250 4833 National Park abt. 683.4425 ha ex rds & TWY
BUSSELTON

PLAN: BUSSETON NE (1930-1-NE)
 SCALE 1:25 000

354

355

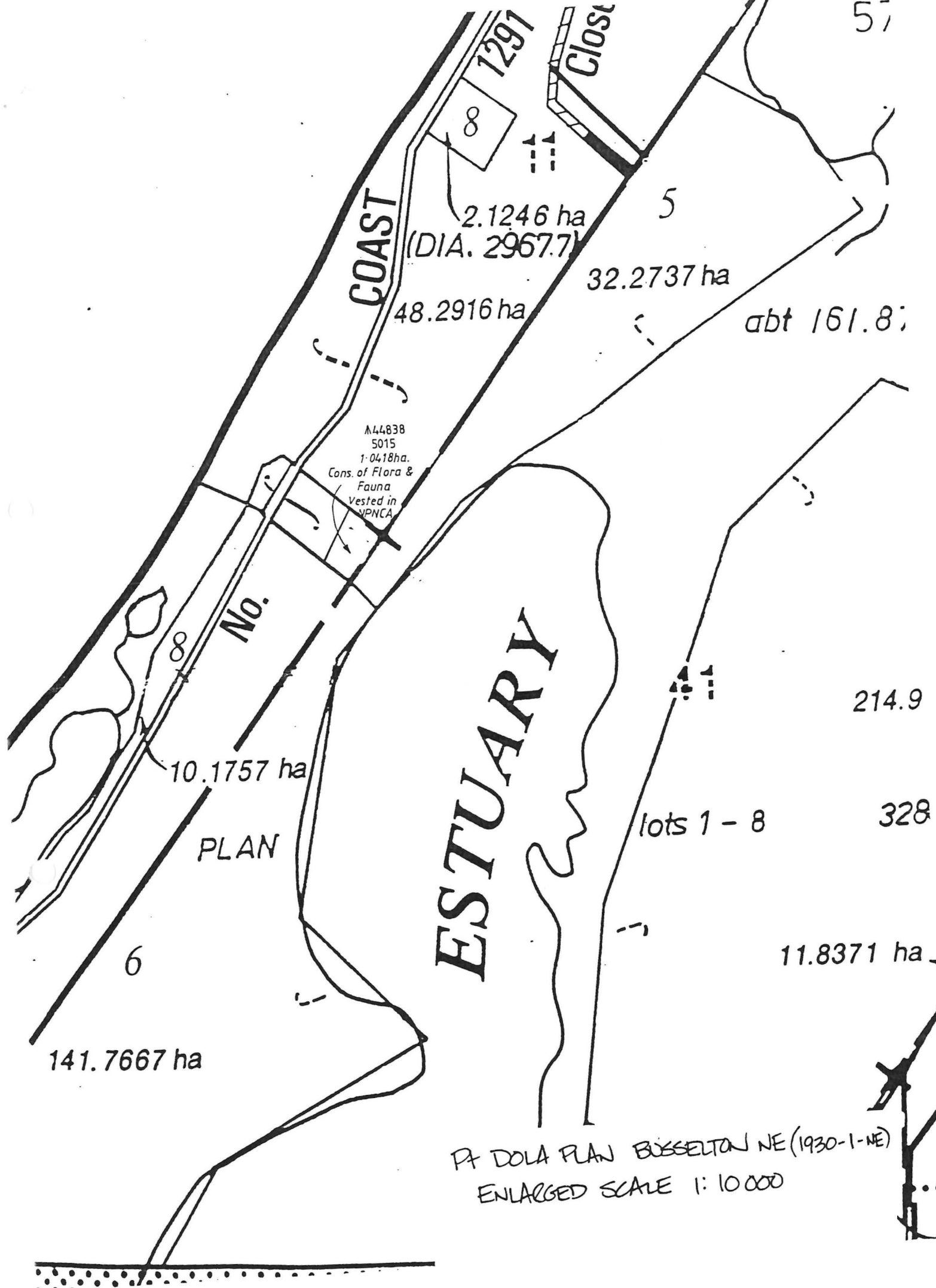

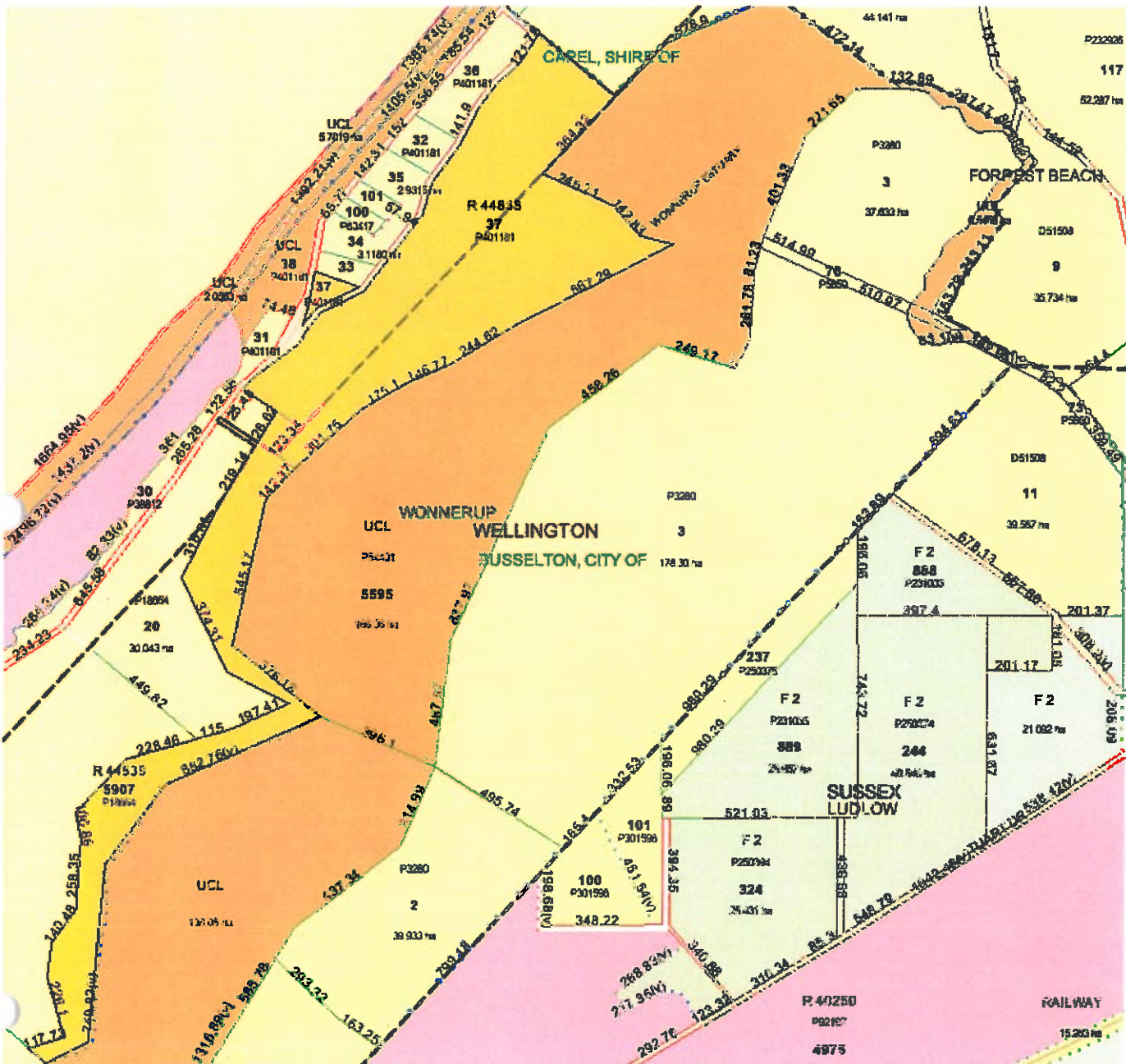



Reserve 44838 Addition of Lot 2 on Plan 3280

Legend

-  Proposed Freehold Addition to 44838
-  Proposed Freehold Additions
-  Freehold
-  Unallocated Crown Land
-  Public Roads
-  National Park
-  Nature Reserve
-  Important Wetlands - Western Australia



1:6,032

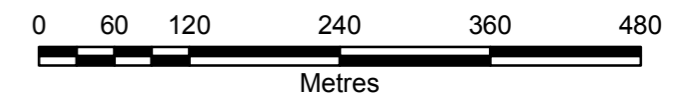

Projection: Universal Transverse Mercator
MGA Zone 50. Datum: GDA94

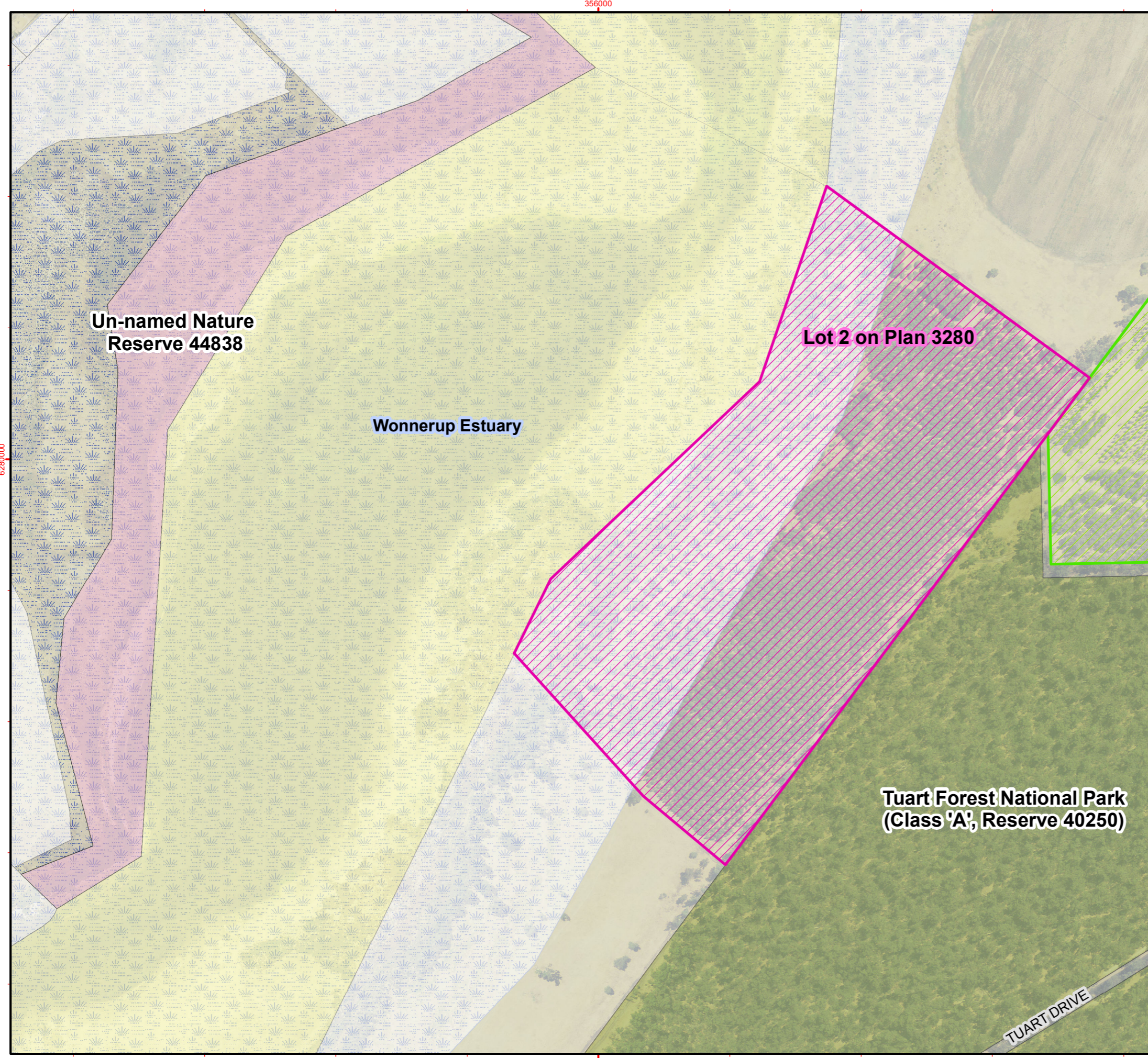

Produced by the
Department of
Parks and Wildlife



Graticule shown at 1 minute intervals
Grid shown at 1000 metre intervals

The Dept. of Parks and Wildlife does not guarantee that this map is without flaw of any kind and disclaims all liability for any errors, loss or other consequence which may arise from relying on any information depicted.
Roads and tracks on land managed by DPaW may contain unmarked hazards and their surface condition is variable. Exercise caution and drive to conditions on all roads.



Author:

[https://map-viewer-plus.landgate.wa.gov.au/land_id=3082313&layers={%22on%22:%20\[%22Lot%20on%20Plan%20-%20Annotation%22\]}&theme=hybrid](https://map-viewer-plus.landgate.wa.gov.au/land_id=3082313&layers={%22on%22:%20[%22Lot%20on%20Plan%20-%20Annotation%22]}&theme=hybrid)

1:18,056

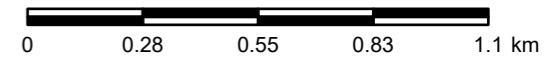

VER.	AMENDMENT	AUTHORISED BY	DATE
2	AUDIT REQUIREMENTS	M.E. SAUZIER	10/06/14
3	ROAD WIDENING AMENDMENT	M.E. SAUZIER	19/05/14

TYPE FREEHOLD

PURPOSE SUBDIVISION

PLAN OF

**38,
ROAD, ROAD WIDENINGS,
COVENANT & EASEMENT**

DISTRICT SUSSEX & WELLINGTON

TOWNSITE

LOCAL AUTHORITY CITY OF BUSSELTON

LOCALITY WONNERUP

INDEX ON

SEE SHARYPLAN

SSA YES/NO

FORMER TENURE

SEE TABLE

FIELD BOOK

123883

HELD BY LANDGATE
IN DIGITAL FORM ONLY.

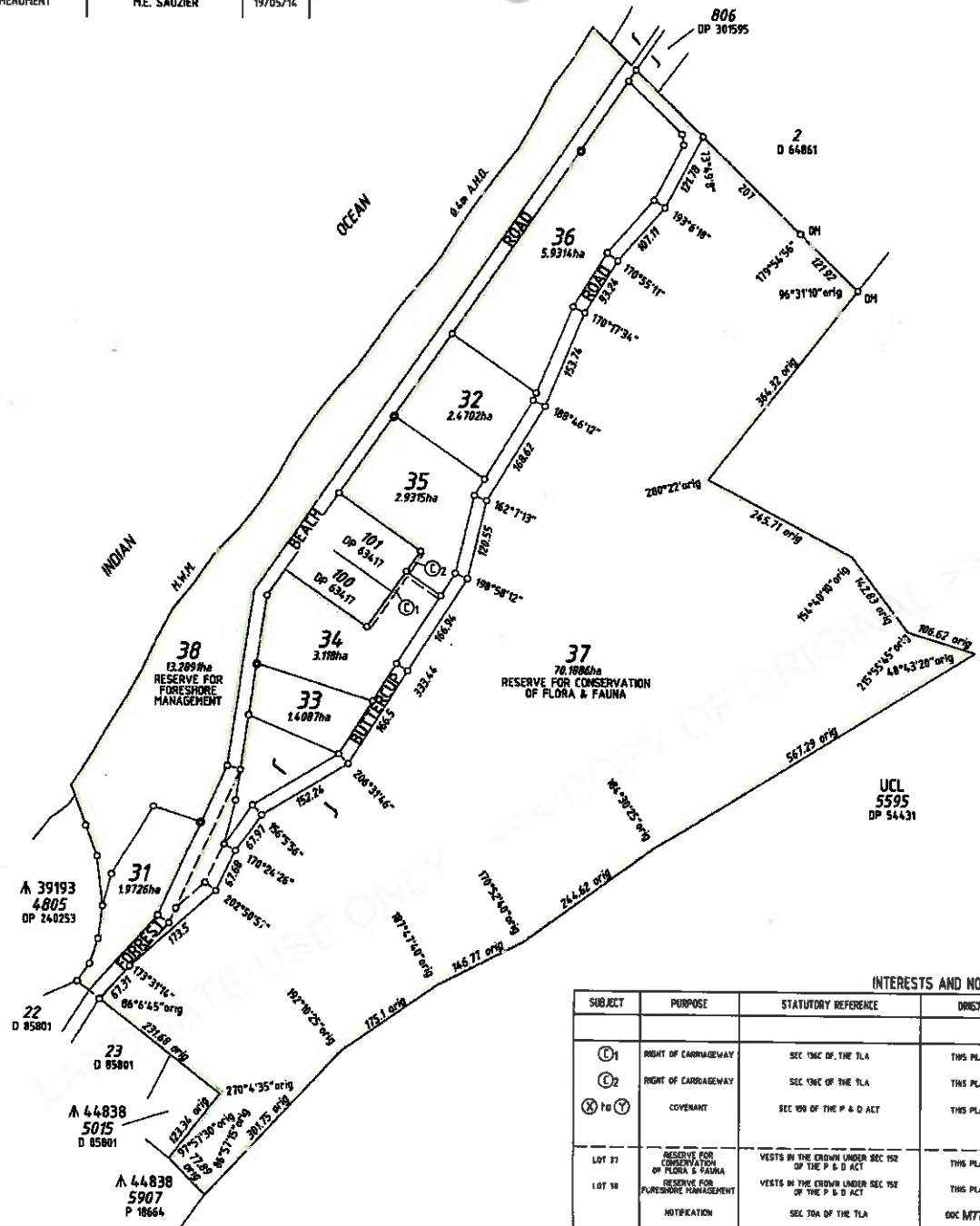

SEE SHEET 2 OF 2 FOR
LOT DETAILS

LOT	FORMER P/TENURE	ON PLAN/DIAGRAM	TITLE
21 - 24	LOT 25	DP 41766	2628 - 303
27	PR LOT 25 LOT 5	DP 42784 P 3289	1628 - 560 106 - 884
28	PR LOT 25	DP 41766	2628 - 303

INTERESTS AND NOTIFICATIONS

SUBJECT	PURPOSE	STATUTORY REFERENCE	DRAWN	LAND BURDENED	BENEFIT TO	COMMENTS
①	RIGHT OF CARRIAGEWAY	SEC 156C OF THE TLA	THIS PLAN	LOT 34	LOTS 30 & 31 ON DP 63417	
②	RIGHT OF CARRIAGEWAY	SEC 156C OF THE TLA	THIS PLAN	LOT 35	LOT 301 ON DP 63417	
③ to ⑦	COVENANT	SEC 199 OF THE P & D ACT	THIS PLAN	LOT 36	CITY OF BUSSELTON	RESTRICTION OF MOTOR VEHICLE ACCESS
LOT 31	RESERVE FOR CONSERVATION OF FLORA & FAUNA	VESTS IN THE CROWN UNDER SEC 152 OF THE P & D ACT	THIS PLAN			
LOT 38	RESERVE FOR FORESHORE MANAGEMENT	VESTS IN THE CROWN UNDER SEC 152 OF THE P & D ACT	THIS PLAN			
	NOTIFICATION	SEC 70A OF THE TLA	DOC M778743	LOTS 31 - 36		CITY OF BUSSELTON FIRE MANAGEMENT PLAN
	NOTIFICATION	SEC 70A OF THE TLA	DOC M778742	LOTS 31 - 36		DEPARTMENT OF PARKS & WILDLIFE BUILDING ENVELOPES

SURVEYOR'S CERTIFICATE - Reg 54

M.E. SAUZIER

Harley Dykstra

Harley Dykstra
22/03/2014
19/05/2014

LOGGED DATE 25 Mar 2014

TYPE OF VALIDATION FULL AUDIT LEGAL COMPONENT

APPROVED BY M. Schofield

FILE 195272

ASSESS No. \$680

DOCKET TRIM

DATE 29-5-14

ASSESS No. 16727212

F.S.C.

Delegated Under 136 P & D Act 2005

IN ORDER FOR DEALINGS

SUBJECT TO Sections 70A & 136C of the TLA, Sections 150 & 152 of the P & D Act, Sections 168(1)(2) & (3) of the P & D Act.

FOR INSPECTOR OF PLANS & SURVEYS / AUTHORIZED LAND OFFICER DATE 16-7-14

APPROVED

INSPECTOR OF PLANS & SURVEYS / AUTHORIZED LAND OFFICER DATE 26/09/2014

Landgate

Western Australian Land Information Authority

DEPOSITED PLAN

401181

SHEET 1 OF 2

VERSION 3

HQ Ref 13738L1-01A
BOR 30/10/13

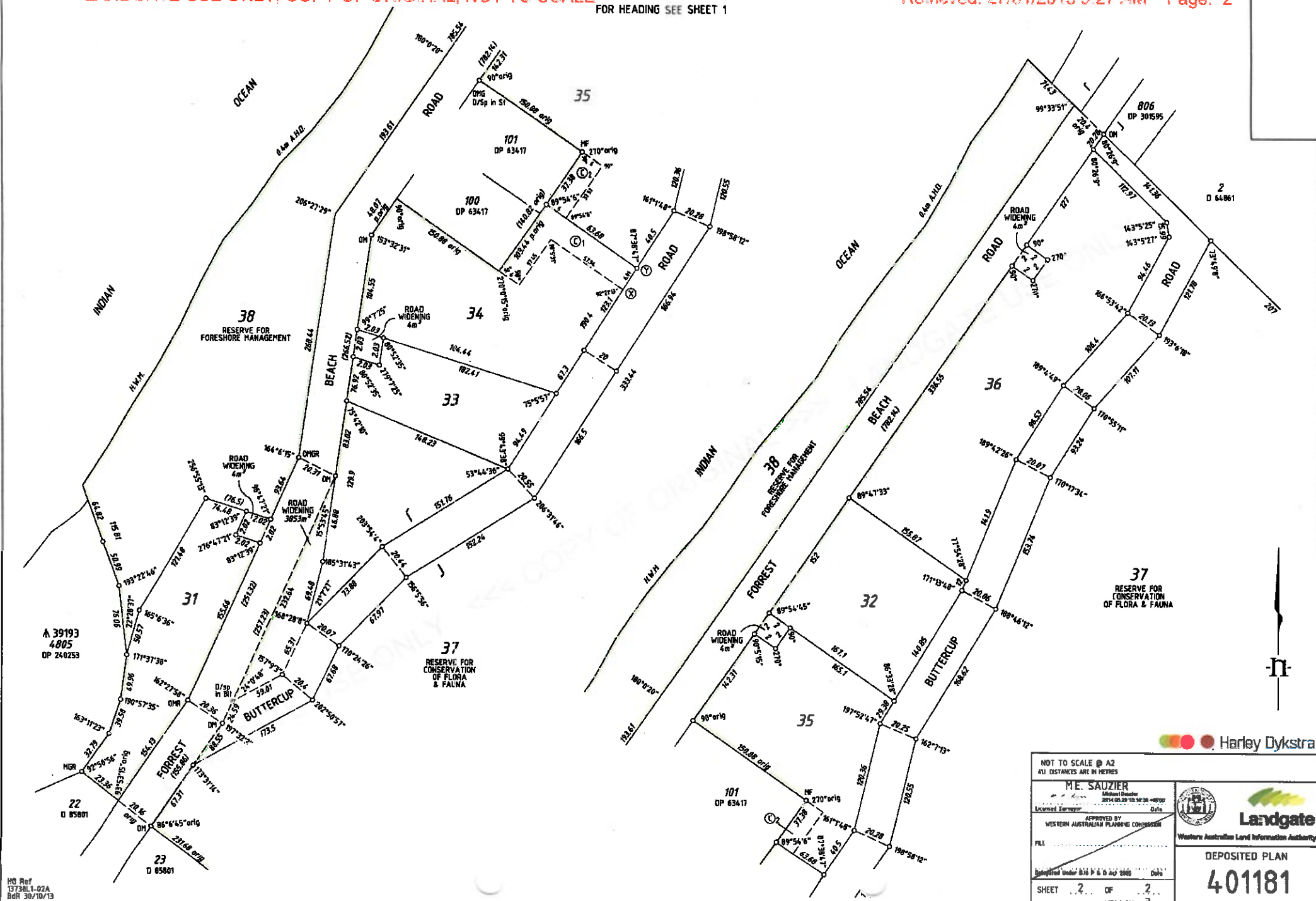

Harley Dykstra

NOT TO SCALE @ A2
ALL DISTANCES ARE IN METRES

M. SAUZIER
Michael Sauzier
2014 08 20 10:40:36 +0800
Licensed Surveyor Date

APPROVED BY
WESTERN AUSTRALIAN PLANNING COMMISSION

FILE

Deposited under 816 P & S Act 2005 Date

SHEET 2 OF 2
VERSION 3

Landgate
Western Australian Land Information Authority

DEPOSITED PLAN
401181

H0 Ref 1373ML1-02A Bdr 30/10/13

VER.	AMENDMENT	AUTHORISED BY	DATE
2	Landgate Audit Amendments	Malcolm Cockman	16/8/2016

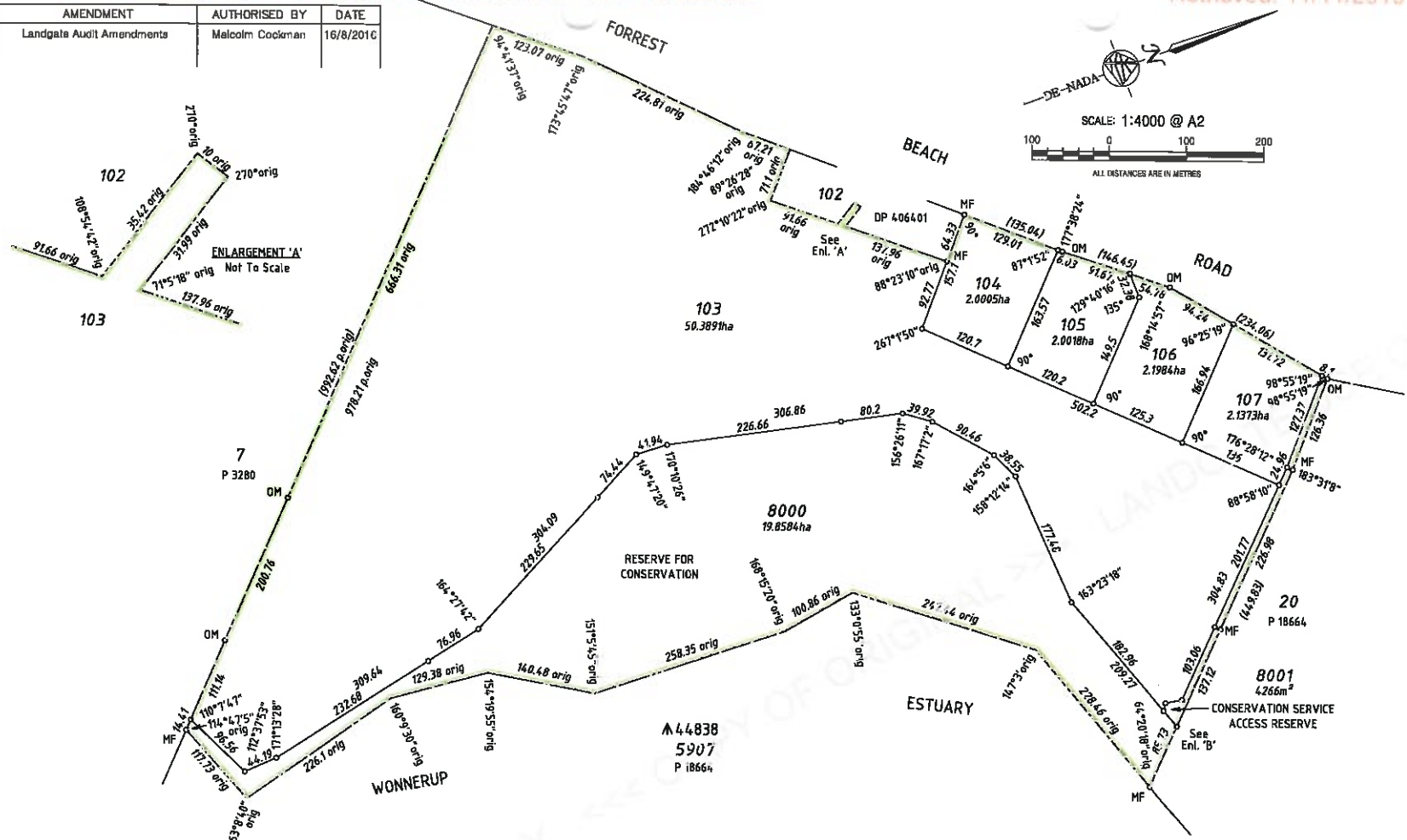

TYPE	FREEHOLD	S.S.A. NO
PURPOSE	SUBDIVISION	
PLAN OF	LOTS 103-107, 8000 AND 8001	
FORMER TENURE	LOT 101 ON DP 406401 C.T. 2902/652	
LOCAL AUTHORITY	CITY OF BUSSELTON	
LOCALITY	WONNERUP	
D.O.L. FILE		
FIELD RECORD	134786	
SURVEYOR'S CERTIFICATE - REG 54	I, MALCOLM GEORGE COCKMAN hereby certify that this plan is accurate and is a correct representation of the - (a) survey; and/or (b) calculations from measurements recorded in the field records, (+ delete if inapplicable) undertaken for the purposes of this plan and that it complies with the relevant written law(s) in relation to which it is lodged.	
Date: 2016.06.16	06:24:11 +0800	8-Aug-16
LICENSED SURVEYOR	LOGGED	DATE
02.08.16	\$028.00	19931516
DATE	FEE PAID	ASSESS No.
I.S.C.	EXAMINED	DATE
	E. Mikowka	16.08.2016
WESTERN AUSTRALIAN PLANNING COMMISSION	FILE	152162
Delegated Under S.16 P&D Act 2005	DATE	16-Aug-2016
IN ORDER FOR DEALINGS		
SUBJECT TO	SEC 152 OF THE P&D ACT SEC 165 OF THE P&D ACT	
FOR INSPECTOR OF PLANS AND SURVEYS	DATE	17.08.2016
APPROVED		
FOR INSPECTOR OF PLANS AND SURVEYS	DATE	18.8.2016
LICENSED LAND & ENGINEERING SURVEYORS Unit 1A/30 Peers Lane, DUNEDIN SOUTH WA, 6251 Tel: (08) 9750 8000 Fax: (08) 9577 8006 Email: info@denada.com.au Website: www.denada.com.au DIE NADA Ref: 800018dp-002h CSD File: DP407525.CSD		
DEPOSITED PLAN 407525 SHEET 1 OF 1 SHEETS VERSION 2		

INTERESTS & NOTIFICATIONS

SUBJECT	PURPOSE	STATUTORY REFERENCE	ORIGIN	LAND BURDENED	BENEFIT TO	COMMENTS
LOT 8000	RESERVE FOR CONSERVATION	VESTS IN THE CROWN UNDER SEC 152 OF THE P & D ACT	THIS PLAN			Lot 8000 is "to be added to Crown Reserve 44838 and vested in the Conservation Commission of WA".
LOT 8001	RESERVE FOR CONSERVATION SERVICE ACCESS NOTIFICATION	VESTS IN THE CROWN UNDER SEC 152 OF THE P & D ACT SEC 165 OF THE P & D ACT	THIS PLAN DOC N412167	LOT 103-107		RURAL LAND USE

