

RESERVE ACTION SHEET - CONSERVATION RESERVES

RESERVE No. 45056

REASON FOR ACTION

- Creation of a class 'C' Miscellaneous Reserve vested in the Executive Director for the purpose of "Conservation and Protection of Aboriginal Heritage and Culture".
NOTE: Intention was to create a Section 5(g) Reserve. DOLA has been notified of gazettal error and will rectify by cancelling current Vesting Order and gazetting vesting in NPNCA. Area: 15.7604 ha
- Recommended for a conservation reserve as part of DEP's System 6 update. Area, formerly leased for grazing, was found to contain DRF *Aponogeton hexatepalus* (stalked water-ribbons) and two priority flora species. Area is culturally significant to local Aboriginal people as a venue to express and maintain Nyungar wisdom, knowledge and culture.
- Gazettal date: 11 November 1997 See folios 62 - 64
- Plans at folios 66, 70 & 71

	OFFICER	ACTION
1	RESERVES <i>sc</i>	- Fill in above details _____ - Attach copies of gazettal notices to file _____
2	INDEX CLERK, RECORDS	- Index reserve's name _____ - Index reserve's number _____
3	RESERVES CLERK <i>sc</i>	Send copies of gazettal notices and Map to: - Clerk, Woodvale _____ - District Manager, Dwellingup _____ - Regional Manager, Swan _____
4	CONSERVATION ESTATE OFFICER	To note: <i>Sharon Colliss</i> <i>9.12.97</i>
5	LAND ACQUISITIONS OFFICER	To note:
6	MANAGER, PLANNING & VISITOR SERVICES	To note:
7	DIRECTOR, NATURE CONSERVATION/ NATIONAL PARKS	To note:

63

LA601*

LAND ACT 1933
ORDER IN COUNCIL
(VESTING OF RESERVE)

By the direction of His Excellency the Governor under Section 33(2), the following reserves have been vested.

DOLA File: 03342-1895-03RO.

Reserve No 891 (Victoria Location 12129) vested in the Shire of Greenough for the designated purpose of "Landscape Protection".

Local Authority: Shire of Greenough.

DOLA File: 05607-1914-05RO.

Reserve No 15815 (Kyarra Locations 67, 75, 152, 154, 187, 188 and 196) vested in the Shire of Meekatharra for the designated purpose of "Parks and Recreation".

Local Authority: Shire of Meekatharra.

DOLA File: 01581-1990-02RO.

Reserve No 16199 (Nelson locations 13503, 13504, 13505 and 13506) vested in the Shire of Boyup Brook for the designated purpose of "Water and Parkland".

Local Authority: Shire of Boyup Brook.

DOLA File: 03878-1919-01RO.

Reserve No 17265 (Malcolm Location 98) vested in the Water Corporation for the designated purpose of "Water".

Local Authority: Shire of Leonora.

DOLA File: 05859-1919-01RO.

Reserve No 17302 (Malcolm Location 99) vested in the Water and Rivers Commission for the designated purpose of "Water".

Local Authority: Shire of Leonora.

DOLA File: 03727-1924-01RO.

Reserve No 19132 (Nugadong Agricultural Area Lot 112) vested in the Shire of Dalwallinu for the designated purpose of "Historic Site—School".

Local Authority: Shire of Dalwallinu.

DOLA File: 01947-1954-01RO.

Reserve No 24032 (Donnybrook Lots 466, 469 and 476) vested in the Minister for Education for the designated purpose of "School Site".

Local Authority: Shire of Donnybrook/Balingup.

DOLA File: 00260-1963-01RO.

Reserve No 27033 (Morawa Lot 315) vested in the Shire of Morawa for the designated purpose of "Landscape Protection".

Local Authority: Shire of Morawa.

DOLA File: 02187-1987-01RO.

Reserve No 32932 (Kununurra Lots 1206 and 2441) vested in the Shire of Wyndham-East Kimberley for the designated purpose of "Drainage".

Local Authority: Shire of Wyndham/East Kimberley.

DOLA File: 00550-1975-01RO.

Reserve No 33114 (Kununurra Lot 1196) vested in the Shire of Wyndham-East Kimberley for the designated purpose of "Public Utility Services".

Local Authority: Shire of Wyndham/East Kimberley.

DOLA File: 01864-1973-01RO.

Reserve No 33765 (Swan Location 12753) vested in the Town of Bassendean for the designated purpose of "Drain".

Local Authority: Town of Bassendean.

DOLA File: 02296-1971-01RO.

Reserve No 34330 (Port Hedland Lots 1701 and 2465) vested in the Minister for Education for the designated purpose of "Primary Schoolsite (South Hedland)".

Local Authority: Town of Port Hedland.

DOLA File: 04014-1976-01RO.

Reserve No 34989 (Canning Locations 2970, 3287, 3307, 3593 and 4142) vested in the City of Gosnells for the designated purpose of "Public Recreation".

Local Authority: City of Gosnells.

DOLA File: 01550-1979-01RO.

Reserve No 36382 (Canning Location 3152 and Kelmscott lot 260) vested in the City of Armadale for the designated purpose of "Public Recreation".

Local Authority: City of Armadale.

DOLA File: 00178-1970-01RO.

Reserve No 36839 (Canning Location 3222) vested in the City of Armadale for the designated purpose of "Public Recreation".

Local Authority: City of Armadale.

DOLA File: 02521-1993-01RO.

Reserve No 43165 (Pingelly Lot 878) vested in the Shire of Pingelly for the designated purpose of "Buffer Strip".

Local Authority: Shire of Pingelly.

DOLA File: 02842-1994-01RO.

Reserve No 43779 (Boulder Lots 1440, 4599, 4745, 4746, 4750, 4751 and 4752) vested in the City of Kalgoorlie-Boulder for the designated purpose of "Drainage".

Local Authority: City of Kalgoorlie-Boulder.

DOLA File: 02559-1995-01RO.

Reserve No 44262 (Leonora Lots 849 and 1330) vested in the Shire of Leonora for the designated purpose of "Parking".

Local Authority: Shire of Leonora.

DOLA File: 00882-1996-01RO.

Reserve No 44395 (Wellington Locations 5758 and 5808) vested in the Shire of Harvey for the designated purpose of "Drainage".

Local Authority: Shire of Harvey.

DOLA File: 02522-1996-01RO.

Reserve No 44646 (Cockburn Sound Location 4292) vested in the Shire of Serpentine—Jarrahdale for the designated purpose of "Public Recreation".

Local Authority: Shire of Serpentine/Jarrahdale.

DOLA File: 01279-1969-02RO.

Reserve No 45056 (Pinjarra Lot 350) vested in the Executive Director, Department of Conservation and Land Management for the designated purpose of "Conservation and the Protection of Aboriginal Heritage and Culture".

Local Authority: Shire of Murray.

DOLA File: 01766-1997-01RO.

Reserve No 45107 (Cockburn Sound Location 4344) vested in the Shire of Murray for the designated purpose of "Foreshore Management and Pedestrian Accessway".

Local Authority: Shire of Murray.

DOLA File: 01818-1997-01RO.

Reserve No 45110 (Victoria Location 21662) vested in the City of Geraldton for the designated purpose of "Drainage".

Local Authority: City of Geraldton.

DOLA File: 02608-1996-01RO.

Reserve No 45111 (Kyarra Location 191) vested in the Shire of Meekatharra for the designated purpose of "Rubbish Disposal Site".

Local Authority: Shire of Meekatharra.

DOLA File: 01716-1997-01RO.

Reserve No 45112 (Swan Location 12767) vested in the Shire of Swan for the designated purpose of "Drainage".

Local Authority: Shire of Swan.

DOLA File: 00996-1997-01RO.

Reserve No 45113 (Cockburn Sound Location 4320) vested in the City of Cockburn for the designated purpose of "Public Recreation".

Local Authority: City of Cockburn.

DOLA File: 01735-1994-01RO.

Reserve No 45114 (Erivilla Location 49) vested in the Shire of Meekatharra for the designated purpose of "Water".

Local Authority: Shire of Meekatharra.

DOLA File: 02981-1986-01RO.

Reserve No 45116 (Omalinde Location 7) vested in Telstra Corporation Ltd for the designated purpose of "Telecommunication Site".

Local Authority: Shire of Halls Creek.

DOLA File: 02082-1997-01RO.

Reserve No 45118 (Plantagenet Location 7910) vested in the Shire of Albany for the designated purpose of "Public Recreation".

Local Authority: Shire of Albany.

DOLA File: 02119-1997-01RO.

Reserve No 45119 (Plantagenet Location 7911) vested in the Shire of Albany for the designated purpose of "Public Recreation".

Local Authority: Shire of Albany.

DOLA File: 02005-1997-01RO.

Reserve No 45120 (Wellington Location 5813) vested in the Shire of Harvey for the designated purpose of "Drainage".

Local Authority: Shire of Harvey.

M. C. WAUCHOPE, Clerk of the Council.

LA602*

LAND ACT 1933
ORDER IN COUNCIL
(VESTING OF RESERVE)

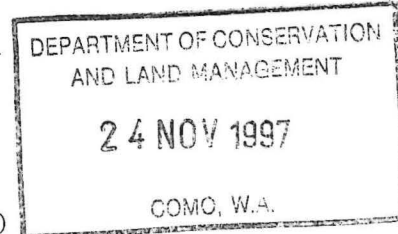

By the direction of His Excellency the Governor under Section 33(2), the following reserve has been vested

DOLA File: 01741-1997-01RO.

Reserve No. 45115 (Plantagenet Location 7901) vested in the Honourable Montague Grant House M.L.A., the Minister for Fisheries for the time being and his successors in Office for the designated purpose of "Aquaculture and Aquaculture Research" with power, to lease the whole or any portion thereof for any term.

Local Authority: Shire of Albany.

M. C. WAUCHOPE, Clerk of the Council.

LA701*

LAND ACT 1933
RESERVATION NOTICE

Made by His Excellency the Governor under Section 29.

The Crown Land described below has been set apart as public reserves

DOLA File: 02522-1996-01RO.

Reserve No 44646 comprising Cockburn Sound Location 4292 (formerly Lot 154 on Diagram 92777) with an area of 1.0832 hectares for the designated purpose of "Public Recreation"

Section 20A

Public Plan/s: BG33 (2) 23.34. near Nettleton Road

Local Authority: Shire of Serpentine/Jarrahdale.

DOLA File: 01482-1995-01RO.

Reserve No 44986 comprising Cockburn Sound Locations 3041, 3042, 3043, 4157 (formerly Lot 79 on Plan 16751), 4166 (formerly Lot 42 on Diagram 84689), 4189 (Lot 210 on Plan 14556), 4191 (formerly Lot 43 on Plan 8813), 4270 (formerly Lot 19 on Plan 21139), 4271 (formerly Lot 18 on Plan 21139), 4272 (formerly Lot 20 on Plan 21139), 4273 (formerly Lot 21 on Plan 21139), 4274 (formerly Lot 119 on Plan 21250) and 4331 (formerly Lot 33 on Diagram 18582) with an area of 258.0542 hectares for the designated purpose of "Conservation of Flora and Fauna"

Section 20A

Public Plan/s: BG33 (10) 2.1. and 2.2. near Serpentine River

Local Authority: Shire of Murray.

DOLA File: 01279-1969-02RO.

Reserve No 45056 comprising Pinjarra Lot 350 with an area of 15.7604 hectares on Land Administration Diagram 90417 for the designated purpose of "Conservation and the Protection of Aboriginal Heritage and Culture"

Public Plan/s: BG32 (2) 14.28 and 14.29. Hampton Road

Local Authority: Shire of Murray.

DOLA File: 02211-1995-01RO.

Reserve No 45100 comprising Swan Location 12784 (formerly the area abutting Lots 34 and 58 and marked 'Pedestrian Accessway' on Plan 17061) with an area of 190 square metres for the designated purpose of "Pedestrian Accessway"









Section 20A

Public Plan/s: BG34 (2) 22.33 and 22.34. Spiers Place and Sprint Close

CALM-MANAGED LANDS AND WATERS

AS AT 30th JUNE 1997

Legend

-  National Park
-  Conservation Park
-  Nature Reserve
-  State Forest, Timber Reserve, Freehold & Other Reserve
-  Section 5(g) Reserve
-  Leasehold in the name of the Executive Director
-  Marine Park / Marine Nature Reserve
-  CALM Region Boundary
-  CALM Regional Office

Scale

0 100 200 300 400 Km

Projection: Polyconic, Origin 121° 0'



Produced by INFORMATION MANAGEMENT BRANCH

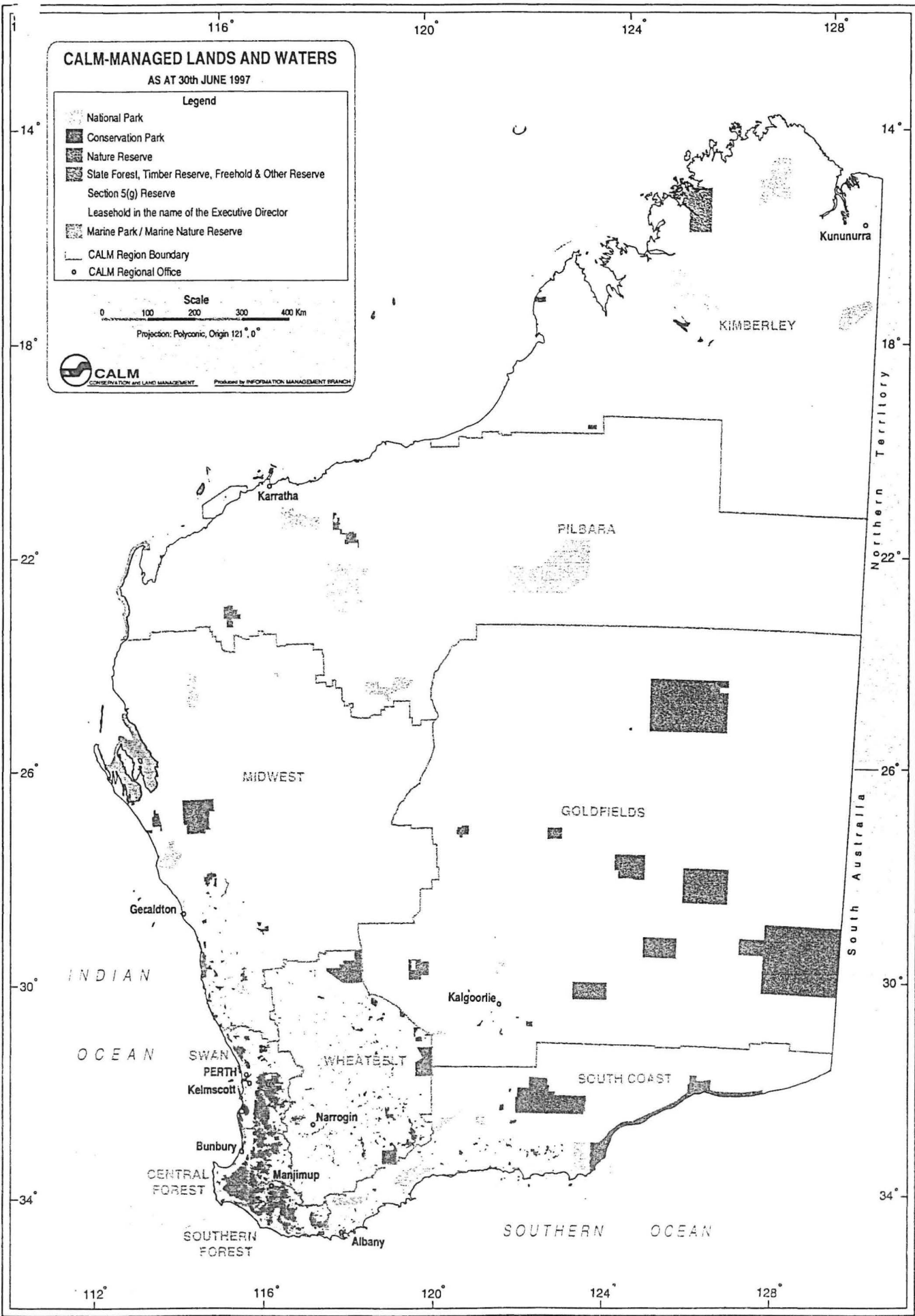

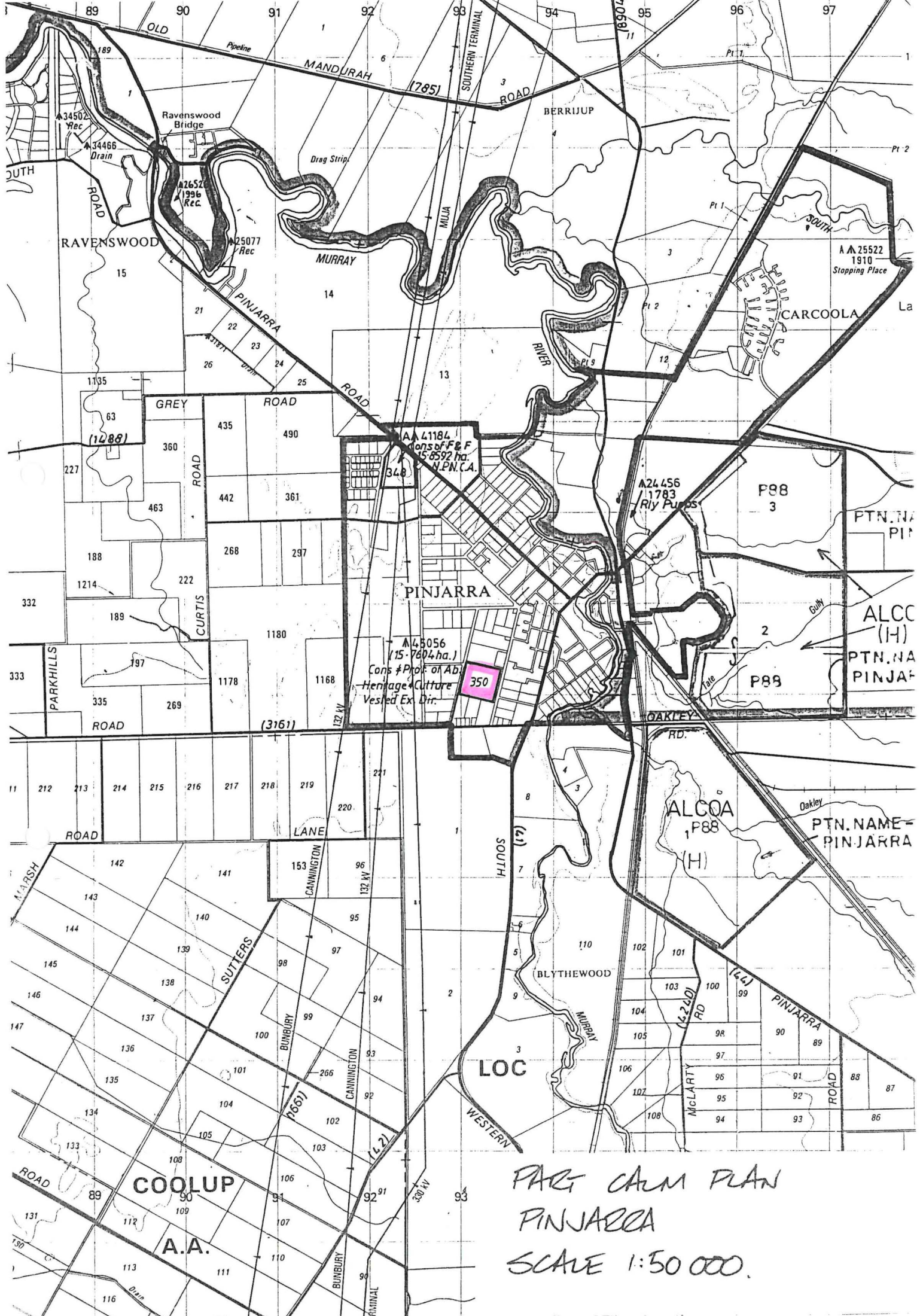

PAGE CALM PLAN
 PINJARRA
 SCALE 1:50 000.

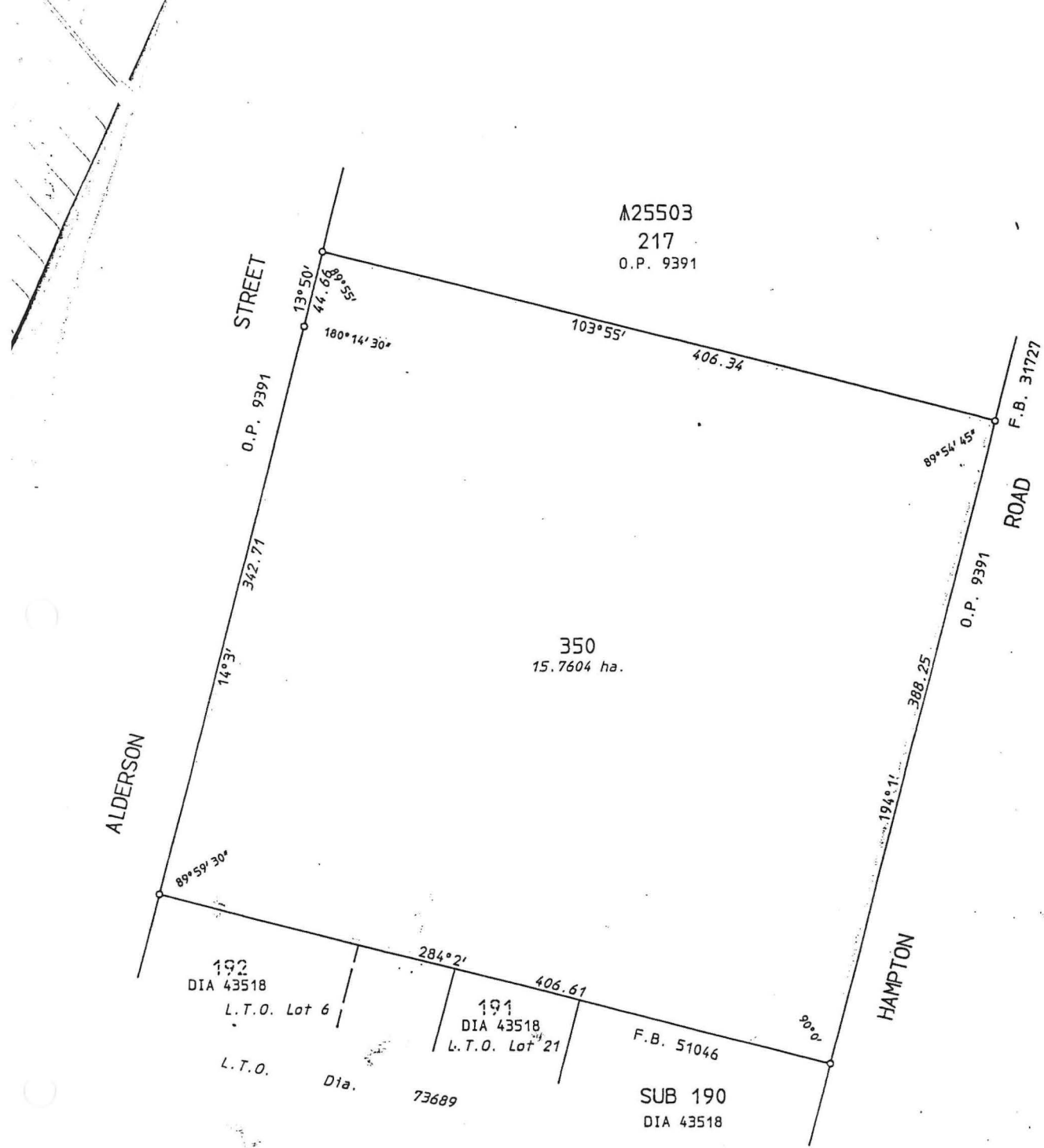

▲25503
217
O.P. 9391

350
15.7604 ha.

192
DIA 43518
L.T.O. Lot 6

191
DIA 43518
L.T.O. Lot 21

F.B. 51046

SUB 190
DIA 43518



LAND DISTRICT
MURRAY

PINJARRA LOT 350



SURVEYOR'S CERTIFICATE

I hereby certify that:-
 (a) this plan of survey is a correct and accurate representation of the survey carried out by me personally / under my own personal supervision, inspection and field check and recorded in Fieldbooks lodged for the purpose of this plan of survey;
 (b) the measurements are in strict accordance with the Licensed Surveyors (Guidance of Surveyors) Regulations 1961 and in particular regulations 23 and 34 of those regulations; and
 (c) this survey and this plan of survey are in strict accordance with the requirements of the Licensed Surveyors (Guidance of Surveyors) Regulations 1961 and the relevant law in relation to which it is lodged.

SCALE 1:2500
measurements in metres

FILE 1279/969

SURVEYOR

PUBLIC PLANS PINJARRA 2000 14.28 & 14.29

FIELD BOOK

INDEX PLANS MURRAY BG32 (2) 14.28 & 14.29

Licensed Surveyor _____ COMPILED _____ Date _____
(* strike out which ever does not apply)

In order for certification
Date _____

AZIMUTH FROM O.P. 9391

RECORDED ON KEYPLAN
INDEX PLANS MURRAY BG32 (2) 14.28 & 14.29

Examined MLC Date 18-12-91
in order for further action

DIAGRAM CERTIFIED CORRECT
J. Kearney
Authorized Land Officer Date 23.12.91

RECORDED ON PUBLIC PLAN
M.A.S. 20/01/92

DEPARTMENT OF LAND ADMINISTRATION

Date _____

REGISTERED
R.F.P. 12/12/91

DIAGRAM 90417