

## RESERVE ACTION SHEET - CONSERVATION RESERVES

**RESERVE No. 46126 (Goldfields Woodlands National Park)**

### REASON FOR ACTION

- Creation of a new class A national park, with a Management Order issued to the Conservation Commission, for the purpose 'National Park'. Area : 64612 hectares
- The reserve is of very high value to conservation. It contains a diversity of landforms and vegetation types including sandplains, eucalypt woodlands and granite complexes. Biological surveys have recorded the richest assemblage of dragon lizards for the eastern goldfields.
- Reserves 46126 and 46127 have been created as stage 1 in the setting aside of a substantial area as national park and conservation park, arising from recommendations in the Regional Management Plan for the Goldfields Region (see folio 335).
- Date of DOLA's advice: 14 April 2000 See folio: 315
- Plans at folios: 319, 335, 342, **343** & 344

OFFICER	ACTION
<p>1 <del>CONSERVATION ESTATE OFFICER</del> <sup>nw</sup></p>	<p>- Fill in above details <span style="float: right;">✓</span></p> <p>- Attach copies of DOLA's advice to file <span style="float: right;">✓</span></p> <p>Send copies of advice &amp; maps to:</p> <p>- Lisa Wright, Woodvale <span style="float: right;">✓</span></p> <p>- Regional Manager, Kalgoorlie <span style="float: right;">✓</span></p> <p>Rec. IUCN classification: <span style="float: right;"><u>II</u></span></p> <p>To note: <i>N. Willers</i> <span style="float: right;">9.1.01</span></p>
<p>2 INDEX CLERK, RECORDS</p>	<p>To note: _____</p>
<p>3 LAND ACQUISITIONS OFFICER</p>	<p>To note: _____</p>
<p>4 MANAGER, PLANNING &amp; VISITOR SERVICES</p>	<p>To note &amp; approve IUCN classification: _____</p>
<p>5 DIRECTOR, NATURE CONSERVATION/ NATIONAL PARKS</p>	<p>To note: _____</p>
<p>6 PROGRAM LEADER (TENURE)</p>	<p>To note &amp; update IUCN records: _____</p>

# RESERVE ACTION SHEET: CONSERVATION RESERVES

**RESERVE No.** 46126

**LOCAL GOVERNMENT:** Shire of Coolgardie

**NAME:** Goldfields Woodlands National Park

**PURPOSE:** National Park

**VESTING:** Conservation Commission

**ACTION**

Addition of Reserve 31897 (Lot 43 on Deposited Plan 176216) to Reserve 46126.

**Total Area:** 64,612 to 64,628.18ha

**REASON FOR ACTION**

The Department of Water has undertaken a review of all their water reserves and are seeking to rationalisation their management responsibilities. As part of this process Reserve 31897 was identified as surplus to their department's requirements.

DEC (now DPaW) expressed an interest in accepting management of Reserve 31897 for addition to the Goldfields Woodlands National Park. Reserve 31897 is a 16.18 hectare enclave lot within the national park.

On the 4 January 2013 Reserve 31897 was added to Goldfields Woodlands National Park.

**Date of amendment:** 4/1/13

**Maps:** 24, 60

**Customer advice:** 57

**Proposal Summary:** 48

**IUCN classification:** Ia

1	<b>LAND UNIT LEADER</b>	To note	<i>6/1/6/2013</i>
2	<b>LAND UNIT</b>	Send copies of advice and maps to: <ul style="list-style-type: none"> <li>• Lisa Wright (Kensington) DIGITAL COPY</li> <li>• District Manager DIGITAL COPY</li> <li>• Regional Manager DIGITAL COPY</li> </ul> Attach TENIS gazettal history to file Delete from District Proposals spreadsheets Create Conservation Commission summary	<div style="text-align: right;"><i>[Signature]</i></div> <div style="text-align: right;"><i>[Signature]</i></div> <div style="text-align: right;"><i>[Signature]</i></div>
3	<b>DIRECTOR, PARKS AND VISITOR SERVICES</b>	To note	
4	<b>C.I.S.</b>	Please rename file/create new file  Keyword: Activity: Subject: Free text:	

**Customer Advices for Reserve Actions**  
1/04/2000 - 30/04/2000

**Shire of Coolgardie 1/04/2000 - 30/04/2000**

Reserve No.	Land Description	DOLA File No.	Volume/Folio	Action	Document No.	Lodge Date	Street Name	Area	Public Plans
10829		04083-1907-01RO	3116-916	Revocation of Management Order () for the designated purpose of "Goldfields Water Supply Administration".	H419912	14/04/2000	Great Eastern Highway	44110 Ha	Boorabbin
10829		04083-1907-01RO	3116-916	Management Order to Minister for Water Resources of 629 Newcastle Street, Leederville for the designated purpose of "	H419914	14/04/2000	Great Eastern Highway	9379.828 Ha	Boorabbin (250)
10829	Jaurdi Location 109 Ngalbain Location 139	04083-1907-01RO	3116-916	Amendment of Reserve to By excising those portions of Jaurdi Location 109 now comprised in Jaurdi Location 111 and Jaurdi Location 112 on Land Administration Miscellaneous Plan 20774 and those portions of Ngalbain Location 139 now comprised in Ngalbain Location 182 and Ngalbain Location 183 on Land Administration Miscellaneous Plan 20774 with its area being reduced to 9379.828 hectares accordingly.	H419913	14/04/2000	Great Eastern Highway	9379.828 Ha	Boorabbin (250)
2178	Ngalbain Location 140	03074-1898-01RO	3116-915	Reserve Cancellation "Public Utility"	H419916	14/04/2000	Great Eastern Highway	404.6856 Ha	Boorabbin (250)
22170	Ngalbain Location 130	00701-1940-01RO	3113-915	Reserve Cancellation "School Site"	H423824	19/04/2000	Coolgardie Esperance Highway	8094 sqm	Boorabbin (250)
22170	No parcel identifier or graphic available	00701-1940-01RO	0-0	Amendment of Reserve to To now comprise of Ngalbain Location 130, Crown Land Title Volume 3113, Folio 915 on 1 and Administration Miscellaneous Diagram 94273.	H423825	19/04/2000		8094 sqm	
2918		02526-1999-01RO	3116-921	Revocation of Management Order () for the designated purpose of "Water".	H419904	14/04/2000	Great Eastern Highway	403.8763 sqm	Boorabbin (250)
2918	Jaurdi Location 108 Ngalbain Location 138	02526-1999-01RO	3116-921	Reserve Cancellation "Water"	H419905	14/04/2000	Great Eastern Highway	403.8763 sqm	Boorabbin (250)
2918	Ngalbain Location and Ngalbain Location	02526-1999-01RO	3116-916	Amendment of Reserve to To include Jaurdi Location 108 (Crown land Title Volume 3116 Folio 920) and Ngalbain Location 138 (Crown Land Title Volume 3116 Folio 921)	H419903	14/04/2000	Great Eastern Highway	0 sqm	Boorabbin (250)
42713		02944-1994-01RO	3025-956	Management Order to Fire and Emergency Services Authority of Western Australia of 420 Hay Street, Perth for the designated purpose of "Fire Station Site"	H423808	19/04/2000	Morgans Street	3751 sqm	CD30(2) 29.01
46126	Jaurdi Location 111 Ngalbain Location 183	01943-1999-01RO	3116-905	Reserve Creation for the designated purpose of "National Park".	H419928	14/04/2000	Great Eastern Highway	64612 Ha	Boorabbin (250)
46127	Jaurdi Location 112 Ngalbain Location 141 Ngalbain Location 142	01943-1999-01RO	3116-906	Reserve Creation for the designated purpose of "Conservation Park".	H419929	14/04/2000	Great Eastern Highway	33370.65 Ha	Boorabbin (250)
6078		03162-1998-01RO	3116-919	Revocation of Management Order () for the designated purpose of "Water".	H419899	14/04/2000	Great Eastern Highway	163.8977 Ha	Boorabbin (250)
6078	Jaurdi Location 110	03162-1998-01RO	3116-919	Reserve Cancellation "Water"	H419900	14/04/2000	Great Eastern Highway	163.8977 Ha	Boorabbin (250)
8480		00598-1990-01RO	3081-413	Revocation of Management Order () for the designated purpose of "Conservation of Flora and Fauna".	H419920	14/04/2000	Great Eastern Highway	258.9988 Ha	Boorabbin
8480	Ngalbain Location 89	00598-1990-01RO	3081-413	Reserve Cancellation "Conservation of Flora and Fauna"	H419921	14/04/2000	Great Eastern Highway	258.9988 Ha	Boorabbin

↑46127 -  
New area  
33311.65

WRONG  
NOT  
CANCELLED

Note A8480 was cancelled by ERROR by DOLA (area was to be included in new ↑46127 (Cons Park) - no approvals were sought or given).

Customer Advices - Created 03/05/2000

DOLA has now reinstated A8480 and amended the area of ↑46127 to include the 258.9988 ha accordingly

S. Collis  
9.1.01.

3/5

(GOLDFIELDS REGION  
KALGOORLIE DISTRICT)

Customer Advices for Reserve Actions  
1/04/2013 - 30/04/2013

(DEC FILE NO 2009/006896)

Shire of Coolgardie 1/04/2013 - 30/04/2013

Reserve No.	Land Description	DPI File No.	Volume/Folio	Action	Document No.	Registered	Street Name	Area	Public Plans
31897	Lot 43 on Deposited Plan 176216	02737-1971-02RO	3081-354 3081-354	Reserve Cancellation "Sand Pit"	M150511	04/01/2013	Nr Great Eastern Highway	16.1874 Ha	Boorabbin (250)
31897	Lot 43 on Deposited Plan 176216	02737-1971-02RO	3081-354 3081-354	?	M150510	04/01/2013	Nr Great Eastern Highway	16.1874 Ha	Boorabbin (250)
46126	Lot 183 on Deposited Plan 220774 Lot 111 on Deposited Plan 220774	01943-1999-02RO	3118-132 3116-905 3116-905	Order for Addition of Land to Certain Class 'A' Reserves to & area = 64628.1874 Hectares	M150512	04/01/2013	Nr Great Eastern Highway	64628.1874 Ha	Boorabbin (250)
5345 5345 5345 5345	Lot 162 on Deposited Plan 41932 Lot 163 on Deposited Plan 41932 Lot 164 on Deposited Plan 41932 Lot 182 on Deposited Plan 41932	07531-1897-01RO	3122-939 3122-940 3122-941 3128-259 3128-259 3128-259 3128-259	Management Order to Shire of Coolgardie of PO Box 138, Kambalda WA 6442. To be utilised for the designated purpose of "Commonage" only, for the designated purpose of "Commonage"	M150520	04/01/2013		1890.5706 Ha	50/80
5345	Lot 182 on Deposited Plan 41932	07531-1897-01RO	3128-259	Amendment of Reserve to To Include Lot 182 on Deposited Plan 41932 and its area being Increased to 1890.5706 hectares, accordingly.	M150519	04/01/2013		1890.5706 Ha	50/80
6630	Lot 182 on Deposited Plan 41932	01811-2001-01RO	3128-259 3128-259	Reserve Cancellation "Water"	M150518	04/01/2013		10.5706 Ha	
6630	Lot 182 on Deposited Plan 41932	01811-2001-01RO	3128-259 3128-259	?	M150517	04/01/2013		10.5706 Ha	

INCLUSION OF CANCELLED R31897 "SANDPIT" INTO  
R46126 (+ 16.1874 ha)  
AREA: 64628.1874 ha

TO: NICOLA MINCHAM (LAND UNIT),  
ALL DATABASES INCLUDING TENIS  
HAVE BEEN AMENDED. RELEVANT  
DOCUMENTS ON PAGES 57-60.

WHITE FOLDER - 14/6/13 RO  
SHAPEFILE - 14/6/13 RO  
TENIS - 14/6/13 RO.  
MAP/INFO - UNAVAILABLE  
SINCE JAN'13 RO.

Rob Dania  
TENURE OFFICER  
GIS SECTION  
27/6/13.

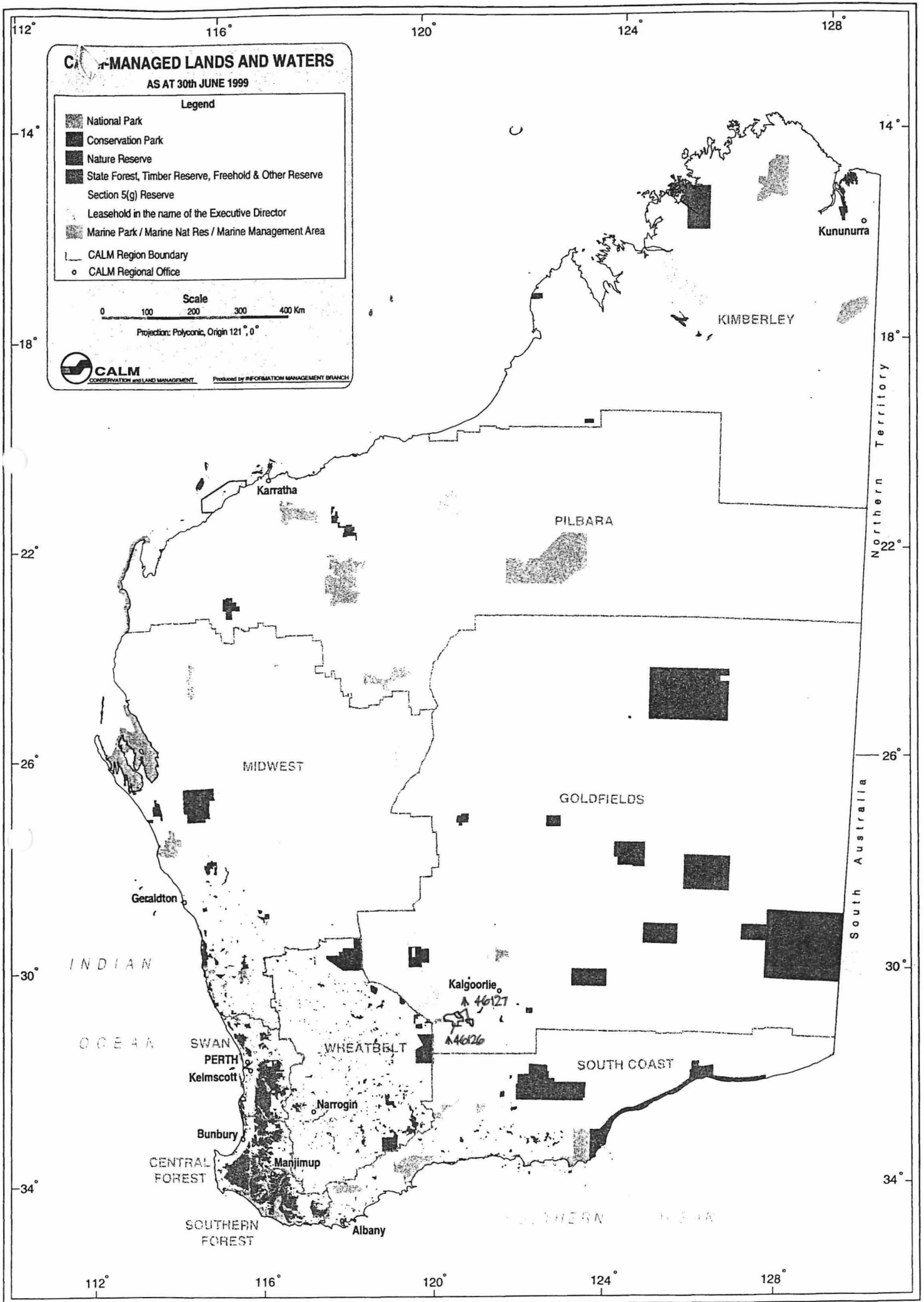

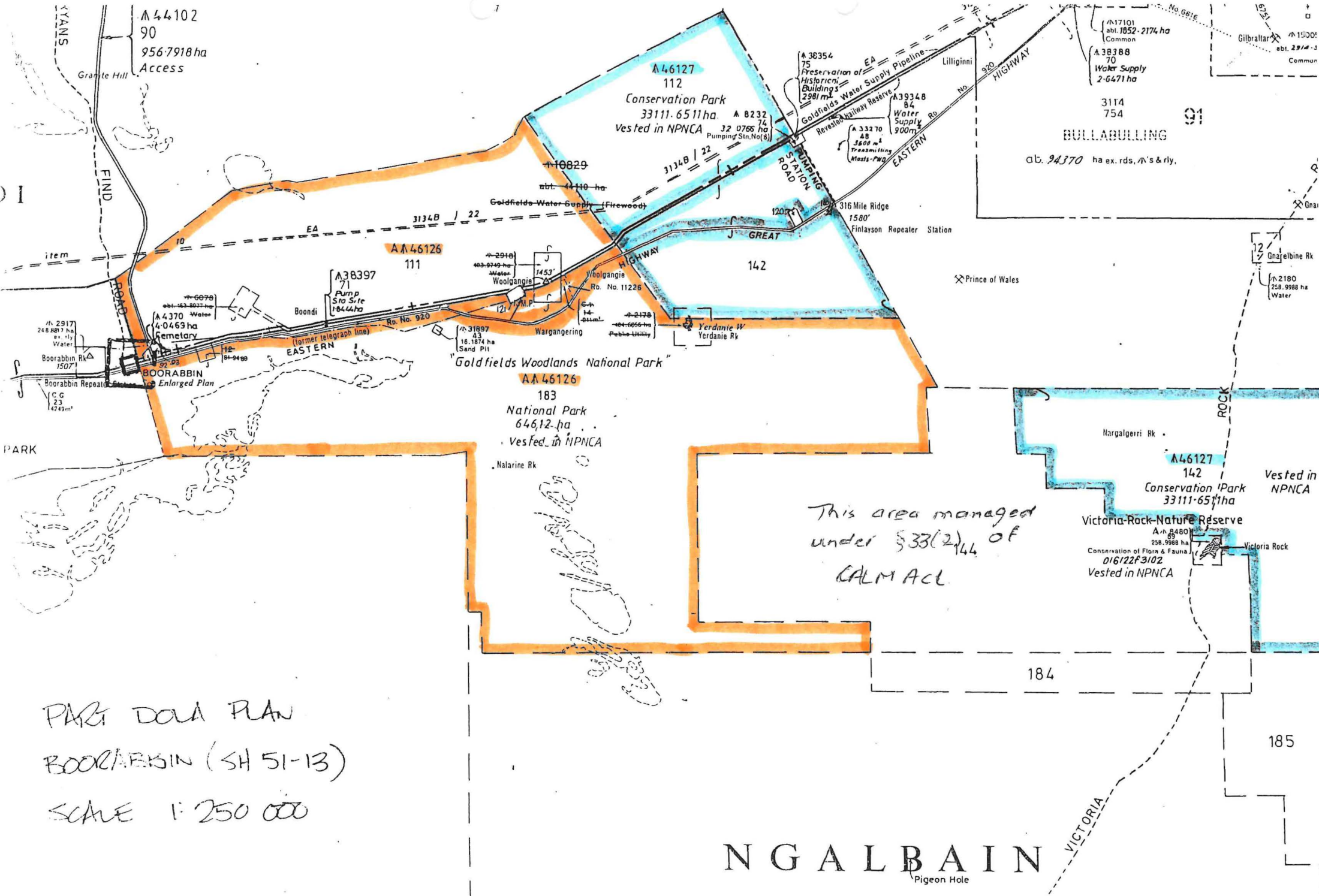

PART DOLA PLAN  
 BOORABBIN (SH 51-13)  
 SCALE 1:250 000

NGALBAIN  
 Pigeon Hole

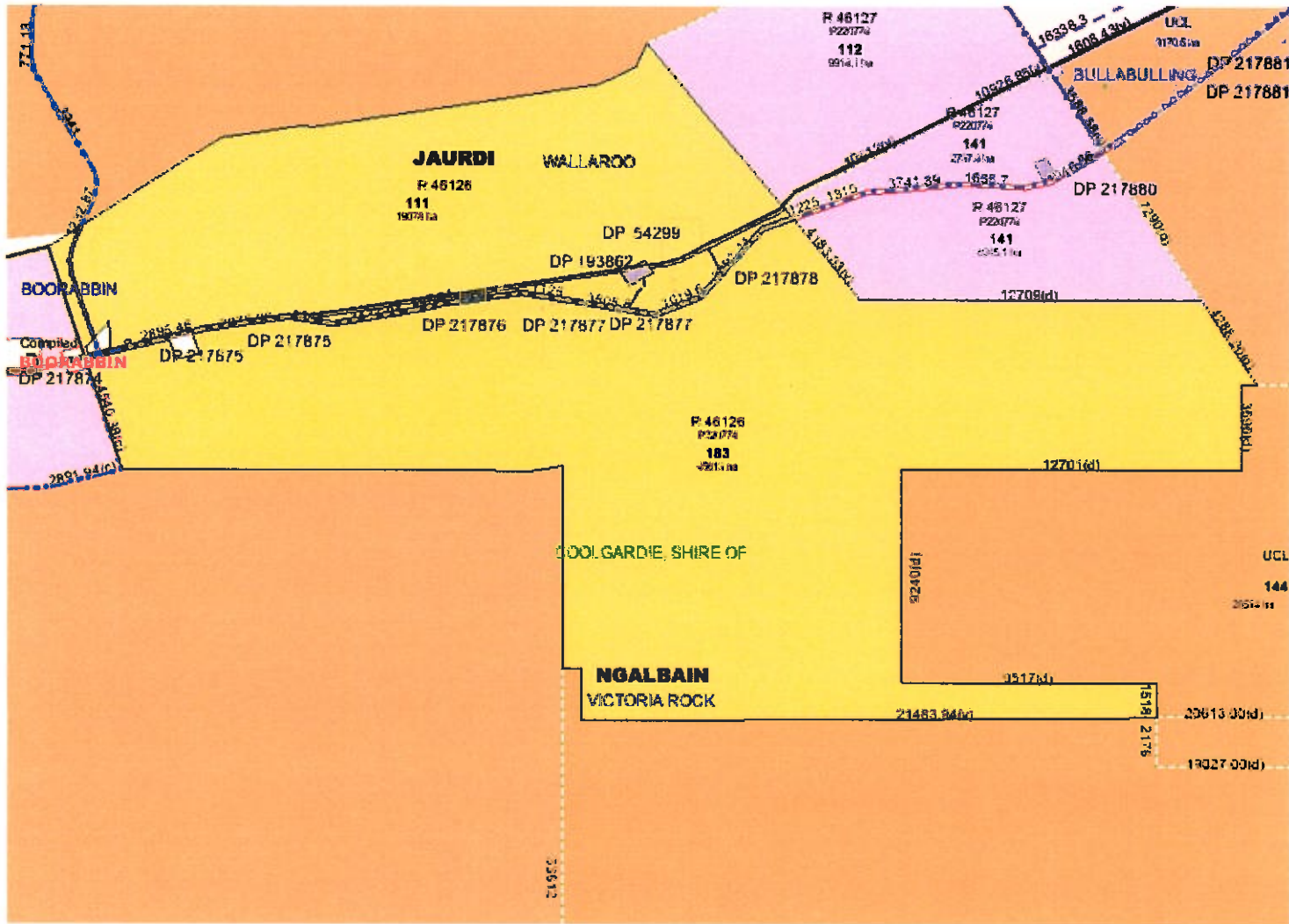

**Crown Reserve 31897  
Addition to Goldfields Woodlands National Park  
(Class A, Crown reserve 46126)  
Shire of Coolgardie**

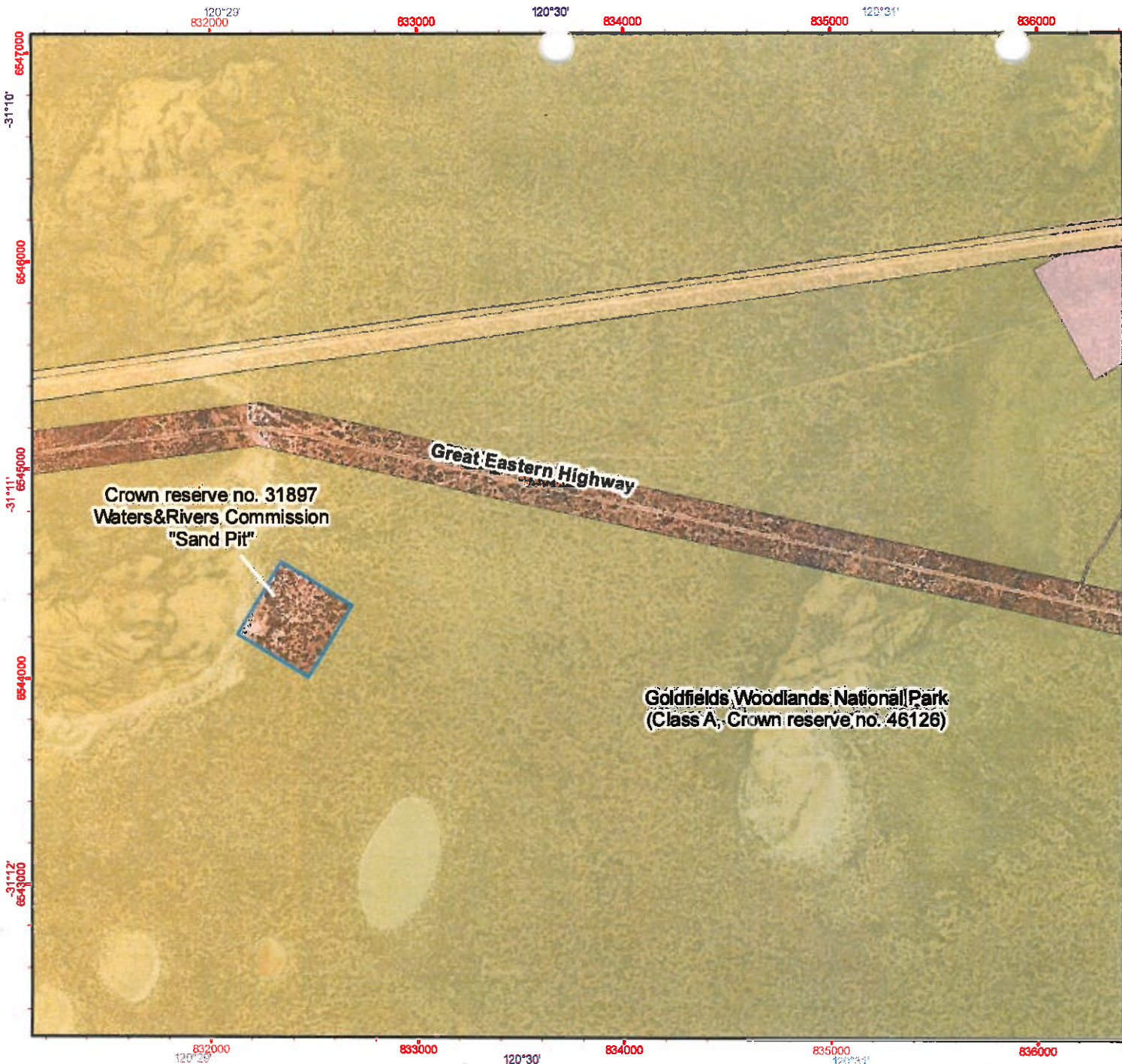

**Legend**

- Crown reserve 31897
- Unallocated Crown Land
- DEC Estate (statewide)
  - Conservation Park
  - Former Leasehold
  - National Park
  - Nature Reserve

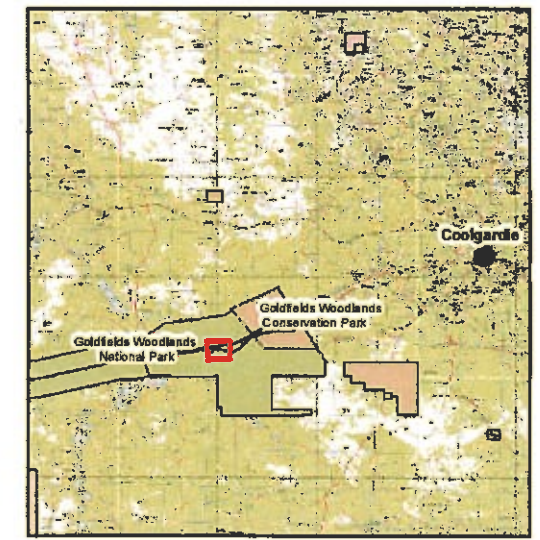
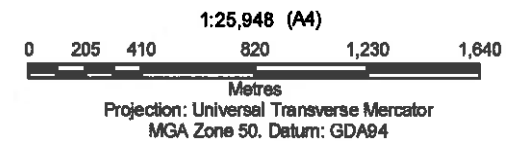

Produced by the  
Department of  
Environment and Conservation

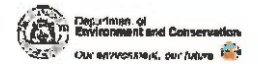

Grid shown at 1 metre intervals  
Grid shown at 1000 metre intervals

The Dept. of Environment and Conservation does not guarantee that this map is without flaw of any kind and disclaims all liability for any errors, loss or other consequence which may arise from relying on any information depicted.  
Roads and tracks on land managed by DEC may contain unmarked hazards and their surface condition is variable. Exercise caution and drive to conditions on all roads.

Produced at 12:6pm, on March 30, 2012

24