

Soil Survey

Ludlow

1937



123

Book 2.

123

Stirling Block

Landow

1937

JLdE

16
3

30
21

12
12

20

20

20

Matting Paddock: Skirling: Pudlow
 River Paddock.
Contents.

Book 2.

River Paddock

Reconnaissance soil survey cpts. 31b, 31c, 32a.
 Continuation of above

Pages
 1-7
 17-21

Matting Paddock.

Interpretation of lines in old 1936 soil survey
 cpts 35a, 35b, 36d, 36e
 cont'd from Book 1

8-13.

Deep Holes.

"A" River Paddock cpt. 34e back of book

26+back.

"B" Matting Paddock. cpt 35a

26.

"F" "C" "H" " " " cpts 36d, 35a, 35b,

25

C, D

cpt. 31c
 see also book 1.

24

① 0-15 Greyton s on
 ploughed up
 15-20 H.Y. s
 22-50 H.Y. greyish
 H8 water
 50-66 Fresh Y = coarse
 66 + 7 super fine
 material.

↑
 ② Δ 300
 ploughed:

① main T
 (or) Ag. flx.
 B. grand.
 c) grass
 Phlebotoma cil.

ploughed F.L.

④ 0-1 Greyton s on
 6-20 Brit Y s
 20-28 grey Y s.
 38-40 Brit Y s (dark)
 40 Brit Y s (white)
 48 do Brit Y
 60 Brit Y s
 66 + super
 water

② Δ 50
 ploughed F.L.

④ J.M.T
 (c) B. grand
 (or) B. grand. Nupt flx.
 (R) B. grand
 B₂ Grasses Huff sad
 m₂ X of Tail fine
 Phlebotoma cil
 o₂ Pet Cur. Erio for
 H₂ B. grand. B. grand
 H₂ B. grand. B. grand
 H₂ B. grand. B. grand
 H₂ B. grand. B. grand
 H₂ B. grand. B. grand
 H₂ B. grand. B. grand

200 ft
 along
 side
 of
 road



|| || 625 || ||
 ploughed F.L.

③ 0-6 Sk Greyton s on
 6-20 Brit H.Y. s.
 20-42 H.Y. s.
 40 water
 42-50 Brit H.Y. s
 52 Brit H.Y.

③ Δ 570

not ploughed.

③ J.M. on T. wood
 (c) B. grand (or) B. grand
 (R) Nupt flx
 of grasses Huff sad.
 m₂ Six str.
 o₂ H₂ B. grand. B. grand
 Pet Cur. Erio for
 H₂ B. grand. B. grand
 H₂ B. grand. B. grand
 H₂ B. grand. B. grand
 H₂ B. grand. B. grand

④ 0-6 Sk Grayson s on
 6-20 Brk H Y s
 20-28 Gray s
 28-40 Gray H Y s (water)
 40 Brk H Y s (water)
 48 do Brk H Y
 60 Brk H Y
 66+ wiper
 water

Time 2
 River
 2874

② Δ 50
 played F.L.



④ J.M.T.
 (c) B. gradus
 (m) B. ablen. Nuyt flex
 (R) B. longif.
 Rg Grasses Nuyt flex
 Nuyt x for Jack pine
 Phlebo bed
 oc Pet Cur Dryo Jan
 Nub enough
 Nub Nuyt Nuyt flex
 Nub calce
 Nub Nuyt flex
 Nub Nuyt flex
 Nub Nuyt flex

By suitable app.



③ 0-6 Sk Grayson s on
 6-20 Brk H Y s
 20-42 H Y s
 40 water
 42-50 Brk H Y s
 50 Bright

③ Δ 570
 not played

③ J.M. on a T unit
 (c) B. grad (oc) B. ablen.
 (R) Nuyt flex
 oc grasses Nuyt flex
 Nub sev str.
 oc Nub Nuyt Bony Eric
 Pet Cur
 Kern prot. Phlebo
 oc Nuyt flex
 Ten prot. N. ablen

② 0-12 Grayson s on
 12-22 H Y s
 22-36 Brk H Y s
 36-50 " " wet.
 40 water
 50-60 Gray H Y s
 60-66 " " M. Jan
 66-7 do wiper
 72+ wiper
 water

② Δ 300
 p. pin
 grad
 played

② Played area
 matri J
 (c) B. gradus H Y flex
 (R) B. ablen.
 (c) Spr.
 (oc) H Y
 Rg grasses
 oc Nub Nuyt Cao Jan
 Tack Jan. Kern prot.
 Pet Cur Sowerba
 Cary Swift spicatus

played

played

Cpt 31
 b'

Cpt 31
 c'

① 0-1 Sk Grayson s on
 1-5 Grayson s
 5-12 H Y s
 12-20 H Y s
 20-22 water
 22 do M. Jan
 40+ wiper
 Ave K grand
 Larklin.

S West corner
 Cpt 31 b'
 1074

① Δ 00
 Cpt 31
 b

Cpt 31
 c

① P. pin food / v fair
 matri (c) Spr
 oc grasses (Nuyt flex)
 Nub sev str. Nuyt flex
 Nub sev str. Nuyt flex
 Nub sev str. Nuyt flex
 oc Sowerba ? sample
 Bony curab Bony
 matri. Rg precu
 Nub Yane Hony
 Rg matri. Nuyt flex
 31/8/37

River Raddock.

(12) 0-15 Grey s. om
 15-36 Y Br / s
 36-50 Grey Y s.
 50-60 Ash Y s.
 60 water
 66 do M yr
 66+ water imper-

(12) 2 300
 ploughed.

(10) JM
 (a) Mz (b) Sollen.
 ab Phlebo cil. Conistylus brown
 on low of forest?
 on low bushes

(11) 0-12 Grey s. om
 12-30 Y Br Grey s
 30-36 Y Br s
 36-50 Y Br s (water)
 50-56 Coffee Ash Br s
 56-60 M yr.
 36+ imper on road.

(11) 50
 ploughed break
 50

(11) JM
 (R) red occidentalis Penlight
 Nuytia flab.
 (c) Tee tree (Mz) Mz
 ab Grass Hyp. rad.
 on Phlebo cil.
 on 2 trees Young Pet Lin
 Phyl. calce.

300 ft of Grey s
 300 ft of Y Br s
 300 ft of Ash Y s
 300 ft of M yr



(10) 0-10 Grey s om
 10-18 Y Br Grey s
 18-45 Y Br
 45-66+ Ash Y s.
 66 water
 66+ imper water.

(10) 600
 600

(10) Turb. marr. Jarrad
 (a) xpr (b) J. Jarrad.
 ab Grass Hyp. rad.
 on Sush. Pet. Lin.
 on Phlebo cil. Plectis caerulea
 Turb. marr. Jarrad
 Ran. prostrata Ph. calce
 Conistylus brown

(9) 0-15 Grey s
 15-36 Y Br s
 2a water
 36 Grey Y s.
 -50+ water imper

(9) 300
 grey/white
 drier ↓

(9) Marr. Jarrad
 (a) B. cut.
 ab Conistylus brown
 Phlebo cil.
 on dry riv. Turb. marr.
 on Y Br flod
 Sygenia abundant.

wet
 Y Br.
 surface.

grey
 road

(10) 0-10 Grey s. om
10-18 Lt. Grey s.
18-45 Y Br
45-66+ Br Y Lgn.
LB water
66+ wiper water.

(10) 600

(2) Turt. m. J. ad.
W. sp. (W. B. sand)
Rb. Grass hyp. rad.
with Sev. sh. Pet. Lin.
on Phlebo cil. Rostia conf.
Turt. pure Lign. Phlebo cil.
Rostia pr. ad. R. ad.
Conostyles brown

(11) 0-15 Grey s.
15-24 Y Br s.
24+ water
36 Grey Y s.
-52+ water wiper

(9) 300

grey/white
dirt ↓
wet
Y Br.
surface

(9) water T. ad.
O.B. cut.
ab Conostyles brown
Phlebo cil
on Dry riv. Turt. pure.
on Y Br. R. ad.
Lycopodium abundant.

grey/white

Road
(8) 700

(12) 0-12 Grey s. om
12-16 Lt. Grey Br s.
16-24 Y Br. Lign. Y s.
24-30 High Lt Y s.
30-40 M. Green water
51+ wiper water.

(8)

ab grass, Turt. pure
with Turt. pure. Phlebo cil
Met. stem. Conostyles brown
Sp. pet.
on Rostia conf.
V. m. ad. den.
Rak u. ad. den.

Cont. 300
100
No of plants
abundant

0-6 Green Br s. om
(13) 6-18 Grey Y s.
24-40 M. Green d. (water)
44+ water wiper

(7) 650

Track
380 →

w. s.
(1) Y Br
(7) ab Conostyles brown Rostia conf.
Turt. pure
with Sp. sp. Lign. stem
on Sp. sp. Lign. stem
Lign. stem sp. Phlebo cil.
N. m. ad. den. Phlebo cil.

(14) 0-5 Br Y s.
5-15 Y Br " "
15-30 Y s. wet.
30-40 Lt Grey Y s. water.
40 100+ wiper

(6) 600

last flat bottom.

(6) E. m. ad.
a) + pr
ab Met. stem? Conostyles brown

① 0-5 Sh GB s om
 5-11 Y Br s.
 11-60 Greyish BY s.
 60-120 Brklt. Y s.
 120-132 Lt Y s.
 132 - Yellow coarse (wett.)
 water.

④ 1200
 centre way
 1150

④ P. pin s fair
 (C) Ag flies on
 ab Grass Hyp rad.
 wab Dav div.
 see Fabrice Yarn Bosselin
 Gallia sp. sand. north.
 also sp. Picrella xan.
 Lepid.

156+

③ 0-4 Sh Grey s om
 4-10 Y Br s.
 10-59 Brk Y s.
 59-102 Brk Grey Y s.
 102-118 Greenish Y Grey s
 118 - much illuminate.
 lighter ditto.
 126 Blunish Grey
 prout. fine illuminate
 130-138 Brk Lt Y s.
 138 - do but greyer
 & lgr. small.
 144 - Grey coarse
 wett.
 water.

③ 900

Zogarrup
 Sd.

③ P. pin good.
 J.M.
 (C) Ag. flies (or) Batten Bines
 Ab Hypnat grasses.
 wab Dav div. Lepid. sp.
 see Tot oct. Pet. Cin. Kib. Nov.
 Phyl. cal. Fabrice Yarn
 Hll. hyp. Eric. fru.
 Gomp. tan
 Gomp. d. l. s. brown Bosselin
 Dry. Am. Nov. Bosselin

150+

② 0-5 Sh Grey s om
 5-80+ Y Br / Brk Y

② 600

Wlee
 last.

J.
 ② P. pin s fair
 (C) B. atter. B. sand
 (R) Ag. flies. P. pin long
 Ab Grasses x for. Mz
 wab sp. div. Tel oct
 low Pr.
 see Wlee. frog. Phyl. cal.
 Gomp. tan. P. pin
 Gomp. d. l. s. crystal web
 Eric. sp. Tull. juv.

① 0-10 Sh GB s om.
 10-40 Y Br.
 40-80 lighter flur / Port. s.
 so wett.
 110 Greyish Y Br s lgr
 Greenish coarse dice
 to illuminate phlos
 120+ miper waler.

① 200

see
 Zogarrup Sand.

① P. pin good.
 Tull. web.
 (C) B. atter.
 ab Grasses
 wab Tel. oct.
 see Dav. div. Eric. sp.
 Muehlen. g. l. s.
 Low. Pr. P. pin. Phyl. cal.
 Wab. d. l. s. Kib. hyp.
 Hard comp.

Case 1
 2572
 11/11/53
 11/11/53

CP31c
 Break

Cpt 316.

① 0-5 BK 2B 5 om.
 5-80+ Y/B / Parshy

② 600

Wet
 east.

③ P. pin & fair

④ B. abler, B. sand
 (P) H. flies per long
 No grasses x par. M
 Not Jan. div. Tel. oak
 Tom Pr.
 see West prod. Phy. coly
 Gomp. form. P. Ken
 Long det. crypt. det.
 Eric sp, Tall pine,

① 0-10 BK 2B 5 om.

10-40 Y/B
 40- higher for / Parshy
 So wet.

110 High Y/B's low
 from some dice
 to illuminate phloem

120+ maple water.

① 300

see
 Fogamp Sand.

① P. pin good.

Saltak harr
 (C) B. abler.

of Grass

not Tel. oak.

see Jan. div. Eric sp
 Much less grass
 Low for P. Ken
 H. flies per long
 Handcount.

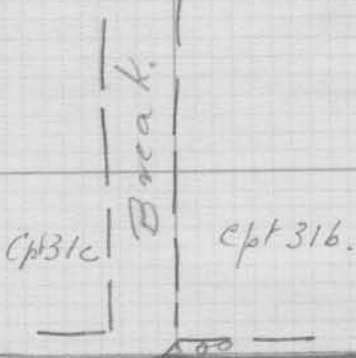
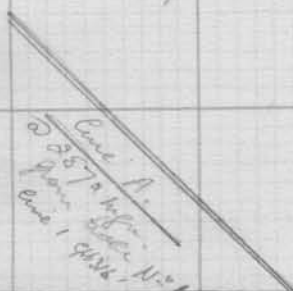

P. pin

Road 2700

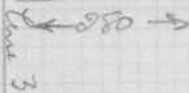

⑬ 0-19 Y/B off
 19-24 Grey Y's
 24- v. ct 9x. 5
 H. flies large.
 36+ maple for
 water.

⑬ 600

15" water

Y/B
 West side.

⑭ Eric sp

abf Sedges
 not Hyp rad.

of shrubs off
 Salt for Melaleuca
 Skin? Angiozanthus
 Mayh.

Grey

④ 0-10 dk grey ls on
 10-20 Grey Brn s
 22-70 Y Brn s.
 70-150 Porsh Y s.
 150+ Lst w/ spec.



④ Turst
 (ab) Ag flex. P pin good
 Ag Nyp red grasses
 wab End waste
 oc Bracken, Phyl. callu
 Horden, Ampel
 1300 ched Lao King
 Natase Yam Red fruit

⑧ 0-18 dk Grey Brn som.
 18-54 Grey Brn s.
 54-120 Y Brn.
 contains ilmenite.
 120-134 Greyish Y s
 (granitic)
 134- Greenish Grey s
 (ilmenite)
 144-175 Greyish Y s
 (granitic)
 175- Porsh Y s
 Coarse w/lt
 some ilmenite
 Lgn

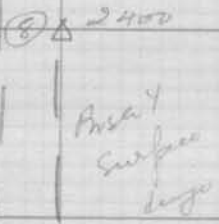

⑧ Turst
 (ab) Ag flex.
 (oc) Ag.
 Ag grasses, Nyp red.
 wab
 oc Bracken

Change direction

⑦ 0-9 dk Grey Brn som
 9-27 Grey Brn s
 27-70 Y Brn s
 70- Greyish Br Y s.
 152- do
 180- vlt greyish Y

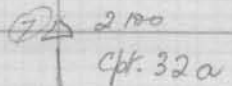

⑦ Turst P pin good
 (c) Ag flex
 dk grasses Nyp red.
 wab

198 do coarse w/lt
 200+ w/lt w/ spec.

oc Bracken P pin good
 Nat. under Natase
 Yam Phyl. callu
 Rhizophora Cateal
 Mircalagm sty.
 Tack. fare.

⑥ 0-5 dk Grey Brn
 5-34 Grey Brn / Y Brn s
 34-50 Y Brn s
 50-90 Por Y s
 90-130 Greyish Br L Y s

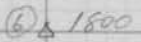

⑥ Turst P pin good
 (c) Ag flex
 (oc) Ag
 dk grasses Nyp red

134 - Greenish Gray s
 (Chenille)
 144 - 175 Greenish Gray s
 (Chenille)
 175 - Reddish Gray s
 Coarse wet
 180 - Greenish Gray s
 Lyr

Lyr change

⑦ 0-9 Grey, brown
 9-27 Grey Brown
 27-70 Y Br s
 70 - Grey Br Y s
 156+ do
 180 - Vlt grey Y

326

⑦ 2100
 Cpt. 32a

⑦ Turb P. pin good
 (c) Ag flex
 ab grass suprad.
 web

198 do coarse wet
 200+ water wipen.

on Bracon Par xanth.
 Nab. undul. hance
 Yarr Phyl. calic.
 Rhizophora Culex
 hurelaga sdy
 Tack. fare.

⑧ 0-5 Grey Brown
 5-34 Grey Brown/Y Br s
 34-50 Y Br s
 50-90 Br Y s
 90-130 Greyish Br LY s
 130 - Grey LY/LY
 156+ W Grey Y s (wet)

⑧ 1800

⑧ Turb P. pin good
 (c) Ag flex
 (c) Mz
 ab even suprad.

web Sedges End. woch.
 Grad. eggium
 on Boss. chin. sub hyp.
 Kan. prov. Turb. clab
 Pab. and. Kalk. undul.
 Lyr. sp. Gomp. tom.
 Lem. prop. hance. Yarr

⑨ 0-10 Grey Br s. cov.
 18-24 Y Br s.
 24-60 Br Y s.
 60-144 Br LY s.
 144-156 LY s. cov. Y s
 + Coarse (wet)
 156+ water

⑨ 1500

⑨ I.M.
 (c) Mz (c) B. C. hance
 Mz (c) spr.
 No/ Nyp. s. p. s.
 web Boss. chin.

on Tet. oct. Kan. prov.
 Ph. calic. Gomp. tom.
 hance. Yarr. long. s. d.
 Lem. prop. Hard. abrupt.
 web hyp. Kann. Caffine

(14) 0-6 St. Grey Brown
 6-15 Grey Brown
 15-22 " (ground?)
 22-72 Pink Y
 72-126 Pink LTY
 126-134 4 L de Ho

to Canary
 134- Lt Grey Y (WAT)
 144-156 Lt Canary coarse
 3d water
 greyish

(14) Δ 1200

(14) Turb. J M

(c) Ag flex
 (oc) B. titen
 (var) Mg for

ab grass High road

note seeds low P
 P. 2000 No. 1000
 S. 2000 No. 1000
 S. 2000 No. 1000
 S. 2000 No. 1000
 S. 2000 No. 1000

(13) 0-12 St. Grey Brown

12-72 Y. Br. s
 72-130 Pink Y s
 130-156 Grey for Lt Y s
 156-180 Grey Lt Y
 180-188 Canary? Y. sd
 188 water imple

(13) Δ 900

(13) Turb. P.p. good

(ab) Ag flex

ab grasses High road.

note Trichopus Clad.
 S. 2000 No. 1000
 S. 2000 No. 1000
 S. 2000 No. 1000
 S. 2000 No. 1000

Cpt. 316.

Break

(12) 0-6 EK Grey Brn. S. on

6-18 G. P. s
 15-40 Y. Br. s.
 40-66 Pink Y S
 66-130 Pink grey LTY.
 130-144 Grey Y
 144- Grey Y
 156-7 with aluminate

(12) Δ 600

Cpt. 32a

(12) Turb. P.p. fair

(c) Ag flex

(R) Ac calyptra, Mg

Ab Grass High road

note Bad. work

note Lobelia Pat occid
 S. 2000 No. 1000
 S. 2000 No. 1000
 S. 2000 No. 1000
 S. 2000 No. 1000

(11) 0-20 EK Grey Brn. S. on

20-30 Y. Br. s
 30-75 Y. Br. s
 75-144 Y. Br. s

(11) Δ 300

(11) Turb. P.p. good

(c) Ag flex

(oc) B. granules

(13) 0-10 Old Grey Ben s
 12-72 Y Ben s
 72-130 Pr Y s
 130-152 Grey Pr LY s
 156-180 Grey LY s
 180-186 Cadamy Y s
 1st water impure

(13) Δ 900

(13) Turst Pip good
 (ab) Ag flex
 ab Grasses Hyp rad.
 web Trichome clad.
 Hard wood & cypress
 all better from Lepidoptera
 Hard compt Low sp.

Cpt. 316.

Breaks

(14) 0-6 EN Grey Ben s on
 6-16 GY s
 16-40 Y Pr s.
 40-64 Pr Y S
 66-130 Prish grey LY.
 130-144 Grey Y
 144-156 Grey Y
 156+ much element

(14) Δ 600

Cpt. 32a

(14) Turst P. p. tan
 (C) Ag flex.
 (R) Ac caespia, Mz
 Ab Grass Hyp rad
 web Good wood
 all Lepidoptera Pat accid
 Hard compt Low sp.
 Long Hugel. Tel cat.
 Comestyles brown.

(11) 0-20 Old Grey Ben s on
 20-30 Grey Ben s
 30-75 Y Ben s
 75-108 Grey Pr Yellow s
 108-132 Grey Pr Yellow s
 132-140 Prish GY s
 140-150 LY Grey Y s.
 150-156 VLY Y (grey s)
 + 1st flouter

(11) Δ 300

(11) Turst P. p. tan
 (C) Ag flex
 (R) B. grandis.
 ab Grass Hyp rad.
 web Poor chio.
 all Low prof. Gamba tan
 Hard compt Pat accid.
 Low prof. kly. Prish
 Stucco sp. Rhizophora
 Good egg Good wood.

(10) 0-15 Old Grey Ben s on
 15-30 Grey Ben s
 30-60 Y Ben s
 60-72 Prish Y s
 72-204 Prish LY s
 204-216 Prish LY s
 216+ all

(10) Δ 00

(10) Turst
 (a) Ag. flex.
 ab Grass
 web Good wood egg
 all Low prof. brown
 Hard compt Prish
 Pat accid. Low prof.
 Phycarid

150
 100
 50
 0
 100
 200
 300
 400
 500
 600
 700
 800
 900
 1000

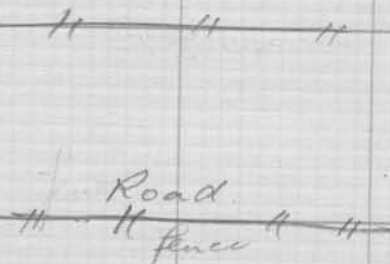

(16) 0-15 Grey Blue s on
 15-20 Grey Blue s
 20-27 lt. dk
 27-40 bluish grey s.
 40-46 blk
 45-60 blk H.Y. s
 60-120 blk grey H.Y.
 120-138 Grey H.Y. s
 coarse
 v. red gravel
 & blk shell
 138+ blk impur.

ey
 grey
 blk
 326

(16) 1300
 large
 Cpt 32a

(16) Turst P. p. p. road
 (C) Ag flk.
 (C) Ag flk.
 ab grasses H.Y. road.
 with Bracken
 or Turbergye flat. Kew
 grass. hard corfs
 Gouffé domes
 Puffball
 Physalis
 Calceolaria
 Balaclava

(17) 0-20 St. Grey Blue s
 30-70 Y Grey Blue
 70-144 do
 144-168 do
 168-180 blk grey s
 coarse
 some chert
 180-204 Grey H.Y. s
 v. coarse
 204 blk H.Y. s (wet)
 216 do into broken
 shell water

(17) 900

(17) Turst P. p. p. road
 (C) Ag flk.
 or Glass H.Y. road.
 with Bracken ? Best work
 or Bracken
 Stipa
 Tan
 few prof
 Gouffé domes
 Halimolobos
 Harder
 prof

(18) 0-20 St. Grey Blue s
 30-70 Y Grey Blue
 70-144 do
 144-168 do
 168-180 blk grey s
 coarse
 some chert
 180-204 Grey H.Y. s
 v. coarse
 204 blk H.Y. s (wet)
 216 do into broken
 shell water

60-120 1/2" grey Lt Y s
 120-138 1/2" grey Lt Y s
 coarse
 v. rare gravel
 & tiny shells
 135+ 1/2" impure

21
 Turbarys lat. Rem
 prob. hard corals
 Gouph. domus
 Pat. acis
 Phyl. calis
 Bala. dylis Rem.

(17) 0-20 1/2" grey Lt Y s
 5 cm.
 20-70 1/2" grey Lt Y s
 70-144 do greenish tan
 due to iron oxide
 144-168 1/2" grey Lt Y s
 so much iron oxide
 168-180 1/2" grey Lt Y s
 coarse
 some clastic
 180-204 1/2" grey Lt Y s
 v. coarse
 204 1/2" grey Lt Y s (w/lt)
 216 1/2" grey Lt Y s
 shell weather

(17) 900

(17) Turbarys P. p. 2 masses
 (c) Ag flex
 ab Grass Hyp rad.
 web Broken ? best work
 occ Broken bony beam
 Spha. 2 N. acis
 Jan. Spha. drum
 low prof. Borealis
 Gouph. domus
 N. lites undulata
 Harder. Corall. the
 prof. layer. Spha.

(16) 0-18 1/2" grey Lt Y s
 13 cm
 18-70 1/2" grey Lt Y s
 70-140 1/2" grey Lt Y s
 140-150 1/2" grey Lt Y s
 150-155 1/2" grey Lt Y s
 155+ Lt.

ironclay
 Sol.
 Broken large
 or surface

(16) 600

(16) Turbarys P. p. good
 (c) Ag flex
 (cc) B. grandis (R) B. atten
 ab Grass. Hyp rad.
 web Broken Cor. mouth
 occ Gouph. tom. N. lites
 low prof. Borealis
 low prof. Hard corals
 Phyl. calis Ac. pulch
 Spha. fura Sowerham
 Corif.

(15) 0-16 1/2" grey Lt Y s
 16-21 1/2" grey Lt Y s
 21-54 1/2" grey Lt Y s
 54-70 1/2" grey Lt Y s
 70-144 1/2" grey Lt Y s
 144-150 1/2" grey Lt Y s
 150-168 1/2" grey Lt Y s
 168-180 1/2" grey Lt Y s
 180-185 1/2" grey Lt Y s
 coarse
 185+ Lt

ironclay
 Sand
 Break
 Cpt 32a
 900
 frame

(15) 800

(15) Turbarys P. p. fine
 (c) Ag flex.
 ab Grass Hyp rad
 web Broken (am) Turb. mass.
 occ Broken bony beam
 Hard. corals. Ac. lites
 low prof. Gouph. tom
 low prof. Borealis
 low prof. Spha. fura

300 w/ham
 Cpt 32a
 1/2" A cont
 185+ Lt

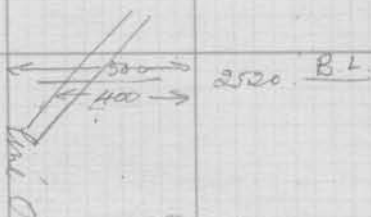

79) 0-3 Black dkdk G
 3-16 dk G
 16-30 Ldk G
 30-37 dk G
 37-54 dk med G
 54-76 Y med G / pm Med Y
 76+ water upen

79) 2400

79) Tuari P. p. pool
 (A) flex B. grandis
 ab Sedges sark juce
 not Rakia prostrata
 see Dax malayda
 Convolvus kran Damp
 Hulohe
 R P. sec. ten prof. Accipiter

4B
 (76AD)

78) 0-3 Ldk dk G s om
 3-15 Ldk G s
 15-22 dk med G
 22-24 Ldk G / dk med G
 24-36 Ldk G s
 36-46 dk med G s
 46-60 dk med G s
 60 + 100 upen

78) 2150

78) Tuari M. p. pool
 (A) B. grandis P. p. pool
 (B) B. grandis
 ab Sarks juce Seproop
 not Dax malayda
 see Convolvus kran
 Hulohe
 R Sarks juce

4B
 5A

77) 0-3 Bdk G s / dk med G
 3-14 dk med G
 14-18 dk med G
 18-20 dk med G
 20-31 dk med G
 31-36 dk med G / dk med G
 36-40 dk med G
 40-45 dk med G
 45-50 dk med G
 50-55 dk med G
 55-60 dk med G
 60-65 dk med G
 65-70 dk med G
 70-75 dk med G
 75-80 dk med G
 80-85 dk med G
 85-90 dk med G
 90-95 dk med G
 95-100 dk med G

77) 1850

77) Tuari M. p. pool
 ab Seproop, sark juce
 not Dax malayda
 see Convolvus kran
 Hulohe

4B
 5A

76) 0-6 Bdk dk G s om
 6-9 Ldk dk G s
 9-13 dk med G s

76) 1550

76) Tuari P. p. pool
 (A) B. grandis
 (B) B. grandis

75) 0-3 Lt. Brn dk. G. s. on
 5-15 Lt. Brn G. s.
 15-18 Brn G. s.
 18-22 Brn med G. s. / Lt. Brn G. s.
 22-24 Lt. Brn G. s. / Lt. Brn G. s.
 24-36 Lt. Brn G. s.
 36-46 Brn dk. G. s.
 46-60 Lt. Brn G. s. coarse
 water.
 60+ Lt. Brn w/fern.

75) 1850

sh. 5A1

76) Trout Marri
 (cc) 6/10/11 P. pm
 (cc) 8/1/11
 at last full Lepidoptera
 w/ab 200. m. m. m.
 cc Conspicuous brown
 water
 R. not pres.

77) 0-3 Brn G. s. / Lt. Brn G. s.
 3-15 Lt. Brn G. s.
 15-18 Brn G. s.
 18-22 Lt. Brn G. s.
 22-36 Brn med G. s. / Lt. Brn G. s.
 36-46 Lt. Brn G. s.
 46-60 Lt. Brn G. s. coarse
 water
 60+ Lt. Brn w/fern.

77) 1850

sh. 5A1
 shallow

77) Trout Marri P. pm
 at Lepidoptera, not full
 not Pres. m. m. m.
 cc Conspicuous brown
 water

76) 0-1 Lt. Brn dk. G. s.
 1-9 Lt. Brn dk. G. s.
 9-15 Lt. Brn G. s.
 15-22 Brn G. s.
 22-36 Lt. Brn G. s.
 36-46 Lt. Brn G. s. coarse
 water
 46-60 Lt. Brn G. s. coarse
 water
 60+ Lt. Brn G. s. coarse
 water
 + u. hard + thorny.

76) 1550

Break.

500 → 1000

sh. 6A1
 shallow

76) Trout P. pm
 (cc) 8/1/11
 (cc) 8/1/11
 at Lepidoptera spp.
 w/ab 200. m. m. m.
 not full
 cc No conspicuous Trout
 Marri P. pm
 at Lepidoptera spp.
 w/ab 200. m. m. m.
 not full

78) 0-3 Lt. Brn dk. G. s.
 3-6 G. s.
 6-15 Lt. Brn G. s.
 15-18 Brn med G. s.
 18-27 Brn med G. s. / Lt. Brn G. s.
 27-36 Brn med G. s. / Lt. Brn G. s.
 36-46 Lt. Brn G. s.
 46-60 Lt. Brn G. s. coarse
 water
 60-72 Lt. Brn G. s. coarse
 water
 72-90 Lt. Brn G. s. coarse
 water
 90+ Lt. Brn G. s. coarse
 water
 + u. hard + thorny.

78) 1200

78) Trout P. pm
 (cc) 8/1/11
 (cc) 8/1/11
 at Lepidoptera spp.
 w/ab 200. m. m. m.
 not full
 cc Sp. pet. open v. v.
 at Lepidoptera spp.
 w/ab 200. m. m. m.
 not full

81 0-2 2/3 aktrakom
2-8 1/2 aktrakom
8-14 1/2 aktrakom
14-20 1/2 aktrakom
20-28 1/2 aktrakom
28-34 1/2 aktrakom
34-40 1/2 aktrakom
40-46 1/2 aktrakom
46-52 1/2 aktrakom
52-58 1/2 aktrakom
58-64 1/2 aktrakom
64-70 1/2 aktrakom
70-76 1/2 aktrakom
76-82 1/2 aktrakom
82-88 1/2 aktrakom
88-94 1/2 aktrakom
94-100 1/2 aktrakom

80 800 8pm 8
BREAK

80 The Gull
ab Jack fruit Tamen pely
mds Kniff sand. End mow
acc Tel och Cough from
Thom 8 Cough belated
Wanted a...
Lagen. Hufjeller

Break K Line 0
1100
BREAK
1000

82 2-8 1/2 aktrakom
8-14 1/2 aktrakom
14-20 1/2 aktrakom
20-28 1/2 aktrakom
28-34 1/2 aktrakom
34-40 1/2 aktrakom
40-46 1/2 aktrakom
46-52 1/2 aktrakom
52-58 1/2 aktrakom
58-64 1/2 aktrakom
64-70 1/2 aktrakom
70-76 1/2 aktrakom

82 900
30/30

82 Tugst Malli
ab Jack fruit Cough from
mds Comdyl/brom Tamen pely
acc 1/2 aktrakom
flavor. the example

83 2-8 1/2 aktrakom
8-14 1/2 aktrakom
14-20 1/2 aktrakom
20-28 1/2 aktrakom
28-34 1/2 aktrakom
34-40 1/2 aktrakom
40-46 1/2 aktrakom
46-52 1/2 aktrakom
52-58 1/2 aktrakom
58-64 1/2 aktrakom
64-70 1/2 aktrakom
70-76 1/2 aktrakom
76-82 1/2 aktrakom

83 600
30/30

83 P. pen v tan
ab Jack fruit Tamen pely
mds Comdyl/brom Tamen pely
acc 1/2 aktrakom
flavor. the example

84 2-8 1/2 aktrakom
8-14 1/2 aktrakom
14-20 1/2 aktrakom
20-28 1/2 aktrakom
28-34 1/2 aktrakom
34-40 1/2 aktrakom
40-46 1/2 aktrakom
46-52 1/2 aktrakom
52-58 1/2 aktrakom
58-64 1/2 aktrakom
64-70 1/2 aktrakom
70-76 1/2 aktrakom

84 300

84 Tugst Malli
P. pen v tan
ab Jack fruit Tamen pely
mds Comdyl/brom Tamen pely
acc 1/2 aktrakom

2-3 Sh. calc. s. on
 8-13 Sh. calc. s.
 16-20 Y. calc. s.
 27-32 Sh. calc. s.
 32-52 Sh. calc. s.
 44" coarse
 do coarse
 52-70 L. calc. s. coarse
 70+ test

900
 30/30

83 T. calc. s. on
 (P) P. calc. s. on
 (R) R. calc. s. on
 sh. calc. s. on
 not Com. s. on
 see also see
 (P) P. calc. s. on
 (R) R. calc. s. on
 sh. calc. s. on
 not Com. s. on
 see also see

8-13 Sh. calc. s. on
 15-20 Y. calc. s.
 22-30 Y. calc. s.
 30-39 L. calc. s.
 38-48 DKG Y. s.
 46-52 L. calc. s.
 52-60 L. calc. s.
 72 do v. calc. s.
 72-76 L. calc. s.
 78+ water sample

600
 60/50

81 P. calc. s. on
 (P) P. calc. s. on
 (R) R. calc. s. on
 sh. calc. s. on
 not Com. s. on
 see also see
 (P) P. calc. s. on
 (R) R. calc. s. on
 sh. calc. s. on
 not Com. s. on
 see also see

8-13 Sh. calc. s. on
 10-17 B. calc. s.
 17-20 Y. calc. s.
 20-26 L. calc. s.
 26-32 DKG Y. s.
 32-38 L. calc. s.
 38-44 L. calc. s.
 44-50 Sh. calc. s.
 60-68+ L. calc. s.
 68+ water sample

300
 50/50

81 T. calc. s. on
 (P) P. calc. s. on
 (R) R. calc. s. on
 sh. calc. s. on
 not Com. s. on
 see also see
 (P) P. calc. s. on
 (R) R. calc. s. on
 sh. calc. s. on
 not Com. s. on
 see also see

80 0-5 Sh. calc. s. on
 5-20 Sh. calc. s.
 20-38 Y. calc. s.
 38-60 L. calc. s.
 60-70 L. calc. s.
 70-74 L. calc. s.
 74-80 L. calc. s.
 78+ water sample

1000
 400
 500
 50/50

80 T. calc. s. on
 (P) P. calc. s. on
 (R) R. calc. s. on
 sh. calc. s. on
 not Com. s. on
 see also see
 (P) P. calc. s. on
 (R) R. calc. s. on
 sh. calc. s. on
 not Com. s. on
 see also see

500 E. of
 B. L. of
 1/2 mi. E. of
 1/2 mi. E. of
 1/2 mi. E. of



- (24) 0-3 L. B. H. G. s.
- 3-14 L. B. H. G. s. (Bot 1)
- 14-24 L. B. H. G. s. (Bot 2)
- 24-40 L. B. H. G. s.
- 40-48 L. B. H. G. s.
- 48-52 L. B. H. G. s.
- 52-60 Med Y s.
- 60-62 do
- 62-70 L. B. H. G. s.
- 70-78 L. B. H. G. s.
- 78-80 L. B. H. G. s.

(29) 10
300

- (27) Turst Mesa P. F.
- (a) Myflex B. Cotton
- ab Salt pine Sedges
- mat Borrerio
- occ Samp fields Eucalyptus
- Comp tom of cactus
- 1st Myflex s. s. per Thom.
- 2nd Myflex s. s. per Thom.
- 3rd Myflex s. s. per Thom.



- (25) 0-1 L. B. H. G. s.
- 1-7 L. B. H. G. s.
- 7-13 L. B. H. G. s.
- 13-20 L. B. H. G. s.
- 20-27 L. B. H. G. s.
- 27-32 L. B. H. G. s.
- 32-40 L. B. H. G. s.
- 40-48 L. B. H. G. s.
- 48-52 L. B. H. G. s.
- 52-60 L. B. H. G. s.
- 60-70 L. B. H. G. s.
- 70-78 L. B. H. G. s.
- 78-80 L. B. H. G. s.

- (28) Turst P. F.
- (a) B. Cotton Myflex
- (ab) Salt pine B.L. grasses
- (mat) Sedges
- (oc) Thom of Borrerio, Samp
- fields of Eucalyptus
- Med Myflex s. s. per Thom.
- 1st Myflex s. s. per Thom.
- 2nd Myflex s. s. per Thom.
- 3rd Myflex s. s. per Thom.

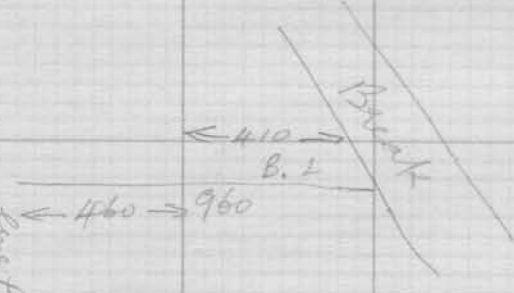

- (26) 0-8 L. B. H. G. s.
- 8-12 L. B. H. G. s.
- 12-18 L. B. H. G. s.
- 18-24 L. B. H. G. s.
- 24-32 L. B. H. G. s.
- 32-46 L. B. H. G. s.
- 46-52 L. B. H. G. s.
- 52-60 L. B. H. G. s.
- 60-70 L. B. H. G. s.
- 70-78 L. B. H. G. s.
- 78-80 L. B. H. G. s.

(29) 900

- (27) Turst P. F.
- (a) B. Cotton
- ab Sedges
- mat Thom s. s. per Thom.
- occ Samp fields Eucalyptus
- Med Myflex s. s. per Thom.
- 1st Myflex s. s. per Thom.
- 2nd Myflex s. s. per Thom.
- 3rd Myflex s. s. per Thom.

- (24) 0-6 L. B. H. G. s.
- 6-12 L. B. H. G. s.
- 12-18 L. B. H. G. s.
- 18-24 L. B. H. G. s.
- 24-32 L. B. H. G. s.
- 32-40 L. B. H. G. s.
- 40-52 L. B. H. G. s.
- 52-60 L. B. H. G. s.
- 60-70 L. B. H. G. s.
- 70-78 L. B. H. G. s.
- 78-80 L. B. H. G. s.

(29) 900

- (27) Turst P. F.
- ab Sedges
- mat Salt pine
- occ Nabea foetida
- Comp s. s. per Thom.
- 1st Myflex s. s. per Thom.
- 2nd Myflex s. s. per Thom.
- 3rd Myflex s. s. per Thom.



← 410 →
B.L.

← 460 → 960

Bank

- ① 0-8 L.P. Ben. 4/9 s
- 8-12 3/4 Ben G. s
- 12-24 Ben G. s
- 24-38 1/2 Ben G. s
- 38-46 1/2 Ben G. s
- 46-52 1/2 Ben G. s
- 52-60 1/2 Ben G. s
- 60-70 1/2 Ben G. s

1/2 Ben

lots lot.

② 900

③ Trest P. pr G

ab Sedges
not 1 m. juv.
ab Long Petiole
Aster

70 + 1/2 Ben

- ④ 0-6 1/2 Ben G. s
- 6-20 1/2 Ben G. s
- 20-24 1/2 Ben G. s
- 24-32 1/2 Ben G. s
- 32-40 1/2 Ben G. s
- 40-52 1/2 Ben G. s
- 52-60 1/2 Ben G. s
- 60-70 1/2 Ben G. s

⑤ 300

⑥ Trest P. pr P

ab Sedges
not 1 m. juv.
ab Halca foeniculata
Eragrostis
Sida
Callitriche
Sedum



- ⑦ 0-8 1/2 Ben G. s
- 8-18 1/2 Ben G. s
- 18-30 1/2 Ben G. s
- 30-36 1/2 Ben G. s
- 36-44 1/2 Ben G. s
- 44-52 1/2 Ben G. s
- 52-66 1/2 Ben G. s
- 66-72 1/2 Ben G. s
- 72-74 1/2 Ben G. s
- 74 + 1/2 Ben

⑧ 300

⑨ Trest P. pr P

ab Sedges
not 1 m. juv.
ab Trest
ab Sedges
ab Sedges
ab Sedges
ab Sedges
ab Sedges



11

250 to NW corner 356

1870

1800

1500

1200

900

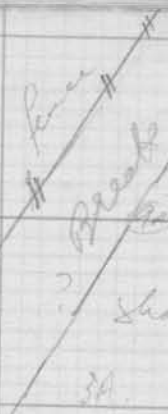

(91) 0-4 1/2 Brn Hk 4
 4-10 Grays
 10-18 1/2 Brn G. s
 18-26 Brn Hk 5
 26-35 Brn G. water
 35+ L&S mifer

(92) 0-10 3/4 Brn G/3/4 G s
 10-18 1/2 Brn G s
 18-20 1/2 Brn G s
 20-22 Brn G/1/2 Brn
 22-27 1/2 Brn 1/2 Brn
 27-42 1/2 Brn 1/2 Brn
 42-48 Brn 1/2 s
 48-54 1/2 Brn 1/2 s
 54-58 GY s water
 58-66 1/2 Brn 1/2 s coarse
 66- 1/2 Brn 1/2 s
 72+ water mifer

(92) 0-2 1/2 Brn Hk 5
 2-14 1/2 Brn G s
 14-22 1/2 Brn Hk (Red 4)
 22-27 1/2 Brn
 27-36 1/2 Brn 1/2 Brn
 36-53 1/2 Brn
 53-60 1/2 Brn
 60-66 GY coarse
 66-70 1/2 Brn 1/2 s coarse
 70- 1/2 Brn 1/2 s coarse
 76+ water mifer

66-70 GY s coarse
 70- 1/2 Brn 1/2 s coarse
 76+ water mifer

Shallow
 3A

5B

6A1
 almost
 coffee Rk Brn

(91) Trest P. p. 2 P.
 (C) Ag. fls. Phos
 ob 1st fine Sedgs
 mib 1000 Lumph. Exad wood
 ob 1/2 s amply Lumph
 brown, coarse, leaf
 damp, thick, thin
 Ac. leaf, Ac. leaf
 Hard comp. Goran mella
 Steel, Kahana, beam
 Exad wood, L&S mifer
 Hor. drags, L&S
 Gumph. beam

(92) Trest P. p. 2 P.
 (C) Ag. fls. Phos
 (B) B. quad B. Cotton
 ob 1st fine Sedgs
 mib

ob 1st fine Sedgs
 mib
 Gumph. beam, L&S mifer
 Exad wood, L&S mifer
 Calad. flav.

Trest P. p. 2 P.
 (C) B. Cotton Ag. fls. L. p.
 (B) mib
 ob 1st fine
 mib Sedgs, L&S mifer
 water, L&S mifer
 mib + mifer

ob 1st fine Sedgs
 mib
 L&S mifer, Exad wood
 Spic. L&S mifer, L&S mifer
 L&S mifer, L&S mifer
 L&S mifer, L&S mifer
 L&S mifer, L&S mifer

Main
 Break

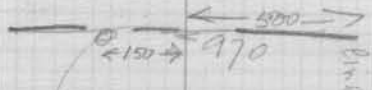

(91) 0-4 1/2 Brn Hk 5
 4-10 1/2 Brn G s
 10-18 1/2 Brn G s
 18-22 1/2 Brn G s
 20-30 1/2 Brn G s (Bot 2)
 30-36 1/2 Brn (Bot 2)
 36-42 1/2 Brn 1/2 Brn
 42-48 1/2 Brn 1/2 Brn
 48- 1/2 Brn 1/2 Brn

1936
 hole
 No. 76
 6A1

(91) 20 before

42-48 B.V.S.
 48-52 G.Y.S. water
 52-56 G.Y.S. coarse
 56-60 G.Y.S.
 72+ water upper

50.

6-25
 as sample taken. Noted for
 sample taken. Collected
 large caliche. Considerable
 ground from the channel
 Colad flow

(92) 0-2 1/2 Br. dk. brown
 2-14 G.Y.S.
 14-22 1/2 Br. dk. brown
 22-24 1/2 Br. dk. brown
 24-36 1/2 Br. dk. brown
 36-52 1/2 Br. dk. brown
 52-60 G.Y.S.
 60-70 G.Y.S. coarse

6A1 (92) 1200
 almost
 coffee R. Br

Quartz
 (loc. 5, Colad flow p.p.)
 (R) 1/2
 as 1st fine
 sub Sedgs low P
 water surface
 much - mm

66-70 G.Y.S. coarse
 70-74 1/2 Br. dk. brown
 74-78 1/2 Br. dk. brown

6-25
 The same as before. Found
 some small blue sand
 some talc
 High caliche in coarse
 chafeta upper

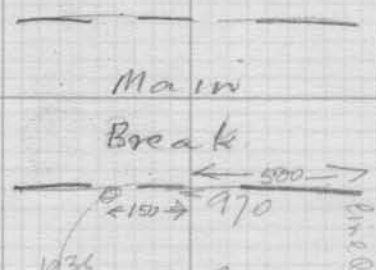

(91) 0-4 1/2 Br. dk. brown
 4-10 G.Y.S.
 10-18 G.Y.S.
 18-22 1/2 Br. dk. brown
 22-30 1/2 Br. dk. brown
 30-36 1/2 Br. dk. brown
 36-42 1/2 Br. dk. brown
 42-48 1/2 Br. dk. brown
 48-52 1/2 Br. dk. brown
 52-60 dk + coffee Br = DK Br. Y.
 60-66 G.Y.S. coarse
 66-70 1/2 Br. dk. brown
 70-74 1/2 Br. dk. brown
 74-78 1/2 Br. dk. brown
 78+ water upper

6A1 (91) 900
 as before

(91) as before

(90) 0-3 1/2 Br. dk. brown
 3-8 1/2 Br. dk. brown
 8-12 1/2 Br. dk. brown
 12-16 1/2 Br. dk. brown
 16-22 1/2 Br. dk. brown
 22-34 1/2 Br. dk. brown
 34-50 G.Y.S.
 50-70 G.Y.S. coarse
 70-74 1/2 Br. dk. brown
 74-78 1/2 Br. dk. brown
 78+ 1st upper

(90) 600
 6A1

(90) 1/2 Br. dk. brown
 (a) 1/2 Br. dk. brown - to better
 (ab) 1st fine Sedgs
 (ab) T.S. 1/2
 (ac) from 1/2 Br. dk. brown
 the same as before. Collected
 some G.Y.S. coarse
 some 1/2 Br. dk. brown
 some 1/2 Br. dk. brown

$\frac{12500}{1600}$
 Main Break
 $\frac{500}{}$

97 0-9 G/L 5 am
 9-20 G/L 5 am
 20-27 C. Pan 5
 27-36 L. Pan 5
 34-36 L. Pan 5
 36-46 vit G/L 5
 46-48 L. Pan 5
 48-54 G/L 5 water
 54-60 L. Pan 5
 60-72 L. Pan 5
 72+ water up from

SA
 125

97 1200

97 Toast 1.0 sp Pan
 (a) By 1/2
 (b) B/a Pan? or C/L
 ab edges
 with ink face low P?
 ac none on the paper
 Gough low C/L
 B/L... B/L...
 up R. Pet...
 S...
 Damp...

98 0-3 G/Med 5 am
 3-14 Med G/L 5
 14-18 R/L 5
 18-24 L. Pan 5
 24-27 L. Pan 5
 27-36 B/L 5
 36-38 L. Pan 5
 38+ water up

HA
 Coffee Pan

98 900

98 Toast
 (a) By 1/2
 (b) L. Pan 5
 with low P?
 ac Gough low C/L
 B/L...
 R. Pan 5
 S...
 Damp...

99 0-8 G/L 5 am
 8-11 B/L 5
 11-23 B/L 5
 23-36 B/L 5
 36-46 B/L 5
 46-54 B/L 5
 54-60 G/L 5
 60-70 G/L 5
 70+ water up

see 92
 coffee Pan
 SA/SB

99 600

99 Toast 5.0 M. Pan 5
 (a) By 1/2
 (b) B/L
 ab L. Pan 5
 with R. Pan 5
 ac none on the paper
 Gough low C/L
 B/L...
 R. Pan 5
 S...
 Damp...

change in no. 92

96 0-3 G/L 5 am

96 500

96 Toast 5.0 M. Pan 5

(94) 0-3 G/Med. G. com
3-14 Med G. / LK 1/2
14-18 R.G. / LK 1/2 G.C. S
18-24 LK 1/2 G.C. S
24-27 LK 1/2 G.C. S
27-36 Ben / DKB 1/2 G.C. S
36-38 LK 1/2 G.C. S
38+ water ripen

HA

Coffee Pan

(95) 900

(98) Tract
C. P. P. P. P.
P. P. P. P. P.

(26) Lepidopt Larkspur

not born P. ?

see Camp four Camp five
Camp six
Camp seven
Camp eight
Camp nine
Camp ten
Camp eleven
Camp twelve
Camp thirteen
Camp fourteen
Camp fifteen
Camp sixteen
Camp seventeen
Camp eighteen
Camp nineteen
Camp twenty

(97) 0-2 C. G. com
2-16 Ben G.
16-23 Ben G. med G. S
23-34 Ben G. / DKB 1/2 G.C. S
34-46 Ben G. (water)
46-52 W. Ben / M. G.
52-54 LK 1/2 G.C. S
54-60 G. LK 1/2 G.C. S
60-70 LK 1/2 G.C. S
70+ water ripen

see 92
coffee Pan

W.P. / S.B.

(97) 600

(97) Tract see "M" P.P. off
C. P. P. P. P.
P. P. P. P. P.

at Lepidopt off.

not Ac alata born P. ?
Larkspur

see Camp four Camp five
Camp six
Camp seven
Camp eight
Camp nine
Camp ten
Camp eleven
Camp twelve
Camp thirteen
Camp fourteen
Camp fifteen
Camp sixteen
Camp seventeen
Camp eighteen
Camp nineteen
Camp twenty

(96) 0-3 W. Ben dk G. com
3-8 B.G.
8-14 Y. Med G.
14-23 H. P. Ben G.
23-27 Y. Ben Med G. S.
27-34 Ben Med G. / DKB 1/2 G.C. S
34+ LK 1/2 G.C. S

change in veg?

HA

(96) 500

(96) Tract see Camp G
C. P. P. P. P.
P. P. P. P. P.
(C) Med. P. (see "M. G. S.")

at Lepidopt off. H. G. com.

not Ac pulch.
V. unicolora den?

see Camp four Camp five
Camp six
Camp seven
Camp eight
Camp nine
Camp ten
Camp eleven
Camp twelve
Camp thirteen
Camp fourteen
Camp fifteen
Camp sixteen
Camp seventeen
Camp eighteen
Camp nineteen
Camp twenty

(95) 0-2 B. Ben dk G. com
2-5 B.G. / H. G. S.
5-13 B.G. / H. G. S.
13-18 B. LK 1/2 G.C. S.
18-24 B. LK 1/2 G.C. S.
24-27 B. LK 1/2 G.C. S.
27-34 B. LK 1/2 G.C. S.
34-46 B. LK 1/2 G.C. S.
46-52 B. LK 1/2 G.C. S.
52-54 B. LK 1/2 G.C. S.
54-60 B. LK 1/2 G.C. S.
60-70 B. LK 1/2 G.C. S.
70+ water ripen

HA

(95) 00

(95) Tract FC. Prod G.
C. P. P. P. P.
P. P. P. P. P.
(C) Med. P. P.

at edges

not V. unicolora den?
H. G. com.

see Camp four Camp five
Camp six
Camp seven
Camp eight
Camp nine
Camp ten
Camp eleven
Camp twelve
Camp thirteen
Camp fourteen
Camp fifteen
Camp sixteen
Camp seventeen
Camp eighteen
Camp nineteen
Camp twenty



0-3 L. ...
 3-7 ...
 9-14 ...
 16-30 ...
 36-46 ...
 46-60 ...
 60-70 ...
 70-74 ...



(103) ...
 at ...
 sub ...
 or ...
 (R) ...

(100) 0-4 ...
 4-30 ...
 30-30 ...
 30-38 ...
 38-60 ...
 60-70 ...
 10-76 ...
 76-78 ...
 X. see below
 W. corner of 36e



(102) ...
 at ...
 sub ...
 or ...
 (101) ...
 at ...
 sub ...
 or ...
 (100) ...
 at ...
 sub ...
 or ...

(101) 0-2 ...
 2-5 ...
 5-16 ...
 16-24 ...
 24-35 ...
 36-44 ...
 44-50 ...
 50-70 ...
 70-76 ...
 76- ...
 76- ...



(100) ...
 at ...
 sub ...
 or ...
 (102) ...
 at ...
 sub ...
 or ...
 (100) ...
 at ...
 sub ...
 or ...

(100) 0-2 ...
 2-5 ...
 5-11 ...
 11-20 ...
 20-30 ...
 30-36 ...
 36-38 ...
 38-46 ...
 46-60 ...
 60-70 ...
 70-76 ...
 76- ...

(104) 0-2 Sh. ...
 5-10 G. ...
 10-30 Sh. ...
 35-60 ...
 60-66 ...
 66- ...
 66+ ...

(104) 1200

(107) as before.



(104) 0-5 ...
 5-10 ...
 10-15 ...
 15-25 ...
 25-75+ ...
 like last

(104) 800

(106) P. ...
 ...
 ...
 ...

...
 ...
 ...
 ...

(104) 0-3 ...
 3-10 ...
 10-20 ...
 20-50 ...
 50-60 ...
 60-70 ...
 70-80 ...
 80-100 ...
 100-110 ...
 water

(105) 400

(105) P. ...
 ...
 ...

...
 ...
 ...

Cpt 36a

(104) 0-4 ...
 4-10 ...
 10-20 ...
 20-60 ...
 60-66 ...
 66-70 ...
 70-76+ ...

(104) 00

(104) P. ...

Break

...
 ...

...
 ...

...
 ...
 ...

main Road.

Matting Patch.
 (Cpt 36)

9/11/57

W. 200 ft. - Race 94 (1937) Cpt 35 1/2 + 150 SE (at 1000)

0-10 ...
 10-15 ...
 15-20 ...
 20-40 ...
 40- ...
 40-50 ...
 50- ...

102-114 + 100 med + 2000

K

1000
1000
1000
1000
1000

Cpt 36a

Tuark Ag. Rev.

(100) 0-4 8 dB 3 on
4-10 8 dB 1 on
10-20 10 Y 1 on
20-60 50 B 1 on
60-66 Y 1 on
66-70 Y 1 on
70-74 10 Y 1 on

(100) 00

(100) 1. pin good

Break

at 1000 yds
High 100

20.

side 1000 yds
1000 yds

on 1000 yds. 1000 yds

main Road.

Matting Paddock.
Cpt 36a

9/11/37

1000 yds
1000 yds
1000 yds
1000 yds
1000 yds

W. 200 N from Race 9/4/1937 Cpt 35a + 150 SE (at Low)

0-10 8 dB 1 on
10-12 10 Y 1 on
12-14 10 Y 1 on
14-20 10 Y 1 on
20-40 10 Y 1 on
40-42 10 Y 1 on
42-50 10 Y 1 on
50-52 10 Y 1 on
52-54 10 Y 1 on
54-56 10 Y 1 on
56-58 10 Y 1 on
58-60 10 Y 1 on

U 350 W along R.L. from NE side Cpt 36a 100 N.

0-5 8 dB 1 on
5-10 10 Y 1 on
10-14 10 Y 1 on
14-20 10 Y 1 on
20-30 10 Y 1 on
30-40 10 Y 1 on
40-42 10 Y 1 on
42-50 10 Y 1 on
50-52 10 Y 1 on
52-54 10 Y 1 on
54-56 10 Y 1 on
56-58 10 Y 1 on
58-60 10 Y 1 on

V. 150 W of NE corner Cpt 36c

0-5 8 dB 1 on
5-10 10 Y 1 on
10-14 10 Y 1 on
14-20 10 Y 1 on
20-30 10 Y 1 on
30-40 10 Y 1 on
40-42 10 Y 1 on
42-50 10 Y 1 on
50-52 10 Y 1 on
52-54 10 Y 1 on
54-56 10 Y 1 on
56-58 10 Y 1 on
58-60 10 Y 1 on

(181)
200

(112) 0-3 Wadk's on
3-12 1/2" P. 10 s
13-52 1/2" P. 10 s
53-65 Wadk's
66-74 1/2" med y s
do

1A

(112) 2000

(112) P. pin v good
Treats by floor
Rmy cabs slender

ab Tunicia prolif
w/ whole dairy

cc Pat occid 1/2" of
1/2" fine with 1/2" of
lost also some
from 5000 spm
Tunicia prolif P. 10 s

(114) 0-4 1/2" dk. s rom
4-15 1/2" dk. s
15-45 1/2" dk. s
46-57 1/2" med B
58-70 1/2" med y s
71-90 1/2" med y s
90+ do.

L
i
n
e
2

(114) 00

Break.

(114) Tunicia P. pin v good.
by floor
(50) m/s

ab Tunicia prolif
w/ 1/2" med y s
1/2" cabs

with whole dairy

cc 1/2" P. pin v good
Pat occid 1/2" fine
Bovs 2000 Thyraulid
cabs

Time 2
1/2" - 1/2" med B
1/2" - 1/2" med y s
1/2" - 1/2" med y s

← 400

|| || ||

1A.

|| || ||

Break
1350

← 400 →

L
i
n
e
A

(116) 00" 1/2" s

2B
1A.

(116) 1500

(116) P. pin v good
Treats by floor
acc m/s

ab Tunicia prolif
w/ 1/2" med y s
1/2" cabs
cc Pat occid 1/2" fine
Bovs 2000 Thyraulid
cabs

1/2" med y s
1/2" med y s
1/2" med y s

(108) 0-4 1/2" dk. s rom
4-12 1/2" med B s
12-30 1/2" med y s

1A

(108) 2800

(108) P. pin v good
as before + (35) m/s
(60) 1/2" med y s, P. cyanoph.
whole dairy

(108) 0-4 1/2" dk. s rom
4-12 1/2" med B s
12-30 1/2" med y s

(108) 4000

Break

(108) P. pin v good
Treats by floor
P. cyanoph.

Break 1350

← 400 →

B
P
E
A
R

(110) 60" lgw

(110) 1500

2B
1A

(110) P. pin wood.
Threat Hy flex.
23 May

at Tinnis prof
not present of 21 Feb same
see 1000
at Tinnis prof
see 1000
at Tinnis prof
see 1000

at Tinnis prof
see 1000
at Tinnis prof
see 1000

(109) 60" lgw

(109) 800

1A

(109) P. pin wood
as before + 13 May

(109) Not covered, Ac. cyanus
white sandy

(108) 0-4 Gakks + om

- 4-13 21/2 med B 5
- 14-20 21/2 med B 5
- 21-30 21/2 med B 5
- 31-40 21/2 med B 5
- 41-50 21/2 med B 5
- 51-60 21/2 med B 5
- 61-70 21/2 med B 5
- 71-80 21/2 med B 5
- 81-90 21/2 med B 5
- 91-100 21/2 med B 5
- 101-110 21/2 med B 5
- 111-120 21/2 med B 5
- 121-130 21/2 med B 5
- 131-140 21/2 med B 5
- 141-150 21/2 med B 5
- 151-160 21/2 med B 5
- 161-170 21/2 med B 5
- 171-180 21/2 med B 5
- 181-190 21/2 med B 5
- 191-200 21/2 med B 5

(108) 400
Break

1A

(108) P. pin wood.

Threat Hy flex. 23 Jan 2000

at Tinnis prof
winds

not Calandrinia of Stipagrostis

at Tinnis prof
see 1000
at Tinnis prof
see 1000
at Tinnis prof
see 1000

500 E of where Bl
Tide 1
End line

B.L. ← 500 →

B.L.
End line

1700

(120)

B
P
E
A
R



(116) all 1/2" dia. s. from
 11-16 1/2" dia. s. from
 16-80 1/2" dia. s. from
 80-96 1/2" dia. s. from
 100

(116) water
 1" dia. pipe

PIPE 5
 100' dia. break
 3/4" dia. pipe

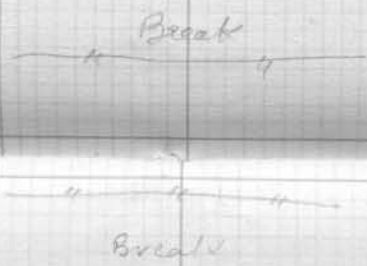

(115) 76+

1A.

(115)

650-870
 600
 1
 2
 3

(115)

Pipe 1" dia
 water like 111

(114) 0-4 1/2" dia. s. from
 4-11 1/2" dia. s. from

(114) 300

(114)

Tank 1" dia
 4/100

(116) 0-4 2nd class zone
 4-16 3rd class zone
 16-80 4th class zone
 80-96 5th class zone

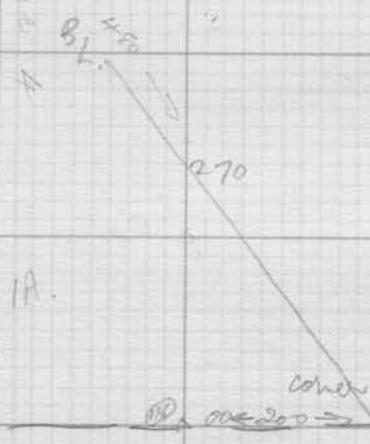

(116) water
 as before

100 ft of line 4
 along B.L.
 150 ft of line 5
 along B.L.

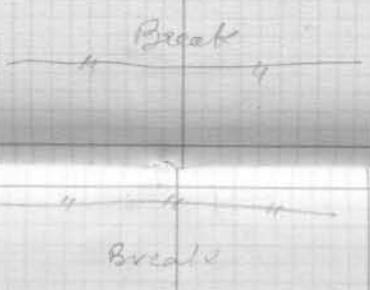

(115) 75+

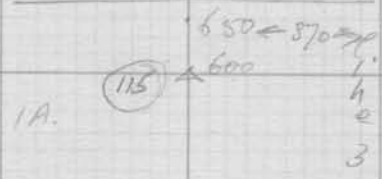

(115) Pipe road
 100 ft line III

(114) 0-4 1st class zone
 4-16 2nd class zone
 16-80 3rd class zone
 80-108 4th class zone

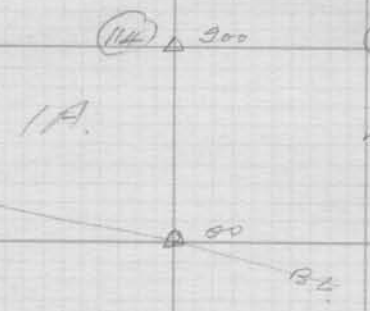

(114) 1st class zone
 2nd class zone
 3rd class zone
 4th class zone

100 ft of line 3
 along B.L.
 150 ft of line 4
 along B.L.

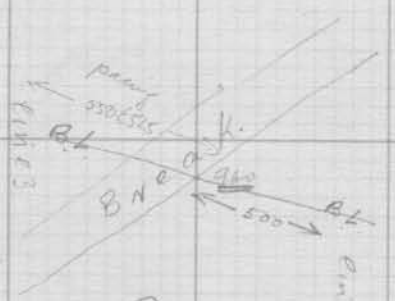

(113) 63-68
 1st class zone
 2nd class zone

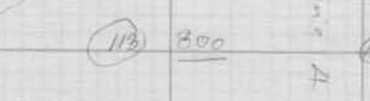

(113) 1st class zone
 2nd class zone
 3rd class zone

(31) 0-15 1st/2nd/3rd/4th/5th
 15-20 1st/2nd/3rd/4th/5th
 21-25 1st/2nd/3rd/4th/5th
 26-30 1st/2nd/3rd/4th/5th
 31-35 1st/2nd/3rd/4th/5th
 36-40 1st/2nd/3rd/4th/5th
 41-45 1st/2nd/3rd/4th/5th
 46-50 1st/2nd/3rd/4th/5th
 51-55 1st/2nd/3rd/4th/5th
 56-60 1st/2nd/3rd/4th/5th
 61-65 1st/2nd/3rd/4th/5th
 66-70 1st/2nd/3rd/4th/5th

(31) 800
 10 DBLY wilsons or parkets.

(31) P. pin. Fair
 T. I. M. 1st/2nd/3rd/4th/5th
 16 T. I. M. 1st/2nd/3rd/4th/5th
 open grassy
 with white daisy

open grassy site.

on 1st/2nd/3rd/4th/5th
 1st/2nd/3rd/4th/5th
 1st/2nd/3rd/4th/5th
 1st/2nd/3rd/4th/5th
 1st/2nd/3rd/4th/5th

(30) 0-10 1st/2nd/3rd/4th/5th
 11-20 1st/2nd/3rd/4th/5th
 21-30 1st/2nd/3rd/4th/5th
 31-40 1st/2nd/3rd/4th/5th
 41-50 1st/2nd/3rd/4th/5th
 51-60 1st/2nd/3rd/4th/5th
 61-70 1st/2nd/3rd/4th/5th
 71-80 1st/2nd/3rd/4th/5th
 81-90 1st/2nd/3rd/4th/5th
 91-100 1st/2nd/3rd/4th/5th

(30) 400

(30) P. pin. 1st/2nd/3rd/4th/5th
 T. I. M. 1st/2nd/3rd/4th/5th
 1st/2nd/3rd/4th/5th
 1st/2nd/3rd/4th/5th
 1st/2nd/3rd/4th/5th

on 1st/2nd/3rd/4th/5th
 1st/2nd/3rd/4th/5th
 1st/2nd/3rd/4th/5th
 1st/2nd/3rd/4th/5th
 1st/2nd/3rd/4th/5th

99+ do
 moisture increasing
 1st/2nd/3rd/4th/5th
 1st/2nd/3rd/4th/5th
 1st/2nd/3rd/4th/5th

Central 800 Way.



(34) 0-10 1st/2nd/3rd/4th/5th
 11-20 1st/2nd/3rd/4th/5th
 21-30 1st/2nd/3rd/4th/5th
 31-40 1st/2nd/3rd/4th/5th
 41-50 1st/2nd/3rd/4th/5th
 51-60 1st/2nd/3rd/4th/5th
 61-70 1st/2nd/3rd/4th/5th
 71-80 1st/2nd/3rd/4th/5th
 81-90 1st/2nd/3rd/4th/5th
 91-100 1st/2nd/3rd/4th/5th

(34) 1600

Ploughed area

(34) M. 1st/2nd/3rd/4th/5th
 1st/2nd/3rd/4th/5th
 1st/2nd/3rd/4th/5th
 1st/2nd/3rd/4th/5th

(35) 0-10 1st/2nd/3rd/4th/5th
 11-20 1st/2nd/3rd/4th/5th
 21-30 1st/2nd/3rd/4th/5th
 31-40 1st/2nd/3rd/4th/5th
 41-50 1st/2nd/3rd/4th/5th
 51-60 1st/2nd/3rd/4th/5th
 61-70 1st/2nd/3rd/4th/5th
 71-80 1st/2nd/3rd/4th/5th
 81-90 1st/2nd/3rd/4th/5th
 91-100 1st/2nd/3rd/4th/5th

(35) 1200

flat bottom

(35) 1st/2nd/3rd/4th/5th
 1st/2nd/3rd/4th/5th
 1st/2nd/3rd/4th/5th
 1st/2nd/3rd/4th/5th
 1st/2nd/3rd/4th/5th

(34) 0-10 H.G.
10-14 H.H.G.
16' water
16' 1st. heavy soil
38' + Ngr water refer.

(39) Δ 2400
Ploughed area
Tr 229/0 c k

(39) Ploughed area
oc² Eridias
ab grass
oc² Amgoy viridis
Lepidopt.

(38) 0-3 2nd Ben
3-30 2nd med Ben
30-42 2nd H.G.
42-66 do 1/2 fine gr
66- 1/2 H.G. (placuit)
min. elements
78+ de moist.
W. 07-10+

(38) Δ 2000
Edge planting.

(38) P. pin 1/2 F
Lepidopt. 1/2
ab Briza max 2nd. div
net Sipa 2nd. whit. daisy
oc² Ngr prod. 2nd hyp.
Lepidopt.

(37) 0-2 1st H.G. 5 rows
2-38 2nd med Ben 5
38-70 2nd H.G.
70-100 de ground.
min. elements.
H.G.
96-100
100- 1/2 H.G. coarse
114+ do water

(37) Δ 1600

(37) P. pin 1/2 (1st H.G.)
Lepidopt. 1/2
ab Trimen 1st. Briza max
2nd. div
net Whit daisy
oc² P. pin 1/2. Briza 1st. from P.
Sipa 2nd. 2nd. Briza
Lepidopt. 1st. Briza

(36) 0-3 1st H.G. 5 rows
3-27 1st H.G. (1st. H.G. Prod) 5
27-60 2nd H.G. 5
60+ like 35.

(36) Δ 1300
Centre Way.

(36) P. pin 1/2
Lepidopt. 1/2
ab Briza max 1st. Trimen 1st.
Lepidopt. 1st. Briza
net Whit daisy
oc² P. pin 1/2. Briza 1st. Briza
Lepidopt. 1st. Briza

1st. Briza 1st. Briza 1st. Briza
Lepidopt. 1st. Briza
net Whit daisy

(35) 0-2 1st H.G. 5 rows
2-27 1st H.G. 5
27-38 2nd med Ben c
38-60 2nd H.G. 5
60+ 1/2 same elements
do

(35) Δ 800

(35) P. pin 1/2 1st H.G. 5 rows
Lepidopt. 1/2
ab Briza max 1st. Trimen 1st.
Lepidopt. 1st. Briza
net Whit daisy
oc² P. pin 1/2. Briza 1st. Briza
Lepidopt. 1st. Briza
net Whit daisy
oc² P. pin 1/2. Briza 1st. Briza
Lepidopt. 1st. Briza
net Whit daisy

(34) 0-2 1st H.G. 5 rows

(34) Δ 400

(34) P. pin 1/2 1st H.G. 5 rows

0-2 1/2 H. B. L. s. on
 3-38 2 1/2 med. B. s.
 38-70 2 1/2 B. s.
 70-100 do. greenish
 med. B. s.
 1/2 1/2
 96-100 do.
 100-114 C. dry coarse
 water
 114+ do

37 1600

37 P. pin. Fair (1st Plate)
 100 ft. by Bottom ground
 ab. Tanna protif. B. s. max
 Sec. div. + grasses
 not Whit. decay
 occ. P. s. B. s. from P.
 P. s. B. s. B. s. B. s.
 Lepidopt. Kinn prot.

38 0-3 1/2 B. L. s. on
 3-57 1/2 (dry, Prot.) s.
 57-60 2 1/2 B. s.
 60+ like 35.

36 1300

1140
Centro Way.

36 P. pin. Fair but patchy lake
 1 M. T. cor. B. s. B. s. B. s.
 ab. Sec. div. Tanna protif.
 B. s. max Hypo. radia
 not
 occ. P. s. B. s. B. s. B. s.
 Herb. hyp. B. s. B. s.

low P. s. B. s. B. s. B. s.
 white two spec.
 white decay

35 0-2 2 1/2 s. on
 2-24 2 1/2 B. s.
 24-38 2 1/2 med. B. s.
 38-60 2 1/2 B. s.
 60-84 Y same distance
 do.

35 200

35 P. pin. Fair 1 M. B. s.
 20 M. T. B. s. B. s.
 ab. B. s. max Tanna
 protif. Hyp. rad. ab.
 not B. s. B. s. Whit. decay
 occ. Lepidopt. B. s. B. s.
 B. s. B. s. B. s. B. s.
 B. s. B. s. B. s. B. s.
 B. s. B. s. B. s. B. s.
 B. s. B. s. B. s. B. s.

34 0-5 1/2 B. s. on
 5-30 2 1/2 B. s.
 30-7 2 1/2 B. s.
 7+ do.

34 400

34 P. pin. Good
 1 M. T. B. s. B. s.
 ab. B. s. max Tanna protif.
 Hyp. rad.
 not
 occ. low P. s. wild Yam
 G. Chaney. B. s. B. s.
 Tanna protif. B. s. B. s.

33 as before.
 650+

33 100

Break.

33 P. pin. Fair
 Veg. as before

400 S of Line D
 along base
 of 9.12
 1/2

32 0-4 1/2 B. s. on
 4-12 2 1/2 B. s.
 12-30 2 1/2 med. B. s.
 30-36 2 1/2 med. B. s.
 36-60 do. B. s.
 60- B. s. s. greenish E

32 1300

430

32 P. pin. Fair
 1 M. T. B. s. B. s.
 ab. Tanna protif. Hyp. rad.
 not
 occ. B. s. B. s.

Break.

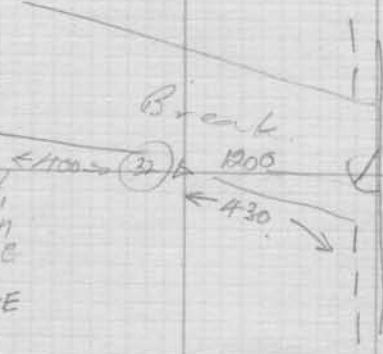

(42) 0-5 Cat B + on
 8-24 SK med Ben s
 24-30 do / SK BLY / but
 pedunc.
 60-66 SK Y / SK Ben with
 for huge
 66-74 Ben s med Y s
 1st measurement
 complete

(42) 20 2000

(46) T. near N. J. for
 P. juv. good
 ab. *Tumca plicif. Briz. max.*
 var. *4. sp. 2nd.*
 not
 ac. *Lepidoptera* *larvae*
Thysanotus *sp.*
4. sp. 2nd. *4. sp. 2nd.*
Thysanotus *sp.*

(44) 0-8 Hb. off Ben
 8-15 Hb. Ben
 15-27 SK med Ben s
 27-36 SK B. 4. Y.
 66-78+ Hb. Ben 1st
 do

(44) 1600

(44) T. near N. J. for
 P. juv. 2. good
 ab. *Tumca plicif. Briz. max.*
 not white daisy
 ac. *Boss* *sp.* *off. 2nd.*
Gomph. form. *hard* *comp.*
near *1st* *2nd* *3rd* *4th*
Letitia *larvae*

like last.

(43) 0-5 Hb. off Ben s on
 5-10 Hb. Ben s
 10-20 SK med Ben s
 24-30 do / SK BLY s
 36-46 Hb. med Y s
 46-114+ do / LBLY s

(43) 1200
 400
 Centre
 1140
 LINE E

(43) P. juv. fair but probably
 T. 2. M.
 ab. *Tumca plicif. Briz. max.*
 not *Skp. Scumbark.*
 ac. *4. sp. 2nd.* *Gomph. form.*
near *1st* *2nd* *3rd* *4th*
near *1st* *2nd* *3rd* *4th*
near *1st* *2nd* *3rd* *4th*
near *1st* *2nd* *3rd* *4th*
near *1st* *2nd* *3rd* *4th*

(42) 0-8 Cat B s + on
 8-27 SK med Ben
 27-40 do / SK BLY Y
 more
 40- SK Ben 1st
 some daisy
 78+ do

(42) 800

open
 hole

(42) P. juv. fair
 T. 2. M. *off. 2nd.*
 ab. *Tumca plicif. Briz. max.*
 not *Thysanotus* *sp.* *probably*
 = *Thysanotus* *sp.*
 ac. *Boss* *sp.* *off. 2nd.*
Gomph. form. *hard* *comp.*
near *1st* *2nd* *3rd* *4th*
near *1st* *2nd* *3rd* *4th*
near *1st* *2nd* *3rd* *4th*
near *1st* *2nd* *3rd* *4th*

(41) 0-10 Cat B s + on
 10-22 SK med Ben s
 22-37 do / SK BLY s
 37-57 Hb. med Y s
 78+ do

(41) 400

last line on flat

(41) T. near N. J. for
 P. juv. v. good
 ab. *Tumca plicif. Briz. max.*
 not *Thysanotus* *sp.*
 ac. *Boss* *sp.* *off. 2nd.*
Gomph. form. *hard* *comp.*
near *1st* *2nd* *3rd* *4th*
near *1st* *2nd* *3rd* *4th*
near *1st* *2nd* *3rd* *4th*
near *1st* *2nd* *3rd* *4th*

Line E
 from 22 to 37
 by 27 to 37

← 27 → 00

1954 July 10-14
 from H. G. ...
 ...
 Engasium ...

22) 9-5 L. ...
 2-27 ...
 27-40 ...
 40- ...
 78+ do

800

open hole

23) P. ...
 ...
 ...
 ...

24) 0-10 ...
 10-22 ...
 22-37 ...
 37- ...
 78+ do

400

east line on flat

25) J. M. ...
 ...
 ...

Line F
 1/2 mi. S of ...
 ...

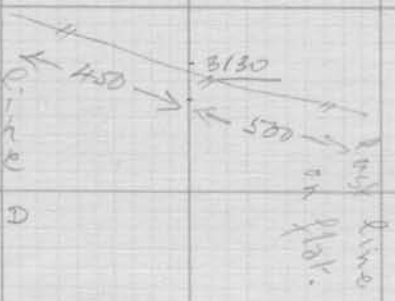

26) 0-10 ...
 10-17 ...
 17-40 ...
 40-60 ...
 60+ do

2200

Roughed area

27) J. M. T.
 ...
 ...

Break 211
1150

(50) 0-4 Bm s
11-26 Lb Bm s
28-34 DK Y Lb Bm
34-76 Bm Y/Gdk Y s
multicolored
76+ 4 DK Y 3 some
faint marks

(50) 200

(50) T.M. B. grandis Ag flex

ob Tunicata poly. Bm s
Hyp rad. Tunicat

web

oc Gynerium Lycopodium?
White grass
Gymnoph. fern
Spha. sp.
Hel. ciliata

(49) 0-2 Lt Br G. s + 82w
3-34 DK Y Lb Bm s
34-60 DK Bm Y
60-78 Lb Bm Y
78- Y/Lb DK Y s
100+ do.

(49) 400

(49) P. pin. var.
T.M. Ag. flex.

ob Tunicata poly. Bm s
Hyp rad. of other forms. ob

web Thysanotus alatus

oc Lepidopt. Lycopodium?
Barkley Bm s
Hel. radium

2100 H
Near West of Center
along N bank of
Brook 271

Center Way 502 CARP

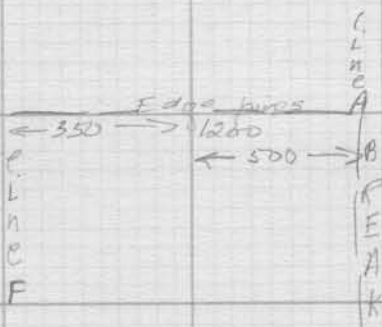

(48) 0-1 G. red Bm s
1-10 DK Y Lb Bm s
10-36 Bm Bm Y s
36-56 dk/Bm Y. s
52-66 Y s. some
66-78+ Y some
multicolored

(48) 300

(48) P. pin. var. LM
(or) B. grandis, altam.

ob Sav. det. Lepidopt
Bm s

web Nib. det. Gymnoph. fern
P. Lm. Bm s
Spha. scabra
Hel. (Hyp.) Cal. sp.
Nib. det. camel
Lepid. sp. (= Thysanotus?)
Tel. det. Barkley Bm s

(47) 0-4 Lb Bm s
4-8 Lb Bm s
8-52 Bm Y s
52-66 Y/Lb Bm s
66- 3 some
78 dk/multicolored
dk/multicolored

(47) 400

(47) P. pin. var. LM
(or) B. grandis altam sp. Ag

ob Sav. det. Bm s
Bm s. Hyp rad

web Spha. scabra. Lepidopt
Tel. det.

oc Bm s
Hel. det. Barkley Bm s

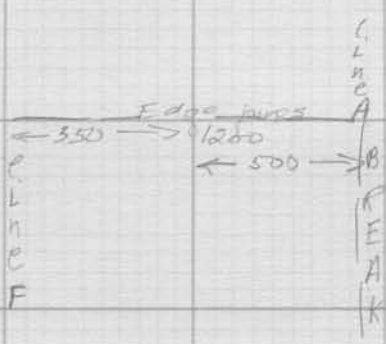

0-1 G. mag. blue 5 rom.
 1-10. SKY for blue 5
 10-36 DK blue LxY 5
 36-52 dk/ blue Y. 5
 52-66 Y 5 some blue white
 66-78 Y greenish purple "

46 400

P. pr. 400 1. M.
 (a) to garden, allam.
 ab. Dav. blue Lepidoptera
 Buzga mag.
 mag. Nib. blue. Gough. tom.
 10. blue. black. blue. sp.
 yellow. yellow. blue.
 white. (black?) Calce.
 black. blue. camel.
 10. sp. (= Thym. histid.?)
 Tet. out. black. blue.

0-4 1/2 blue
 4-8 1/2 blue
 8-22 1/2 blue
 22-66 1/2 blue / 1/2 blue
 66- 3 1/2 blue
 78 1/2 blue

47 400

P. pr. 400 1. M.
 (a) garden allam. sp. 1/2
 ab. Dav. blue. Gough. tom.
 Buzga mag. Nib. blue.
 mag. Nib. blue. Gough. tom.
 10. blue. black. blue. sp.
 yellow. yellow. blue.
 white. (black?) Calce.
 black. blue. camel.
 10. sp. (= Thym. histid.?)
 Tet. out. black. blue.



0-4 1/2 blue
 4-8 1/2 blue
 8-22 1/2 blue
 22-66 1/2 blue / 1/2 blue
 66-80 1/2 blue / 1/2 blue
 80-94 1/2 blue
 94 1/2 blue

48 400

P. pr. 400 1. M.
 (a) garden allam. sp. 1/2
 ab. Dav. blue. Gough. tom.
 Buzga mag. Nib. blue.
 mag. Nib. blue. Gough. tom.
 10. blue. black. blue. sp.
 yellow. yellow. blue.
 white. (black?) Calce.
 black. blue. camel.
 10. sp. (= Thym. histid.?)
 Tet. out. black. blue.

114+ do.
 130 N. of 1/2 blue
 140 S. of 1/2 blue
 150 S. of 1/2 blue
 160 S. of 1/2 blue

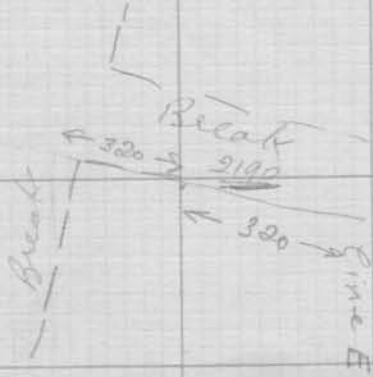

Deep Hole "C"

Cpt A1C in N.E. corner see hole N^o 47 of 1937 survey.

0-2"	DKG / DKG s + O.M.	Bag H
2-7"	DKG	Low 6
7-12"	G / (B G?) s.	6A. ?
12-18"	Bm G s.	9A sent Perth Nov 37 column 5.
18-23"	Bm Lt G s.	13
23-26"	Bm med G s.	89
26-30"	Lt Y Bm / Bm med Y s	Low 5
30-42"	Bm Y (con' have org.) s.	90 (or 99?)
42-53"	Lt Bm Y / Bm Y s. con' G Y mottle.	18 ?
53-60"	Bm Y / DK Bm Y s. Mgr.	19 ?
60-72"	Bm med Y	large Horiz. part. impen.
72-78"	Bm med G. (very fine?) water impen.	

Compare
TNS description
p 26a
Book 1

Deep Hole D

Cpt A1C

0-1"	DK Bm G s + O.M.	
1-5"	DKG / Lt Bm DKG s.	Bag 10
5-10"	Lt Bm G / Bm G s.	G
10-15"	Bm G / Y med G (=DK Bm G?) s.	200
15-25"	Bm med G s.	17
25+	Bm Lt G / Y Lt G s. water impen.	

Compare -
description back
of Book 1

Deep Hole I

Type 3A

Prod. section

Cpt 35B

4' s of break + from Hole N^o 19 of 1937 survey

0-1"	DK G s + O.M.	
1-10"	med G s.	Bag H1
10-25"	Lt Y med G s	H2
25-34"	dk / dk med Y s	H3
34-48"	Lt Y s coarse	H4
48+	water + dk	

Deep Hole F.

18 ch. W of gate Cpt 36 d

0-1 Lt Brn dk G s 0.11.
 1-4 dk Bluv G s.
 4-8 Lt Brn G / Brn G s.
 8-20 Brn G / Y med G s.
 to med med G
 20-25 dk G Y s.
 25-34 G Y s.
 34-44+ Lt G Y s.
 41" water.

Bag 207
 16 X
 65
 } 1/11.

69.
 41 (448 once)
 20

1B

Deep Hole G.

100 N.W from NO 39 of 1957 survey. Cpt 35 d

0-2 Lt Brn dk G s 0.11.
 3-8 B. G s.
 8-13 Y med G s.
 13-20 dk G s.
 20-24 Lt Brn Y s.
 24-29 Lt G med Y s.
 29-40 med Y s.
 40-56 Lt Y s.
 56-60 do: Muv.
 60-64 Ys (folded)
 64-72+ Lt G med Ys (concrete) wet.
 72+ water

2 bags 2(39) } sent Perth
 " 1(39) } Nov. 137 colour
 samples.

Note for description - faint down
 to ca 64 - well after a 1A.
 the nature of color is wet or sealed
 for about 20 min. based on the map.

Deep Hole H.

250 W x 250 N of SE corner Cpt 35 b.

0-2 Lt Brn dk G / dk Brn G s 0.11. Bag 52
 2-5 med G s 35
 5-8 Lt Brn med G s 88
 8-12 Brn Lt G s A
 12-17 dk Brn med G s 14
 17-20 Brn med G / Lt G Lt Brn (?) s. 86
 20-27 Brn med G / dk G Y s 33
 27-35 dk G Y (wet) 37
 35-39 G Y Lt Brn Lt Y s (wet)
 39+ water.

1B

Description of Deep Hole "A"
dug next to borer hole described on next page.

Deep Hole "A"

0-3 v. DK Grey Brn s. 0m
3-15 DK Brn s some O.M.
15-37 Brn/G Brn s
57-90+ Y with some itmenite

Bag A
Bag 5
Bag Ludlow 2
Bags sent taken to Perth by J.L.E.
circa Sept 3rd

Deep Hole B. Malling Paddock. Compl: 352.

Locⁿ 450 N along break from entrance gate corner and 390 @ 275' high.

Br. DK G. ① 0-4 DK Grey Brn s O.M.
DK Brn. ② 4-14 Brn s.

Bag
B
② (also old brand 37)

Deep Hole B. Malling Paddock. Count: 352.

Locⁿ. 450 N along break from entrance gate corner and 390 @ 275' high.

			Bag	
Br DK G.	①	0-4	Sk Grey Brn 3 O. Wt.	B
DK Brn.	②	4-14	Brn 3.	(2) (also old brand 32)
Brn.	③	14-18	G. Br / Y Brn 3	C
DK Y Brn.	④	18-46	Y Brn / Y (Brn) 3	E
Brn DK Y	⑤	46-64	Y (Brn) 3	A
LL Brn DK Y	⑥	64-84	DK Y less Brn than last.	93
DK Y	⑦	84-96	Golden Y 3	9
Hg maly	⑧	96-108	Light Y (greyish) 3	79
	⑨	108-120+	Gth Y water infen.	20

Bags sent to Perth. early sept J.L.E

Vegetⁿ

Tuant Prad fair/poor.

- (2) No flex.
- (100) Bl. grandis.

ab Hyp. rod. Tunca prolifera Native Yam.

map Pat. ovid. Jack figs & Pota hepudosp. Lomant Prass

oc Boss. sig. Itak prothala Anzio Mandeseri Kern West Soterpae Caxi Phil. Calis Lao. Hwae. H. Conloden Hdb rollwota Conchy Bromel Eriad prothalam

1000 Hdb. concipimus Hypha. th. radii.

3/9/37 J.L.E

Compt 34E

River Paddock.

deep hole in centre of fenced off grass plot.

Deep Hole "A"

Bore profile:-

- 0 - 3" v. dk. Grey Brn s. O.M.
- 3 - 15" DK Grey Brn / DK Brn s
- 15 - 35" Y Brn }
35 - 60" } Lighter Y Brn } s
- 60 - 114" } Greenish Y Brn } s
 much silicate
- 114 - 150 do. Coarse Brn.
- 150 - 180" Greyish Brn H Y s.
- 180 - 192 H Y s (Coarse)
- 192 - 198 H Y s. (u coarse).
v. occ. iron + iron
mottling - water.
- 198 - 204 Brn Y s v. Coarse
(occ. qtz fragment)
- 204 + water impen
see next page.

P. pin surrounding v. fair
P. rad on plot good.

Vegetation
Tuart
(c) Ag. flex.

Ab Grasses annuals in Brn s s/s
Bromus spp. Hyp rad. Cape Weed.

Mab Post. eucaly. Native Yarn

occ Pat. occid. Leptosiph
Amigocarpus N. S. Y. leaf
Hib. cuneifolius Low. Ph.

2/9/37

Locⁿ

200 South from NE corner Cpt 34E River Paddock by 75 Links West. i.e.

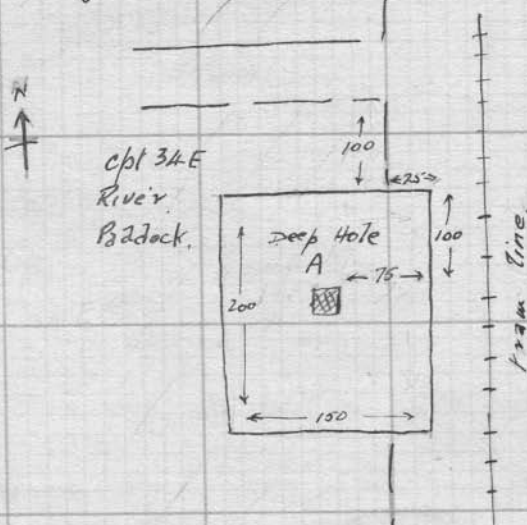

Note
see 260 p 26.

31a
250

101

Myza recurva

can. divaricata

Lepo. ellipticum

Askr. longiflorum

Ac. stenoptera

libe. Sav. n. n.

39
12
51

101

50
50
100
1480

15
50

500

P.

220
14
234
14
1728

12 out/k

1728
15600
20012
21200
17280
3920

123