

Printed 16/6/2014.

Alan Clarke's Field Notebooks

(INDEX)

(Only pages with notes are numbered)

None of these
have been scanned.

get

1. 1992-1995 (12-07-1992/19-10-1995)
2. 1995-1996 (06-11-1995/²¹⁻¹¹⁻¹⁹⁹⁶~~20-02-1996~~)*
3. 1995-1996 (08-11-1996/11-03-1996)*
4. 1996 (12-04-1996/21-11-1996)*
5. 1996-1997 (09-12-1996/06-08-1997)
6. 1997 (13-08-1997/14-10-1997)
7. 1997-1998 (20-10-97/23-10-1998)
8. 1998 (04-05-1998/04-05-1998)
9. 1998-1999 (08-09-1998/04-02-1999)
10. 1998-1999 (30-09-1998/18-02-1999)
11. 1999 (15-02-1999/08-06-1999)
12. 1999-2000 (27-05-1999/24-02-2000)
13. 1999-2000 (29-06-1999/20-01-2000)
14. 2000 (29-03-2000/17-04-2000 and 27-09-2000)
15. 2000 (26-04-2000/15-08-2000)
16. 2000-2001 (01-05-2000/16-03-2001)
17. 2001-2002 (30-10-2000-19-07-2001)
18. 2000-2001 (06-11-2000/23-05-2001)
19. 2001 (02-04-2001/08-11-2001)
20. 2001-2002 (26-11-2001/11-04-2002)
21. 2002 (07-05-2002/25-05-2002)
22. 2002 (05-07-2002/25-11-2002)

Plus sorting and preliminary IDs of aquatic invertebrates from Muir-Uncup area in 1996 and 1997

GA 1998 (09-11-98/24-11-98)

GA/8/2014



23. 2002-2003 (11-11-2002/19-09-2003)
24. 2002-2004 (14-10-03/27-11-03) + (09-03-04/17-06-2004)
25. 2004 (03-08-2004/29-09-2004)
26. 2004-2006 (08-11-2004/19-11-2004) +
(13-03-2006/09-11-2006)
27. 2005-2006 (05-07-2005/10-02-06)
28. 2006-2007 (14-11-2006/07-11-2007)
29. 2008 (05-03-2008/09-11-2008)
30. 2009 (11-03-2009/04-08-2009)

~~*Alan to worked out the pages' order.~~

5102 L. WARDEN BATHY



①

by phone 7.5 days off
12/12/12

②

MATHILDE 97542772

SPECTRUM 92404444

FAX 92406666

Stam South

TOP com by the RSK STARBU

Gary Ogden 94005763

back by Quads FAX 9400550

PAUL WAS 92502261

SCANLANS FAX 92746208

FAX HT7

DELLA HAROMAN 92737675

TILO

successful
successful
successful
successful
succeed

③

fishing room requires only 2.2m
in cabin length 2m
bottom of gumbel 650mm

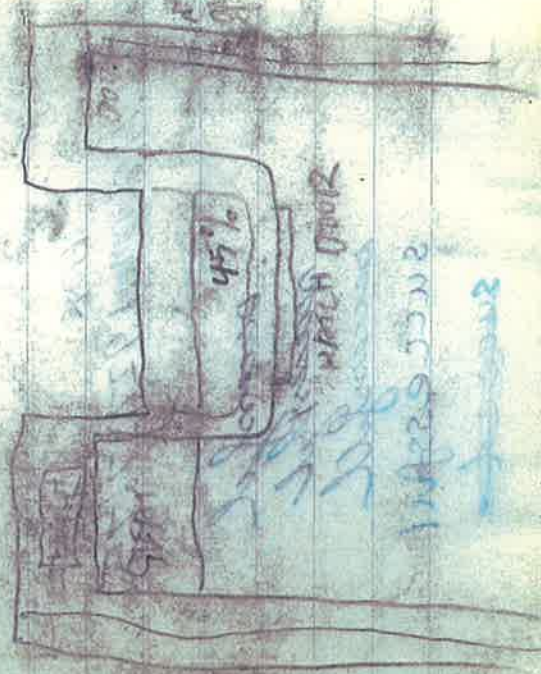
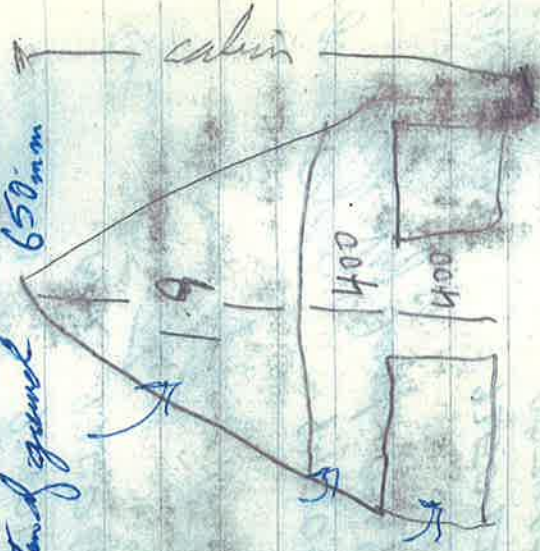

④

Propeller parts BE 627
Average length 2.85m
2.57 pairs etc

transom rounded corners
bottoms under transom
short to low end, compact
under transom

shows side fuel pump and
electrics low level out of
of well.

mark top of the well
to the running
to the main
gunwell high 65mm to the
transom then needs a light
at the water pushing in.

water - fold up etc

③

fishing room requires only 2.2m
in cabin length 2m
bottom of gunnel 650mm

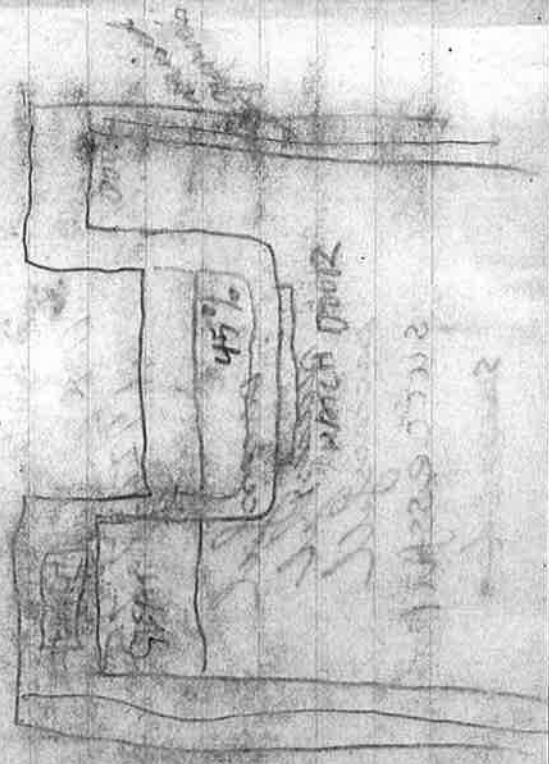
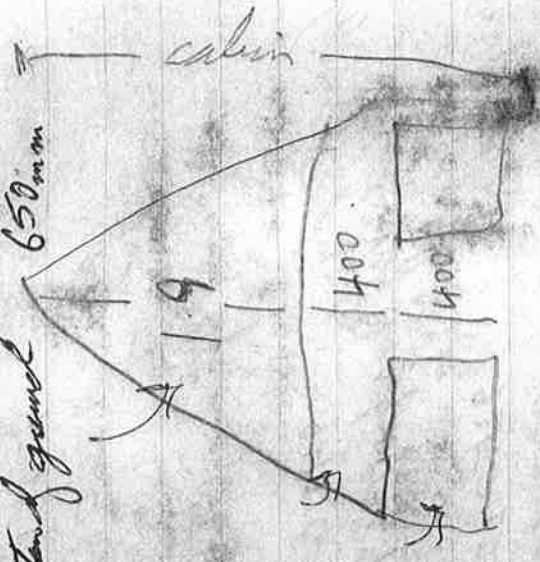

④

Propulsion Sports BE 627
Passage length 2.85m
2.57 doors etc

transom rounded corner
batens under transom
door to low end compartment
under transom

doors side fuel pump and
electrics low level outcrop of
gunnel.

mark top of
height varying
from 1.5m to 1.8m
gunwell high 85mm to top
transom then needs a lip to
stop water pouring in.

leather - fold up etc

(5)

APP. A

C.4 price information

\$70 TOTAL ?!!!

prices for job seem excessive.
most of total price

(6)

GREG THOMAS

Engrs. staff + DGPS ?!

- US ability had on work/travel

does address the labor or
covered the sum in real time

- Does not address land
based sum or higher labor
profile work

labor sum survey too detailed

RTK on a land job would

require additional pick-ups

would be needed to map

labor shape 0429958

which summing not explained,

note level transfer techniques

PRO XL what is it?

(7)

WARREN King
Murray

Bill payroll end of June 30th

Darryl 11² Jostoye,
Patricia 10

File which availability
looking around.
working

Dough Hadman. 0429958194

pick up fuel tank Jostoye
drop off Keys Morris
change type
email Murray

(8)

DARYL BROWN 92742535

90417 937022

put into mobile phone
photo copy prepared

top of river 1.282 AHD

Michael Pitt @ Exmouth. WA.
GOV. AU

Station lake 7/5/02 4:30 pm

depth at gauge 0.545

majority of the lake is 0.5m

Swans lake flow 0.6m - 0.4m

Mullett lake edges 300-400m

center approx 0.5 depth

[Faint blue ink scribbles and illegible handwriting on the reverse side of the page]

(9)

Feel in boat tanks

but for back in orgo.

(10)

6/5/02

Depart Bursledon with

Matthie Bretan at 8:30am
stop at Keyring for 1/2 hr for
lunch.

arrive in Exmouth 6:30pm.

rain and wind with a

heavy load delayed our
trip.

room at Batho Paradise

~~Foot~~ meal at Pier Hotel

depart Exmouth for Matilda
and me.

11

which included reviewing
the priorities for the
heavy rate work for
the through and inflow
work, and we explained
how the work would
progress.

12

7/5/02

Colon Express 8:40

met with TLO and discussed
the job. You went out
to the lakes and looked at
mount water levels. Spent
Warden and flow/inflow,
Windy lake, Westfield
outflow, Ewers lake inflow
and outlets. And looking
at the Bendy Creek
below Station Lake and the
Bendy creek weir.

PM. Admin including my
account was reconstituted.
phoning both Spector and
Mr. Myller and Nolan regarding
the Galloway report on the jobs.
Did some stopping for

13

7/5/02

Breakfast and morning tea
done.

Went to the Skin to
obtain an AHD for the
top of Bandy Creek river.
Also looked at depths in
Covers, Muller and Station
lake.

Met Davey at 5.45
at CP and discussed
the job. Part fuel in
Patrol.

Finish 6.00 pm.

8/5/02

start 0720 hrs.

Meeting at CALM Camp. 7:30am
with Deryk Hoochman,
Deryk (Warrior King survey)
Cameron, Rob (DOLA), Matthew
to discuss projects.

looked at boat and scho
number equipment. took boat
and bucket to Glenora.

along Sabrina's to set up.

Deryk Hoochman took

Deryk to see the SSM's

PM. RTK work using the
argo at Levens lade.

harveyed 3/4 off the rim

argo leaked water from
either than the lungs!!

finished at lake 5:30

back to CP finish water there
at 6:15pm.

9/5/02

start 6.30am repair vehicle
to get ready for
depart pad at 7.00am.
flat tyre on trailer.
set up base station.

start RTK Daryl + Matthew
at 8.00am to finish run of
Lewards.

I went back to pick up the
boat from Alloy fabrications
then brought food, chopped
into CALM to see TILLO
and get Cameron + Berndts
picked up. Takston and
loaded the tank in
Lewards at 9.45.

dragged boat with cargo
to water.

9/5/02

morning tea / rest for
RTK people at 10.00-10.20.

RTK log needs to be

rechecked on a separate
lighter log of way through
the slough!!!

PM RTK open water of Lewis
lake and lunch off Pin

Tide in the boat to see

RTK from boat. Investigated

Middle lake with the bridge

and found that it will

need to be RTKed with a

boat in open water.

Packed up boat, bridge and

Base station

Arrive CP and unpacked at

6.45.

Depart CP 6.45

10/5/02

Wheatfield

8800

Joint transect

8700

8600

8500 make note
set up base station at

Wheatfield. Rough Hordman
was present. Set up
the recording equipment. Sound
equip. Set up well and the
Dumrell was running well

showing depth equivalent to
that taken by my staff
measurements on High frequency.

The low frequency was
not accurate in shallow
water (200 m). The software
that links the depth with the

(18)

positions was not exactly -
apparently the wrong program
was given. A new program had
to be emailed to Exp. The lake
was RTK with probe. Start
10:30 ish.

(19)

10/5/02

Wheat field outflow/culvert is

4.24 AMD (water level number)

Photo 20000256/1

MGA 401602.707

6259186.372

6:26 PM AMD.

29

11/5/02

see note pad

Spent the day ROK in the
open water
spine

Spent weekend field
ROK with both cameras
at Woody Lake. Spent
half of the run.

Spent all CID 6.30

12/5/02

Start 7:00 leave CP

unload boat at Woody lake. And spent 2 hours trying to get cube saws software to load

RTK the stake using pole in 3 hrs.

Run survey completed by Marshall and Clint,

pm moved to WINDYBOAT.

Both surveys did Run surveys for 2 hours.

finished at 10:00

4:15 arrive CP and finish at 4:30

(21)

12/5/02

Left 7:00 leave CP

unload boat at Woody
Lake. And spent 2 hours
trying to get echo sounder
software to log

RTK the lake using pole
in 3 hrs.

Rin survey completed by
Methilde and Clint.

per moved to WINDSBORO.

Both surveys did Rin
surveys for 2 hours.

Spelled out lake at

4:15 arrive CP and finish
at 4:30

leave CP 6.45

13/5/02

put fuel in boat fuel tank
 set up boat and took
 both survey teams out to
 continue the river survey.
 Clint and Cam. + Darryl had 5120
 after lunch. Continue run with
 Clint and Cam. and Darryl and
 Mathilde.

am I spot picking up trash
 type, shopping, several survey
 time sheets I picked up lunches
 and Mathilde from Woody is.
 Tom, Mathilde dropped off
 survey teams pm while I
 picked up the cargo, fuel etc
 and brought out to the
 lake and removed tracks.
 undulate

(23)

13/5/02

picked up both survey teams, took to car park 5:05 pm
up boat had up trailer. Spent at lake 5:30. Start of CP 5:45 pm

(24)

14/5/02

start 6:40
trawl to Windolant and get boat ready. Surveyors set up base station on L. Warden dam. Took Chris and car out to start run work.
set the survey equipment up on boat. sent boy off clubwork

DONE 7450

. 7500 water cont.

7550

7400

7350

7300

14/5/02

Romp Bay

N 7500

7550

7600

7650 full length.

7700 "

7750 "

7800 "

7850 "

7900 "

7950 done

Spent 2 hrs trying to make the software work. at 11:00

we began surveying 50m

travels with depth sounder recorded every 5 sec.

50% of the data was survey

(26)

outboard fuel
batteries
0.5 loads

(24)

14/5/02

in 3.5 hours.

Rim work with Clint and
Cameron in AM and Clint and
Wayne pm was finished.
Daryl and I packed up the
cheese and beer
finished that at 5:00 pm.
Drove to Warden base station
and picked up Wayne
and dropped him off back
at Lake Windermere ramp.
back to CP at 5:45 pm.

15/5/02

Depart CP 6:40 Fuel boat from
Windabout

am finished with ramming of lake
Clint and Cameron attempted
to work on lake Warden.
pm began RTK of shallow
areas on windabout. Not
completed.

pm Clint and Mark did
some work on lake Warden.
need 2nd boat on lake
Warden first thing tomorrow
morning

Finish at lake 5:20
arrive at CP 5:30 pm

16/5/02

depart CP 6.45

PC and Daryl finished off

PETK pole work on areas

top platform for the auto

rounder. Finished at 10.40

arrived for lake warden

11.15. set up auto rounder

on boat and surveyed lake

transits x 2 until 1300hrs

on river. Clint and Cameron

doing P.M. work on lake

Warden.

pm. Clint and Cameron on

12/2/05

04.2 - 0.40

0.40 - 0.50

0.50 - 1.00

1.00 - 1.10

1.10 - 1.20

1.20 - 1.30

1.30 - 1.40

1.40 - 1.50

1.50 - 2.00

2.00 - 2.10

2.10 - 2.20

2.20 - 2.30

2.30 - 2.40

2.40 - 2.50

2.50 - 3.00

30

2/5/02

Warden depth egg / 1.87m

13/2/02

11.30 time Warden inflam.
RTK photo.

5/2/02

(31)

24/5/02

Departed CP at 6:45
have set up on Bandy Creek
Red hill. Beryl and Allan.
RTK survey in the lower of
Bandy Creek from weir to
200m upstream from bridge on
Bandy Creek RB.

Finished at 4:00 packed up
home and took shots at
3 points upstream from the
peddings with stone blockage.
Lan. and Chris used the arge
to RTK the remainder of the
week leading into Bandy creek
from the Westfield Landflow.
They also finished Bandy creek
up to Station Lake.
Finish at CP 6:00 pm.

25/5/02

Start from CP at 7.30 am
out up/clar and fix ergo
catch up with D+C who
were picking up creek from Lewis
to Station.

10.00 start signal disrupted.
waited until 11.30 then went
back to meet the Lewis. This
worked and began pickup
at 12.20

sent Mottilda back to CP
at 10.30 because she had a cold.

5/12/05

[Faint, mostly illegible handwriting in blue ink, possibly bleed-through from the reverse side of the page.]

USP. Crystalline
mashro 296.85
112 50% Nov. USP.

Pir Hotel 48.70
Lunch 18.10 / Legum
Metal band 37.00 angk irono
orgo sawro 600 50/50 Nov, 85
Ravi food 19.66

~~W~~ ~~ms~~ ~~peperant~~

flower
W (1) ~~the cream~~

(1) ~~breeding bag~~ (1) shorts drip dry
~~Butter~~

(1) glass stop (1) Butier
W (1) Johnson

W (1) deaton
umbrella
35mm film.

W (1) LACTOSE MILK
W (1) baked bread
W (1) ~~crack food~~.

W (1) vitamins
~~anti-inflammatory~~ ~~toto~~

W (1) water bottle
chux toilet paper
~~paper knife~~
~~lunch bag~~

W ~~Johnson~~

35

9 enjoy
Pajaro

0893840066

calhoun beachside
resort.

Sandwich Hospital
94009999

1/ARN

A 432198

N 8009713

14

36

94055141

medically dist #141

#6

box T10

MOTHER

96412727

tea

milk

chips

CUTARSIN

0297629191

(3) (37)

13/5/02

cutthroat Gull
ergo Gull
pick up tractor type

milk
Bread
~~top man organ~~

~~same~~
Bancroft

lettice
~~found apples bananas~~

milk John 200 eggs 36x2
Gull ergo

1919565850

(38)

COMBINATION C12

- AVICIA
- RUTA GRAV
- HYPERCALUM
Doughl Basin
H7

HEBACHARM ST
HOERING
R east

FC6410
DE IN CHINA