

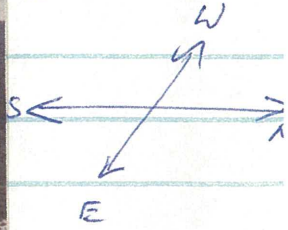



91:11



Lake Ace 2 MAY 80

# LAKE ACE GENERAL LOCATION MAP

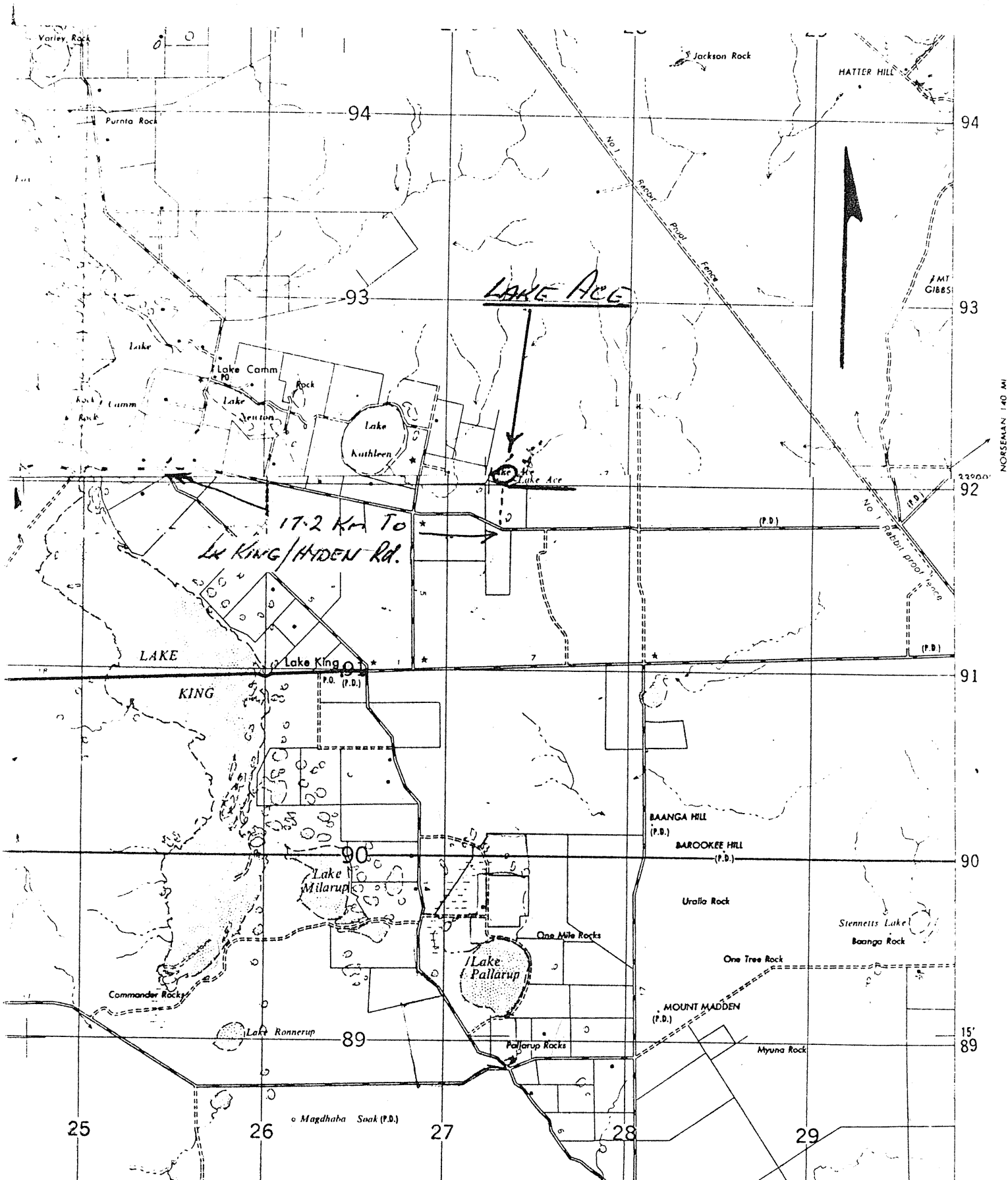

LAKE ACE  
ACCESS MAP

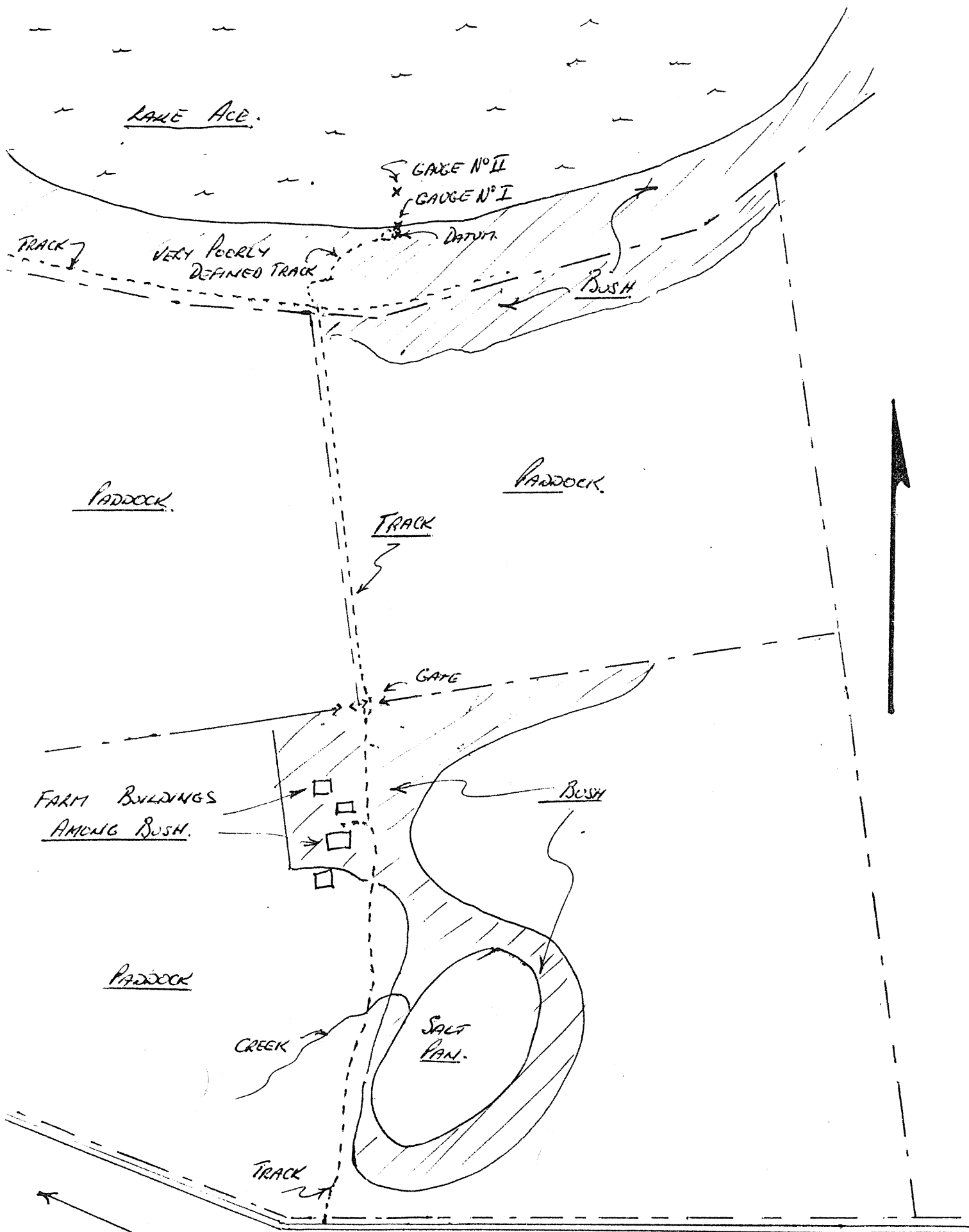

← To LK KING / HYDEN Rd - 17.2 km.

# LAKE ACE

## DEPTH GAUGE LOCATION & ACCESS.

DATE INSTALLED - 31: 7: 80

BY - D. R. MUNRO.

DATUM HEIGHT - 2.00 M.

DATUM LOCATION - ON S/W SIDE OF LAKE, APPROX 500M (DIRECT) FROM GATE ENTERING RESERVE OF 650M ALONG TRACK (VERY POORLY DEFINED) DATUM IS AT THE BASE OF AND LAKE SIDE OF NORTH. - WESTERN MOST EUC. Sp. WHICH IS ONE OF SIX IN A CONSPICUOUS GROVE AT THIS LOCATION.

GAUGE NO I LOCATION - 14.0M & 16° FROM DATUM

GAUGE NO II LOCATION 80.0M & 16° FROM DATUM.

GAUGE READING: LAKE FLOOR =

