

RESERVE ACTION SHEET: CONSERVATION RESERVES

RESERVE No. 640, south of Kalbarri

REASON FOR ACTION

Addition to of Lot 100 on Deposited Plan 40730 to Utcha Well Nature Reserve, Reserve 640, south of Kalbarri, in the Shire of Northampton. **Purpose:** Conservation of Flora & Fauna. **Vesting:** Conservation Commission of Western Australia.

New Area: 291.7499 hectares

The addition is part of land-exchanges worked out with the mining company G.M.A. Garnet. The exchanges, once completed, will result in a consolidated nature reserve adjoining a large area of unallocated Crown land proposed for reservation at Hutt Lagoon.

Native Title: native title on the added land has been extinguished by previous freehold tenure.

Date of amendment: 4/10/2006

Maps: pp. 90-1

Customer advice: p. 39

Proposal Summary: see pp. 54-5
together with the map at p. 83

	OFFICER	ACTION
1	CONSERVATION-ESTATE OFFICER	Send copies of advice & maps to: - Lisa Wright, Woodvale _____ - Manager, Geraldton District _____ - Manager, Midwest Region _____ Recommended I.U.C.N. classification: <u>1a</u>
2	LAND-ACQUISITIONS OFFICER	To note: _____
3	UNIT LEADER, LAND & EXTERNAL FUNDING	To note: _____
4	DIRECTOR, NATURE CONSERVATION	To note: _____
5	INDEX CLERK, RECORDS	To note: _____
6	CONSERVATION-ESTATE OFFICER	Reserve details to inside cover of file & add details to Conservation Commission Reserves Summary Table _____

36807		02369-1979-02RO	0000-000 0000-000 0000-000 0000-000	Management Order to Shire of Northampton of Post Office Box 61, Northampton. for the designated purpose of "Drain"	J905529	07/09/2006		3064 sqm	
36807; 36807		02369-1979-02RO	3044-468 3044-478	Revocation of Management Order (Shire of Northampton) for the designated purpose of "Drain".	J905527	07/09/2006		556 sqm	
48817	Lot 12152 on Deposited Plan 193420	00855-1997-01RO	0000-000	Reserve Creation for the designated purpose of "Emergency Services Centre".	J865410	08/08/2006	Mitchell Street, Horrocks	4.89 Ha	BE44(2) 03.18 & 03.19
48817	Lot 12152 on Deposited Plan 193420	00855-1997-01RO	0000-000 0000-000	Management Order to Shire of Northampton of PO Box 61, NORTHAMPTON WA 6535 (i) To be utilised for the designated purpose of "Emergency Services Centre" only, (ii) Power to lease for the designated purpose (or sub-lease or licence) is granted for the whole or any portion thereof for any term not exceeding twenty-one (21) years from the date of the lease subject to the approval in writing of the Minister for Lands being first obtained to each and every lease or assignment of lease, pursuant also to the provisions of Section 19 of the Land Administration Act 1997. for the designated purpose of "Emergency Services Centre"	J865411	08/08/2006	Mitchell Street, Horrocks	3360 sqm	BE44(2) 03.18 & 03.19
640	Lot 12117 on Deposited Plan 219414. Lot 12118 on Deposited Plan 219414. Lot 12119 on Deposited Plan 219414.	00307-1908-02RO	3137-853 3137-854 3137-855	Amendment of Reserve to To now comprise Lots 12117, 12118 and 12119 on Deposited Plan 219414 and Lot 100 on Deposited Plan 40730, and of its area being increased to 291.7499 hectares.	J938447	04/10/2006	George Gray Drive	291.7499 Ha	

CONSERVATION ESTATE OFFICER
LAND ADMINISTRATION SECTION
PARK POLICY AND TOURISM BRANCH

Reserve 640 within MIDWEST / GERRARDTON Region/District, was
~~created~~/amended, effective from 4 OCTOBER 2006.

- A copy of the customer advice can be found at folio 39.
The addition / ~~excision~~ / ~~amendment~~ is shown on the associated Deposited
Plan / ~~Diagram~~ which is listed below:

Deposited Plan 40730 lot / location 100 folio 89

Other relevant deposited plans / diagrams:
 _____ lot / location _____ folio _____

- A locality plan with the addition / ~~excision~~ / ~~amendment~~ shown highlighted can be
found at folio 90.
- Copies of other relevant notifications pertinent to this reserve action have been
placed at folios 91.

Would you please advise the relevant offices of this amendment through your Reserve
Action Sheet.

Recommended IUCN classification 1a



Program Leader
Tenure Group, GIS
Information Management Branch

19.3.07

LEGEND

- REGION BOUNDARY
- DISTRICT BOUNDARY
- REGION HQ
- DISTRICT HQ
- WORK CENTRE

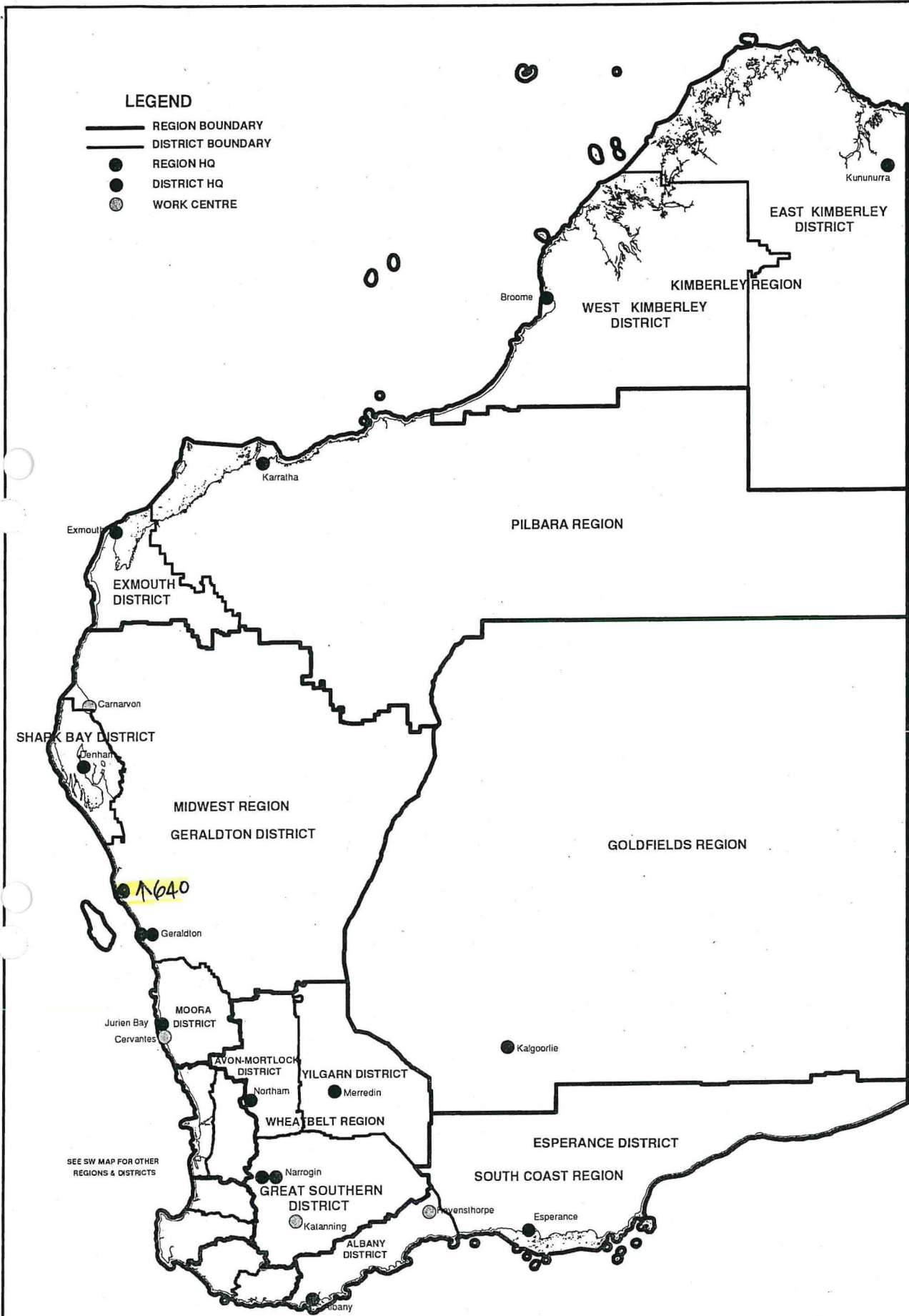

**DEPARTMENT OF ENVIRONMENT AND CONSERVATION
REGION AND DISTRICT BOUNDARIES**

JAN 2007

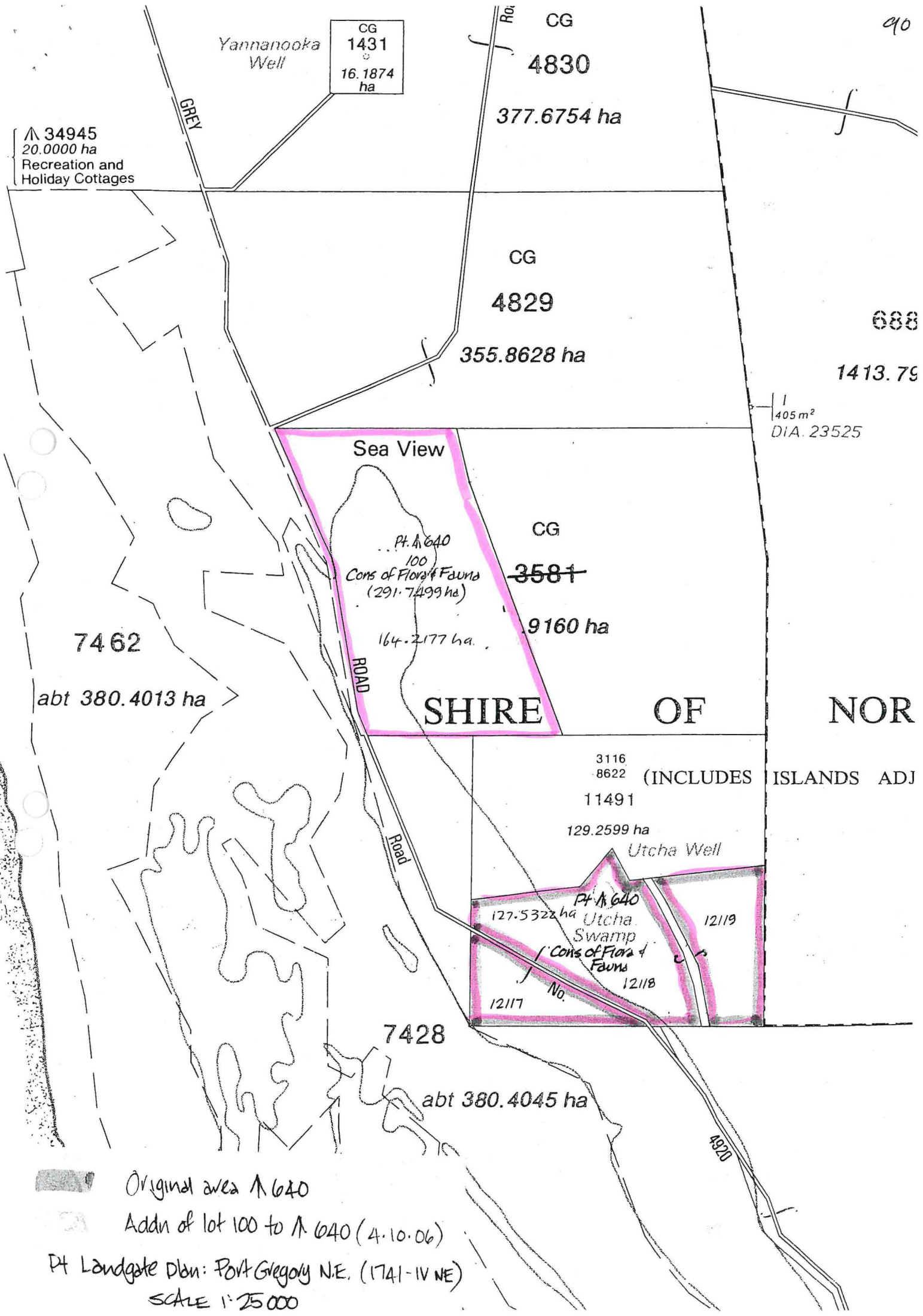

CG
1431
16.1874
ha

Yannanooka
Well

▲ 34945
20.0000 ha
Recreation and
Holiday Cottages

CG
4830
377.6754 ha

CG
4829
355.8628 ha

90
688
1413.79

1
405 m²
DIA. 23525

Sea View

Pt. A 640
100
Cons of Flora & Fauna
(291.7499 ha)

CG
~~3581~~
9160 ha

164.2177 ha.

7462

abt 380.4013 ha

SHIRE OF NOR

3116
8622 (INCLUDES ISLANDS ADJ
11491
129.2599 ha

Utcha Well

Pt. A 640
127.5322 ha Utcha
Swamp
Cons of Flora & Fauna
12119
12118
12117 No.

7428

abt 380.4045 ha

Original area A 640

Addn of lot 100 to A 640 (4.10.06)

Pt Landgate Dbn: Port Gregory N.E. (1741-IV NE)

SCALE 1:25000

DP 40730 ORIGINAL NOT TO SCALE - Wtd Desc 20 1611 132 2006 JOB 27355893

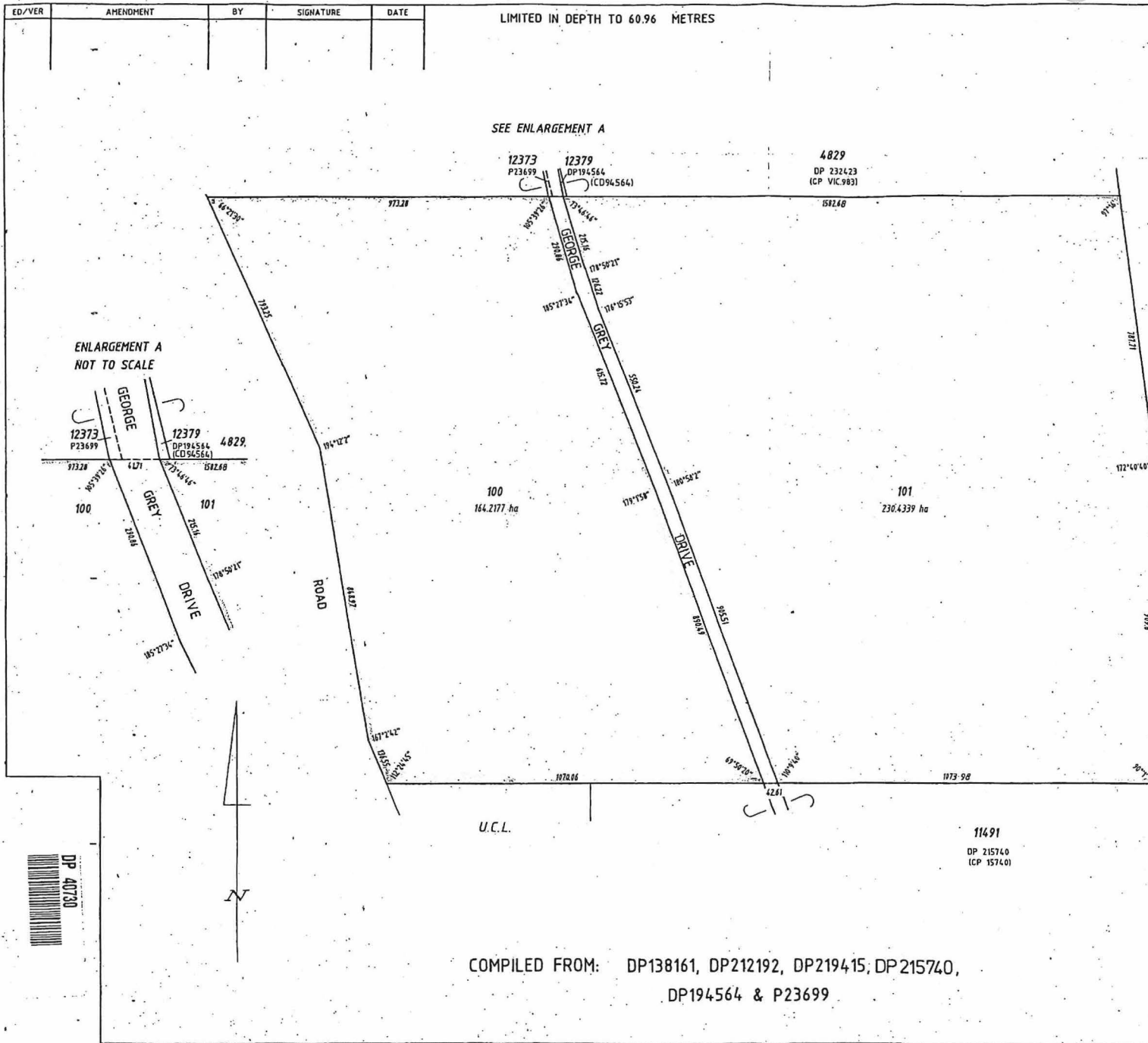

TYPE FREEHOLD	
PURPOSE SUBDIVISION	
PLAN OF LOTS 100-101	
DISTRICT VICTORIA TOWNSITE FILE LOCAL AUTHORITY SHIRE OF NORTHAMPTON LOCALITY YALLABATHARRA ON INDEX PORT GREGORY N.E.(25)	SSA REF/NO FORMER TENURE LOT 3581 ON DP 136461 C/T 1876-1 FIELD BOOKS COMPILED
SCALE 1:7500 ALL DISTANCES ARE IN METRES	
SURVEYOR'S CERTIFICATE - Reg 84 I, PHILLIP L. RICHARDS herby certify that this plan is a correct representation of the survey and / or restitution from measurements recorded in the field book kept for the purpose of this plan and that it conforms with the relevant written lawful conditions to which it is subject.	
6882 DP 202186 (CP 2186)	9/12/02 Data
OUR REF 03142	CSD FILE 122833-CSD
LOGGED DATE 15/12/2003 FEE PAID \$280 APPROVED BY 4-3-79B	TYPE OF VALIDATION FILE NAME LEGAL INSTRUMENT S.MEE DOCKET P.40700 CERTIFIED CORRECT 27.1.04 L.S.D. FILE
APPROVED BY WESTERN AUSTRALIAN PLANNING COMMISSION FILE 122833 DELEGATED UNDER 6.23 WAPC ACT 1985 DATE 24/2/2004	
SUBJECT TO Dedication of Road Widening (inc 12379) on P23699 & Prior approval of D.A. 194564	
APPROVED 1.06.06	
INSPECTOR OF PLANS & SURVEYS / AUTHORISED LAND OFFICER DATE	
DEPOSITED PLAN 40730	
SHEET 1 OF 1	EDITION 1 VERSION 1

COMPILED FROM: DP138161, DP212192, DP219415, DP215740,
DP194564 & P23699

89