

## RESERVE GAZETTAL ACTION SHEET FOR REGIONS AND DISTRICTS

LANDS CLERK: Attach a copy of map and forward to the following:

1. REGIONAL MANAGER:  
CENTRAL FOREST, GREENOUGH, GOLDFIELDS, KIMBERLEY, SWAN REGION, PILBARA,  
SOUTH COAST, SOUTHERN FOREST, WHEATBELT ✓
2. DISTRICT MANAGER: Merredin
3. CLERK, WOODVALE ✓
4. O.I.C. INVENTORY BUNBURY / KELMSCOTT / MANJIMUP
5. DISTRICT WILDLIFE OFFICER: Merredin

REASON FOR GAZETTAL:

Former "Travellers & Stock" reserve changed to  
"Conservation of Flora & Fauna" on District recommendation.  
A Class.

### RESERVE DETAILS

RESERVE NUMBER: 1563  
 CALM FILE NUMBER: 031111F3102  
 MAP REFERENCE: Goomalling S.W. 1:25,000 2235-2  
 SHIRE: Goomalling

### CHANGES MADE AT GIVEN GAZETTAL DATE

NAME OF RESERVE: \_\_\_\_\_  
 PURPOSE: Conservation of Flora & Fauna.  
 CLASS: "A"  
 AREA: 98.09 ha  
 VESTING: NPNC  
 DATE AND PAGE NO. OF CURRENT GAZETTAL: 12/6/92 Page 2403

S. Water  
LANDS CLERK

(09) 367 0221

Goomalling 2235-11  
1:50,000  
20/1/93  

9/7/92  
DATE

Reserv Am. 0815

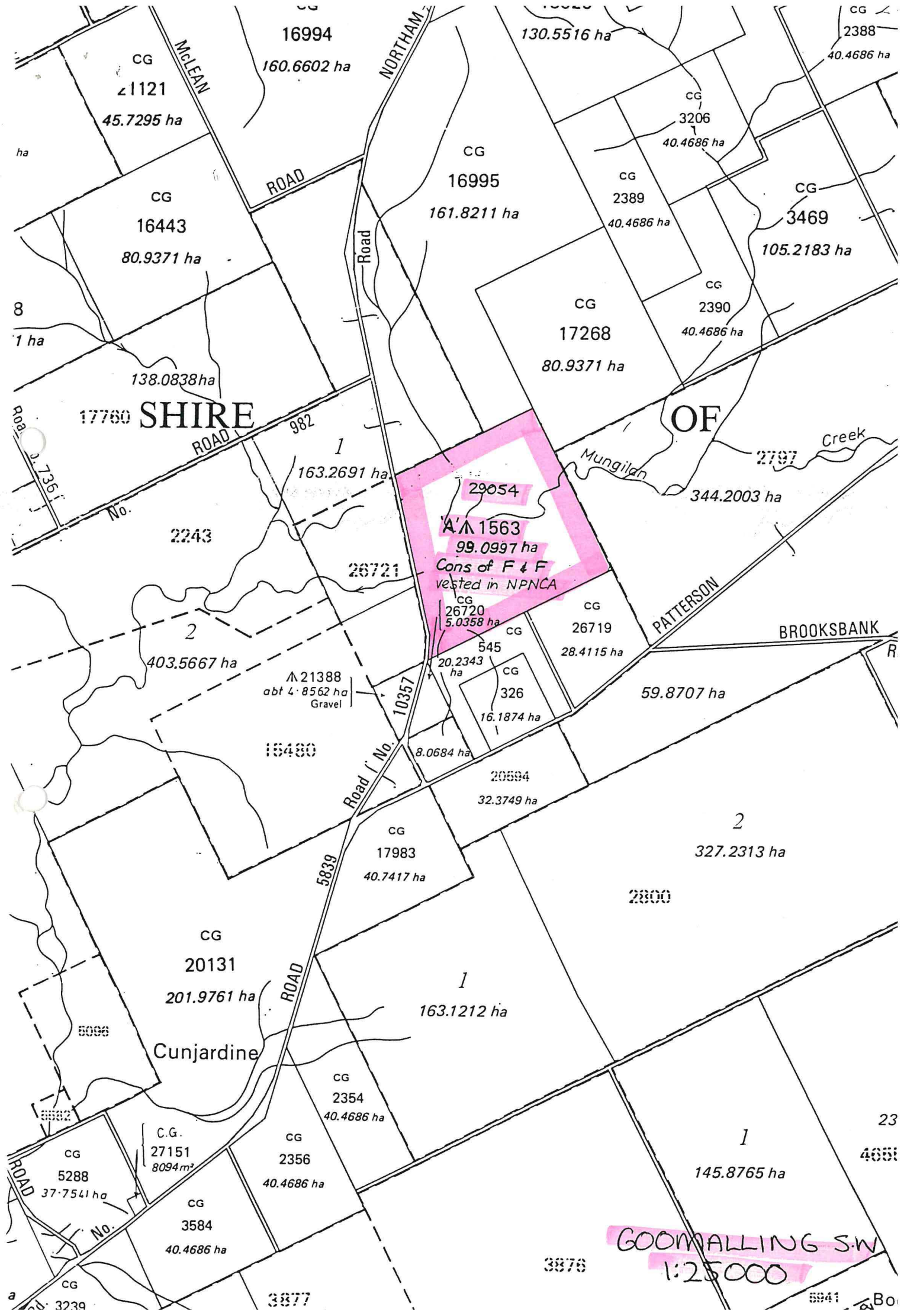

SHIRE

OF

GOOMALLING S.W.  
1:25000

29054  
A 1563  
99.0997 ha  
Cons of F & F  
vested in NPNCA

16994  
160.6602 ha

130.5516 ha

CG 2388  
40.4686 ha

CG 1121  
45.7295 ha

CG 16995  
161.8211 ha

CG 3206  
40.4686 ha

CG 16443  
80.9371 ha

CG 2389  
40.4686 ha

CG 3469  
105.2183 ha

8  
1 ha

CG 17268  
80.9371 ha

CG 2390  
40.4686 ha

138.0838 ha

17760

OF

Mungilan Creek

344.2003 ha

163.2691 ha

29054

A 1563  
99.0997 ha  
Cons of F & F  
vested in NPNCA

2243

26721

CG 26719  
28.4115 ha

403.5667 ha

A 21388  
abt 4.8562 ha  
Gravel

CG 20.2343  
ha

CG 545

CG 326

59.8707 ha

15480

8.0684 ha

20594  
32.3749 ha

327.2313 ha

CG 17983  
40.7417 ha

2200

CG 20131  
201.9761 ha

163.1212 ha

Cunjardine

CG 2354  
40.4686 ha

145.8765 ha

C.G. 27151  
8094m<sup>2</sup>

CG 2356  
40.4686 ha

CG 5288  
37.7541 ha

CG 3584  
40.4686 ha

3876

5941 Bo

3877

CG 3239