

ADMINISTRATIVE INFORMATION

W.A. NATURE RESERVE NO.: 1998

GOVERNMENT GAZETTE
Date Page No.

FILE NUMBER: 890/76

PURPOSE: Camping & Cons. of Flora 12.6.70 1636

NAME:

CLASS (Land Act):

AREA: 37.6409 ha 15.7.77 2223

VESTING: Albany Shire 12.6.70 1621

LOCATION NO(S): Plant.

CLASSIFICATION:
(Wildlife Act
Section 12A)

LOCAL AUTHORITY: Albany Shire

LITHO NO(S): 451D/40

CADASTRAL MAP NO(S):

TOPO. MAP NO(S):

LATITUDE:

LONGITUDE:

AUST. GRID REFERENCE:

TRAVELLER'S ATLAS OF W.A.: Map No.:

Ref. No.:

AERIAL PHOTOGRAPHS
Wallet No.:

INFO. on COMPUTER:

WILDLIFE DISTRICT RESPONSIBLE:

RESEARCH OFFICERS/AREA OF RESEARCH:

NOTES:

RESERVE ACTION SHEET: CONSERVATION RESERVE

RESERVE NO: 1998

REASON FOR ACTION: Change in purpose from "Camping and Conservation of Flora" to "Conservation of Flora and Fauna". Change in vesting from the Shire of Albany to NPWSA. Changes in accordance with recommendations from South Coast Region Management Plan.

OFFICER	ACTION	ACTION DATE
1. Lands Clerk	Fill in above details	NRR 12.7.93.
2. Reserves Clerk <i>bb.</i> to note.	Attach copies of gazettal notices to file (folios: 35-37...) Enter relevant details on file cover.	
3. Officer In Charge Records Index Office <i>messenger</i> <i>13/7/93</i>	For new reserves: Index Reserves name: Index Reserves number:	
4. Senior Drafts person Legal mapping <i>15.7.93</i>	Amend Litho. ✓ Attach copy of litho to file (mark litho name/number) <i>F38</i>	<i>15.7.93</i>
5. Lands Clerk	Send copies of gazettal notices (or Lands Department memo) and map to: Clerk Woodvale _____ Regional Manager _____ OIC Inventory _____ Kelmscott/Bunbury _____ District Manager _____ District Wildlife Officer _____ Note: Information sent must include: (a) Dept file No. (b) Litho no./name	
6. Senior Clerk Reserves	To Note	
7. Manager Land Admin	To Note	
8. Director Nature Conservation/National parks	To Note	

CLERK, WOODVALE - RYI

Gazetted 1/6/93 PVH.

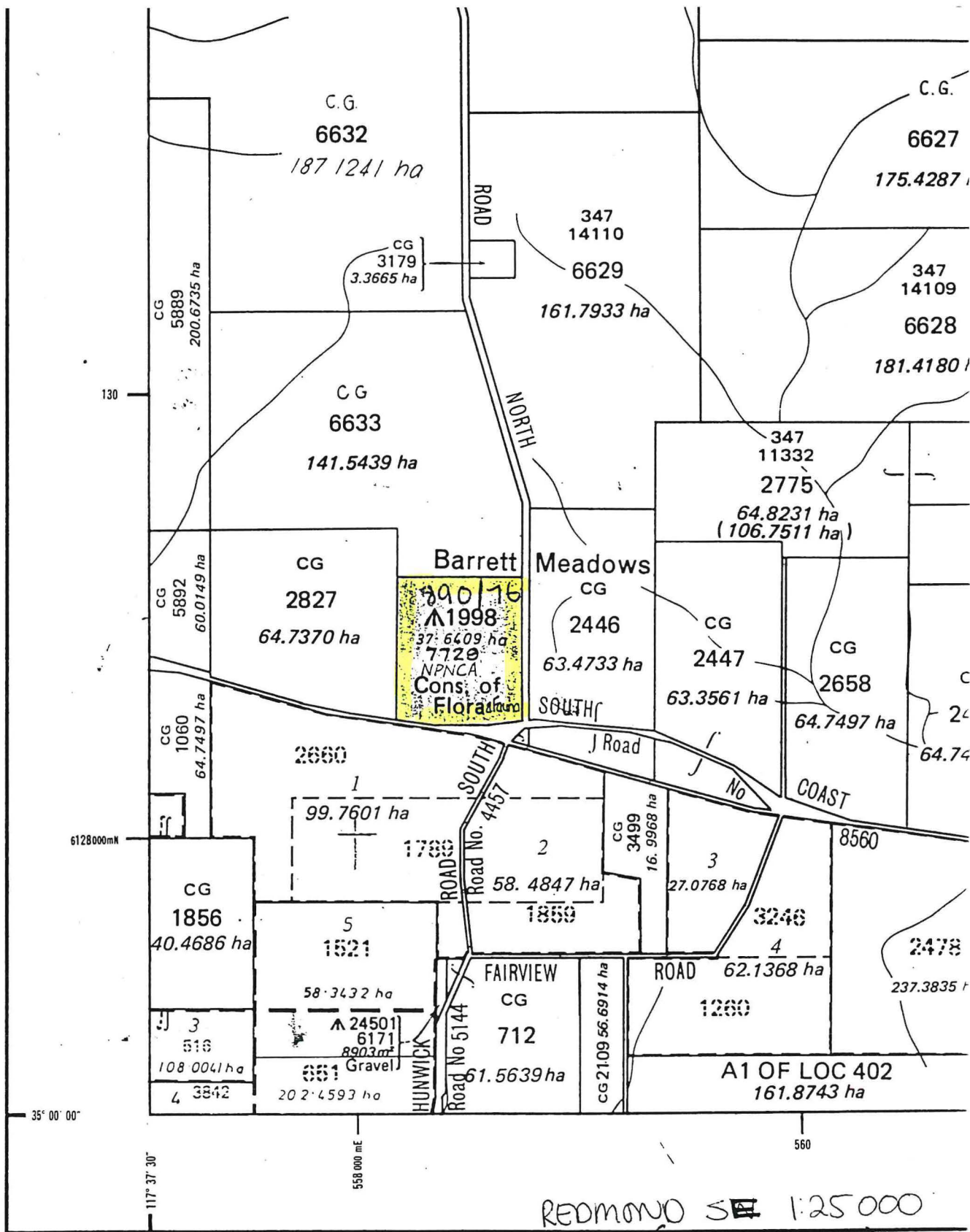

REDMOND SE 1:25 000
(2428-111 SE)

Named, unsurveyed & undedicated constructed road

Also see Redmond 1:50000

PLANTAGENET DISTRICT
SOUTH WEST LAND DIVISION
SOUTH WEST MINERAL FIELD



COMPILED on the Australian Map Grid from Cadastral Surveys and Aerial Photography flown December 1964
PROJECTION Universal Transverse Mercator C.M. 117° E.
HORIZONTAL DATUM Australian Geodetic Datum 1966
VERTICAL DATUM Australian Height Datum 1971
PREPARED under the direction of the Surveyor General Department of Lands and Surveys, Western Australia.

Surveyed Boundary	_____
Unsurveyed Boundary	-----
Goldfield Boundary
Townsite under Local Gov't Act
Townsite Boundary	_____ x _____
State Forest Boundary	_____ ++ _____
Land District Boundary	_____ + - _____
Agricultural Area or Estate Boundary	_____ x x _____

AND LAND MANAGEMENT

14 JUN 1993

Reserve No. 37512 (Morawa Lot 27) in
of "Homes for the Aged".
COMO, W.A.

DOLA File: 2940/979.

Order in Council gazetted on 20 November 1981 vesting Reserve No. 37512 (Morawa Lot 27) in the Morawa Community Care for the designated purpose of "Homes for the Aged".

Local Authority—Shire of Morawa.

DOLA File: 3163/976.

Order in Council gazetted on 4 March 1977 vesting Reserve No. 34524 in The Minister of Water Supply, Sewerage and Drainage for the designated purpose of "Water Supply Depot".

Local Authority—Shire of Cue.

DOLA File: 1576/966V3.

Order in Council gazetted on 1 December 1978 vesting Reserve No. 35771 in The State Energy Commission of Western Australia for the designated purpose of "Government Requirements (State Energy Commission)".

Local Authority—City of Cockburn.

DOLA File: 2287/975.

Order in Council gazetted on 1 April 1977 vesting Reserve No. 34539 in the Metropolitan (Perth) Passenger Transport Trust for the designated purpose of "Bus Depot Site"

Local Authority—City of Cockburn.

DOLA File: 752/924.

Portion of the Order in Council gazetted on 16 May 1924 vesting Reserve No. 18594 (Nuleri District) in The Honourable the Minister for Water Supply, Sewerage and Drainage for the designated purpose of "Water Supply".

Local Authority—Shire of Laverton.

DOLA File: 1244/971.

Order in Council gazetted on 2 February 1973 vesting Reserve No. 31776 in The State Energy Commission of Western Australia for the designated purpose of "Transformer Site".

Local Authority—Shire of Merredin.

DOLA File: 1895/954.

Order in Council gazetted on 7 February 1986 Vesting Reserve No. 26839 (Boulder Lots 3056 and 3057) in the Shire of Boulder for the designated purpose of "Pre-School Centre"

DOLA File: 2113/935V4.

Order in Council gazetted on 27 February 1981 vesting Reserve No. 34565 (Perth Lots 939 and 940 and Swan Locations 10156 and 10157) in the City of South Perth for the designated purpose of "Recreation".

DOLA File: 2654/984.

Order in Council gazetted on 5 June 1992 vesting Reserve No. 40718 (De Witt Location 191) in the Australian Maritime Safety Authority for the designated purpose of "Navigation Beacon Site"

Local Authority—Shire of Roebourne.

DOLA File: 3767/989.

Order in Council gazetted on vesting Reserve No. 41633 (Perth Lot 1017) in the City of Perth for "Municipal Purposes".

DOLA File: 2248/954.

Order in Council gazetted on 7 February 1986 vesting Reserve No. 28088 (Avon Locations 18513, 28467 and 28875) in the National Parks and Nature Conservation Authority for the designated purpose of "Conservation of Flora and Fauna".

Local Authorities—Shires of Beverley, Brookton and Quairading.

DOLA File: 251/966.

Order in Council gazetted on 27 May 1988 vesting Reserve No. 28264 (Plantagenet Location 6247) in the Shire of Gnowangerup for the designated purpose of "Gravel".

DOLA File: 1722/969

Order in Council gazetted on 12 June 1970 vesting Reserve No. 1998 (Plantagenet District) in the Shire of Albany for the designated purpose of "Camping and Conservation of Flora".

Local Authority—Shire of Albany.

DOLA File: 2350/957.

Portion of the Order in Council gazetted on 25 August 1961 vesting Sussex Locations 4171 and 4172 being portion of Class "A" Reserve No 8434 in the Augusta-Margaret River Tourist Bureau for the designated purpose of "Protection and Preservation of Caves and Flora, and for Health and Pleasure Resort".

Local Authority—Shire of Augusta-Margaret River.

DOLA File: 1383/965.

Order in Council gazetted on 4 June 1965 vesting Reserve No. 27580 (Williams Locations 15454, 11342 and 15455) in the Shire of Wagin for the designated purpose of "Park".

15-6-93
 1. File. 2. Lands Clerk. #P35, 36.

DOLA File: 326/945.

Reserve No. 23232 (Kyarra District) "Use and Benefit of Aboriginal Inhabitants" to comprise Locations 40 and 44 as delineated on Land Administration Plan 9469 and of its area being increased (recalculated) to 10.9442 hectares accordingly.

Public Plan: Meekatharra Townsite Sheet 1 Kalgoorlie-Meekatharra Road.

Local Authority—Shire of Meekatharra.

DOLA File: 1983/970.

Reserve No. 31113 (De Witt District) "Gravel (MRD)" to comprise Location 185 as surveyed and shown bordered pink on Land Administration Diagram 86212 in lieu of Location 48 and of its area being increased to 76.1343 hectares accordingly.

Public Plans: BH65 (10) 06.05 and Karratha NW (25) North West Coastal Highway.

Local Authority—Shire of Roebourne.

DOLA File: 762/968.

Reserve No. 33142 (Swan Locations 9200, 9201 and 10820) "Public Recreation" to exclude those portions containing an area of 229 square metres as surveyed and shown bordered green on Land Administration Diagram 90856 and of its area being reduced to 3774 square metres accordingly.

Public Plan: BG34 (2) 09.33 Wanstead Street.

Local Authority—City of Stirling.

DOLA File: 1722/969

Reserve No. 1998 (Plantagenet District) "Camping and Conservation of Flora" to comprise Location 7729 as surveyed and shown on Land Administration Plan 8576 and of its area remaining at 37.6409 hectares accordingly.

Public Plan: Redmond SE 1:25,000 Hunwick Road North.

Local Authority—Shire of Albany.

DOLA File: 6776/919.

Reserve No. 17264 (at Kalgoorlie) "High School" to comprise Lot 4907 as surveyed and shown bordered red on Land Administration Diagram 91126 in lieu Lots 2891, 3025 and 3384 and of its area being increased to 2.9927 hectares accordingly.

Public Plan: CF37 (2) 30.36 Boulder Road and Lane and Short Streets.

Local Authority—City of Kalgoorlie-Boulder.

DOLA File: 2347/987

Reserve No. 40258 (at Kununurra) "Buffer Strip" to comprise Lot 2425 as surveyed and shown bordered pink on Land Administration Diagram 91153 in lieu of Lot 2256 and of its area being increased to 6010 square metres accordingly.

Public Plan: Burt Range NW (25) Victoria Highway.

Local Authority—Shire of Wyndham-East Kimberley.

DOLA File: 2932/977

Reserve No. 35295 (Meekatharra Lot 810) "Recreation" to include Lots 484, 485 and 486 as surveyed and shown on Land Administration Plan P1478 and of its area being increased to 2.8683 hectares accordingly.

Public Plans: BL49 (2) 13.16 and 13.17 Railway Street.

Local Authority—Shire of Meekatharra.

DOLA File: 1069/987

Reserve No. 40026 (at Fremantle) "Cultural Facility" to comprise Lot 2083 as surveyed and shown bordered pink on Land Administration Diagram 91091 in lieu of Lot 2035 and of its area being increased to 1037 square metres accordingly.

Public Plan: BG34 (2) 6.13 Short Street.

Local Authority—City of Fremantle.

DOLA File: 2979/978

Reserve No. 35677 (at Fremantle) "Park" to comprise Lot 2084 as surveyed and shown bordered pink on Land Administration Diagram 91091 in lieu of Lot 1966 and of its area being reduced to 6263 square metres accordingly.

Public Plan: BG34 (2) 6.13 Short Street.

Local Authority—City of Fremantle.

DOLA File: 2192/938.

Reserve No. 21947 (at Pemberton) "Forests Department (Quarters)" to comprise Lot 245 on Land Administration Plan 16972 and Lot 248 on Plan 17707 and of its area being reduced to 5.6692 square metres accordingly.

Public Plans: Pemberton Regional & (2) 25.28.

Local Authority—Shire of Manjimup.

File

2.

*15.6.93
Lands Clerk, #P35*

Lu

DOLA File: 5646/912.

Reserve No. 15967 (Mingenew Lot 13) being changed from "Water Supply" to "Drainage".

Public Plan: Mingেনew Townsite—King Street.

Local Authority—Shire of Mingেনew.

DOLA File: 951/989.

Reserve No. 41213 (Swan Location 11304) being changed from "Public Recreation" to "Drainage".

Public Plan: BG34 (2) 13.39 Rolleston Dale.

Local Authority—City of Wanneroo.

DOLA File: 4074/922.

Reserve No. 32304 (Wubin Lot 44) being changed from "Recreation" to "Emergency Services".

Public Plan: BH39 (2) 18.30 Arthur Street.

Local Authority—Shire of Dalwallinu.

DOLA File: 3054/963.

Reserve No. 32081 (Canning Locations 3005 and 3754) being changed from "Hospital Site" to "Health (Hospital and Allied Purposes)".

Public Plan: BG34 (2) 17.19 Mills Street.

Local Authority—City of Canning.

DOLA File: 576/943.

Reserve No. 22452 (Avon Location 27056) being changed from "Gravel Quarry" to "Parkland and Recreation".

Public Plans: Cunderdin NE and SE (25).

Local Authority—Shire of Cunderdin.

DOLA File: 438/910.

Reserve No. 13761 (Melbourne Location 4144) being changed from "School Site" to "Community Purposes".

Public Plan: BG38 (2.5) 18.23 Coorin Street.

Local Authority—Shire of Moora.

DOLA File: 1722/969.

Reserve No. 1998 (Plantagenet Location 7729) being changed from "Camping and Conservation of Flora" to "Conservation of Flora and Fauna".

Public Plan: Redmond SE (25) Hunwick Road North.

Local Authority—Shire of Albany.

Reserve 1998 is automatically vested in the National Parks and Nature Conservation Authority pursuant to the CALM Act 1984.

DOLA File: 1383/965.

Reserve No. 27580 (Williams Locations 11342, 15454 and 15455) being changed from "Park" to "Parkland and Water Supply".

Public Plan: Wagin NW (25) Arthur Road.

Local Authority—Shire of Wagin.

DOLA File: 3542/964.

Reserve No. 28322 (Bunbury Lot 466) being changed from "Public Buildings (Bunbury Harbour Master and Bunbury Harbour Board)" to "Harbour Purposes".

Public Plan: BG30 (2) 01.33 Henry Street.

Local Authority—City of Bunbury.

A. A. SKINNER, Chief Executive.

LB201

LAND ACT 1933

CANCELLATION OF RESERVES

Made by His Excellency the Governor under Section 37.

The following reserves have been cancelled.

DOLA File: 1540/927.

Reserve No. 20752 (Karlгарin Lot 67) "Police".

Public Plan: Karlгарin Townsite Unity and Federal Streets.

Local Authority—Shire of Kondinin.

DOLA File: 3262/973V4PF.

Reserve No. 33286 (Swan Locations 8993 and 9694) "Use and Requirements of the Minister for Works".

Public Plans: BG34 (2) 08.39 and 08.40. Ellison Drive.

Local Authority—City of Wanneroo.

L. A. T. 2 15.6.93 Lands Clerk