

RESERVE ACTION SHEET - CONSERVATION RESERVES

RESERVE No. 3249

REASON FOR ACTION

- Change of purpose from 'Public Utility' to 'Conservation of Flora and Fauna' with vesting in the NPNCA (previously unvested). Area: 2.69 hectares.
- The reserve is of value to conservation in that it contains a population of the orchid *Drakea elastica*, a species of Declared Rare Flora.
- Date of DOLA's advice: 6 December 1999 See folio: 50, 57-9
- Plans at folios: 53-5 & 58

OFFICER	ACTION
1 CONSERVATION ESTATE OFFICER	<ul style="list-style-type: none"> - Fill in above details - Attach DOLA's advice to file <p style="margin-left: 20px;">Send copies of advice & maps to:</p> <ul style="list-style-type: none"> - Lisa Wright, Woodvale - District Manager, Busselton - Peter Hanly, Bunbury <p style="margin-left: 20px;">Rec. IUCN classification: 1a</p> <p style="margin-left: 20px;">To note: <i>[Signature]</i> 16/3/00.</p>
2 INDEX CLERK, RECORDS	<p>Please amend the title of this file to:</p> <ul style="list-style-type: none"> > Nature Reserves > Tenure > 3249 Drakea elastica
3 LAND ACQUISITIONS OFFICER	<p>To note:</p>
4 MANAGER, PLANNING & VISITOR SERVICES	<p>To note & approve IUCN classification:</p>
5 DIRECTOR, NATURE CONSERVATION	<p>To note:</p>
6 PROGRAM LEADER (TENURE)	<p>To note & update IUCN records:</p>

NOT TO BE REMOVED FROM THE DEPARTMENT OF LAND ADMINISTRATION
NO DUPLICATE ISSUED

ation H301805
03723-1989-01ro

REGISTER
VOLUME 3023 FOLIO 145

WESTERN AUSTRALIA



CERTIFICATE
OF



CROWN LAND TITLE

UNDER THE "TRANSFER OF LAND ACT 1893" AS AMENDED
AND THE "LAND ADMINISTRATION ACT 1997"

The undermentioned land is Crown land, in the name of the
STATE of WESTERN AUSTRALIA,
subject to the interests and status orders in the First Schedule which interests and status orders are subject to the
interests, easements, encumbrances and notices shown in the Second Schedule hereto.

Dated 6 December 1999

J. Hyde
REGISTRAR OF TITLES



LAND REFERRED TO

Capel Suburban Lot 69 on Land Administration Plan Capel 32/2 delineated on the sketch in the Third Schedule.

THIRD SCHEDULE

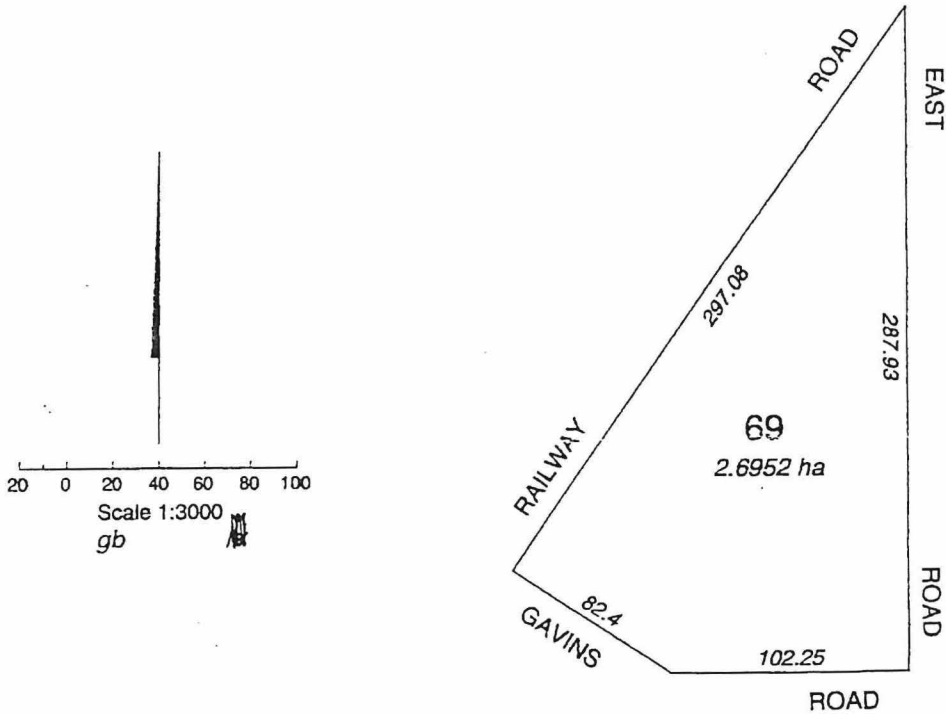

COMPILED FROM LAND ADMINISTRATION PLAN 12345

WARNING: A CURRENT SEARCH SHOULD BE OBTAINED BEFORE DEALING ON THIS LAND

Page 1 (of 3 pages)

LAND

CROWN

CLT-28/10/99









LAND

CROWN

CALM-MANAGED LANDS AND WATERS

AS AT 30th JUNE 1999

Legend

-  National Park
-  Conservation Park
-  Nature Reserve
-  State Forest, Timber Reserve, Freehold & Other Reserve
-  Section 5(g) Reserve
-  Leasehold in the name of the Executive Director
-  Marine Park / Marine Nat Res / Marine Management Area
-  CALM Region Boundary
-  CALM Regional Office

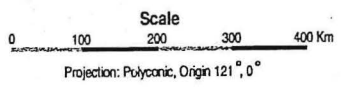

Produced by INFORMATION MANAGEMENT BRANCH

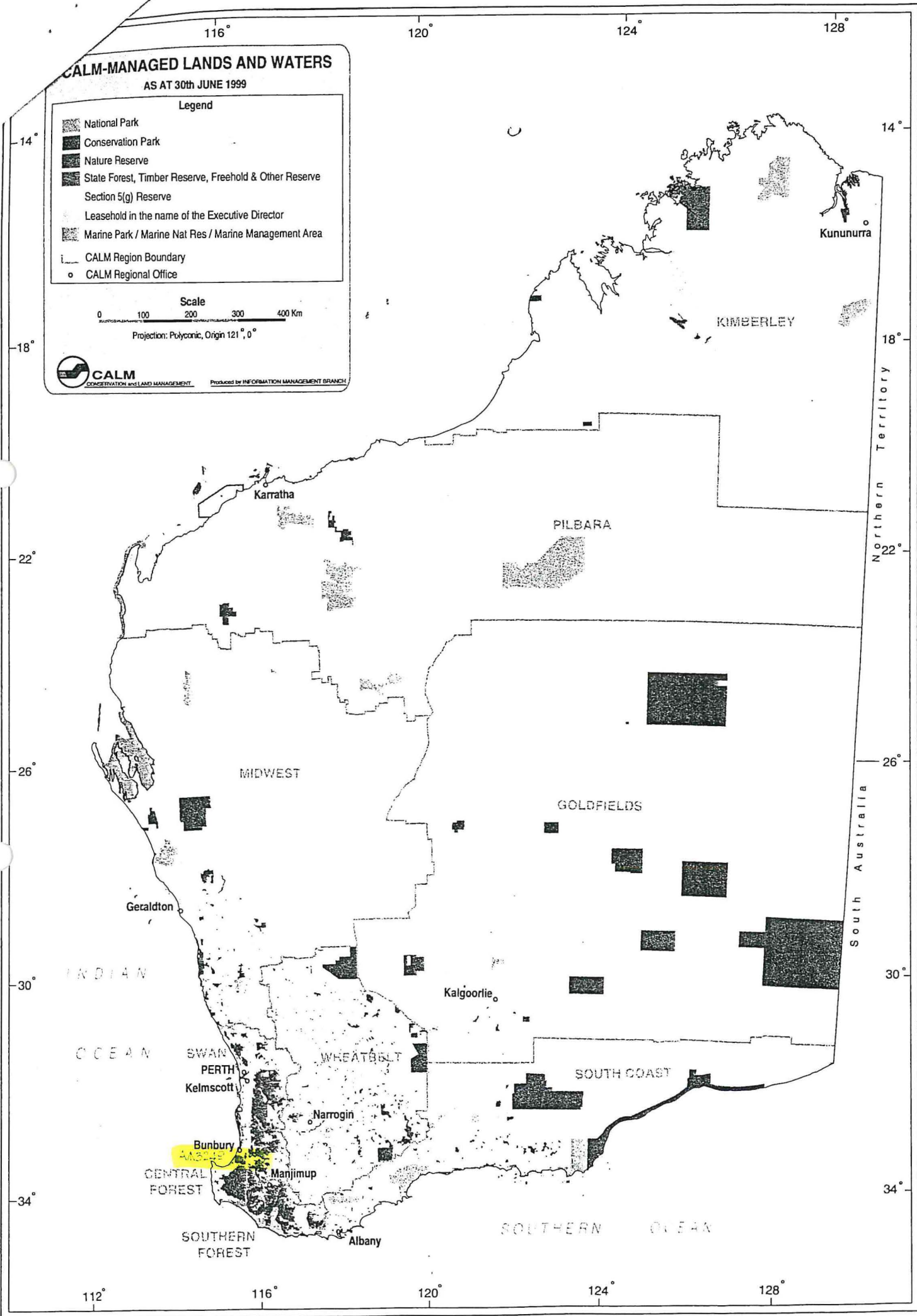



Sub 67

1.5252 ha.

AM 3249

Sub 69

Conservation of Flora & Fauna

2.6952 ha.

Sub 70

2.8758 ha.

AM 21929

Sub 71

Quarry (Sand)

7.8565 ha.

PART PLAN BF 30(2) 38.08.

SCALE 1:2000.

(DIA.