

RESERVE ACTION SHEET - CONSERVATION RESERVES

RESERVE No. 9091

REASON FOR ACTION





- Addition of reserve 10653 (unvested, 'School Site') to Cherry Tree Pool Nature Reserve resulting in its area being increased by 1.7 hectares. Area: 5.79 hectares
- Reserve 10653 exhibits high values for nature conservation as it supports an healthy woodland of sheoak, which is contiguous with the vegetation at Cherry Tree Pool Nature Reserve. The addition of reserve 10653 to Cherry Tree Pool Nature Reserve has assisted in rationalising the Nature Reserve's boundaries.
- Date of DOLA's advice: 25 February 2000 See folio: 191
- Plans at folios: 197-200

OFFICER	ACTION
1	CONSERVATION ESTATE OFFICER - Fill in above details _____ - Attach copies of DOLA's advice to file _____ Send copies of advice & maps to: - Lisa Wright, Woodvale _____ - District Manager, Katanning _____ - Regional Manager, Narrogin _____ IUCN classification: 1a _____ To note: _____
2	INDEX CLERK, RECORDS Index reserve's name _____ Index reserve's number _____
3	LAND ACQUISITIONS OFFICER To note: _____
4	MANAGER, PLANNING & VISITOR SERVICES To note: _____
5	DIRECTOR, NATURE CONSERVATION/ NATIONAL PARKS To note: _____
6	PROGRAM LEADER (TENURE) To note: _____

MANAGED LANDS AND WATERS

AS AT 30th JUNE 1999

Legend

-  National Park
-  Conservation Park
-  Nature Reserve
-  State Forest, Timber Reserve, Freehold & Other Reserve
-  Section 5(g) Reserve
-  Leasehold in the name of the Executive Director
-  Marine Park / Marine Nat Res / Marine Management Area
-  CALM Region Boundary
-  CALM Regional Office

Scale

0 100 200 300 400 Km

Projection: Polyconic, Origin 121° 0'



CALM
CONSERVATION and LAND MANAGEMENT

Produced by INFORMATION MANAGEMENT BRANCH

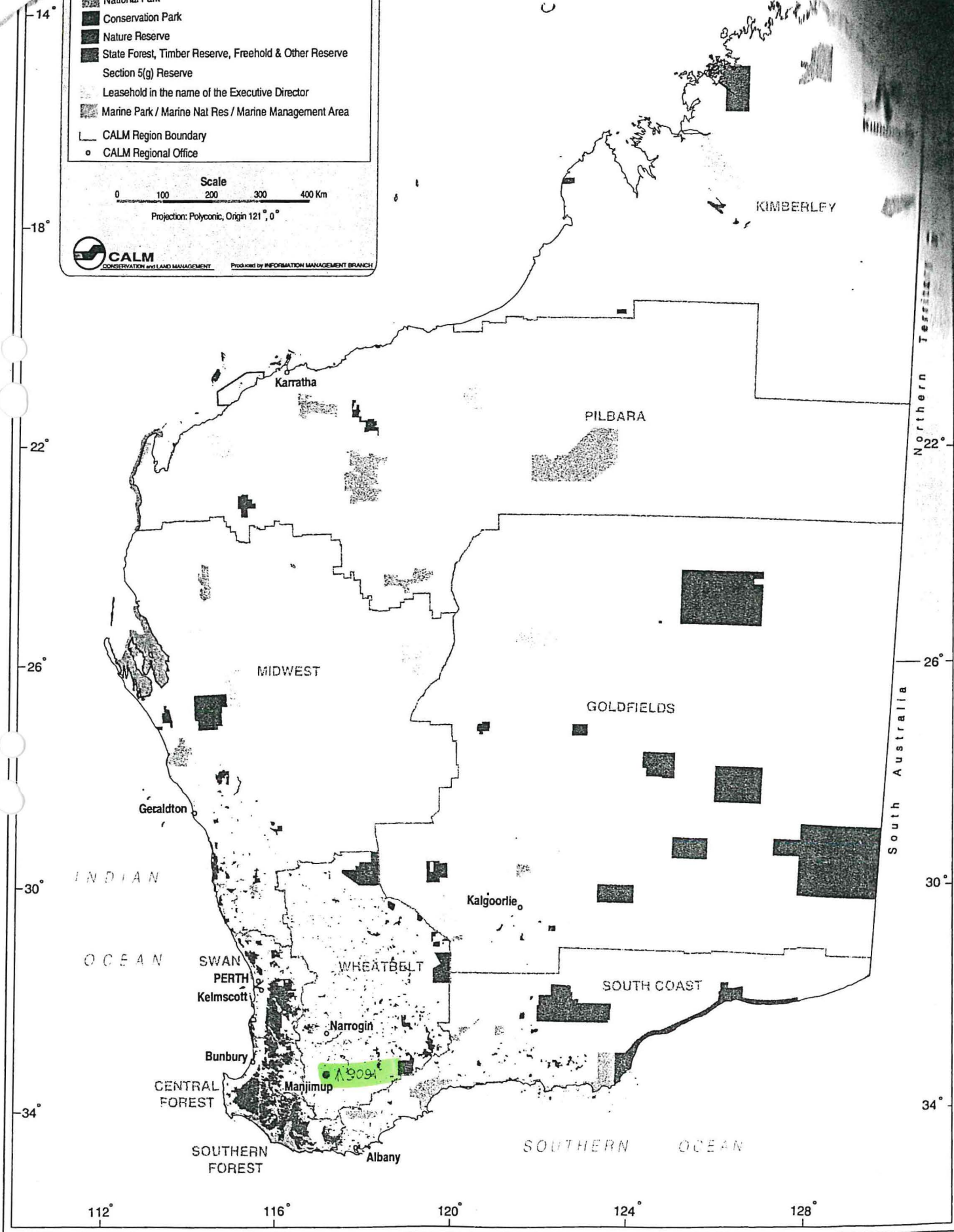

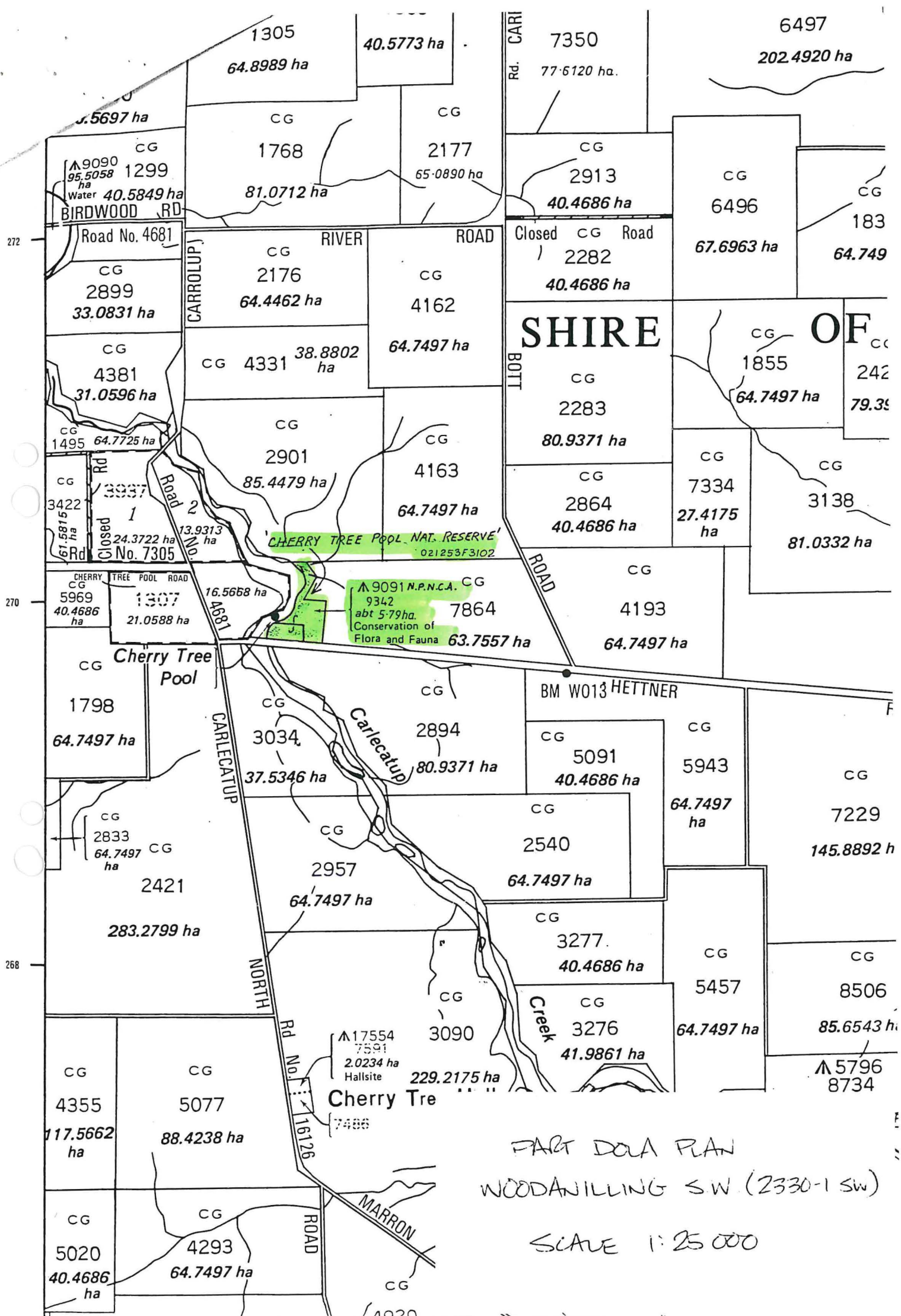

PART DOLA PLAN
 WOODANILLING SW (2330-1 SW)
 SCALE 1:25 000

NAMING OF RESERVES

Department of Land Administration,
Perth, 18 December 1987.

Corres. No. 3583/981.

IT is hereby notified for general information that the Reserves listed in the Schedule hereunder by this notice named in accordance with the said Schedule.

Schedule

Reserve No.; Name; Public Plan.

- 24257 and 26756; Bampunup Nature Reserve; Gingin SE 1:25 000.
31241; Yeal Nature Reserve; Gingin SW 1:25 000.
A983; Lake Wannamal Nature Reserve; Wannamal NW, SW 1:25 000.
30618; South Mimegarra Nature Reserve; Yatheroo Walvengarra 1:50 000.
7504; Karakin Nature Reserve; Lancelin NE 1:25 000.
29538; Chitterling Lakes Nature Reserves; Chitterling SW 1:25 000. Bindoon 02, 27.07, 27.08.
4070; Barracca Nature Reserve; Jumperkine NW 1:25 000.
37060; Chandala Nature Reserve; Muchea NE, Gingin SE 1:25 000.
23201; Wyening Nature Reserve; Mortlock River SW 1:25 000.
20738; Koodjee Nature Reserve; 50/80 C, D3, 4.
7615; Sevenmile Well Nature Reserve; Wannamal NE 1:25 000.
26841; Moganmoganing Nature Reserve; Calligrin W, SW; Wannamal NE 1:25 000.
17655; Glendale Nature Reserve; Mortlock River SW, Calingri SW 1:25 000.
23316; Namban Nature Reserve; Tanche 1:50 000.
28674; Manaling Nature Reserve; Tanche 1:50 000.
A2736; Martinjinni Nature Reserve; Miling 1:50 000.
7765; Karamarra Nature Reserve; Moora 10 4.3.
A25210; Pinjarrega Nature Reserve; 90/80 B1 and 2.
24618; Capamauro Nature Reserve; 90/80 BC1, 95/80 BC4.

N. J. SMYTH,
Executive Director.

NAMING OF RESERVES

Department of Land Administration,
Perth, 18 December 1987.

Corres. No. 3583/981.

IT is hereby notified for general information that the Reserves listed in the Schedule hereunder by this notice named in accordance with the said Schedule.

Schedule

Reserve No.; Name; Public Plan.

- 23602; Gunyidi Nature Reserve; 90/80 CD4.
29073; Lake Logue Nature Reserve; Beagle Is. and Logue 1:50 000.
29806; Wolto Nature Reserve; Eneabba 1:50 000.
16144; Capel Nature Reserve; Capel NW 1:25 000.
A25446; Powlalup Nature Reserve; Balingup NE 1:25 000.
27080; Broadwater Nature Reserve; Broadwater SOB 5D, 6D, 33.
A31634; Sugar Loaf Rock Nature Reserve; Yallingup NW 1:25 000.
20258; Walburra Nature Reserve; Cowaramup NW, Pt Mentellene 1:25 000.
A31188; Sabina Nature Reserve; Busselton 10, 6.8.
23321; Fish Road Nature Reserve; Busselton SE 1:25 000.
37010; Haag Nature Reserve; Yallingup SE 1:25 000.
30626; Gingilup Swamps Nature Reserve; White Point NE, Lake Jasper NW 1:25 000.
32142; Wilgarup Nature Reserve; 439C/40.
A30217; Redhill Nature Reserve; Dinninup NE, Qualeup NW 1:25 000.
18239; Kulikup Nature Reserve; Kulikup Townsite.
8167; Narlingup Nature Reserve; Qualeup NE 1:25 000.
15388; Mettabinup Nature Reserve; Qualeup SW, Lake Clabburn NW 1:25 000.

- 9091; Cherry Tree Pool Nature Reserve; Woodanilling SW 1:25 000.
9920; Maragoonda Nature Reserve; Woodanilling SW 1:25 000.
17759; Jingalup Nature Reserve; Vannup NW, Kojonup SW 1:25 000.

N. J. SMYTH,
Executive Director.

NAMING OF RESERVES

Department of Land Administration,
Perth, 18 December 1987.

Corres. No. 3583/981.

IT is hereby notified for general information that the Reserves listed in the Schedule hereunder by this notice named in accordance with the said Schedule.

Schedule

Reserve No.; Name; Public Plan

- 17760; South Jingalup Nature Reserve; Uannup NW, Lake Clabburn NE 1:25 000.
27769; Birdwood Nature Reserve; Boscabel SE 1:25 000.
A9307; Mongelup Nature Reserve; Uannup SW 1:25 000.
A16031; Cootlayerup Nature Reserve; 438C/40F4.
A16568; Wandoora Nature Reserve; 437D/40A4.
9308 and 24677; Yellerup Nature Reserve; 437d/40A4, Uannup SW 1:25 000.

N. J. SMYTH,
Executive Director.

PARKS AND RESERVES ACT 1895

Revocation of Appointment

Department of Land Administration,
Perth, 18 December 1987.

File 1073/969V2.

HIS Excellency the Governor, by and with the advice and consent of the Executive Council hereby revokes under the provisions of the Parks and Reserves Act 1895 the appointment of the National Parks Board of Western Australia as a Board to control and manage Class "A" Reserve No. 32376 (Sussex Location 4608) "National Park".

N. J. SMYTH,
Executive Director.

BODDINGTON TOWNSITE

Amendment of Boundaries

Department of Land Administration,
Perth, 18 December 1987.

File No. 3330/11.

HIS Excellency the Governor in Executive Council has been pleased to approve, under section 10 of the Land Act 1933 of the amendment of the boundaries of Boddington Townsite to include the area described in the Schedule hereunder.

Schedule

All that portion of land bounded by lines starting from the southernmost northeastern corner of Williams Location 15740, as surveyed and shown on Department of Land Administration Original Plan 16453, a point on a present western boundary of Boddington Townsite, and extending northwesterly, northerly and northeasterly along boundaries of that lot to its northernmost southeastern corner, a point on a present western boundary of Boddington Townsite, and thence southerly along that boundary to the starting point.

(Public Plans Boddington Townsite and Marradong NE 1:25 000.)

N. J. SMYTH,
Executive Director. 17.88

records, please file + return to @lands clerk.

30-12-87

CLERK WOODANILLING

021253 F 3102

9091

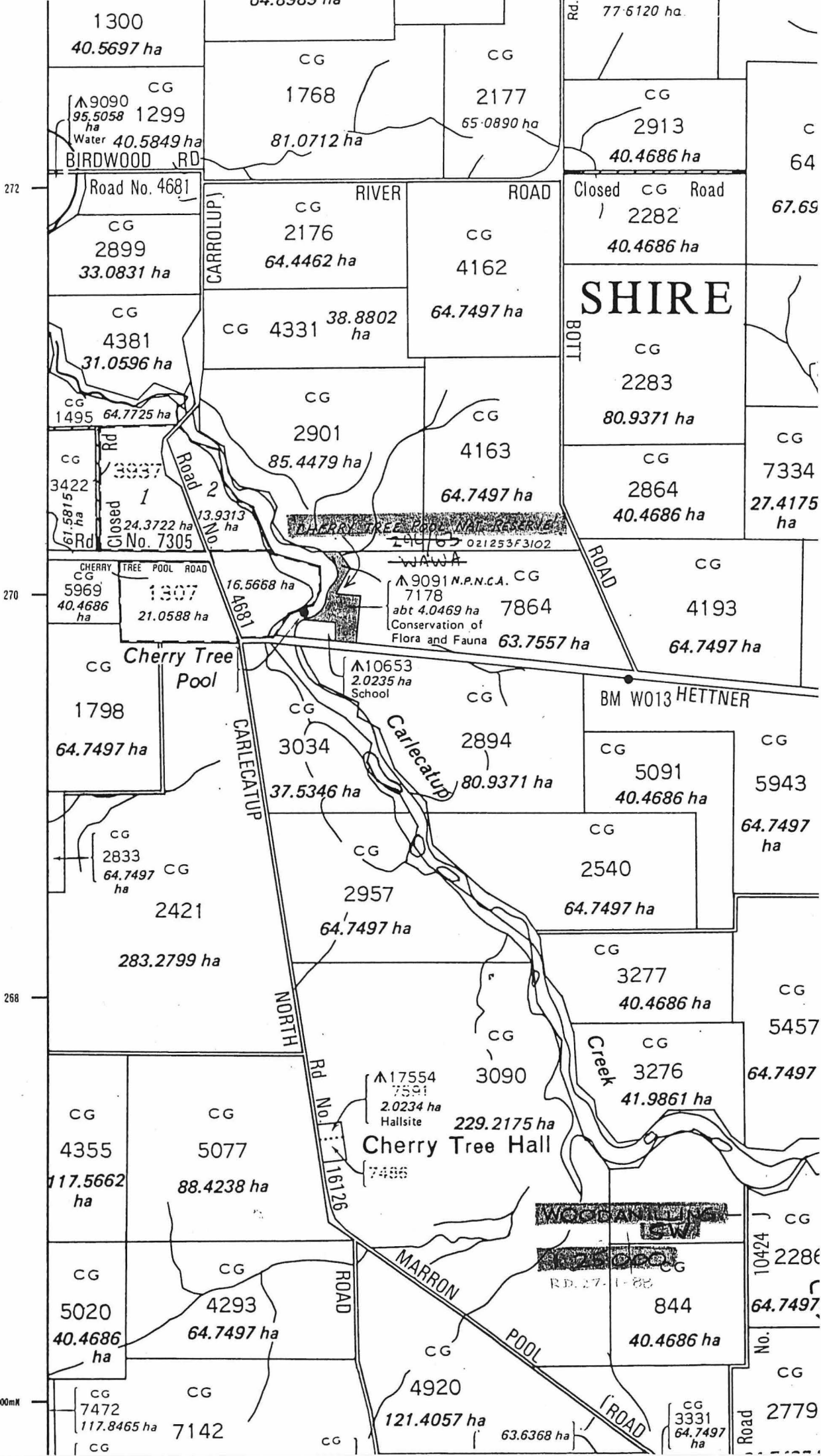

1300
40.5697 ha

CG
1768

CG
2177

Rd 77-6120 ha.

CG
A9090
95.5058 ha
Water 40.5849 ha
BIRWOOD RD

81.0712 ha

65-0890 ha

CG
2913
40.4686 ha

C
64

272
Road No. 4681

CG RIVER

ROAD

Closed CG Road
2282

67.69

CG
2899
33.0831 ha

CG
2176
64.4462 ha

CG
4162

SHIRE

CG
2283
80.9371 ha

CG

CG
4381
31.0596 ha

CG 4331 38.8802 ha

64.7497 ha

BOTT

CG

CG
1495 64.7725 ha

CG
2901

CG
4163

CG
2864
40.4686 ha

CG
7334

CG
3422
61.5815 ha
Closed Rd
Rd No. 7305

CG
3937
24.3722 ha

CG
3937
13.9313 ha

CG
2901
85.4479 ha

64.7497 ha

CHERRY TREE POOL ROAD
JAWA
A9091 N.P.N.C.A. CG
7178
abt 4.0469 ha
Conservation of
Flora and Fauna

021 253 F 3102

ROAD

27.4175 ha

270
CHERRY TREE POOL ROAD

CG
5969
40.4686 ha

CG
1307
16.5668 ha
21.0588 ha

CG
7864
63.7557 ha

CG
4193
64.7497 ha

CG
1798
64.7497 ha
Cherry Tree Pool

A10653
2.0235 ha
School

CG
2894

BM W013 HETTNER

CG
5091
40.4686 ha

CG
5943

CG
2833
64.7497 ha

CG
3034
37.5346 ha

CG
80.9371 ha

CG
2540
64.7497 ha

64.7497 ha

268

CG
2421
283.2799 ha

CG
2957
64.7497 ha

CG
3277
40.4686 ha

CG
5457

CG
4355
117.5662 ha

CG
5077
88.4238 ha

A17554
7591
2.0234 ha
Hall site
Cherry Tree Hall

CG
3090

CG
3276
41.9861 ha

64.7497

CG
5020
40.4686 ha

CG
4293
64.7497 ha

MARRON ROAD
ROAD

CG
844
40.4686 ha

CG
2286

E266000mN

CG
7472
117.8465 ha

CG
7142

CG
4920
121.4057 ha

63.6368 ha

CG
3331
64.7497 ha

CG
2779

Road No.

NATURE RESERVE

RESERVE NO: 9091

GOVERNMENT GAZETTE
Date Page No.

FILE NUMBER: 296/63

PURPOSE: Cons. of Flora 31.12.69 4371
& Fauna

NAME: Cherry Tree Pool

CLASS (Land Act):

AREA: 4.0469 ha 7.7.22 1312

VESTING: W.A.W.A. 31.12.69 4364

LOCATION NO(S): Kojonup 7178

CLASSIFICATION:
(Wildlife Act
Section 12A)

LITHO: Woodanilling 40 Sheet 3-
416B/40

LOCAL AUTHORITY: KOJONUP SHIRE

Notes:

FORMER TENURE
Loc 7178 (A9091)
A10653

ON PLAN/DIAGRAM
Comp. Kojonup 218

2901
O.P. Kojonup 301

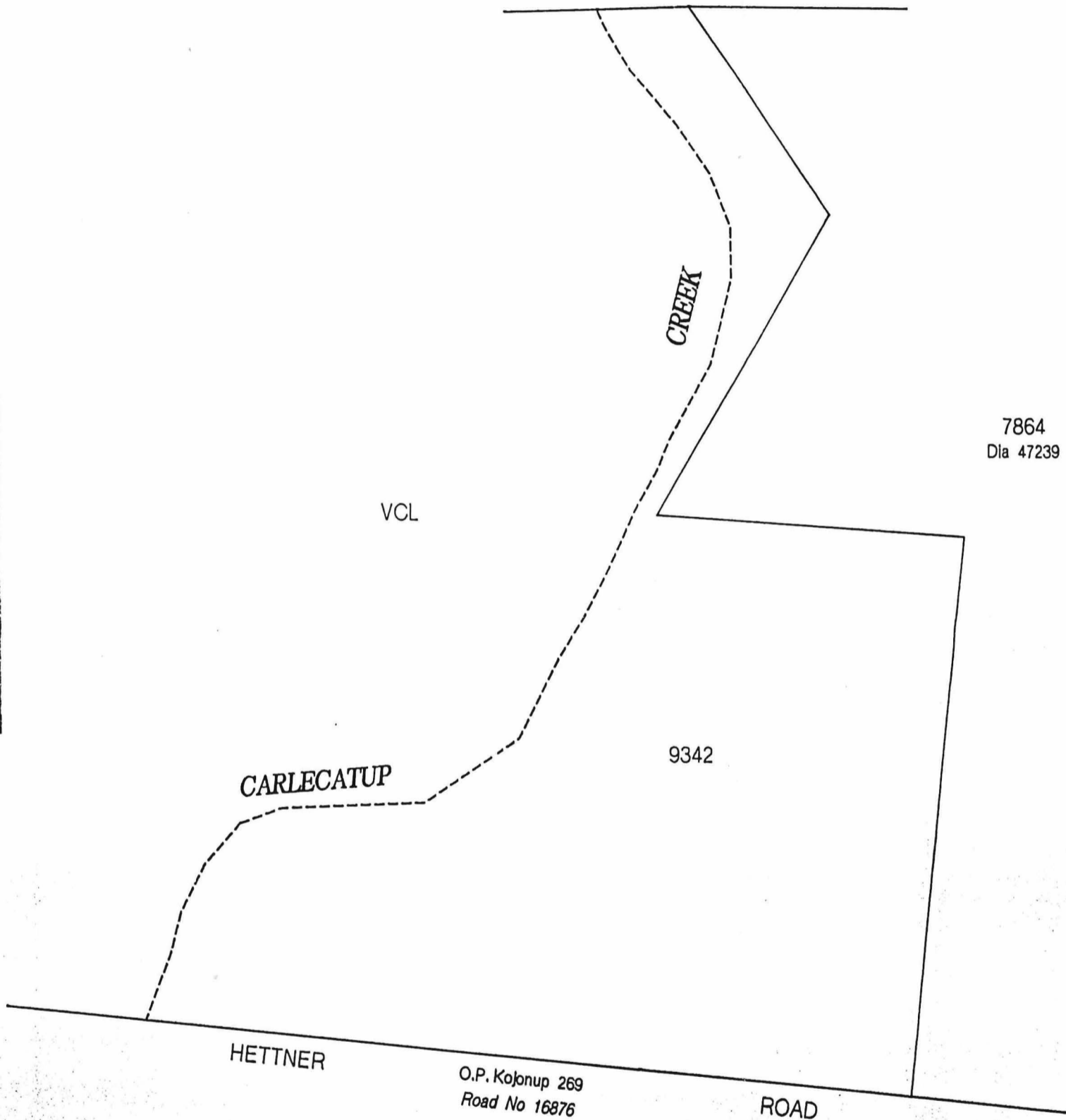

7864
Dia 47239

VCL

9342

CARLECATUP

HETTNER

O.P. Kojonup 269
Road No 16876

ROAD

CREEK



KOJONUP LOCATION 9342 CREATED ON THIS DIAGRAM
WATERLINES ON THIS DIAGRAM DO NOT NECESSARILY DEPICT AN EXACT CADASTRAL BOUNDARY
GRAPHICS AND ABOUT AREAS HAVE BEEN DERIVED FROM DOLA'S SPATIAL CADASTRAL DATA BASE

RESERVE No 9091 AREA <i>abt 5.79 ha</i>		FILE No. 2528/1989
Purpose <i>Conservation of Flora & Fauna</i>		SCALE 1:2000 <small>All measurements in metres</small>
DISTRICT KOJONUP	SUBJECT TO SURVEY	
Public Plan WOODANILLING (25) S.W.	AMENDMENTS	
Reference Comp. Kojonup 218 Page	Gazette	Page
Prepared by PAUL NUTTALL Date 23/1/1998		Initials
Checked <i>G. MARSHALL</i> Date		
Ex. Min. 3/93		
Approved <i>Paul Nuttall</i> Date <i>21.4.98</i>		
Manager Statutory Services		
		Gazetted Ex. Min. 3/93
		Recorded on Public Plan
		Registered PAUL NUTTALL for Manager Statutory Services.
		On S.I.P. WOODANILLING (25) S.W.
		DEPT. OF LAND ADMINISTRATION MISCELLANEOUS DIAGRAM No. 720

Cherry tree pool.

0 21253F3102