

RESERVE ACTION SHEET - CONSERVATION RESERVES

RESERVE No. A9868 CITY: Wanneroo NAME: Yanchep National Park

REASON FOR ACTION

Swan Locations 11544 and 13712 have been added to class A reserve 9868, Yanchep National Park.

Area:
 Added – 34.2895 ha
 Total – 2876.4968 ha

The Ministry for Planning purchased the majority of the land in 1996. The Locations contain Beonaddy Swamp and wetland vegetation associated with Pipidinny Swamp. The additions are consistent with System 6 recommendation M3 and the *Yanchep National Park Management Plan 1989-99* section 11.2.3.

Date of amendment: 12 September 2002
 Plans at folios: pp. 99, 151 & 162-5
 Native title clearance: previous freehold history
 IUCN classification: 1a

Customer Advice: p. 150
 Folio: pp. 150 & 152-4

OFFICER	ACTION	
1 LAND UNIT	Send copies of advice & maps to: - Lisa Wright, Woodvale - Manager, Swan Coastal District - Manager, Swan Region	<div style="text-align: right; color: blue;">✓ 6/1/05 ev</div> <hr/> <hr/>
2 SENIOR POLICY OFFICER, PVS	to note native title clearance:	<hr/>
3 DIRECTOR, PARKS & VISITOR SERVICES	to note:	<hr/>
6 CIS	to record the locations on files reference	<hr/>
7 LAND UNIT	reserve details to inside cover:	<hr/>

**Customer Advices for Reserve Actions
1/04/2003 - 30/04/2003**

City of Wanneroo 1/04/2003 - 30/04/2003

Reserve No.	Land Description	DOLA File No.	Volume/Folio	Action	Document No.	Registered	Street Name	Area	Public Plans
44915	Swan Location 12249 on Office of Titles Plan 17935	00894-1995-01RO	3105-314	Reserve Cancellation "Foreshore Management"	I233537	12/09/2002	Near Beonaddy Swamp, Eglinton.	5.6708 Ha	BG35 (10) 1.5
9868	Swan Location 11544 on Land Administration Plan 17799	00894-1995-01RO	3093-635	Revocation of Management Order (NP & NCA) for the designated purpose of "National Park".	I233538	12/09/2002	In the vicinity of Wanneroo, Yanchep Beach, Pipidinny and Waiding Roads, Yanchep, Eglinton and Carabooda.	2876.4968 Ha	BG35 (10) 1.5, Yanchep NE and Part NW (25)
9868 9868 9868	Swan Location 11544 on Land Administration Plan 17799, Swan Location 13711 on Office of Titles Diagram 90753 and Swan Location 13712 on Deposited Plan 194893.	01179-1903-05RO	3093-635	Management Order to Conservation Commission of Western Australia Corner Hackett Drive and Australia II Drive CRAWLEY WA 6009 To be utilised for the designated purpose only for the designated purpose of "National Park"	I233540	12/09/2002	In the vicinity of Wanneroo, Yanchep Beach, Pipidinny and Waiding Roads, Yanchep, Eglinton and Carabooda.	2876.4968 Ha	BG35 (10) 1.5, Yanchep NE & Pt NW (25)
A 9868	Swan Location 11544 on Deposited Plan 217799.	00894-1995-01RO	3093-635	Amendment of Reserve to To now comprise Swan Location 11544 on Deposited Plan 217799, Swan Location 13712 on Deposited Plan 194893 and Swan Location 13711 on Office of Titles Diagram 90753, and with its area being increased to 2876.4968 hectares, accordingly.	I233539	12/09/2002	Waiding Road	2876.4968 Ha	BG35 (10) 1.5, Yanchep NE & Pt NW (25)

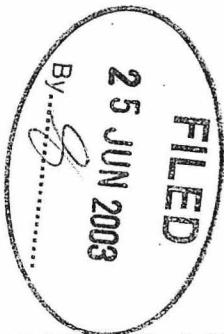



QUALIFIED CERTIFICATE OF CROWN LAND TITLE

UNDER THE TRANSFER OF LAND ACT 1893 AND THE LAND ADMINISTRATION ACT 1997

VOLUME LR 3118 FOLIO 186



NO DUPLICATE CREATED

The undermentioned land is Crown land in the name of the STATE of WESTERN AUSTRALIA, subject to the interests and Status Orders shown in the first schedule which are in turn subject to the limitations, interests, encumbrances and notifications shown in the second schedule.

J. Hyde



LAND DESCRIPTION:

REGISTRAR OF TITLES

LOT 13711 ON DIAGRAM 90753

STATUS ORDER AND PRIMARY INTEREST HOLDER: (FIRST SCHEDULE continued overleaf)

STATUS ORDER/INTEREST: RESERVE UNDER MANAGEMENT ORDER

PRIMARY INTEREST HOLDER: CONSERVATION COMMISSION OF WESTERN AUSTRALIA OF CORNER HACKETT DRIVE AND AUSTRALIA II DRIVE, CRAWLEY.

(XE I233540) REGISTERED 12 SEPTEMBER 2002

LIMITATIONS, INTERESTS, ENCUMBRANCES AND NOTIFICATIONS: (SECOND SCHEDULE continued overleaf)

- 1. I233539 PART CLASS A RESERVE 9868 FOR THE PURPOSE OF NATIONAL PARK. REGISTERED 12.9.2002. I233540 MANAGEMENT ORDER. CONTAINS CONDITIONS TO BE OBSERVED. REGISTERED 12.9.2002.

- Warning: (1) A current search of the sketch of the land should be obtained where detail of position, dimensions or area of the lot is required. Lot as described in the land description may be a lot or location. (2) The land and interests etc. shown hereon may be affected by interests etc. that can be, but are not, shown on the register. (3) The interests etc. shown hereon may have a different priority than shown.

-----END OF CERTIFICATE OF CROWN LAND TITLE-----

STATEMENTS:

The statement set out below are not intended to be nor should they be relied on as substitutes for inspection of the land and the relevant documents or for local government, legal, surveying or other professional advice.

SKETCH OF THE LAND: DIA 90753
PREVIOUS TITLE: 2075-476
PROPERTY STREET ADDRESS: NO STREET ADDRESS INFORMATION AVAILABLE.
LOCAL GOVERNMENT AREA: NO LOCAL GOVERNMENT AUTHORITY INFORMATION AVAILABLE.

NOTE 1: A000001A CORRESPONDENCE FILE 00894-1995-01RO
NOTE 2: LAND PARCEL IDENTIFIER OF SWAN LOCATION 13711 CHANGED TO LOT 13711 ON DIAGRAM 90753 ON 12-SEP-02 TO ENABLE ISSUE OF A DIGITAL CERTIFICATE OF TITLE.

END OF PAGE 1 - CONTINUED OVER

FORM LAA-1023

SECTION 46

WESTERN AUSTRALIA
LAND ADMINISTRATION ACT 1997
TRANSFER OF LAND ACT 1893 AS AMENDED

MANAGEMENT ORDER (XE)

RESERVE DESCRIPTION (NOTE 1)

EXTENT

VOLUME

FOLIO

9868	Whole	3093	635
9868	Whole	3118	186
9868	Whole	3118	187

MANAGEMENT BODY (NOTE 2)

Conservation Commission of Western Australia
Corner Hackett Drive and Australia II Drive
CRAWLEY WA 6009

CONDITIONS (NOTE 3)

To be utilised for the designated purpose of "National Park" only.

THE MINISTER FOR LANDS (IN THE NAME OF AND ON BEHALF OF THE STATE OF WESTERN AUSTRALIA) ORDERS THAT THE CARE, CONTROL AND MANAGEMENT OF THE ABOVE RESERVE BE PLACED WITH THE ABOVE DESCRIBED MANAGEMENT BODY FOR THE PURPOSE FOR WHICH THE LAND IS RESERVED UNDER SECTION 41 OF THE LAND ADMINISTRATION ACT 1997, AND FOR PURPOSES ANCILLARY OR BENEFICIAL TO THAT PURPOSE SUBJECT TO THE CONDITIONS STATED ABOVE

Dated this 12th day of SEPTEMBER in the year 2002

ATTESTATION

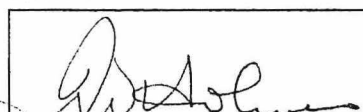

PROJECT OFFICER
METROPOLITAN REGION
LAND ADMINISTRATION SERVICES

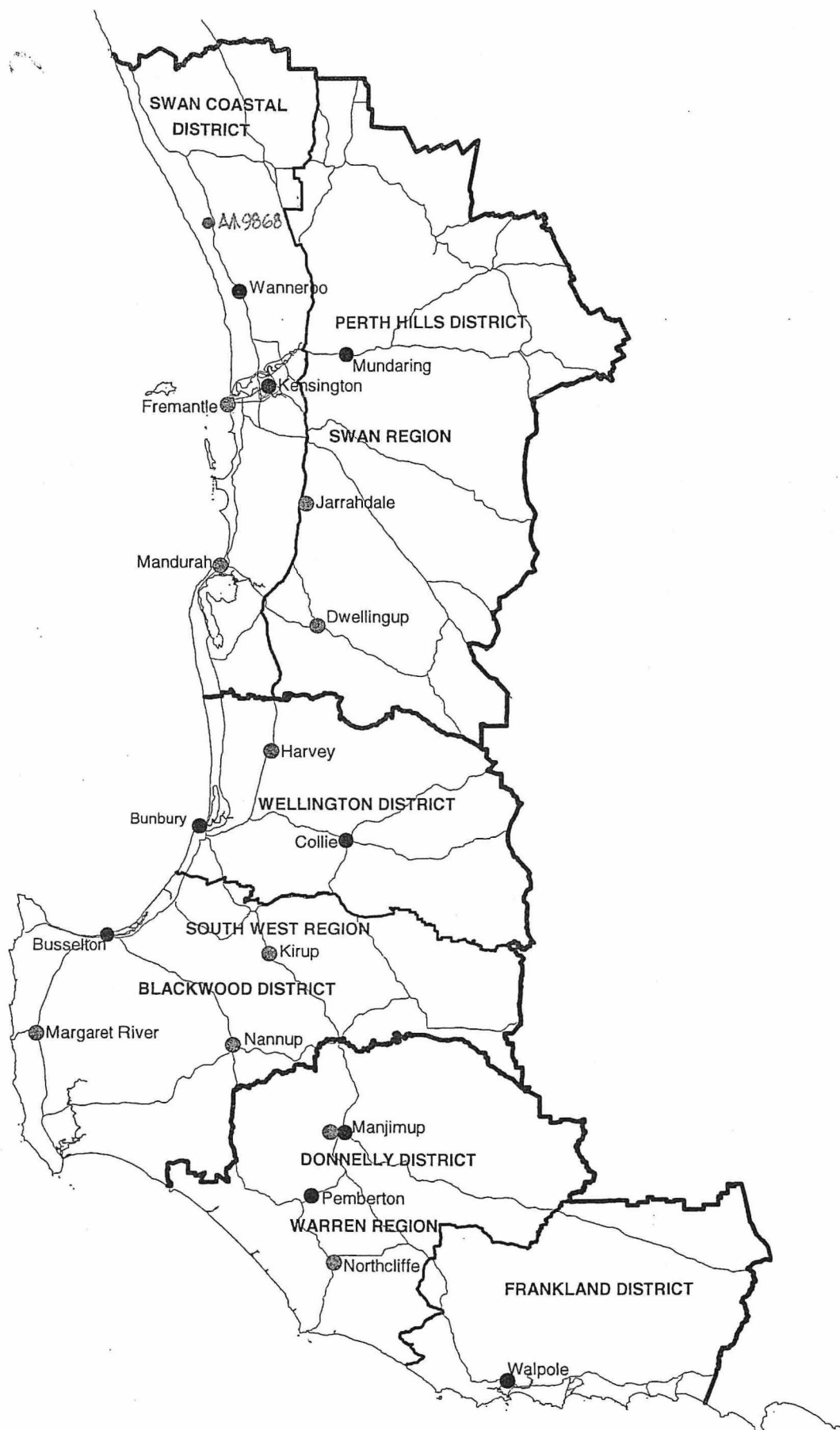

**DEPARTMENT OF CONSERVATION AND LAND MANAGEMENT
 REGION AND DISTRICT BOUNDARIES - SOUTH WEST W A
 OCTOBER 2001**

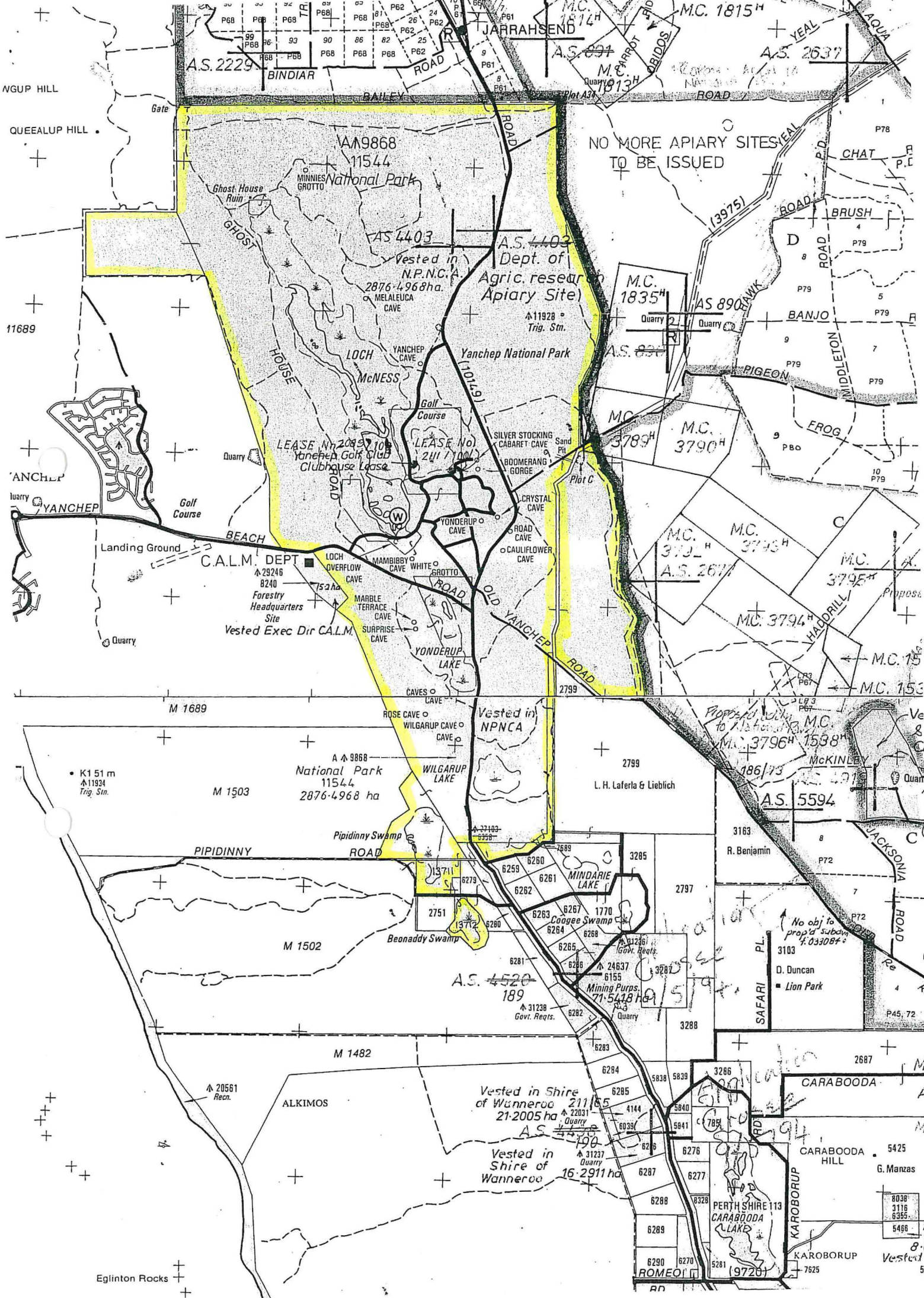

NGUP HILL

QUEEALUP HILL

11689

ANCHER

YANCHEP

Quarry

Golf Course

Landing Ground

Quarry

BEACH

C.A.L.M. DEPT

Forestry Headquarters Site

Vested Exec Dir CALM

Quarry

M 1689

K 151 m

11934 Trig. Stn.

M 1503

National Park 11544

2876-4968 ha

WILGARUP LAKE

Pipidiny Swamp

PIPIDINNY ROAD

M 1502

Beonaddy Swamp

M 1482

20561 Recn.

ALKIMOS

Vested in Shire of Wanneroo

21,2005 ha

Vested in Shire of Wanneroo

16,2911 ha

PERTH SHIRE 113

CARABOODA LAKE

ROMEO

A.S. 2229

BINDIAR

Ghost House Ruin

MINNIE'S GROTTTO

AS 4403

Vested in N.P.N.C.A.

2876-4968ha

MELALEUCA CAVE

YANCHEP CAVE

McNESS

Golf Course

LEASE No. 2089/108

Yanchech Golf Club Clubhouse Lease

LEASE No. 241/1100

SILVER STOCKING CABARET CAVE

BOOMERANG GORGE

CRYSTAL CAVE

ROAD CAVE

CAULIFLOWER CAVE

YONDERUP CAVE

LOCH OVERFLOW CAVE

MAMMIBBY CAVE

WHITE GROTTTO

MARBLE TERRACE CAVE

SURPRISE CAVE

ROSE CAVE

WILGARUP CAVE

WILGARUP LAKE

MINDARIE LAKE

Coogee Swamp

Mining Purps. 71-5418 ha

Govt. Reqts.

Quarry

Govt. Reqts.

Quarry

Govt. Reqts.

Quarry

Govt. Reqts.

Quarry

Govt. Reqts.

Quarry

Govt. Reqts.

Quarry

Govt. Reqts.

Quarry

AM9868

11544

National Park

AS 4403

Vested in N.P.N.C.A.

2876-4968ha

MELALEUCA CAVE

YANCHEP CAVE

McNESS

Golf Course

LEASE No. 2089/108

Yanchech Golf Club Clubhouse Lease

LEASE No. 241/1100

SILVER STOCKING CABARET CAVE

BOOMERANG GORGE

CRYSTAL CAVE

ROAD CAVE

CAULIFLOWER CAVE

YONDERUP CAVE

LOCH OVERFLOW CAVE

MAMMIBBY CAVE

WHITE GROTTTO

MARBLE TERRACE CAVE

SURPRISE CAVE

ROSE CAVE

WILGARUP CAVE

WILGARUP LAKE

MINDARIE LAKE

Coogee Swamp

Mining Purps. 71-5418 ha

Govt. Reqts.

Quarry

Govt. Reqts.

Quarry

Govt. Reqts.

Quarry

Govt. Reqts.

Quarry

Govt. Reqts.

Quarry

Govt. Reqts.

Quarry

Govt. Reqts.

Quarry

Govt. Reqts.

AS 4403

Vested in N.P.N.C.A.

2876-4968ha

MELALEUCA CAVE

YANCHEP CAVE

McNESS

Golf Course

LEASE No. 2089/108

Yanchech Golf Club Clubhouse Lease

LEASE No. 241/1100

SILVER STOCKING CABARET CAVE

BOOMERANG GORGE

CRYSTAL CAVE

ROAD CAVE

CAULIFLOWER CAVE

YONDERUP CAVE

LOCH OVERFLOW CAVE

MAMMIBBY CAVE

WHITE GROTTTO

MARBLE TERRACE CAVE

SURPRISE CAVE

ROSE CAVE

WILGARUP CAVE

WILGARUP LAKE

MINDARIE LAKE

Coogee Swamp

Mining Purps. 71-5418 ha

Govt. Reqts.

Quarry

Govt. Reqts.

Quarry

Govt. Reqts.

Quarry

Govt. Reqts.

Quarry

Govt. Reqts.

Quarry

Govt. Reqts.

Quarry

Govt. Reqts.

Quarry

Govt. Reqts.

Quarry

Govt. Reqts.

Quarry

AS 4403

Vested in N.P.N.C.A.

2876-4968ha

MELALEUCA CAVE

YANCHEP CAVE

McNESS

Golf Course

LEASE No. 2089/108

Yanchech Golf Club Clubhouse Lease

LEASE No. 241/1100

SILVER STOCKING CABARET CAVE

BOOMERANG GORGE

CRYSTAL CAVE

ROAD CAVE

CAULIFLOWER CAVE

YONDERUP CAVE

LOCH OVERFLOW CAVE

MAMMIBBY CAVE

WHITE GROTTTO

MARBLE TERRACE CAVE

SURPRISE CAVE

ROSE CAVE

WILGARUP CAVE

WILGARUP LAKE

MINDARIE LAKE

Coogee Swamp

Mining Purps. 71-5418 ha

Govt. Reqts.

Quarry

Govt. Reqts.

Quarry

Govt. Reqts.

Quarry

Govt. Reqts.

Quarry

Govt. Reqts.

Quarry

Govt. Reqts.

Quarry

Govt. Reqts.

Quarry

Govt. Reqts.

Quarry

Govt. Reqts.

Quarry

AS 4403

Vested in N.P.N.C.A.

2876-4968ha

MELALEUCA CAVE

YANCHEP CAVE

McNESS

Golf Course

LEASE No. 2089/108

Yanchech Golf Club Clubhouse Lease

LEASE No. 241/1100

SILVER STOCKING CABARET CAVE

BOOMERANG GORGE

CRYSTAL CAVE

ROAD CAVE

CAULIFLOWER CAVE

YONDERUP CAVE

LOCH OVERFLOW CAVE

MAMMIBBY CAVE

WHITE GROTTTO

MARBLE TERRACE CAVE

SURPRISE CAVE

ROSE CAVE

WILGARUP CAVE

WILGARUP LAKE

MINDARIE LAKE

Coogee Swamp

Mining Purps. 71-5418 ha

Govt. Reqts.

Quarry

Govt. Reqts.

Quarry

Govt. Reqts.

Quarry

Govt. Reqts.

Quarry

Govt. Reqts.

Quarry

Govt. Reqts.

Quarry

Govt. Reqts.

Quarry

Govt. Reqts.

Quarry

Govt. Reqts.

Quarry

AS 4403

Vested in N.P.N.C.A.

2876-4968ha

MELALEUCA CAVE

YANCHEP CAVE

McNESS

Golf Course

LEASE No. 2089/108

Yanchech Golf Club Clubhouse Lease

LEASE No. 241/1100

SILVER STOCKING CABARET CAVE

BOOMERANG GORGE

CRYSTAL CAVE

ROAD CAVE

CAULIFLOWER CAVE

YONDERUP CAVE

LOCH OVERFLOW CAVE

MAMMIBBY CAVE

WHITE GROTTTO

MARBLE TERRACE CAVE

SURPRISE CAVE

ROSE CAVE

WILGARUP CAVE

WILGARUP LAKE

MINDARIE LAKE

Coogee Swamp

Mining Purps. 71-5418 ha

Govt. Reqts.

Quarry

Govt. Reqts.

Quarry

Govt. Reqts.

Quarry

Govt. Reqts.

Quarry

Govt. Reqts.

Quarry

Govt. Reqts.

Quarry

Govt. Reqts.

Quarry

Govt. Reqts.

Quarry

Govt. Reqts.

Quarry

AS 4403

Vested in N.P.N.C.A.

2876-4968ha

MELALEUCA CAVE

YANCHEP CAVE

McNESS

ADDITIONS TO YANCHEP NATIONAL PARK

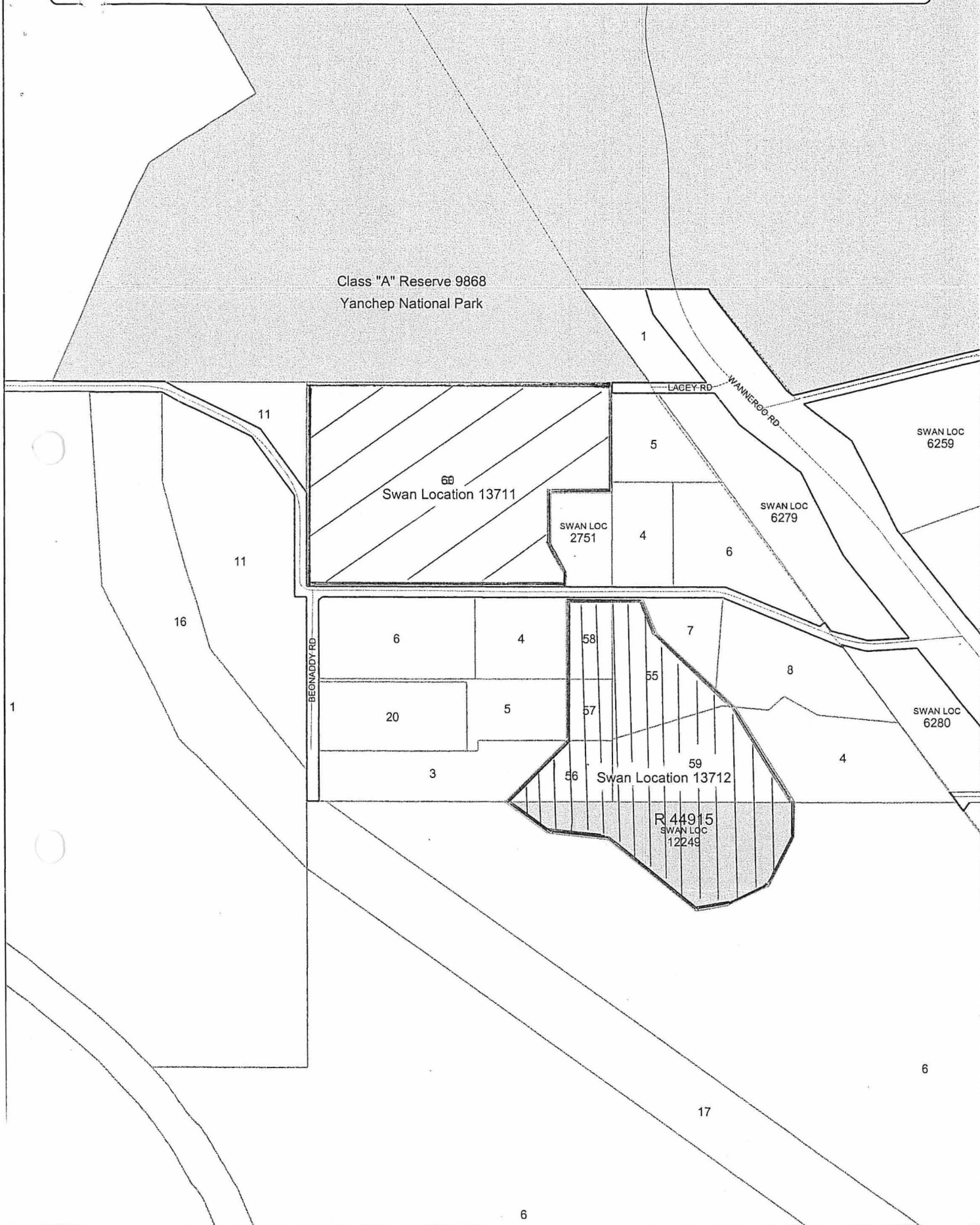

Scale : 1:8000 (Geographical)
MGA : SW=374572.9E,6503547.3N Zone 50 / NE=376155.2E,6506022.2N Zone 50
Lat/Long : 115°40'40.494",-31°35'46.825" / 115°41'41.641",-31°34'27.077" 263* 198

Printed : 15:33 Wed 27/Jun/2001
Crown Copyright Reserved May 1997

This product is for information purposes only and is not guaranteed. The information may be out of date and should not be relied upon without further verification from the original documents. Where the information is being used for legal purposes then the original documents must be searched for all legal requirements.

NATURE RESERVE

RESERVE NO: A9868

GOVERNMENT GAZETTE
Date Page No.

FILE NUMBER: 173/23

PURPOSE: Protection & Preservation
of Caves & Flora and for Health
& Pleasure Resort 25.8.1905 2790
NAME: Yanchep National Park

CLASS (Land Act): "A" 3 new blocks
(Locs) 19.11.76 4578

AREA: 2789.9558 +
9.0498 = 2799.0056 ha

VESTING: N.P.A.

LOCATION NO(S): Swan 6258, 7689, 7720. 19.11.76 4578
Swan 422, 4402, 6933, 3306-7

CLASSIFICATION:
(Wildlife Act
Section 12A)

LITHO: 28/80, 29/80

LOCAL AUTHORITY: WANNEROO SHIRE

Notes: