

RESERVE ACTION SHEET - CONSERVATION RESERVES

RESERVE No. 11153

REASON FOR ACTION

Creation of a new nature reserve, with a management order issued to the Conservation Commission for the purpose 'Conservation of Flora and Fauna'.

Area: 19.97 hectares

The reserve consists of three vegetation communities consisting of woodlands of salmon gum, York gum and gimlet, which are poorly represented on wheatbelt nature reserves. It contains many mature trees that provide nesting opportunities and shelter for a number of bird and mammal species. Furthermore, this reserve occurs low in the landscape, yet is presently unaffected by salt. Clearing may result in a rising local water table.

- Date of DOLA's advice: 24 October 2000 See folio: 17
- Plans at folios: 19,18

	OFFICER	ACTION
1	CONSERVATION ESTATE OFFICER	- Fill in above details ✓ - Attach copies of DOLA's advice to file ✓ Send copies of advice & maps to: - Lisa Wright, Woodvale ✓ - District Manager, Narrogin ✓ - Regional Manager, Narrogin ✓ Recommended IUCN classification: 1a
2	LAND ACQUISITIONS OFFICER	To note: _____
3	MANAGER, PLANNING & VISITOR SERVICES	To note & approve IUCN classification: _____
4	DIRECTOR, NATURE CONSERVATION/ NATIONAL PARKS	To note: _____
5	INDEX CLERK, RECORDS	To note: _____
6	CONSERVATION ESTATE OFFICER	Attach copy of Reserve Details to inside cover of new file _____

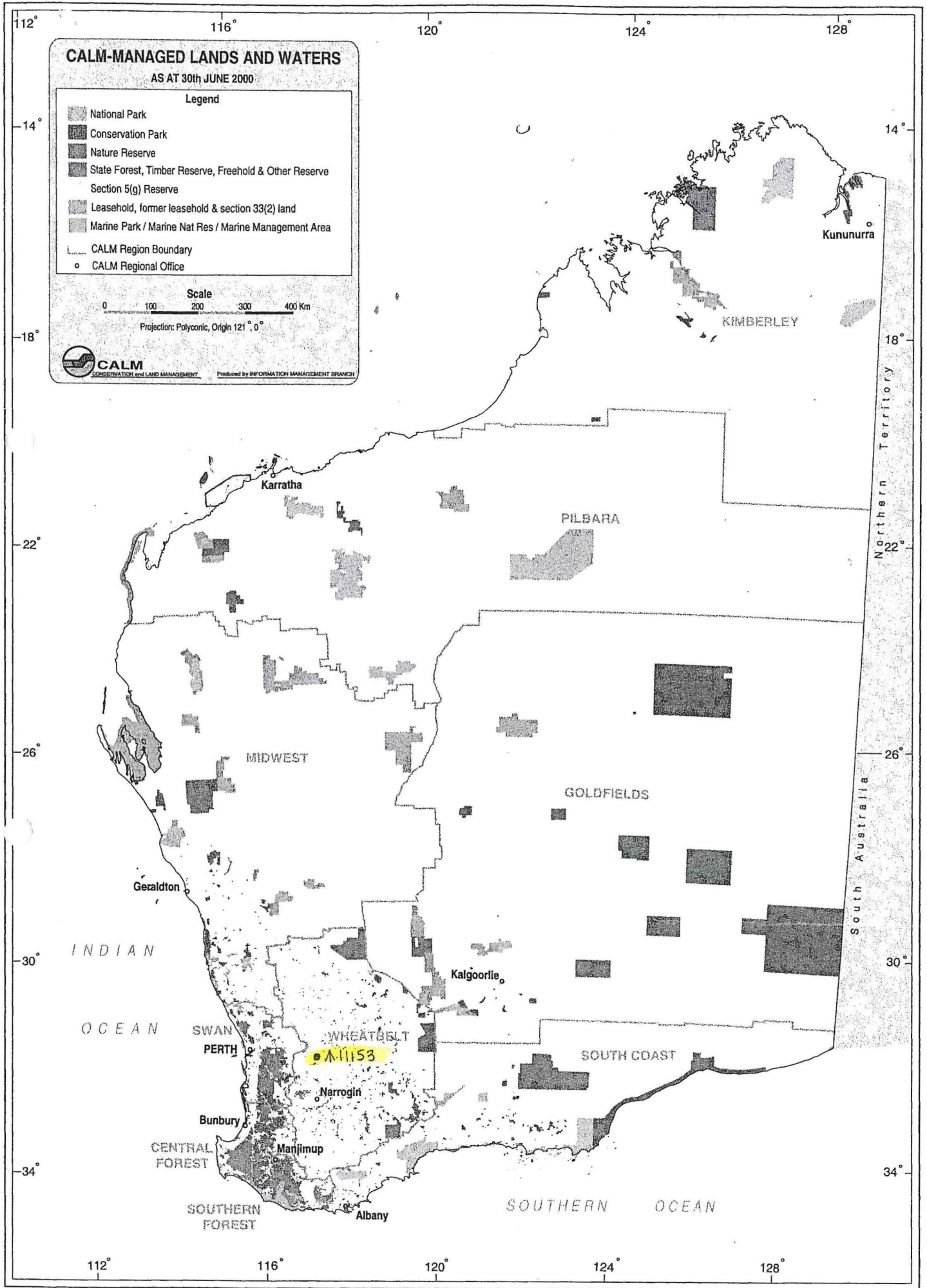

CALM-MANAGED LANDS AND WATERS
 AS AT 30th JUNE 2000

Legend

- National Park
- Conservation Park
- Nature Reserve
- Slate Forest, Timber Reserve, Freehold & Other Reserve
- Section 5(g) Reserve
- Leasehold, former leasehold & section 33(2) land
- Marine Park / Marine Nat Res / Marine Management Area
- CALM Region Boundary
- CALM Regional Office

Scale
 0 100 200 300 400 Km

Projection: Polyconic, Origin 121° 0'

CALM
 CONSERVATION and LAND MANAGEMENT
 Produced by INFORMATION MANAGEMENT BRANCH

Northern Territory

South Australia

INDIAN OCEAN

SOUTHERN OCEAN

KIMBERLEY

PILBARA

MIDWEST

GOLDFIELDS

WHEATBELT

SOUTH COAST

CENTRAL FOREST

SOUTHERN FOREST

Kununurra

Karratha

Geraldton

SWAN PERTH

Kalgoorlie

Narrogin

Bunbury

Manjimup

Albany

1153

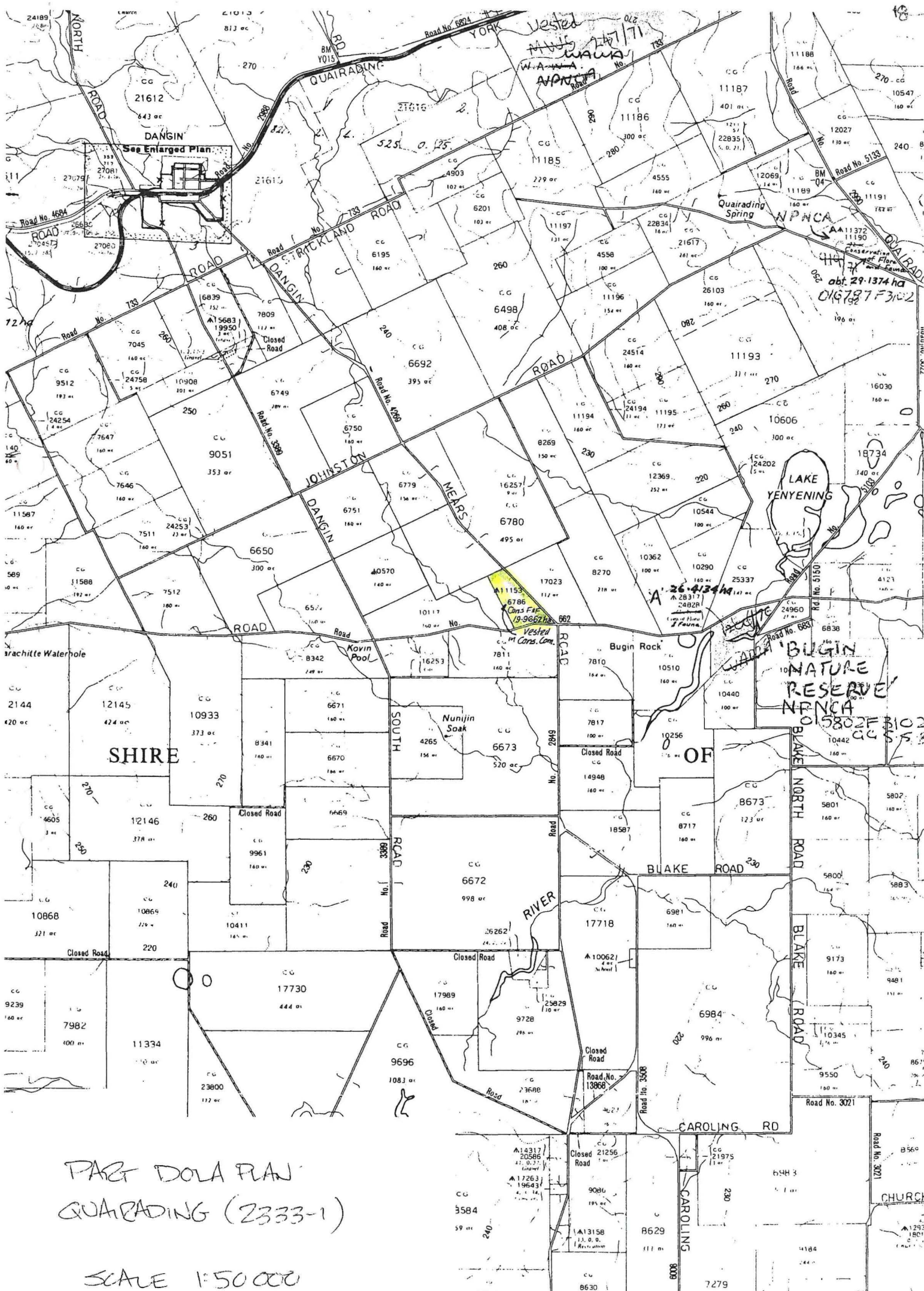

PART DOLA PLAN
 QUAIRADING (2333-1)

SCALE 1:50 000

**Customer Advices for Reserve Actions
1/02/2001 - 28/02/2001**

Shire of Quairading 1/02/2001 - 28/02/2001

Reserve No.	Land Description	DOLA File No.	Volume/Folio	Action	Document No.	Registered	Street Name	Area	Public Plans
11153	Avon Location 6786 on Land Administration Diagram 16822	10553-1904-01RO	3063-244	Change of Purpose to "Conservation of Flora and Fauna"	H606146	24/11/2000	Old Beverley Road	19.9662 Ha	Quairading NW (25)
11153		10553-1904-01RO	3063-244	Revocation of Management Order (Water & Rivers Commission) for the designated purpose of "Water".	H606145	24/11/2000	Old Beverley Road	19.9662 Ha	Quairading NW (25)