

NATURE RESERVE

RESERVE NO: 12049

GOVERNMENT GAZETTE  
Date Page No.

FILE NUMBER: 944/76

PURPOSE: Water & Cons. of  
Flora & Aquatic Life 21.11.58 3032

NAME:

CLASS (Land Act):

AREA: 79.4196 ha

VESTING:

LOCATION NO(S): Wellington Loc. 1071

CLASSIFICATION:  
(Wildlife Act  
Section 12A)

LITHO: 383A/80 B2

LOCAL AUTHORITY: HARVEY SHIRE

Notes:

W 944/76

133



DEPARTMENT OF LANDS AND SURVEYS

Cathedral Avenue,  
Perth,  
Western Australia 6000

Department of Conservation  
and Land Management  
9 - JUL 1986  
COMO, W.A.

Your Ref. W944/76  
Our Ref. 1727/09 CN:AP  
Telephone Enquiries 323 1278

EXECUTIVE DIRECTOR  
DEPARTMENT OF CONSERVATION AND LAND  
MANAGEMENT

12049

SYSTEM 6 - IMPLEMENTATION OF REDBOOK RECOMMENDATION C60 -  
RESERVES C12049 AND C12632 HARVEY

Further to your memo of January 28, 1986 I advise for your information that Executive Council has approved of the purpose of Reserve No. 12049 (Wellington Location 1071) being changed from "Water and Conservation of Flora and Aquatic Life" to "Conservation of Flora and Fauna, and Water" and issued an Order in Council directing that Reserve No. 12049 shall vest in and be held by the National Parks and Nature Conservation Authority in trust for the purpose of "Conservation of Flora and Fauna, and Water".

Notice to this effect was published in the Government Gazette of June 27, 1986 and I enclose a print showing the said Reserve.

R. W. Mickle  
ACTING EXECUTIVE DIRECTOR

8 July 1986

enc

10-7-86  
Wildlife Admin

383/80 ✓ cf  
383A/80 ✓ cf  
15/9/86

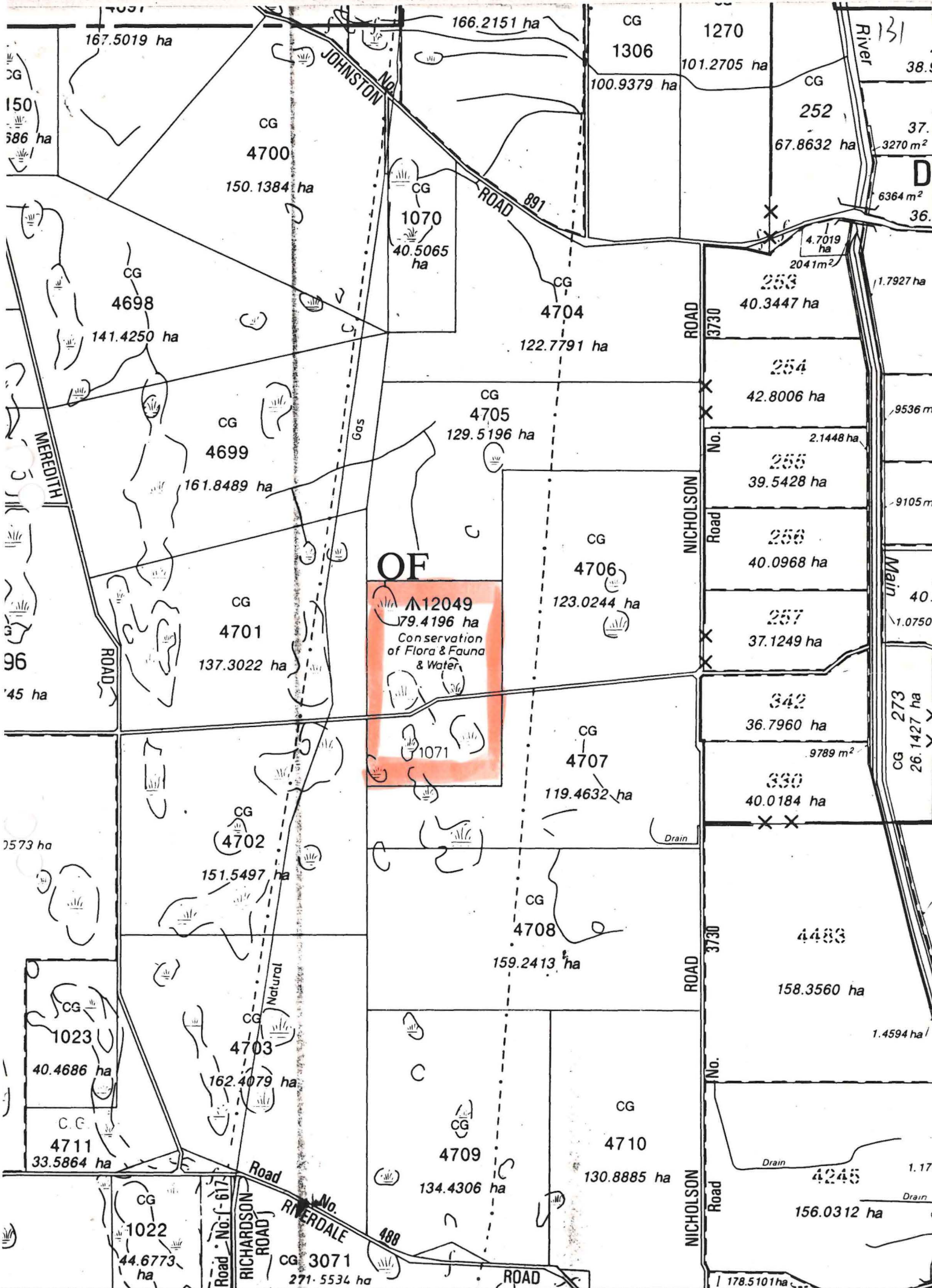

**OF**  
12049  
179.4196 ha  
Conservation  
of Flora & Fauna  
& Water

D  
36.

40.  
1.0750

CG 273  
26.1427 ha

1.4594 ha

1.17  
Drain

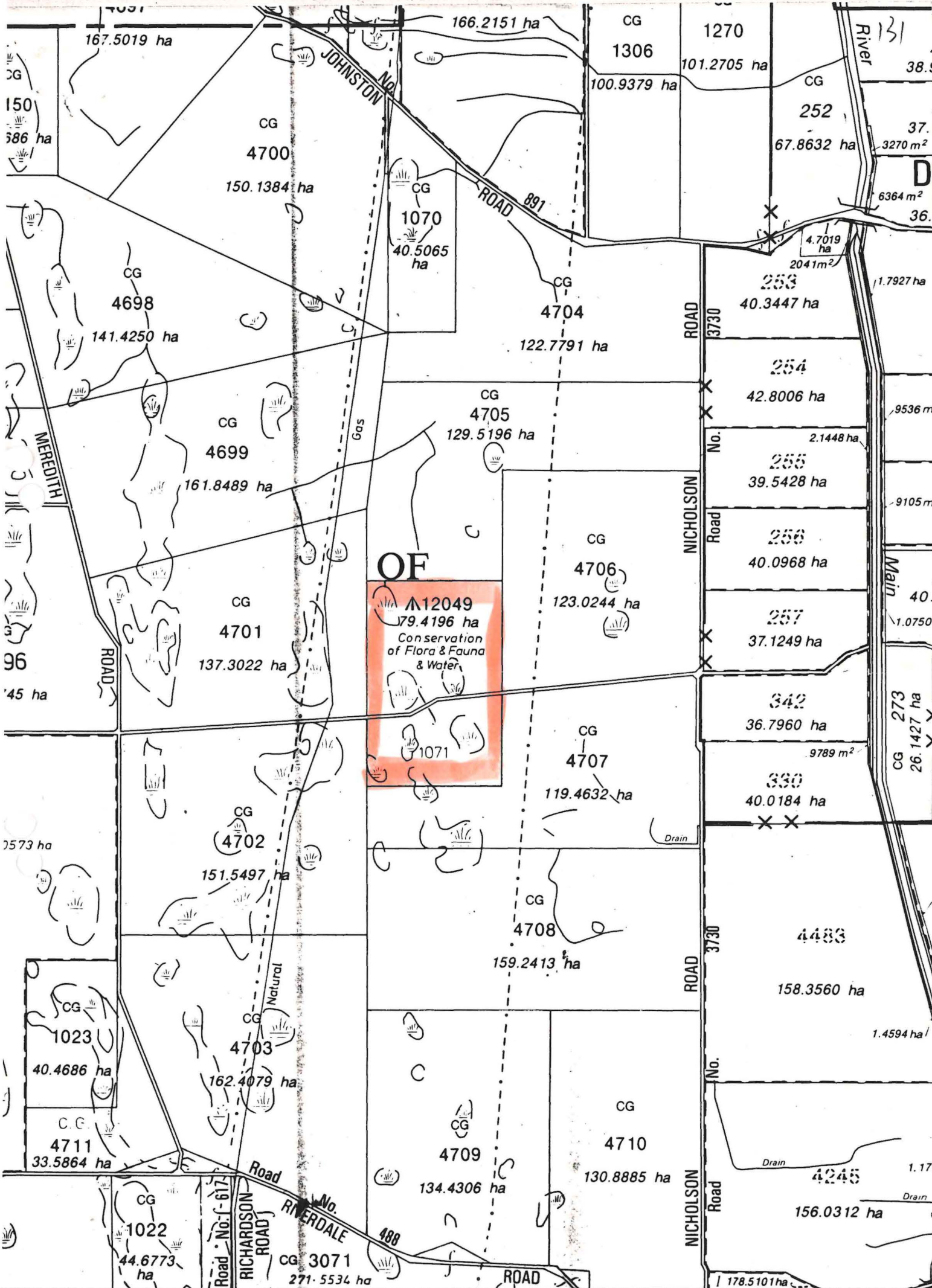

## NAMING OF RESERVES

Department of Land Administration,  
Perth, 19 December 1986.

Corres. No. 3583/981.

IT is hereby notified for general information that the Reserves listed in the Schedule hereunder are by this Notice, named in accordance with the said Schedule.

Reserve No; Reserve Name; Public Plan  
22262; Wundowlin Nature Reserve; Mukinbudin 1:50 000.  
31715; Barbalin Nature Reserve; Mukinbudin 1:50 000.  
13051; Calcaling Nature Reserve; Calcaling 1:50 000.  
30705; South Wilgoyne Nature Reserve; Calcaling 1:50 000.  
31629; Cookinbin Nature Reserve; Nungarin 1:50 000.  
23835; Karloning Nature Reserve; Karloning 1:50 000.  
29303; North Bonnie Rock Nature Reserve; Blain 1:50 000.  
20530; Portion of Joverdine Nature Reserve; Bonnie Rock 1:50 000.  
37034; Portion of Joverdine Nature Reserve; Bonnie Rock 1:50 000.  
36526; Lake Cronin Nature Reserve; Lake Cronin 1:50 000.  
A17186; Walyormouring Nature Reserve; Botherling S.W. & S.E.  
A4313; Eaton Nature Reserve; Quelagetting 1:50 000.  
14510; Hindmarsh Nature Reserve; Quelagetting 1:50 000.  
A9228; Moonijin Nature Reserve; Cadoux S.E.  
15794; Cullimbin Nature Reserve; Cadoux N.E.  
10991; Carrimbin Rock Nature Reserve; 33/80.  
21719; Wallambin Nature Reserve; Yelbeni 1:50 000.  
10992; Elashgin Nature Reserve; Bulagin 1:50 000.  
23887; Wyalkatchem Nature Reserve; Wyalkatchem 1:10 000 5.6 & 5.7.  
34385; Nembudding Nature Reserve; Yelbeni 1:50 000.  
15386; Yelbeni Nature Reserve; Yelbeni Townsite.  
35413; Walcancobbing Nature Reserve; Trayning 1:50 000.  
15579; East Wallambin Nature Reserve; Lake Wallambin S.E.  
20986; Marindo Nature Reserve; Beacon 1:50 000.  
22457; North Beacon Nature Reserve; Beacon 1:50 000.  
26911; Beebeegnying Nature Reserve; Gabbing 1:50 000.  
17923; Mungarri Nature Reserve; Beacon 1:50 000.  
24539; Herndermuning Nature Reserve; Beacon 1:50 000.  
35679; Danjinning Nature Reserve; Karloning 1:50 000.  
12689; Wiacubbing Nature Reserve; Bencubin 1:50 000.  
26687; North Wallambin Nature Reserve; Lake Wallambin S.E.  
24789; Lake Champion Nature Reserve; 35/80.  
23339; Elachbutting Nature Reserve; 67/80.  
23338; Geeraning Nature Reserve; 67/80.  
16235; Carrabin Nature Reserve; Carrabin Townsite.  
1431; Baladjie Nature Reserve; 53/80, 54/80.  
A35732; Walyahmoning Nature Reserve; Waroona Townsite.  
24465; Yanneymoon Nature Reserve; 54/80.  
25194; Anderson Lake Nature Reserve; Toolbrunup S.E.  
26162; Three Swamps Nature Reserve; Toolbrunup S.E.  
30526; East Balicup Nature Reserve; Toolbrunup S.W.  
26381; McDougall Nature Reserve; Merilup S.E.  
9237; Portion of Snake Gully Nature Reserve; 88/80, 89/80.  
10351; Portion of Snake Gully Nature Reserve; 88/80, 89/80.  
36448; Portion of Snake Gully Nature Reserve; 89/80.  
27283; Goodlands Nature Reserve; Kalannie 1:50 000.  
26259; Carlyarn Nature Reserve; Karrakutta 1:50 000.  
18381; Sawyers Nature Reserve; Kalannie 1:50 000.  
19650; Old Store Nature Reserve; Kalannie 1:50 000.  
33803; Milyu Nature Reserve; Perth 1:2 000 12.21, 12.22, 13.21, 13.22.  
16867; Dukin Nature Reserve; Koorda S.E.  
24838; Walk Walkin Nature Reserve; Koorda S.W.  
9281; Portion of Warramuggan Nature Reserve; Koorda S.E.  
16040; Portion of Warramuggan Nature Reserve; Koorda S.E.  
4670; Nembudding South Nature Reserve; Yelbeni S.W.  
12398; Lake Mears Nature Reserve; Quairading S.W.

36063; Strange Road Nature Reserve; Luptons S.W., S.E.  
19740; Bartram Nature Reserve; Luptons S.E.  
36519; Pingeulling Nature Reserve; Brookton S.W.  
36742; Brookton Highway Nature Reserve; Luptons S.E.  
8830; Bulgin Nature Reserve; Cunderdin 1:50 000.  
10313; Noonying Nature Reserve; 26C/40.  
23566; Tammin Nature Reserve; 26C/40.  
17732; North Bungulla Nature Reserve; Kellerberrin 1:50 000.  
4667; Lundy Nature Reserve; 26B/40.  
24831; Wyola Nature Reserve; 26C/40.  
28289; Moulieu Nature Reserve; 3B/40.  
33990; Bungulla Nature Reserve; Bungulla Townsite.  
21153; Morranoppin Nature Reserve; Doodlakine 1:50 000.  
22921; Durokoppin Nature Reserve; Kodjikooin 1:50 000.  
12329; North Bandee Nature Reserve; Kodjikooin 1:50 000.  
24897; Mournucking Nature Reserve; Kellerberrin 1:50 000.  
25112; Portion of Glenluce Nature Reserve; Pantapin 1:50 000.  
26266; Portion of Glenluce Nature Reserve; Pantapin 1:50 000.  
30903; Craig Nature Reserve; Pantapin 1:50 000.  
5456; Dead Mans Swamp Nature Reserve; Hillman S.E. Moodiarup N.E.  
25904; Boolading Nature Reserve; Boolading Townsite.  
16904; Hillman Nature Reserve; Hillman N.W.  
21521; Williams Nature Reserve; Williams N.E.  
29313; Borgey Nature Reserve; Highbury N.W. Williams N.E.  
32448; Moorapulling Nature Reserve; Dwarda S.W.  
30563; Moomagul Nature Reserve; Dattening N.W.  
19784; Haddleton Springs Nature Reserve; Blackwood River N.W., S.W.  
29322; Weam Nature Reserve; Brookton S.W., N.W.  
31913; Haddleton Nature Reserve; Blackwood River N.W., N.E.  
13373; Benjabbering Nature Reserve; Benjabbering Townsite.  
15895; Folly Nature Reserve; Yorkrakine 1:50 000.  
14920; Dingo Well Nature Reserve; Wyalkatchem 1:50 000.  
13242; Gabwotting Nature Reserve; Wyalkatchem 1:50 000.  
A23756; Portion of Kooljerrenup Nature Reserve; Lake Clifton N.E.  
36126; Portion of Kooljerrenup Nature Reserve; Lake Clifton N.E.  
B4990; Portion of Austin Bay Nature Reserve; Mandurah 1:10 000, 2.7.  
B24036; Portion of Austin Bay Nature Reserve; Pinjarra N.W.  
28087; Portion of Austin Bay Nature Reserve; Mandurah S.E., N.E. Pinjarra S.W., N.W.  
24739; McLarty Nature Reserve; Mandurah 1:10 000, 1.5.  
33749; Boodalan Nature Reserve; Mandurah 1:10 000, 2.7.  
16907; Nine Mile Lake Nature Reserve; Pinjarra S.W.  
22199; Buller Nature Reserve; Hamel N.W., S.W.  
12049; Harvey Flats Nature Reserve; Hamel S.W.  
12632; Riverdale Nature Reserve; Hamel S.W.  
24472; Crampton Nature Reserve; Lake Preston N.E., N.W.  
22797; Falls Brook Nature Reserve; Harvey N.E. Tallanalla N.W.  
34811; Benger Swamp Nature Reserve; Harvey S.W.  
1740; Wild Horse Swamp Nature Reserve; Blackwood River S.E.  
24917; Toverring Nature Reserve; Moddiarup N.W.  
30668; Arthur River Nature Reserve; East Arthur N.W. Hillman N.E.  
7349; Jandabup Nature Reserve; Swan 1:10 000, 3.2.  
A31048; Portion of Lake Joondalup Nature Reserve; Swan 1:10 000, 2.2.  
A21708; Portion of Lake Joondalup Nature Reserve; Swan 1:10 000, 2.2.  
30809; Woodvale Nature Reserve; Swan 1:2 000, 8.03, 8.04, 9.04.  
25919; Copley Dale Nature Reserve; Swan 1:10 000, 6.3.  
30667; Beechina Nature Reserve; 3E/40.

*Records* *2 LAND CLERK*  
Please ensure that title of list is correct  
Dae C  
3.11.87

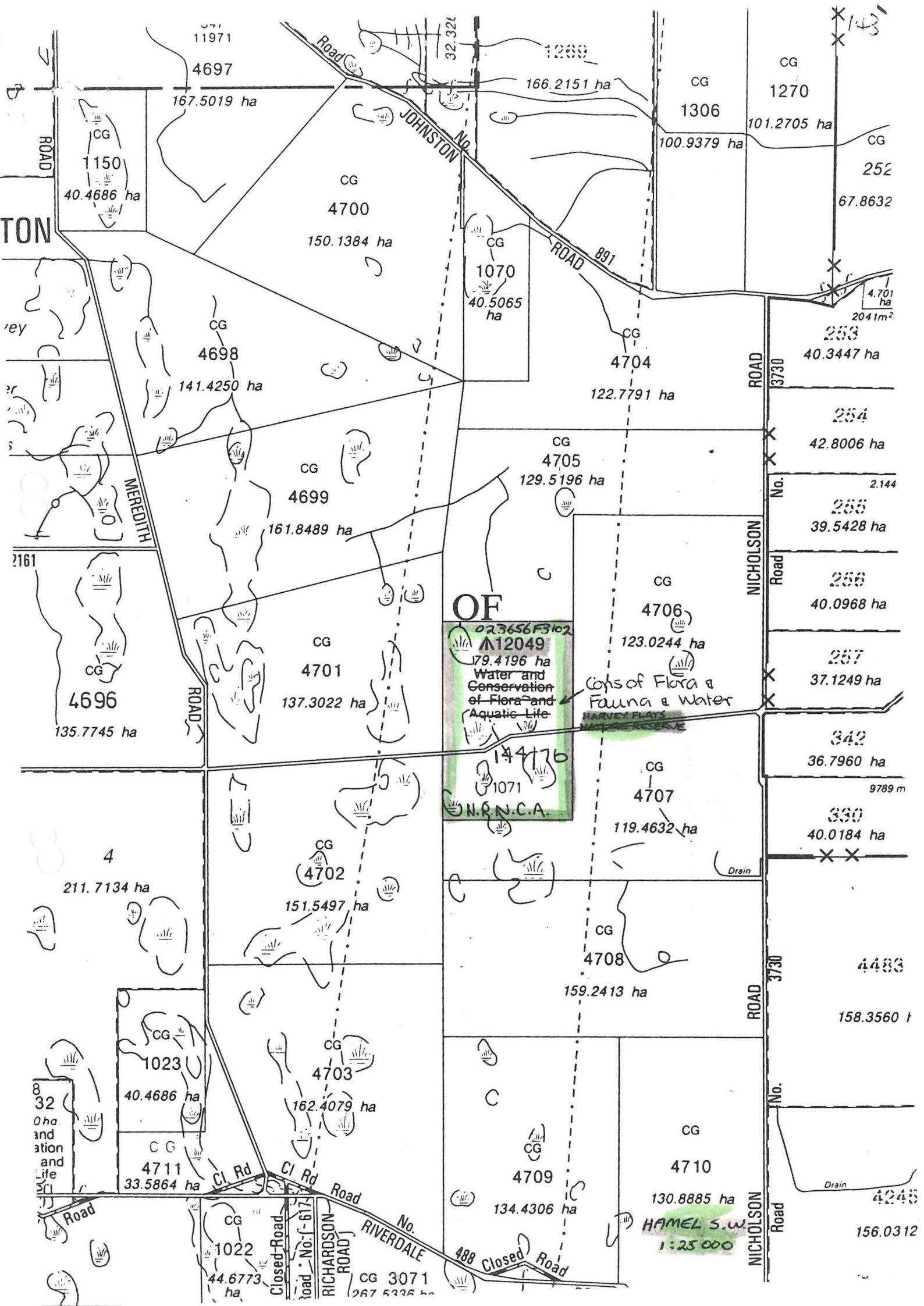

11971  
4697  
167.5019 ha  
ROAD  
CG  
1150  
40.4686 ha

32.321  
1289  
166.2151 ha  
JOHNSTON ROAD No. 891  
CG  
4700  
150.1384 ha  
CG  
1070  
40.5065 ha

CG  
1306  
101.2705 ha  
CG  
252  
67.8632  
CG  
1270  
100.9379 ha  
CG  
4.701 ha  
2041m<sup>2</sup>

CG  
4698  
141.4250 ha  
MEREDITH ROAD  
CG  
4699  
161.8489 ha  
CG  
4701  
137.3022 ha  
CG  
4696  
135.7745 ha

CG  
4704  
122.7791 ha  
CG  
4705  
129.5196 ha  
CG  
4706  
123.0244 ha  
CG  
4707  
119.4632 ha  
CG  
4708  
159.2413 ha  
ROAD 3730  
CG  
253  
40.3447 ha  
CG  
254  
42.8006 ha  
No. 2.144  
CG  
255  
39.5428 ha  
CG  
256  
40.0968 ha  
CG  
257  
37.1249 ha

**OF**  
023656F3102  
CG  
4706  
123.0244 ha  
CG  
4707  
119.4632 ha  
CG  
4708  
159.2413 ha  
CG  
1071  
144.176  
N.Z.N.C.A.

Cons of Flora & Fauna & Water  
HARVEY FLATS  
NATURAL RESERVE

2161  
CG  
4696  
135.7745 ha

4  
211.7134 ha  
CG  
4702  
151.5497 ha  
CG  
4703  
162.4079 ha

CG  
1023  
40.4686 ha  
CG  
4711  
33.5864 ha  
Cl Rd  
Cl Rd  
ROAD  
CG  
1022  
44.6773 ha  
CG  
3071  
267.5326 ha

CG  
4709  
134.4306 ha  
CG  
4710  
130.8885 ha  
ROAD 3730  
CG  
4706  
123.0244 ha  
CG  
4707  
119.4632 ha  
CG  
4708  
159.2413 ha  
CG  
4709  
134.4306 ha  
CG  
4710  
130.8885 ha  
ROAD 3730  
CG  
258  
40.3447 ha  
CG  
259  
37.1249 ha  
CG  
349  
36.7960 ha  
9789 m  
CG  
350  
40.0184 ha  
CG  
4245  
156.0312

32  
Oh.  
and  
Life

HAMEL S.W.  
1:25 000

RICHARDSON ROAD  
RIVERDALE ROAD  
488 Closed Road