

NAMING OF RESERVES

Department of Land Administration,
Perth, 19 December 1986.

Corres. No. 3583/981.

IT is hereby notified for general information that the Reserves listed in the Schedule hereunder are by this Notice, named in accordance with the said Schedule.

Reserve No; Reserve Name; Public Plan
22262; Wundowlin Nature Reserve; Mukinbudin 1:50 000.
31715; Barbalin Nature Reserve; Mukinbudin 1:50 000.
13051; Calcaling Nature Reserve; Calcaling 1:50 000.
30705; South Wilgoyne Nature Reserve; Calcaling 1:50 000.
31629; Cookinbin Nature Reserve; Nungarin 1:50 000.
23835; Karloning Nature Reserve; Karloning 1:50 000.
29303; North Bonnie Rock Nature Reserve; Blain 1:50 000.
20530; Portion of Joverdine Nature Reserve; Bonnie Rock 1:50 000.
37034; Portion of Joverdine Nature Reserve; Bonnie Rock 1:50 000.
36526; Lake Cronin Nature Reserve; Lake Cronin 1:50 000.
A17186; Walyormouring Nature Reserve; Botherling S.W. & S.E.
A4313; Eaton Nature Reserve; Quelagetting 1:50 000.
14510; Hindmarsh Nature Reserve; Quelagetting 1:50 000.
A9228; Moonijin Nature Reserve; Cadoux S.E.
15794; Cullimbin Nature Reserve; Cadoux N.E.
10991; Carrimbin Rock Nature Reserve; 33/80.
21719; Wallambin Nature Reserve; Yelbeni 1:50 000.
10992; Elashgin Nature Reserve; Bulagin 1:50 000.
23887; Wyalkatchem Nature Reserve; Wyalkatchem 1:10 000 5.6 & 5.7.
34385; Nembudding Nature Reserve; Yelbeni 1:50 000.
15386; Yelbeni Nature Reserve; Yelbeni Townsite.
35413; Walcancobbing Nature Reserve; Trayning 1:50 000.
15570; East Wallambin Nature Reserve; Lake Wallambin S.E.
20986; Marindo Nature Reserve; Beacon 1:50 000.
22457; North Beacon Nature Reserve; Beacon 1:50 000.
26911; Beebeegnying Nature Reserve; Gabbing 1:50 000.
17923; Mungarri Nature Reserve; Beacon 1:50 000.
24539; Herndermuning Nature Reserve; Beacon 1:50 000.
35679; Danjinning Nature Reserve; Karloning 1:50 000.
12689; Wiacubbing Nature Reserve; Bencubin 1:50 000.
26687; North Wallambin Nature Reserve; Lake Wallambin S.E.
24789; Lake Champion Nature Reserve; 35/80.
23339; Elachbutting Nature Reserve; 67/80.
23338; Geeraning Nature Reserve; 67/80.
16235; Carrabin Nature Reserve; Carrabin Townsite.
1431; Baladjie Nature Reserve; 53/80, 54/80.
A35732; Walyahmoning Nature Reserve; Waroona Townsite.
24465; Yanneymooning Nature Reserve; 54/80.
25194; Anderson Lake Nature Reserve; Toolbrunup S.E.
26162; Three Swamps Nature Reserve; Toolbrunup S.E.
30526; East Balicup Nature Reserve; Toolbrunup S.W.
26381; McDougall Nature Reserve; Merilup S.E.
9237; Portion of Snake Gully Nature Reserve; 88/80, 89/80.
10351; Portion of Snake Gully Nature Reserve; 88/80, 89/80.
36448; Portion of Snake Gully Nature Reserve; 89/80.
27283; Goodlands Nature Reserve; Kalannie 1:50 000.
26259; Carlyarn Nature Reserve; Karrakutta 1:50 000.
18381; Sawyers Nature Reserve; Kalannie 1:50 000.
19650; Old Store Nature Reserve; Kalannie 1:50 000.
33803; Milyu Nature Reserve; Perth 1:2 000 12.21, 12.22, 13.21, 13.22.
16867; Dukin Nature Reserve; Koorda S.E.
24838; Walk Walkin Nature Reserve; Koorda S.W.
9281; Portion of Warramuggan Nature Reserve; Koorda S.E.
16040; Portion of Warramuggan Nature Reserve; Koorda S.E.
4670; Nembudding South Nature Reserve; Yelbeni S.W.
12398; Lake Mears Nature Reserve; Quairading S.W.

36063; Strange Road Nature Reserve; Luptons S.W., S.E.
19740; Bartram Nature Reserve; Luptons S.E.
36519; Pingeculling Nature Reserve; Brookton S.W.
36742; Brookton Highway Nature Reserve; Luptons S.E.
8830; Bulgin Nature Reserve; Cunderdin 1:50 000.
10313; Noonying Nature Reserve; 26C/40.
23566; Tammin Nature Reserve; 26C/40.
17732; North Bungulla Nature Reserve; Kellerberrin 1:50 000.
4667; Lundy Nature Reserve; 26B/40.
24831; Wyola Nature Reserve; 26C/40.
28289; Moulieu Nature Reserve; 3B/40.
33990; Bungulla Nature Reserve; Bungulla Townsite.
21153; Morranoppin Nature Reserve; Doodlakine 1:50 000.
22921; Durokoppin Nature Reserve; Kodjikooin 1:50 000.
12329; North Bandee Nature Reserve; Kodjikooin 1:50 000.
24897; Mournucking Nature Reserve; Kellerberrin 1:50 000.
25112; Portion of Glenluce Nature Reserve; Pantapin 1:50 000.
26266; Portion of Glenluce Nature Reserve; Pantapin 1:50 000.
30903; Craig Nature Reserve; Pantapin 1:50 000.
5456; Dead Mans Swamp Nature Reserve; Hillman S.E. Moodiarup N.E.
25904; Boolading Nature Reserve; Boolading Townsite.
16904; Hillman Nature Reserve; Hillman N.W.
21521; Williams Nature Reserve; Williams N.E.
29313; Borgey Nature Reserve; Highbury N.W. Williams N.E.
32448; Moorapulling Nature Reserve; Dwarda S.W.
30563; Moomagul Nature Reserve; Dattening N.W.
19784; Haddleton Springs Nature Reserve; Blackwood River N.W., S.W.
29322; Weam Nature Reserve; Brookton S.W., N.W.
31913; Haddleton Nature Reserve; Blackwood River N.W., N.E.
13373; Benjabbering Nature Reserve; Benjabbering Townsite.
15895; Folly Nature Reserve; Yorkrakine 1:50 000.
14920; Dingo Well Nature Reserve; Wyalkatchem 1:50 000.
13242; Gabwotting Nature Reserve; Wyalkatchem 1:50 000.
A23756; Portion of Kooljerrenup Nature Reserve; Lake Clifton N.E.
36126; Portion of Kooljerrenup Nature Reserve; Lake Clifton N.E.
B4990; Portion of Austin Bay Nature Reserve; Mandurah 1:10 000, 2.7.
B24036; Portion of Austin Bay Nature Reserve; Pinjarra N.W.
28087; Portion of Austin Bay Nature Reserve; Mandurah S.E., N.E. Pinjarra S.W., N.W.
24739; McLarty Nature Reserve; Mandurah 1:10 000, 1.5.
33749; Boodalan Nature Reserve; Mandurah 1:10 000, 2.7.
16907; Nine Mile Lake Nature Reserve; Pinjarra S.W.
22199; Buller Nature Reserve; Hamel N.W., S.W.
12049; Harvey Flats Nature Reserve; Hamel S.W.
12632; Riverdale Nature Reserve; Hamel S.W.
24472; Crampton Nature Reserve; Lake Preston N.E., N.W.
22797; Falls Brook Nature Reserve; Harvey N.E. Tallanalla N.W.
34811; Benger Swamp Nature Reserve; Harvey S.W.
1740; Wild Horse Swamp Nature Reserve; Blackwood River S.E.
24917; Tawerring Nature Reserve; Moddiarup N.W.
30668; Arthur River Nature Reserve; East Arthur N.W. Hillman N.E.
7349; Jandabup Nature Reserve; Swan 1:10 000, 3.2.
A31048; Portion of Lake Joondalup Nature Reserve; Swan 1:10 000, 2.2.
A21708; Portion of Lake Joondalup Nature Reserve; Swan 1:10 000, 2.2.
30809; Woodvale Nature Reserve; Swan 1:2 000, 8.03, 8.04, 9.04.
25919; Copley Dale Nature Reserve; Swan 1:10 000, 6.3.
30667; Beechina Nature Reserve; 3B/40.

56
y Records
2 LAND CLERK
Please ensure that title of list is correct
DOME AMP. 26-7-88

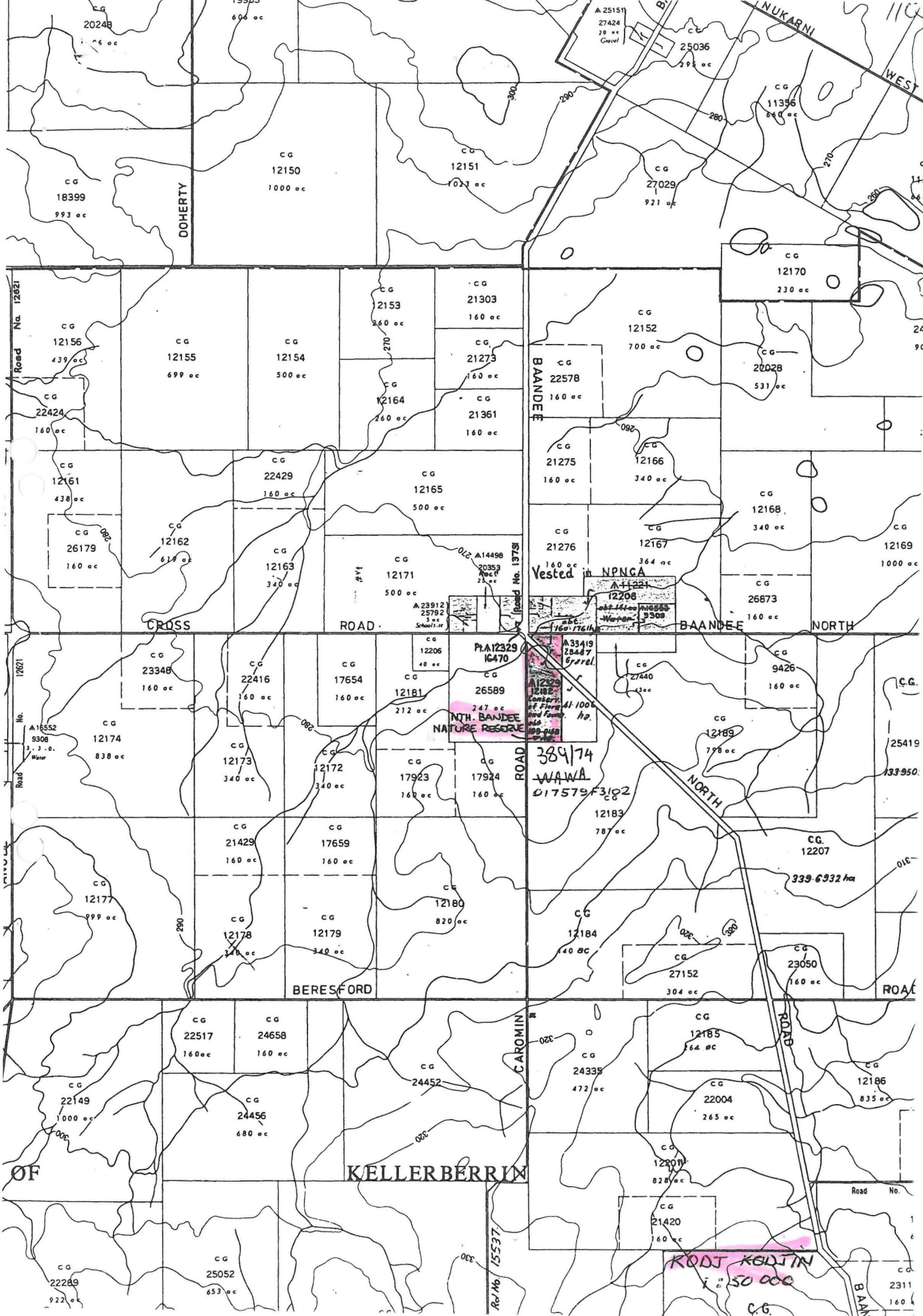

2024B

CG 18399
993 ac

DOHERTY

CG 12150
1000 ac

CG 12151
1023 ac

A 25151
27424
28 ac
Gravel

25036
293 ac

CG 11356
840 ac

NUKARNI WEST

Road No. 12821

CG 12156
439 ac

CG 12155
699 ac

CG 12154
500 ac

CG 2153
260 ac

CG 21303
160 ac

CG 12152
700 ac

CG 12170
230 ac

CG 22424
160 ac

CG 12164
260 ac

CG 21273
160 ac

CG 21361
160 ac

BAADEE

CG 22578
160 ac

CG 20028
531 ac

CG 12161
438 ac

CG 22429
160 ac

CG 12165
500 ac

CG 21275
160 ac

CG 12166
340 ac

CG 12168
340 ac

CG 26179
160 ac

CG 12162
611 ac

CG 12171
500 ac

CG 12206
40 ac

CG 12181
212 ac

CG 26589
247 ac

Vested in NPNGA
A 11224
12208
A 16553
Water
3308
A 33419
28487
Gravel
A 12182
12182
A 11006
ho.

CG 27440
330 ac

CG 9426
160 ac

CROSS

ROAD

BAADEE NORTH

Road No. 12821

CG 12174
838 ac

CG 22416
160 ac

CG 17654
160 ac

CG 12181
212 ac

CG 26589
247 ac

384174
WAWA
017579 F3102

CG 27440
330 ac

CG 9426
160 ac

NTH. BANDEE NATURE RESERVE

Road No. 12821

CG 12177
999 ac

CG 21429
160 ac

CG 17659
160 ac

CG 17923
160 ac

CG 17924
160 ac

CG 12183
787 ac

CG 12189
798 ac

CG 9426
160 ac

Road No. 12821

CG 22149
1000 ac

CG 22517
160 ac

CG 24658
160 ac

CG 24452

CG 24335
472 ac

CG 12185
164 ac

CG 22004
265 ac

CG 12186
835 ac

OF

KELLERBERRIN

ROAD

CG 22289
922 ac

CG 25052
653 ac

CG 24452

CG 12201
828 ac

CG 21420
160 ac

ROD J KOLJIN
i. 50 000
CG

CG 2311
160 ac

BAADEE

Road No. 15537

Road No.