

RESERVE ACTION SHEET - CONSERVATION RESERVES

RESERVE No. 13534

REASON FOR ACTION

Change of purpose from 'Water and Camping' to 'Timber' with a Management Order issued to the Conservation Commission (previously vested in the Hon.Minister for Works)

Area: 43.60 hectares

The revesting of this reserve is a recommendation by the Shire of Narambeen. The purpose was decided upon to allow the establishment of sandalwood. The reserve has a good existing population of sandalwood (*Santalum spicatum*), with mature jam (*Acacia acuminata*) throughout the reserve. The reserve is fenced with good boundary access.

- Date of DOLA's advice: 22 May 2001 See folio: 40
- Plans at folios: 26,25

	OFFICER	ACTION
1	CONSERVATION ESTATE OFFICER	- Fill in above details - Attach copies of DOLA's advice to file Send copies of advice & maps to: - Lisa Wright, Woodvale - District Manager, Busselton - Peter Hanly, Bunbury Recommended IUCN classification: VI
2	LAND ACQUISITIONS OFFICER	To note:
3	MANAGER, PLANNING & VISITOR SERVICES	To note & approve IUCN classification:
4	DIRECTOR, NATURE CONSERVATION/ NATIONAL PARKS	To note:
5	INDEX CLERK, RECORDS	To note:
6	CONSERVATION ESTATE OFFICER	Attach copy of Reserve Details to inside cover of new file

**Customer Advices for Reserve Actions
1/07/2001 - 31/07/2001**

Shire of Narembeen 1/07/2001 - 31/07/2001

Reserve No.	Land Description	DOLA File No.	Volume/Folio	Action	Document No.	Registered	Street Name	Area	Public Plans
13534		07968-1910-01RO	3064-61	Management Order to Conservation Commission of Western Australia of Corner Hackett Drive and Australia II Drive Crawley, Western Australia 6009 To be utilised for the designated purpose only for the designated purpose of "Timber"	H755190	22/05/2001	Merredin-Narembeen Road	43.6048 Ha	Wadderin (50)

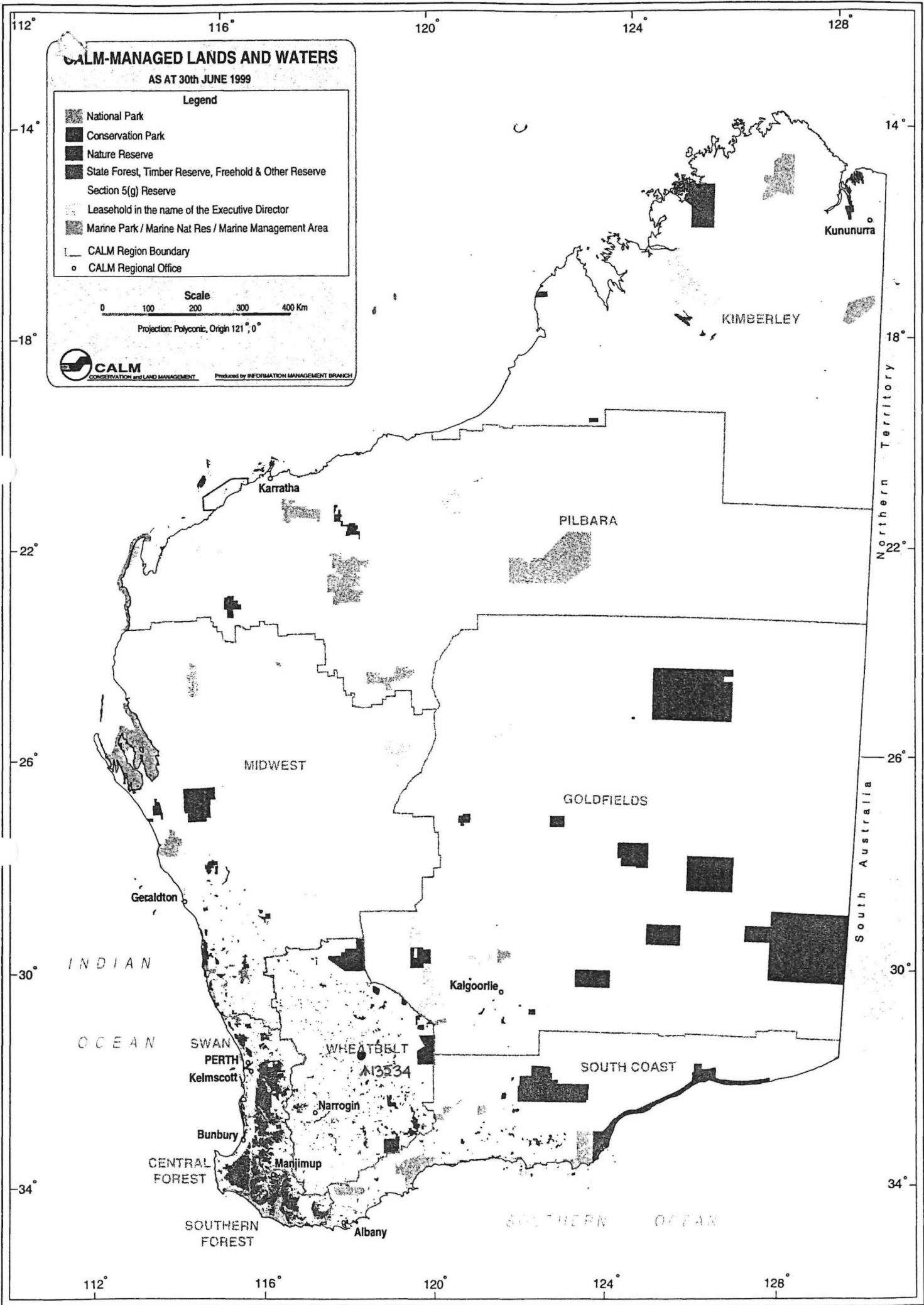

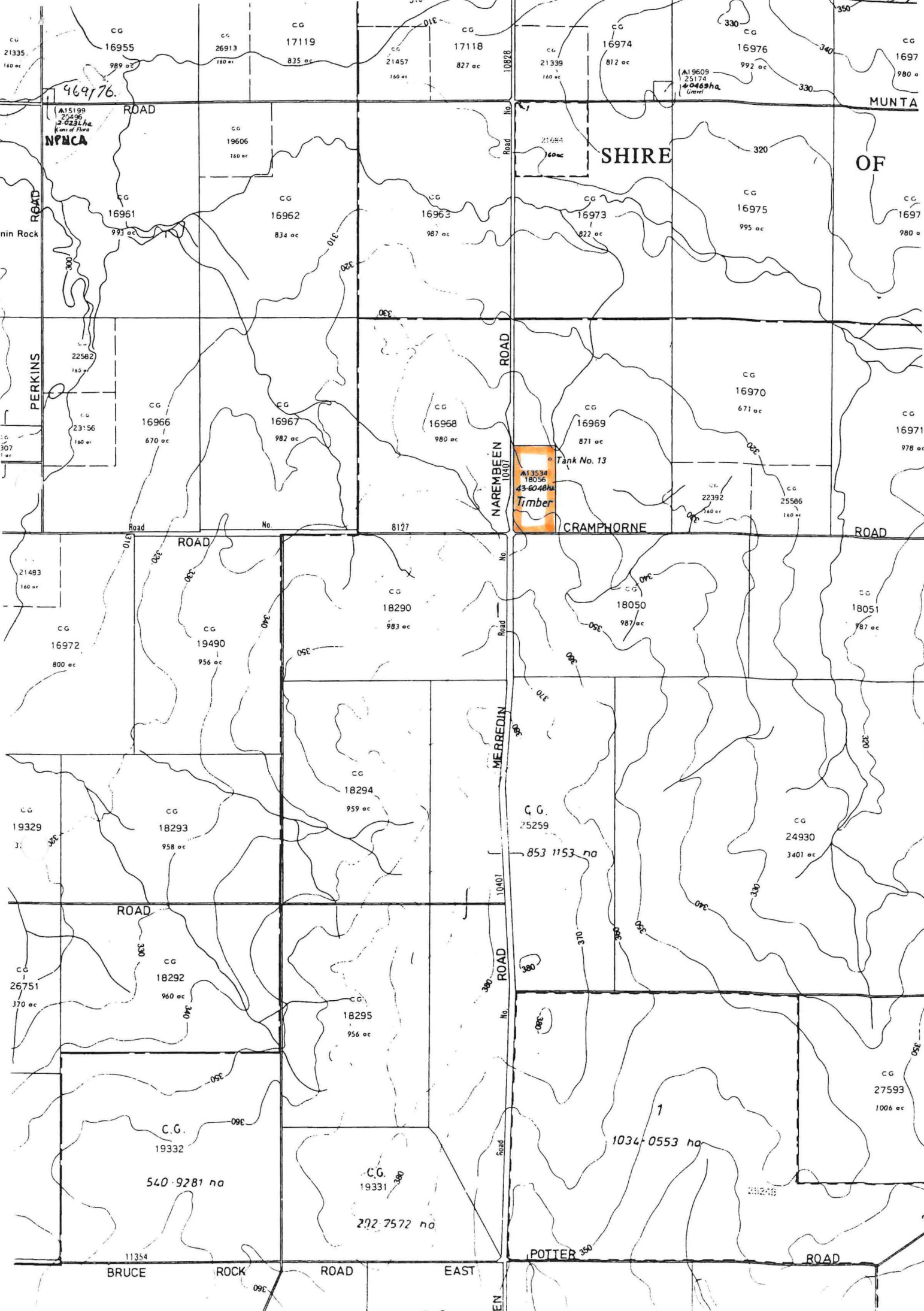

469176
 (A)15198
 27496
 3-0231 ha
 (Cons of Trees)
 NPWS

(A)13534
 18056
 43-60-48 ha
 Timber

(A)19609
 25174
 4-0469 ha
 (Cons of Trees)

PERKINS ROAD

NAREMBEEN ROAD

MERREDIN ROAD

BRUCE ROCK ROAD

POTTER ROAD

SHIRE

OF

MUNTA

CRAMPHORNE

ROAD

min Rock

min Rock

min Rock

min Rock

min Rock

min Rock

min Rock

min Rock

min Rock

min Rock

min Rock

min Rock

min Rock

min Rock

min Rock

min Rock